

PRE-DRILL

for hard woods.  
woods and a 3/32in. (2.4mm) drill bit  
pre-drill holes in the mounting surface  
with a 1/16in. (1.5mm) drill bit for soft  
Using the pencil marks for guidance,  
**STEP 3: PRE-DRILL**



MARK

for guidance.  
screw with a pencil, using the keyholes  
fully installed. Mark the locations for each  
direction the linking cords will face when  
plugging the included linking cord into  
the output of the first fixture and into the  
input of the second fixture.

**STEP 2: MARK SCREW LOCATION**

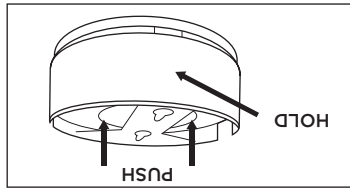

HOLD

PUSH

remove the puck.  
and input cords out of the way to fully  
two. You may need to bend the output  
the backside of the puck to separate the  
Hold the ring in place and firmly push on  
**STEP 1: SEPARATE PUCK FROM RING**

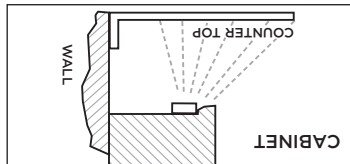

CABINET

a countertop.  
This provides the best light distribution across  
lip of your kitchen under cabinets as shown.  
For kitchen installations, the recommended  
mounting for LED puck lights is near the front  
of your kitchen under cabinets as shown.  
next puck in the sequence.

outlet with the output cord facing the  
always be facing towards the nearest  
5in. output cord. The input cord should  
and has a pre-installed 7in. input cord and  
Each puck is held within a ring-like frame

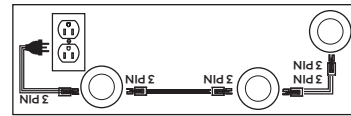

as needed.  
the nearest 120VAC 60Hz outlet. screws  
puck in the sequence. Then, plug it into  
power cord with the input cord of the first  
installed and connected, connect the  
After all of the pucks have been properly

**STEP 9: CONNECT TO POWER**

Repeat steps 1-7 to install additional  
fixtures. Connect them to each other by  
plugging the included linking cord into  
the output of the first fixture and into the  
input of the second fixture.

**STEP 8: LINK TO ADDITIONAL PROLINK FIXTURES**

Continue to feed the cords through their  
openings and push the puck back into the  
ring until it snaps into place.

**STEP 7: INSTALL PUCK**

With the cords fed through the ring, align  
the keyholes with the screws and slide  
them securely into place. Tighten the  
screws as needed.

**STEP 6: MOUNT RING**

and tighten the screws.  
ring as the cords cannot be inserted afterwards.

leaving enough room to mount the ring  
both cords back through their openings—  
Before mounting the ring, partially feed  
and tighten the screws.

**STEP 5: FEED CORDS INTO RING**

the surface.  
leaving the heads protruding 1/8in. from  
Place each screw in the pre-drilled holes.

**STEP 4: INSERT SCREWS**



LIGHTING SPECS 3 PUCKS (55214)	LUMENS: 663	WATTAGE: 11.7	CRI: 97	LUMENS/WATT: 56.7	CCT: 3000K / 4000K / 5000K
LIGHTING SPECS 5 PUCKS (55215)	LUMENS: 1105	WATTAGE: 19.5	CRI: 97	LUMENS/WATT: 56.7	CCT: 3000K / 4000K / 5000K

**CLEANING INSTRUCTIONS:** Your LED light fixture is made from quality materials that will last for many years with minimum care. When cleaning, make sure you have unplugged your LED light fixture and have allowed sufficient time for the unit to cool to room temperature. You should clean the housing and lens using a soft, damp cloth. DO NOT USE chemicals to thoroughly dried

LED light fixture in only after the light fixture has  
clean your LED light fixture as this could damage  
or disable the light fixture. You should plug your

**STEP 4: INSTALL PUCKS**

Feed the input and output cords through  
the hole, making sure that they face the  
proper direction. Press the puck upwards  
until it becomes fully seated into the  
mounting hole.

**STEP 3: DRILL HOLES**

Use a power drill and a 3/16in. hole  
saw to drill a mounting hole for each  
puck light.

Turn the LED puck lights ON/OFF with  
the in-line switch on the power cord.  
NOTE: The LED pucks are also fully dimmable  
with a compatible ProLink In-Line Dimmer  
(54873) (sold separately) or a compatible LED  
in-wall dimmer (sold separately).

**WHITE SELECT:** Change between Daylight (DL), Cool  
White (CW) and Warm White (WW)  
color temperatures.

**NOTE:** The white select switch only controls  
a single LED puck. If the pucks are recessed  
mounted, the color temperature must be  
selected before installation, as access to  
the switch will be unavailable after installation  
is complete.

**ON/OFF:** Turn the LED puck lights ON/OFF with  
the in-line switch on the power cord.

**OPERATION**

After all of the pucks have been properly  
installed and connected, connect the  
power cord with the input cord of the first  
puck in the sequence. Then, plug it into  
the nearest 120VAC 60Hz outlet.

**STEP 6: CONNECT TO POWER**

Repeat steps 1-4 to install additional  
PROLINK PUCKS

**STEP 5: LINK TO ADDITIONAL PROLINK PUCKS**

Hold the ring in place and firmly push on  
the backside of the puck to separate the  
and input cords out of the way to fully  
remove the puck.

**STEP 1: SEPARATE PUCK FROM RING**

Hold the ring in place and firmly push on  
the backside of the puck to separate the  
and input cords out of the way to fully  
remove the puck.

**STEP 2: MARK RECESSED HOLE LOCATIONS BEFORE YOU DRILL.** Consider the proper distance between each puck to make sure the linking cords and power cord have enough room to connect.

**STEP 3: DRILL HOLES**

Use a power drill and a 3/16in. hole saw to drill a mounting hole for each puck light.

**STEP 4: INSTALL PUCKS**

Feed the input and output cords through the hole, making sure that they face the proper direction. Press the puck upwards until it becomes fully seated into the mounting hole.

**STEP 5: LINK TO ADDITIONAL PROLINK PUCKS**

Repeat steps 1-4 to install additional PROLINK PUCKS

**STEP 6: CONNECT TO POWER**

After all of the pucks have been properly installed and connected, connect the power cord with the input cord of the first puck in the sequence. Then, plug it into the nearest 120VAC 60Hz outlet.

**WHITE SELECT:** Change between Daylight (DL), Cool White (CW) and Warm White (WW) color temperatures.

**NOTE:** The white select switch only controls a single LED puck. If the pucks are recessed mounted, the color temperature must be selected before installation, as access to the switch will be unavailable after installation is complete.

**ON/OFF:** Turn the LED puck lights ON/OFF with the in-line switch on the power cord.

**OPERATION**

After all of the pucks have been properly installed and connected, connect the power cord with the input cord of the first puck in the sequence. Then, plug it into the nearest 120VAC 60Hz outlet.

## RECESS INSTALLATION

## SURFACE INSTALLATION

Thank you for your purchase!

Instructions made easy



Read instructions or watch easy-to-follow video. Scan code or visit [byjasco.com/55214i](http://byjasco.com/55214i)

Exclusive deals



For deals, to register your purchase and to tell us how we're doing, simply scan the code or visit [byjasco.com/deals](http://byjasco.com/deals)



## LED Puck Lights User Manual



Discover more premium LED lighting and lighting accessories at [byjasco.com/lighting](http://byjasco.com/lighting)



**Like our product?**  
Leave a review on your favorite retailer website or amazon.com



**Having problems?**  
Let us know how we can help. Call 1-800-654-8483 between 7AM-8PM, M-F, Central Time.

**IMPORTANT: BEFORE INSTALLING, READ ALL SAFETY INSTRUCTIONS LISTED AT THE END OF THIS MANUAL.**

See reverse for easy-to-follow instructions and exclusive deals.

#### FCC STATEMENT:

Suppliers Declaration of Conformity | Model #: 55214 55215 | Jasco Products Co., 10 E. Memorial Rd., Oklahoma City, OK 73114, [www.byjasco.com](http://www.byjasco.com)

This device complies with Part 15 of the FCC rules. Operation is subject to the following two conditions: (1) this device may not cause harmful interference, and (2) this device must accept any interference received, including interference that may cause undesired operation.

**FCC NOTE:** The manufacturer is not responsible for any radio or TV interference caused by unauthorized modifications to this equipment. Such modifications could void the user's authority to operate the equipment.

**NOTE:** This equipment has been tested and found to comply with the limits for a Class B digital device, pursuant to Part 15 of the FCC Rules. These limits are designed to provide reasonable protection against harmful interference in a residential installation. This equipment generates, uses and can radiate radio frequency energy and, if not installed and used in accordance with the instructions, may cause harmful interference to radio communications. However, there is no guarantee that interference will not occur in a particular installation. If this equipment does cause harmful interference to radio or television reception, which can be determined by turning the equipment off and on, the user is encouraged to try to correct the interference by one or more of the following measures:

- Reorient or relocate the receiving antenna.
- Increase the separation between the equipment and receiver.
- Connect the equipment into an outlet on a circuit different from that to which the receiver is connected.
- Consult the dealer or an experienced radio/TV technician for help.

#### DECLARACIÓN DE LA COMISIÓN FEDERAL DE COMUNICACIONES (FCC):

Declaración de conformidad del proveedor | Modelo #: 55214 55215 | Jasco Products Co., 10 E. Memorial Rd, Oklahoma City, OK 73114, [www.byjasco.com](http://www.byjasco.com)

Este dispositivo cumple con las Especificaciones del apartado 15 de las normas de la FCC y con las especificaciones de las normas radioeléctricas (RSS) del Ministerio de Industria de Canadá aplicables a aparatos exentos de licencia. El funcionamiento está sujeto a las siguientes dos condiciones: (1) este dispositivo no debe provocar interferencia perjudicial, y (2) este dispositivo debe aceptar toda interferencia que reciba, incluso la que pudiera causar un funcionamiento no deseado.

**NOTA DE LA FCC:** El fabricante no se hace responsable de ninguna interferencia de radio o TV ocasionada por modificaciones no autorizadas efectuadas a este equipo. Dichas modificaciones podrían anular la autoridad del usuario para utilizar el equipo.

**NOTA:** Este equipo ha sido probado y cumple con los límites para aparatos digitales de Clase B, de conformidad con el apartado 15 de las normas de la FCC. Estos límites están diseñados para proveer protección razonable contra interferencias perjudiciales en una instalación residencial. Este equipo genera, usa y puede irradiar energía de radiofrecuencias y, si no se instala y usa según las instrucciones, puede provocar interferencia perjudicial a las radiocomunicaciones. No obstante, no hay garantías de que no ocurrirá interferencia en una instalación en particular. Si este equipo provoca interferencia perjudicial a la recepción de radio o televisión, lo que puede determinarse encendiendo y apagando el equipo, se recomienda que el usuario intente corregir la interferencia por medio de la implementación de una o más de las siguientes medidas:

- Reorientar o reubicar la antena receptora.
- Incrementar la separación entre el equipo y el receptor.
- Conectar el equipo a un tomacorriente de un circuito diferente del circuito al que está conectado el receptor.
- Consultar al distribuidor o a un técnico con experiencia en radio/televisión parasolicitar asistencia.

### ⚠ WARNING

- **RISK OF ELECTRIC SHOCK**
- DO NOT USE IN WET LOCATIONS.
- USE INDOORS ONLY.
- USE ONLY INSULATED STAPLES OR PLASTIC TIES TO SECURE THE CORDS.
- ROUTE AND SECURE THE CORDS SO THAT THEY WILL NOT BE PINCHED OR DAMAGED.
- NO SERVICEABLE PARTS
- NON-REPLACEABLE LEDS
- LED LIGHT OUTPUT IS STRONG ENOUGH TO INJURE HUMAN EYES. PRECAUTIONS MUST BE TAKEN TO PREVENT LOOKING DIRECTLY AT THE LEDS WITH UNAIDED EYES FOR MORE THAN A FEW SECONDS.
- **RISK OF FIRE**
- NOT INTENDED FOR ILLUMINATION OF AQUARIUMS.
- NOT INTENDED FOR USE ABOVE STOVES, COOK TOPS, SINKS OR OTHER HEAT PRODUCING APPLIANCES, SUCH AS COFFEE MAKERS, TOASTERS, OR TOASTER OVENS.
- NOT INTENDED FOR RECESSED INSTALLATION IN CEILINGS OR SOFFITS.
- NOT INTENDED FOR SURFACE INSTALLATION INSIDE OR ON TOP OF BUILT-IN FURNISHINGS SUCH AS KITCHEN CABINETS, CHINA CABINETS, OR TROPHY CASES.
- DO NOT CONCEAL POWER SUPPLY CORD OR LINKING CORDS INSIDE A WALL, CEILING, SOFFIT, KITCHEN CABINET, OR SIMILAR PERMANENT STRUCTURE.
- DO NOT RUN THE POWER SUPPLY CORD OR LINKING CORDS THROUGH HOLES IN WALLS, CEILINGS OR FLOORS.

MADE IN CHINA

Distributed by Jasco Products Company LLC, 10 E. Memorial Rd., Oklahoma City, OK 73114.

This Jasco product comes with a limited-lifetime warranty. Visit [www.byjasco.com](http://www.byjasco.com) for warranty details.

Questions? Contact our U.S.-based Consumer Care at 1-800-654-8483 between 7AM-8PM, M-F, Central Time.

55214 55215 v1  
11/20



[byjasco.com/recycle](http://byjasco.com/recycle)

### ⚠ ADVERTENCIA

- **RIESGO DE DESCARGA ELÉCTRICA**
- NO UTILICE EN UBICACIÓN MOJADOS.
- USO SOLO EN INTERIORES.
- UTILIZAR LA SÓLO GRAPAS AISLADAS O CUERDAS DE PLÁSTICOS PARA ASEGURAR LOS CABLES.
- RUTA Y ASEGURAR LAS CUERDAS PARA QUE NO VA SER APRETADO O DAÑAR. NO HAY PIEZAS NO REEMPLAZABLE BOMBILLO DE LED
- SALIDA DE LUZ LED ES SUFICIENTEMENTE FUERTE PARA DAÑAR LOS OJOS HUMANOS. DEBEN TOMARSE PRECAUCIONES PARA EVITAR MIRAR DIRECTAMENTE LOS LEDS CON OJOS SIN AYUDA PARA MÁS DE UNOS POCOS SEGUNDOS.
- **RIESGO DE INCENDIO**
- NO ES DESTINADOS PARA LA ILUMINACIÓN DE ACUARIO.
- NO ESTÁ DISEÑADO PARA USO POR ENCIMA DE LAS COCINAS, ENCIMERAS DE COCCIÓN, FREGADEROS O APARATOS DE CALOR PRODUCIENDO, COMO CAFETERAS, TOSTADORAS, HORNOS TOSTADORES O.
- NO ES DESTINADOS A LA INSTALACIÓN EMPOTRADA EN TECHO O PLAFONES.
- NO ES DESTINADOS A LA INSTALACIÓN DE SUPERFICIE DENTRO O ENCIMA DE MOBILIARIO INCORPORADA COMO GABINETES DE COCINAS, GABINETES DE CHINA O CASOS DE TROFEO.
- NO OCULTAR LA FUENTE DE ALIMENTACIÓN O LA CONEXIÓN DE CABLES ADENTRO DE UNA PARED, TECHO, PLAFONES, ARMARIOS DE COCINA O SIMILAR ESTRUCTURA PERMANENTE.
- NO SE EJECUTAN EL CABLE DE SUMINISTRO DE ALIMENTACIÓN O LA CONEXIÓN DE CABLES, A TRAVÉS DE AGUJEROS EN LAS PAREDES, TECHO O PISOS.

HECHO EN CHINA

Distribuido por Jasco Products Company LLC, 10 E Memorial Rd., Oklahoma City, Oklahoma 73114.

Este producto de Jasco tiene una garantía de por vida limitada. Visite [www.byjasco.com](http://www.byjasco.com) para conocer los detalles de la garantía.

¿Preguntas? Comuníquese al 1-800-654-8483 entre las 7AM y las 8PM CST (hora central estándar).