

## Hands-Free Screen Door Installation Instructions

**IMPORTANT:** Before hanging, ensure that the surface is clean of dirt and debris.

**Determine the proper direction to install the screen:**

- If your door opens IN, install on the OUTSIDE of the door frame.
- If your door opens OUT, install on the INSIDE of the door frame.

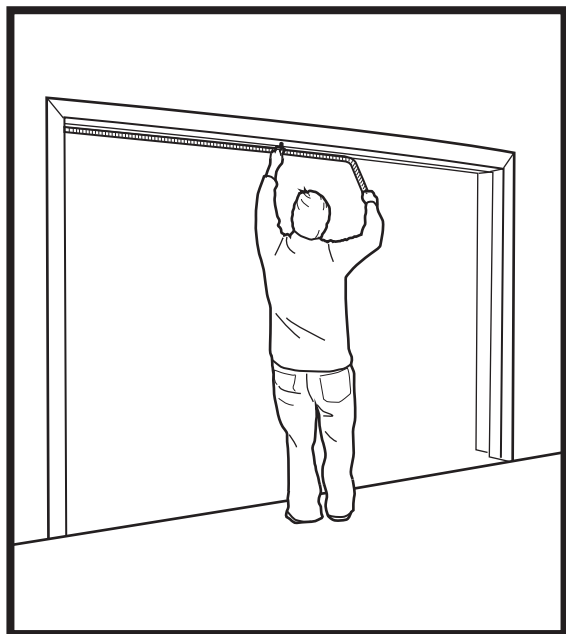

**1.** Measure the opening of the doorway.

**Note:** For garage doors with a width less than 9 feet, the Magic Mesh® comes equipped with additional lining, which allows the Magic Mesh® to be cut to size.

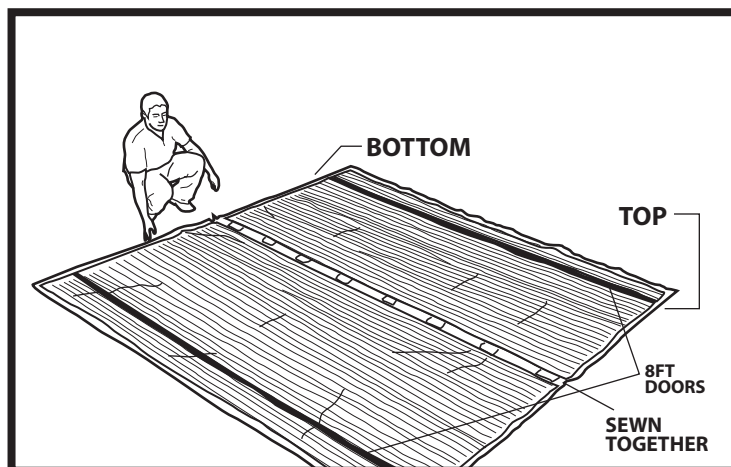

**2.** Lay your Magic Mesh® Screen flat on the floor with the magnets aligned in the center. If required, cut the Magic Mesh® to size. Cut on the outer edge of the vertical seam as shown above.

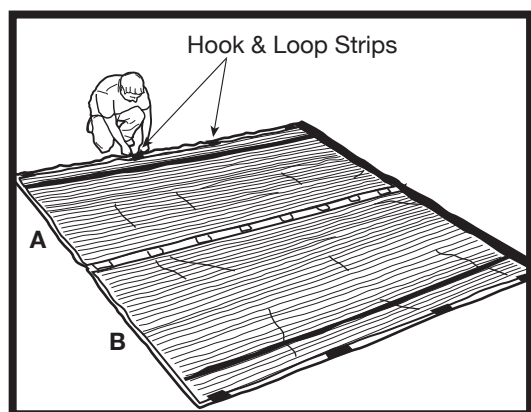

**3.** Peel the adhesive backing off of the hook and loop strips and apply to the Magic Mesh® Screen according to FIGURE 1.

**Note:** Hook and loop #5 has split back strips.

**FIGURE 1**

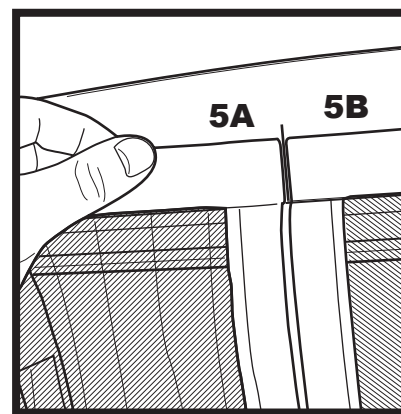
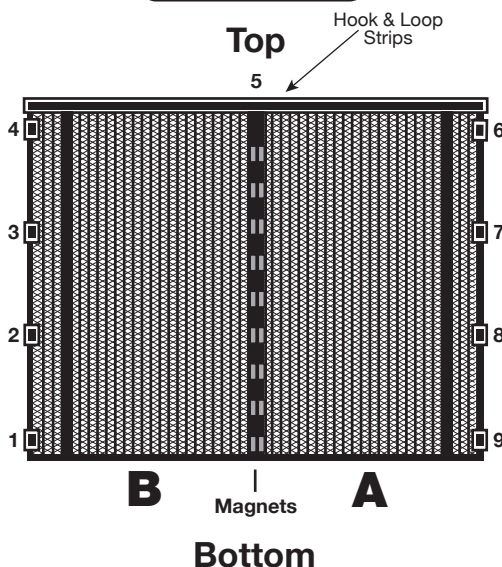

**4.** Peel off 1/2 adhesive backing of hook and loop strips then apply them to the door frame one at a time with pressure. Hold for 30 seconds.

**Note:** Be sure to hang the screen high enough so that it does not drag on the ground.

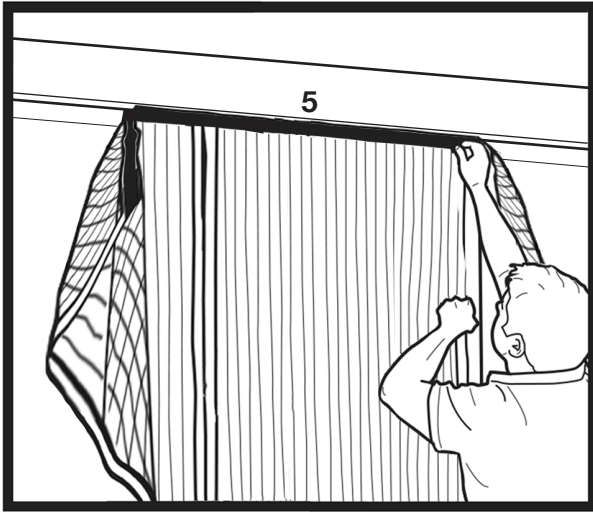

**5.** Place the remaining length of hook and loop strip #5.

**Note:** Be sure to hang the screen high enough so that it does not drag on the ground.



**6.** Attach the rest of the hook and loop strips row by row: #1-4 and #6-9.

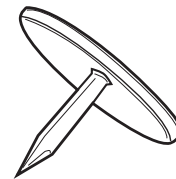
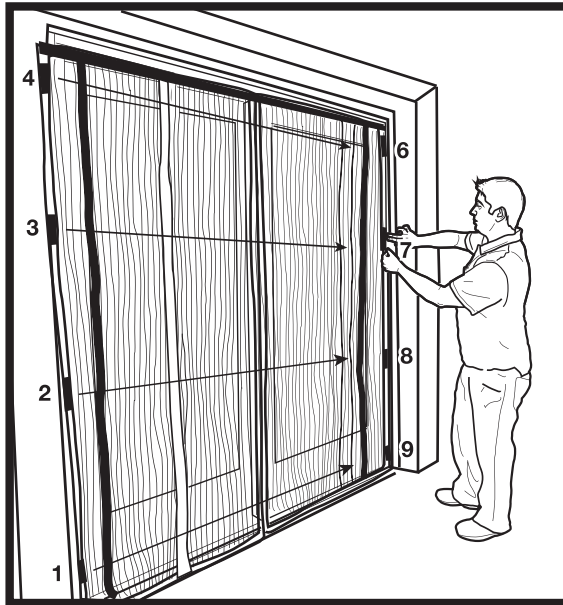

**\*NOTE:** It is recommended to further secure the screen using the included wood tacks. Insert tack through each hook & loop strip, and be sure to only use them on wood frames or molding. Do not use the wood tacks on any surface other than wood.

**PLEASE NOTE: THE WOOD TACKS LEAVE PUNCTURE HOLES.**

#### Helpful Tips & Troubleshooting:

Do not attempt to attach the wood tacks to glass, vinyl, or aluminum siding or to the door/door frame. They should only be used for wooden frames or walls.

#### Cleaning and Storage:

- Do not use any harsh abrasive cleaners on this product.
- Wipe off the mesh with a damp, lukewarm cloth. For stubborn dirt, you can spot clean with a small amount of soap and a cloth. Allow the mesh to air-dry.
- Do not put in a dryer. Do not dry clean.

#### Important Safety Instructions

- Keep children away from the packaging material and the storage bag. There is danger of suffocation.
- Maintain an adequate distance from heat sources such as stove tops, ovens, or BBQ grills.
- Because of possible electromagnetic interference, people with implanted medical devices (e.g. pace makers) should consult their doctor before using.
- Take extra caution when using wood tacks. Keep away from children.
- Product may not function properly if not installed correctly.

**FOR MORE INFO & HELPFUL TIPS, VISIT:**  
**[www.MagicMeshTips.com](http://www.MagicMeshTips.com)**

©2018 APG  
All Rights Reserved.  
Magic Mesh is a registered trademark of APG.

Distributed By:  
Allstar Products Group  
Hawthorne, NY 10532