



51351

12' W x 10' H

Run-In-Shed Assembly Manual



Shown in 12' x 20' x 8'

Assembly Instructions

Before you start: 2+ individuals recommended for assembly, approximate time 3 hours.
Recommended tools: Power Drill, Safety Glasses, Rope, Tape Measure, Ratchet with Socket Set, Adjustable Wrench, Step Ladder, Rubber Mallet, Utility Knife, 5/8 Concrete Drill Bit, Sledge Hammer.

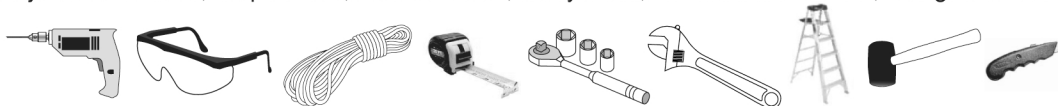

ShelterLogic, LLC
150 Callender Road
Watertown, CT 06795

www.shelterlogic.com

1-800-524-9970

Canada:

1-866-559-6175

ATTENTION:

This Shelter product is designed with the highest quality material available. It is designed to fit the **ShelterLogic™** custom fabric cover included. **ShelterLogic™** Shelters offer storage and protection from damage caused by sun, light rain, tree sap, animal - bird excrement and light snow. Please anchor this **ShelterLogic™** structure properly. See manual for more anchoring details. Proper anchoring, keeping cover tight and free of snow and debris is the responsibility of the consumer. Please read and understand the installation detail, warnings and cautions prior to final installation. If you have any questions call the customer service number listed on the cover of the manual. Please refer to the warranty included with your purchase.

DANGER:

Prior to installation, consult with all local municipal codes regarding installation of temporary shelters. Choose the location of your shelter carefully. **DANGER: Keep away from electrical wires.** Check for overhead utility lines, tree branches or other structures. Check for underground pipes or wires before you dig. DO NOT install near roof lines or other structures that could shed snow, ice or excessive run off onto your shelter. DO NOT hang objects from the roof or support cables.

WARNING:



Risk of fire. DO NOT smoke or use open flame devices (including grills, fire pits, deep fryers, smokers or lanterns) in or around the shelter. DO NOT store flammable liquids (gasoline, kerosene, propane, etc.) in or around your shelter. Do not expose top or sides of the shelter to open fire or other flame source.

CAUTION:



Use **CAUTION** when erecting the frame. Use safety goggles during installation. Secure and bolt together overhead poles during assembly. Beware of pole ends.



CAUTION: PROPER ANCHORING AND INSTALLATION OF FRAME:



NOTE: PROPER ANCHORING OF THE FRAME IS THE RESPONSIBILITY OF THE CONSUMER.

ShelterLogic® is not responsible for damage to the unit or the contents. Any shelter that is not anchored securely has the potential to fly away causing damage, and is not covered under the warranty. Periodically check the anchors to ensure stability of shelter. The preferred anchoring system includes the use of bolted cement wedge lags for the frame. **ShelterLogic®** cannot be responsible for any shelter that blows away. **NOTE:** *Your shelter's cover can be quickly removed and stored prior to severe weather conditions.* If strong winds or severe weather is forecast in your area, we recommend removal of cover. Check with your insurance carrier for any damage as you would for any other outdoor structure or personal property claims.

REPLACEMENT PARTS, ASSEMBLY, SPECIAL ORDERS:

Genuine **ShelterLogic®** replacement parts and accessories are available from the factory, including anchoring kits for nearly any application, replacement covers, wall and enclosure kits, vent and light kits, frame tubes, pipes, zippered doors and other accessories. All items are shipped factory direct to your door.

QUESTIONS - CLAIMS - SPECIAL ORDERS? CALL OUR CUSTOMER SERVICE HOTLINE:

U.S. CUSTOMER SERVICE: 1-800-524-9970 INTERNATIONAL CUSTOMER SERVICE: 001-860-945-6442 CANADA CUSTOMER SERVICE: 1-800-559-6175

HOURS OF OPERATION: MON-FRI 8:30AM-8:00PM EST, SAT-SUN 8:30AM-5:00PM EST.

CARE AND CLEANING:

A tight cover will ensure longer life and performance. Always maintain a tight cover. Loose fabric can accelerate deterioration of cover. Immediately remove any accumulated snow or ice from the roof structure with a broom, mop or other soft-sided instrument. Use extreme caution when removing snow from cover- always remove from outside the structure. DO NOT use bleach or harsh abrasive products to clean the fabric cover. Cover can be easily cleaned with mild soap and water. DO NOT use hard-edged tools or instruments like rakes or shovels to remove snow. This could result in punctures to the cover.

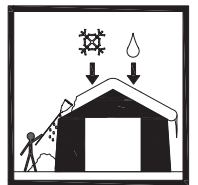

WARRANTY:

This shelter carries a full limited warranty against defects in workmanship. **ShelterLogic, LLC** warrants to the Original Purchaser that if properly used and installed, the product and all associated parts, are free from manufacturer's defects for a period of:

1 YEAR FOR COVER FABRIC, END PANELS AND FRAMEWORK

Warranty period is determined by date of shipment from **ShelterLogic, LLC** for factory direct purchases or date of purchase from an authorized reseller, (please save a copy of your purchase receipt). If this product or any associated parts are found to be defective or missing at the time of receipt, **ShelterLogic®** will repair or replace, at its option, the defective parts at no charge to the original purchaser. Replacement parts or repaired parts shall be covered for the remainder of the Original Limited Warranty Period. All shipping costs will be the responsibility of the customer. Parts and replacements will be sent C.O.D. You must save the original packaging materials for shipment back. If you purchased from a local dealer, all claims must have a copy of original receipt. Check with your insurance carrier for any damage as you would for any other outdoor structure or personal property claim. After purchase, please fill out and return warranty card for product registration. Please see warranty card for more details.

Covered by one or more of the following U.S. Patents and patents pending:

6,871,614; 6,994,099; 7,296,584; D 430,306; D 415,571; D 414,564; D 409,310; D 415,572

Run-In-Shed Assembly Manual

Please read instructions completely before assembly

Frame Assembly Overview

12'W x 10'H

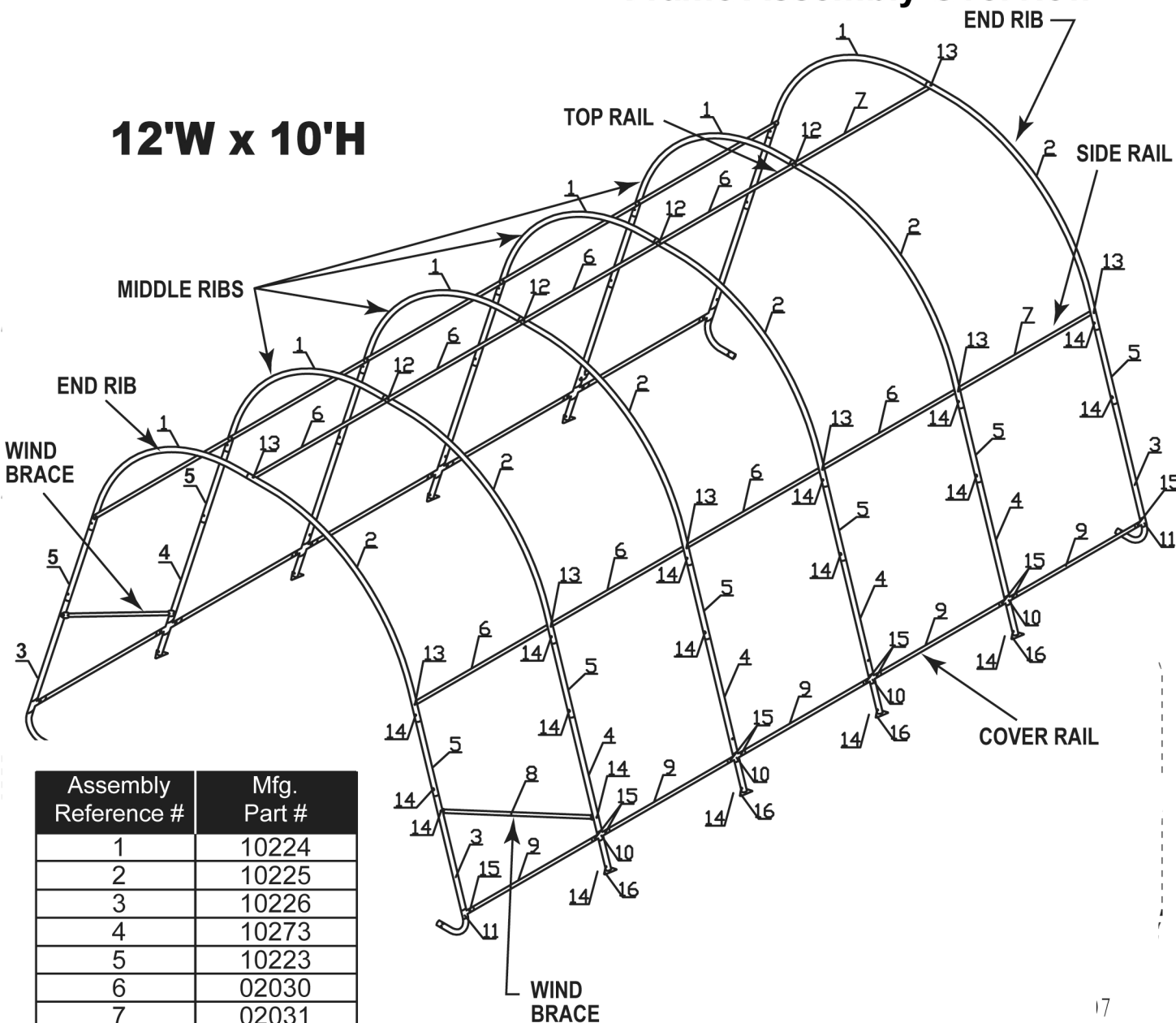

Assembly Reference #	Mfg. Part #
1	10224
2	10225
3	10226
4	10273
5	10223
6	02030
7	02031
8	10205
9	10110
10	10111
11	10112
12	00669
13	10210
14	10114
15	10115
16	10270
17	800260

Basic Frame Assembly

STEP 1

Fit together an end rib using the following parts (1) #10224 Bent Tube Swedged, (1) #10225 Bent Tube Plain and (2) #10226 Bent Corner Leg. Using (2) #10114 1/4" x 2" L Carriage Bolts and (2) #1010 1/4" Nuts securely fasten the joints of the Corner legs to the bends. Lay this rib on the ground at the rear of your shelters designated location.

Fig.1

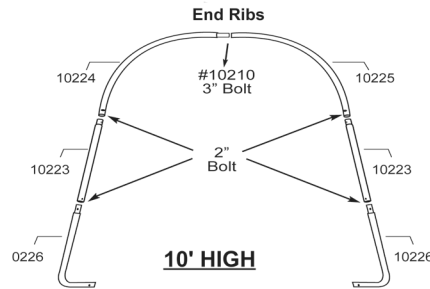

STEP 2

Assemble a middle rib using the following parts (1) #10224 Bent Tube Swedged, (1) #10225 Bent Tube Plain and (2) #10273 Middle Upright Tube. Using (2) #10114 1/4" x 2" L Carriage Bolts (1) #669 1/4" x 3" Round Head Bolt and (3) #1010 1/4" Nuts securely fasten the joints of the Corner legs to the bends. Lay this rib on the ground near the first end rib.

Fig.2

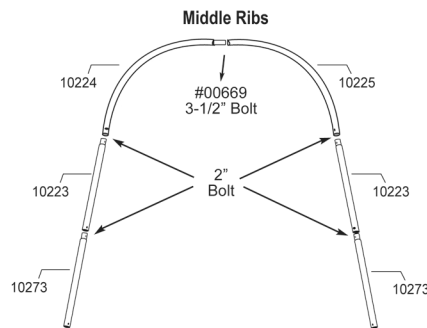

STEP 3

3A Stand the rear end rib vertically and lean against a permanent structure. Place a ShelterLock against the rib over the hole for the cross rail just above the joint of the side bend and the extension. Insert a 1/4" x 3"L Carriage Bolt through the rib and ShelterLock with the head of the Bolt on the outside of the rib. Place the plain end of a #02030 Cross Rail onto the bolt and rest it into the ShelterLock and secure it with a 1/4" Nut. Next, attach a #10205 Wind Brace using a 1/4" x 2"L Carriage Bolt and Nut to each corner upright tube. Place (2) #10112 3-Way Connectors around the bent corner leg. Insert the end of a #10110 Cover Rail Tube into the 3-Way Connector and fasten these with a 1/4"x1 5/8" Bolt and Nut. Slide the connector until it is 5" up from the ground and loosely tighten. Repeat at the other bent corner.

3B Attach a #10111 4-Way Connector to the end of the 2 cover rail tubes and loosely faster with a 1/4" x 1 5/8" Bolt and Nut. Insert another cover rail tube into each 4-Way Connector and loosely fasten with a 1/4" x 1 5/8" Bolt and Nut. Place the plain end of another #02030 Cross Rail over the swedged end of those already attached and lean them down. With help, stand the middle rib vertically and insert the bottom of each upright tube into the 4-Way Connectors. Place an ShelterLock against the rib over the hole for the cross rail just above the joint of the side bend and the extension. Insert a 1/4" x 3"L Bolt through the rib and ShelterLock with the head of the bolt on the outside of the rib. Raise the cross rails up and slide them over the bolt and rest them into the anti-rack device and secure with a 1/4" Nut. Attach the lower end of the Wind Braces to the middle rib with a 1/4" x 2"L carriage Bolt and Nut. Be sure that the head of the bolt is on the outside of the rib. Slide the 4-Way Connector up until they are 5" above the ground and tighten loosely.

Fig.3A

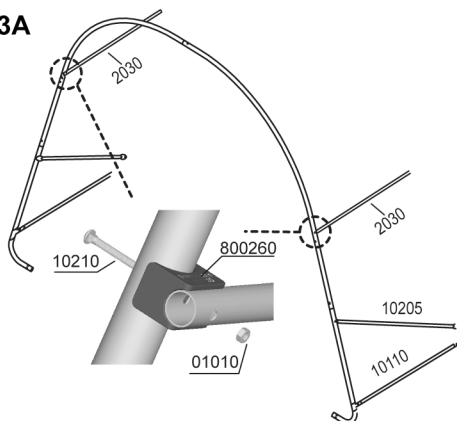
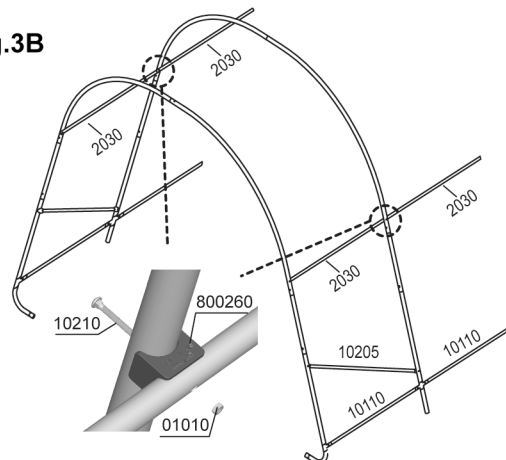

Fig.3B



STEP 4 INSTALLING TOP RAIL

Install top cross rail assembly starting with (1) #2031 Plain Cross Rail Tube UNDER the last bow and on TOP of the all the middle bows. End with the plain end of the Cross Rail Tapered End UNDER the front bow .

NOTE: Use the Special Round Head 1/4" x 3" Bolts for securing the top rail to the Middle Ribs only!

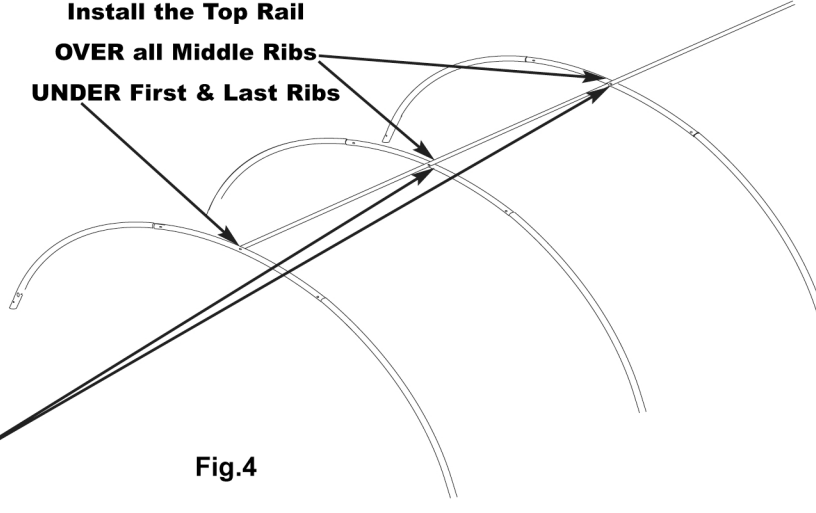

Fig.4

STEP 5 ATTACHING & SECURING BASE FEET

Depending on the model you have purchased, your base feet will either fit onto the outside of the leg poles, or slide inside the leg poles. After installing Base Feet Plates onto bottom of Middle leg Poles, be sure to line up the pre-drilled hole in the leg with the pre-drilled hole in the base foot. Insert 1/4" x 2" bolts all the way through leg and foot, to other side, secure with nuts.

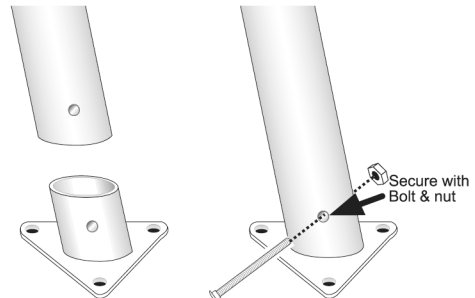

Fig.5

STEP 6 (Anchor Shelter) W/Auger Anchors for Dirt Surfaces

You will secure the anchors to the corner leg bends using the cable and clamp. Be sure to put cable through the hole in the corner leg bend, and through eye of anchor, secure with clamp. Repeat process attaching the remaining anchors to the middle ribs with the cable around the upright above the foot plate.

Note: Anchors must be placed inside of shelter.

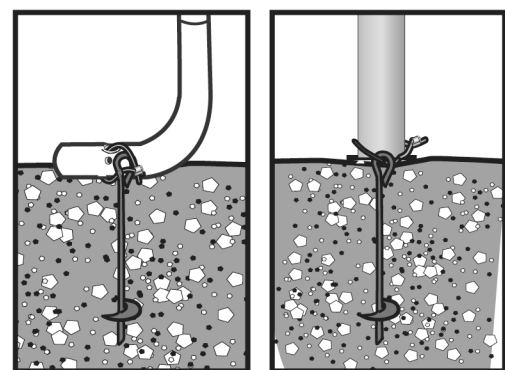

Fig.6

Fig.7

STEP 7 SECURING YOUR COVER

Pull the cover over the frame. The welded in webbing should be at the front and back of the building. Also note that the pocket with cutouts, running along the sides of the cover should be on the inside and near the ground. Insert the "S" hook from the ratchets into the hole in the leg of the frame. Next, insert the webbing into the spindle of the ratchet and tighten ratchet until the webbing overlaps itself, do not tighten all the way yet. Check to be sure the cover still has an even overhang on the front and rear, adjust as necessary. Once the cover is even, finish tightening the ratchets, alternating from corner to corner to ensure the cover stays even.

After the cover is tight end to end, remove the cross rails and connectors on one side of the frame and place them into the pockets between the cutouts. Attach the crossrails using the 3-way and 4-way cover rail clamps around the uprights and loosey fasten with the 1/4" x 1 5/8" bolts and 1/4" nuts. Check that the rails are evenly spaced above the ground on both sides. Push down on the connectors one at a time to tension the cover and tighten the bolts to hold tightly.

Warning:
Do not leave a partially or fully covered unit without being fully anchored. Serious injury to persons or property could result.

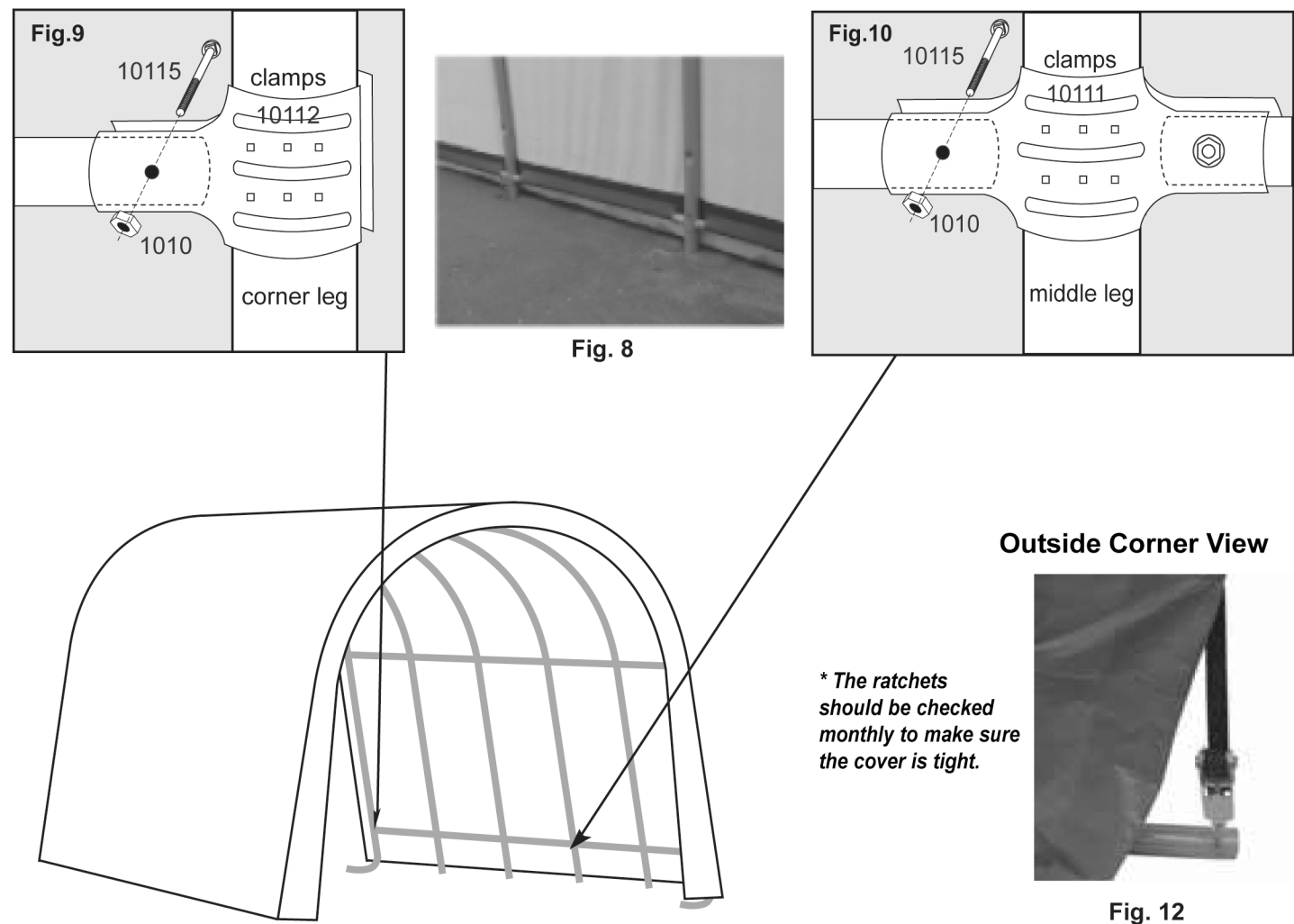
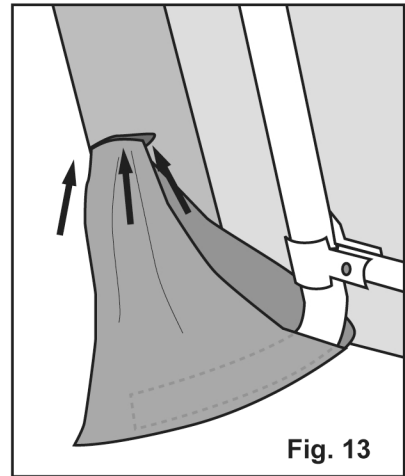

Fig. 11

Fig. 12

STEP 8

Find the open side of the protective boot and open it.
Insert the foot of the corner leg into the protective boot.
When the foot is all the way in the boot insert the top edge of the boot into the hem of the cover (Fig 13).
When complete secure the Velcro on the open side of the boot to close the boot.



WARNINGS, CAUTIONS, CARE & CLEANING

Warning!

Prior to installation, check all local and municipal laws regarding these shelters.
Choose your shelter's location carefully.
Check for overhead utility lines, branches, etc.
Do NOT install near roofs or other structures that may shed snow or ice onto shelter.
Do NOT hang objects from the roof structure or cables.
Do NOT smoke or use open flame devices near the shelter.
Do NOT store flammable liquids (eg. Gasoline, Kerosene, etc.) in your shelter.
Do NOT expose top or sides to open fire or flame.
Do NOT use barbeque grills, fire pits, deep fryers or smokers inside this shelter.
Be sure to remove any accumulated snow from roof. Care should be used when removing snow to prevent punctures being made in the cover with rakes, shovels, etc.

Caution!

This shelter is intended to protect against the effects of sun, rain, tree sap, bird droppings, light snow, etc.
It is not designed to hold the loads that can accompany heavy wind, deep snow or ice storms.
Proper anchoring is the responsibility of the user.
Please read and understand all warnings prior to permanent installation.
Any canopy that is not anchored securely or properly will fly away. We will not be responsible for any canopy^t that blows away.
Proper anchoring is your responsibility.
Your shed's cover can be quickly removed if needed when you know that a strong or severe weather front is approaching.

Care & Cleaning

During the first few months of use, it will be necessary to tighten the cover a few times.
Be sure that the cover is kept tight, loose fabric will deteriorate quickly.
Do NOT apply any "Protect & Shine" type products to the cover and ends or use any harsh or abrasive cleaners. The cover may be cleaned with mild soap and water.