

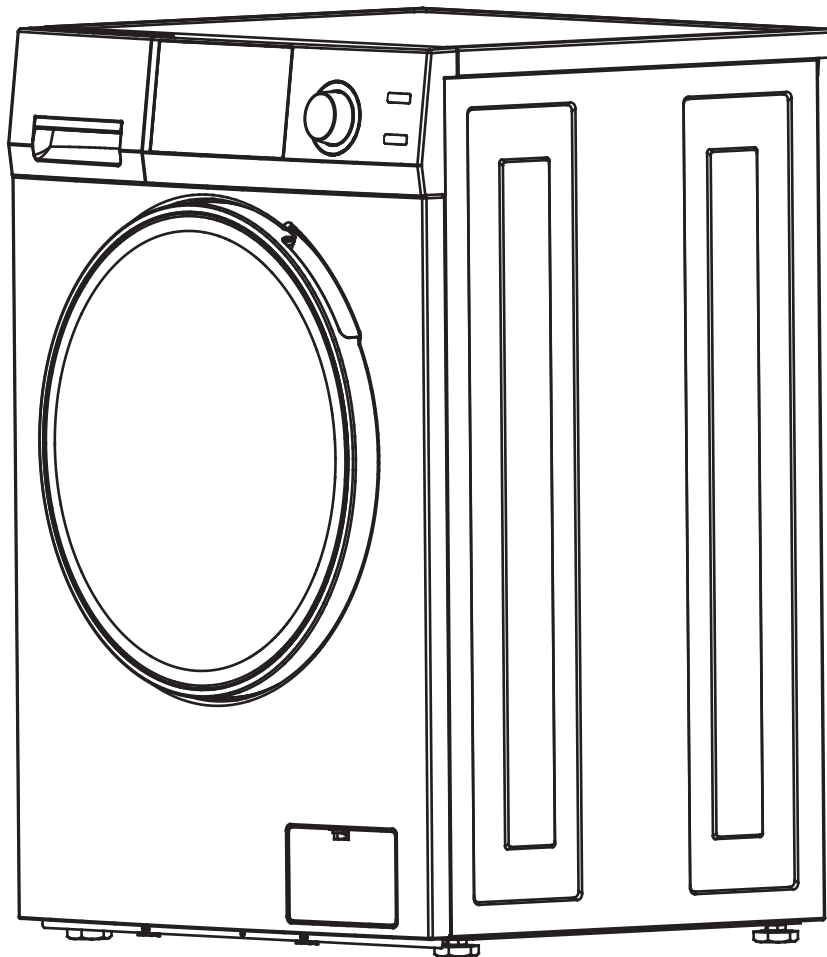

All-in-One Combo Washer-Dryer

BUILT-IN

MODEL: EZ 4600 C



OWNER'S MANUAL

Please read the instructions carefully and keep for future reference. Information may be updated from time to time so please refer to the manual online for the latest version of the manual.

TABLE OF CONTENTS

**Please read the Owner's Manual carefully before using your
ALL-IN-ONE COMBO WASHER ⊕ DRYER**

Introduction	1
Warranty	2
Technical Data	5
Important Safety Instructions.....	6
Helpful Hints	7
Pre-installation	7
Diagram of the Combo	8
Installation Instructions.....	9
Unpacking and Leveling	10
Electrical	11
Plumbing	12
Program Selection Chart.....	13
Built-In, Recessed, Closet, Alcove Installation	14
Operating Instructions	15
Control Panel	18
Display Panel	19
Maintenance	21
Stain Removal Chart	23
Troubleshooting	25
Diagnostic Menu	27

INTRODUCTION

Congratulations on your new Super Combo! In addition to its contemporary design, this is a highly sophisticated engineered product that will give you many years of satisfaction.

Here are some of the best reasons for buying your Super Combo

- 1. Space Saving**
By combining the two functions of washer and dryer in one unit, the space taken for the second unit, i.e. separate dryer, is saved.
- 2. Built-in Installation.**
Can be completely built-in in place of a standard dishwasher, with 0 clearance at the back and sides.
- 3. Placement Options**
The Washer⊕Dryer's sleek and compact size design makes it a perfect appliance for any kitchen or laundry room.
- 4. Water & Energy Saving**
New automatic water level feature determines the amount of water required based on quantity of clothes which helps save water. Also this appliance is engineered to provide valuable energy savings e.g., LED display goes off after 5 mins to save energy.
- 5. Better Clothing Appearance**
This Washer⊕Dryer has no agitator to damage your clothes so they look better and last longer.
- 6. Specialized Wash Programs**
There are special wash programs for Sanitize, Allergen, Winterize etc.
- 7. Refresh Function**
The refresh function keeps your clothes warm and fluffy always.
- 8. High spin speed**
With a high spin speed of 1400 rpm, more water is extracted, allowing improved dry times.
- 9. Easy Operation**
This appliance is simple to use as a washer or as a dryer – or it can go seamlessly from wash to the dry functions.
- 10. Sensor Dry**
This function automatically selects the ideal dry level to make sure your clothes are dried with utmost perfection based on wash cycle used.
- 11. Lint Free Maintenance**
Since the machine has a self-cleaning pump, this appliance needs no cleaning of lint after drying. Instead, there is a convenient coin trap.
- 12. Portability**
The appliance can be permanently installed or made portable with the installation of the portability kit (Accessory Part #1070 sold separately) where needed.

WARRANTY INFORMATION

Your appliance is protected by this warranty under normal, personal, family or household use for 1 Year Parts & Labor and limited commercial use (90 days) in USA and Canada.

WARRANTY

Equator Appliances undertakes to the consumer / owner to repair or, at our option, to replace any part of this product which proves to be defective in workmanship or material under normal personal, family or household use, in USA and Canada, for a period of one year parts & labor from the date of original purchase. For commercial use, the product is warranted for a period of 90 days.

During this period, we will provide all labor and parts necessary to correct such defect, free of charge, if the appliance has been installed and operated in accordance with the written instructions provided with the appliance. Ready access to the appliance, for service, is the responsibility of the consumer / owner. If a unit is installed in a closet or cabinet, it should be removed by the consumer / owner, for access by service technicians. If this is not done, there will be an extra charge.

EXCLUSIONS

In no event shall Equator Appliances be liable for incidental or consequential damages or for damages resulting from external causes such as abuse, operation misuse, neglect, alterations, normal wear and tear, incorrect voltage or acts of God. This warranty does not cover service calls which do not involve defective workmanship, damage due to other products while combined use with this product or materials covered by this warranty. Accordingly, diagnosis and repair costs for a service call which does not involve defective workmanship or materials will be the responsibility of the consumer / owner.

Most work is covered. The defining factor is, has the machine malfunctioned (Equator Appliances is responsible) or has the customer omitted or done something to cause malfunction (customer is responsible). Some states do not allow the exclusion or limitation of incidental or consequential damages, so the above limitation or exclusion may not apply to you.

You can register your warranty by either of the following methods:

1. Scan the QR Code
2. Online at: ApplianceDesk.com/Warranty

QR Code



1. Open Smart Phone
2. Open Camera
3. Scan QR Code
4. Click the Link

WARRANTY SERVICE

This warranty is given by:

Equator Appliances
10222 Georgibelle Drive, Suite 200,
Houston, TX 77043-5249

Customer Service: **Appliance Desk**
Phone / Text: 1-800-776-3538
Email: Service@ApplianceDesk.com
Web: www.ApplianceDesk.com
Business hours: 9:00 am to 5:00 pm weekdays

THE FOLLOWING WORK ARE NOT COVERED UNDER WARRANTY:

A) Installation

1. Non-removal of shipping rods, causing vibration / internal damage.
2. Non-adjustment of feet to level machine, causing vibration / internal damage.
3. Non-removal of exhaust vent plate at the back while using Venting Dry mode, causing excess heat and resulting in damage to internal components.
4. Not conforming to minimum space requirements for built-in installation, causing excess heat and resulting in damage to internal components.
5. Installation in a corrosive environment.
6. Incorrect water pressure i.e., below 7.25 psi or above 145 psi.
7. Incorrect water inlet hose installation (use only factory supplied hoses with metric threads on the L-shaped side to fit water valve).

B) Maintenance

1. Non-cleaning of coin trap for debris, causing the unit to not drain out water and resulting in drain pump malfunction.
2. Improper maintenance (such as, but not limited to, scale build-up, freeze damage, or vent blockage).

C) Damage

Breakage of cosmetic parts e.g., door handle, knob.

D) Other

1. Moving of product without installation of shipping rods.
2. Accident, abuse, or misuse.
3. Using solvents to clean the machine or wash clothes, causing damage.
4. Misapplication of this product e.g., use in a non-household / commercial environment.
5. Any other cause not due to defects in materials or workmanship.
6. Problems or damage due to fires, flooding, electrical surges, freezing or any acts of God.
7. Any damage caused by poor water quality.
8. Operating the appliance with anything other than potable water at all times.
9. Force majeure.

California Proposition 65

WARNING: This product contains chemical known to the State of California to cause cancer and birth defects or other reproductive harm.

Warranty Limitations

1. If a unit is located more than 25 miles away, there will be a trip charge.
2. If a unit is in a remote area more than 75 miles away, the machine should be taken to the technician's workshop.
3. If the unit is installed in a 5th wheel RV, in a location behind the axle, it will not be covered under warranty.
4. All repairs or replacements are warranted only for the remainder of the original warranty period.
5. If a return or replacement is required, allow 3-4 weeks to process.
6. Replacement units will be delivered with curbside delivery only.
7. We may require the return of products or parts to our warranty department for which the shipping charges are to be pre-paid by the consumer / owner.
8. Charges may be incurred if warranty coverage is not applicable.
9. Service would be provided from Monday to Friday between normal business hours.

GENERAL

Since it is the responsibility of the consumer / owner to establish the warranty period by verifying the original purchase date, Equator Appliances recommends that a receipt, delivery slip or some other appropriate payment record be kept for that purpose. This warranty gives you specific legal rights, and you may also have other rights which vary from state to state.

All rights reserved. Manual subject to change without notice.

TECHNICAL DATA

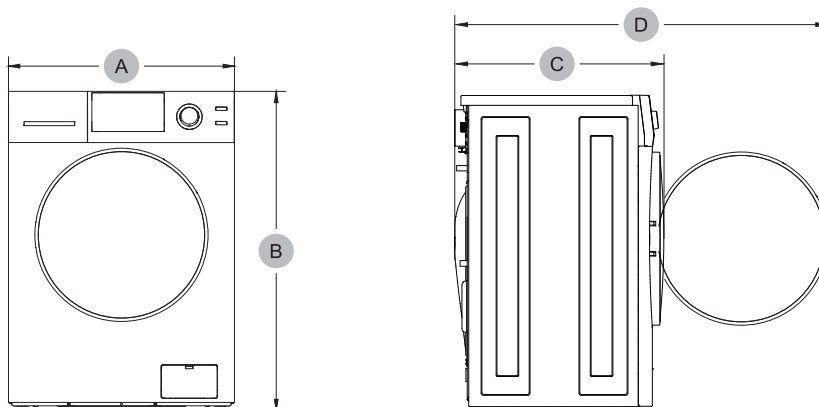

Type		Front loading washer-dryer combo
Model		EZ 4600 C
Dimensions (inches / mm)	A. Width	23.6 / 600
	B. Height-overall	33.5 / 850
	C. Depth	21.85 / 555
	D. Depth with door open	38.54 / 979
Rated voltage		110-120V / 60Hz 12A
Water pressure (psi / Mpa)		7.25 - 145 / 0.05- 1.00
Wash capacity (lb / kg)		15.0 / 7.0
Dry capacity (lb / kg)		Max. 7.7 / 3.5
Net weight (lb / kg)		161 / 73
Spin revolution		Max. 1,400 rpm
Power consumption (W)	Washing	120 W
	Spin	500 W
	Wash heater	1,000 W
	Dry heater	1,300 W



Intertek
4007606

US N° 4007606 CANADA

The ETL Listed Mark is the legal equivalent to the UL and CSA Listed Marks

Note: All rights reserved.
Designs, Specifications and Manual subject to change without notice.

IMPORTANT SAFETY INSTRUCTIONS



Your Combo Washer ⊕ Dryer has been built in compliance with safety regulation to protect you and your family.

WARNING – To reduce the risk of fire, electric shock, or injury to persons when using your appliance, follow basic precautions, including the following:

1. Read all instructions before using the appliance.
2. Do not wash or dry articles that have been previously cleaned in, washed in, or spotted with gasoline, dry-cleaning solvents, other flammable or explosive substances, as they emit vapors that could ignite or explode.
3. Do not allow children to play on or in the appliance. Close supervision of children is necessary when the appliance is used near children.
4. Before the appliance is removed from service or discarded, remove the door.
5. Do not reach into the appliance if the tub or drum is moving.
6. Do not install or store this appliance where it will be exposed to the weather.
7. Do not tamper with controls.
8. Do not repair or replace any part of the appliance or attempt any servicing unless specifically recommended in the user-maintenance instructions or in published user-repair instructions that you understand and have skills to carry out.
9. Do not add gasoline, dry-cleaning solvents, or other flammable or explosive substances to the wash water. These substances give off vapors that could ignite or explode.
10. Under certain conditions, hydrogen gas may be produced in a hot water system that has not been used for 2 weeks or more. **HYDROGEN GAS IS EXPLOSIVE.** If the hot water system has not been used for such a period, before using a washing machine or combination washer-dryer, turn on all hot water faucets and let the water flow from each for several minutes. This will release any accumulated Hydrogen.
11. Do not use fabric softeners or products to reduce static unless recommended by the manufacturers of the fabric softener product.
12. Do not use heat to dry articles containing foam rubber or similarly textured rubber-like materials.
13. Check the Coin Trap every few months to remove any coins, buttons or similar size objects.
14. For washer-dryer keep surrounding areas free from accumulation of lint, dust, and dirt.
15. Do not place items exposed to cooking oils in your dryer. Item contaminated with cooking oils may contribute to a chemical reaction that could cause a load to catch fire.
16. To reduce the risk of fire due to contaminated loads, the final part of a tumble dryer cycle occurs without heat (cool down period). Avoid stopping a tumble dryer before the end of the drying cycle unless all items are quickly removed and spread out so that the heat is dissipated.

SAVE THESE INSTRUCTIONS

SAFETY

 CAUTION 	The model number and the serial number are on the label affixed to the back of the unit. These numbers are also available on the front of the cabinet behind the door.
RISK OF ELECTRIC SHOCK DO NOT OPEN	You should note the model and serial numbers of this unit in the space provided. Retain this booklet as a permanent record of your purchase to aid in identification in the event of theft.
CAUTION: TO REDUCE THE RISK OF ELECTRIC SHOCK, DO NOT REMOVE COVER (OR BACK). NO USER SERVICABLE PARTS INSIDE. REFER SERVICING TO QUALIFIED SERVICE PROFESSIONALS.	MODEL No: _____ SERIAL No: _____

HELPFUL HINTS

1. Your Washer⊕Dryer spins at a high 1400 rpm spin speed, which will extract more water especially from absorbent fabrics and reduce the degree of dampness as the machine goes into the drying mode. This will cut down on your drying time.
2. **FABRIC SOFTENER:** After the wash cycle, the clothes can get stuck to the sides of the drum. USING LIQUID FABRIC SOFTENER WILL CAUSE THE CLOTHES TO UNSTICK IMMEDIATELY AND TUMBLE IN THE DRY CYCLE. THIS HELPS TO DRY CLOTHES FASTER AND CAUSES LESS WRINKLES.
3. **OVERLOADING:** The drum has a capacity of 19 lbs. The drum should be loaded only to 2/3 of its capacity otherwise it reduces air flow and causes increase in dry time.
4. **CONDENSING DRYING:** Since there is no external exhaust system, the moisture content remains in the machine. Frequently when it seems the clothes are damp, it is actually the remaining moisture (like dew). Take clothes out and they will dry within a few minutes.
5. **USE HIGH EFFICIENCY (HE) DETERGENT:** By using High Efficiency (HE) detergent, you are preventing suds from entering the condensing chamber. When suds enter the condensing chamber, the particles can clog up the chamber and the fan blower. Over time, this reduces drying efficiency and may require the fan blower (impeller) to be cleaned. For this and all other front-loading/horizontal-axis units, Front Loading detergents go a long way to improve the efficiency of the units.
6. **SORTING:** When sorting laundry always take into consideration the quantity and type of fabric contained in the load. Highly absorbent fabrics such as those used in towels or jeans will absorb more water and become very heavy when saturated. If you notice that your clothes are taking longer than usual to dry you may be overloading the machine, or washing too many highly absorbent articles in a single load.

PRE-INSTALLATION

1. The unit must be installed on a strong leveled surface in a protected, dry and well-ventilated area, with a power and water supply of sufficient capacity and a sufficient outlet in close proximity.
2. Installation on Carpet or Wood increases vibrations.
 - Carpets – place on light carpet only.
 - Wood – brace floor with screws and place additional sheets of plywood before installation.
3. This unit's installation and grounding should be done in accordance with local codes by a qualified installer. "Installation Instructions" are included in this manual for the Installer's reference.
4. The unit should be plugged into a properly grounded three (3) prong electrical outlet of 110V/60Hz with minimum 15 Amps, It should not be controlled by a wall switch or pull cord which might be turned off accidentally.

DIAGRAM OF THE COMBO WASHER + DRYER

Parts

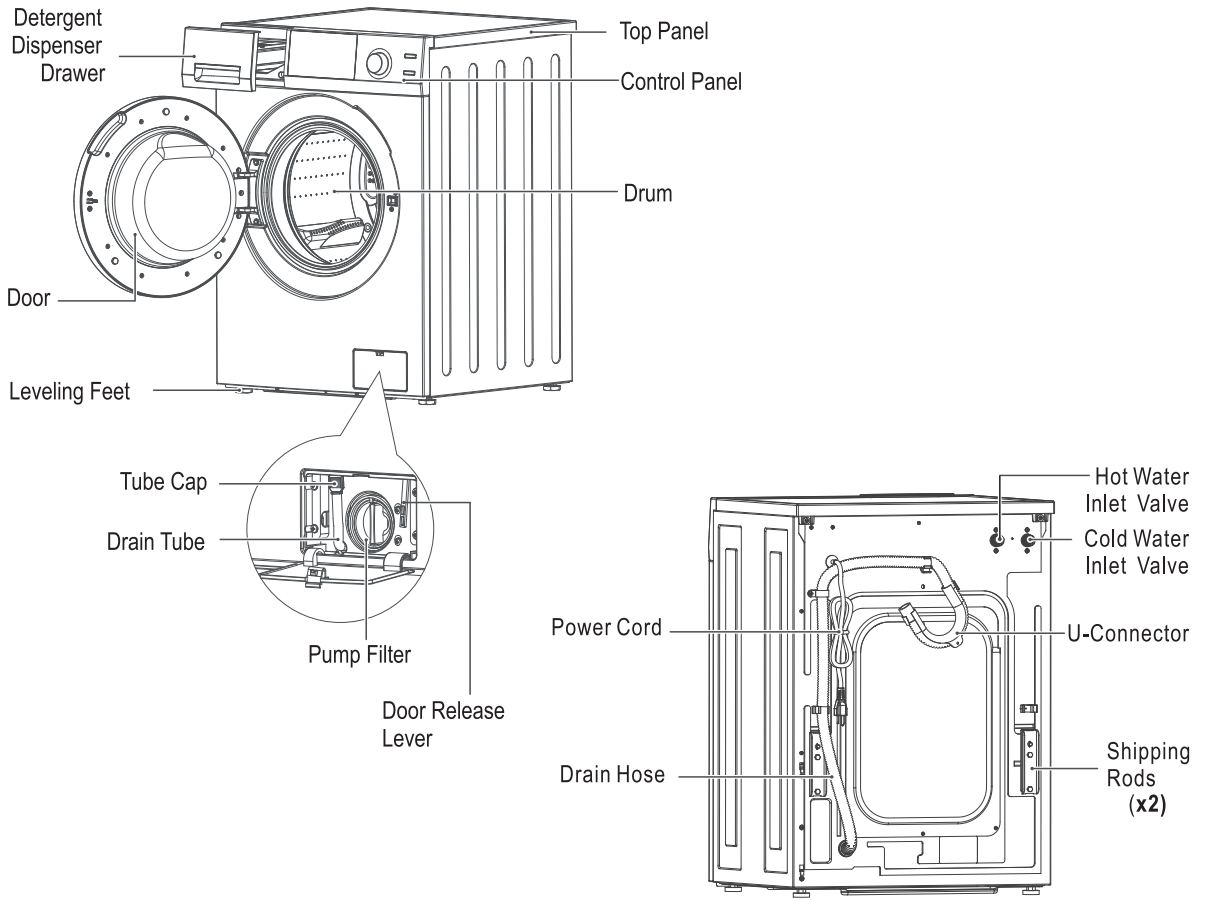

Factory supplied accessories

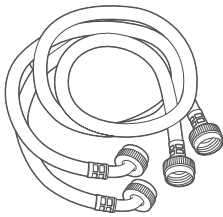

Cold/Hot water hoses

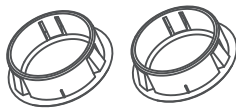

Caps for covering shipping rod holes

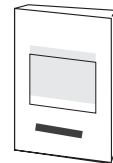

Owner's Manual

NOTE

- Contact Customer Service if any accessories are missing.
- For your safety and for extended product life, use only authorized components. The manufacturer is not responsible for product malfunction or accidents caused by the use of separately purchased unauthorized components or parts.
- The images in this guide may be different from the actual components and accessories, and are subject to change by the manufacturer without prior notice for product improvement purposes.

INSTALLATION INSTRUCTIONS

Handling

Please handle the machine carefully and use appropriate means while lifting and moving the machine so that it does not get damaged. Do not drag the machine on your floor. Do not hold on to protruding parts when lifting.

Disposing of the packing

The shipping package has protected your new appliance on its way to your home. All packaging materials are non-polluting and recyclable. Please dispose of packing material according to local environmental regulations.

DANGER

Keep children away from the shipping carton and packing components. Danger of suffocation from plastic foil and folding cartons.

Disposing of your old appliance

Old Appliances are not worthless trash! Valuable raw material can be recycled from old appliances. To prevent children from locking themselves in the appliances, remove the door. Please dispose of your old appliance according to local environmental regulations.

Factory - supplied equipment

Inside the drum there is a packet of accessory parts supplied with your appliance. Check that all the accessory parts supplied for your model are there. If any parts are missing contact customer service.

Any residual moisture inside the drum is due to the final testing which every appliance undergoes before leaving the factory.

Installation area

DANGER

Appliance stability is very important otherwise washing machine could “wander” during the spin cycles.

The installation area must be solid and even. Soft floor surfaces such as carpets or surfaces with foam backing are not suitable.

DANGER

Do not install the appliance outdoor or in an area exposed to freezing condition. frozen hoses can tear / burst.

If the appliance is located in a room which will be exposed to temperatures below freezing point, or if it is located in a cabin that is being shutdown for the winter, any residual water in the pump or water inlet hoses must be drained.

Removing the shipping rods

CAUTION

The shipping rods must be removed before using the appliance for the first time and must be retained for any future transport. (e.g when moving)

UNPACKING, LEVELING & POSITIONING

Remove the packing and check that the Super Combo is undamaged. If you have any doubt, do not use the Super Combo and call Customer Service. Keep all packing parts (plastic bag, foam rubber, screws, etc.) out of the reach of children since they could be dangerous.

Important: The inside of the Super Combo consists of a free floating drum that is affixed with shipping bolts at the back of the cabinet during transport (Fig.1). The power cord can be accessed by removing the shipping bolts (Fig. 2 & 3). Close the holes left open by the bolts with the caps provided (Fig. 4).

It is important for the machine to be perfectly level. For this reason, the machine is fitted with adjustable feet used for leveling the machine before use (Fig. 5).

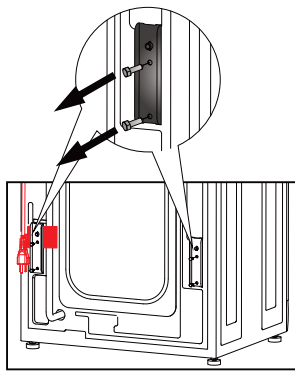

Fig.1

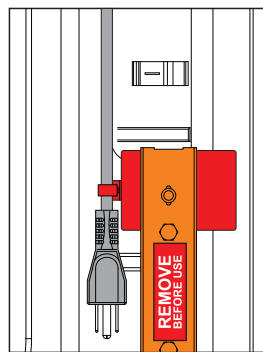

Fig.2

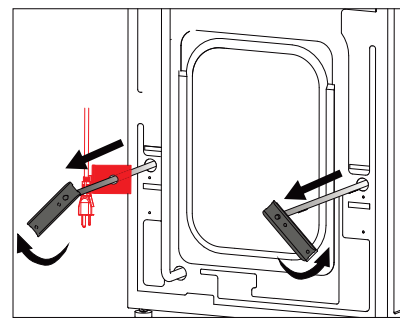

Fig.3

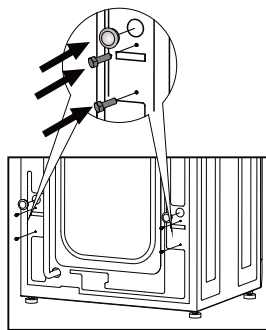

Fig.4

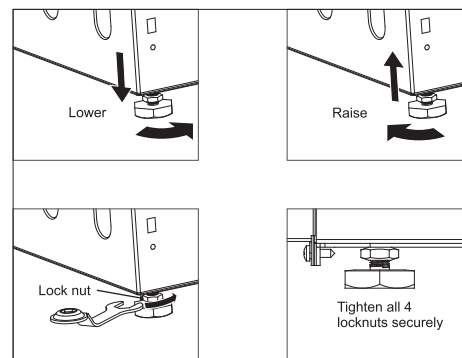

Fig. 5

NOTE

- Save the bolt assemblies for future use. To prevent damage to internal components, DO NOT transport the washer-dryer combo without reinstalling the shipping bolts.
- Failure to remove shipping bolts and retainers may cause severe vibration and noise, which can lead to permanent damage to the combo.
- The cord is secured to the back of the combo by a clamp with a shipping bolt to help prevent operation with shipping bolts in place.
- An adjustable wrench or 17mm open end wrench is required when loosen or tighten the leveling feet.

ELECTRICAL

CONNECTION

Connect the plug to a power outlet - 110V / 60Hz with minimum 15 Amps. Make sure that the voltage and frequency available correspond with those stated on the serial number plate located on the machine. Do not use adaptors or extension cords since they could result in overheating and burn out.

POWER SUPPLY

This Washer⊕Dryer must be connected to an individual circuit identical to the one specified on the rating plate of the loading port protected by fuses or circuit breaker conforming to local codes.

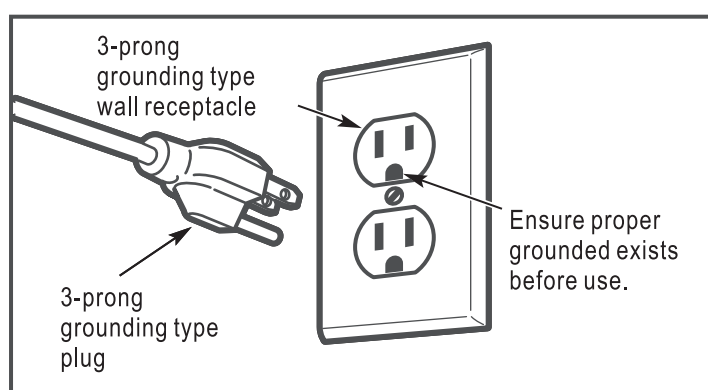

Fig. 6

GROUNDING

This appliance must be grounded. In the event of malfunction or breakdown, grounding will reduce the risk of electric shock by providing a path of least resistance for electric current. This appliance is equipped with a power cord having an equipment-grounding conductor and a grounding plug. The plug must be plugged into an appropriate outlet that is properly installed and grounded in accordance with all local codes and ordinances.

WARNINGS

- Improper connection of the equipment-grounding conductor can result in a risk of electric shock. Check with a qualified personnel or service representative if you are in doubt as to whether the appliance is properly grounded.
- Do not modify the plug provided with the appliance: if it will not fit the outlet, have a proper outlet installed by a qualified electrician.

Note: If the electrical power supply does not meet the specifications listed above, please call a licensed electrician.

PLUMBING

CONNECTING TO THE WATER FAUCET

To connect the hoses to the water faucets:

- Connect the straight end of each hose to the cold or hot faucet.
- Turn the fittings by hand until they are tight, and then tighten them by just an additional two-thirds of a turn with a wrench. Do not over tighten the fittings. They can be damaged.
- When done, pull the water hoses up and down to check if they are properly connected.

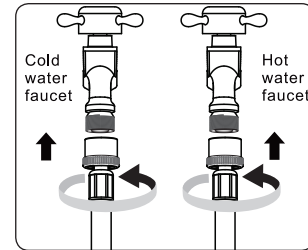

CONNECTING TO THE MACHINE

Make sure that there are no kinks in the hose and that they are not crushed. (Fig.7).



After connecting inlet hose to water faucet, turn on the water faucets to flush out foreign substances (dirt, sand or sawdust) in the water lines. Let water drain into bucket and check the water temperature.



After completing connection, if water leaks from the hose, repeat the same steps. Use the most conventional type of faucet for water supply. In case the faucet is square or too big, remove the spacing ring before inserting the faucet into the adaptor.

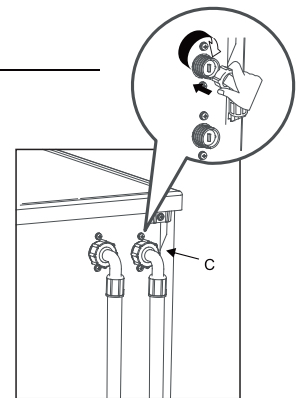

Fig.7

CONNECTING THE DRAIN HOSE

Connect the drain hose to a drain duct (with internal diameter of at least 1.6") or place it for drainage in to a sink or a tub, ensuring that there are no kinks or bends. The free end must be at a height of 24" - 40" from the floor. The hose can be held in place using the white plastic clamp on the upper part of the back panel.

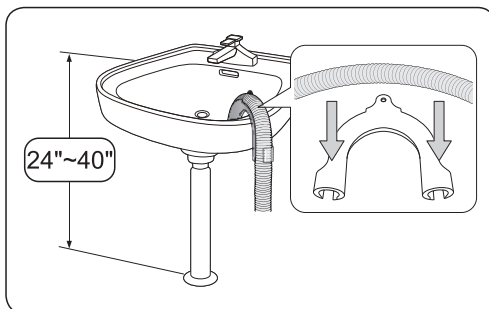

Fig. 8

Height difference between the installation location of the washing machine and the drainage point:
Minimum 24" to Maximum 40"

- Attach water drain hose to U-Connector.
- Hook the U-Connector over the side or stand pipe (Fig 8.)
- When the water is being drained, check that the water flow out of the hose is adequate.

PROGRAM SELECTION CHART

1. WASH & DRY, WASH ONLY, DRY ONLY

Recommended cycles according to the laundry type.

Wash Programs	Description of Load	Wash Features			Dry Features	
		Water Temp	Spin rpm	Duration	Max. Heat	Approx Time
1 - NORMAL	Mixed cottons	Warm	1200	51 mins	1300W	90 mins
2 - Prewash+Heavy	Thick cottons (towels, jeans)	Cold + Hot	1400	75 mins	1300W	120 mins
3 - Heavy	Mixed cottons (t-shirts, jeans)	Warm	1400	61 mins	1300W	120 mins
4 - ECO	Mixed cottons	Cold	800	31 mins	1300W	80 mins
5 - Quick 20'	Cotton blends, light fabrics	Cold	1200	20 mins	1300W	80 mins
6 - Delicate	Silk, Polyester, etc.	Cold	800	36 mins	750W	80 mins
7 - Wool	Woolens	Cold	500	36 mins	Tumble only NO HEAT	
8 - Quiet 60 dB	Mixed cottons	Cold	800	31 mins	1300W	80 mins
9 - Allergen 131°	Bedsheets, etc.	Hot (131°F)	1200	59 mins	1300W	120 mins
10 - Sanitize 165°	Mixed Cottons	Hot (165°F)	1200	69 mins	1300W	120 mins
11 - PET Cycle	Mixed Cottons	Cold	1200	36 mins	1300W	30 mins
					750W	60 mins

2. DRY CYCLES

Refresh 12 - 12 minutes cycle blowing hot air onto the clothes.

Time Dry 60 - 60 minutes dry cycle.

3. OTHER CYCLES:

Self clean - 40 minutes cycle to clean the inner drum and tub of the machine.

Drain - 2 minutes cycle to drain out the residual water in the tub of the machine.

Winterize - 2 minutes cycle to winterize your appliance.

NOTE:

The total working time will vary with the laundry size, water pressure, dryness level, water temperature and ambient temperature etc..

SPECIAL INSTALLATION REQUIREMENTS

0 CLEARANCE OTHER THAN ALCOVE OR CLOSET INSTALATION

BUILT-IN, RECESSED, CLOSET AND ALCOVE INSTALLATION

Minimum Installation Clearances

When installed in alcove: Sides, Rear, Top = 0" (0cm)

When installed in closet: Sides, Rear, Top = 0" (0cm), Front = 1" (2.54cm)

Consideration must be given to provide adequate clearance for installation and service.

Mobile Home Installation

Installation must conform to Standard for Mobile Homes, ANSI A119.1 and National Mobile home Construction and Safety Standards Act of 1974 (PL93-383).

The appliance must be attached to the floor according to ADA Compliance given below.

ADA COMPLIANCE

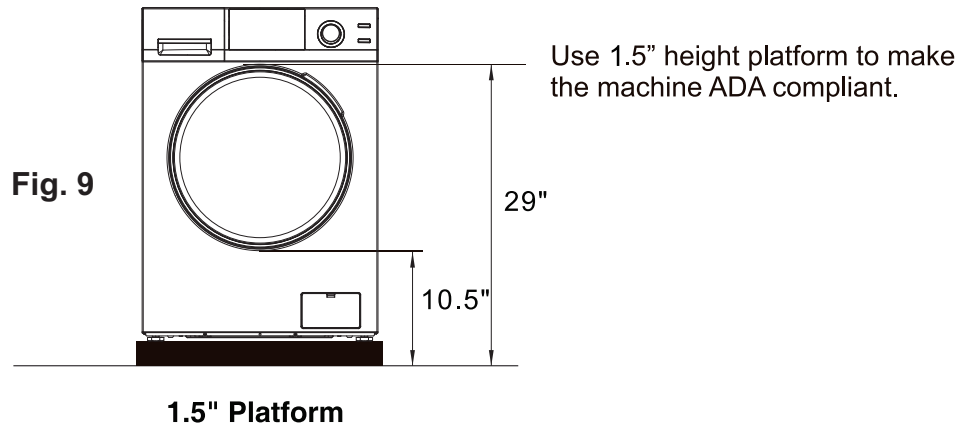

PET Cycle

Before loading clothes and sheets into the appliance, remove as much pet hair as possible in order to prevent buildup and clogging of the drain pump. Wipe the surface of clothes and sheets with a lint roller or a damp rubber glove to easily remove pet hair.

After the end of the wash cycle, run a quick wash cycle without clothes. After the cycle ends, wipe down the drum with a damp cloth to collect any pet hair on the drum surface.

OPERATING INSTRUCTIONS

1. Ensure the Combo Washer⊕Dryer is turned off. (Power Indicator light should be off).
2. Separate clothes by type, color and degree of soiling.
3. For small items such as socks, children's garments and small towels please use a **Washing Net Bag**.
4. Load clothes of the selected type loosely into the drum.
If you are using Wash Only cycle, you can fill the drum.
If you are using Wash + Dry cycle, please do not load clothes more than 2/3 full.
5. Close the Washer⊕Dryer door. You will hear a click when it is correctly closed.
Use Front Load detergent, as per direction.
Add detergent to Dispenser A.
You can add fabric softener in Dispenser B & pre-wash detergent and bleach in Dispenser C (Fig. 10)

Detergent Dispenser

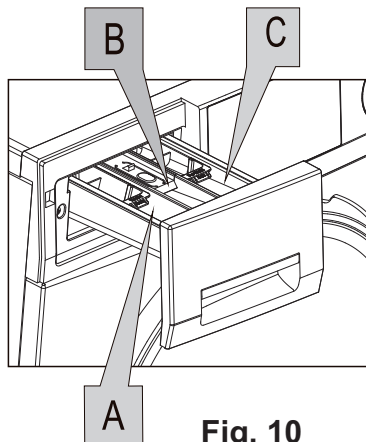

Dispenser A:
Detergent for main wash

Dispenser B:
Fabric softener

Dispenser C:
Detergent for pre-wash and bleach

**The blue cups are only for liquid detergent.
Please do not add powder in these cups.**

Note: concentrated fabric softener must be diluted with a little water before being poured into the dispenser
(This prevents the overflow siphon from getting blocked)

Your washer/combo is designed to use a high efficiency (HE) detergent, which reduces or eliminates suds and results in more efficient washing.



OPERATING INSTRUCTIONS

Care before washing

Before the first washing

- Select a cycle (Heavy, add a half load of detergent) allow the unit to wash without clothing. This will remove residues from the drum that may have been left during manufacturing.

1. Care Labels

Look for a care label on your clothes. This will tell you about the fabric content of your garment and how it should be washed.

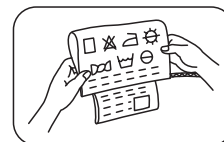

Wash Cycle		Special Instructions		Warning Symbols for Laundering	
	Normal		Line Dry/ Hang to Dry		Do Not Wash
	Permanent Press / Wrinkle Resistant / Wrinkle Control		Drip Dry		Do Not Wring
	Gentle/Delicates		Dry Flat		Do Not Bleach
	Hand Wash	Heat Setting			Do Not Tumble Dry
Water Temperature**			High		No Steam (added to iron)
	Hot		Medium		Do Not Iron
	Warm		Low	Dryclean	
	Cold		Any Heat		Dry Clean
Bleach			No Heat/Air		Do Not Dry Clean
	Any Bleach (when needed)	Iron-Dry or Steam Temperatures			Line Dry/ Hang to Dry
	Only Non-Chlorine (color-safe) Bleach (when needed)		High		Drip Dry
	Tumble Dry Cycle		Medium		Dry Flat
Normal			Low		For machine-washable wool. Loads should be under 3 kg.
	Permanent Press/ Wrinkle Resistant/ Wrinkle Control				
	Gentle/ Delicates				

OPERATING INSTRUCTIONS

2. Sorting

To get the best results, Sort clothes into loads that can be washed with the same wash cycle. Water temperature and spin speed and different fabrics need to be washed in different ways. Always sort dark colors from pale colors and whites. Wash separately as dye and lint transfer can occur causing discoloration of white etc. If possible, do not wash heavily soiled items with lightly soiled one.

Soil (Heavy, Normal, Light) Separate clothes according to amount of soil.

Color (White, Lights, Darks) Separate white fabrics from colored fabrics.

Lint (Lint producers, Collectors) . . . Wash lint producers and lint collectors separately.

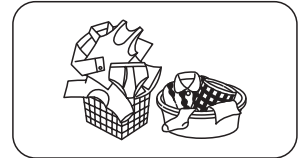

3. Caring before loading

Combine large and small items in a load. Load large items first. Large items should not be more than half the total wash load. Do not wash single items. This may cause an out-of-balance load. Add one or two similar items.

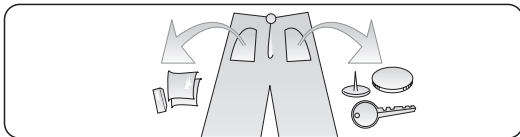

- Check all pockets to make sure that they are empty. Items such as nails, hair clip, matches, pens, coins and keys can damage both your washer and your clothes.

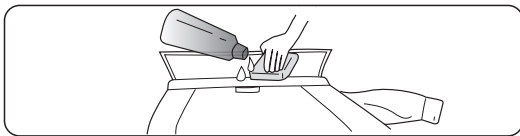

- Pre treat dirt and stains by brushing a little detergent dissolved in water onto stains like collars and cuffs to help shift dirt.

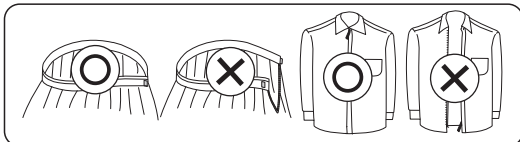

- Close zippers, hooks and strings to make sure that these items don't snag on other clothes.

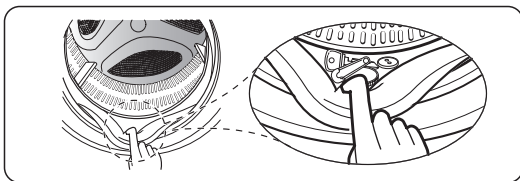

- Check the folds of the flexible gasket (gray) and remove any small articles, if any.
- Check inside of the drum and remove any left items in it for next wash cycle.

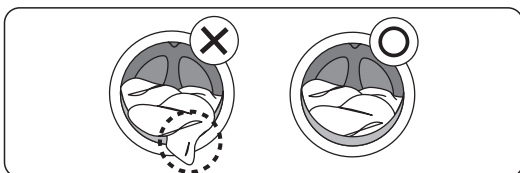

- Remove any clothing or items on the flexible gasket to prevent clothing and the gasket damages.

Control Panel

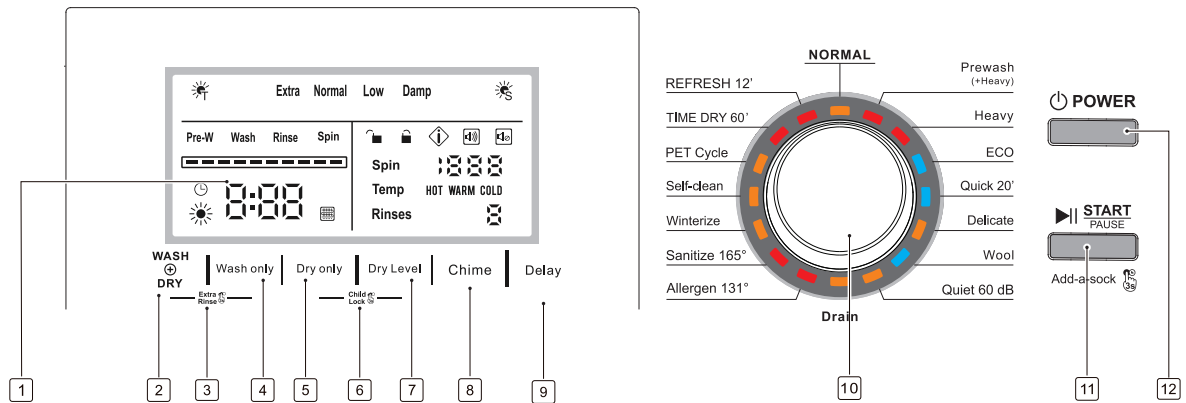

Buttons Introduction

1	Colored LED Display	To display the information of selected program, such as the water temperature, spin speed, remaining time, rinse times, wash cycles and error messages.
2	Wash + Dry button	To select Wash & Dry cycle together.
3	Extra Rinse button	To add an extra rinse to the selected cycle, touch Wash + Dry and Wash only buttons for 3 seconds before starting.
4	Wash only button	To select Wash cycle only.
5	Dry only button	To select Dry cycle only.
6	Child Lock button	To prevent the children from playing with your machine. Touch Dry only and Dry level button at same time for 3 seconds when machine is running.
7	Dry Level button	Touch this button to select the dry level for a Sensor Dry cycle. The default is Normal and you can select Extra, Low or Damp Dry.
8	Chime button	Touch this button for 3 seconds to turn the chime on or chime off when your washer is running.
9	Delay button	To delay the start of the wash cycle, touch this button to select the delay time from 1 to 24 hours, increasing in one-hour increments. To change the delay time, turn the dial to another program, then back to the desired program and reset the delay time.
10	Program dial knob	Turn dial to point to one of the 16 programs depending on the load.
11	Start / Pause	Press this button to start, or interrupt the selected wash program, or to view the program during a cycle.
12	Power	Press this button to turn the machine on. Or hold down this button to turn it off.

Display Panel Symbols

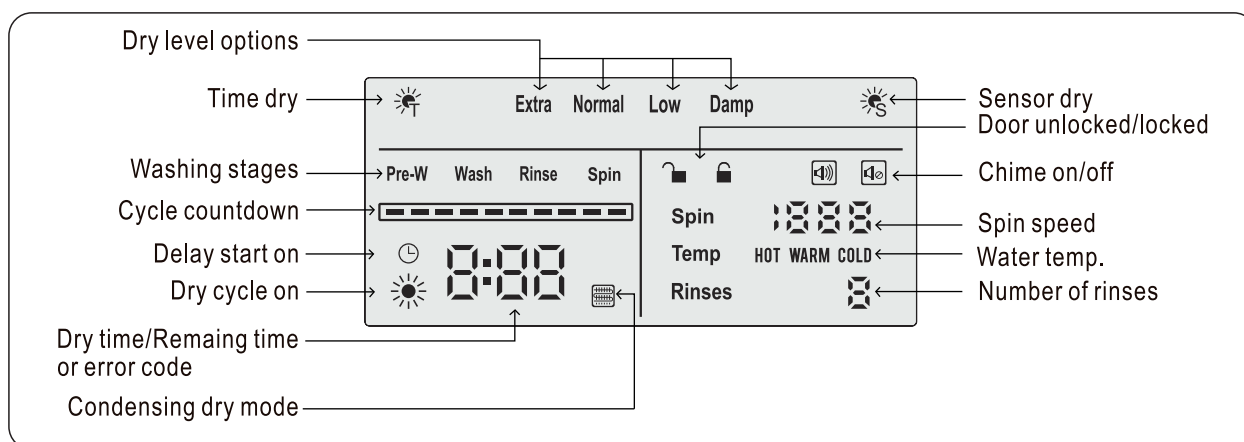

Run the cycle

A. How to run WASH + DRY Cycle

1. Press POWER button
2. Press START

Default cycle is NORMAL - If required you can change to desired washing and drying cycle based on the type of clothes by rotating the Program Dial knob.

B. How to run WASH Only Cycle

1. Press POWER button
2. Press WASH Only button
3. Press START

Default cycle is NORMAL - If required you can change to desired washing cycle based on type of clothes by rotating the Program Dial knob.

C. How to run DRY Only Cycle

1. Press POWER button
2. Press DRY Only button
3. Press START

Default cycle is NORMAL - If required you can change to desired drying cycle based on the type of clothes by rotating the Program Dial knob.

D. How to stop the wash cycle

1. The wash program can be stopped at any time.
2. Press START/PAUSE, rotate the knob to another program to cancel the current selected program.
3. Press POWER button for 3 seconds to turn off the machine

E. How to stop the dry cycle

1. Press START/PAUSE to stop the dry cycle.
2. Press POWER button for 3 seconds to turn off the machine

F. How to turn on the display in energy saving mode?

1. Machine display gets turned off automatically during operations to save energy.
2. Press any button to turn on display during this energy saving mode

Add-a-sock Feature



The wash program can be stopped at any time to add forgotten items to the laundry.

- Press START/PAUSE for 3 seconds.
- Door will open after draining water so that it does not overflow.
- Load clothes. Close door.
- Press START The cycle will continue from the point it stopped

How to winterize for cold weather

- Pour 2 cups of RV type Antifreeze in soap dispenser.
- Select WINTERIZE cycle on knob and press START. Machine will Rinse & Spin.
- Open coin trap once cycle is finished and drain out remaining water.
- Shut off water at both faucets and disconnect water inlet hoses from faucets and drain.

Door lock function

Pressing the START button  will lock the door  → . The wash cycle will start and will continue until the whole program is completed. The door will be locked and cannot be opened until the wash cycle ends. In a few minutes after the cycle ends, the door lock icon will change from locked to unlocked and then you can open the door easily.

Please do not try to force the door open. **Breakage of the door handle is not covered by warranty.**

USEFUL TIPS

Denim Alert:

Some overalls have straps with hooks that can damage the drum of your washing machine or other garments during the wash. To minimize the risk, place hooks in the pocket and fasten with safety pins.

Vacations: unplug the appliance:

It is recommended that you should unplug the machine from the socket and turn off the water supply. Leave the door ajar to allow air circulation to the drum and the door gasket area. This will prevent unpleasant odors.

MAINTENANCE

Your Washer-Dryer has been designed to operate with easy maintenance. Follow these simple maintenance procedures to obtain optimum performance:

1. Ensure that your machine was installed according to the correct installation procedures detailed in this Manual.
2. Do not use solvents either to clean the machine or to wash clothes.
3. Keep the inside of the detergent dispenser clean.

Cleaning the coin trap

- Switch off the appliance, allow the water to cool down.
- Open the service flap by using a finger (bottom right corner) (Fig. 11).
- Carefully unscrew the coin-trap cover. **Warning: Some residual water will flow out. (Approx. 1 Cup)** (Fig. 12)
- Remove foreign objects/fluff from inside and clean the interior. (Fig. 13)
- The pump impeller wheel is located behind the water filter, must be able to rotate.
- Remove detergent residue and fluff from the pump cover thread and pump housing.
- Insert the coin-trap cover and screw tight, close the service flap (Fig. 14)

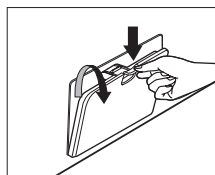

Fig. 11

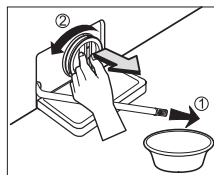

Fig. 12

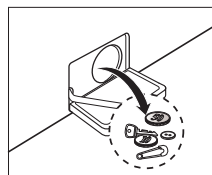

Fig. 13

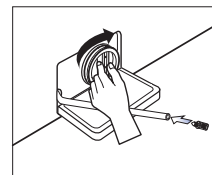

Fig. 14

Cleaning the Detergent drawers and Recess

- Press release lever on the inside of the drawer and pull it out. (Fig. 15)
- Remove the cap from the Fabric Softener compartment.
- Clean the drawer recess with a small brush. (Fig. 16 & Fig. 17)
- Reinsert the cap (Pushing it firmly into place).
- Push the drawer back into place.
- Run a rinse program without any laundry in the drum.

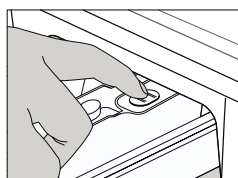

Fig. 15

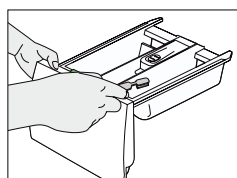

Fig. 16

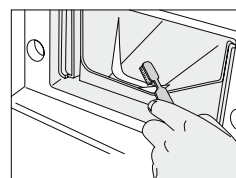

Fig. 17

Clean the machine

1. Exterior

Proper care of appliance can extend its life.

- The outside of the appliance can be cleaned with warm water and a neutral non abrasive household detergent.
- Immediately wipe off any spills. Wipe with damp cloth.
- Try not to hit surface with sharp objects.
- Do not use methylated spirits, diluents, chemicals or similar product.

2. Interior

- Dry around the machine door opening, flexible gasket and door glass.
- Run appliance through a complete cycle using hot water.
- Repeat process if necessary.

NOTE : To remove hard water deposits, use only cleaners labeled washer safe.

MAINTENANCE

Clean the water inlet filter

If water is very hard or contains traces of lime deposit, the water filter may become clogged. It is therefore a good idea to clean it from time to time.

- Turn off the water faucet (Fig. 18).
- Unscrew the water inlet hose (Fig.19).
- Clean the filter using a hard bristle brush under the running water (Fig.20).
- Insert the filter into the valve and tighten up the inlet hose (Fig. 21).

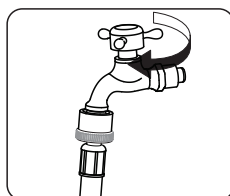

Fig. 18

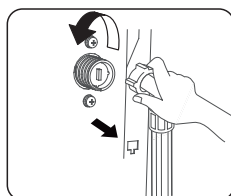

Fig. 19

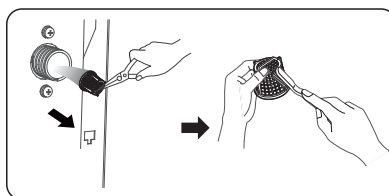

Fig. 20

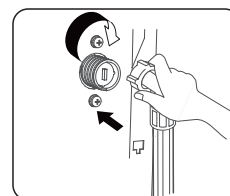

Fig. 21

Clean the drum

If you live in a hard water area, lime scale may build up continuously in places where it cannot be seen and thus not easily removed. Over time the build up of scale clogs appliance, and if it is not kept in check these may have to be replaced. Although the washing drum is made of stainless steel, specks of rust can be small metal articles (paper clips, safety pins) which have been left in the drum.

- The washing drum should be cleaned from time to time.
- If you use descaling agents, dyes or bleaches, make sure they are suitable for washing machine use.
- Descale may contain chemicals that may damage part of appliance.
- Remove any spots with a stainless steel cleaning agent.
- Never use steel wool.

Clean the door gasket

Clean the door gasket once a month to prevent buildup of dirt in the door gasket.

- Open the door, and then empty the drum.
- Combine 3/4 cups of liquid chlorine bleach and 1 gallon of warm tap water.
- Turn over the rubber door gasket.
- Wearing rubber gloves, use a soft, clean cloth dipped in the water and bleach solution to clean the gasket.
- Let stand 5 minutes, and then wipe up and dry well.
- Put the rubber gasket back.

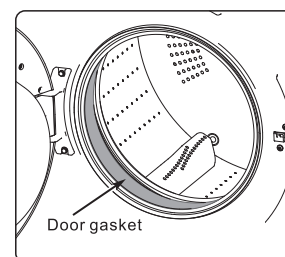

Fig. 22

CAUTION

1. Clean the door gasket with undiluted liquid chlorine bleach may cause the door gasket and machine to malfunction. Dilute the bleach by adding it to water before using it.
2. Use bleach carefully and be sure to follow the bleach manufacturer's use and care instructions.

Emergency release, e.g the power failure occurs.

The program continues running if the power is restored, If the laundry is still to be unload, the door can be opened as described below:

- Open the service flap.
- Drain the remaining water.
- Pull down the emergency release lever with a tool and release.
- Door can then be opened.
- Close the service flap.

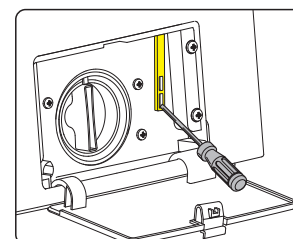

Fig. 23

STAIN REMOVAL CHART

Blood

Rinse or soak fresh stain in cold water. Work detergent into any remaining stain. Rinse. If stain persists, put a few drops of ammonia on stain and repeat detergent treatment. Rinse. If necessary bleach.

Burn Marks

Rinse or soak in cold water. Work detergent into stain. Rinse. Bleach, if necessary. Stain may be impossible to remove.

Candle Wax

Scrape off excess. Place stain between clean white blotters or several layers of facial tissues. Press with warm iron. Sponge with cleaning fluid. If dye spot remains, bleach.

Chewing Gum

Rub with ice to harden. Scrape off excess with dull blade. Sponge with cleaning fluid.

Chocolate or Cocoa

Soak 15 minutes in cold water. Rub detergent paste into stain, then rinse thoroughly. Launder in hottest water safe for fabric. If colored stain remains, sponge with hydrogen peroxide, rinse and launder.

Coffee or Tea

Soak fresh stains immediately in cold water. Then use bleach treatment with hottest water safe for fabric. Launder.

Cosmetics (makeup, lipstick, etc.)

Apply undiluted liquid detergent to stain, or dampen stain and rub in soap or detergent paste until thick suds are formed. Work in until stain is gone, rinse well. Repeat if necessary. If color remains, bleach if safe for fabrics.

Cream, Ice Cream or Milk

Sponge stain with cool water or soak stain in cool water for 30 minutes or longer. If stain remains, work detergent on spot then rinse. Bleach if necessary.

Deodorants and Antiperspirants

Wash or sponge stain thoroughly with warm water and detergent; rinse. If stain remains, bleach with hot sudsy water. Launder. You may be able to restore fabric color by sponging with ammonia. Rinse thoroughly.

Dye

Rinse or soak in cold water. Work detergent into stain. Rinse. If necessary, bleach. Stain is not always possible to remove. A commercial color remover may also be used.

Egg or Meat Juice

Rinse in cold water. If stain remains, sprinkle with meat tenderizer, let stand 15-20 minutes. If stain still remains, sponge with cleaning fluid or diluted bleach. Launder in hot water. The use of hot water first may set stain.

Fabric Softener Stain

Rub with bar soap until stain has lightened. Rinse thoroughly. Launder. Rubbing alcohol is sometimes effective in the color of the garment can take it. Launder. If desired, dry cleaning can be used.

Felt tip pen

Spray spot with cleaners suitable to this purpose. Sponge stain thoroughly. Rinse with cold water. Reapply cleaner if necessary.

Fruit, Wine

Soak fresh stains immediately with cool water. Then use bleach treatment with hottest water safe for fabrics. Launder.

Grass

Work detergent into stain. Sponge with denatured alcohol. Bleach, if necessary.

Grease or Oil

Scrape away excess. Rub detergent paste or a general purpose liquid household cleaner into stain, rinse with hot water. If stain remains, sponge thoroughly with a grease solvent. Dry. Repeat if necessary. To remove yellow stain, use a chlorine or oxygen bleach.

Ink

Some ball-point inks are set by water. First test a scrap of cloth. Sponge stain repeatedly with acetone, amyl acetate or rubbing alcohol. Hair spray is effective. Launder. Bleach if necessary. Use amyl acetate on triacetate, arnel, dynel and verel. Use acetone on other fabrics. NOTE: Some inks cannot be removed.

Ketchup

Scrape off excess. Soak in cold water 30 minutes. Pre-treat with a detergent paste. Launder.

Mildew

Brush off surface growth to keep mold spores from spreading. Dip article into solution of ½ cup bleach per 1 gallon (~3.8 Litres) of cool sudsy water for 5 to 10 minutes. Rinse well. Launder.

Mud

Let stain dry; then brush well. Rinse repeatedly in cool water until mud comes out. Launder. (Hot soaps suds set a red or yellow clay stain).

Mustard

Soak in hot detergent water for several hours. If stain remains, bleach.

Nail Polish

Treat while fresh, scraping or wiping off as much as possible, before it dries. Place stain face down on white paper towels. Sponge back of stain acetone (nail polish remover) or sponge with denatured alcohol and a few drops of household ammonia. Sponge stain frequently. Launder with water at temperature suitable for fabric. *Do not use acetone on acetate, arnel, dynel or rayon.*

Paint

Sponge or soak in turpentine or solvent recommended as a thinner on label. Launder.

Perfume

Rinse in cold water. Rub undiluted liquid detergent or a detergent paste into stain. Rinse. If stain remains, bleach.

Perspiration

Wash or sponge stain thoroughly with warm water and detergent paste. If perspiration has changed the color of the fabric, restore it by treating with ammonia or vinegar. Apply ammonia to fresh stains; rinse with water. Apply vinegar to old stains; rinse with water.

Rust and Iron

Apply commercial rust remover, Rinse. Or, if safe for fabric, boil stained article in solution of 4 teaspoons of cream of tartar to 2 cups of water.

Shoe Polish

Scrape off as much as possible. Pre-treat with a detergent paste; rinse. If stain persists, sponge with rubbing alcohol (1 part to 2 parts water) or turpentine. Remove turpentine by sponging again with warm detergent solution or with alcohol. Bleach if necessary.

Soft Drinks

Sponge with cold water, some stains are invisible when they have dried, but turn brown when heated and may be impossible to remove.

Tar and Asphalt

Act quickly before stain is dry. Sponge with grease solvent or turpentine. Launder.

Urine

Soak in cool water. If stain is dry, work a detergent paste into the spot then rinse. If necessary, bleach.

TROUBLESHOOTING

Before call for service

In most cases when your washer-dryer fails to work the problems arising, can be easily solved without having to call for a technician. Before calling for assistance, always check these points.

Problem	Solution
Will not start..	<ul style="list-style-type: none"> • Make sure the door is firmly closed. E -1 • Make sure your Washer is plugged in. • Make sure the water source faucets are open. • Make sure to press the Start/Pause Button to start your Washer. • Make sure the Child Lock is not activated. • Before your machine starts to fill, it will make a series of clicking noises to check the door lock and do a quick drain. • Check the fuse or reset the circuit breaker
Has no water or not enough water..	<ul style="list-style-type: none"> • Turn both faucets on fully. E -3 • Make sure the door is tightly closed. • Straighten the water inlet hoses. • Disconnect hoses and clean filters. Hose filter screens may be clogged. • Open and close the door, then press the Start/Pause Button.
Vibrates or is too noisy.	<ul style="list-style-type: none"> • Make sure your machine is set on a level surface. If the surface is not level, adjust your machine feet to level the appliance. • Make sure that the shipping bolts are removed. • Make sure your machine is not touching any other object. • Make sure the laundry load is balanced.
Stops	<ul style="list-style-type: none"> • Plug the power cord into a live electrical outlet. • Check the fuse or reset the circuit breaker. • Close the door and press the Start/Pause Button to start your machine. For your safety, your machine will not tumble or spin unless the door is closed. • Before your machine starts to fill, it will make a series of clicking noises to check the door lock. • There may be a pause or soak period in the cycle. Wait briefly and it may start. • Check the filters on the inlet hoses at the faucets for obstructions. Clean the filters periodically.
Door locked or will not open.	<ul style="list-style-type: none"> • Press the Start/Pause Button to stop your machine. • Your machine door will remain locked during the heating portion of the Sanitize Cycle • It may take a few moments for the door lock mechanism to disengage.
Does not drain and/or spin.	<ul style="list-style-type: none"> • Check the fuse or reset the circuit breaker. • Straighten the drain hoses. Eliminate kinked hoses. If there is a drain restriction, call for service. E -2 • Close the door and press the Start/Pause Button. For your safety, your Washer will not tumble or spin unless the door is closed.

TROUBLESHOOTING

Problem	Solution
Fills with the wrong temperature water.	<ul style="list-style-type: none"> • Turn both faucets on fully. • Make sure the temperature selection is correct. • Make sure the hoses are connected to the correct faucets. Flush water lines. • Check the water heater. It should be set to deliver a minimum 120° F (49° C) hot water at the tap. Also check the water heater capacity and recovery rate. • Disconnect the hoses and clean the screens. The hose filter screens may be plugged. • As your Washer is filling, the water temperature may change as the automatic temperature control feature checks incoming water temperature. This is normal. • While your Washer is filling, you may notice just hot and/or just cold water going through the dispenser when cold or warm wash temperatures are selected. This is a normal function of the automatic temperature control feature as your Washer determines the temperature of the water.
Load is too wet at the end of the wash cycle.	<ul style="list-style-type: none"> • Use the High or Extra High spin speed. • Use high efficiency detergent to reduce over-sudsing. E -4 • Load is too small. Very small loads (one or two items) may become unbalanced and not spin out completely.
Leaks water.	<ul style="list-style-type: none"> • Make sure the door is firmly closed. • Make sure all hose connections are tight. • Make sure the end of the drain hose is correctly inserted and secured to the drainage system. • Avoid overloading. • Use high efficiency detergent to prevent over-sudsing. E -4
Has excessive suds.	<ul style="list-style-type: none"> • Use high efficiency detergent to prevent over-sudsing. E -4 • Reduce the detergent amount for soft water, small or lightly soiled loads. • Non-HE detergent is NOT recommended.
No drying	<ul style="list-style-type: none"> • The dryer knob is in the correct position for drying cycle. • A dry cycle is selected (Time dry/ Sensor dry).
Not drying efficiently	<ul style="list-style-type: none"> • The end of drain hose is under water. • The drain pump is obstructed. • The drum is overloaded. • The cold water faucet is not open. • The fabric softener is not being used.
Condensation at soap dispenser	<ul style="list-style-type: none"> • Slight condensation can occur at soap dispenser and will evaporate. This is normal.

DIAGNOSTIC MENU

DIAGNOSTIC MENU		
Code	Description	Component
E1	Door open	Door Switch
E2	Drain failure	Drain Pump
E3	Water inlet failure	Inlet Valves
E4	Water overfill	Inlet Valves
E5	Motor failure	Motor +Electronic Module
E7	Washing heater failure	Washing heater
E8	Dryer Malfunction	Temp. sensor (@rear-bottom of tub)
E9	Dryer Malfunction	Temp. sensor (@front of heater housing)
E10	Water level failure	Water level sensor
E11	Dryer Malfunction	Temp. sensor (near the blow fan motor)
E12	Dryer Malfunction	Fan Motor
E13	Dryer Malfunction	Dying heater
E16	Communication between display & electronic module	Communication Cable

To Order parts : www.ApplianceDesk.com/Parts



Equator Advanced Appliances USA was established in 1991 for providing the most Efficient, Highest Quality and Innovative household appliances.

Equator's mission is to provide Innovative, Practical, Top-Quality appliances that Save Time, Space and Energy and Simplify domestic chores.

Equator's vision is to Improve the Quality of Life for our Customers!

Equator Appliances USA

www.EquatorAppliances.com