

Installation Instructions, 1-1/2" Hex Cap Nuts Dome Cap Nuts 1" Hex Cap Nuts

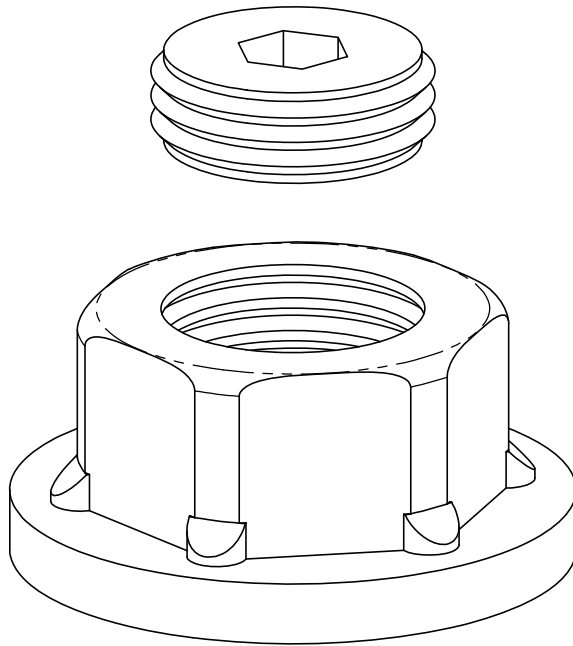

56621 & 86621
1-1/2" Hex Cap Nuts

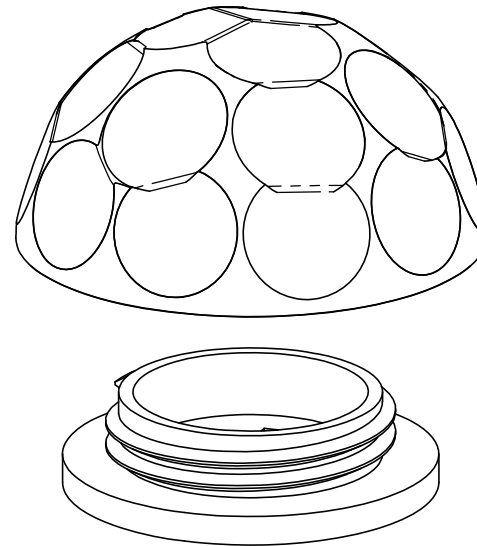

56622 & 86622
Dome Cap Nuts

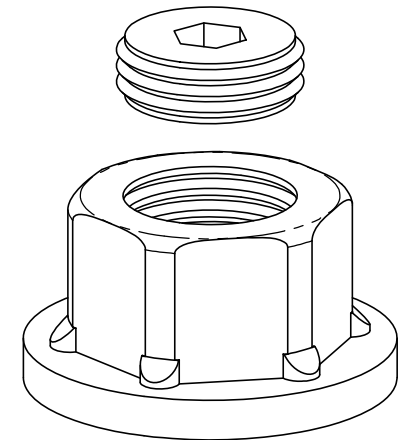

56681 & 86681
1" Hex Cap Nuts

All Cap Nuts function the same

Hex Cap Nuts are standard on most products.

Dome Cap Nuts are standard on hinges.

Either are suitable in place of one another plus a variety of other uses.

Increased holding power of fasteners with additional surface area.



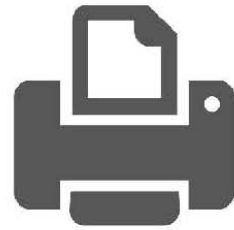

Printing Documents from ISSUU

Unfortunately, there is currently no way to print content directly through issuu. To print a publication, you will need to download it and print it from your computer.

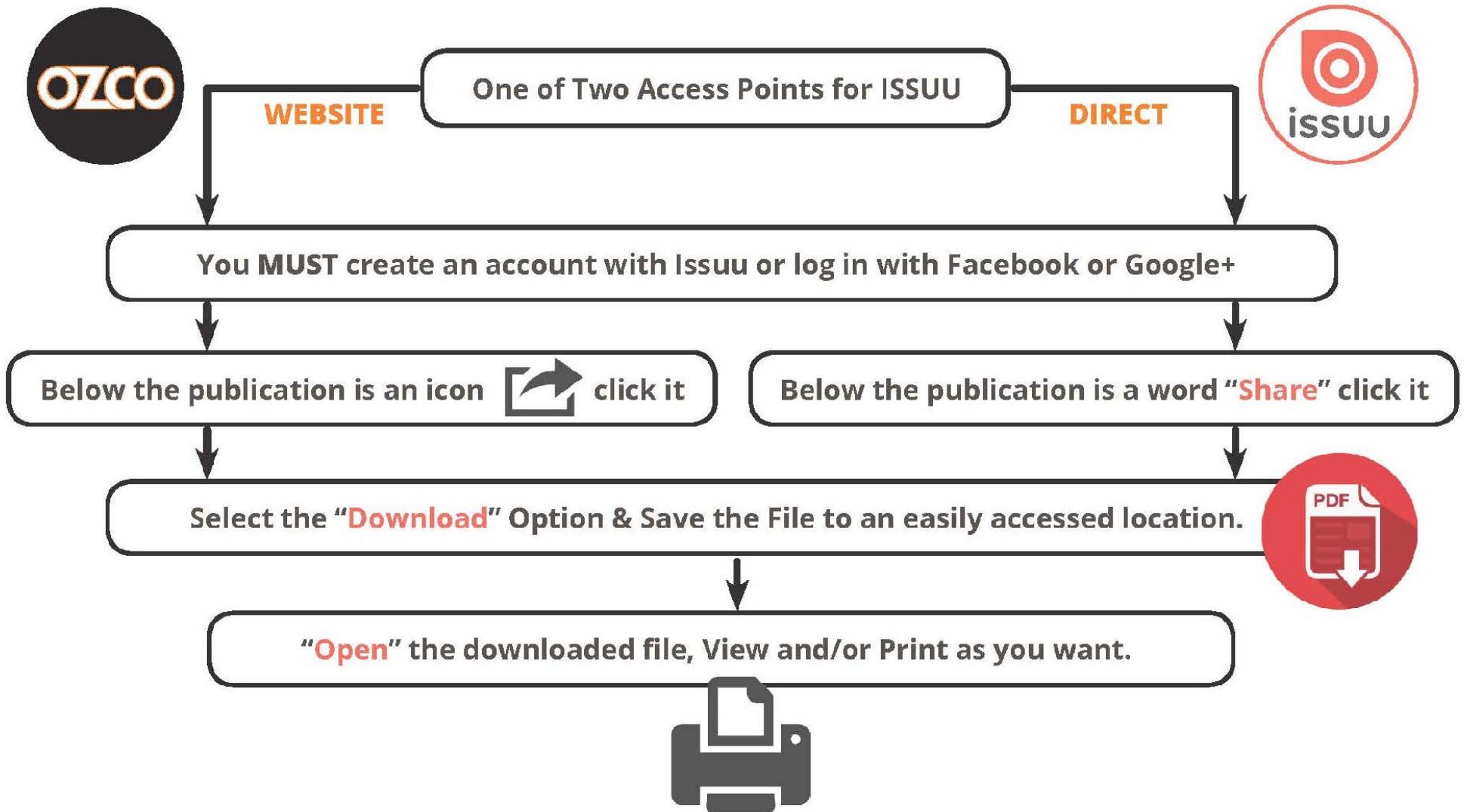

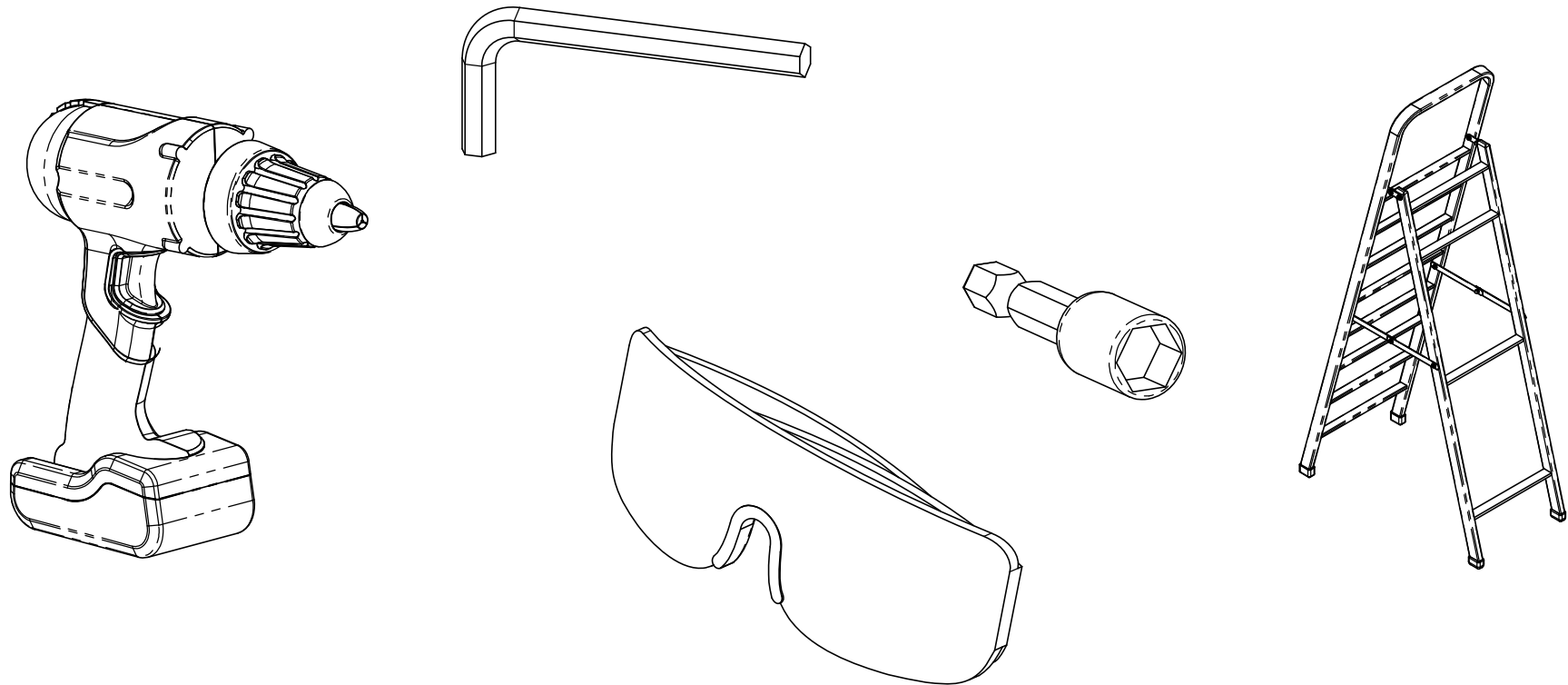

Suggested Tools

(others may be required)

Installation Instructions, Cap Nuts

Recommended Fastener:
OWT Timber Screws

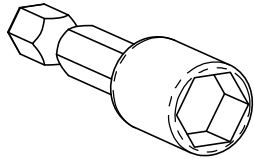

Tool required
3/8" Driver (not
included)

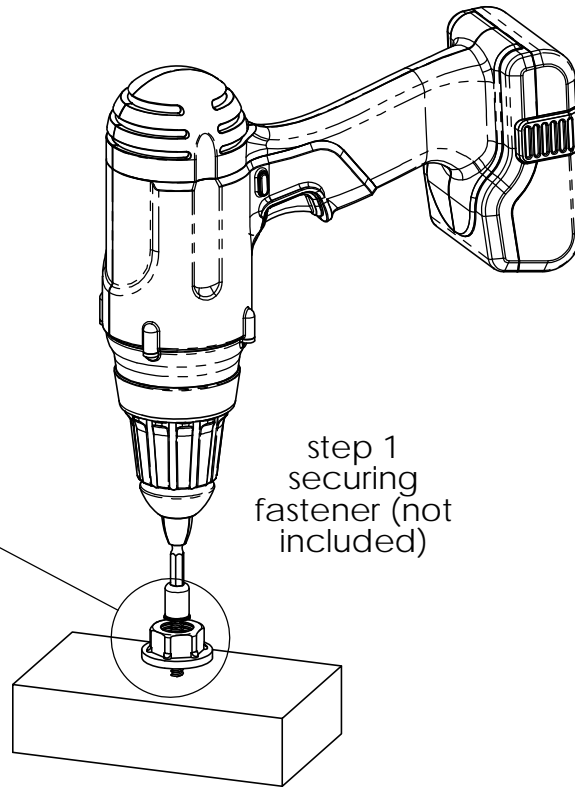
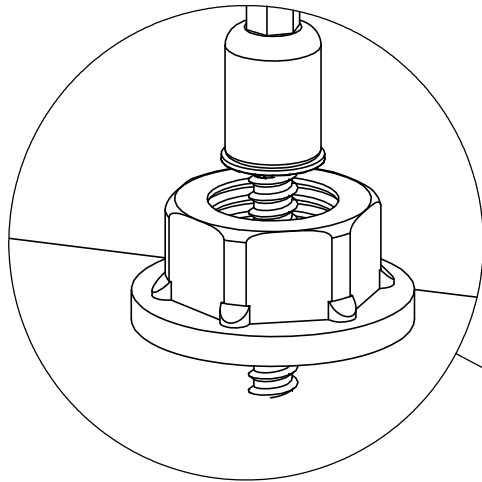

step 1
securing
fastener (not
included)

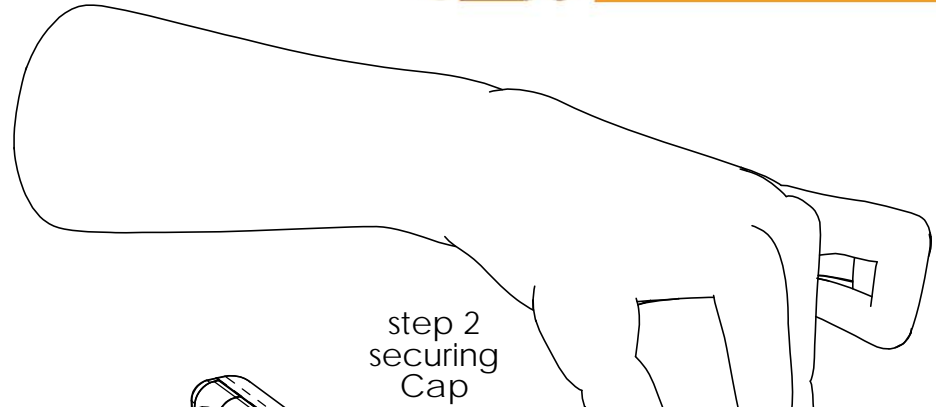

step 2
securing
Cap

finger tight

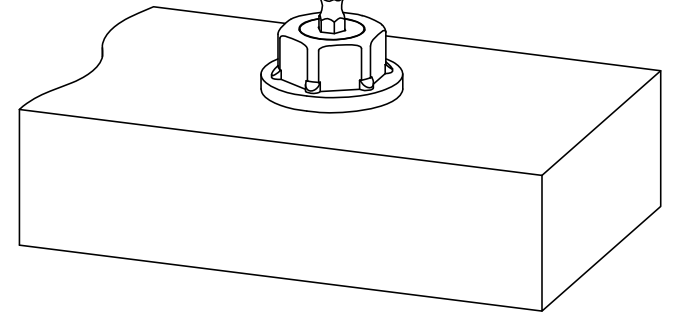

1-1/2" Hex Cap Nut Installation

Recommended Fastener:
#8x1"
(phillips head shown)

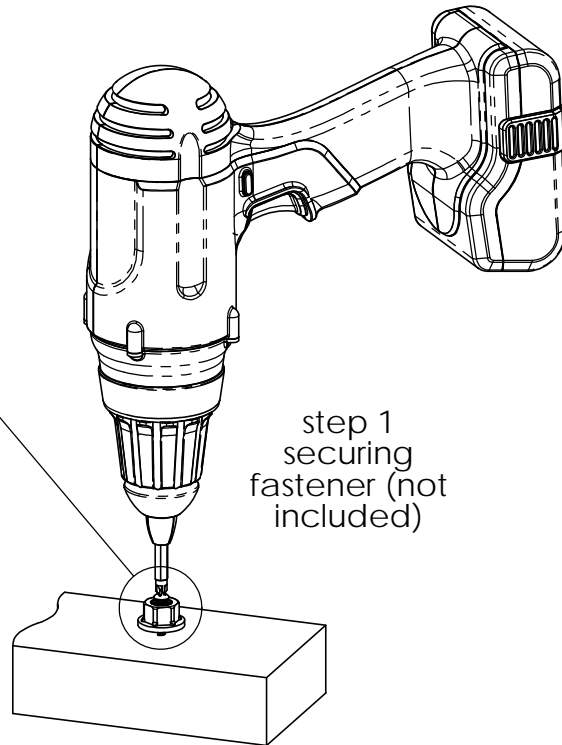
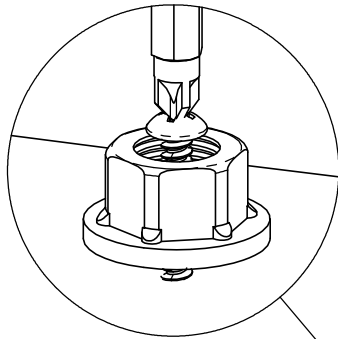

step 1
securing
fastener (not
included)

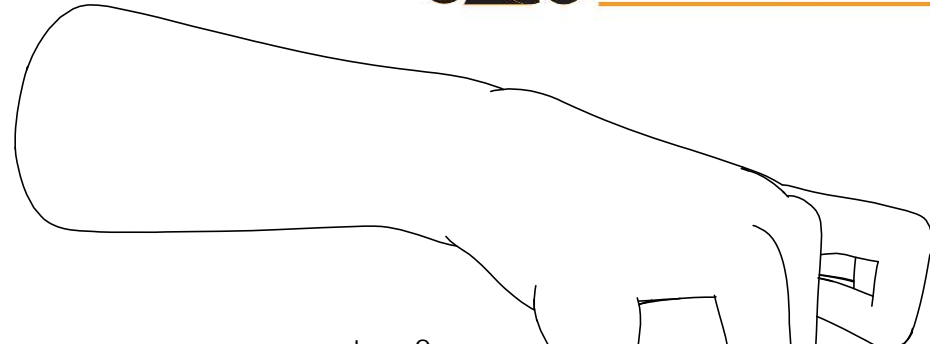

step 2
securing
Cap

finger tight

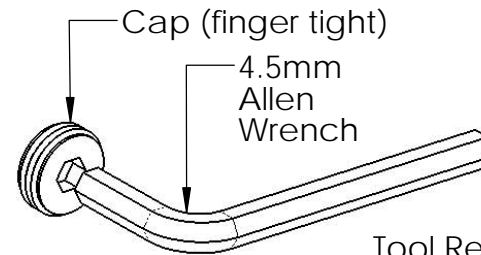
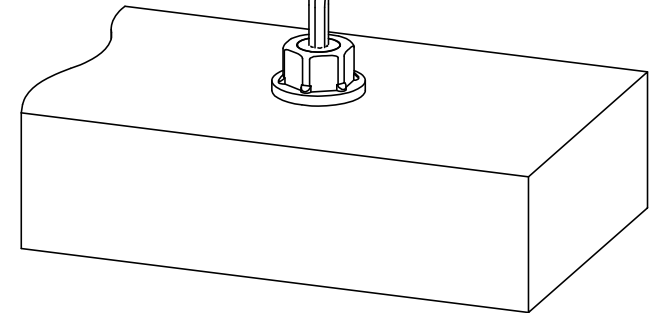

Cap (finger tight)

4.5mm
Allen
Wrench

Tool Required

1" Hex Cap Nut Installation

Installation Instructions, Cap Nuts

Recommended Fastener:
OWT Timber Screws

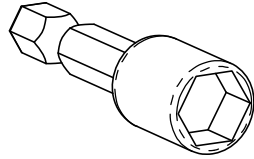

Tool required
3/8" Driver (not included)

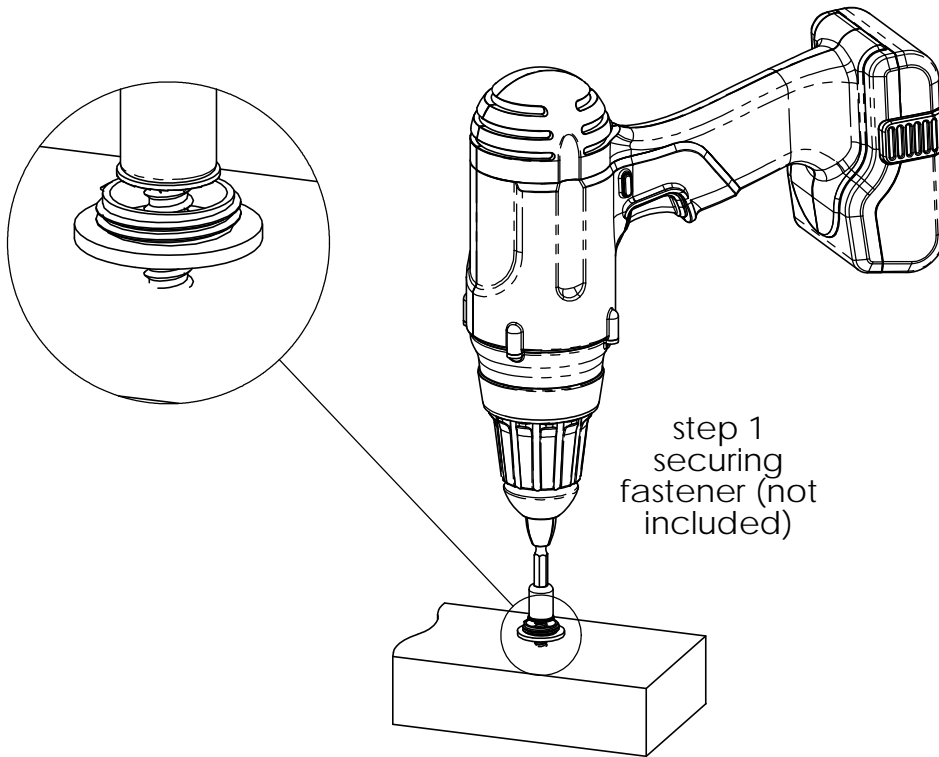

step 1
securing
fastener (not included)

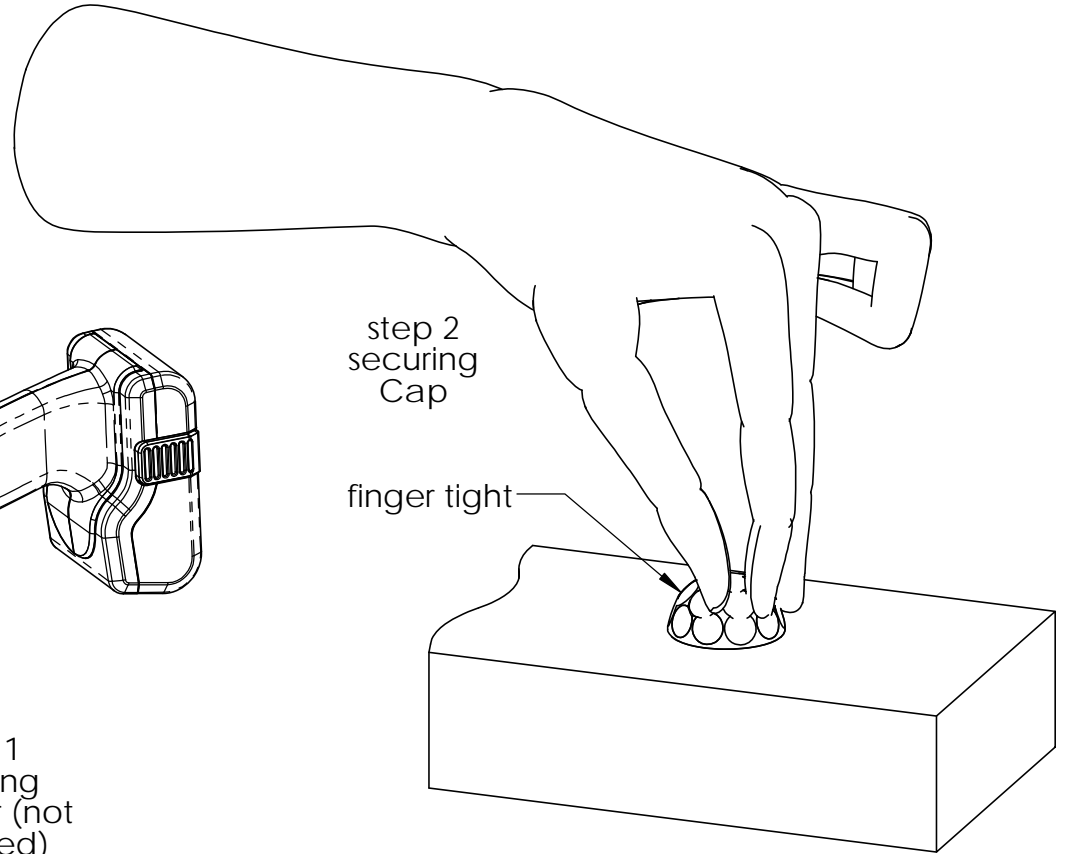

step 2
securing
Cap

finger tight

Dome Cap Nut Installation

Installation Instructions, Cap Nuts

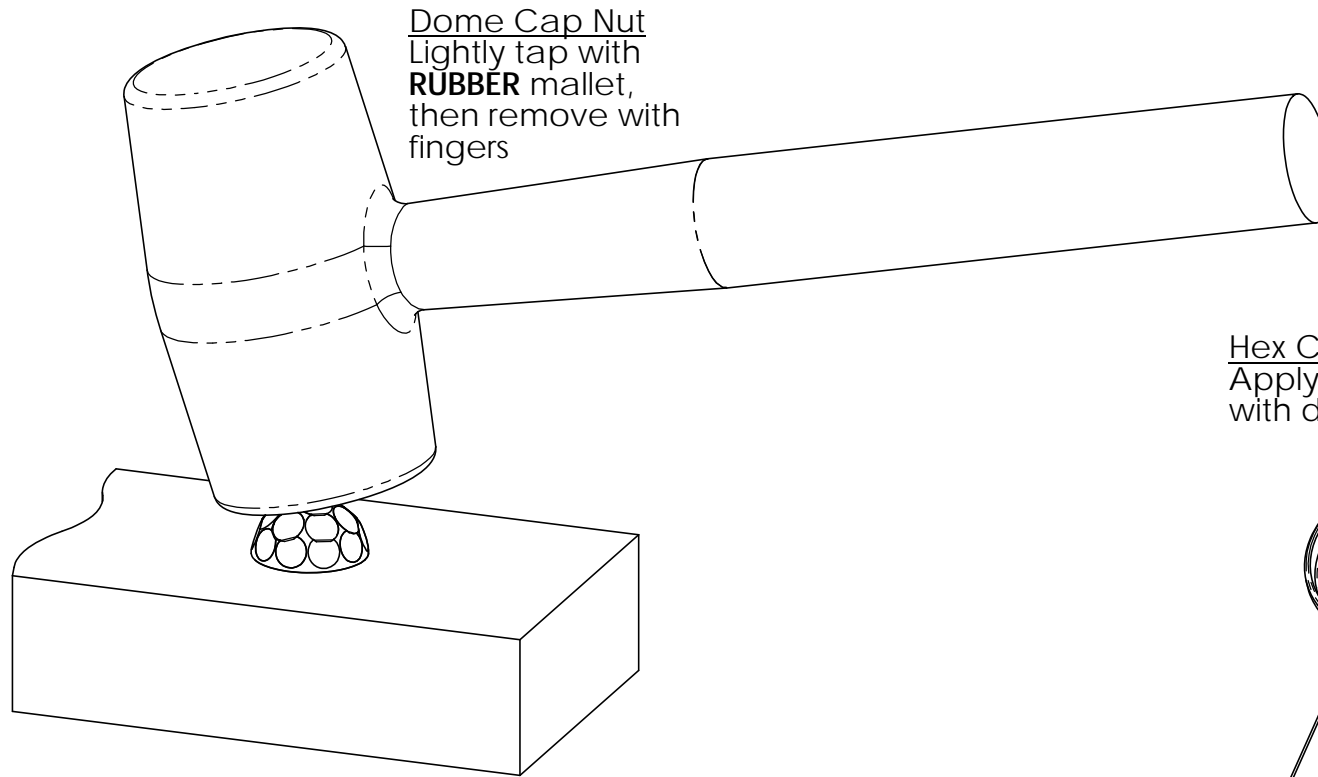

Hex Cap Nut (both sizes)
Apply lubricant, then remove
with driver/allen wrench

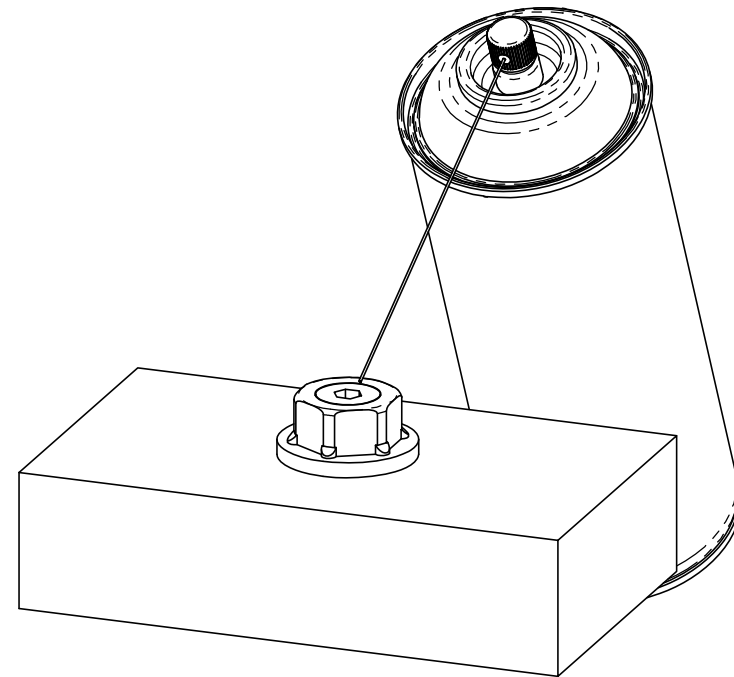

Disassembly Method...if difficult