

PARTS BREAKDOWN SHEET



ACCENT TWO HANDLE LAVATORY FAUCET



Model #: _____
Specific Features: _____
Project Name: _____
Submitted For: _____
Date: _____

- Lever Handles
- 4-1/8" Reach, 1-3/4" From Deck to Aerator
- Washerless Cartridge Operation
- 3-Hole 4" Installation
- 50/50 Pop-Up Drain Assembly
- With 1.5 GPM Flow Rate

L-7240 SHOWN **ADA**

Model #	Features	Finish	
L-7240*		CP	
L-7240-BN*		PVD BN	
L-7240-ORB*		ORB	
L-7240B*	Builder Tract Pack	CP	

* Aerator limited to 1.5 GPM Flow Rate

Olympia products are engineered and manufactured to meet the following standards and codes:

- ASME A112.18.1
- ANSI A117.1
- ANSI / NSF 61, SECTION 9
- IAPMO LISTED
- CONTAINS NO MORE THAN 0.25% WEIGHTED AVERAGE LEAD CONTENT

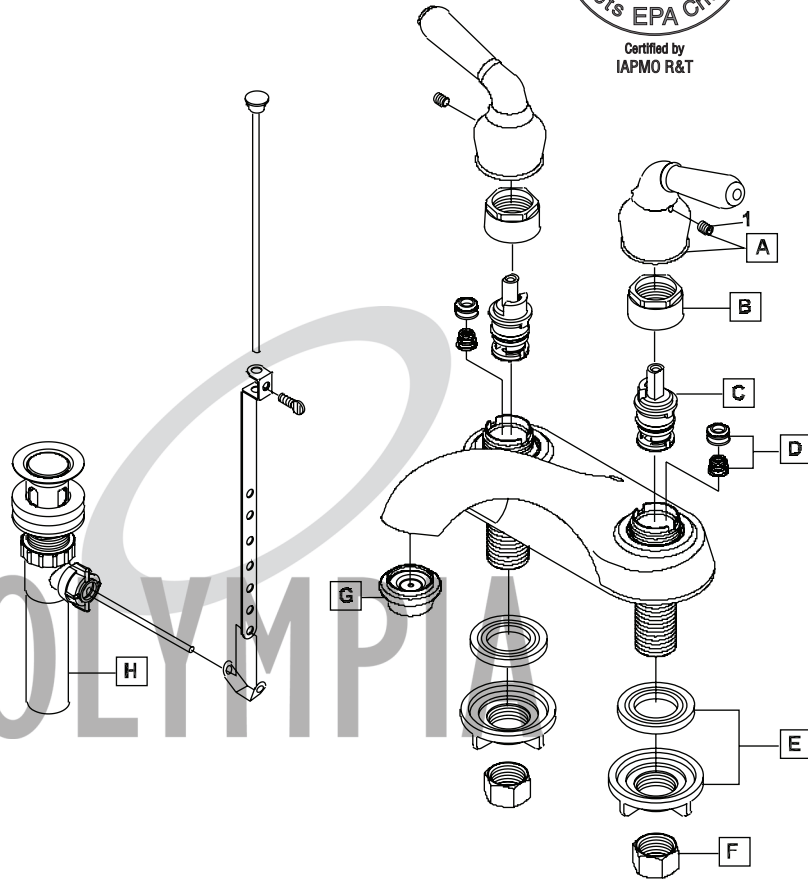

ITEM #	DESCRIPTION
A	OP-190010C,H* Lever Handle Cold, Hot
B	OP-490040 Bonnet Nut
C	OP-390004 Cartridge-Brass Post
D	OP-490041 Springs & Seat
E	OP-590003 Mounting Locknut & Washer
F	OP-590001 Supply Nut
G	OP-430007* 2.0 GPM Aerator
H	OP-630004* 50/50 Pop-Up Drain Assembly
1	OP-490029 Allen Screw

* Note- Please Specify finish/color code while ordering.