

# JACKEL™

Trusted Since 1972

## Installation Guide

### Sump Basin Cover

Model: SF22B

#### Package Contents



4 x Bolts & Washers

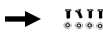

Cover

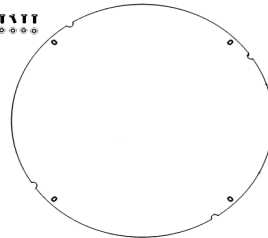

#### Tools Required



Safety Goggles



7/16" Wrench

#### Basic Installation:

If all you require is to cover up an existing sump basin; simply place the cover on top of the sump basin, align the bolt holes in the cover with the bolt holes in the basin and secure the cover to the basin with the provided bolts and washers. Do not overtighten.

#### Custom Installation:

1. If your application requires discharge and / or vent openings use a hole saw to perform the necessary cuts. On the bottom of the cover, you will find circular molded inserts that can be used as a template when making your cuts. You can also use your existing cover as a template.
2. Unplug your pump and remove / detach existing pipe(s) and the pump cord from your existing cover.
3. Attach the new cover to the sump basin using the basic installation instructions (above) and make sure that your discharge and / or vent pipe(s) are properly aligned with the hole(s) that have been cut into the cover.
4. Install your check valve and the rest of your discharge and / or vent pipes.
5. To complete the installation, the pump cord can be run through a separately cut hole in the cover or through a discharge or vent hole if necessary. Plug your pump back in.

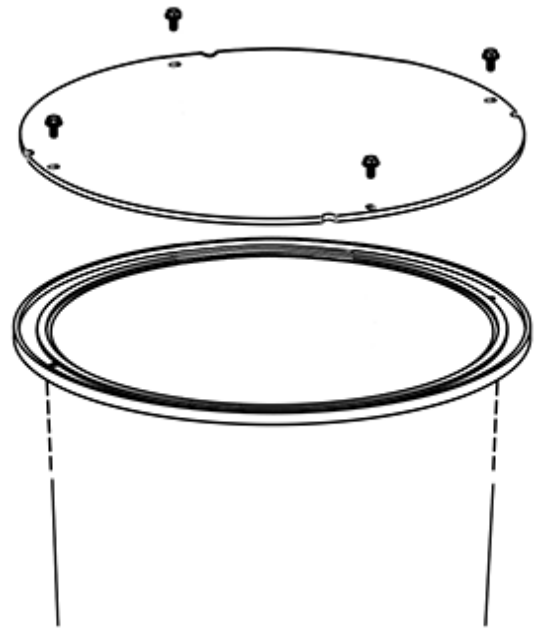

#### Safety Information:



**WARNING:** Failure to install basin cover as shown will create a safety risk. Install cover as shown.

**Warranty:** For more information please visit our website: [www.jackelinc.com/warranty](http://www.jackelinc.com/warranty)