

A few simple steps to ensure
perfect water, every time.



Everything you need to clean your cooler



citric acid crystals



mini screwdriver

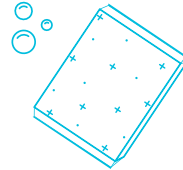

scrubbing sponge



2 disinfectant wipes



mixing stirrer



pair of nitrile gloves

These instructions are intended for Avalon water coolers. This cleaning kit may be used for other branded water coolers as well but the actual detailed instruction steps may vary depending on your machine.

Cleaning

To prolong the lifetime of the machine, it is recommended that the unit be cleaned and sanitized manually about every three to six months

To clean the outside of the unit

Use one of the included disinfectant wipes to wipe down the outside of the machine.

To remove mineral deposits that may have built up inside the cold tank, mix 4L of water with the included 200g of citric acid crystals.

1. Before cleaning, make sure that the cooling switch and heating switch are in the off (O) position and unplug the machine.



2. You will need to drain out any existing water from inside the machine. Place a large bucket beneath the drain outlet located on the back of the unit. Unscrew the drain cover using the phillips head screw driver, remove the blue plug, and allow the water to drain from the unit. Water will start flowing as soon as the drain plug is removed. Reposition the drain plug back into place before moving on to the next step.

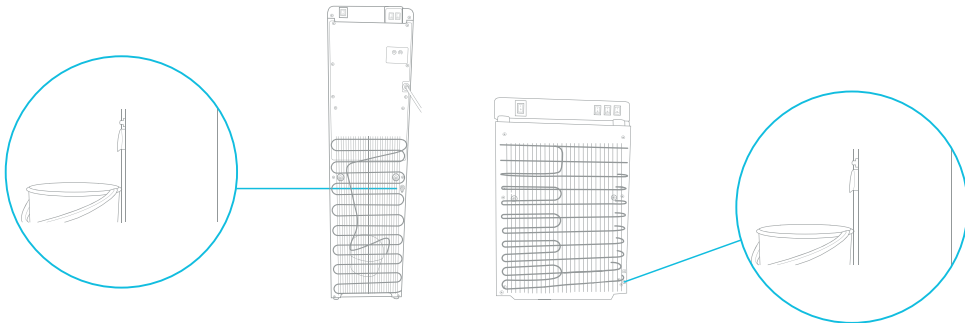

Caution: The dispenser will heat water to a temperature of approximately 185°F. It can cause severe burns if not handled carefully. Please use caution while operating and cleaning. Please allow ample time for any hot water inside the machine to cool down before draining it.

Cleaning

3. To access the cold tank for top loading models, twist off the bottle supporter.

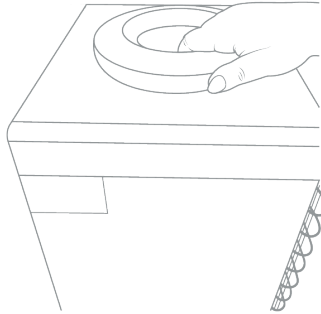

For bottom loading and bottleless models, use the included phillips head screw driver to remove the two screws located on the back (at the top, in line with the switches) of the cooler. Remove the top cover by lifting at an angle and pull off. Remove the white cold water tank cover and the separator.

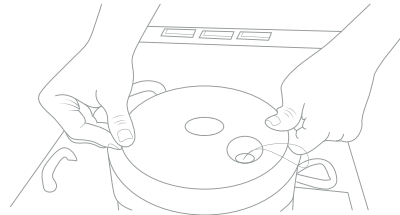
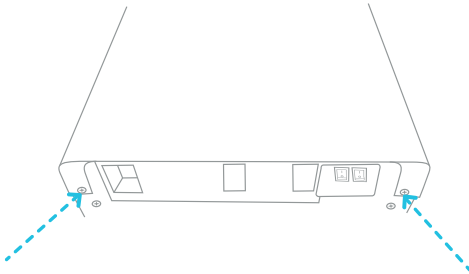

Cleaning

4. If there is any noticeable mineral buildup inside the cold tank, you can moisten the included scrubbing sponge and scrub the inside of the cold tank.

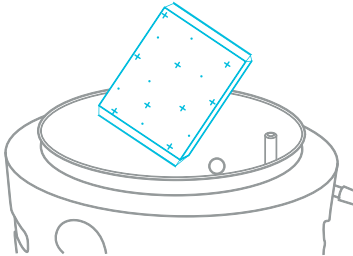

5. Put the mixture into the machine's cold tank and make sure the water can flow out of the hot water spout.

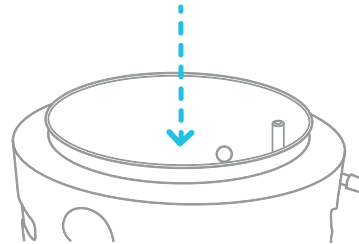

6. Plug in the power cord and turn on (I) the heating switch. Allow the water to heat for 15 minutes.

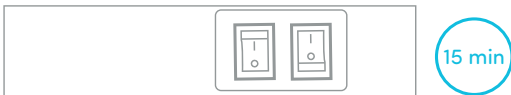

7. Turn off (O) the heating switch and allow the liquid mixture to cool down for 20 minutes.

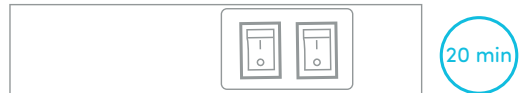

Cleaning

8. Place a large bucket beneath the drain outlet located at the back of the unit. Remove the drain cover and allow the mixture to drain from the unit. Water will start flowing as soon as the drain cover is removed.

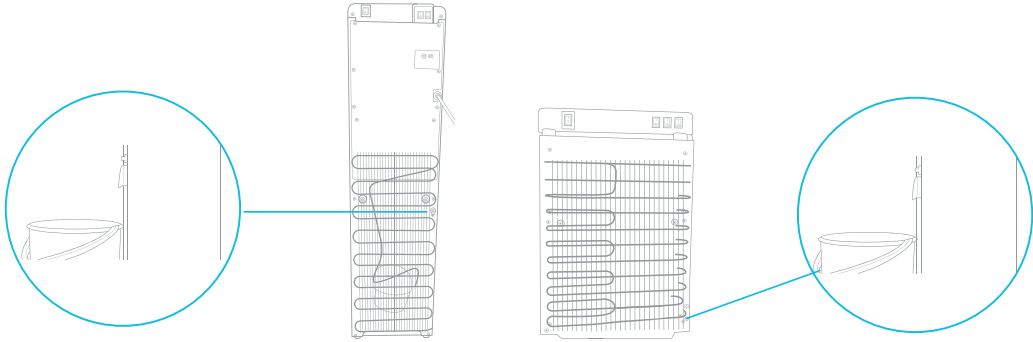

9. Now you will flush the tanks two to three times. Pour 0.6 gallons of clean water into the cold tank.

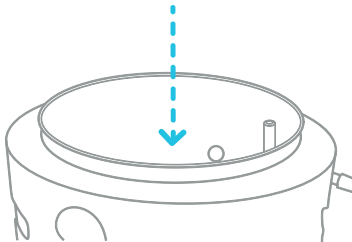

10. Allow the water to drain out of the open drain outlet on the back of the unit. Repeat one or two times.

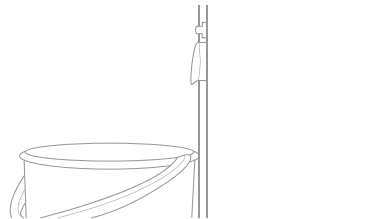

Cleaning

11. Once water is completely drained, reposition the drain cover, cold tank cover and the top cover. Ensure that the pipes and wires are connected properly and you may use the dispenser as normal.

