

RUGS 101: SIZE GUIDELINES

LIVING

DO

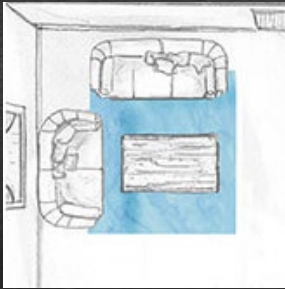

DON'T

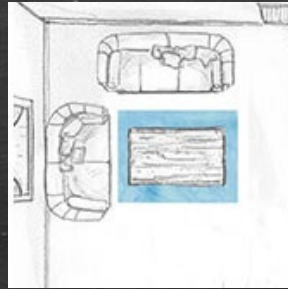

ALL KEY PIECES SHOULD SIT ON THE RUG

BEDROOM

DO

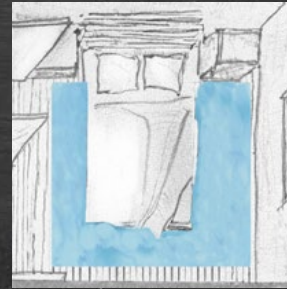

DON'T

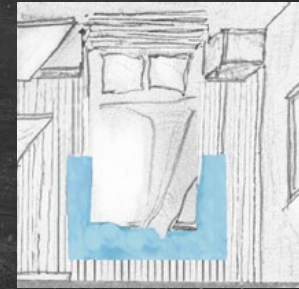

IN GENERAL BIGGER IS BETTER

DINING

DO



DON'T

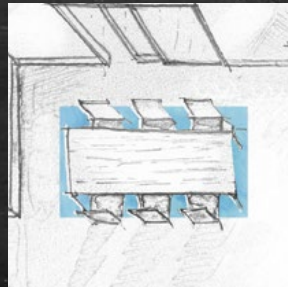

18" LARGER THAN THE TABLE
ON ALL SIDES

LAYERING



1. LARGE RUG TO FILL THE SPACE
2. SMALLER RUG FOR ADDED INTEREST