

APEX

Apex Massage Chair

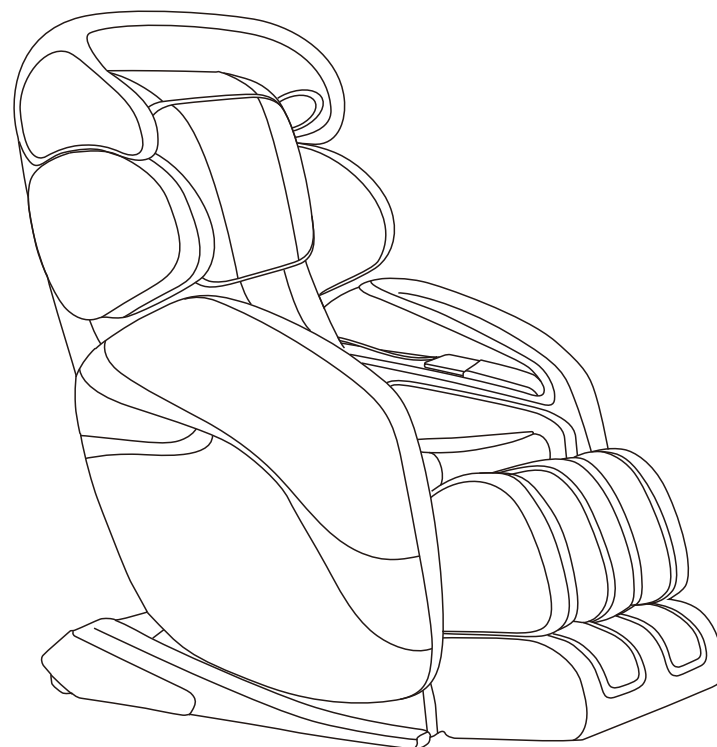

User Handbook

Apex AP-Aurora 5.0

Made In China

MAINTENANCE

CONTENTS

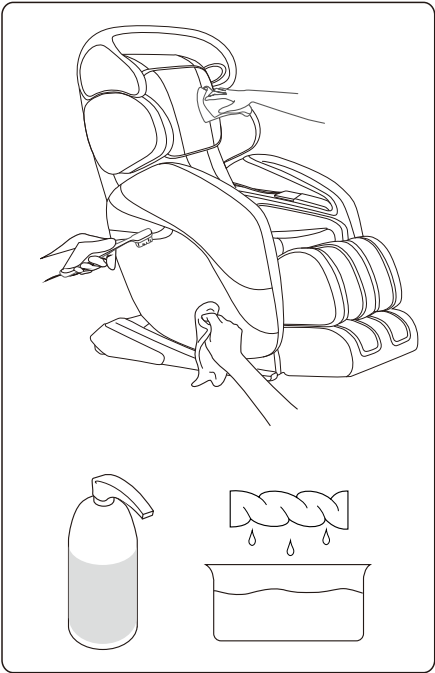

- Use dry cloth to wipe sweat and other besmirch.
- Besmirch is serious, please use neutral wash to wipe and lightly brush the massage chair.
- Please airing.
- Turn off and pull out the plug before clean the massage chair, do not touch the plug with wet hands.

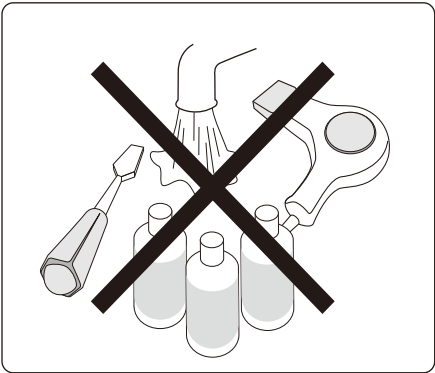

- Prohibit to use water to clean the chair.
- Do not dry the chair with roaster.
- Prohit to use alcohol, benzene wash etc.

Please read and follow all safety and operating instructions listed in this user manual prior to use. Basic precautions should always be used when operating an electrical appliance.

Safety Instructions	-----2
Product Specifications	-----4
Product Components	-----5
Chair Installation	-----7
Remote Controller	-----9
Operation Guide	-----10
Trouble Shooting	-----15
Maintenance	-----16

SAFETY INSTRUCTION

Warning

The power plug must be inserted properly to the outlet. If the connection of the Equipment-grounding conductor is not connected properly it can result in the risk of electric shock. Check with a qualified electrician or service technician, if you are in doubt as to whether the product is properly grounded. Do not modify the plug provided with the product, if the outlet is not suitable. Please make sure that the outlet is properly installed by a qualified electrician. When using the massage chair, basic precautions should always be followed to reduce the risk of electric shock, burns, fire or injury.

1. Please make sure that the power plug of massage chair is properly inserted in a proper electrical outlet.
2. Make sure the power plug is properly inserted into the proper electrical outlet to reduce the risk of short-circuit and fire.
3. Always unplug the massage chair from the electrical outlet immediately after use and before cleaning.
4. Do not use the massage chair in places where the humidity is high.
5. Do not use the massage chair outdoors and avoid place with direct sunlight.
6. If the power turns off during using make sure to switch the power OFF position and pull the power plug out from the socket to prevent damage from occurring when the power is restored.
7. Do not operate the massage chair if the power cord is wet or damaged.
8. Do not plug/unplug the power cord from the socket with wet hands.
9. Supervision is necessary when the massage chair is being used by on or near the children or disabled persons.
10. Use the massage chair only for its intended use as described in this user manual.
11. Do not stand, sit or jump in the calves rest, backrest and armrest when the massage chair is in use to prevent any injury.
12. Do not fall asleep during the massage session.
13. Always keep the massage chair clean and do not insert any object into the gaps and around the massage chair.
14. Do not move the massage chair by pulling the power supply cord.
15. Make sure that there are no person (children in particular) pet or obstacles underneath the massage chair prior to lowering the leg rest/backrest.

TROUBLE SHOOTING

If abnormal sounds or movements are observed, please power off the massage chair by turning off the main power switch, and removing the plug from the electric outlet. Please contact the customer service department for further assistance.

Problem	Solution
The massage chair is connected to power but is not functioning.	1. Check to see if plug is inserted properly, or if power outlet is functioning properly. 2. Check to see if the main power switch is in the "I" position.
The remote controller is responding, but the massage chair is not functioning.	The massage chair may have automatically shut down due to overheating protection devices. Please turn off the power and allow the chair to cool off for 30-50 minutes.
Both the remote controller and massage chair are not responding.	The massage chair automatically goes into idle mode when a massage program is completed. Please press the power button again to turn on the chair.

OPERATION GUIDE

4 After use

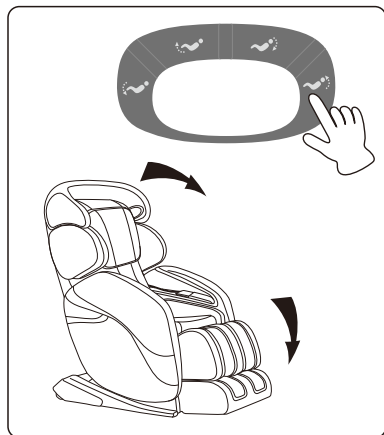

1. After the massage program is completed, return chair to upright position by pressing the Recline Angle Adjustment button.

- Please survey surrounding area prior to adjusting the recline angle, paying special attention to children or pets that may be in close proximity.
- Please make sure your arms and legs are away from gaps between the armrest, legrest, and footrest, to prevent any possible pinching or injury.

2. Press the power button to power off the massage chair and return remote controller to the storage box.

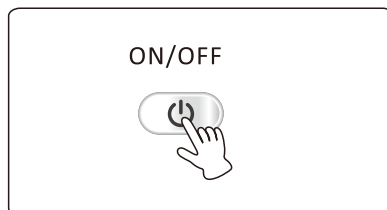

3. Turn off the main power switch.

4. Remove plug from power outlet.

* Please do not pull on the power cord to remove the plug.

* Please do not unplug with wet hands.

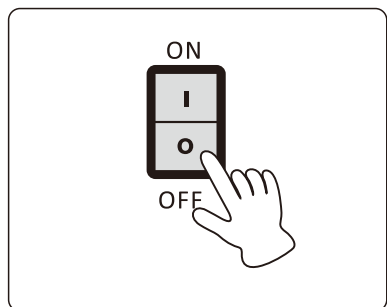

SAFETY INSTRUCTION

16. Always check whether the surface of the massage chair is torn or ripped before usage, if you find any unfamiliar rips in any area of the cloth in the backrest, do not use the massage chair, Kindly contact the service centre immediately for repairs.
17. This appliance is designed for household use only.
18. For those suffering from illnesses, please consult your doctor for advice prior to use.
19. The following persons are requested to consult a doctor prior to use in order to reduce the risk of user feeling sick or suffering from injury
 - Those who have malignant tumor
 - Those who suffer from heart disease
 - Those who are experiencing pregnancy, menstruation and puerperal fever
 - Those who require complete rest
 - Those who are under medical treatment
 - Those who suffer from back problem or whose backbone is abnormal or bent
20. If you experience pain during usage, stop using the massage chair immediately, if any injuries occur, seek medical treatment immediately.
21. Never massage the swollen or inflamed parts of the body.
22. This product is non-professional appliance designed to provide a comfortable massage. Do not use this product as substitute for medical treatment.
23. Each massage session should not exceed 30 minutes. Massage the targeted area only for 15minutes, Over-massaging can lead to overheating , thus giving the appliance a shorter lifespan.
24. Do not operate where aerosol(spray) products are used or where oxygen is being administered
25. The massage chair is not suitable for children aged 12 and below.

NOTE:

This appliance is not intended for use by persons(including children) with reduced physical sensory or mental capabilities, or lack of experience and knowledge, unless they have been given supervision or instruction concerning use of the appliance by a person responsible for their safety.

Children should be supervised to ensure that they do not play with the appliance.

If the supply cord is damaged, it must be replaced by a special cord or assembly available from the manufacturer or its service agent.

The appliance heats up during operation. persons sensitive to heat must take extra caution when using the appliance.

PRODUCT SPECIFICATIONS

Description	Specifications
Product Name	Apex Massage Chair
Model No.	Apex AP-Aurora 5.0
Rated Voltage	120V~
Rated Frequency	50/60Hz
Rated Power Consumption	230W Max.
Dimension (LxWxH)	Main Body: 1790x750x870mm
Weight	Net Weight: 94Kg Gross Weight: 108Kg

OPERATION GUIDE

3 Display Diagram

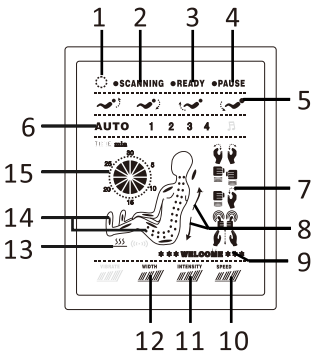

- 1. Massage chair is powered on.
- 2. Massage chair is scanning the back contour and preparing for initiation.
- 3. Scanning is complete and ready for massage programs.
- 4. Pause button has been pressed and chair is temporarily stopped.
- 5. Reclining position adjustment buttons are pressed and the backrest and /or legrest are moving.
- 6. Displays which automatic program is activated.
- 7. Displays which massage technique is activated at the time.
- 8. Depicts the direction of the massage rollers, moving upwards or downwards.
- 9. Cheerful greeting from your massage chair.
- 10. Shows the massage speed level.
- 11. Shows the air intensity level.
- 12. Shows massage roller width, from narrow to medium to wide.
- 13. Heating function is on.
- 14. Displays the location of massage rollers and active air bags.
- 15. Depicts time remaining in current massage program.

OPERATION GUIDE

- AIR

: Pressure massage position button. Each time you press this button, namely to lit the air pressure massage position on the screen. Press the button continued, there will be different parts of the combination of massage.
- AIR+

Air intensity strengthen button,press this button strengthen air massage.
- AIR-

Air intensity weaken button,press this button weaken air massage.
- HEATING

Switch on/off for heating function
- FOOT ROLLER

Roller massage for sole.
- WIDTH

Press once to adjust the width of 2 roller, Three levels is adjustable.

PRODUCT COMPONENTS

Main Body Diagram (Front)

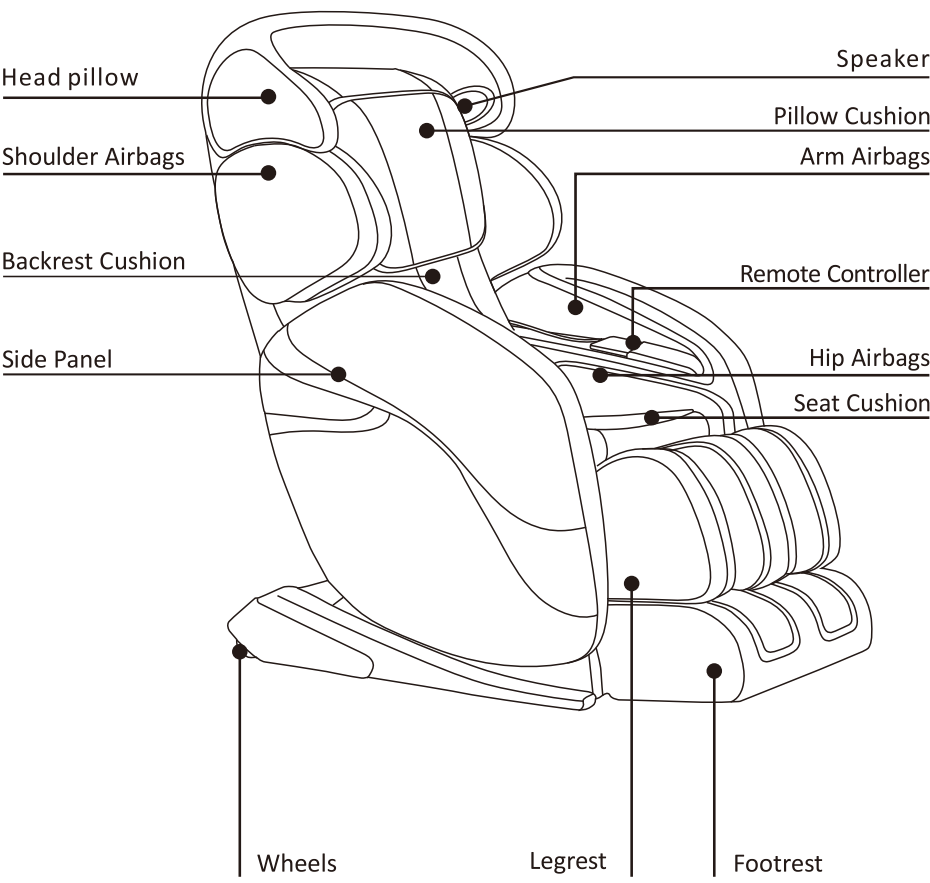

PRODUCT COMPONENTS

Main Body Diagram (Rear)

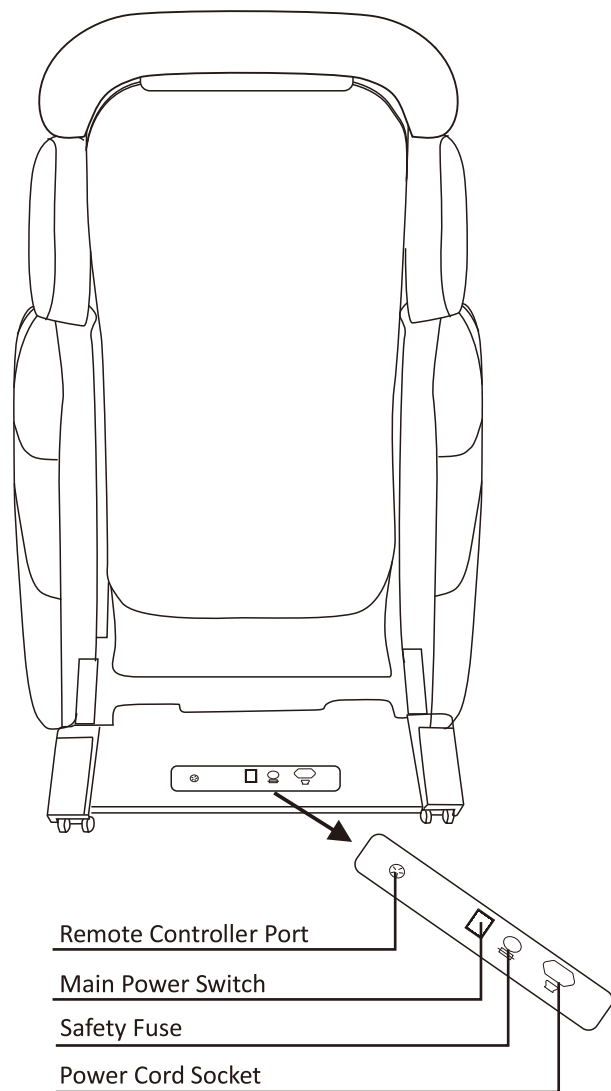

OPERATION GUIDE

Auto mode:

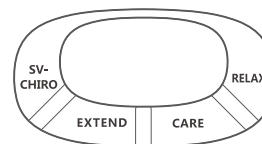

: Intelligent Automatic Programs: Press once to initiate the first of four intelligent automatic programs.
SV-CHIRO / EXTEND / CARE / RELAX

If you use it continuously, please have 10 minutes rest in order to lessen the burden to the body.



: 5-30 minutes adjustable, 5 minutes as a adjustable unit, default working time: 15 minutes .

Manual mode



Press once to activate the Kneading function, and press again to stop the function.



Press once to activate the Tapping function, and press again to stop the function.



Press once to activate the Rolling function, and press again to stop the function.



Speed: Tapping & Kneading Speed adjustment (3 levels)



Roller Location Adjustment: Hold the up or down arrow to move the massage rollers to the desired location.



“Fixed Spot Massage” Press to stop the rollers at a particular area for a fixed point focal massage in manual mode.



“Area Adjustment Button” In manual mode, press to select between specific areas in the following order:

Back -> Waist -> Seat -> Back & Waist -> Waist & Seat -> The whole body

OPERATION GUIDE

2 Function description of Controller buttons.



: Start or Stop massage chair

Press this button, massage chair will be ON, screen will be ON, User can choose auto or manual function to massage.

Press this button again, massage chair will be off, massage stopped, massage chair will come back to the original position, all buttons are inactive. When the chair returns to the original position the chair will completely shut off.



: Press to temporarily pause the massage, chair will enter idle mode. Press again to resume massage.



: Press the button first, massage back and leg position to zero G1, press second, the position to zero G2, press third, the position to zero G3, press fourth, massage chair return to original position.

Zero G1 -> Zero G2 -> Zero G3 -> Original Position

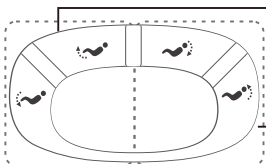

: Press the button and hold on to adjust the footrest independently.

: Press the button and hold on to adjust the massaging position of backrest or legrest.

PS: The position adjustment button have no function when the chair in the stretch programme

CHAIR INSTALLATION

1. Remove the package and get out the spare parts

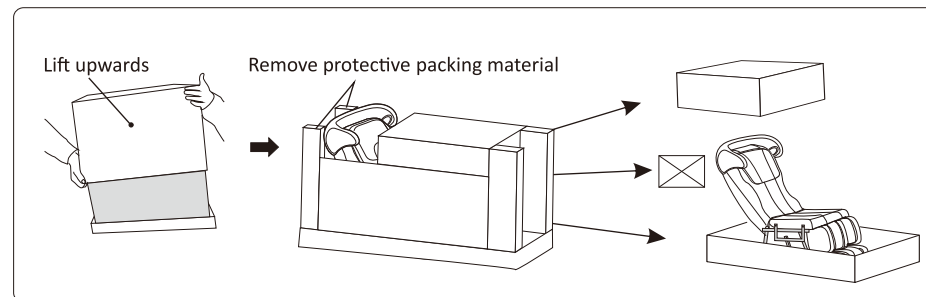

- 1) Remove the carton.
- 2) Take out the packing material.
- 3) The spare parts include: user manual, power cord.

2. Install the side board

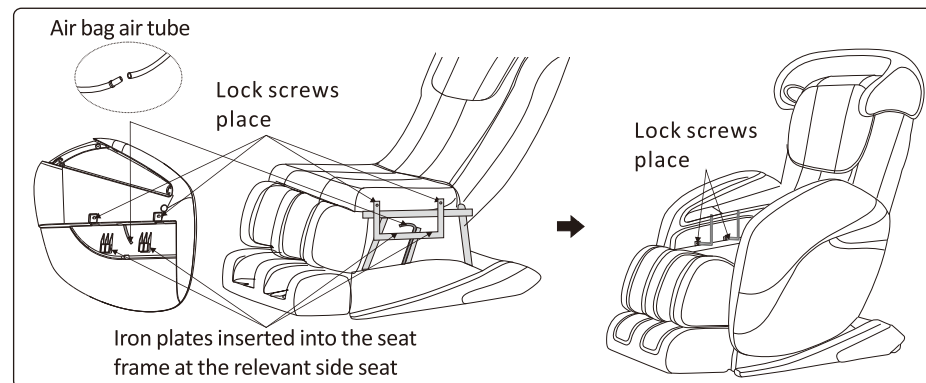

- 1) Remove the board from the cartoon and take out the sideboard.
- 2) Connecting the side plate trachea with the saddle lateral tracheal the both sides trachea must to insert the end in order to prevent air leakage.
- 3) Aligning the side plate hole and the massage chair hole, then inserted the plate into the corresponding side mount, use the screw driver lock-in screw fixed. The other side completed according to the above mentioned.
- 4) After install the side board, please smooth the chair.

CHAIR INSTALLATION

3. Install the shoulder airbag

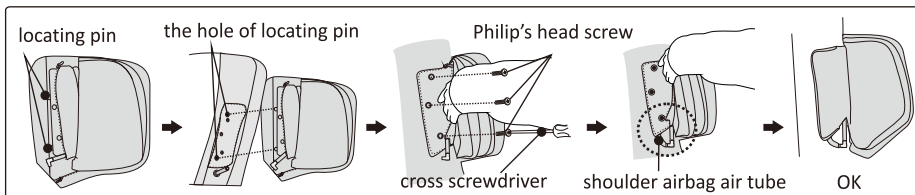

- 1) find the 2 locating pin and screw holes.
 - 2) Using the locating pin insert into the chair backrest, then a cross screw driver to fix the philip's head screw.
 - 3) Connect the tube with tube connector on the chair.
 - 4) Zip up the opening after check each parts are secured.
 - 5) Another side will follow the same steps.
4. Double check the installation steps, smooth out any creases in the cushions.
 5. Place the massage chair in an open area

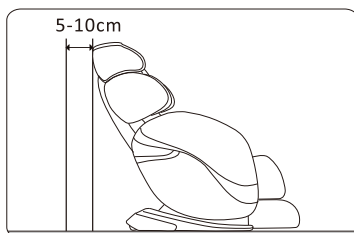

- Allow sufficient space around the chair for recline purposes.
- 5-10cm distance for the back side and 50cm in front of the footrest.

6. Moving the massage chair.

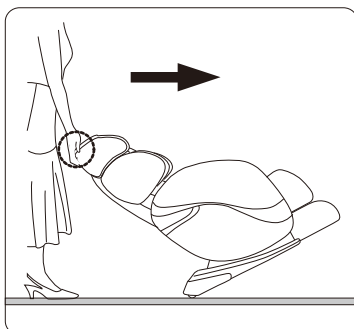

1. As illustrated, push the backrest downwards and tilt chair on to its wheels at a 45° angle. Slowly push and maneuver the massage chair to desired location. Lower massage chair slowly and smoothly until it is fully flat on the ground.

CAUTION:

- *Do not move massage chair when occupied or in use.
- *Moving the massage chair may cause damage to the floors. Floor protection is recommended (e.g. rugs or carpet).
- *Do not drop or suddenly let go of the chair when moving as it may damage the chair.
- *Two persons are recommended when moving and extra care when handling the massage chair.

REMOTE CONTROLLER

1 Remote Controller

