

PowerCare[™]

10Cu.Ft. DUMP CART

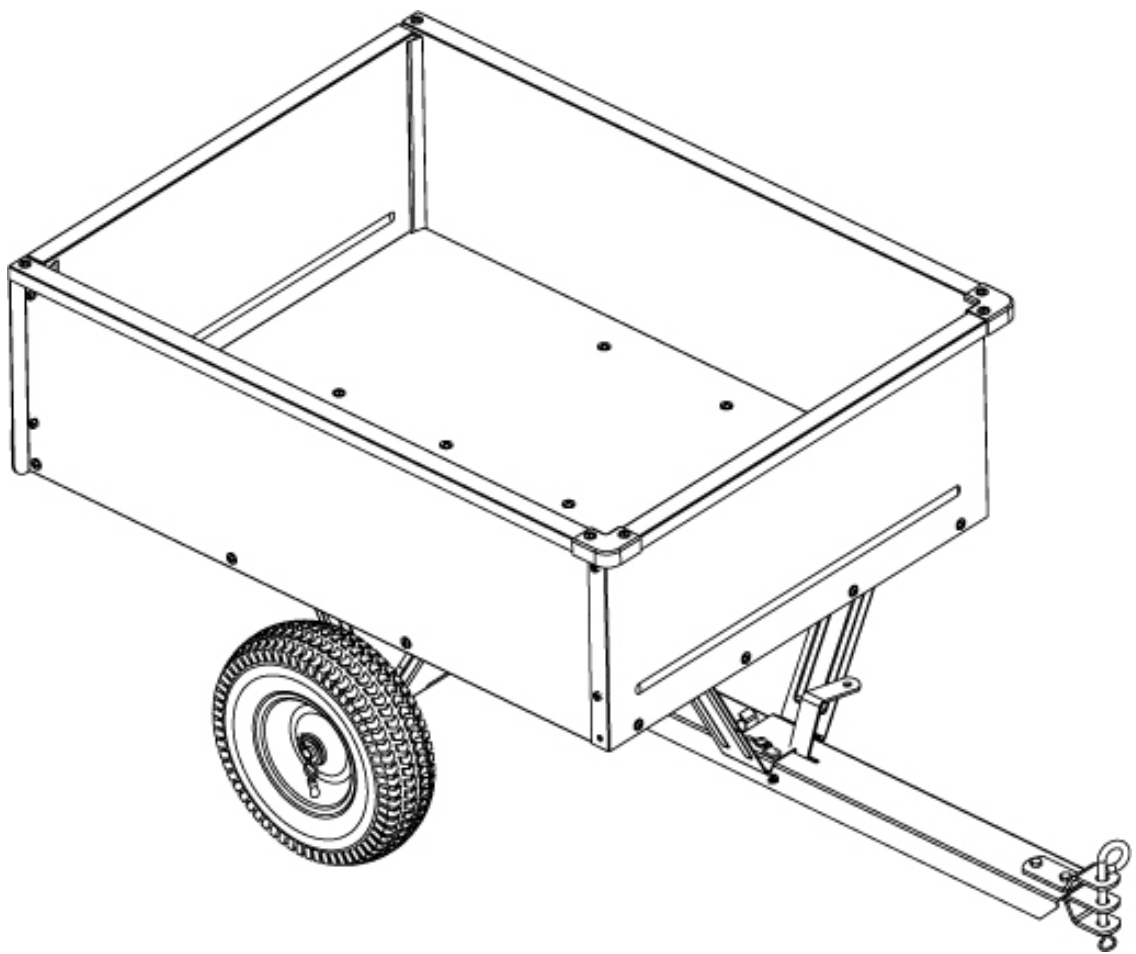

Instruction & Assembly

SAVE THESE INSTRUCTIONS FOR FUTURE REFERENCE

Table of Contents

General Warnings and Rules	3
Hazard Signal Word Definition	4
Controls and Features Identification.....	5
Component & Hardware.....	6, 7
Assembly Instructions	8, 9 10, 11, 12, 13
Operation Instructions	13
Maintenance and Storage	14
Specification	15
Parts Drawing & Parts List.....	16, 17
Limited Warranty	18

GENERAL WARNINGS

READ and UNDERSTAND this manual completely before using Utility Dump Cart.

Operator must read and understand all safety and warning information, operating instructions, maintenance and storage instructions before operating this equipment. Failure to properly operate and maintain the utility dump cart could result in serious injury to the operator or bystanders.

Operation Warnings

- Do not at any time carry passengers sit or stand on the cart.
- Do not allow children to play on, stand upon or climb in the cart.
- Always inspect the cart before using to assure it is in good working condition.
- Replace or repair damaged or worn parts immediately.
- Always check and tighten hardware and assembled parts before operation.
- Do not exceed equipment maximum load capacity of 400lb.
- Avoid large holes and ditches when transporting loads.
- Be careful when operating on steep grades (hill) the cart may tip over.
- Always operate at reduce speed in rough terrain, along creeks, ditches and on hillsides.
- Do not operate close to creeks, ditches and public highways.
- To avoid personal injury and/or equipment damage **DO NOT EXCEED 10MPH.**
- Always use caution when loading and unloading the cart.
- Only tow with recommended vehicles (Lawn/Garden Tractors and ATVs).
- Always secure and lock dump cart to the vehicle hitch before operating.

Crush and Cut Hazards

- Always keep hands and feet clear from moving parts while operating the equipment.
- Always clear and keep work area clean when operating.
- Always wear safety gear, eye protection, gloves and work boots when operating the dump cart.

WARNING

The warnings, cautions, and instructions outlined in this instruction manual cannot cover all possible conditions or situations that may occur. It must be understood by the operator that common sense and caution are factors which cannot be built into this product and must be supplied by the operator.





PROP 65 WARNING

This product can expose you to chemicals including lead and lead compounds which are known to the State of California to cause cancer and birth defects or other reproductive harm. For more information, go to www.P65Warnings.ca.gov

Assembly Is Required

This product requires assembly before use. See "Assembly" section for instructions. Because of the weight and/or size of the utility dump cart, it is recommended that another adult be present to assist with the assembly. **INSPECT ALL COMPONENTS** closely upon receipt to make sure no components are missing or damaged.

Hazard Signal Word Definitions

	<p>This is the safety alert symbol. It is used to alert you to potential personal injury hazards. Obey all safety messages that follow this symbol to avoid possible injury or death.</p>
	<p>DANGER indicates an imminently hazardous situation which, if not avoided, will result in death or serious injury.</p>
	<p>WARNING indicates a potentially hazardous situation which, if not avoided, could result in death or serious injury.</p>
	<p>CAUTION indicates a potentially hazardous situation which, if not avoided, may result in minor or moderate injury.</p>
	<p>CAUTION used without the safety alert symbol indicates a potentially hazardous situation which, if not avoided, may result in property damage.</p>

ABOUT YOUR UTILITY DUMP CART

This utility dump cart has a rugged steel construction and is designed to carry a wide range of materials. The dump cart will easily haul up to 400lbs of tools, firewood, animal feed, trash, landscaping materials, cement or anything else that needs to be moved. Easy to use removable tailgate makes loading and un-loading fast and convenient. Never exceed the rated load capacity of 400lbs when operating the utility dump cart.

Technical specifications on the utility dump cart are provided in the "Specifications" section of this manual.

Controls and Features Identification

Read this owner's manual before operating the equipment. Familiarize yourself with the location and function of the controls and features. Save this manual for future reference.

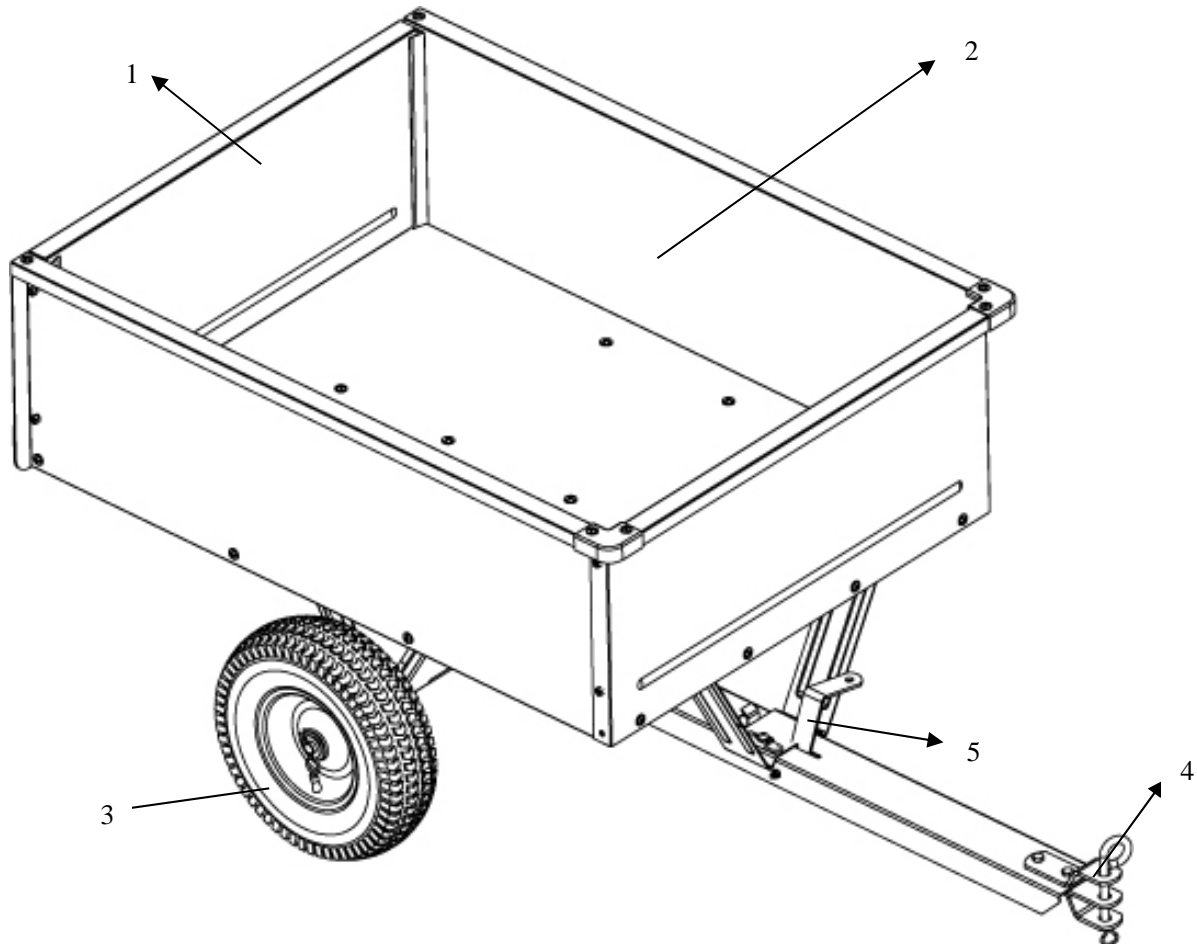

- 1) **Removable Tailgate** – Push up to remove for loading or unloading.
- 2) **Utility Cart Box** – Do not exceed rated load capacity 400lb.
- 3) **Tires / Wheel** – Do not exceed the recommended rate 25 PSI.
- 4) **Hitch** – Pin-type design use only with approve vehicles.
- 5) **Release Pedal** – Release the cart bed.



CAUTION

Read and follow all instructions for assembly and operation. Failure to properly assemble this equipment could result in serious injury to the user or bystanders, or cause equipment damage.

UTILITY DUMP CART COMPONENT PARTS AND ASSEMBLY

Take all parts out of the shipping crate and inspect components to ensure there are no missing pieces before starting to assemble the utility dump cart follow steps 1 through 11.

TOOLS REQUIRED

- Pliers
- Screw Driver
- 10mm & 14mm Wrench

Component Parts

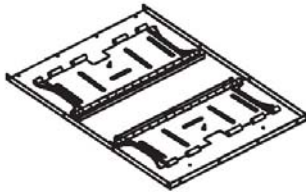

Bottom Panel Assembly
1pc

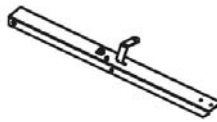

Hitch Tongue Assembly
1pc

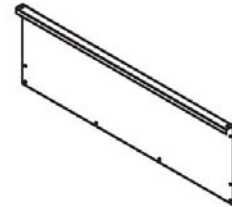

(#2) Side Panel
2pcs



(#6) Rear Card
Slot
2pcs

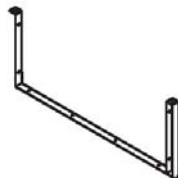

(#7) U-Frame
1pc



(#8) Connecting
Plate
1pc

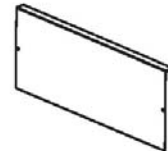

(#9) Rear Panel
1pc



(#15) Wheel
2pcs



(#17) Wheel Axle
1pc



(#23) Hitch Pin
Bracket
2pcs



(#27) Tongue Support
1pc

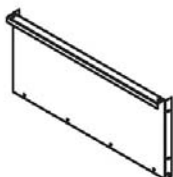

(#28) Front Panel
1pc



(#29) Corner Plate
2pcs

Component Parts



(#3)



(#4)



(#5)



(#12)



(#13)

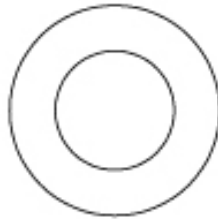

(#14)

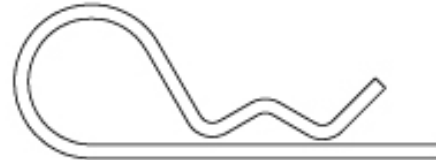

(#16)

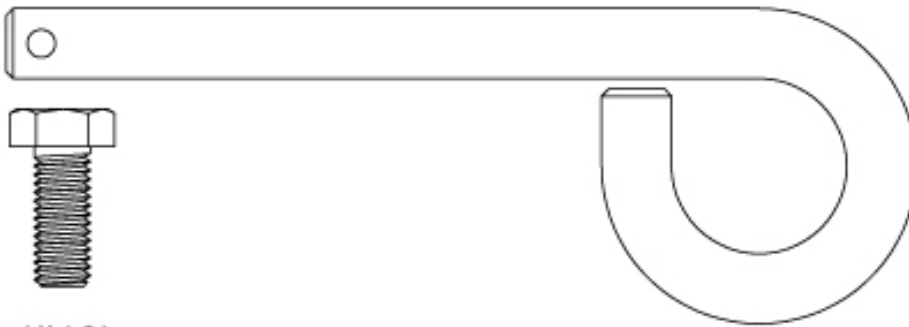

(#18)

(#24)

Ref#	Description	Qty
3	M6x16 Screw	34
4	Ø6 Lock Washer	34
5	M6 Hex Nut	34
12	Ø8 Lock Washer	2
13	M8 Hex Nut	2
14	Ø16 Flat Washer	4
16	Ø3 R Pin	4
18	M8x30 Hex Bolt	2
24	Hitch Pin	1

Assembly Instructions

STEP 1: Attach the Axle Support

1. Lay down the bottom panel assembly on a flat surface, remove the two M6 wing nuts (#33) on the wheel axle supports to release wheel axle supports, wing nuts need to be reinstalled after releasing wheel axle support.

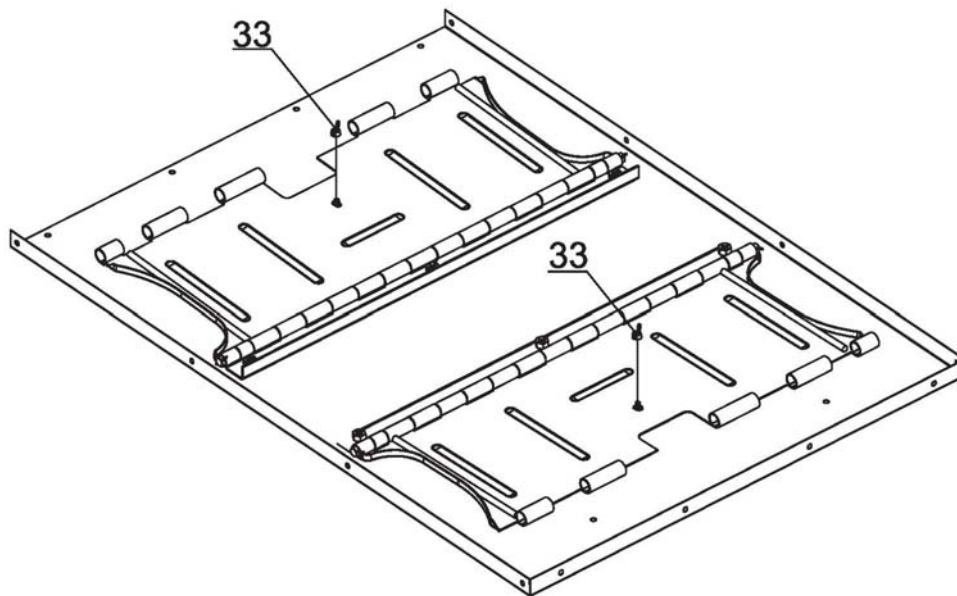

STEP 2: Attach Tongue Support

1. Turn up the wheel axle support and reinstall the M6 wing nuts (#33). Attach the tongue support (#27) to the back of the bottom panel, pay attention to the orientation of the hole on tongue support, hole should be oriented as shown below. Install four sets of M6x16 screws (#3), Ø6 lock washers (#4) and M6 hex nuts (#5), tighten all hardware when cart is turned upright.

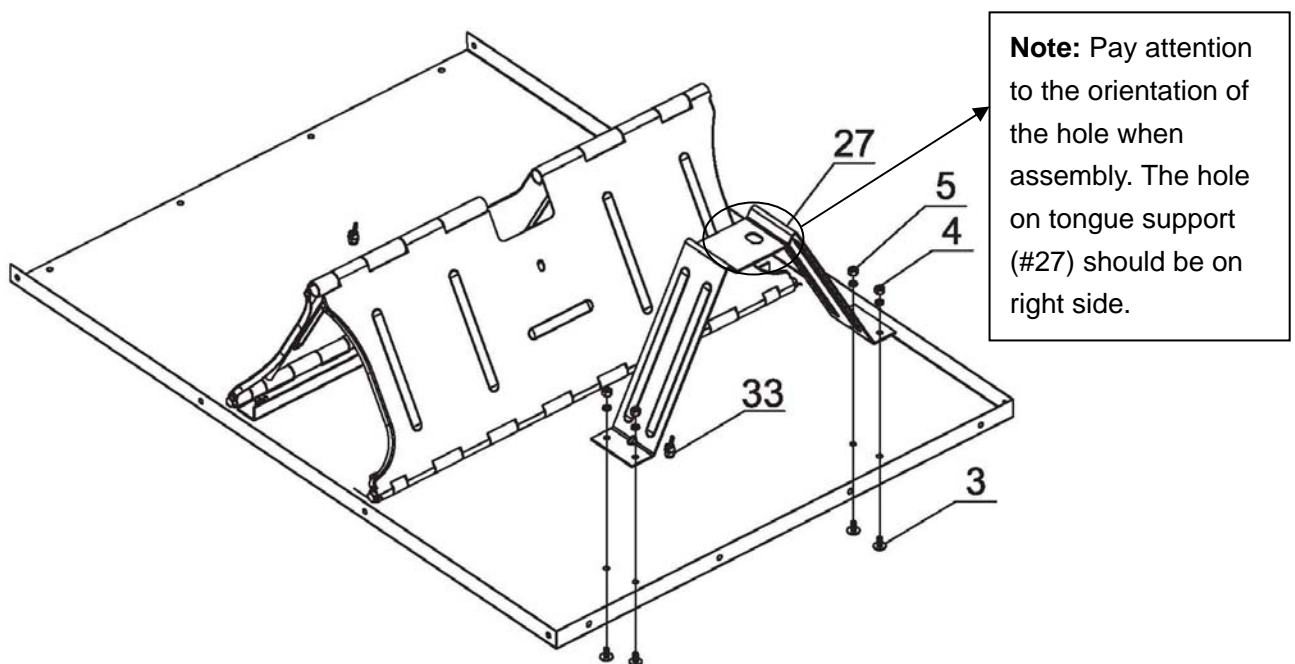

STEP 3: Attach the Hitch Tongue Assembly

1. Line up protrusion on tongue with hole on tongue support, slightly pull the foot pedal (#4) back into a released position and lock while protrusion stick in place, see DETAIL A. Insert axle (#17) into wheel axle support and tongue.

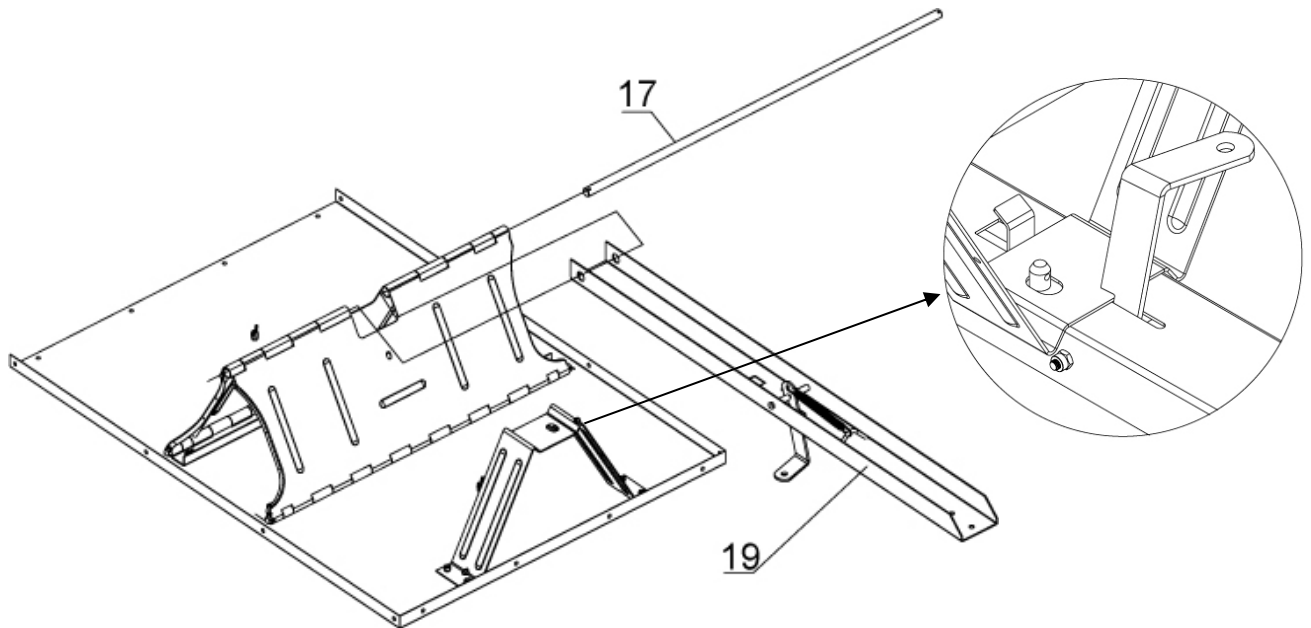

STEP 4: Attach the Wheels

1. Add one Ø16 flat washer (#14) on one side of axle, put the wheel (#15) on ensuring the nipple is outward as shown below, and then put on another Ø16 flat washer (#14), lock by Ø3 R pin (#16). Repeat on the other wheel.

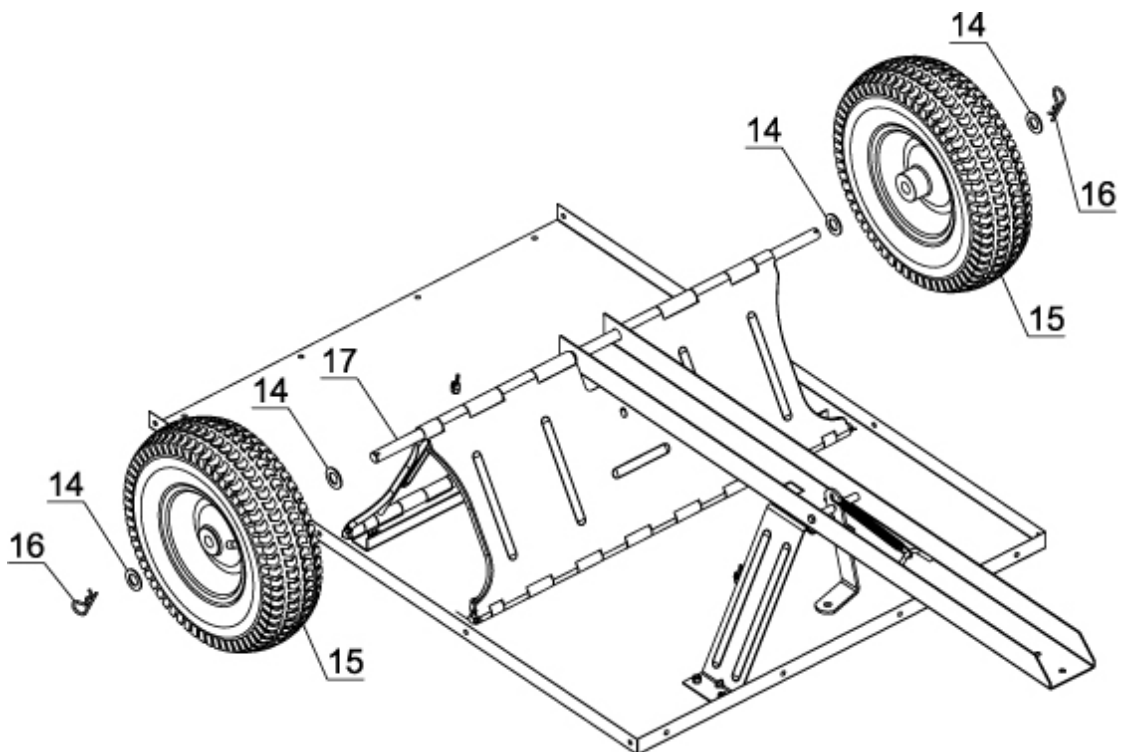

STEP 5: Attach Hitch Pin Bracket

1. Attach two hitch pin brackets (#23) and connecting plate (#8) to the hitch tongue (#19) using two sets of M8x30 hex bolts (#18), Ø8 lock washers (#12) and M8 hex nuts (#13). Insert the hitch pin (#24) through the tongue hole and secure with Ø3 R pin (#16).

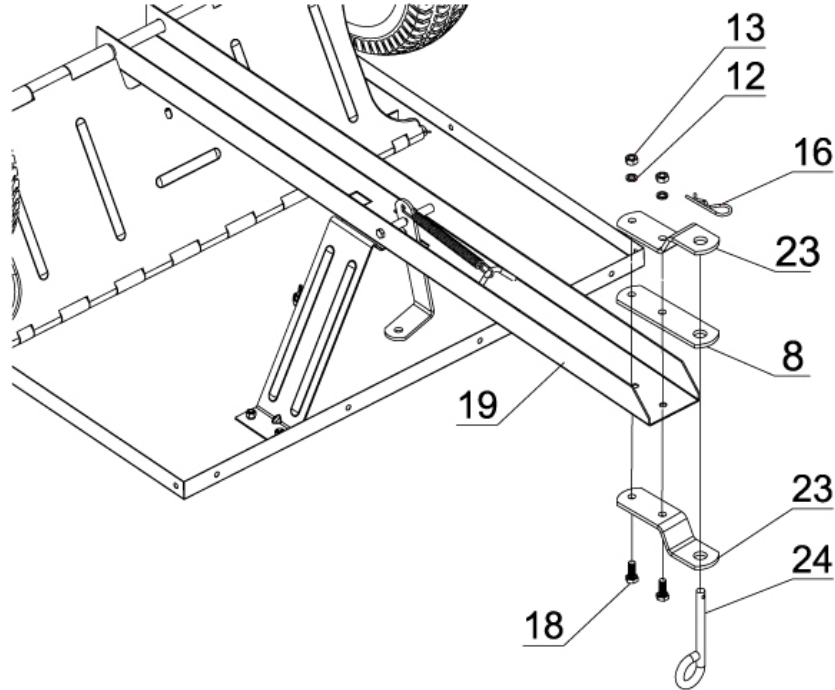

STEP 6: Attach Side Panel

1. Attach the side panel (#2) to the bottom panel (#1) using three sets of M6x16 screws (#3), Ø6 lock washers (#4) and M6 hex nuts (#5). Repeat on the other side panel.

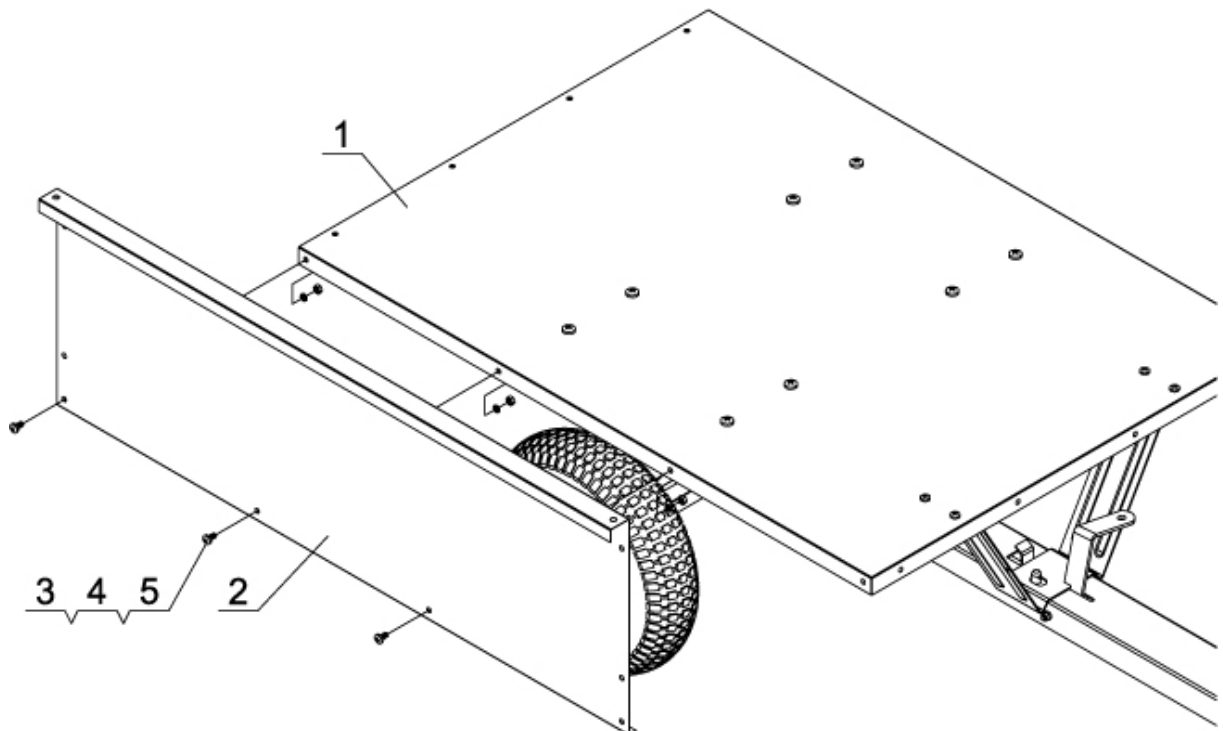

STEP 7: Attach the Front Panel

1. Attach the front panel (#28) to the bottom panel using four sets of M6x16 screws (#3), Ø6 lock washers (#4) and M6 hex nuts (#5).
2. Attach the front panel (#28) to the side panels using six sets of M6x16 screws (#3), Ø6 lock washers (#4) and M6 hex nuts (#5).

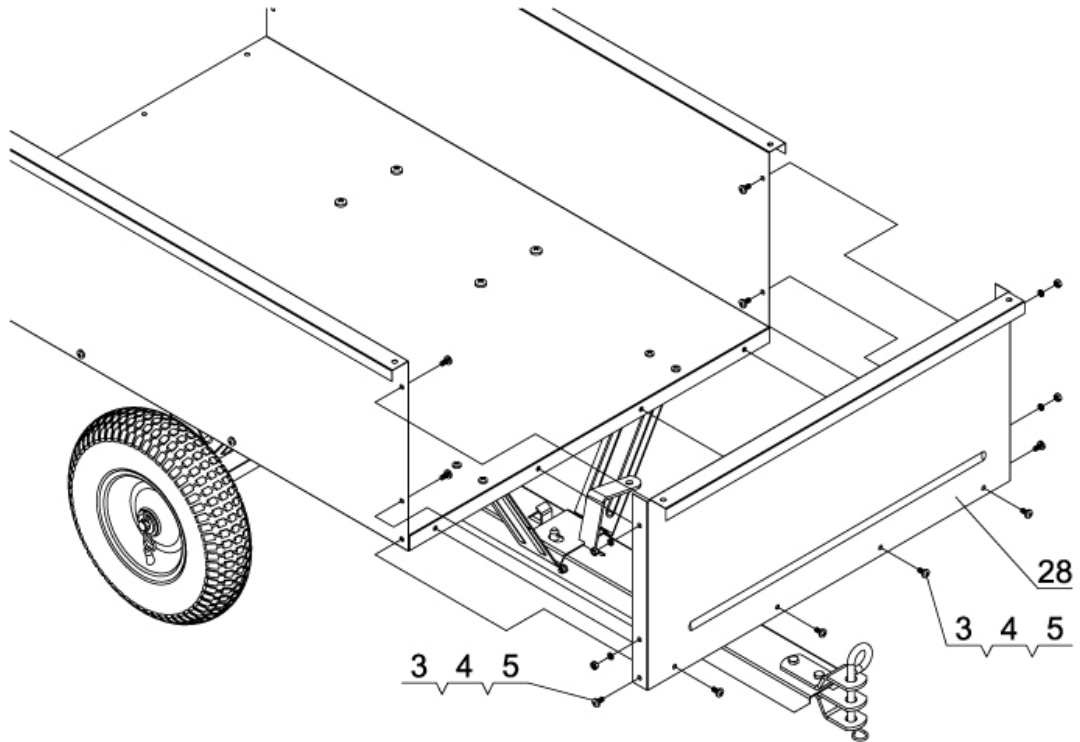

STEP 8: Attach the Corner Plate

1. Attach the two corner plates (#29) to the side panels and front panel using four sets of M6x16 screws (#3), Ø6 lock washers (#4) and M6 hex nuts (#5).

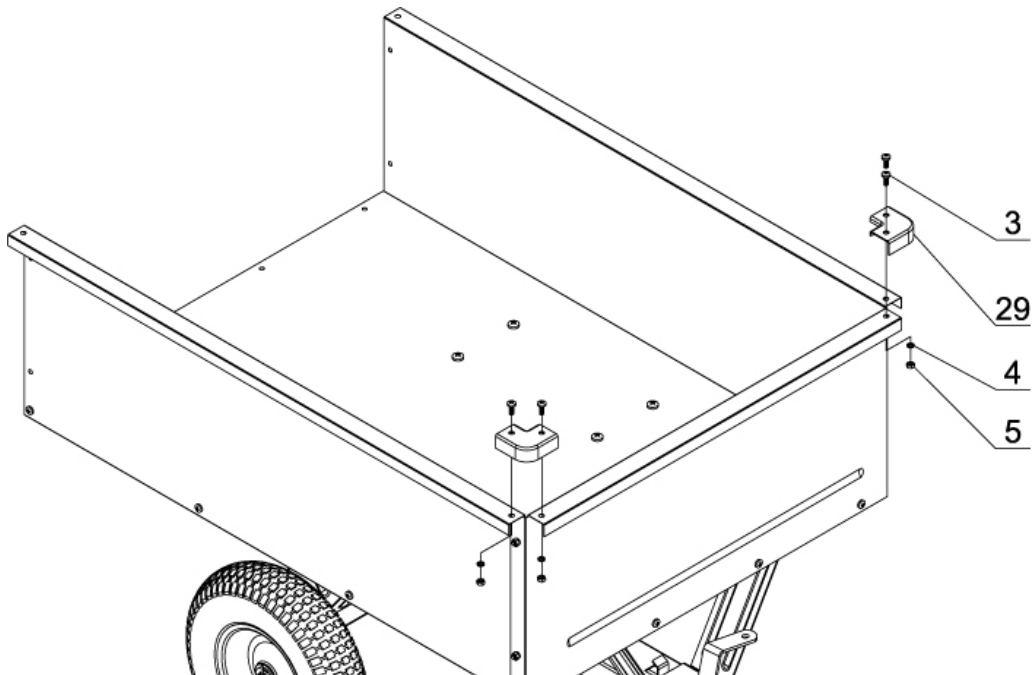

STEP 9: Attach the U-frame

1. Attach the U-frame (#7) to the bottom panel and side panels using six sets of M6x16 screws (#3), Ø6 lock washers (#4) and M6 hex nuts (#5).
2. Attach the two rear card slots (#6) to the U-frame (#7) and both side panels using four sets of M6x16 screws (#3), Ø6 lock washers (#4) and M6 hex nuts (#5).

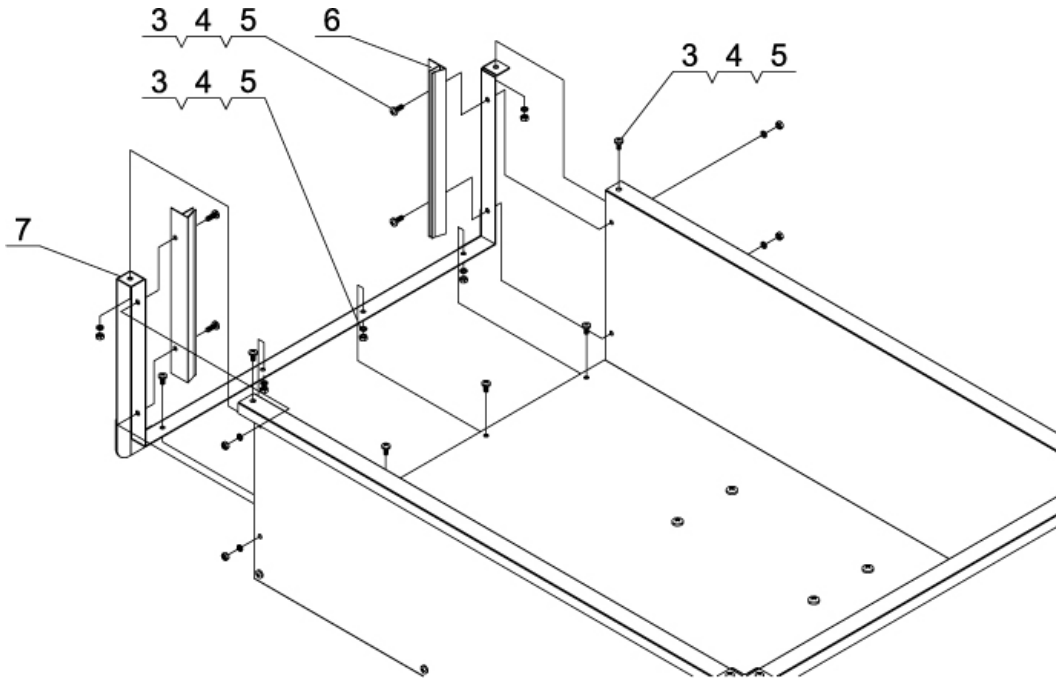

STEP 10: Attach the Rear Panel

1. Slide the rear panel (#9) through the rear card slots on the back side panels.

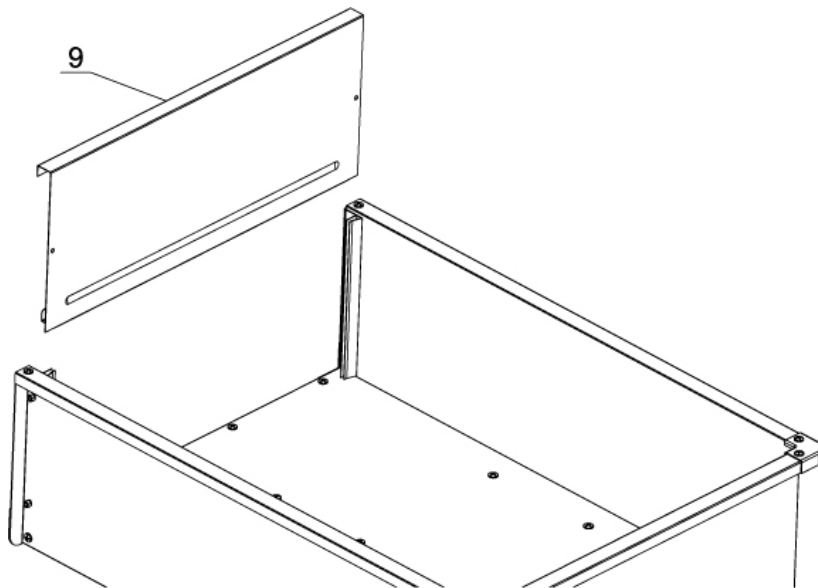

STEP 11: Attach the Card Slot and Lock Support Tube

1. Insert the Ø3 R Pin (#16) into the safety pin on the hitch tongue.
2. Pull out the Ø3 R Pin (#16) before emptying the bed and then press the release pedal.

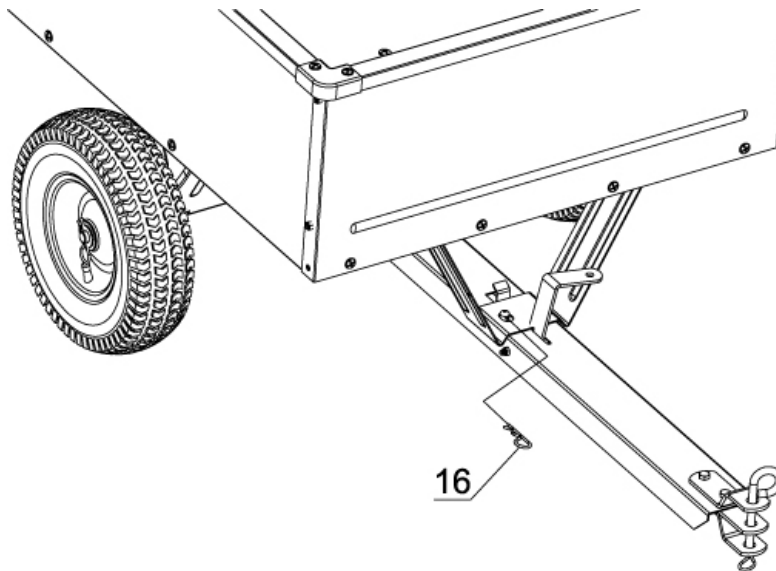

Operation Instructions

WARNING

Before using the utility dump cart, review the instructions below and safety information. Failure to follow these instructions may result in property damage or injury to the operator or bystanders.

USING YOUR UTILITY DUMP CART

1. **DO NOT** exceed rated capacity of 400lb (182kg).
2. **ALWAYS** secure and lock the utility cart to the vehicle hitch before operating.
3. **ONLY** use approved vehicles when towing the dump cart (Lawn/Garden Tractors and ATVs)
4. **NEVER** tow the utility dump cart with box raised.
5. **DO NOT** over fill the utility dump cart. Over flow loads can cause the cart and towing vehicle to lose traction and skid out of control.
6. **ONLY** fill the dump cart to a comfortable dumping load. Extremely heavy loads will be difficult to operate and dump.
7. **ALWAYS** use the dump cart for its intended purpose.
8. **ALWAYS** make sure that the tow vehicle and the combined weight of the operator **MUST BE** greater than the load of the cart weight for proper control.
9. **DO NOT** use cart on public highways or roads.
10. **NEVER** exceed 10mph when towing the dump cart.
11. **DO NOT** make sharp turns that may cause the Lawn/Garden Tractor or ATV tires to rub against the utility dump cart.
12. **ALWAYS** slow down before turning.
13. **ALWAYS** use caution when backing the utility cart. To avoid the cart from “jack-knifing” always back up in a straight line.

Maintenance and Storage



WARNING

Improper maintenance and storage of the utility dump cart may void your warranty.

MAINTENANCE

- After each use clean material out of the cart box.
- Rinse/dry inside and outside of the dump cart after each use.
- Before operating make sure the tires have the RECOMMENDED TIRE PRESSURE 25 PSI.
- Regularly grease the axle and the wheel bearing area or when needed.
- Periodically check all fasteners for tightness.
- Annually clean and lightly lubricate parts.
- Use a glossy enamel spray paint to touch up scratched or worn painted metal surfaces.
- Never exceed load capacity rating of 400lb (182kg) it will damage the utility dump cart.

IMPORTANT:

If a part needs replacement, only use parts that meet the manufacturer's specifications. Replacement parts that do not meet specifications may result in a safety hazard or poor operation.

STORAGE

- Never allow material to remain in the utility dump cart for extended periods of time.
- Before storing make sure the cart is clean and dry for years of trouble free service.
- Store indoors or protected area during severe weather and winter months.
- When storing outside always keep the tongue a little higher than the back of the cart to allow the moisture to easily run out the back and will not accumulate in the box.

Specifications

Load Capacity	400lb
Box and Frame Material	Steel
Cart Box Size	40.5" x 30.7" x 13"
Overall Size	58" x 31.3" x 26.8"
Axle Dimensions.....	0.63" x30.47"
Wheel Size	13" (4.00-6)
Wheel Type	Pneumatic
Hitch Type	Pin Style
Tire Pressure (PSI).....	25

Parts Drawing & Parts List

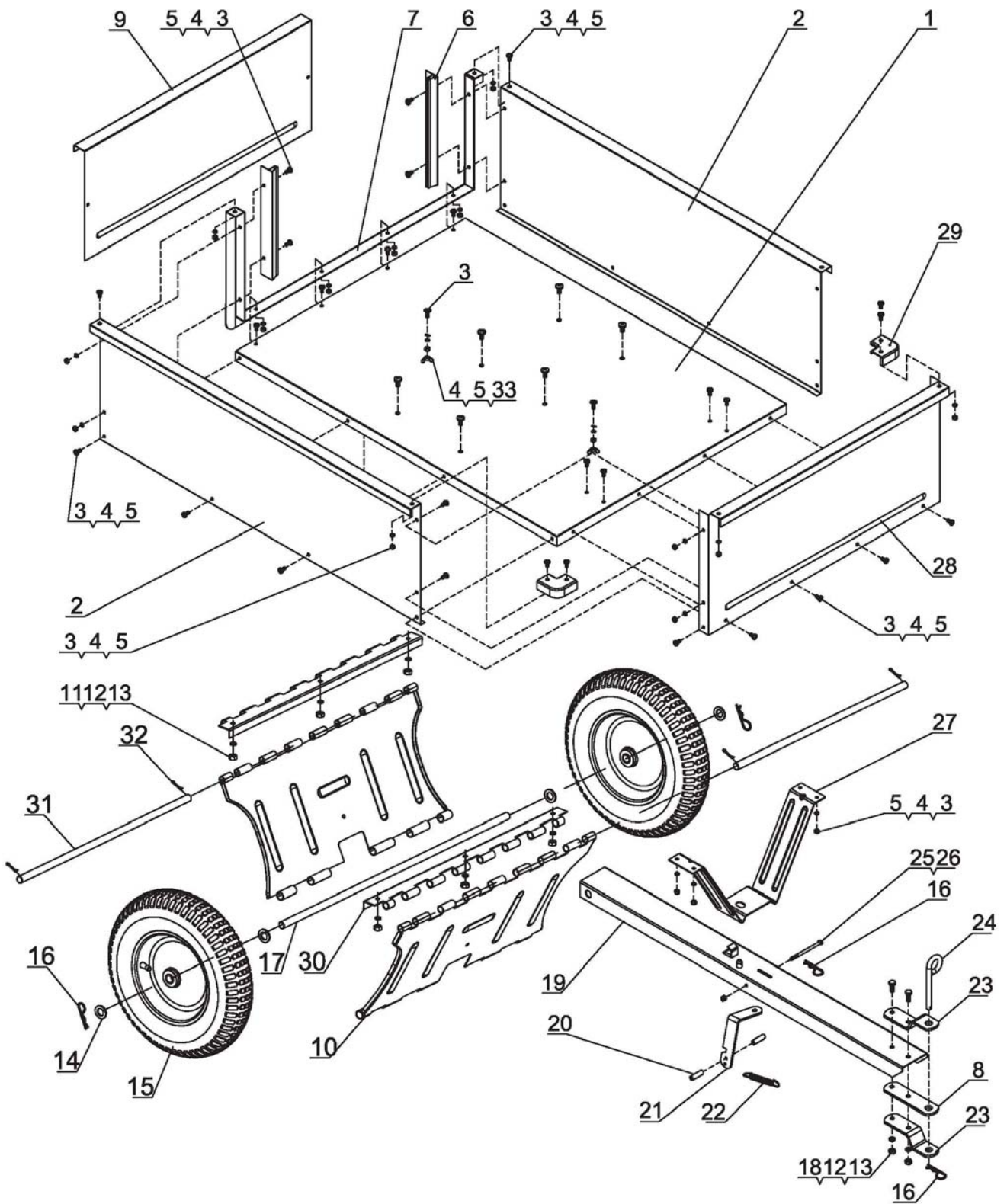

Parts Drawing & Parts List

Ref#	Drawing No.	Description	Qty
1	DC4002-00001	Bottom Panel	1
2	DC400-00002	Side Panel	2
3	9199-06016-DX	M6x16 Screw	36
4	9306-06000-DX	Ø6 Lock Washer	36
5	9201-06000-DX	M6 ex Nut	36
6	DC400-00009	Rear Card Slot	2
7	DC400A-20000	U-Frame	1
8	DC400A-00004	Connecting Plate	1
9	DC4002-00003	Rear Panel	1
10	DC400-07000	Axle Support	2
11	9199-08016-DX	M8x16 Screw	6
12	9306-08000-DX	Ø8 Lock Washer	8
13	9201-08000-DX	M8 Hex Nut	8
14	9301-16000-DX	Ø16 Flat Washer	4
15	DC400-30000	Wheel	2
16	N021-00004	Ø3 R Pin	4
17	DC400A-00008	Wheel Axle	1
18	9101-08030-DX	M8x30 Hex Bolt	2
19	DC400A-10000	Hitch Tongue	1
20	N390-00005	Spacer	2
21	N879-00002	Release Pedal	1
22	N390-00003	Latch Spring	1
23	N390-00002	Hitch Pin Bracket	2
24	N180-00013	Hitch Pin	1
25	9101-06090-DX	M6x90 Hex Bolt	1
26	9206-06000-DX	M6 Hex Lock Nut	1
27	DC400-00007	Tongue Support	1
28	DC4002-00002	Front Panel	1
29	DC400-00003	Corner Plate	2
30	DC0400-00001	Axle Support Connecting Plate	2
31	DC0400-00002-DY	Axle Support Hinge Pin	2
32	9404-02025-DX	Ø2x25 Cotter Pin	4
34	9208-06000-DX	M6 Wing Nut	2

Limited Warranty

Warranty

For two year from the date of purchase YTL International will replace for the original purchaser, or repair the utility dump cart. The warranty will not apply to any unit which was not assembled correctly, misused, overloaded or which has been used or operated contrary to our instructions, or which has been repaired or altered by anyone other than an authorized representative.

Warranty Exclusions

This warranty does not cover cosmetic defects such as paint, decals or wear items such as tires. This warranty will not cover failures or problems due to acts of God, or events or forces beyond the control of the manufacturer.

Normal Wear Exclusion

The utility dump cart needs periodic service to perform well. This warranty does not cover repair when normal use has exhausted the life of a part or the equipment as a whole.

Installation, Use and Maintenance Exclusion

This warranty will not apply to parts and/or labor if the utility dump cart has been misused, neglected, involved in an accident, abused, loaded beyond its limits, modified or assembled incorrectly. Normal maintenance is not covered under this warranty.

Limits of Implied Warranty and Consequential Damage Exclusion

YTL International disclaims any obligation to cover any loss of time, use of this product, freight, or any incidental or consequential claim by anyone from using this utility dump cart. THIS WARRANTY IS IN LIEU OF ALL OTHER WARRANTIES, EXPRESS OR IMPLIED, INCLUDING WARRANTIES OF MERCHANTABILITY OR FITNESS FOR A PARTICULAR.

An exchange unit will be subject to the original warranty. The length of the warranty governing the exchanged unit will have the date as the purchase date of the original unit. This warranty gives you certain legal rights which may change from state to state. Your state may also have other rights you may be entitled to that are not listed within this warranty.

Contact Information

YTL International Inc.
17517 Fabrica Way, Suite H
Cerritos, CA 90703
Phone: (888) 723-6534
Phone: (562) 404-8016
Fax: (562) 404-8013
Email: parts@ytlinternational.com