



EASY ASSEMBLY AND OPERATION INSTRUCTIONS

23SV24211_Lantern Nutcracker

READ AND SAVE THESE INSTRUCTIONS FOR FUTURE REFERENCE

IF ANY PART IS MISSING OR BROKEN, DO NOT ATTEMPT TO ASSEMBLE THE PRODUCT AND CONTACT SVI CUSTOMER SERVICE FROM 8:30 AM TO 5:30 PM PST AT 1-855-428-3921, EMAIL CUSTOMERSERVICE@SVIUS.COM, OR CALL HOME ACCENTS HOLIDAY CUSTOMER SERVICE FROM MON-FRI 8:00 AM TO 7:00 PM AND SAT 9:00 AM TO 6:00 PM EST AT 1-855-HDHOLIDAY (1-855-434-6543).

IMPORTANT TIPS:

- Ensure that the item's adapter is plugged in at the function control box and in the wall.
- Ensure that the switch on the function control box is on the desired setting.
- If not functioning properly (LEDs don't light up, LCD eyes don't activate), ensure that cables are connected correctly, according to the instruction sheet.
- Be sure nothing is blocking movement or caught in moving parts.
- Ensure that the floor or surface that the item sits on is flat and level.
- Ensure that the volume is not all the way down.
- If the item still does not work, contact SVI Customer Service from 8:30 am to 5:30 pm PST at 1-855-428-3921, email customerservice@svius.com, or call Home Accents Holiday Customer Service from Mon-Fri 8:00 am to 7:00 pm and Sat 9:00 am To 6:00 pm EST at 1-855-HDHOLIDAY (1-855-434-6543).

PARTS LIST

- A. Base x 1
 - B. Platform x 1
 - C. Lower Poles x 2
 - D. Left Boot x 1
 - E. Right Boot x 1
 - F. Upper Poles x 2
 - G. Left Leg x 1
 - H. Right Leg x 1
 - I. Body x 1
 - J. Left Hand x 1
 - K. Right Arm x 1
 - L. Lantern Base x 1
 - M. Lantern Poles x 2
 - N. Lantern x 1
 - O. Head x 1
 - P. Leg Caps x 2
 - Q. Hex Key x 1
 - R. Stakes x 2
 - S. Adapter x 1
- Input: 120VAC 50/60Hz
Output: 5.9V 1.5A

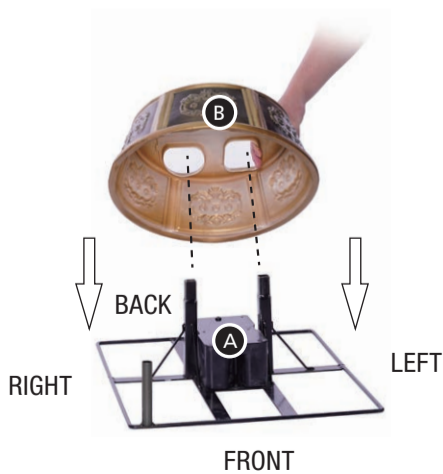
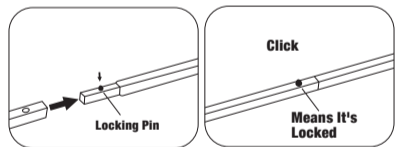

NOTE: Throughout the instructions, Right and Left are relative to the character.

1.1



1.2



2.1



2.2



3.1

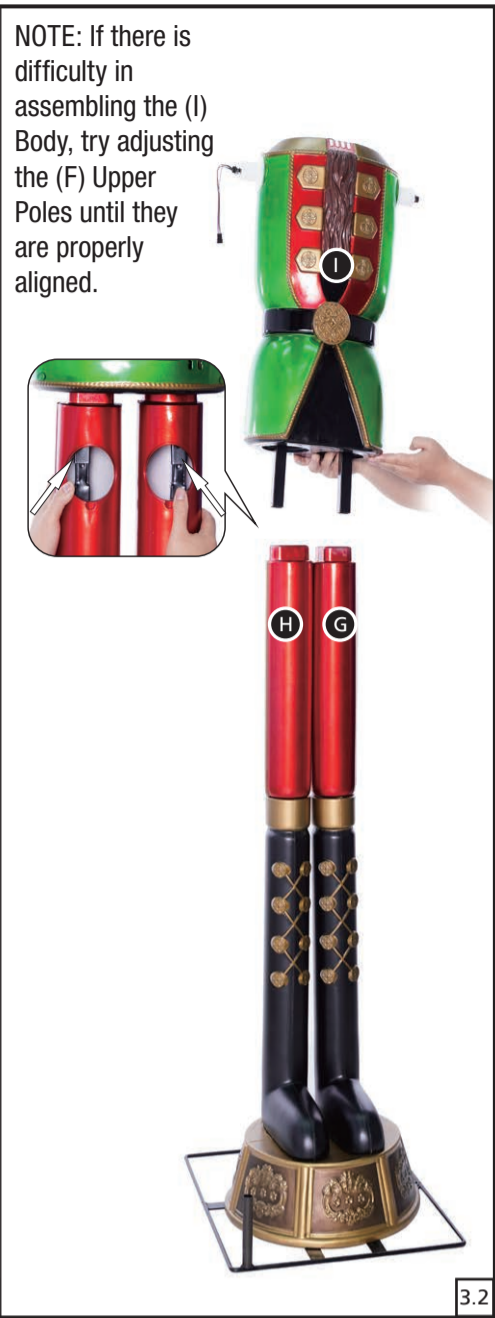

3.2

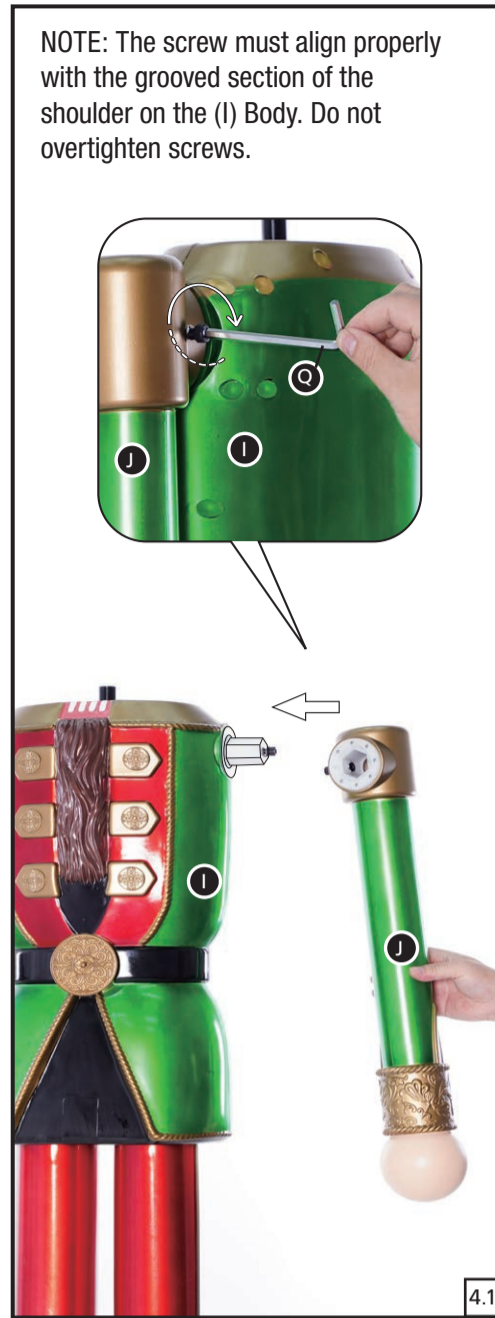

4.1

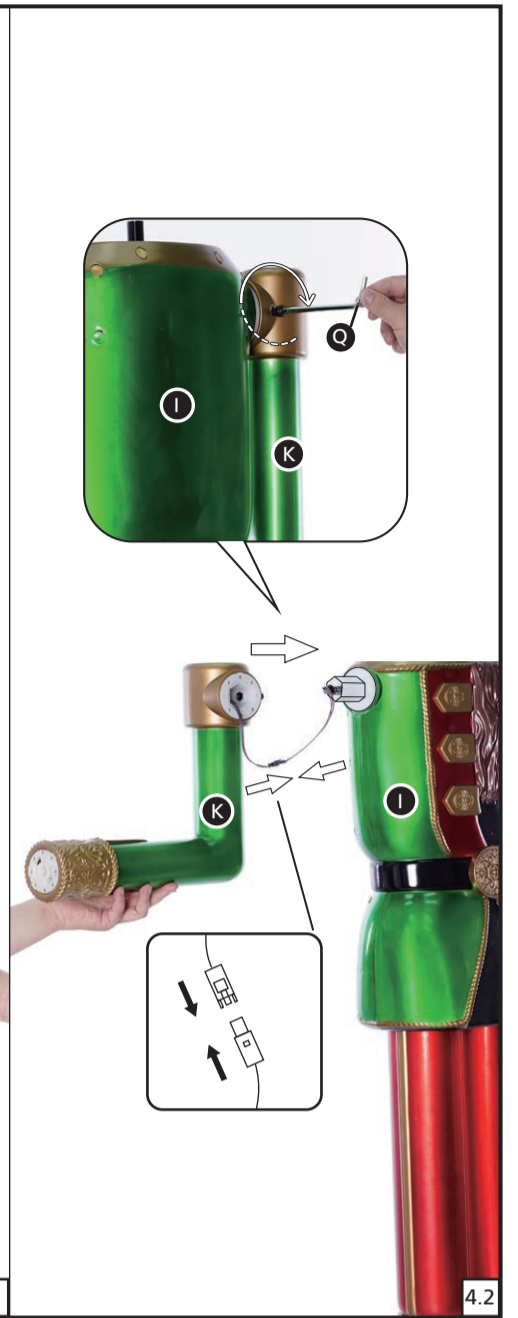

4.2



5.1

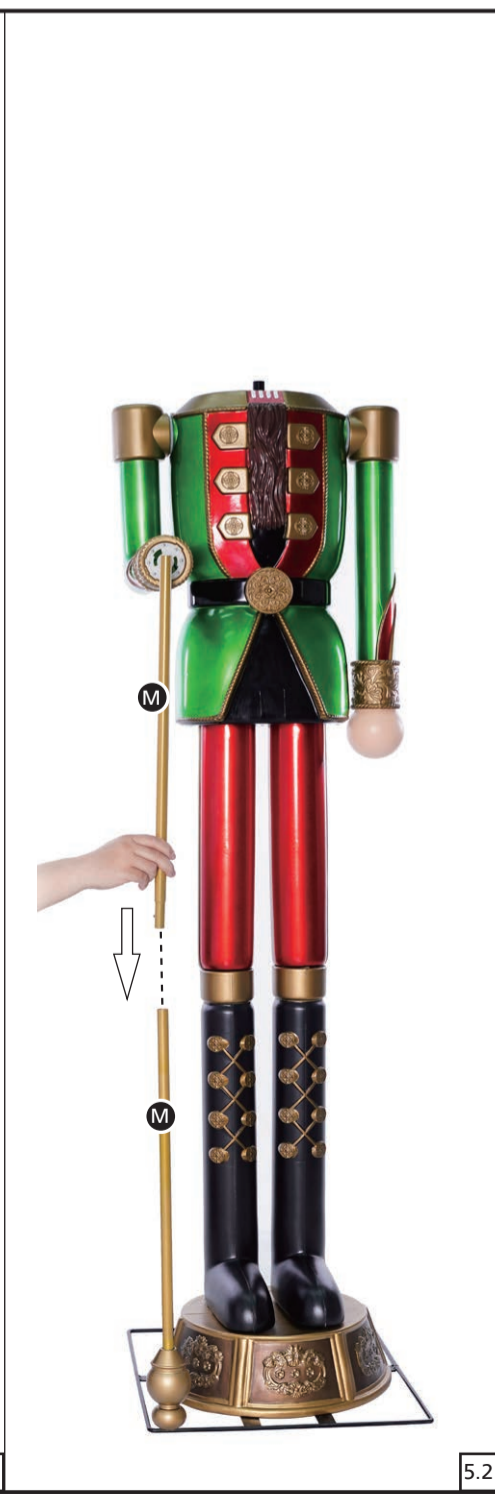

5.2

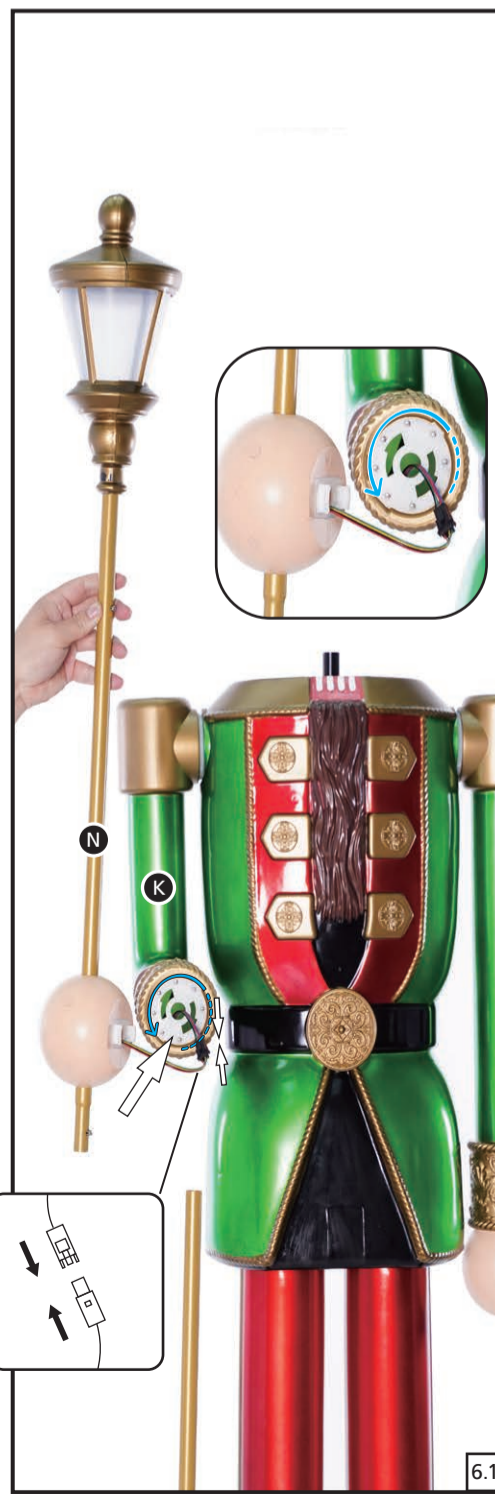

6.1

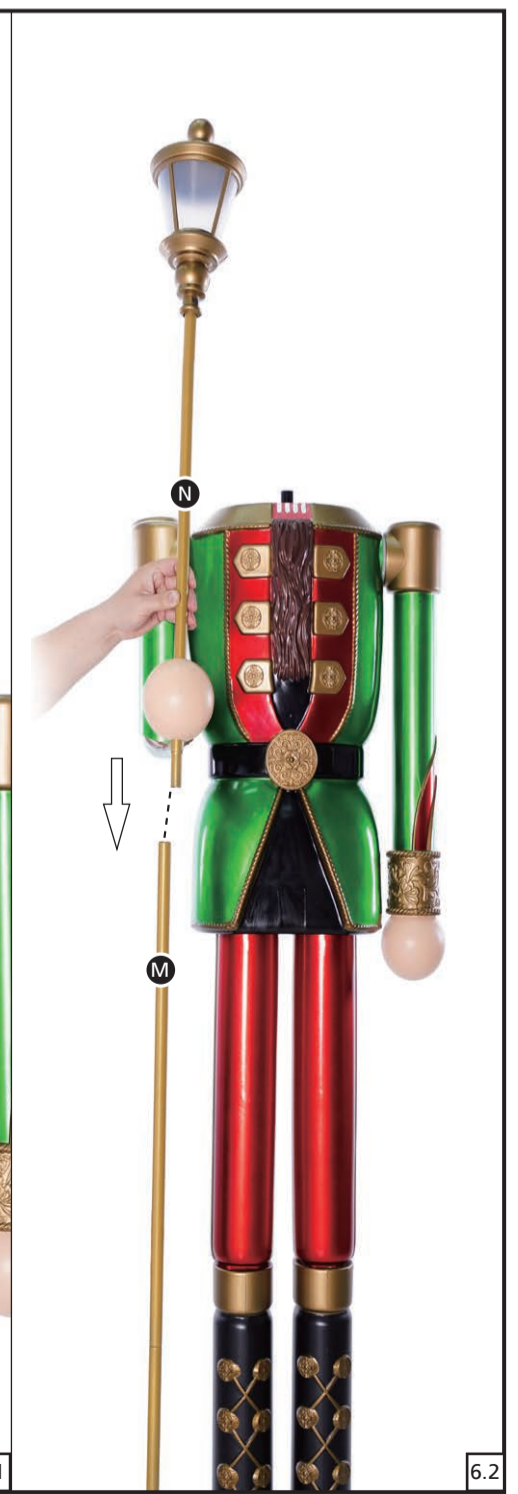

6.2

NOTE: A ladder is advised for assembling the (O) Head. Insert the bottom part of the (O) Head into the top of the (I) Body and rotate counterclockwise so the (O) Head locks in place. Do not pinch wires while assembling the (O) Head to the (I) Body.

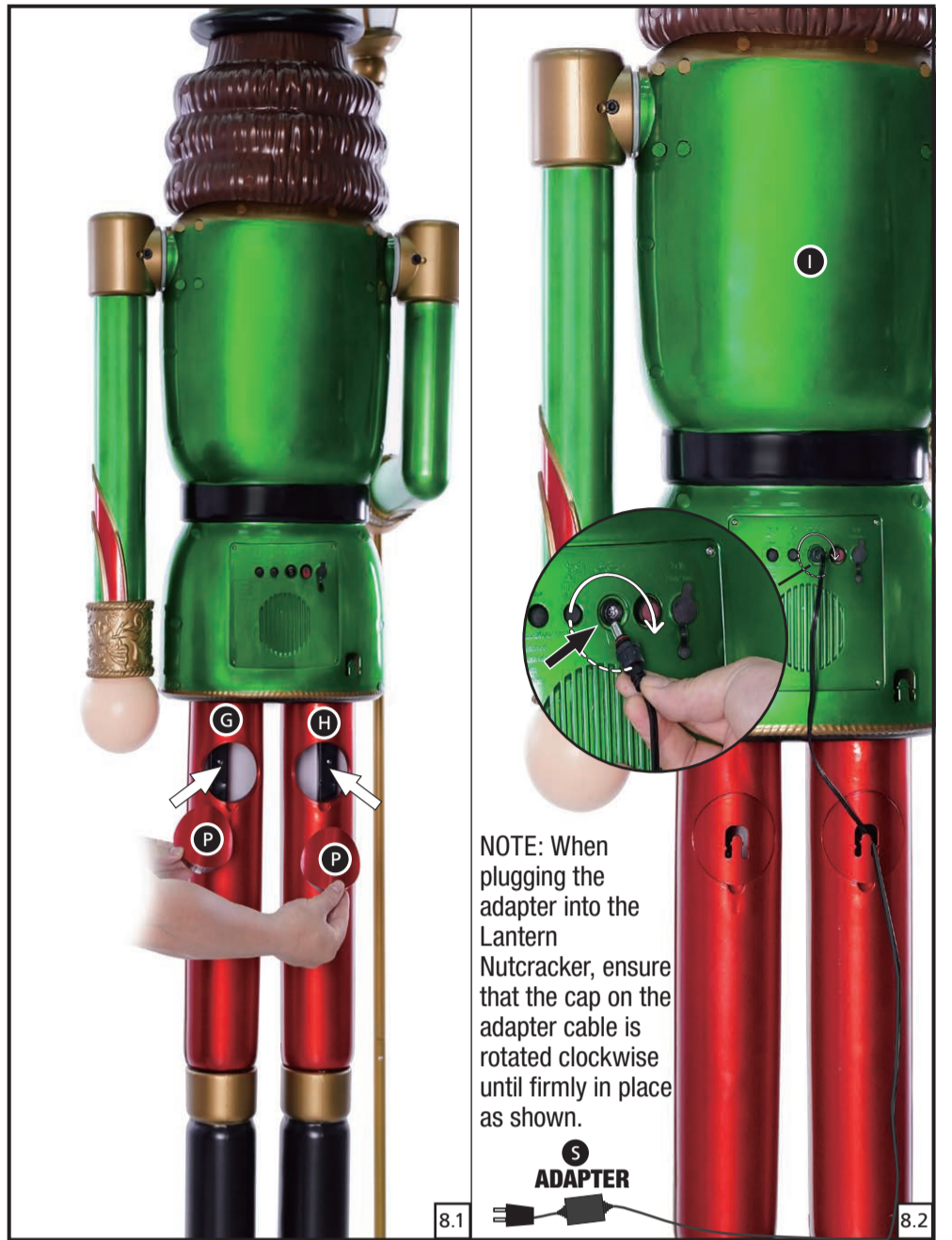

NOTE: When plugging the adapter into the Lantern Nutcracker, ensure that the cap on the adapter cable is rotated clockwise until firmly in place as shown.

YOUR LANTERN NUTCRACKER IS NOW FULLY ASSEMBLED. PLUG IN AND TURN ON TO LET THE FUN BEGIN!

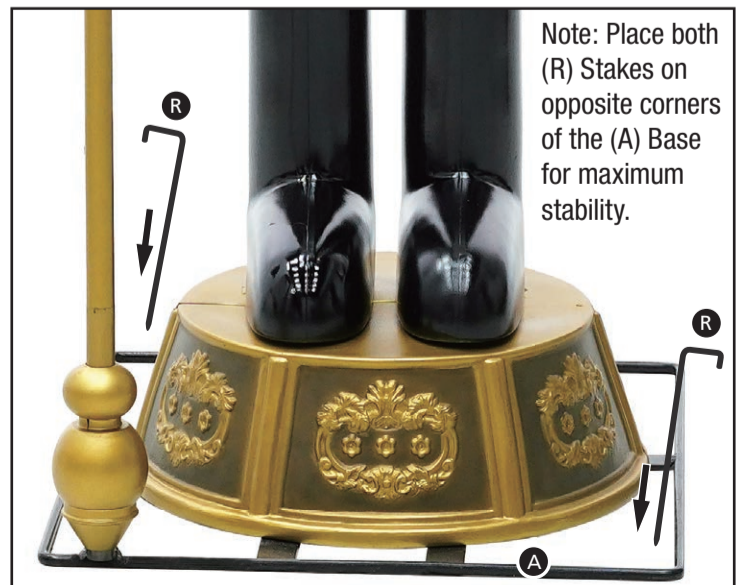

Note: Place both (R) Stakes on opposite corners of the (A) Base for maximum stability.

NOTE: Make sure the waterproof cap is covering the Try Me receiver at all times when not in use.

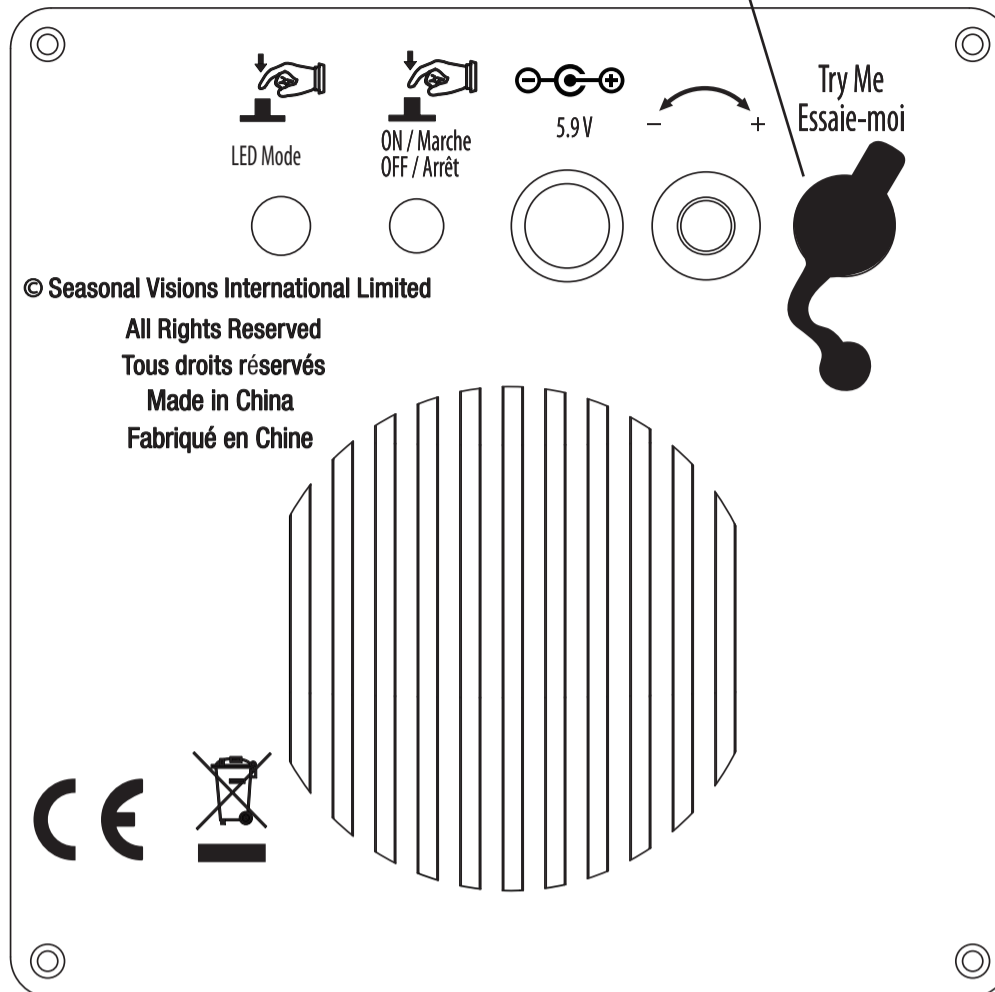

OPERATION INSTRUCTIONS:

1. Plug the power adapter into a standard power outlet and adjust the settings on the function control box, located on the (I) Body, as desired.

2. Settings:

LED Mode	This button will change the LED effects on the Lantern Nutcracker. There are 3 LED effect settings to cycle through; Smooth Color Transition, Slow Color Change, and Fast Color Change
ON / Marche OFF / Arrêt	This button will activate/deactivate the lights, sound, and LCD eye animation of the Lantern Nutcracker. The Lantern Nutcracker will play over 20 minutes of Christmas music and then will repeat the song selection indefinitely until deactivated.
Try Me / Essaie-moi	When the Try Me jack is plugged in and the ON/OFF button is toggled to "ON," the product will automatically enter "Try Me Mode." This mode will deactivate the lights, sound, and LCD eye animation until triggered by using a Step Here Try Me Activation Pad (Not Included). The item will operate for one audio cycle with each Try Me activation.
	Raise or lower the volume using the volume control turn dial, turn all the way down to turn the volume off.

WARNING:

- Lay product down before a storm or strong winds.
- Don't climb or pull on product.
- Don't add to or modify product.
- Assemble and place the product on level surfaces only.
- Don't push or tilt product.

WARNING

This item is not a toy and should be used for decoration only. This item contains small parts that can be a choking hazard. Keep all plastic and wire parts away from children.

1. Please use the adapter supplied by manufacturer.
2. Please assemble item according to instructions. Connect all wires according to matching color.
3. Children should be supervised by adults. Item should not be grabbed, as it becomes a tipping hazard. Keep flammables away from the adapter, as it heats up during operation.

Please view all instructions carefully before assembling. Save this instruction sheet for future reference.

CARE AND STORAGE INSTRUCTIONS

This is both an outdoor and indoor use item. When not in use, store this product in its original packing. Keep away from heat and moisture.

This device complies with Part 15 of the FCC Rules. Operation is subject to the following two conditions: (1) This device may not cause harmful interference, and (2) this device must accept any interference received, including interference that may cause undesired operation.

CAUTION: Changes or modifications not expressly approved by the party responsible for compliance could void the user's authority to operate the equipment.

NOTE: This equipment has been tested and found to comply with the limits for a Class B digital device, pursuant to Part 15 of the FCC Rules. These limits are designed to provide reasonable protection against harmful interference in a residential installation. This equipment generates, uses, and can radiate radio frequency energy and, if not installed and used in accordance with the instructions, may cause harmful interference to radio communications. However, there is no guarantee that interference will not occur in a particular installation. If this equipment does cause harmful interference to radio or television reception, which can be determined by turning the equipment off and on, the user is encouraged to try to correct the interference by one or more of the following measures: Reorient or relocate the receiving antenna, increase the separation between the equipment and receiver. Connect the equipment into an outlet on a circuit different from that to which the receiver is connected. Consult the dealer or experienced radio/TV technician for help.

CAN ICES-003(B)/NMB-003(B)

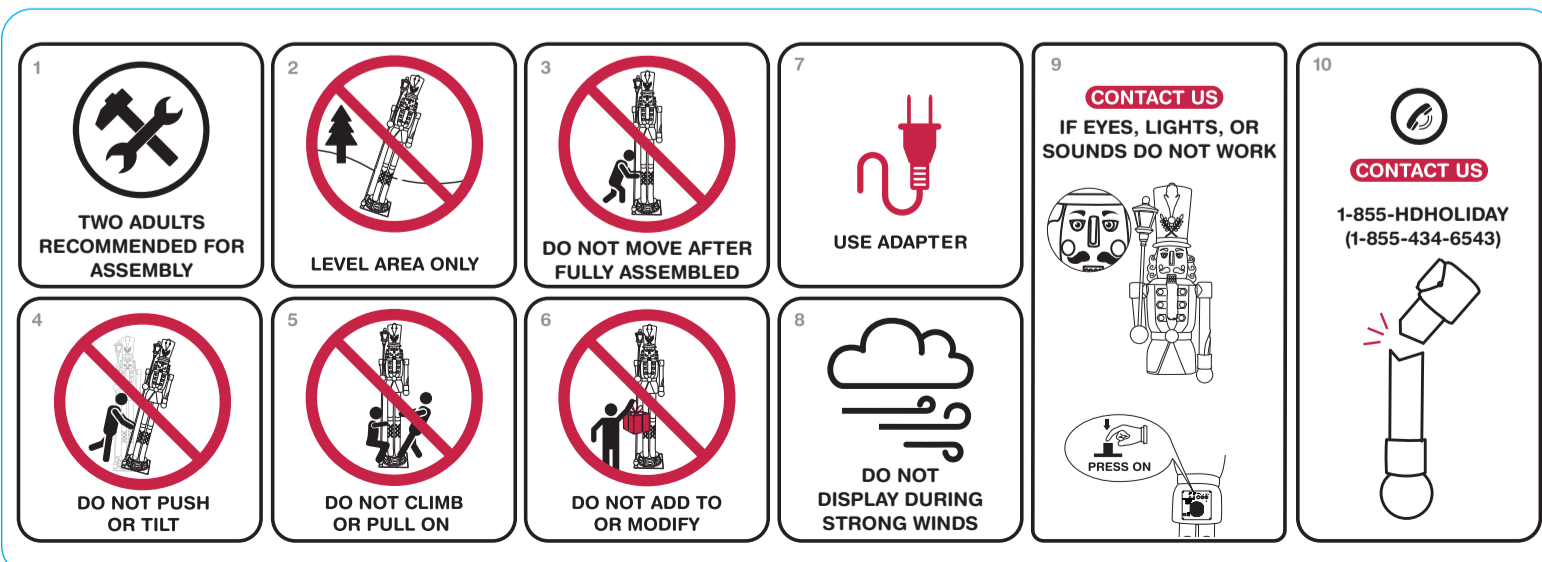

© Seasonal Visions International
Berkeley, CA 94710
Tel: 1-855-428-3921
All Rights Reserved
MADE IN CHINA