

Safety Information

WARNING: READ AND UNDERSTAND ALL INSTRUCTIONS.

Failure to follow all instructions listed below, may result in electric shock, fire and/or serious personal injury.

WARNING:

ELECTRIC PRODUCT. Keep away from children. As with all electrical products, precautions should be observed during handling and use to reduce the risk of electric shock. If the supply cord is damaged, it must be replaced by the manufacturer, its service agent or similarly qualified persons in order to avoid a hazard. To avoid the risk of electrical shock, always make sure the figure is unplugged from the electrical outlet before assembling, disassembling, or relocating.

This product is to be assembled by adults only.

IMPORTANT SAFETY INSTRUCTIONS

BASIC PRECAUTIONS SHOULD ALWAYS BE FOLLOWED WHEN USING ELECTRICAL PRODUCTS, INCLUDING THE FOLLOWING:

READ AND FOLLOW ALL SAFETY INSTRUCTIONS.

- This is an electrical product - not a toy! To avoid risk of fire, burns, personal injury, and electric shock, it should not be played with or placed where small children can reach it.
- Do not use seasonal products outdoors unless marked suitable for indoor and outdoor use. When products are used in outdoor applications, connect the product to a Ground Fault Circuit Interrupting (GFCI) outlet. If one is not provided, contact a qualified electrician for proper installation.
- This seasonal use product is not intended for permanent installation or use.
- Do not mount or place near gas or electric heaters, fireplaces, candles, or other similar sources of heat.
- Do not secure product wiring with staples or nails or place on sharp hooks or nails.
- Do not let lamps rest on the supply cord or on any wire.
- Unplug the product when leaving the house, when retiring for the night, or if left unattended.
- Do not use this product for other than its intended purpose.
- Do not hang ornaments or other objects from cord, wire, or light string.
- Do not close doors or windows on the product, or extension cords, as this may damage the wire insulation.
- Do not cover the product with a cloth, paper, or any material not part of the product when in use.
- Do not place the product against carpeting, furniture, or any other fabric when in use.
- This product has a polarized plug (one blade is wider than the other) as a feature to reduce the risk of electric shock. This plug will fit in a polarized outlet only one way. If the plug does not fit fully in the outlet, reverse the plug. If the plug still does not fit, contact a qualified electrician.
- Do not use an extension cord unless the plug can be fully inserted. Do not alter or replace the plug.
- This product employs overload protection (fuse). A blown fuse indicates an overload or a short-circuit condition. If the fuse blows, unplug the product from the outlet. Also

unplug any additional string or products that may be attached to the product. Replace the fuse as per the user servicing instructions (follow product markings for proper fuse rating) and check the product. If replacement fuse blows, a short-circuit may be present and the product should be discarded.

- Read and follow all instructions that are on the product or provided with the product.

SAVE THESE INSTRUCTIONS USE AND CARE INSTRUCTIONS

1. When the product is placed on a live tree, the tree should be well maintained and fresh. Do not place on live trees in which the needles are brown or break off easily. Keep the tree holder filled with water.
2. If the product is placed on a tree, the tree should be well secured and stable.
3. Before using and reusing, inspect the product carefully. Discard any products that have cut, damaged or frayed wire insulation cords, cracks, lamp holders or enclosures, loose connections, or exposed copper wire.
4. When storing the product, carefully remove the product from wherever it is placed, including trees, branches, or bushes, to avoid any undue strain or stress on the product conductors, connections and wires.
5. When not in use, store neatly in a cool, dry location protected from sunlight.

To reduce the risk of fire and electric shock:

1. Do not install on trees having needles, leaves or branch coverings of metal or materials which look like metal and.
2. Do not mount or support wires in a manner that can cut or damage wire insulation.

CAUTION: Do not attempt to inflate this unit during unusually strong winds. If it becomes too windy for safe operation, allow the unit to deflate and wait for safer conditions.

CAUTION: Do not connect to another lighting string, decorative outfit, or seasonal product. To reduce the risk of fire do not deliberately reposition either lamp holder contact.

Do not attempt to inflate your Airblown® Inflatable during unusually strong winds. If it becomes too windy for safe operation, simply allow your Airblown® Inflatable to deflate and wait for better conditions before re-inflating.

Protect the electric fan and power cord from direct exposure to water. This precaution will reduce the risk of electrical shock. When the temperature is below 14° F (-10° C), the motor may temporarily stop running. The motor will begin functioning again higher temperatures.

WARNING

Remove all plastic fasteners and tags. These are part of the packaging and should be discarded.

This item is not a toy and should be used for decorative purposes only.

For indoor and outdoor use.

120 V 60 Hz.

CAUTION:

1. For temporary (90 days maximum) installation and use only.
2. To reduce the likelihood of excessive heat and possible damage, use only decorative lamp accessories packaged with this product.
3. Always unplug this product before installing or replacing fuses and/or lamps.
4. Replace only with same type C7, 0.9 Watt Max candleabra-base UL Classified Lamps.

USER SERVICING INSTRUCTIONS

Lamp Replacement (Not included)

Disconnect the plug from the electrical outlet and allow

the lamp to cool completely before replacing bulb. Do not touch the bulb when the power is "ON" as it is extremely hot and make cause electrocution.

1. Grasp plug and remove from receptacle or other outlet device. Do not unplug by pulling on the cord.
2. Open the zipper opening on the Airblown® Inflatable.
3. Push aside the locking tabs to open the light cover.
4. Replace lamp with same type C7, 0.9W maximum, candelabra base, UL classified.
5. Do not over-tighten the lamp as this may damage the lamp or lamp holder.

Replace only with same type C7, 0.9 Watt Max Candelabra-base 120 Volt UL Classified lamps.

Fuse Replacement

WARNING: Risk of Fire:

Replace only with same size and type of fuse. Do not replace the attachment plug. Contains a safety device (fuse) that should not be removed. Discard product if attachment plug is damaged.

1. Grasp plug and remove from the receptacle or other outlet device. Do not unplug by pulling on the cord.
2. Open fuse cover. Slide open the fuse access cover on top of the attachment plug towards blades. (See illustration)
3. Remove fuse carefully.
4. Replace fuse only with 5 Amp Max, 125 Volt (provided with product).
5. Close the fuse cover. Slide closed the fuse access cover on top of the attachment plug.

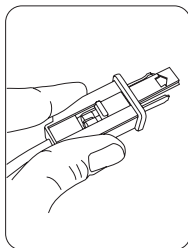

TROUBLESHOOTING CHECKLIST

If your Airblown® Inflatable is not inflating, the problem may be.

1. The power source is disabled or the cord may be unplugged.
2. Debris may be lodged in the motor.
3. The zipper may not be securely fastened, sealing the Airblown® Inflatable.
4. The temperature may be below 14° F (-10° C).

NOTE: ONCE FAN IS UNPLUGGED AND STOPS BLOWING, YOUR Airblown® Inflatable WILL DEFLATE.

WARNING

This device complies with Part 15 of the FCC Rules. Operation is subject to the following two conditions: (1) this device may not cause harmful interference, and (2) this device must accept any interference received, including interference that may cause undesired operation.

CAUTION: Changes or modifications not expressly approved by the party responsible for compliance could void the user's authority to operate the equipment.

NOTE: This equipment has been tested and found to comply with the limits for a Class B digital device, pursuant to Part 15 of the FCC Rules. These limits are designed to provide reasonable protection against harmful interference in a residential installation. This equipment generates, uses, and can radiate radio frequency energy and, if not installed and used in accordance with the instructions, may cause harmful interference to radio communications. However, there is no guarantee that interference will not occur in a particular installation. If this equipment does cause harmful interference to radio or television reception, which can be determined by turning the equipment off and on, the user is encouraged to try to correct the interference by one or more of the following measures:

- Reorient or relocate the receiving antenna.
- Increase the distance between the equipment and receiver.
- Connect the equipment into an outlet on a circuit different from that to which the receiver is connected.
- Consult the dealer or an experienced radio/TV technician for help.

FREQUENTLY ASKED QUESTIONS (FAQ's)

1. Can I continually run my Airblown® Inflatable?

Yes, you can run your Airblown® Inflatable during the day and at night. We recommend that you turn off your Airblown® Inflatable when leaving the immediate area and when retiring for the evening. Otherwise, your Airblown® Inflatable is designed to run continually as you see fit.

2. What happens if my Airblown® Inflatable becomes torn?

Rips in the Airblown® Inflatable can be sewn by hand (no special thread is required) or taped with clear packing tape.

3. How can I clean my Airblown® Inflatable?

Wipe clean with a damp cloth and allow to dry before storing away. Use mild detergent if necessary.

4. When I unplug my Airblown® Inflatable, it deflates. Why is this?

Your Airblown® Inflatable will not stay inflated unless it is plugged in and the fan is blowing air.

5. How much electricity does an Airblown® Inflatable consume?

It uses about as much energy as a standard string of holiday lights.

6. What is the best way to store my Airblown® Inflatable?

Store in a bag, box or other storage container and keep in a cool, dry location.

7. I have stored my Airblown® Inflatable for several months and now the motor does not work?

Sometimes the air intake may be blocked by loose grass/leaves or other particles. Gently shake, knock or tap the motor and see if it will operate again.

These Instructions Are For These Items
221760

Package Contents



x1



x4



x4



x4



x1

Assembly Instructions

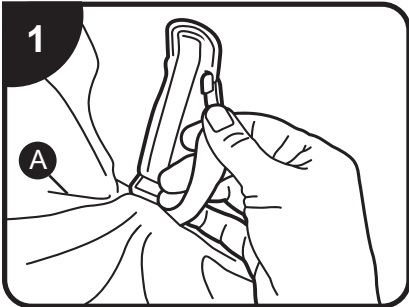

Ensure the four clips on the bottom of the fabric of the inflatable (A) are attached to the plastic legs on the base of the inflatable.

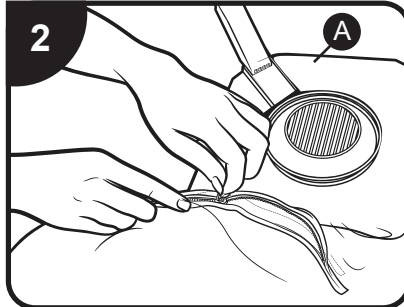

Ensure that the air intake on the inflatable (A) unit is clear of fabric and other obstructions and that the zipper is fully closed. Some inflatables have more than one zipper.

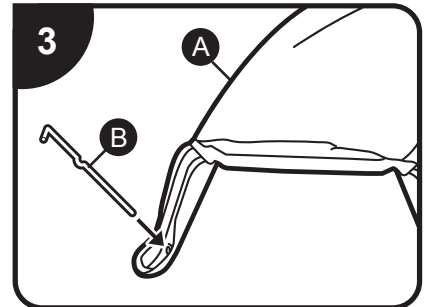

Turn the inflatable (A) upright and insert four base stakes (B) through the holes of the plastic legs into the ground.

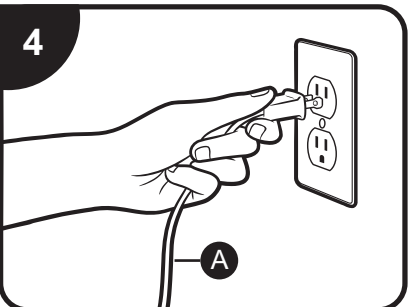

Plug in the inflatable (A) into an outlet or other power source to inflate.

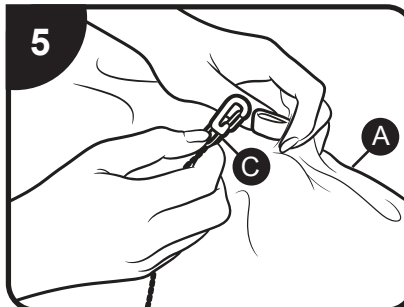

Once fully inflated, clip the nylon tethers (C) to each of the attached nylon loops on the side of the inflatable (A).

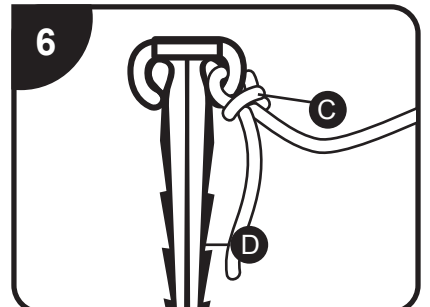

Using the loop at the end of the tether (C), fasten the tethers to the tether stakes (D).

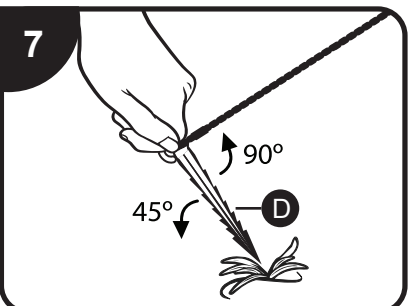

Drive the stakes (D) into ground at a 45-degree angle.

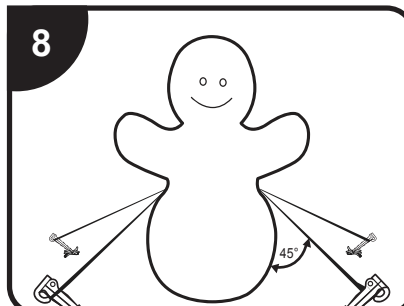

For maximum stability bring tether down to a 45-degree angle from the inflatable as shown in the illustration. In order to achieve this you may need to wrap the excess tether around the top of the stake.

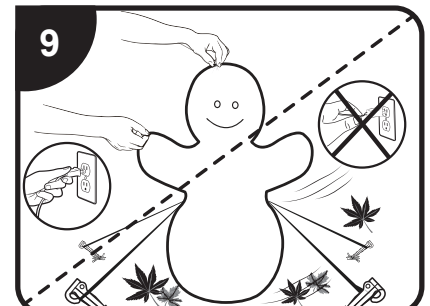

Do's and Don'ts

1. Do check your inflatable daily and adjust to stand up straight.
2. Do not attempt to operate your inflatable in unusually strong winds. (see caution)
3. Do not unplug by pulling on cord.
For faster deflation, unzip zipper after unplugging plug.

Visit WWW.GEMMY.COM for more information.

©2021 GEMMY INDUSTRIES CORP.

117 WRANGLER DRIVE, SUITE 100

COPPELL, TX 75019 U.S.A.

1 (800) 274-6717

MADE IN CHINA / PRINTED IN CHINA