

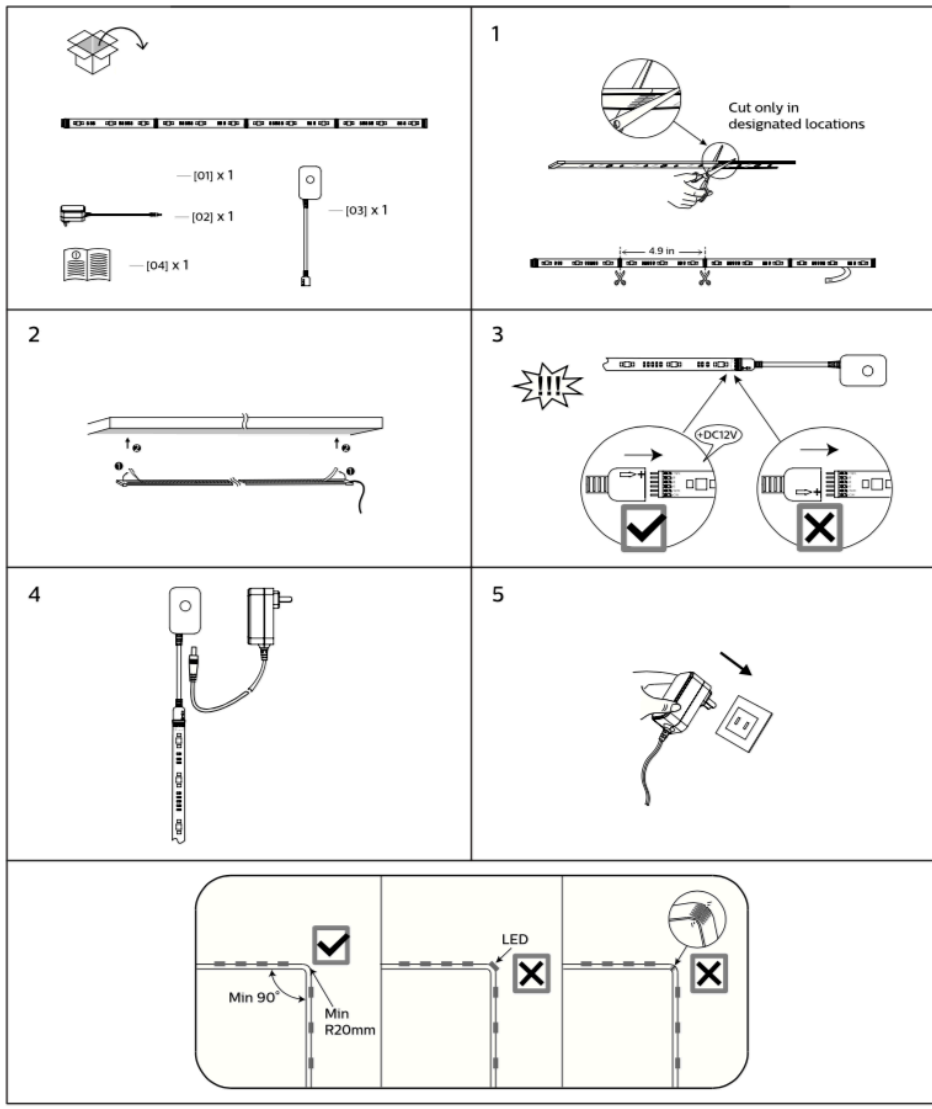

# Philips Wi-Fi LED



LED strip 2m starter kit  
9290025249  
3241 656 60871



- 1 Download the free app**  
Search for "WIZ lighting"  
Download on the App Store  
GET IT ON Google Play
- 2 Install the light strip**  
Connect the LED strip, the power adapter and the control box
- 3 Pair light strip**  
Follow the on-screen steps in the app to complete the setup
- Enjoy your light**  
Create your desired ambiance at home

Only use the control box provided in this kit to control this light strip. This lamp will not operate properly when connected to a standard (incandescent) dimmer or dimming control device.

- Not intended for use with emergency exit lights.
- Suitable for damp locations.
- To prevent early failure, lamp should be installed in operating environment ranging from -4°F / -20°C to +95°F / +35°C.
- Caution: Risk of shock – Turn off power before inspection, installation or removal. Do not open the light strip. No user serviceable parts inside.

## IMPORTANT SAFETY INSTRUCTIONS

This product has a polarized plug (one blade is wider than the other) as a feature to reduce the risk of electric shock. This plug will fit in a polarized outlet only one way. If the plug does not fit fully in the outlet, reverse the plug. If it still does not fit, contact a qualified electrician. If it is necessary to use an extension cord, only do so if the light strip plug can be fully inserted into the extension cord, and the extension cord can be fully inserted into the electrical outlet. Do not alter the plug.

### CAUTION:

1. Use only insulated staples or plastic ties to secure cords.
2. Route and secure cords so that they will not be pinched or damaged by furniture.
3. Not intended for recessed installation in ceilings
4. The National Electrical Code (NEC) does not permit cords to be concealed where damage to insulation may go unnoticed. To prevent fire danger, do not run cord behind walls, ceilings, soffits, or cabinets where it may be inaccessible for examination. Cords should be visually examined periodically and immediately replaced when any damage is noted.
5. If necessary, the light strip may be cut to shorten its overall length. Only cut at designated locations (see instruction sheet). Once cut, the light strip cannot be reconnected.

This device complies with Part 15 of the FCC Rules and Industry Canada licence-exempt RSS standard(s). Operation is subject to the following two conditions: (1) This device may not cause harmful interference, and (2) This device must accept any interference received, including interference that may cause undesired operation. CAN ICES-005 (B) / NMB-005(B)

Changes or modifications not expressly approved by the party responsible for compliance could void the user's authority to operate the equipment. This device has been tested and found to comply with the limits for a Class B digital device pursuant to Part 15 of the FCC Rules. These limits are designed to provide reasonable protection against harmful interference in a residential installation. This device generates, uses, and can radiate radio frequency energy and, if not installed and used in accordance with the instructions, may cause harmful interference to radio communications. However, there is no guarantee that interference will not occur in a particular installation. If this device does cause harmful interference to radio or television reception, which can be determined by turning the device off and on, the user is encouraged to try to correct the interference by one or more of the following measures:  
Reorient or relocate the receiving antenna  
Increase the separation between the device and receiver  
Connect the device into an outlet on a circuit different from that to which the receiver is connected  
Consult the dealer or an experienced radio/television technician for help.

Philips and the Philips Shield Emblem are registered trademarks of Koninklijke Philips N.V.

Wi-Fi®, the Wi-Fi logo, the Wi-Fi CERTIFIED logo are registered trademarks of Wi-Fi Alliance.  
Wi-Fi CERTIFIED™, WPA2™ are trademarks of Wi-Fi Alliance.  
The Bluetooth® word mark and logos are registered trademarks owned by Bluetooth SIG, Inc. and any use of such marks by Signify is under license. Other trademarks and trade names are those of their respective owners.  
Amazon, Alexa and all related logos are trademarks of Amazon.com, Inc. or its affiliates. Google is a trademark of Google LLC. Siri is a registered trademark of Apple Inc.