

Parts Identification

Wood Components

(NOT TO SCALE)



(1) **E1** - FRONT LEFT UPRIGHT - W4L13354
1 3/8"x3 3/8"x81 3/4" (36x86x2076)



(1) **E2** - FRONT RIGHT UPRIGHT - W4L13355
1 3/8"x3 3/8"x81 3/4" (36x86x2076)



(1) **E3** - BACK LEFT UPRIGHT - W4L13356
1 3/8"x3 3/8"x81 3/4" (36x86x2076)



(1) **E4** - BACK RIGHT UPRIGHT - W2A02975
1 3/8"x3 3/8"x81 3/4" (36x86x2076)



(2) **E77** - ANGLE BRACE - W4L13357
1 3/8"x3 3/8"x73 1/4" (36x86x1862)



(3) **F71** - STANDARD ANGLE BRACE - W4L13358
1 3/8"x2 3/8"x13" (36x60x330)



(2) **G1** - WALL RAIL - W4L13359
1"x5 1/4"x22" (24x134x559)



(1) **H1** - LEFT ROOF RAIL - W4L13360
1"x3 3/8"x60" (24x86x1524)

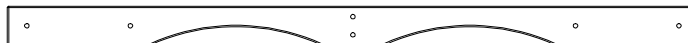

(1) **H2** - RIGHT ROOF RAIL - W4L13361
1"x3 3/8"x60" (24x86x1524)



(1) **H3** - FLOOR JOIST - W4L13362
1"x3 3/8"x40 1/8" (24x86x1018)



(1) **H4** - FLOOR SUPPORT - W4L13363
1"x3 3/8"x40 1/8" (24x86x1018)



(1) **H5** - SWING BEAM RAIL - W4L13364
1"x3 3/8"x40 1/8" (24x86x1018)



(1) **H6** - ROOF UPRIGHT - W4L13365
1"x3 3/8"x24" (24x86x610)



(2) **H7** - BENCH UPRIGHT - W4L13366
1"x3 3/8"x15" (24x86x380)



(2) **H8** - SEAT SUPPORT - W4L13367
1"x3 3/8"x8 1/2" (24x86x216)



(2) **H9** - SHELF SUPPORT - W4L13368
1"x3 3/8"x4 1/2" (24x86x114)

Parts Identification

Wood Components

(NOT TO SCALE)



- (1) **H10** - FLOOR SUPPORT - W4L13369
1"x3 3/8"x40 1/8" (24x86x1018)



- (1) **H11** - ROOF UPRIGHT - W4L13370
1"x3 3/8"x55 1/4" (24x86x1404)

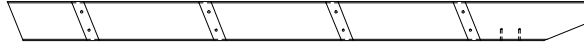

- (1) **H74** - LEFT UPRIGHT - W4L13371
1"x3 3/8"x50 3/4" (24x86x1290)



- (1) **H75** - RIGHT UPRIGHT - W4L13372
1"x3 3/8"x50 3/4" (24x86x1290)

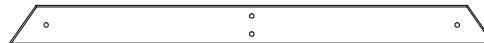

- (1) **H79** - END SUPPORT - W4L13373
1"x3 1/2"x42" (24x86x1072)



- (1) **J1** - DOOR STOP - W4L13374
1"x2 3/8"x2" (24x60x50)



- (1) **K1** - GROUND BOARD - W4L13375
5/8"x5 1/4"x59" (16x134x1499)



- (2) **K2** - GROUND BOARD - W4L13376
5/8"x5 1/4"x60 1/2" (16x134x1538)



- (1) **K3** - GROUND BOARD - W4L13377
5/8"x3 3/8"x47 1/2" (16x86x1205)



- (1) **K4** - GROUND BOARD - W4L13378
5/8"x5 1/4"x40 1/8" (16x134x1018)



- (1) **K5** - SERVING SHELF - W4L13379
5/8"x5 1/4"x40 1/8" (16x134x1018)

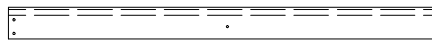

- (1) **K91** - LEFT WALL BOARD - W4L13380
3/8"x2 3/4"x37 1/2" (11x70x954)



- (1) **K92** - RIGHT WALL BOARD - W4L13381
3/8"x2 3/4"x37 1/2" (11x70x954)



- (10) **K93** - WALL BOARD - W4L13382
3/8"x3 3/8"x19 1/2" (11x86x495)



- (2) **K94** - WINDOW CLEAT - W4L13383
3/8"x1 1/8"x9 7/8" (11x30x252)



- (1) **L1** - ARCHED ROOF BOARD - W4L13384
5/8"x4 3/8"x40" (16x112x1016)

Parts Identification

Wood Components

(NOT TO SCALE)



- (1) **L2** - ARCHED ROOF BOARD - W4L13385
5/8"x4 3/8"x40" (16x112x1016)



- (2) **M1** - END ROOF RAIL - W4L13386
5/8"x3 3/8"x41 7/8" (16x86x1064)



- (1) **M2** - FLOOR BOARD - W4L13387
5/8"x3 3/8"x41 7/8" (16x86x1064)



- (2) **M3** - WALL BOARD - W4L13388
5/8"x3 3/8"x41" (16x86x1040)



- (1) **M4** - SERVING SHELF SUPPORT - W4L13389
5/8"x3 3/8"x40 1/8" (16x86x1018)



- (2) **M5** - WALL BOARD - W4L13390
5/8"x3 3/8"x40 1/8" (16x86x1018)



- (1) **M6** - FLOOR SUPPORT - W4L13391
5/8"x3 3/8"x40" (16x86x1016)



- (1) **M7** - TOP ROOF RAIL - W4L13392
5/8"x3 3/8"x40" (16x86x1016)



- (2) **M8** - BRACE - W4L13393
5/8"x3 3/8"x26 5/8" (16x86x676)



- (1) **M9** - HANDLE WALL BOARD - W4L13394
5/8"x3 3/8"x31 3/4" (16x86x808)



- (2) **M10** - WALL BOARD - W4L13395
5/8"x3 3/8"x30" (16x86x762)



- (1) **M11** - SERVING HEADER - W4L13396
5/8"x3 3/8"x40 1/8" (16x86x1018)

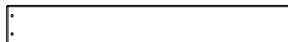

- (2) **M12** - WINDOW WALL BOARD - W4L13397
5/8"x3 3/8"x25" (16x86x634)



- (1) **M13** - WALL RAIL - W4L13398
5/8"x3 3/8"x19 1/4" (16x86x490)

Parts Identification

Wood Components

(NOT TO SCALE)



- (4) **M14** - PICKET - W4L13399
5/8"x3 3/8"x17 3/4" (16x86x452)



- (1) **M15** - WALL RAIL - W4L13400
5/8"x3 3/8"x16 5/8" (16x86x422)



- (2) **M16** - WINDOW WALL BOARD - W4L13401
5/8"x3 3/8"x14" (16x86x356)



- (4) **M17** - WINDOW WALL BOARD - W4L13402
5/8"x3 3/8"x6 1/2" (16x86x164)



- (1) **M18** - FLOOR SUPPORT - W4L13403
5/8"x3 3/8"x40" (16x86x1016)



- (1) **M19** - WALL BOARD - W4L13404
5/8"x3 3/8"x40 1/8" (16x86x1018)



- (1) **M20** - WALL BOARD - W4L13405
5/8"x3 3/8"x31 3/4" (16x86x808)

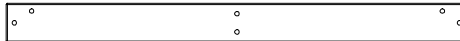

- (1) **M21** - WALL BOARD - W4L13406
5/8"x3 3/8"x40 1/8" (16x86x1018)

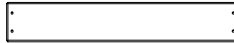

- (5) **M22** - PICKET - W4L13547
5/8"x3 3/8"x20 1/8" (16x86x512)



- (1) **M77** - SLIDE BRACE - W4L13407
5/8"x3 3/8"x14 1/4" (16x86x362)



- (2) **M78** - CENTER SLIDE BRACE - W4L13408
5/8"x3 3/8"x14 1/4" (16x86x362)



- (1) **M102** - ATTACHMENT BOARD - W4L13409
5/8"x3 3/8"x18 1/4" (16x86x462)



- (1) **M103** - REAR SUPPORT - W4L13410
5/8"x3 3/8"x18 1/4" (16x86x462)



- (4) **M104** - LADDER RUNG - W4L13411
1"x3 3/8"x17 1/8" (24x86x434)

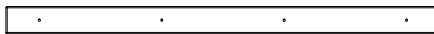

- (2) **N1** - HINGE BOARD - W4L13412
5/8"x2 3/8"x37 3/4" (16x60x958)



- (1) **N2** - WALL BOARD - W4L13413
5/8"x2 3/8"x41" (16x60x1040)



- (1) **N3** - WALL BOARD - W4L13414
5/8"x2 3/8"x30" (16x60x762)

Parts Identification

Wood Components

(NOT TO SCALE)



- (1) **N5** - DOOR STOP SUPPORT - W4L13415
5/8"x2 3/8"x4 7/8" (16x60x125)



- (1) **O1** - SAFETY RAIL - W4L13416
5/8"x1 3/8"x40 1/8" (16x34x1018)



- (2) **Q1** - BENCH SEAT - W4L13417
1"x4 3/8"x40 1/8" (24x112x1018)



- (1) **SB74** - SWING BEAM EXTENDED - W4L13418
2"x5 1/4"x89 1/2" (50x134x2274)



- (2) **T1** - SUPPORT RAIL - W4L13419
1"x1 3/8"x20" (24x34x507)



- (1) **W71** - SWING BEAM SUPPORT - W4L13420
2"x3 3/8"x49 5/8" (50x86x1260)

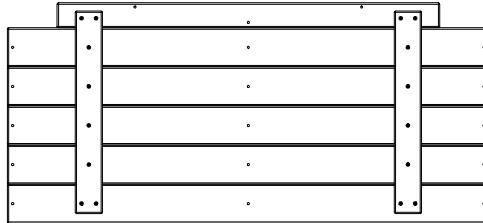

- (2) **FP1** - FLOOR PANEL - W2A02973
1 1/4"x19 1/8"x41 7/8" (32x485x1064)

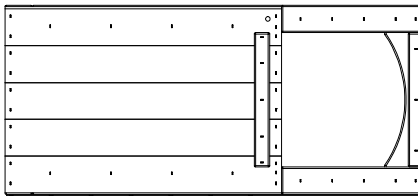

- (1) **DR1** - DOOR PANEL - W2A02974
1 1/2"x16 3/8"x36 3/8" (38x416x924)

Parts Identification

Hardware

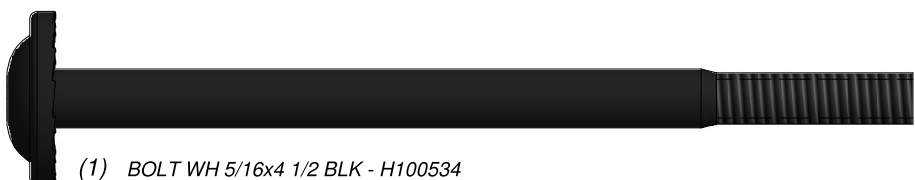

(1) BOLT WH 5/16x4 1/2 BLK - H100534

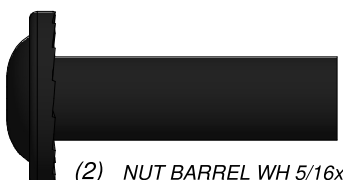

(2) NUT BARREL WH 5/16x1-1/2 BLK - H100193

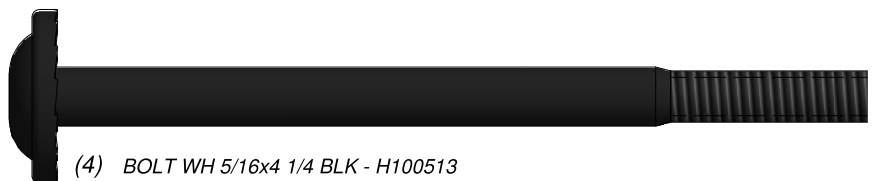

(4) BOLT WH 5/16x4 1/4 BLK - H100513

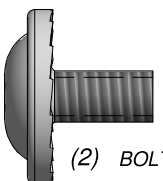

(2) BOLT WH 5/16x1/2 - H100115



(2) BOLT WH 5/16x2-1/2 BLK - H100194

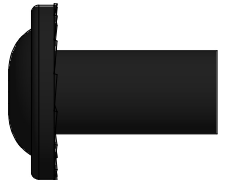

(18) NUT BARREL WH 5/16x7/8 BLK - H100192



(13) NUT BARREL WH 5/16x5/8 BLK - H100469

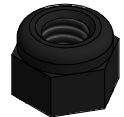

(2) NUT LOCK 5/16 BLK - H100479



(4) BOLT WH 5/16x2-1/4 BLK - H100205



(2) BOLT HEX 5/16x2-3/4 BLK - H100472

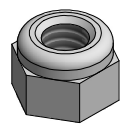

(7) NUT LOCK 5/16 - H100110



(25) BOLT WH 5/16x2 BLK - H100457



(4) BOLT HEX 5/16x2 BLK - H100761



(2) T-NUT 1/4 BLK - H100398

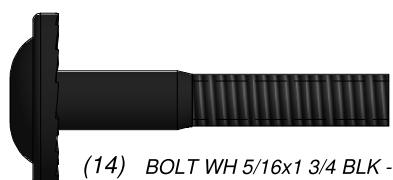

(14) BOLT WH 5/16x1 3/4 BLK - H100378



(21) LAG SCREW WH 5/16x2-1/2 BLK - H100197

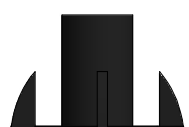

(62) T-NUT 5/16 BLK - H100379



(7) BOLT WH 5/16x1 1/2 BLK - H100407



(15) LAG SCREW WH 5/16x2 BLK - H100458

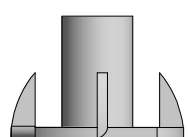

(2) T-NUT 5/16 - H100074

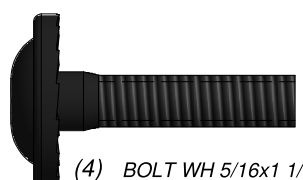

(4) BOLT WH 5/16x1 1/4 BLK - H100459

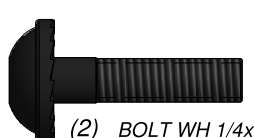

(2) BOLT WH 1/4x1 BLK - H100171



(2) BOLT WH 1/4x1 1/2 BLK - H100406

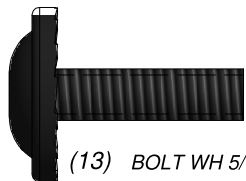

(13) BOLT WH 5/16x1 BLK - H100468

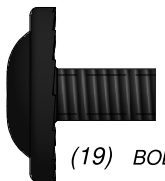

(19) BOLT WH 5/16x1/2 BLK - H100396



(2) NUT BARREL WH 1/4x5/8 BLK - H100404

Parts Identification

Hardware



(7) SCREW PFH 8x2-1/2 BLK - H100201



(26) SCREW PFH 8x2 1/2 - H100090



(26) SCREW PFH 8x2 BLK - H100391



(9) SCREW PFH 8x1 3/4 BLK - H100382



(81) SCREW PFH 8x1-1/2 BLK - H100200



(2) SCREW PFH 8x1-1/4 BLK - H100387



(92) SCREW PFH 8x1 1/8 BLK - H100380



(54) SCREW PFH 8x1 BLK - H100385



(4) SCREW PFH 8x1/2 BLK - H100203



(2) SCREW TAPPING 14x1-1/2 BLK - H100535



(11) SCREW PWH 8x3/4 BLK - H100392



(17) SCREW PWH 8x5/8 BLK - H100202



(4) WASHER LOCK EXT 6x15 BLK - H100405

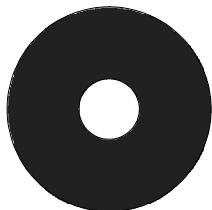

(9) WASHER FLAT 8x27 BLK - H100478

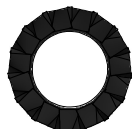

(2) WASHER LOCK EXT 8x15 BLK - H100400

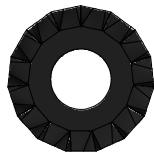

(97) WASHER LOCK EXT 8x19 BLK - H100198

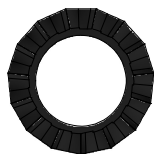

(27) WASHER LOCK EXT 12x19 BLK - H100199

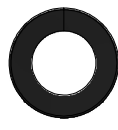

(4) WASHER SPLIT 5/16 BLK - H100477



(2) WASHER FLAT 9x18 BLK - H100474

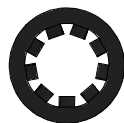

(2) WASHER LOCK INT 8x15 BLK - H100473

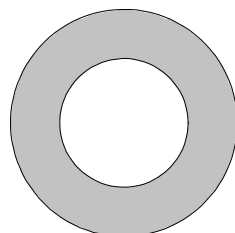

(7) WASHER SAFETY 17x30 - H100103

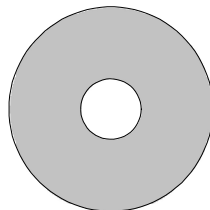

(7) WASHER FLAT 8x27 - H100105

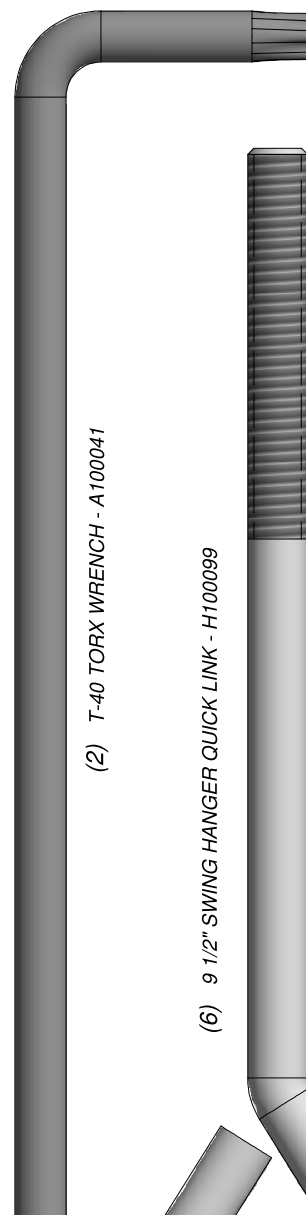

(2) T-40 TORX WRENCH - A100041



(2) T-40 TORX BIT - A100042

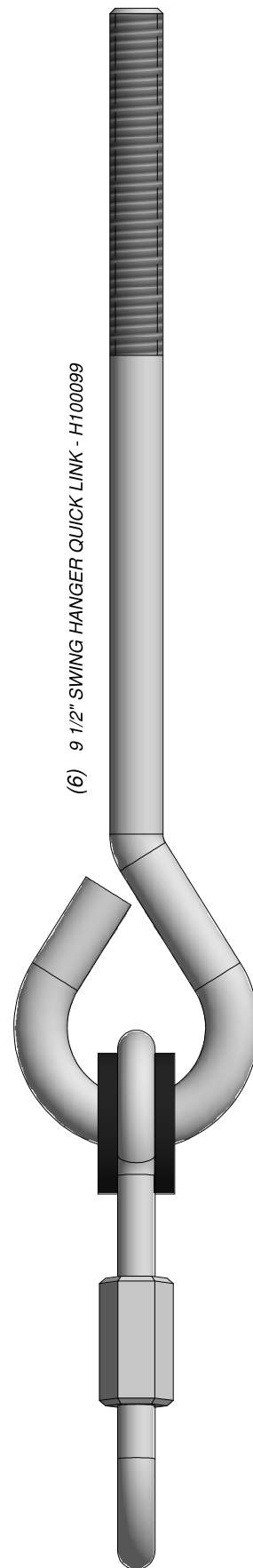

(6) 9 1/2" SWING HANGER QUICK LINK - H100099

Parts Identification

Accessories (NOT TO SCALE)

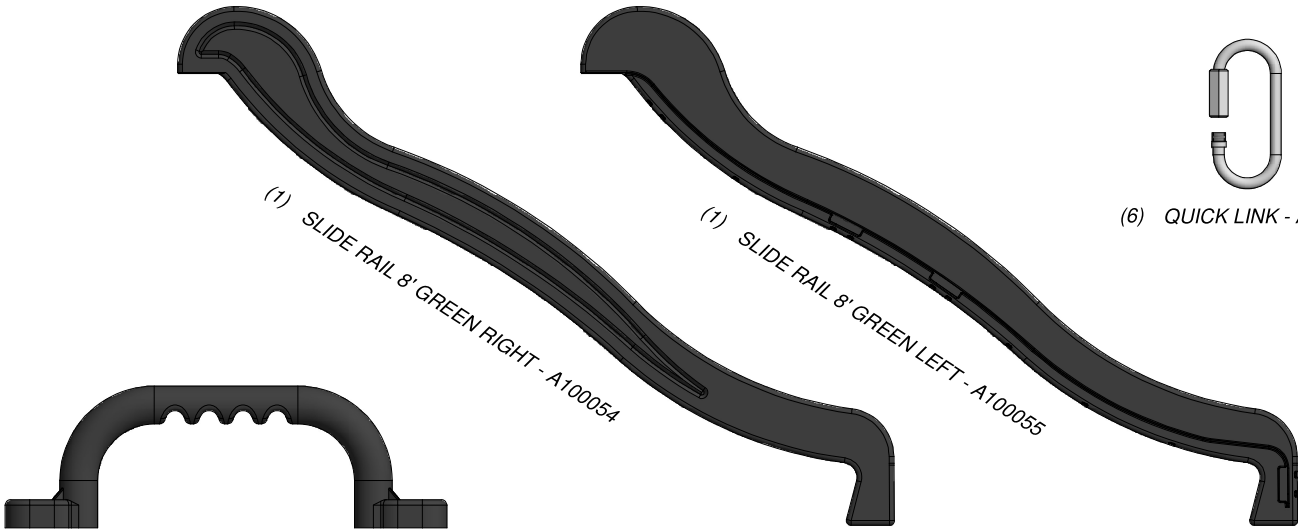

(1) SLIDE RAIL 8' GREEN RIGHT - A100054

(1) SLIDE RAIL 8' GREEN LEFT - A100055

(2) HAND GRIP GREEN PLASTIC - A100028

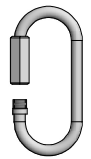

(6) QUICK LINK - A100069



(2) ROPE-CHAIN GREEN 33" - A100083



(4) ROPE-CHAIN GREEN 51.25" - A100087

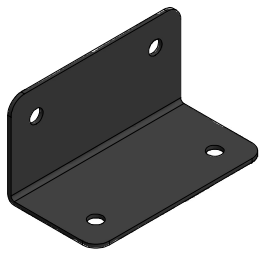

(2) L BRACKET 66x66x127 - A100140

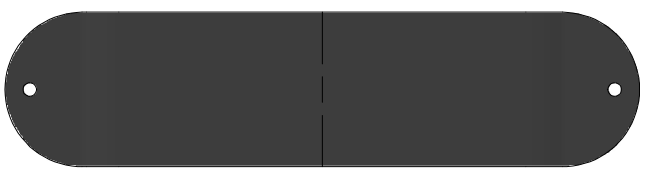

(2) SWING SEAT GREEN 22IN - A6P00054

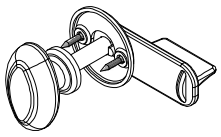

(1) LATCHING KNOB WITH SCREWS - A6P00020

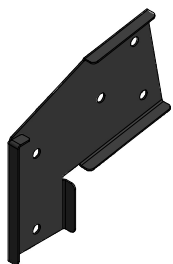

(1) SWING BEAM EXTENSION BRACKET-LEFT - A100325

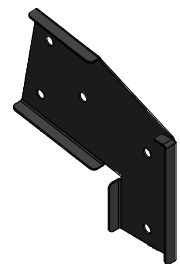

(1) SWING BEAM EXTENSION BRACKET-RIGHT - A100326

Parts Identification

Accessories

(NOT TO SCALE)

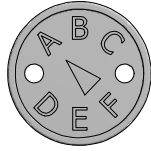

(1) "A" REVISION TAG - A100314

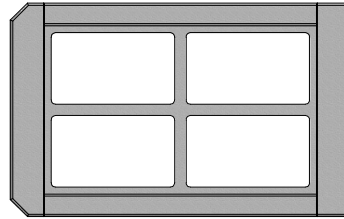

(2) WINDOW (FLAT PACK) - A6P00019

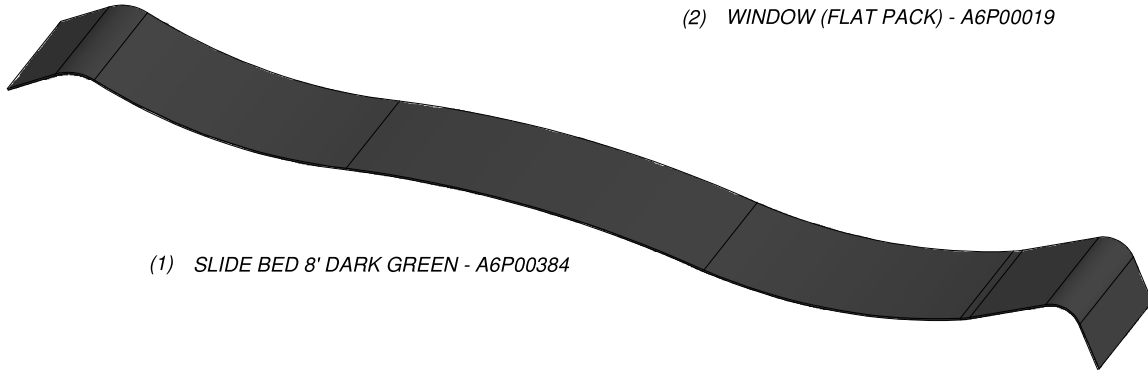

(1) SLIDE BED 8' DARK GREEN - A6P00384

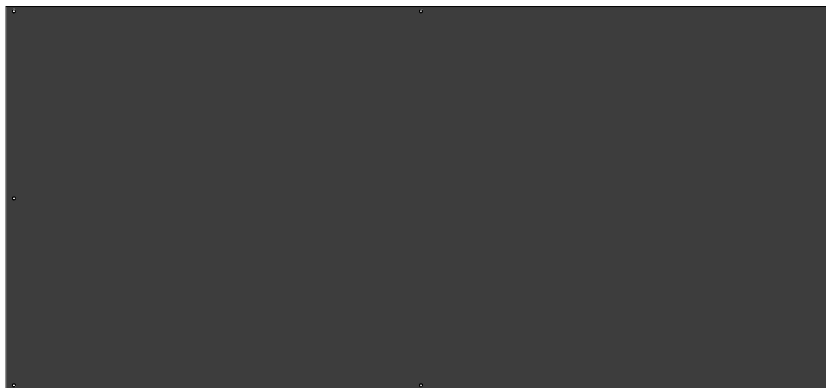

(1) TARP .4x1014x2195 - A6P00381
1/32"x39 7/8"x86 3/8" (.4x1014x2195)

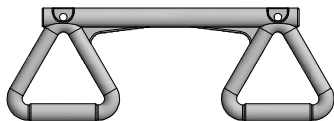

(1) TRAPEZE YELLOW - A6P00034

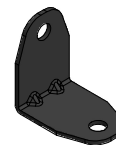

(6) L BRACKET 2.5x38x55x55 - A4M01046



(6) GROUND STAKE REBAR - A4M00527



(1) BYD ID TAG (LARGE) AGES 3-10 - A100164