

METAL[®] GARDEN HOSE

www.metalgardenhose.com

INSTRUCTIONS:

1. Remove the Metal Garden Hose[®] from the package and completely unravel your Metal Garden Hose[®].
2. Attach spray nozzle (included) to the **outlet** of the Metal Garden Hose[®] (figure 1).
3. Attach the Metal Garden Hose[®] **inlet** to the water supply of your home (figure 1).
4. Turn on the tap from your home's water supply to the Metal Garden Hose[®].

① Assemble hose to faucet

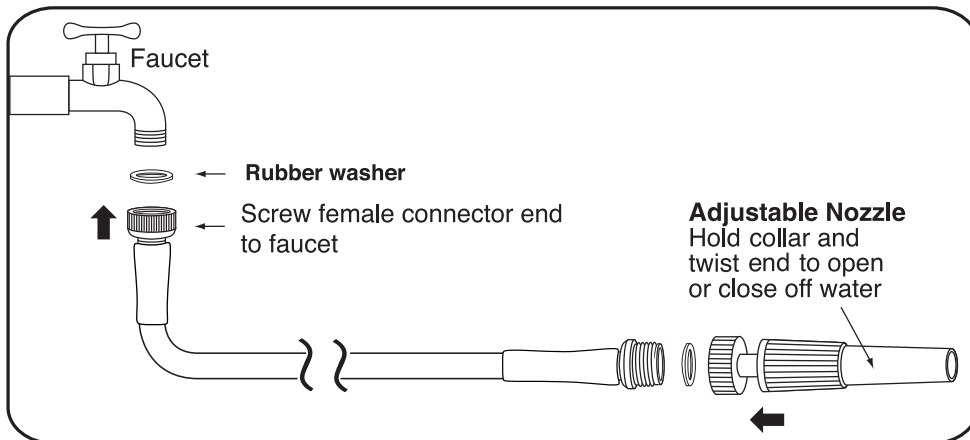

MGHI00179_03 rev6

2018 © Yeiser Research & Development and Metal Garden Hose[®]. Trade names, product names, patterns, prints, images and logos used in this document are the trademark or registered trademarks of YRD LLC, Santee, CA 92071

WORLD WIDE PATENTS PENDING

② Storing your hose

You can store your Metal Garden Hose[®] on just about any common hose reel or simply coil your hose next to your faucet.

TIP: When you are finished watering with your Metal Garden Hose[®] It's best to release the water pressure from your hose before storing.

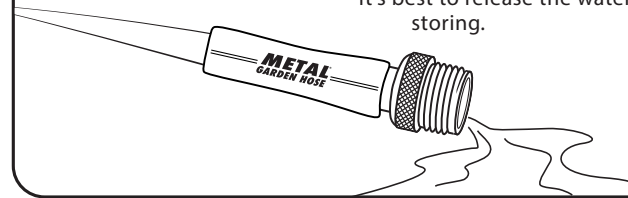

⚠ WARNING

- Portions of this hose are known to the State of California to cause cancer, birth defects and other reproductive harm. DO NOT drink from hose. Wash hands after use.
- The water in ANY garden hose may become contaminated and cause serious health effects.
- Strangulation hazard. Hose wrapped around neck may cause serious injury or death.
- Keep out of reach of children.
- For general OUTDOOR use ONLY in applications under 80 psi.
- DO NOT use this hose for commercial applications, in hot water applications, or high pressure applications. Doing so may cause serious personal injury and or damage or destroy the product. However you can use it on the low pressure inlet side of a high pressure washer.
- DO NOT leave this product unattended when it is in use or under pressure.
- This product is NOT A TOY.

YRD LLC
Yeiser Research & Development
Santee, CA 92071 | www.metalgardenhose.com
Made in China, Designed in the USA
WORLDWIDE PATENTS PENDING

LIMITATION OF LIABILITY

Liability limited to the purchase price of this product. YRD LLC shall not be liable for any incidental or consequential damages or any implied warranty on this product.

Some states do not allow the exclusion or limitation of incidental or consequential damages, so the above limitation or exclusion may not apply to you.

Call us for assistance at +1 (619) 449-2392 or you can email or mail us at: 9545 Pathway Street, Santee, CA 92071
customer@metalgardenhose.com. Our Customer Care Department is available:
Monday - Friday 8:30am to 4:00pm PST / 11:30am - 7:00pm EST