









WG

Wood Products

2022 Installation Instructions for ON-the wall Cabinets

Tools Needed:	Stud Finder, Tape Measure, Pencil, Hammer, drill, 1/8" Drill Bit, Phillips Screwdriver, Phillips Tip, Level
	Depending on the product ordered, your cabinet may be unfinished, primed, or already pre-finished in a color. If your cabinet is unfinished or primed, remove the hinges and store them in a safe place with the screws. Then paint or stain the cabinet as desired. Primed doors can only be painted, not stained. If you want to add hardware to your door after painting or staining, it will be easier to drill the necessary holes with the door off of the cabinet.
	The mounting brackets (See figure A) have already been placed inside the cabinet for you. And the back panel has already been mounted in place with framing tabs that bend over to secure it. If you need to remove it, simply bend the tabs back and pull the panel out. Be sure to put it back in the proper orientation so that it lines up with the holes in the mounting brackets.
	Determine the placement on the wall and mark the location of the mounting brackets on the wall surface. Check to see where studs are in your wall. If your locations match up, great. If not, you can use the included wall anchors instead.
	If using wall anchors, screw those directly into the wall surface (See Figure B) until they are flush. Drilling a 1/8" hole will help the anchor to go in easier and faster. Wall anchors are designed to go in with a Phillips bit on your drill. Then place the cabinet on the wall and line up the brackets with your wall anchors and use the 2" screws to mount the cabinet to the wall. Be sure to use a level on the cabinet.
	Hinge mounting holes have been pre-drilled on either side of the cabinet so that it is reversible. Mount the door on whichever side you desire. Remove the cover cap on each hinge. (See figure E) Re-attach your hinges if you have taken them off of the door. Have a partner help you by holding the door into place while you do the installation, it's easier! Place the door on the side of the cabinet and line up the hinges with the hinge holes marked on that side of the cabinet box. Screw the 3/4" screws (Hardware Bag labeled "Hinge screws") into the hinge hole (see figure C). The hinge should be resting right on the FRONT edge of the cabinet box itself.
	Install your plastic shelf supports (Hardware package labeled - Shelf supports) at the desired locations (See figure D) and insert the shelves into place. Replace hinge cover caps.



**Mounting
Brackets
Already
Installed**

Figure A.



Figure B.

Our custom designed shelf supports keep the shelves in place and do not allow the shelves to rock or come off the supports. Simply slide your shelves in and out of them.

**Orient your shelf supports
UP as shown here**

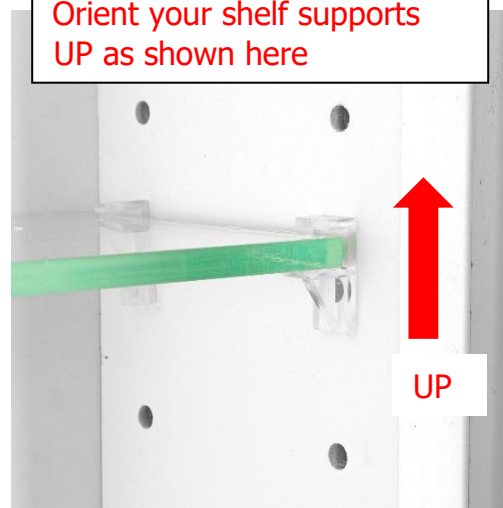

Figure D.



Figure C.



Figure E.

Hints and Tips for a Great Installation

We use a one piece Blum concealed hinge with a built in Blumotion soft close option. The hinges are installed in all the doors. Due to various sizes of cabinets and doors we may ship the door separately from the cabinet to insure the door and hinges will arrive intact and undamaged.



(Exception: Cabinets with slab MDF Doors which must be painted) If this is the cabinet style you purchased the hinges are located in the hardware bag labeled "MDF Door." They only mount one way in the door. Then follow the mounting procedures above.

Hinge Adjustments

There are 4 adjustments on this hinge. **See image below**

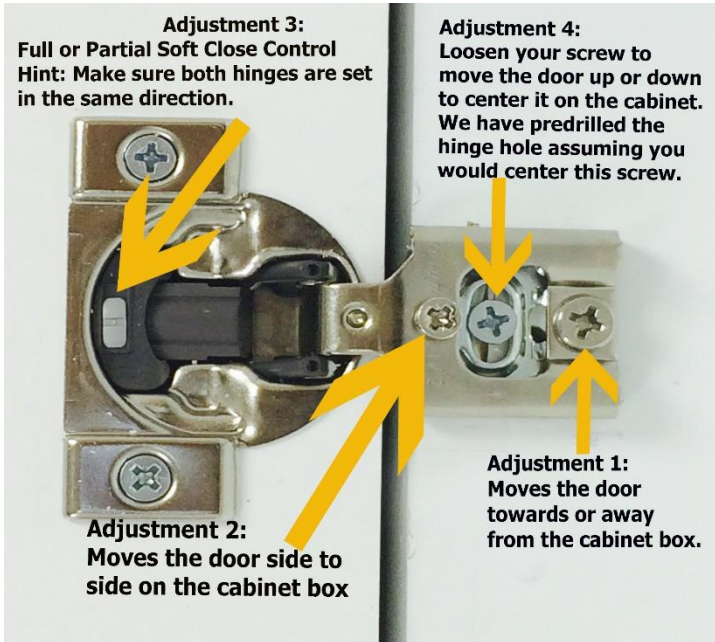

Adjustment #1 - Use this screw to move the door towards or away from the front of the cabinet box (to close the gap between the door and the box). It will only turn about ¼ turn either way.

Adjustment #2 - Use this screw to move the door side to side. It will only turn about ¼ turn either way.



Adjustment #3 - This switch is for full soft close or partial soft close. See tips on last page.

Adjustment #4 - You can loosen your hinge mounting screw and adjust the door slightly up or down, then re-tighten the screw.



Troubleshooting Tips

Occasionally, we have received customer concerns over doors that do not close properly or do not close all the way. There are usually only about five reasons for a door to not close properly and we have covered each one below.

1	<p><u>Soft close hinges are incorrectly setup:</u> There is a gray selector switch in the cup of the hinge as illustrated in the picture above. This switch needs to be in the same direction on both hinges. The switch is a mechanism for 75% closure speed or 25% closure speed meaning it slows the door down when closing at 75% open or 25% open. That is the point where the internal mechanism catches the doors and slows down its closing process.</p>
2	<p><u>Walls are not perfectly flat:</u> In most remodeling projects the beginning surface is not perfectly flat or square despite how it may look. Thus, once the screws are tightened into the side studs it can cause the cabinet box to be bowed or tweaked which can also cause the door to not close properly. Check for plum(level) or square of the installed cabinet. If either of these seems out of line Re-adjust the tension of the mounting screws on the cabinet and or shim around the box to eliminate the binding of the cabinet door.</p>

	<p><u>The door is warped:</u> Solid wood doors do occasionally warp due to the final drying of the wood. There is a simple test you can perform to ensure that your door is not warped. Remove the hinges by taking out the four screws holding them in. The hinges will then just pull out (though they do fit in the holes tightly). Now lay the door down face up on a flat surface such as a table or counter. If the door can rock from corner to corner, it may be warped. 98% of doors will lay perfectly flat. Push down on each corner. If the door rocks, check to see how much it is coming up off the counter. Anything more than 1/8" is a warped door. Anything less than 1/8" is within tolerances and is NOT warped.</p>
	<p><u>Hinge manufacturing defects:</u> All Blum hinges are manufactured to the highest quality standard, and are the leader in the industry. However, occasionally we have run across a hinge that something just wasn't quite right on it. In these instances, replacing the hinge took care of the problem. It is extremely rare to have a defective hinge, but it can happen. If nothing else solves the problem, the hinges could be at fault. Please call us for a replacement hinge.</p>

Still have questions or need help?

	<p>Installation videos are on our website: WGWoodProducts.com Enter the link into your browser: https://www.wgwoodproducts.com/store/agora.cgi?cartlink=Installation_Videos.htm</p>
	<p>Or you can call us at 913-829-6000.</p>