

1. POSITIONING VENTS ON THE ROOF

Distribute the vents evenly spaced across the roof, between the rafters. Position the vents below the ridge so that the vents can only be seen from the back of the house, no greater than 2 feet below the ridgeline.

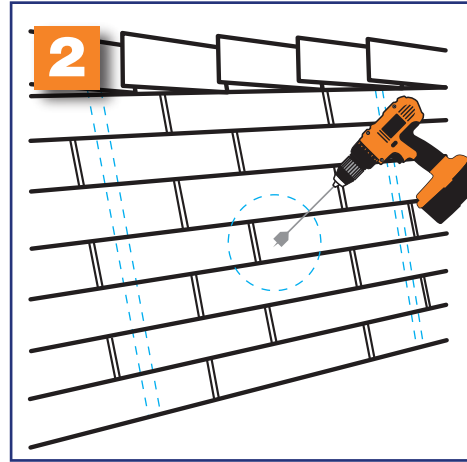

2. DRILL THE GUIDE HOLE

Drill a guide hole near the center position of each vent. Mark the correct diameter for the vent using the chart below.

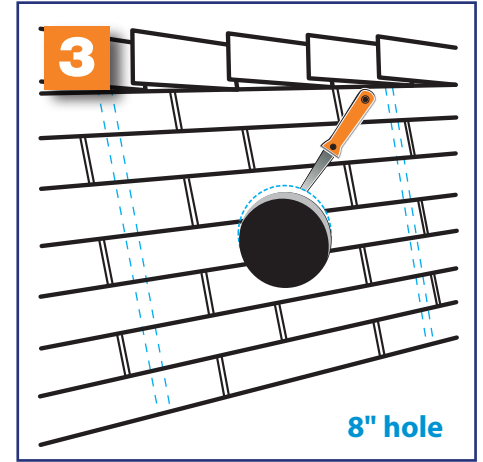

3. CUT HOLE IN THE ROOF

Using a jig or saber saw, cut and remove the shingles and deck inside the circle made in Step 2. Trim back the shingles on the top edge approximately 1 inch to allow for the positioning of the flange.

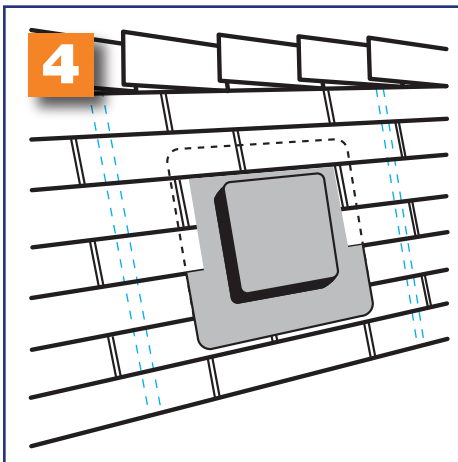

4. POSITIONING THE BASE

Make sure the base flange is parallel to the ridgeline. Slip the upper half of the flange under the shingles. Center the unit over the hole. Shingles should lay on top of the flange except across the bottom where the flange is on top of the shingles

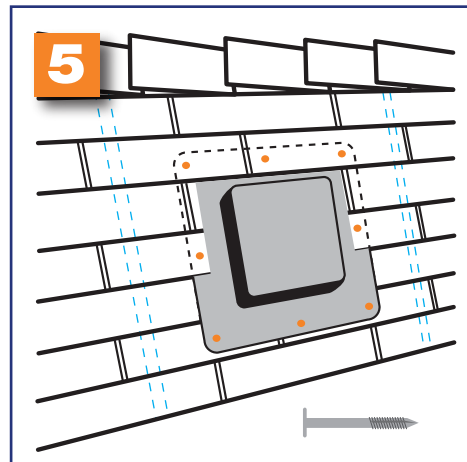

5. SECURING THE BASE

Attach the flange securely to the roof with at least 8 galvanized roofing nails. Nails should be at least 2 inches long and should penetrate the vent, shingles and decking. Use a nail in each corner of the flashing and in the middle of each side. Seal each nail head with caulk.

On plastic vents: use no tar or staples. Use holes provided for installation

Description	N.F.A	Opening
RV38 Square Dome	38 sq. in.	7 3/4 in.
RV40 Slant Back	40 sq. in.	7 1/2 in.
RV50 Slant Back	50 sq. in.	8 in.
RV51 Square Dome	51 sq. in.	8 in.
RV55 Slant Back	50 sq. in.	8 in.
PRV50 Plastic	50 sq. in.	10 1/2 x 8 in.
PRV61 Plastic	61 sq. in.	12 1/2 x 10 in.
RV144 Round	144 sq. in.	14 in.

Metal vents have **sharp edges**. Use gloves to prevent injury. This product is not recommended for direct contact with treated lumber.

Working above grade is inherently dangerous, be sure that **proper fall protection measures** are in place. When working with power tools and sheet metal, gloves and eye protection are **absolutely required**.

These basic installation guidelines are for use with typical or standard applications. It is always recommended to seek advice from a licensed professional, and to check with your local building inspector or building permit office for approvals and possible variations that may apply.