

Item #1005 589 774

Model #H3DETW



USE AND CARE GUIDE

3/8 IN. DRIVE ELECTRONIC TORQUE WRENCH (10-100 FT/LBS)

Questions, problems, missing parts?
Before returning to the store, call
Husky Customer Service
8 a.m. - 7 p.m., EST, Monday - Friday
9 a.m. - 6 p.m., EST, Saturday

1-888-HD-HUSKY

HUSKYTOOLS.COM

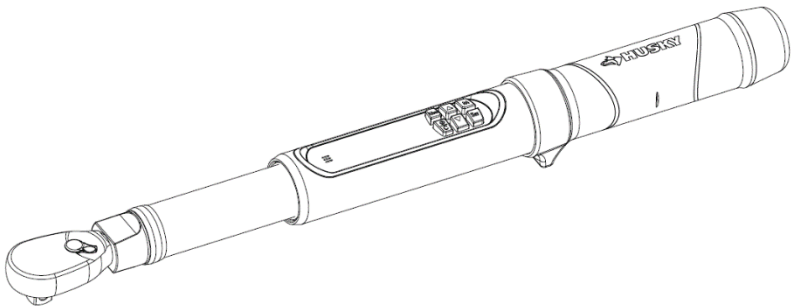

THANK YOU

We appreciate the trust and confidence you have placed in Husky through the purchase of this Electronic Torque Wrench. We strive to continually create quality products designed to enhance your home. Visit us online to see our full line of products available for your home improvement needs. Thank you for choosing Husky!

TABLE OF CONTENTS

Safety/Warranty Information	2	Percentages	5
Warranty	2	How to Use Pre-Set Torque Values	5
Power (On/Off)	3	How to Set Torque with Angle.....	5
LCD Display and Function	3	Battery	6
Settings	4	Low Battery	6
How to Change Unit of Torque Measurement	4	Changing Batteries.....	6
How to Set Mode	4	Operation	7
How to Set Target Torque in "Peak Torque" Mode	4	How to Apply Torque	7
How to Set Angle.....	4	Maximum Capacity Exceeded	7
How to Change "Target Torque Alert" and "Target Angle Alert"	5	Extensions.....	7
		Certification	7

SAFETY INFORMATION

- Never use the torque wrench with the power off. Always turn on the torque wrench so the applied torque is measured.
- Do not press any key while torque is being applied.
- Do not use electronic torque wrench to loosen fasteners.
- Verify the calibration of the wrench if you know or suspect its capacity has been exceeded.
- Periodic recalibration is required to maintain accuracy.
- Never apply more torque than the maximum wrench capacity or the maximum fastener specifications.
- Do not immerse in fluids.
- Do not use on live electrical circuits.
- Electrical shock can cause injury. Rubber handle is NOT insulated.

**WARNING:**

Do not use on live electrical circuits.

**CAUTION:**

Rubber handle is NOT insulated.

NOTICE: Read and understand this manual before use. Improper use of tool can result in damage to tool and/or work piece.

WARRANTY

LIMITED LIFETIME WARRANTY

WHAT IS COVERED

If this Husky product ever fails due to a defect in material or workmanship, return the product to any Home Depot retail store for replacement with an item of equal or greater value.

WHAT IS NOT COVERED

This warranty excludes incidental/inconsequential damages and failures due to misuse, abuse, calibration or normal wear and tear. This warranty gives you specific rights, and you may also have other rights, which vary from state to state. Contact the Customer Service Team at 1-888-43-HUSKY or visit www.HUSKYTOOLS.com.

POWER (ON/OFF)

POWER ON

1. Verify torque is not being applied to the wrench. Press $\frac{\text{ON}}{\text{C}}$ for 1 second. Wrench will beep once.
2. The wrench will default to Peak Torque Mode. The last unit of measurement and last torque setting will display.
3. The wrench is ready to use.

POWER OFF

1. If no torque is applied, wrench will shut off automatically after 180 seconds.
2. To shut off manually, verify torque is not being applied then press $\frac{\text{OFF}}{\text{C}}$ for 3 seconds.

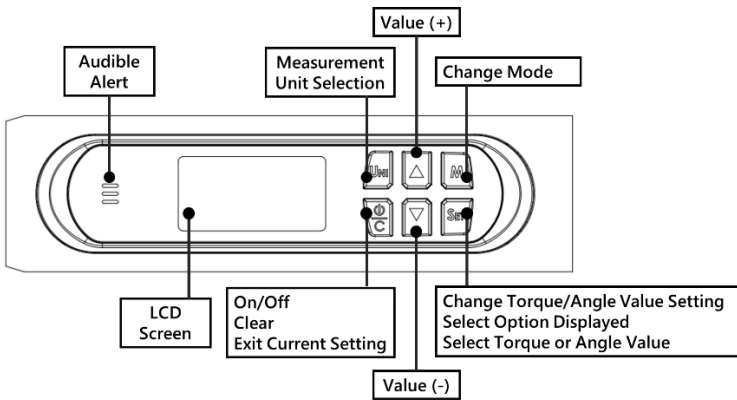

SETTINGS

HOW TO CHANGE UNIT OF TORQUE MEASUREMENT

1. Power on the wrench as described on Page 3. Press "UNI" repeatedly to select one of the five torque measurement options: Ft-lbs., In-lbs., Nm, Kg-m or Kg-cm
2. The wrench is ready to use.

HOW TO SET MODE

There are four mode options: P = Peak Torque (default), A = Angle, PA = Peak Angle, PCt = Target Torque Alert Setting

1. Power on the wrench as described on Page 3. Press "M" repeatedly to scroll through the different modes. "SEL" will show at the top of the screen to indicate the mode being selected.
2. Press "SET" to select the new mode. The screen will show the last setting for the mode selected.
3. The wrench is ready to use.

Note: To exit out of setting mode without changing the mode, press $\frac{\text{OFF}}{\text{C}}$. The current mode and setting will remain unchanged.

HOW TO SET TARGET TORQUE IN “PEAK TORQUE” MODE

1. Power on the wrench as described on Page 3. Press “SET”. The current torque setting will display, the “tor” sign will flash on the screen.
2. The unit of torque measurement can also be adjusted at this time. Press “UNI” to change it if required.
3. Press “**up**” or “**down**” to select the torque value, then press “SET” to confirm the value.
4. The wrench is ready to use.
5. Apply torque and rotate the wrench at a constant moderate speed until alerted to stop by the handle vibration, beeps and LCD display. The LCD screen alternates red/green when the “target torque alert” warning starts. When the target torque is reached the LCD Screen shows solid red.

Note: After reaching the target torque the display will flash for 10 seconds, then default to the last setting. The next measurement can be taken while the screen is flashing by applying force again, or by pressing $\frac{\text{tor}}{\text{C}}$ to return to the last setting.

HOW TO SET ANGLE

1. Power on the wrench as described on Page 3.
2. Press “M” until the “A” mode is reached, then press “SET”.
3. The screen will display the last angle value set.
4. If desired angle is displayed, the wrench is ready to use.
5. If you want a different angle, press “SET” again to change the angle degree. Press “**up**” or “**down**” to get to the required angle, then press “SET”.
6. The wrench is ready to use.
7. Apply torque and rotate the wrench at a constant moderate speed until alerted to stop by the handle vibration, beeps and LCD display.
8. To take the next measurement press $\frac{\text{tor}}{\text{C}}$ or wait until the display stops flashing.

Note: After reaching the target angle the display will flash for 10 seconds, then default to the last setting.

SETTINGS

HOW TO CHANGE “TARGET TORQUE ALERT” AND “TARGET ANGLE ALERT” PERCENTAGES

1. Power on the wrench as described on Page 3. Press “M” until the “Pct” mode is reached, then press “SET”.
2. The current value will display on the screen.
3. Press “**up**” or “**down**” to select when the target torque alert will start. The target torque alert can start at a maximum of 50% to the target torque value or a minimum of 15% to the target torque value. For example, if your target torque is 100 ft-lbs and your target torque alert is set at 50%, the alert will start when you reach 50 ft-lbs. Press “SET” to save.
4. The screen will show “Ang” so the target angle alert can be adjusted.
5. Press “SET” to change the target angle alert setting. Press “**up**” or “**down**” to select when the target angle alert will start. The target angle alert can start at a maximum of 90 degrees before the target angle or a minimum of 15 degrees before the target angle. Press “SET” to save.
6. The wrench is ready to use.

HOW TO USE PRE-SET TORQUE VALUES

1. Power on the wrench as described on Page 3. Press “SET” then “M”. The setting number will flashing at the top of the screen and the torque value will be displayed.
2. Press “**up**” or “**down**” to select the desired pre-set torque value and then press “SET”.
3. The wrench is ready to use.

HOW TO CHANGE PRE-SET TORQUE VALUES

Pre-Set Torque Values can only be selected in Peak or Peak Angle modes

1. Power on the wrench as described on Page 3. Press “SET” then “M”. The Pre-Set number will flash at the top of the screen and the torque value will be shown.
2. Press “**up**” or “**down**” to select the desired pre-set torque value, then press “M” for 1 second.
3. Now the “tor” sign at the top of the screen will flash. Press “**up**” or “**down**” to select the desired torque setting, then press “SET”. The new Pre-Set Value is saved into the Pre-Set options.
4. Press “SET” again to set the target torque to the new Pre-Set value.

HOW TO SET TORQUE WITH ANGLE

1. Power on the wrench as described on Page 3.
2. Press “M” until the “PA” mode is reached, then press “SET”.
3. The screen will show last angle and torque values set.
4. If the desired angle and torque values are displayed, the wrench is ready to use.
5. If you want a different torque value or angle, press “SET” again.
6. To change the torque value press “**up**” or “**down**” to get to the required value, then press “SET”. The screen will show angle value with “Ang” sign flash. If the target angle value previously displayed is correct, press “c” to exit.
7. After setting the torque value, the screen will flash “tor”. Press “**up**” or “**down**” change the angle value to get to the required angle value, then press “SET” again.
8. The wrench is ready to use.
9. Apply torque and rotate the wrench at a constant moderate speed until alerted to stop by the handle vibration, beeps and LCD display.

Note: After reaching the target torque, the wrench will start recording the angle measurement. After reaching both the target torque and target angle, the display will flash for 10 seconds then default to the last setting. To take the next measurement press  or wait until the display stops flashing.

BATTERY

LOW BATTERY

1. When the remaining battery capacity is at 80%-100%, the high battery icon will display.
2. When the remaining battery capacity is at 50%-80%, the mid battery icon will display.
3. When the remaining battery capacity is at 10%-50%, the low battery icon will display. The Electronic Torque Wrench will still function, but the battery will need to be replaced soon.
4. When the remaining battery capacity is at 10%, the low battery icon will show continuously. The Electronic Torque Wrench will not function correctly. Immediately replace the batteries.

CHANGING BATTERIES

1. Use AA (Alkaline) Batteries only.
2. Remove Batteries if the torque wrench is not used for an extended period of time.
3. Unscrew the end cap.
4. Insert two AA (Alkaline) Batteries (Positive end first).
5. Replace the end cap. The wrench will beep once if installed correctly.

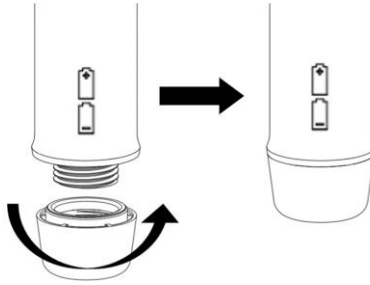

OPERATION

HOW TO APPLY TORQUE

1. This Electronic Torque Wrench is designed so that when force is properly applied to the hand grip, a continuous audible signal, the LCD screen display and vibration in the handle will indicate that the Target Torque or Angle has been attained. DO NOT pull beyond this point.



CAUTION: The audible signal, LCD screen display and vibration in the handle are indicators that the proper torque or angle has been attained. Over torquing beyond these signals could cause fastener failure.

2. To properly apply torque, attach the socket securely on the torque wrench square drive and position the socket on the fastener so that tilting will not occur. Grasp the center of the hand grip and apply a slow steady increasing force perpendicular (90 degrees) to the torque wrench body and perpendicular (90 degrees) to the center line of the square drive, socket and fastener.
3. Turn the fastener down with a smooth and even force applied to the handle of the torque wrench. As turning resistance increases, pull more slowly. To assure accuracy, the fastener must be in motion when the torque measurement is made.



WARNING: Any change from the above procedure will result in a change of torque being applied. DO NOT USE universal joints or universal sockets due to the complexity of determining the associated error.

MAXIMUM CAPACITY EXCEEDED

1. When the applied torque exceeds the wrench full-scale capacity the LCD screen will show red and display "ovEr".
2. Verify the calibration of the wrench if you know its capacity has been exceeded.

EXTENSIONS

1. When it is necessary to use an extension that changes the effective lever length of the torque wrench, torque being applied will change.

Compute adjustments as follows: TW - Torque set on Wrench

TE - Torque applied by the extension to the fastener

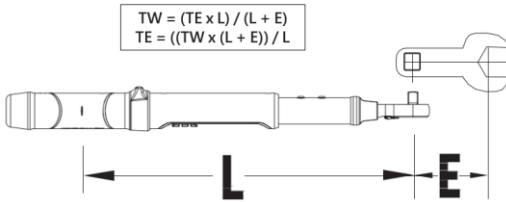

2. Apply torque and rotate the wrench at a constant moderate speed until alerted to stop by the continuous audible signal, the LCD Screen display and handle vibration.

Note: Socket extension bars that are axially in line with the square drive do not cause error and need no adjustment.

CERTIFICATION

This torque wrench was calibrated prior to shipment from the factory within tolerance limits of:

- Torque: +/- 2% Clockwise (Right handed) +/- 3% Counter Clockwise (Left Handed) from 20% to 100% of capacity
- Angle: (+/- 1% of reading) + (+/- 1 degree @ angular velocity >10 degree/sec <180 degree/sec) + (+/- 1 degree of test fixture)



Questions, problems, missing parts?
Before returning to the store, call Husky Customer Service
8 a.m. - 7 p.m., EST, Monday-Friday, 9 a.m. - 6 p.m., EST, Saturday

1-888-HD-HUSKY

HUSKYTOOLS.COM

Retain this manual for future use.