

iSpring Water Systems

WSP-ARB/ WSP-B Series USER MANUAL Ver.07/2020



 **Filter.com**

iSpring Water Systems, LLC (since 2005)

Copyright ©2005-2020 ISPRING WATER SYSTEMS, LLC. All rights reserved.

OVERVIEW

iSpring WSP-ARB/WSP-B

Reusable Spin-down Sediment Water Filter with Scraper and Auto Flushing Module

The iSpring WSP-ARB/WSP-B filters out particulate, sediment, rust, floating objects and other pollutants in water. It should be installed as a central water purification pre-filter to protect terminal equipment and appliances such as downstream pipelines, water purifiers, water heaters, wall-hung boilers, washing machines, and showerheads.

The iSpring WSP-ARB/WSP-B is flushable and reusable. A toggle switch allows particles trapped in the filter to be flushed out without having to shut down the water supply first.



Product Specification

Model Name: WSP-ARB/WSP-B

Flow Rate: 22-35 GMP

Feed Water Temperature: 40°F - 100°F

Connector Size: 1 inch MNPT, 3/4" FNPT, and 3/4" inch Push-Fit

Auto Flushing Module Specification

Dimension: 4.2 In. (L) X 3 In. (W) X 2.4 In. (D)

Power: 100-240V 5V/1A or 3 X AA Battery

Temperature: 40°F - 100°F

PRODUCT FEATURES

- System is constructed with, 316L food grade stainless steel precision filter mesh;
- Integrated auto flushing module with scraper that can trap all kinds of sediments without needing to remove the filter;
- Core components are made of materials that are pressure resistant;
- Explosion-proof transparent housing provides clear visibility and is intuitive and convenient to use;
- Cleaning features conveniently remove contaminant buildup from the filter housing with a just a few turns of the scraper knob;
- Universal fittings are easily installed and adaptable to other applications.

INSTALLATION AND MAINTENANCE TIPS

- This system must be installed in a dry indoor environment away from heat sources;
- This system is only suitable for 40°F - 100 °F municipal tap water; please do not use with wastewater and corrosive liquids;
- During installation, make sure that the direction of water flow marked on the valve body is consistent with the flow direction of the pipeline;
- The installation location must provide reliable drainage;
- Depending on water quality, it is necessary to flush the filter screen at least once a month;
- Take care to protect the components during regular cleaning and maintenance.

We are committed to providing you with complete and reliable products and service.

Please contact us immediately if you have any questions.

PARTS IDENTIFICATION

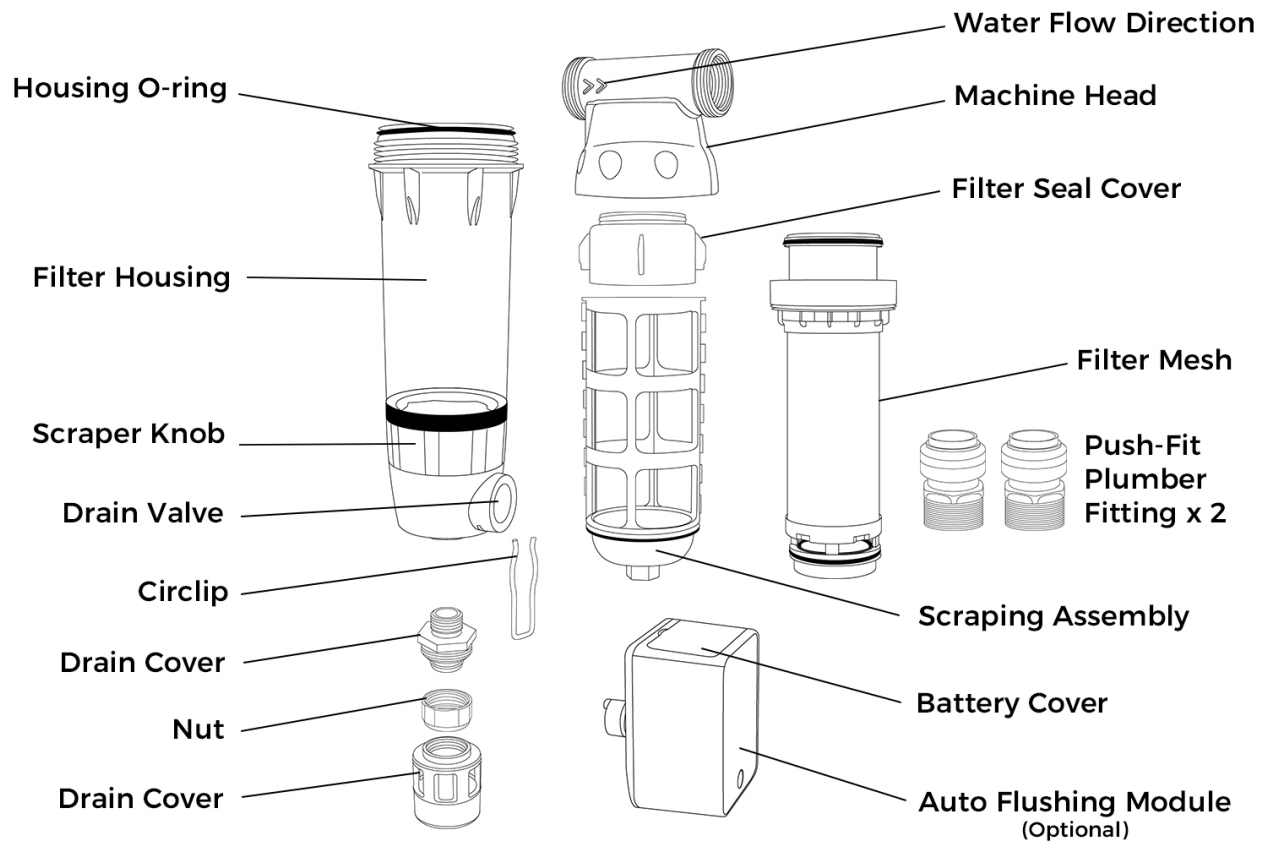

HOW TO INSTALL

To fit different plumbing sizes, the unit comes with two types of threads on both ends: 1 inch MNPT, 3/4" FNPT, and 3/4" inch Push-Fit

Please pay attention to the flow direction indicated by the arrow.

- Close the main inlet valve and drain the remaining water from the pipe.
- When installing, make sure that the direction of water flow marked on the valve body aligns with the direction of water flow in the pipeline.
- After the filter is installed, the filter housing assembly must be kept upright.

Apply plumber's tape

- PPR pipeline installation requires firm welding with special welding equipment.
- This product should not be installed outdoors. It should be located away from direct sunlight, heat sources, fuel oils, and chemicals.
- Make sure to apply plumber's tape evenly.
- When tightening the hex nut with a wrench, make sure that other parts are not turning with it.
- After the filter is installed, check for any water leakage at the joints.

PRODUCT INSTRUCTIONS

- After installation, open the inlet water main valve to allow water flow into the filter.
- Before flushing, ensure that there is a reliable drainage system. You can also flush the drain water in to a suitable container.
- Turn the drain valve knob to flush the drain.
- Press the on/off button to turn on the auto flushing module (optional) on, then press the "drain" button to flush the drain.
- Turn the scraper knob clockwise or counterclockwise 3 to 4 times while draining the water to clean the filter mesh.
- We recommend flushing at least once a week for 30 seconds each time, depending on the quality of the incoming water.
- To clean the filter cartridge after it has been used continuously for 8-12 months, remove the stainless steel filter mesh and clean it with a brush or soak it in vinegar. For best results, we recommend that it be professionally cleaned.

DISASSEMBLING THE FILTER CARTRIDGE

- Buildup on the filter mesh can affect water output. If normal scraping or rinsing doesn't remove the buildup, we recommend removing the filter assembly.

- To remove the filter assembly, unscrew the filter housing counterclockwise using the included wrench.
- Remove the filter assembly and clean the filter mesh.

Note: You do not need to remove the scraping assembly if you're only cleaning the filter assembly.

INSTALLING THE SCRAPING AND FILTER ASSEMBLIES

- To insert the scraping assembly into the filter housing, place the quadrilateral hole with rounded corners into the hexagonal hole on the bottom of the filter housing, and insert it into the bottom.
- When installing the filter assembly, align the four 'bumps' inside the scraper assembly with the four grooves on the upper filter housing, and insert it into the bottom.

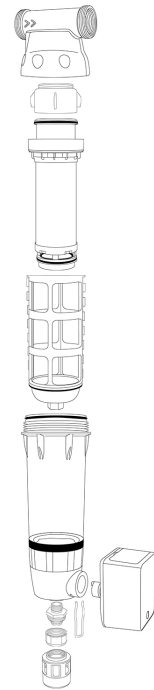

TROUBLESHOOTING

Issue	Possible Causes	Solutions
No water	Water source doesn't have water. Inlet water valve isn't open.	Wait for water to come back on Open the inlet valve
Low outlet flow	Inlet water valve isn't fully open. Surface of the filter is partially blocked.	Fully open the inlet valve Flush the filter mesh to remove debris
Water leakage at the joint	Filter parts have been disassembled. Loose parts at the leaking location Not enough Teflon tape on the threads. O-rings at the leaking location are damaged.	Check to see if the seal is misaligned or missing. Retighten the threaded joint with a wrench. Reapply plumber's tape and tighten. Replace O-rings.
Does not display pressure values	Pressure gauge is damaged. Inlet water valve isn't open.	Replace pressure gauge. Open the inlet valve.

CUSTOMER SATISFACTION AND WARRANTY REGISTRATION

To register your product for the warranty, please visit our website at 123filter.com and go to the “Warranty Registration” tab.

We provide a 30-day money back guarantee, a 1-year manufacturer warranty, and lifetime tech support for all of our products. If you ordered from a website other than 123Filter.com (Amazon, Home Depot, etc.), please be sure to fill in your order information upon registration of your system. If you have any questions or concerns about your product, please do not hesitate to call or email us, or you can use the notes/comments section upon your warranty registration. Your satisfaction is key to our business!

If you are happy with our products and service, please show your support by writing a product review on Amazon. Even just a single line takes you just a minute, but means a lot to us. Thank you!

How to Contact Us

Office Hours: Monday-Friday, 8:30 am - 5:30 pm EST

Phone: (678) 261-7611

Email: support@123filter.com



iSpring Water Systems, L.L.C.
3020 Trotters Pkwy, Alpharetta, GA 30004
(678) 261-7611