

SURFACE MOUNT INSTALLATION MANUAL



THE
MURPHY
DOORTM

— CREATIVE DOORWAY SOLUTIONS —



Scan code to launch installation video

This is a DIY (Do It Yourself) project. You should have a basic understanding of assembly procedures, as well as experience and confidence in your ability to perform the steps in these instructions. If this is not the case, we recommend contacting a professional contractor for assistance.

REQUIRED TOOLS & HARDWARE

TOOLS (NOT INCLUDED)

- Drill
- 7/8" Forstner Drill Bit
- Shims
- #2 Phillips Screw Driver Bit
- Stud Finder
- #30 Torx Bit



HARDWARE (INCLUDED)

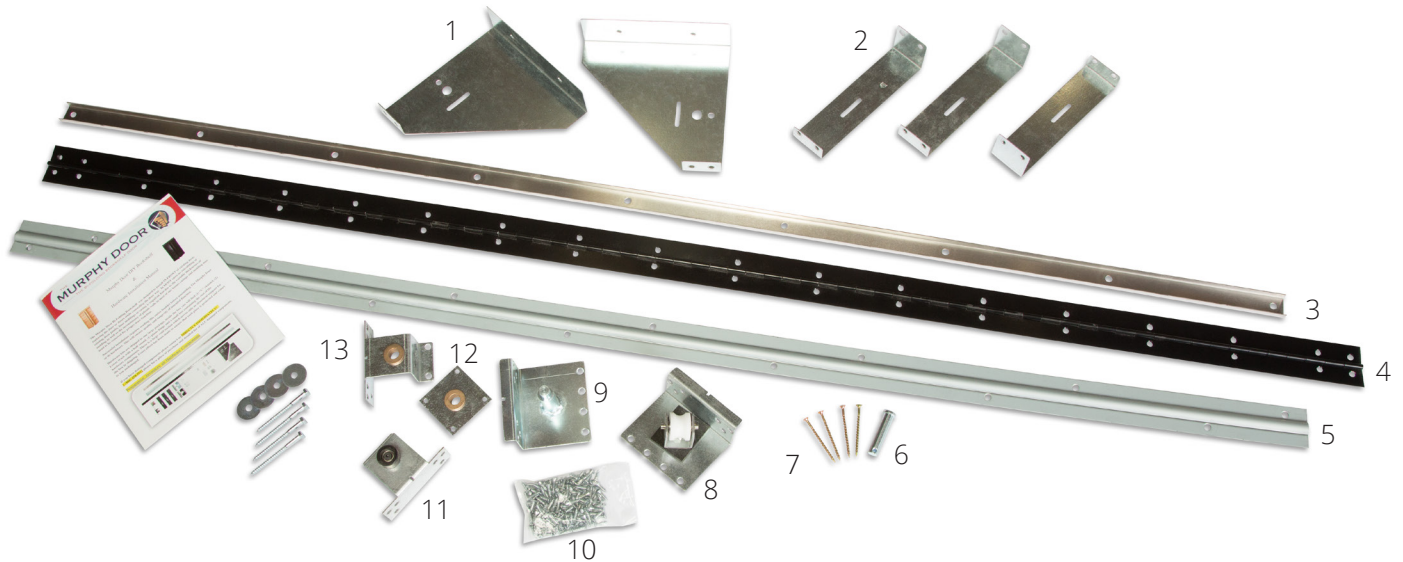

- | | | |
|---------------------|--------------------|---------------------------------|
| 1) Gussets | 6) Upper Pivot Pin | 11) Upper Track Guide Wheel |
| 2) Spanner Brackets | 7) Torx Lag Screws | 12) Threshold Pivot Pin Bushing |
| 3) Upper Track | 8) Trolley | 13) Bookshelf Pivot Pin Bushing |
| 4) Hinge | 9) Lower Pivot Pin | |
| 5) Lower Track | 10) Screws | |

STEP 1 - Install Bottom Hardware

Lay the door on a flat work surface with the hinge facing up.



Identify the two pieces of hardware that will be installed in the bottom of the door.



Lower Pivot Pin

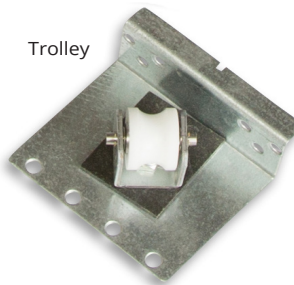

Trolley

Place the lower pivot pin in position and use ten of the included screws to fasten in place.

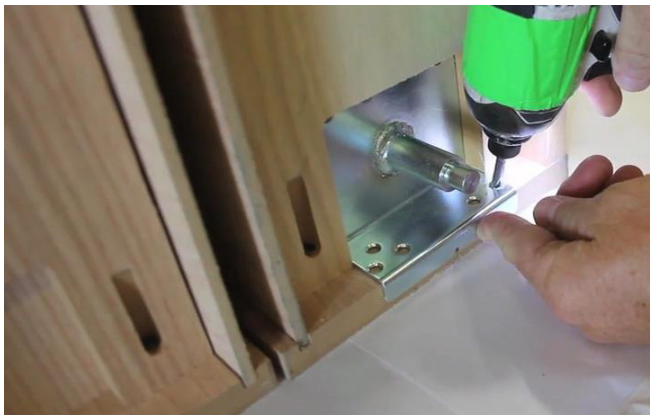

HARDWARE PLACEMENT

Right Hand Door

- Lower Pivot Pin (Left Side)
- Trolley (Right Side)

Left Hand Door

- Lower Pivot Pin (Right Side)
- Trolley (Left Side)

The trolley will be attached to the opposite side of the bottom of the door. For the wheel to sit in position properly, you must drill a $\frac{7}{8}$ " hole deep enough to accommodate the bolt on the back of the trolley.



The easiest way to determine the position for the hole is to place the trolley in position and strike the bolt with enough force to make a slight indentation in the wood.



Use the $\frac{7}{8}$ " Forstner bit to drill just enough depth for the bolt to sit in. Do not drill any deeper than is necessary for the wheel piece to fit properly in its position, being careful NOT to drill through the cabinet.



Place the wheel piece in position to make sure that it sits flush and then fasten it in place with 10 of the included screws.



STEP 2 - Install Top Hardware

In the below photo, the bookshelf pivot bushing is on the left and the threshold pivot pin is on the right. To build a right hand door, attach the bookshelf pivot bushing on the right side. This piece will receive the hinge pin upon installation of the door. Attach the threshold pivot pin on the opposite side as shown below. This piece will ride in the track that will be screwed to the bottom of the valance.



Place both pieces into their corresponding indentations and secure with all ten screws.

STEP 3 - Valance and Floor Track

There are two pre-drilled holes on either end of the valance. For a right hand swing, slide the track all the way to the left, exposing the predrilled hole on the right side and secure the track with the provided screws. Do the opposite for a left hand swing.



Position the floor track on the floor where you want to install the surface mount door. The pivot hardware attached to the bottom track should be on the right hand side for right swing door, or on the left side for a left swing door.



Make sure the track is parallel with the back wall and measures 5 1/4" from the wall to the center of the track. Secure track to a wood floor, by removing a few of the 3/4" screws from the track and replacing them with a 3" grabber screw or similar. If securing to a concrete floor, a hammer drill or construction adhesive is recommended.





STEP 4 - Installing Door Into Position

(This step requires two people.)

Set the door upright so that the pivot hardware can be placed into its counterpart on the floor track. Set the wheel on its track and extend the door to its fully closed position.



STEP 5 - Install Valance

Place valance in position on the top of the door. Use shims on both sides of the door as shown in the photo to create a 1/16" reveal between the valance and the door. This space will allow the door to open and close properly without making contact with the bottom of the valance.



Align the hole in the valance on the pivot side with the corresponding hardware on the top of the door and insert the hinge pin.

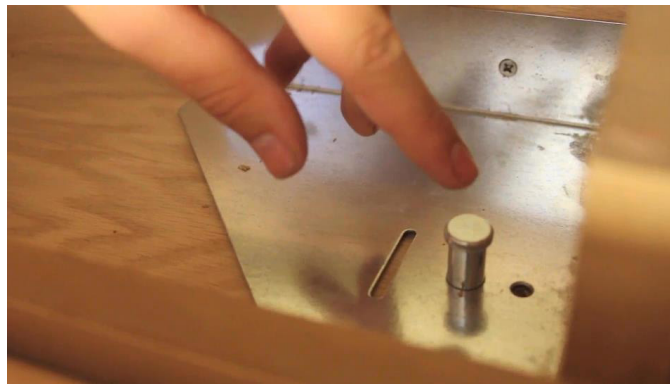

Use a stud finder to insure that you achieve the strength necessary to hold the valance in place, then secure it to the wall with the supplied Torx lag screws using the #30 Torx bit.

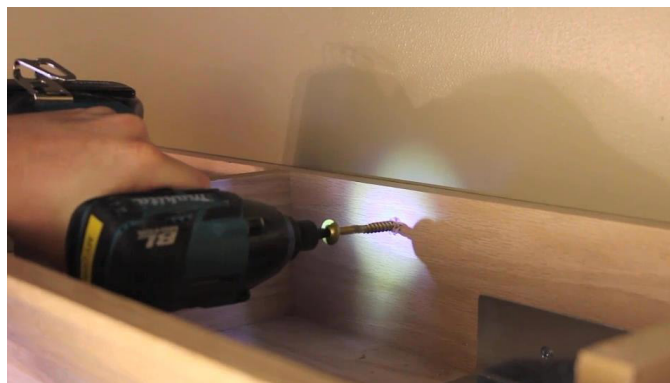



Remove all shims and operate the door moving it to the fully open position and then extend it back to the closed position to ensure proper clearances.



WARNING - DO NOT EXCEED THE WEIGHT LIMITS

This weight limit is based on a statically loaded bookcase door that is secured in a standard wood framed door opening for a Flush Mount Door, or secured to the door header or studs on a Surface Mount Door. The jambs are designed to be built into a standard 2 X 4 wood framed doorway, and adequately secured in the rough opening.

NOTE: This installation is intended for a wood framed home, if your home is steel framed, stop the installation and call 888-458-5911.

Do not overload the Bookcase Door.
Do not climb on or hang from the Bookcase Door.
Routinely inspect the Murphy Door to ensure screws and hardware sets are seated properly.

THESE WARNINGS DO NOT REPLACE YOUR SOUND JUDGEMENT AND DECISION MAKING. IF FOR ANY REASON YOU FEEL THE QUALITY OF YOUR DOORWAY STRUCTURE IS IN QUESTION, DISCONTINUE THE INSTALLATION PROCESS IMMEDIATELY.

DO NOT CONTACT THE RETAILER FOR QUESTIONS. CONTACT MURPHY DOOR DIRECTLY:
888-458-5911
cs.dept@murphydoor.com

Use the Murphy Door wisely and enjoy your newfound space!