











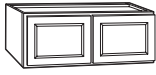

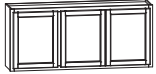



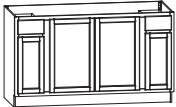

Wall Cabinets (12"D unless noted)			Model #	Internet #	
	30"H	9"W	KW930-UF	302969457	
		12"W	KW1230-UF	302969868	
		15"W	KW1530-UF	302969882	
		18"W	KW1830-UF	302969894	
		21"W	KW2130-UF	302969915	
		24"W	KW2430-UF	302969955	
	36"H	9"W	KW936-UF	302970068	
		12"W	KW1236-UF	302970077	
		15"W	KW1536-UF	302970082	
		18"W	KW1836-UF	302970089	
		21"W	KW2136-UF	302970093	
		24"W	KW2436-UF	302970103	
		30"H	27"W	KW2730-UF	302969965
			30"W	KW3030-UF	302970052
36"W			KW3630-UF	302970063	
36"H		27"W	KW2736-UF	302970109	
		30"W	KW3036-UF	302970122	
		36"W	KW3636-UF	302970144	
Corner Wall (Installs in 24" x 24" wall area)					
	30"H	24"W	KWD2430-UF	302970176	
	36"H	24"W	KWD2436-UF	302970185	
Wall Bridge					
	12"H	30"W	KW3012-UF	302970193	
		36"W	KW3612-UF	302970197	
	15"H	30"W	KW3015-UF	302970213	
		36"W	KW3615-UF	302970220	
	18"H	30"W	KW3018-UF	302970225	
		36"W	KW3618-UF	302970239	
	23-1/2"H	30"W	KW3024-UF	302970248	
		30"W x 15"D	KW302415-UF	302970260	
		36"W	KW3624-UF	302970255	
	24"H	54"W	KW5424-UF	302970265	
Base Cabinets (34-1/2"H x 24"D unless noted)					
		9"W	KBF09-UF	302970284	
		12"W	KB12-UF	302970286	
		15"W	KB15-UF	302970293	
		18"W	KB18-UF	302970301	
		21"W	KB21-UF	302970306	
		24"W	KB24-UF	302970315	
		27"W	KB27-UF	302970318	
		30"W	KB30-UF	302970323	
		36"W	KB36-UF	302970327	

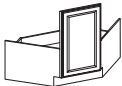

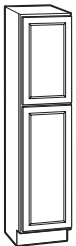
Base Cabinets (continued)		Model #	Internet #	
Drawer Base				
	18"W	KDB18-UF	302970336	
	24"W	KDB24-UF	302970345	
Sink/Cooktop Base				
	30"W	KSB30-UF	302970436	
	36"W	KSB36-UF	302970439	
	60"W	KSBF60-UF	In-Stock	
Accessible Sink Base				
	36"W	KSBA36-UF	302970454	
Corner Sink Base - Ready to Assemble				
	36"W	KCSB36-UF	302970458	
Blind Base				
	36"W	KBBC45-UF	302970464	
Corner Base with Lazy Susan (Installs in a 36" x 36" wall area)				
		KBLSN36-UF	302970467	
<b>Specialty Cabinets</b>				
Pantry (18"W) (Minor assembly of toe kick is required on 96"H pantry)				
	84"H	KP1884-UF	302970471	
	90"H	KP1890-UF	302970474	
	84"H	24"W	KPDR2484-UF	In-Stock



Accessories	Model #	Internet #
<b>End Panels</b>		
! Wall Veneer 30"H (2/pack)	KASKW30-UF	302980476
! Wall Veneer 36"H (2/pack)	KASKW36-UF	302980489
! Base Veneer (2/pack)	KASKB35-UF	302980492
Dishwasher End Panel	KADEP-UF	302980512
<b>Fillers</b>		
3"W x 30"H	KAFS330X-UF	302979814
6"W x 30"H	KAFS630X-UF	302979830
3"W x 36"H	KAFS336X-UF	302979870
6"W x 36"H	KAFS636X-UF	302979885
3"W x 91-1/2"H	KAFS396X-UF	302979895
<b>Drawers and Moldings</b>		
! Toe Kick Molding 91-1/2"L	KATKX-UF	302979901
Shoe Trim Molding 91-1/2"L	KAMTX-UF	302979927
Scribe Molding 91-1/2"L	KAMSX-UF	302980052
Traditional Crown Molding 91-1/2"L	KAMC5X-UF	302980066
Outside Corner Molding 91-1/2"L	KAOCMX-UF	302980069

! Indicates required accessory to complete your project

Dimensions are rounded and are provided for general guidance only. For proper installation on all Hampton Bay products, refer to instructions printed on product carton, or included in package, or online (with each product). The manufacturer reserves the right to discontinue the sale or change the specifications of any product at any time. Every effort was made to assure accuracy of the information contained herein at the time of printing, however, the manufacturer makes no representations to such accuracies.



# Plan your layout

## Design Tips

- Start with the first wall on the left and work to your right around the room. Measure the overall length of each wall.
- Indicate breaks in walls (windows, doors, closets) by measuring to the outside edge of the SJMolding. Include permanent appliances, air vents, electrical, plumbing, etc.
- Start sketching your cabinets. Start in the 0", 0" corner and work outward.

You may be able to SJMve major appliances several inches to accomSJMdate a layout change.

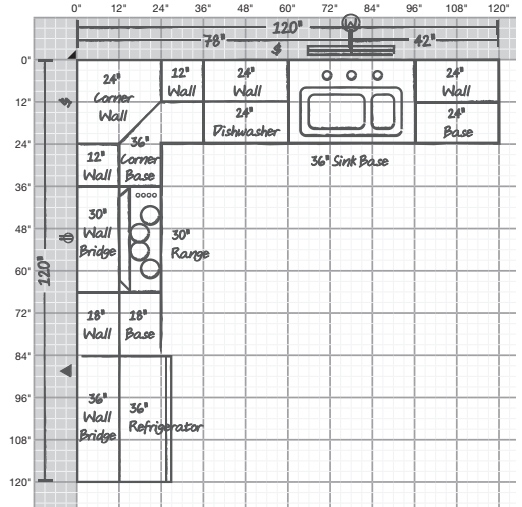

## Designing with Different Wall Cabinet Heights

Typical layouts with 8-foot ceilings

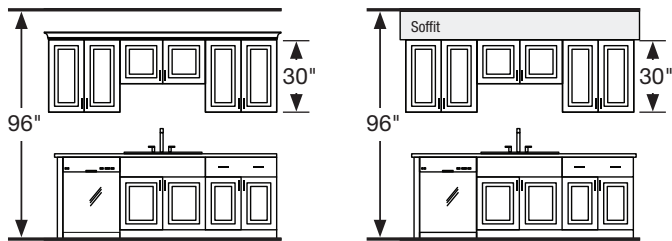

Maximize storage with taller walls and pantries

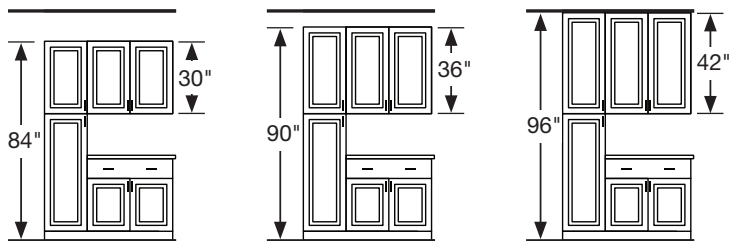

Achieve different looks

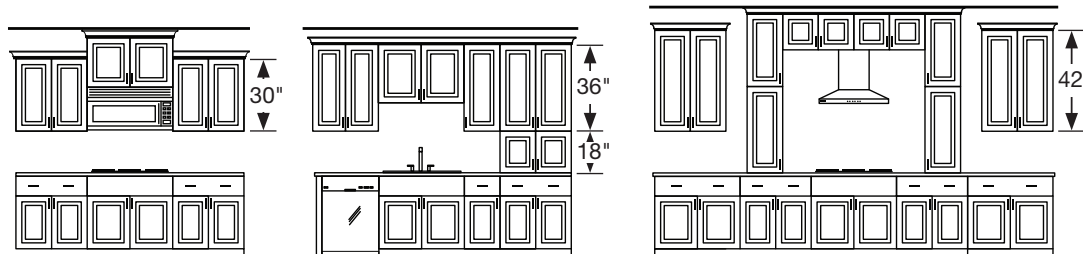

## How to Turn the Corner

Lazy Susan Option

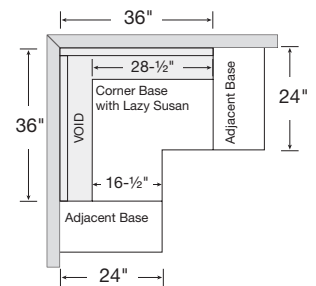

Block Out Option

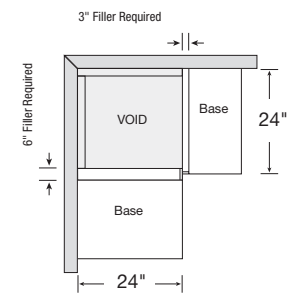

Blind Base Option

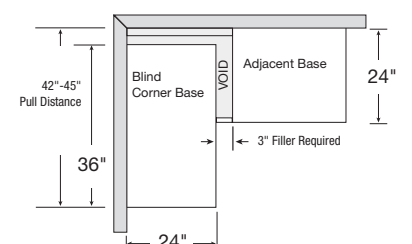



0" 12" 24" 36" 48" 60" 72" 84" 96" 108" 120" 132" 144" 156" 168" 180" 192"

0"  
12"  
24"  
36"  
48"  
60"  
72"  
84"  
96"  
108"  
120"  
132"  
144"  
156"  
168"  
180"  
192"  
204"  
216"  
228"

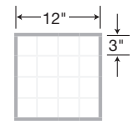

**Large Squares = 12"**  
Cuadrados grandes = 12"  
**Small Squares = 3"**  
Cuadrados pequeños = 3"