

INSTALLATION INSTRUCTIONS FOR 1" BLACKOUT/CEILING CURTAIN ROD

CEILING MOUNTED:

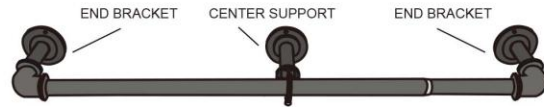

WALL MOUNTED:



NOTE: Please note 28 to 48 inch rod does not come with a center support.

- 1** Place brackets against wall/ceiling at desired locations. Mark screw holes with a pencil. Be sure marks are level across opening. **DO NOT MOUNT UNTIL STEP 6.** Keep in mind that at least one bracket will be mounted on each inner and outer rod to prevent rod movement when sliding curtain.

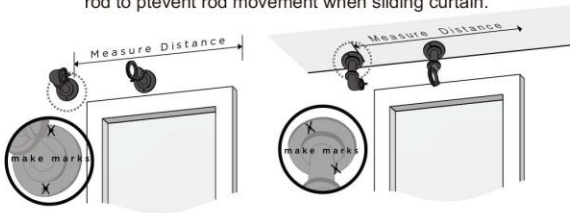

- 2** If screws are going directly into wood trim or wall/ceiling studs, drill a 1/8" pilot hole at pencil marks. If screwing into drywall, follow drywall anchor instructions at the bottom of the page.

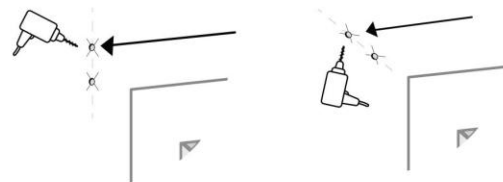

- 3** Assemble the rod by inserting and sliding the smaller diameter rod into the larger diameter rod. Ensure that finials inserts are exposed on each open end after rod assembly.

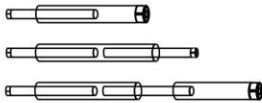

- 4** Slide curtains or curtain rings and center supports (if provided) onto rods.



- 5** Screw-on end brackets to the two ends of rods by turning the end brackets.



- 6** Insert screws through center supports and end brackets, and tighten screws until you feel increased resistance.



- 7** Tighten screws on center supports.

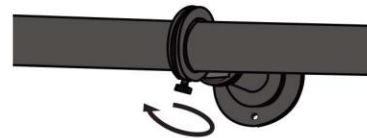

DRYWALL ANCHOR INSTALLATION



If screws are going directly into wood trim or wall studs - drill 1/8" (3mm) holes and install screws through bracket. If screws are going into hollow wall - drill 3/16" (5mm) holes and push or lightly hammer plastic anchors into holes. Then install screws through brackets. Do not tighten screws too much - just snug is best.