



GEARWRENCH®

RATCHET GUIDE

The wide line of GEARWRENCH ratchets offers professional automotive techs and industrial mechanics an impressive arsenal of tools to accomplish just about any job. From our 120XP™ Ratchets with their 3 degree swing arc to our innovative Gimbal Ratchets, every ratchet in the line delivers on the GEARWRENCH promise of superior Speed, Strength, and Access.

120XP Ratchets

The Double-Pawl design of GEARWRENCH 120XP™ Ratchets provides 120 ratcheting positions so fasteners can be turned in the tightest spaces and jobs can be completed faster. Two pawls alternately engage a 60-tooth gear, allowing a swing arc of just 3 degrees and delivering strength that exceeds ASME torque performance requirements.

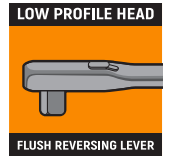
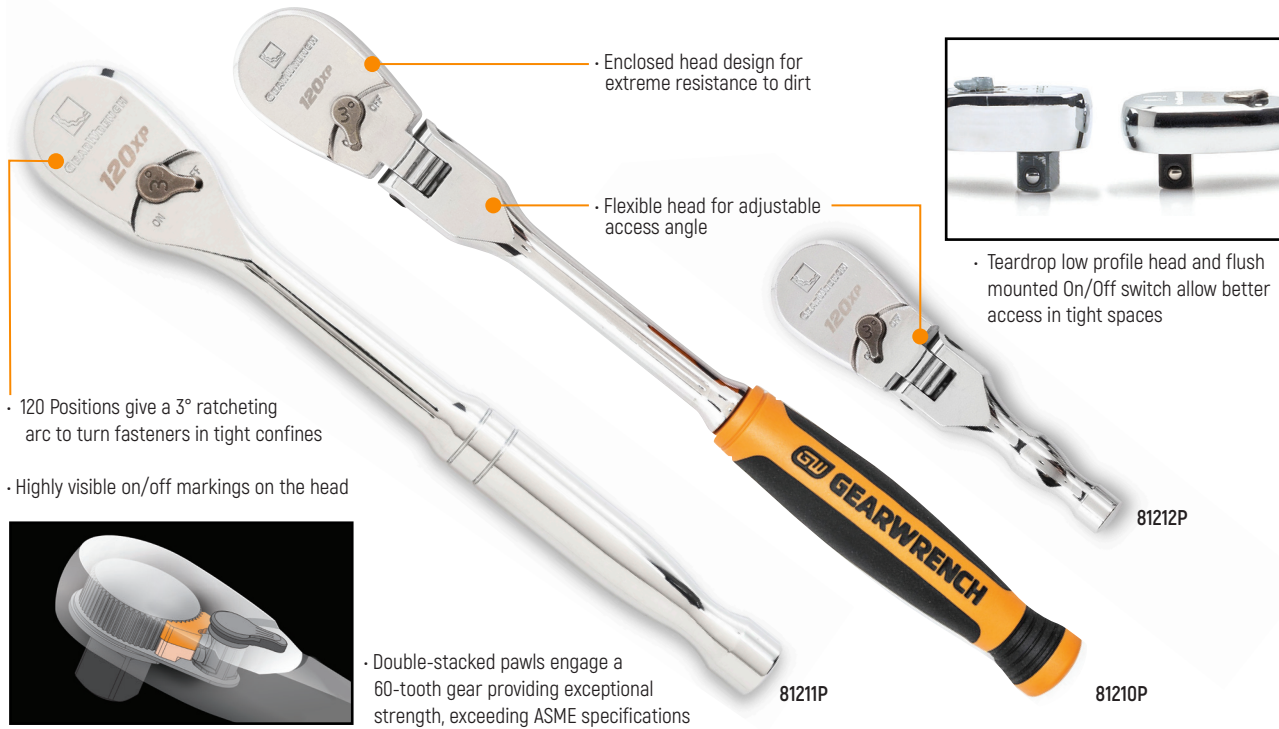

SKU #	Drive Size	Head Style	Handle Style	Finish	Head Width	Head Thickness	Overall Length	Weight	Repair Kit
81011P	1/4"	Tear Drop	Standard	Full Polish	0.98	0.39	5.12	0.29	81099P
81034	1/4"	Tear Drop	Extra Long	Full Polish	0.98	0.39	9.00	0.77	81099P
81012P	1/4"	Tear Drop	Flex	Full Polish	1.02	0.41	6.85	0.33	81099P
81009P	1/4"	Tear Drop	Flex	Cushion Grip	1.02	0.41	8.18	0.36	81099P
81211P	3/8"	Tear Drop	Standard	Full Polish	1.25	0.55	8.38	0.72	81227P
81269	3/8"	Tear Drop	Extra Long	Full Polish	1.25	0.55	18.00	1.08	81227P
81215P	3/8"	Tear Drop	Flex	Full Polish	1.30	0.55	11.47	0.95	81227P
81212P	3/8"	Tear Drop	Stubby Flex	Full Polish	1.30	0.55	5.00	0.55	81227P
81210P	3/8"	Tear Drop	Flex	Cushion Grip	1.30	0.55	13.58	0.99	81227P
81304P	1/2"	Tear Drop	Standard	Full Polish	1.72	0.75	11.02	1.87	81339P
81364	1/2"	Tear Drop	Extra Long	Full Polish	1.72	0.75	24.00	2.86	81339P
81306P	1/2"	Tear Drop	Flex	Full Polish	1.72	0.75	16.90	2.44	81339P

FORGE AHEAD

90T Ratchets

GEARWRENCH 90-Tooth Ratchets have a 4-degree swing arc and a low-profile enclosed head for easier access to hard-to-turn fasteners and extreme resistance to dirt infiltration. The ratchets are some of the strongest on the market, exceeding ASME torque performance specifications. They are available individually or in sets and are offered in a wide range of sizes and styles to suit every preference and job requirement.



• Highly visible On/Off markings on the head

• Locking flex-head with 9 locked positions and unlocked option for adjustable access angle

• 90-Tooth gear delivers a 4° swing arc to turn a fastener in tight confines

• 1/2" Drive dual material handle - large handle butt for improved grip



• Dual material comfort grip handle
• Solvent resistant handle grip for durability



• 3/8" drive ratchet with the head size of a 1/4" drive ratchet

• Exceeds ASME torque performance requirements



• Tear drop low profile head and flush mounted On/Off switch allows better access in tight spaces



SKU #	Drive Size	Head Style	Handle Style	Finish	Head Width	Head Thickness	Overall Length	Weight	Repair Kit
81011T	1/4"	Tear Drop	Standard	Full Polish	0.98	0.35	5.13	0.27	81099T
81028T	1/4"	Tear Drop	Long Handle	Full Polish	0.98	0.35	6.87	0.32	81099T
81007T	1/4"	Tear Drop	Standard	Cushion Grip	0.98	0.35	6.88	0.32	81099T
81029T	1/4"	Tear Drop	Long Handle	Cushion Grip	0.98	0.35	8.26	0.34	81099T
81015T	1/4"	Tear Drop	Locking Flex	Full Polish	0.98	0.35	6.97	0.33	81099T
81012T	1/4"	Tear Drop	Flex	Full Polish	0.98	0.35	6.97	0.33	81099T
81016T	1/4"	Tear Drop	Locking Flex	Cushion Grip	0.98	0.35	8.23	0.33	81099T
81009T	1/4"	Tear Drop	Flex	Cushion Grip	0.98	0.35	8.26	0.39	81099T
81211T	3/8"	Tear Drop	Standard	Full Polish	1.25	0.47	8.39	0.70	81227T
81264T	3/8"	Tear Drop	Long Handle	Full Polish	1.25	0.47	11.00	0.81	81227T
81209T	3/8"	Tear Drop	Stubby	Full Polish	1.25	0.47	4.72	0.41	81227T
81220T	3/8"	Compact	Standard	Full Polish	1.00	0.43	8.40	0.51	
81228T	3/8"	Compact	Stubby	Full Polish	1.00	0.43	4.70	0.32	
81208T	3/8"	Tear Drop	Standard	Cushion Grip	1.25	0.47	9.40	0.64	81227T
81265T	3/8"	Tear Drop	Long Handle	Cushion Grip	1.25	0.47	13.00	0.77	81227T
81266T	3/8"	Tear Drop	Locking Flex	Full Polish	1.25	0.47	11.47	0.93	81227T
81215T	3/8"	Tear Drop	Flex	Full Polish	1.25	0.47	11.40	0.85	81227T
81212T	3/8"	Tear Drop	Stubby Flex	Full Polish	1.25	0.47	5.00	0.52	81227T
81267T	3/8"	Tear Drop	Locking Flex	Cushion Grip	1.25	0.47	13.63	0.93	81227T
81210T	3/8"	Tear Drop	Flex	Cushion Grip	1.25	0.47	13.38	0.85	81227T
81213T	3/8"	Tear Drop	Off-Set Flex	Cushion Grip	1.25	0.47	12.26	0.99	81227T
81304T	1/2"	Tear Drop	Standard	Full Polish	1.72	0.64	11.00	1.65	81339T
81360T	1/2"	Tear Drop	Long Handle	Full Polish	1.72	0.64	15.00	1.97	81339T
81303T	1/2"	Tear Drop	Standard	Cushion Grip	1.72	0.64	11.80	1.30	81339T
81361T	1/2"	Tear Drop	Long Handle	Cushion Grip	1.72	0.64	16.50	1.75	81339T
81362T	1/2"	Tear Drop	Locking Flex	Full Polish	1.72	0.64	16.93	2.30	81339T
81363T	1/2"	Tear Drop	Locking Flex	Full Polish	1.72	0.64	24.00	2.79	81339T
81306T	1/2"	Tear Drop	Flex	Full Polish	1.72	0.64	16.98	2.05	81227T
81371T	1/2"	Tear Drop	Locking Flex	Cushion Grip	1.72	0.64	17.00	1.96	81339T
81372T	1/2"	Tear Drop	Locking Flex	Cushion Grip	1.72	0.64	24.00	2.44	81339T
81370T	1/2"	Tear Drop	Flex	Cushion Grip	1.72	0.64	17.00	2.07	81339T

72 Tooth Ratchets



81270

- Gimbal design allows the ratchet to operate on two plains for easier access
- Anodized aluminum finish for protection and easy wipe down
- Exceeds ASME performance specifications



81225

- 360° rotating head for maximum speed and access



81226

SKU #	Drive Size	Head Style	Handle Style	Finish	Head Width	Head Thickness	Overall Length	Weight
81027	1/4"	Gimbal	Gimbal	Anodized Aluminum	1.97	0.73	N/A	0.20
81224	1/4"	Round	Roto	Cushion Grip	1.25	0.59	6.75	0.36
81008	1/4"	Palm	Standard	Textured	1.90	0.65	N/A	0.31
81270	3/8"	Gimbal	Gimbal	Anodized Aluminum	1.97	0.73	N/A	0.20
81225	3/8"	Round	Roto	Cushion Grip	1.72	0.71	9.84	0.77
81226	3/8"	Palm	Standard	Textured	1.90	0.65	N/A	0.31

Slim Head Ratchets



81025

- 72 Teeth give a 5° ratchet arc to turn a fastener in tight confines
- Flex-Head with 9-locked positions and unlocked for angled access
- Flush mounted forward/reverse lever



81030

- Thumbwheel to start and quickly turn loose fasteners
- Meets or Exceeds ASME Specification

- Head converts from ratchet to bit driver with removal of ratchet adapter



SKU #	Drive Size	Head Style	Handle Style	Finish	Head Width	Head Thickness	Overall Length	Weight	Repair Kit
81025	1/4"	Slim	Locking Flex	Full Polish	0.73	0.49	6.00	0.32	81022
81030	1/4"	Slim	Locking Flex	Full Polish	0.73	0.49	12.00	0.46	81022

Specialty Ratchets



Quick Release: 81014, 81218, 81309



Quick Release Flex: 81219



3/4" Dr: 88800



3/4" Dr: 81400



3/4" Dr: 81402



81403



81500

SKU #	Drive Size	Teeth Count	Head Style	Handle Style	Finish	Head Width	Head Thickness	Overall Length	Weight	Repair Kit
81014	1/4"	45	Quick Release	Standard	Full Polish	1.00	0.47	5.63	0.30	N/A
81218	3/8"	45	Quick Release	Standard	Full Polish	1.25	0.57	7.87	0.85	N/A
81219	3/8"	45	Quick Release	Flex	Full Polish	1.22	0.57	10.30	1.10	N/A
81309	1/2"	45	Quick Release	Standard	Full Polish	1.69	0.72	9.60	1.45	N/A
88800	3/4"	43	Round	Standard	Full Polish	2.71	2.28	19.68	4.98	N/A
81400	3/4"	24	Quick Release	Standard	Full Polish	2.50	1.34	19.75	5.20	81499
81402	3/4"	24	Quick Release	N/A	Full Polish	2.50	1.34	6.10	2.74	81499
81403	3/4"	N/A	N/A	Standard	Full Polish	N/A	N/A	36.00	6.00	N/A
81500	1"	24	Round	Standard	Full Polish	2.75	2.28	25.59	7.10	N/A

120XP Sets



SKU #	Drive Size	Description	Handle Style	Includes
81230P	1/4", 3/8", 1/2"	4 Pc 120XP Flex-Head Ratchet Set	Full Polish	81012P, 81212P, 81215P, 81306P
81204P	1/4", 3/8"	2 Pc 120XP Flex-Head Ratchet Set	Cushion Grip	81009P, 81210P
81206P	1/4", 3/8", 1/2"	3 Pc 120XP Ratchet Set	Full Polish	81011P, 81211P, 81304P
81271	1/4", 3/8"	2 Pc 120XP Extra Long Handle Ratchet Set	Full Polish	81034, 81269

90T Sets



SKU #	Drive Size	Description	Handle Style	Includes
81206T	1/4", 3/8", 1/2"	3 Pc 90T Ratchet Set	Full Polish	81011T, 81211T, 81304T
81207T	1/4", 3/8", 1/2"	3 Pc 90T Ratchet Set	Cushion Grip	81007T, 81208T, 81303T
81216T	1/4", 3/8"	2 Pc 90T Flex-Head Ratchet Set	Full Polish	81012T, 81215T
81230T	1/4", 3/8", 1/2"	4 Pc 90T Flex-Head Ratchet Set	Full Polish	81012T, 81215T, 81212T, 81306T
81204T	1/4", 3/8"	2 Pc 90T Flex-Head Ratchet Set	Cushion Grip	81009T, 81210T
81203T	1/4", 3/8"	3 Pc 90T Mixed Ratchet Set	Cushion Grip	81007T, 81208T, 81210T
81274T	1/4", 3/8"	2 Pc 90T Locking Flex Head Set	Full Polish	81015T, 81266T
81276T	1/4", 3/8", 1/2"	3 Pc 90T Locking Flex-Head Ratchet Set	Full Polish	81015T, 81266T, 81362T
81275T	1/4", 3/8"	2 Pc 90T Locking Flex-Head Ratchet Set	Cushion Grip	81016T, 81267T
81298T	1/4", 3/8", 1/2"	3 Pc 90T Locking Flex-Head Ratchet Set	Cushion Grip	81016T, 81267T, 81371T
81268T	1/4", 3/8"	2 Pc 90T Long Handle Ratchet Set	Full Polish	81028T, 81264T
81229T	3/8"	3 Pc 90T Ratchet Spark Plug Set	Cushion Grip	81213T, 80546, 80547
81253T	3/8"	2 Pc 90T Compact Head Ratchet Set	Full Polish	81220T, 81228T

Additional Sets



SKU #	Drive Size	Description	Includes
81032	1/4"	45 Pc 72T Slim Head Mechanics Tool Set	81025 and 81030 Slim Head Ratchets, 4mm - 13mm sockets, [2] 1/4" adapters, 4" extension, 30 Pc mixed bits in box
81031	1/4"	43 Pc 72T Slim Head Mechanics Tool Set	6" Bit Driver and 12" 1/4" drive Slim Head Ratchet, 4mm - 13mm sockets, 4" extension, 30 Pc mixed bits in box
81223	1/4, 3/8"	2 Pc Cushion Grip Roto Ratchet Set	81224, 81225
81222	1/4", 3/8"	2 Pc Thumbwheel Ratchet Set	81008, 81226
81310	1/4", 3/8", 1/2"	3 Pc Full Polish Quick Release Ratchet Set	81014, 81218, 81309