

## INSTALLATION INSTRUCTIONS FOR 13/16" BAY WINDOW ROD SET

### SINGLE ROD

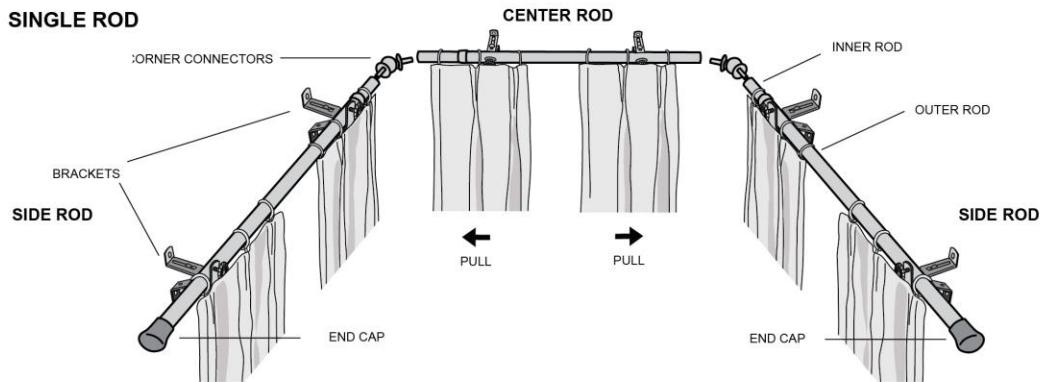

- 1 Mounting Brackets**  
This rod fits most bay window configurations. Spot and mount brackets above window using a level to ensure accuracy. Use anchors with screws for drywall installs.

- 2 Rod Assembly**  
Build the three rod parts by sliding the rod segments together. Depending on the drapes attachment method, slide the rod pockets or the rings over the assembled rod segments.

- 3 Attaching Rod Connector**  
Insert the rod connectors to the center rod and then loosen the connectors tightening screw to find the correct angles for the side segments. Tighten the screw on the connector to lock the angle into place. Push the completed side segments onto the open end of the rod connectors.

- 4 Hanging the Rod**  
Hang the completed assembly by loosening the brackets front adjustment screws and dropping the rods in. Once hung, tighten both the brackets tightening screws and the connectors tightening screws.

- 5 Changing Finials (Optional)**  
Install finials by removing end caps and sliding their posts into the adapters.
- 

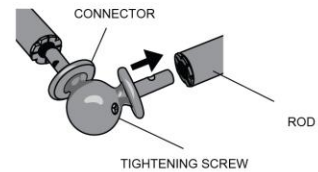

### DOUBLE ROD

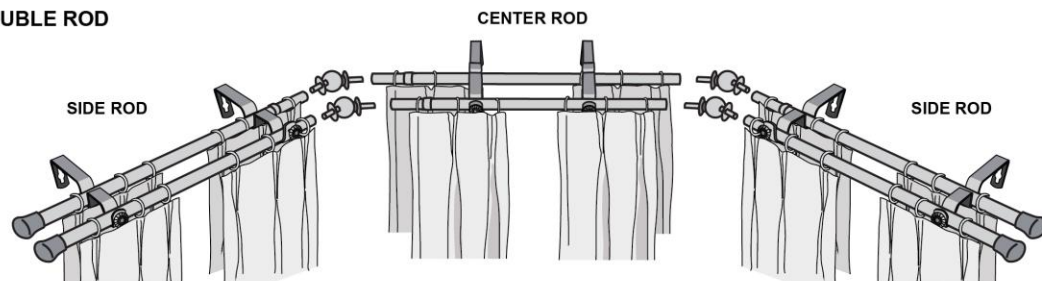

- 1 Mounting Brackets**  
This rod fits most bay window configurations. Spot and mount brackets above window using a level to ensure accuracy. Use anchors with screws for drywall installs.

- 2 Rod Assembly**  
Build the three rod parts by sliding the rod segments together. Depending on the drapes attachment method, slide the rod pockets or the rings over the assembled rod segments.

- 3 Attaching Rod Connector**  
Insert the rod connectors to the center rod and then loosen the connectors tightening screw to find the correct angles for the side segments. Tighten the screw on the connector to lock the angle into place. Push the completed side segments onto the open end of the rod connectors.

- 4 Hanging the Rod**  
Hang the completed assembly by loosening the brackets front adjustment screws and dropping the rods in. Once hung, tighten both the brackets tightening screws and the connectors tightening screws.

- 5 Changing Finials (Optional)**  
Install finials by removing end caps and sliding their posts into the adapters.
- 

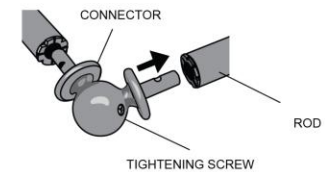

### DRYWALL ANCHOR INSTALLATION



If screws are going directly into wood trim or wall studs - drill 1/8" (3mm) holes and install screws through bracket.  
If screws are going into hollow wall - drill 3/16" (5mm) holes and push or lightly hammer plastic anchors into holes.  
Then install screws through brackets. Do not tighten screws too much - just snug is best.