



Adapters

Cat. No. 49-16-2684, 49-16-2685

⚠ WARNING READ ALL SAFETY WARNINGS AND ALL INSTRUCTIONS. Failure to follow the warnings and instructions may result in electric shock, fire and/or serious injury. **Save all warnings and instructions for future reference.** Before using the Punch, Die and Draw Stud, read this instruction sheet, your tool's operator's manual, and all labels on the tool.

- **Keep work area clean and well lit.** Cluttered or dark areas invite accidents.
- **Do not overreach. Keep proper footing and balance at all times.** This enables better control of the power tool in unexpected situations.
- **Dress properly. Do not wear loose clothing or jewellery. Keep your hair, clothing and gloves away from moving parts.** Loose clothes, jewellery or long hair can be caught in moving parts.
- **Use tool only as directed. Only trained personnel should operate tool.**
- **Do not use in or near live electrical panels.** Only work on de-energized electrical panels. Disconnect all electrical current before use to avoid the risk of electric shock.
- **Keep hands away from knockout die and punch while tool is in use.** Fingers could be crushed or severed.
- **To reduce the risk of injury, wear safety goggles or glasses with side shields. Before use, inspect and discard workpieces and accessories with cracks or damage.** Shards from weakened metal could cause injury.
- **Avoid contact with punched metal edges.** Edges may be sharp and could cause injury.
- **Do not attempt to punch through more than one layer of material at a time.** Punching through multiple layers could cause the material and accessories to warp break, throwing shards that could cause injury.
- **Use tool only with knockout dies and punches rated for the peak output force of the tool. Ensure all threads are hand-tightened securely before operating.** Other uses may cause injury or damage to the tool, accessories, and workpiece.

Use the **MILWAUKEE FORCELOGIC™** Adapter (Cat. No. 49-16-2685) with the **M18™ FORCELOGIC™ 10T Knockout Tool** to properly fit other major brands of small and large punches and dies. Use with other major brand draw studs and spacers, as required.

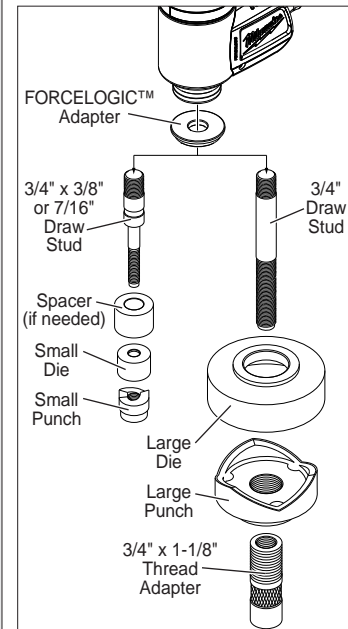

Use the **MILWAUKEE EXACT™** Adapter (Cat. No. 49-16-2684) with **MILWAUKEE EXACT™ 2-1/2" to 4" Dies** on other major brands of tools with 3/4" Draw Studs.

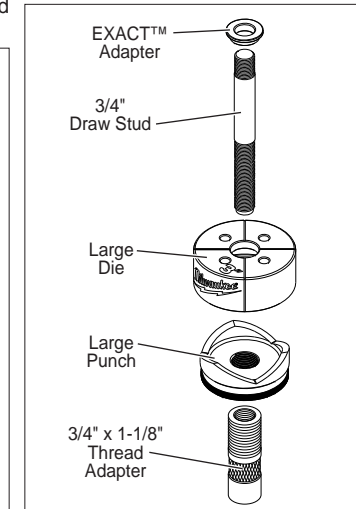

**MILWAUKEE ELECTRIC
TOOL CORPORATION**
13135 West Lisbon Road
Brookfield, Wisconsin, U.S.A. 53005

01/14
58-22-2694d1

Printed in China
961150004-01()