

# Operating Instructions and Manual



**SAVE THESE INSTRUCTIONS:** Read this instruction manual carefully before installation and use. Keep this manual for future use in case it is needed.

Model H1014

35 inch Portable Patio Heater



**WARNING:** Use this heater only as described in this manual. Any other use not recommended by the manufacturer may cause fire, electric shock, or injury to persons.

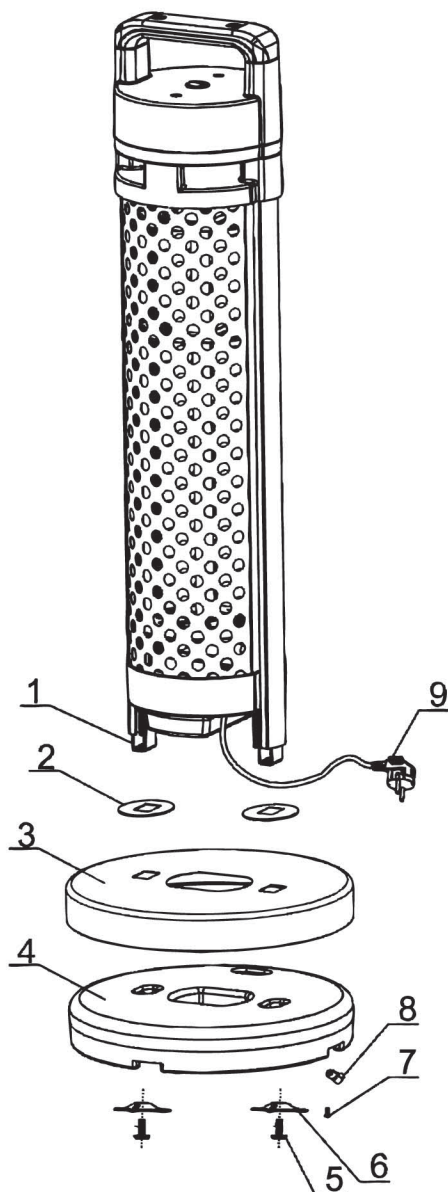

## PARTS LIST

No.	Part Name
1	Base Bracket
2	Deco Board
3	Base Cover
4	Base
5	Screw (M6*20)
6	Washer
7	Screw M4*35
8	Cord Clip
9	Plug

## ACCESSORIES PACK CHECK LIST

Accessory Name	Qty
Screw M6*20	2
Washer	2
Allen Key	1

# PREPARATION

1. Unpack the carton. Ensure all parts outlined in the Parts List are included. If anything is missing, please contact Customer Service at (800) 433-1626.
2. You will need a Phillips head screw driver for the assembly of the product.
3. Read this instruction manual carefully before installation and use. Keep this instruction manual and warranty card in a proper and safe place for future use in case it is needed.

# INSTALLATION

1. Unpack the carton. Turn the main body upside down (Fig A). Slide Deco Board (#2) onto Base Bracket (#1). The mirrored side should be positioned so that it is facing the floor.
2. Tilt the Base Cover (Fig B) and slide Base Cover (#3) onto Base Bracket (#1). Pull the power cord through the center opening, then repeat for the other side.
3. Pull the power cord through the center opening of the Base (#4) then place over the Base Cover (#3) as shown in Fig C.
4. Place Washer (#6) onto Base (#4) where the bracket is visible then secure with Screw M6\*20 (#5) as shown in Fig D using allen key. Attach cord to clip on bottom using screwdriver.

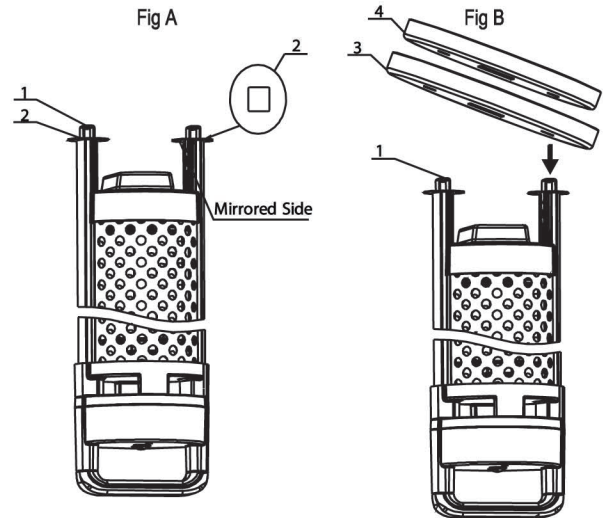

# OPERATION

1. Plug the unit into a grounded wall socket. Ensure the power being used is 120VAC.
2. Press the switch on the top of the heater to turn the unit on or off as desired.

# CLEANING

Unplug the unit and make sure it is completely cool before cleaning. Then gently wipe with a wet cloth, using minimal water.

# STORAGE

Perform the cleaning procedures described in the "Cleaning" section above. Wipe all parts dry, then pack the heater in a plastic bag and store in a cool, dry place.

Do not route cord when heater is stored or heater is not in use.

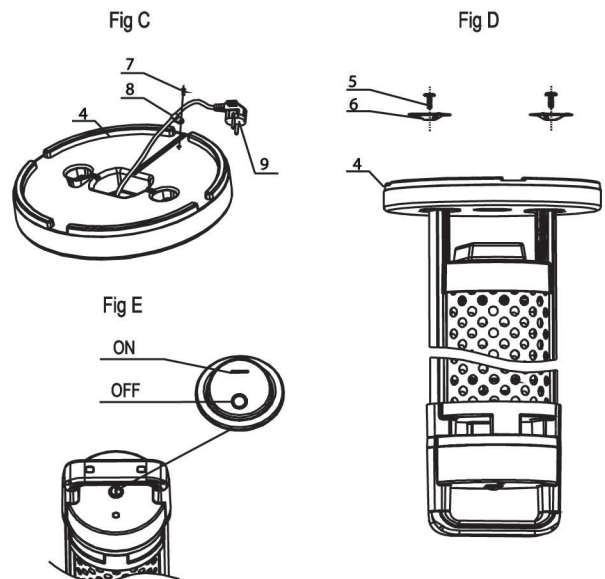

# IMPORTANT INSTRUCTIONS

**When using electrical appliances, basic precautions should always be followed to reduce the risk of fire, electric shock, and injury to persons, including the following:**

1. Read all instructions before using this heater.
2. The heater is hot when in use. To avoid burns, do not let bare skin touch hot surfaces. If provided, use handles when moving this heater. Keep combustible materials, such as furniture, pillows, bedding, papers, clothes, and curtains at least 3 feet (0.9m) from the front of the heater and keep them away from the sides and rear.
3. Extreme caution is necessary when any heater is used by or near children or the elderly and whenever the heater is left operating and unattended.
4. Always unplug heater when not in use.
5. Do not operate any heater with a damaged cord or plug or after the heater malfunctions, has been dropped or damaged in any manner. Discard heater or return to authorized service facility for examination and/or repair.
6. This heater is not intended for use in bathrooms, laundry areas and similar indoor locations. Never locate heater where it may fall into a bathtub or other water container.
7. Do not run cord under carpeting. Do not cover cord with throw rugs, runners, or similar coverings. Do not route cord under furniture or appliances. Arrange cord away from traffic areas and where it will not be tripped over.

# IMPORTANT INSTRUCTIONS (CONT.)

8. To disconnect heater, turn controls to off, then remove plug from outlet.
9. Connect to properly grounded outlets only.
10. Do not insert or allow foreign objects to enter any ventilation or exhaust opening as this may cause an electric shock or fire, or damage the heater.
11. To prevent a possible fire, do not block air intakes or exhaust in any manner. Do not use on soft surfaces, like a bed, where openings may become blocked.
12. A heater has hot and arcing or sparking parts inside. Do not use it in areas where gasoline, paint, or flammable liquids are used or stored.
13. Use this heater only as described in this manual. Any other use not recommended by the manufacturer may cause fire, electric shock, or injury to persons.
14. Always plug heaters directly into a wall outlet/receptacle. Never use with an extension cord or relocatable power tap (outlet/power strip).
15. This heater may include an audible (a visual) alarm to warn that parts of the heater are getting excessively hot. If the alarm sounds (flashes), immediately turn the heater off and inspect for any objects on or adjacent to the heater that may cause high temperatures. **DO NOT OPERATE THE HEATER WITH THE ALARM SOUNDING (FLASHING).**
7. The unit must be handled with care. Avoid vibration or hitting the unit.
8. The unit must be securely grounded during operation.
9. When damaged, the unit must be repaired by a professional repairing team.
10. If the supply cord is damaged, it must be replaced by the manufacturer, its service agent or similarly qualified persons in order to avoid a hazard.
11. The heater must not be located immediately below a socket-outlet.
12. When assembling, keep clear from any board or flammable material.
13. Do not use this heater with a programmer, timer or any other device that switches the heater on automatically, since a fire risk exists if the heater is covered or positioned incorrectly.
14. This appliance is not intended for use by persons (including children) with reduced physical, sensory or mental capabilities, or lack of experience and knowledge, unless they have been given supervision or instruction concerning use of the appliance by a person responsible for their safety.
15. Children should be supervised to ensure that they do not play with the appliance.
23. Do not use this unit in a place of animal propagating and raising.
24. Do not use this unit in heating system of hot air centre.
25. Do not immerse this unit into water for cleaning.
26. The unit should be plugged in a socket, which is easily visible and reachable.
27. Two dark points may exist on the surface of the heating elements, or the surface of the heating element may turn white during the first few minutes after it's turned on. This is normal, and may not affect the performance of the unit.
28. A warning beeper will keep beeping in case the heater is covered by something accidentally and the heating element is switched off because of over-heating.
29. If the alarm sounds (flashes), immediately turn the heater off and inspect for any objects on or adjacent to the heater that may cause high temperatures. **DO NOT OPERATE THE HEATER WITH THE ALARM SOUNDING (FLASHING).**
30. To avoid potential fire hazards, never place your heater or its electrical cord under rugs or carpeting. Place the electrical cord away from busy areas to avoid accidental tripping and contact.
31. To disconnect heater, turn controls to off, then remove plug from outlet.

## CAUTIONS

1. High temperature, keep combustible material such as furniture, papers, clothes, curtains at least 3 feet (0.9m) from the front of the heater and away from the side and rear.
2. The unit must be securely placed on a horizontal and flat surface.
3. The unit is at high temperature during operation. It keeps hot for a period after shut down. Potential danger would occur when touching it during this period.
4. Do not place the unit close to curtains and/or other flammable objects. Otherwise there will be a danger of catching fire.
5. Do not cover the unit with anything during operation or a short time after it is shut down.
6. Do not wrap the power supply cord on the unit.
16. The unit is for household use only. It is not allowed for use in buildings, greenhouses, barns or stables where there is flammable dust.
17. The head of the unit is at high temperature during operation. Unplug the unit and wait until it is cool before cleaning.
18. Do not use this heater in the immediate surroundings of a bath, a shower or swimming pool.
19. Do not use this unit in a place where causticity or volatile air exists, i.e. dust, steam, gas, etc.
20. Do not use this unit as a cloth dryer or towel dryer.
21. Do not use this heater as a sauna heater.
22. Do not use this unit as a room heater of heat storing.

## SAVE THESE INSTRUCTIONS.

## GROUNDING

This heater is for use with 120 VAC only. The cord has a plug as shown in Figure A below. An adapter, shown in Figure C below, must be used for connecting the three-blade plug to a two-plug receptacle. The green grounding lug extending from the adapter must be connected to a permanent ground, such as a properly grounded outlet box. The adapter should not be used if a three-slot grounded receptacle is available.

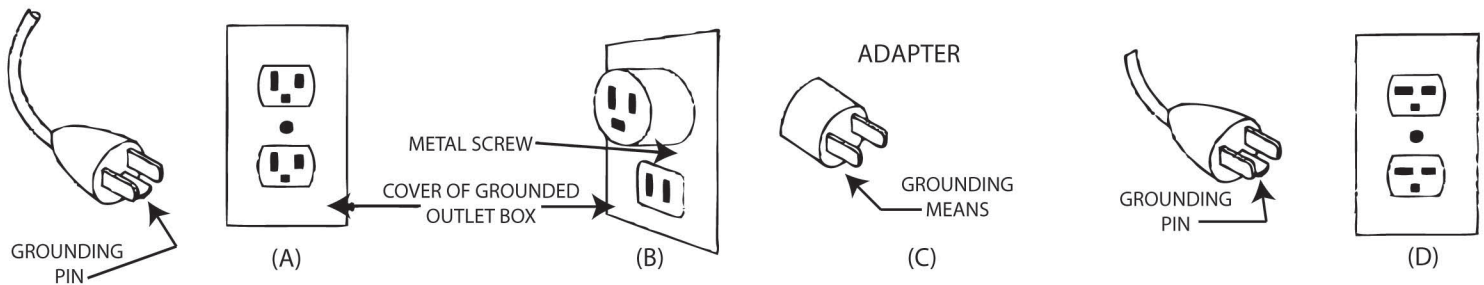

## VENTAMATIC, LTD. LIMITED WARRANTY

Ventamatic, Ltd. extends this warranty to the original retail purchaser of this heater.

The heater is warranted against defects in materials and workmanship for a period of one (1) year from the date of original retail purchase. No other parts or components are warranted. There is no warranty for defects caused by abuse. Repairs or replacement parts supplied under this warranty are warranted only for the period of this warranty; that is, one (1) year from the date of the original retail purchase of the unit. In the event of a defect or malfunction, we will replace or repair the defective part or component only and return the new or repaired part to you freight prepaid. You must bear all other expenses incurred in obtaining repairs, including labor required for field repair or replacement, and the cost of shipping the defective part to us. You must also bear the cost of repair to or replacement of any part or component and the shipping charges incurred for the repair or replacement and return to you of any part or component not covered by this warranty, including parts or components damaged by you.

The company reserves the right to demand and receive written evidence of the date of purchase before undertaking to perform its obligations under this warranty. You should, therefore, retain your sales slip and attach a copy of it to the warranty claim.

In order to obtain the repair or replacement of this unit, you must select one of the following methods:

A. Return to factory.

Return postage prepaid only the part or component which you believe to be defective to the following address:

Ventamatic, Ltd  
100 Washington Street  
Mineral Wells, TX 76067

Complete and enclose a written claim and attach a copy of your sales slip or other proof of purchase.

B. Return to retail dealer.

There is no informal dispute settling mechanism available in the event of a controversy involving this warranty.

Any and all implied warranties which may exist terminate upon the expiration of this warranty one (1) year from the date of the original retail purchase. Some states do not allow limitations on how long an implied warranty lasts, so this limitation may not apply to you.

Ventamatic, Ltd. is not liable to you for incidental or consequential damages arising out of a defect or malfunction of a unit or its installation or out of any alleged breach of this warranty. Some states do not allow the exclusion or limitation of incidental or consequential damages, so this limitation may not apply to you.

This warranty gives you specific legal rights and you may also have other rights which may vary from state to state.