

SAFETY PRECAUTION:

IMPORTANT: PLEASE READ BEFORE INSTALLATION:

- 1.Before you begin installing the fan, shut power off at the circuit breaker of the fuse box.
 - 2.⚠️**CAUTION:** Read all instructions and safety information before installing your new fan. Review accompanying assembly diagrams.
 - 3.Make sure that all electrical connections are in accordance with National Electrical Code, ANSI/NFPA 70 and local codes. Hire a licensed electrician if you are unfamiliar with installing electrical wiring.
 - 4.Make sure the installation site you choose allows the fan blades to rotate without any obstructions. Allow a minimum clearance of 2.1m (7 feet) from the floor and 18 inches from the tip of the blades to the wall.
 - 5.⚠️**WARNING:** To reduce the risk of fire, electric shock, or personal injury, mount to outlet box marked "Acceptable for Fan Support of 22.7 kg (50 lbs) or less" and use mounting screws provided with the outlet box.
 - 6.⚠️**CAUTION:** To reduce the risk of injury, use only the screws provided with the outlet box in conjunction with the lock washers provided with the fan.
 - 7.The outlet box and support structure must be securely mounted and capable of reliably supporting a minimum of 35 pounds. Use only U.L. Listed outlet boxes marked "Acceptable for Fan Support of 22.7 kg (50 lbs) or less".
 - 8.After you install the fan, make sure that all mounting components are secured to prevent the fan from falling.
 - 9.Do not insert anything into the fan blades while the fan is operating.
 - 10.To change the direction of the rotation of the blades the fan must be in operation mode.
 - 11.All set screws must be checked and retightened where necessary before installation.
 - 12.⚠️**WARNING:** To reduce the risk of personal injury, do not bend the blade bracket when installing the brackets, balancing the blades, or cleaning the fan. Do not insert foreign objects in between rotating fan blades.
 - 13.⚠️**CAUTION:** To reduce the risk of electric shock, disconnect the electrical supply circuit to the fan before installing light kit.
 - 14.After making the wire connections, the wires should be spread apart with the grounded conductor and the equipment-grounding conductor on one side of the outlet box and the ungrounded conductor on the other side of the outlet box.
 - 15.The splices after being made should be turned upward and pushed carefully up into the outlet box. Conductor wiring identified as grounded is to be connected to a grounded conductor of power supply. Conductor wiring identified as ungrounded conductor is to be connected to an ungrounded conductor. Conductor wiring identified for equipment grounding is to be connected to an equipment-grounding conductor.
 - 16.This device complies with part 15 of the FCC Rules. Operation is subject to the following two conditions: (1) This device may not cause harmful interference, and (2) this device must accept any interference received, including interference that may cause undesired operation.
⚠️**WARNING:** To reduce the risk of fire or electric shock, this fan must be installed with a general use, isolating wall control/switch.
⚠️**WARNING:** To reduce the risk of fire or electric shock, do not use this fan with any solid-state speed control device.
- NOTE:** The important safeguards and instructions appearing in this manual are not meant to cover all possible conditions and situations that may occur. It must be understood that common sense, caution and care are factors which cannot be built into this product. These factors must be supplied by the person (s) installing, caring for and operating the unit.

⚠️**CAUTION:** The light source is designed for this specific application and can overheat if serviced by untrained personnel. If any servicing is required, the product should be returned to an authorized service facility for examination or repair.

BEFORE YOU START

Contact a licensed electrician if you are uncomfortable performing electrical work. A licensed electrician must install the fan if required by local code. Do not use the fan with a dimmer switch. Turn off power at breaker.

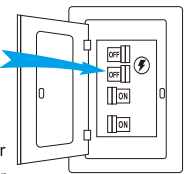

Tools and Materials Required

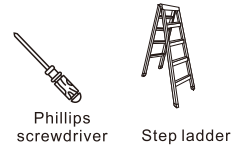

Product instruction:

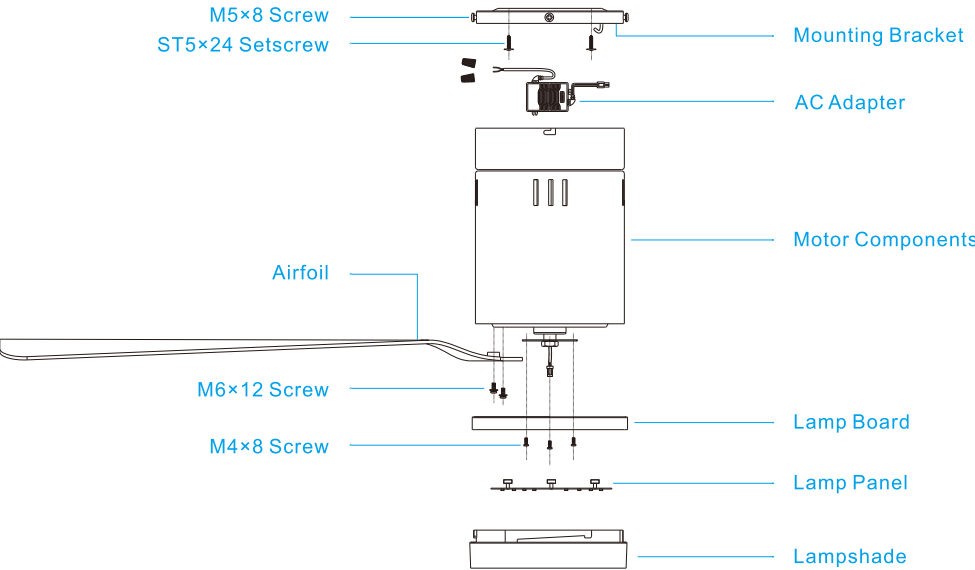

Screws bag

AC Adapter	ST5x24 Setscrew	Wiring cap	M6x12 Screws
1 pc	4 pcs	2 pcs	6 pcs

Installation:

❶ Disassemble the motor components:

- 1.1 Take the motor components out of the box, use a screwdriver to loosen the screws and remove the mounting bracket.
- 1.2 After taking out the lamp board, loosen the screws and remove the lamp panel.

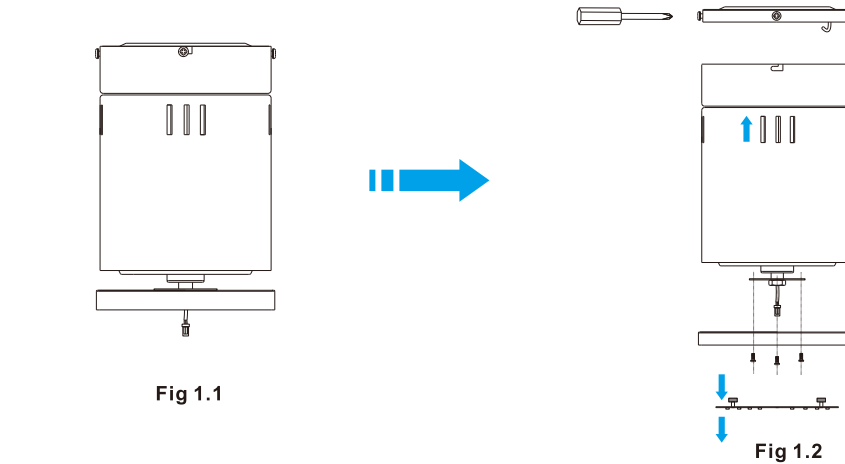

❷ Motor installation:

- 2.1 Fix the mounting bracket to the ceiling.
- 2.2 Hang the motor assembly on the mounting bracket through the screw hole, and use the terminal block to connect the power cord.
- 2.3 Fasten the motor on the mounting bracket with screws.

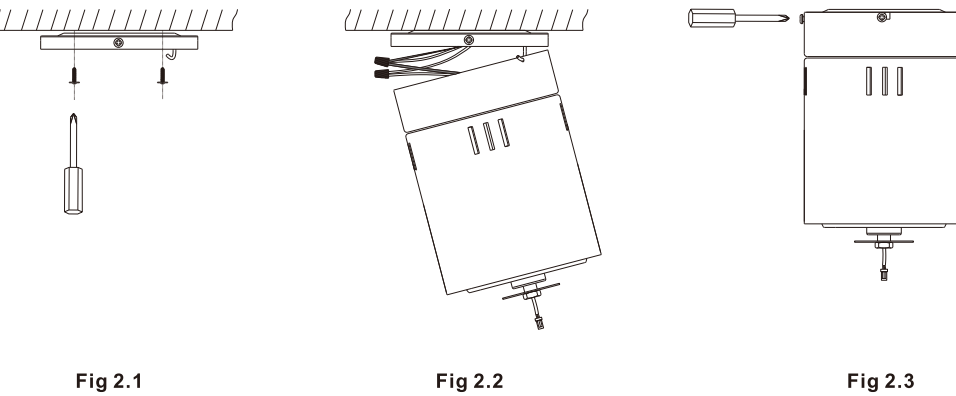

❸ Fan blade installation:

- 3.1 Use a screwdriver to fasten the 3 blades to the machine head in accordingly.

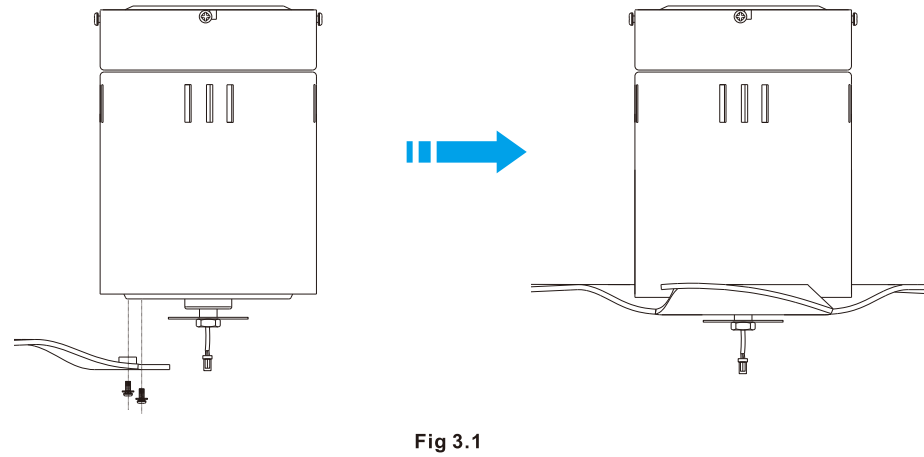

❹ Install lamp panel, lamp board, lamp shade:

- 4.1 Align the previously removed lamp panel fixing plate with the screw holes, and fasten it with a screwdriver.
- 4.2 Install the lamp board so that the magnetic block is attached to the lamp panel and connect to the plug-in terminal on the lamp board.
- 4.3 The lampshade is connected to the lamp panel, and rotate clockwise to lock the lampshade.

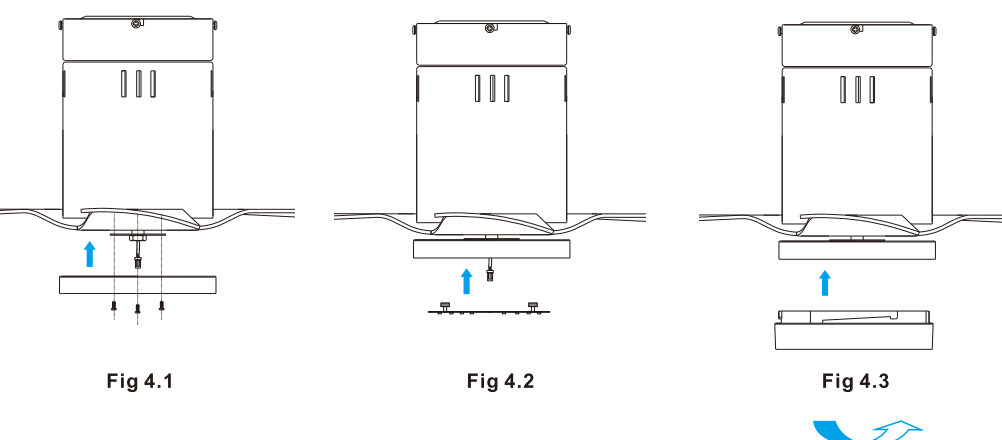

Warning:

The fan blade must have a minimum clearance of 2.3 meters from the ground and a minimum clearance of 1 meter from the wall.

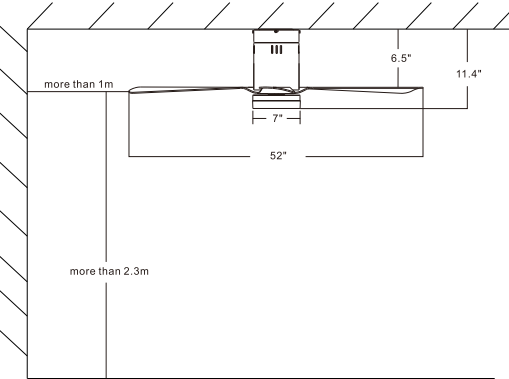

Installation is now complete. Turn on the power switch as Fig 4.4. Then the fan lights are on. Test and pair your fan immediately using the remote control.

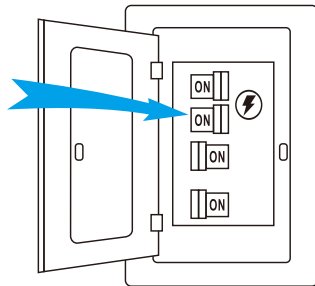

Basic product parameters:

Model	CES523PL	Voltage	120V
Fan Blade Span	52"	Rated Wattage	49W(Fan 27W Lamp 22W)
Gross weight	14.4lbs.	Rpm	50-175rpm
Maximum Airflow	4850CFM	Maximum Noise	≤60dB(A)

Remote Control Operating Instructions:

Pairing the Remote Control to Your Fan
Within 10 min. of plugging fan to power source, press and hold  button for 5 sec. to pair remote control and fan. Successful pairing will trigger beep alert .

Remote Control button definitions

OFF

Turns the fan off.

F/R

Switch between summer mode and winter mode.
• Summer mode - (Counter-clockwise) A downward airflow creates a cooling effect.
• Winter model - (Clockwise)
An upward airflow moves warm air off the ceiling area and redistributes the warm air that hovers around the ceiling to the living space.



Turns the fan on and decreases fan speed.



Turns the fan on and Increases fan speed.

Nature

Switch the fan speed between nature mode and normal mode. Simulate a natural breeze to make you comfortable when you sleep.
Note:Press/hold this button for 5 sec. to turn off the beep. Press/hold button for 5 sec. again to turn it on.



Turns the lights on or off and RF pairing.
Note: Press/hold button for 5 sec. within 10 min. of plugging fan to power source to pair remote and fan. Successful pairing will trigger beep alert .



Switch between warm light and cool light. WIFI Troubleshooting.
Note: Press/hold button for 5 sec. till beep alert. The fan will switch to AP Mode, then select AP Mode on APP, follow the APP control instructions will enable fan Wi-Fi.



Press/Hold button to decrease the desired light level.

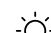

Press/Hold to button to increase the desired light level.

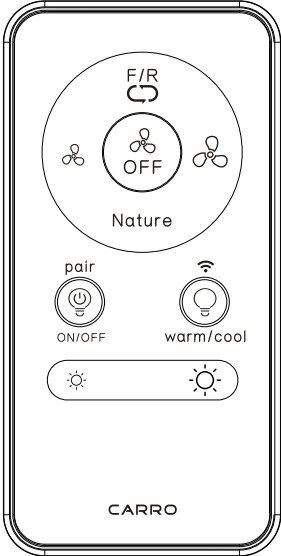

Warning: Do not expose the remote control to rain or water.

APP Control Connection:

- First download the app for free from the App Store or Google Play or scan the barcode below.
- Open the app to create your account. The account with "Carro Home" can be registered through E-mail or Mobile phone. If you already have the account number, just log in with your username and password.
- Set up a WIFI connection. (EZ Mode or AP Mode)
EZ Mode
 - Turn on Wi-Fi on phone settings.
 - Tap "Add device". (Make sure the fan is powered on and there is a red light blinking fast in the center of the ceiling fan lampshade.)
 - Tap "Carro smart ceiling fan" button under "Air circulation" menu. Tap "Next". (The default pairing mode is EZ Mode for WIFI connection)
 - Select your home WIFI and enter password, tap "Confirm".
 - Wait for the connection to be completed, will enter the main control UI.



If you are unable to set up a WIFI connection via EZ Mode, try AP Mode and follow the below steps.
AP Mode

- Press and hold  button for 5 seconds.
- Tap "Add device". (Make sure the fan is powered on and there is a red light blinking slowly in the center of the ceiling fan lampshade.)
- Tap "Carro smart ceiling fan" button under "Air circulation" menu.
- Tap "Net Pairing Mode", select "AP Mode". Tap "Next".
- Select your home WIFI and enter password, tap "Confirm".
- Connect to Carro "CarroHome-xxxx" WIFI signal.
- Reopen the APP.
- Wait for the connection to be completed, will enter the main control UI.

- The app will walk you through the main screen and show you how to create schedules, change fan speeds, dim the light, switch between Summer/Winter mode, invite users, create groups and much more. Refer to app instructions for more details.If necessary, you can reconnect the device according to the above steps.

Care and cleaning:

- Check the support connections, brackets, and airfoil attachments twice a year. Make sure they are secure. Because of the fan's natural movement, some connections may become loose over time. It is not necessary to remove the fan from the ceiling.
- Clean your fan periodically. Use only a soft brush or lint-free cloth to avoid scratching the finish. The plating is sealed with a lacquer to minimize discoloration or tarnishing.
- (Optional) Apply a light coat of furniture polish to the wood blades.
- (Optional) Cover small scratches with a light application of shoe polish.

Do not:

- Use water when cleaning. Water could damage the motor, or the wood, or possibly cause an electrical shock.
- Apply oil to your fan or motor. The motor has permanently-lubricated sealed ball bearings.

Note:Power off the fan before product maintenance or cleaning the fan.

FCC Statement:

NOTE:This equipment has been tested and found to comply with the limits for a Class B digital device, pursuant to part 15 of the FCC Rules, These limits are designed to provide reasonable protection against harmful interference in a residential installation. This equipment generates, uses and can radiate radio frequency energy and, if not installed and used in accordance with the instructions, may cause harmful interference to radio communications. However, there is no guarantee that interference will not occur in a particular installation. If this equipment does cause harmful interference to radio or television reception, which can be determined by turning the equipment off and on, the user is encouraged to try to correct the interference by one or more of the following measures:

- Reorient or relocate the receiving antenna.
- Increase the separation between the equipment and receiver.
- Connect the equipment into an outlet on a circuit different from that to which the receiver is connected.
- Consult the dealer or an experienced radio/TV technician for help.

WARNING: Changes or modifications to this unit not expressly approved by the party responsible for compliance could void the user's authority to operate the equipment.

Troubleshooting:

Your fan may occasionally jerk forward and backward upon start up. This is normal and does not affect fan operation.
Try these troubleshooting steps before contacting Customer Service.

Issue	Solution
The fan will not start.	1.Make sure the fan is receiving power. 2.Check your circuit breaker or fuse panel and wall switch for functionality. 3.Make sure the fan is properly wired and grounded. Check all connections for any damaged, broken, or frayed wires. 4.Make sure the plastic film in the remote's battery tray has been removed. 5.Remote control must be paired within 10mins of connecting ceiling fan to power source. 6.Check to make sure remote control is correctly paired. 7.Any wires connecting ceiling fan to power source must be in ON position. 8.Try to search the WIFI signal on your phone settings and connect with the app, check to see if the app is able to find the fan. 9.If you have paired the remote or the app and the fan still does not start, then try to reset the fan: To reset the fan, cut the power for 10 minutes, then turn the power on and press the pairing button  on the remote for 5 seconds until "beep", then pair the app again to reconnect.
The fan wobbles and noisy	1. Blade screws with the plastic round part against the motor or not. 2. Check all the pin wire connect against the moving part. 3. Check the down fan cup hit the motor. 4. The light kit slanting. 5. Check the down rod slanting or not. 6. Make sure the colour sticker on the motor and blades match each other. 7. Turn off the fan then make the fan running by hand and listen still have noise or not. 8. Take out the middle black cover on the light kit and check the middle big nut loose or not. 9. When the fan running, touch the light kit by hand, try to make the light kit stable. 10. Check the downrod and pivot ball hanging on the bracket if it is seated correctly and in the retention slot. 11. Check all mounting points and bracket to see if there are any screws loose. 12. The ceiling beam must meet the tensile test strength of 30KG for installation. 13. Make sure the airfoils or brackets have not been bent or deformed.
LED OFF	1.Make sure LED wires connect with the controller. 2.Make sure the whole fan is powered. 3.Make sure the remote control code is matching.
Unable to pair remote and app	1.Check if the wires are connected in the right position or not. 2.Check the batteries on the remote. 3.Disconnect the power for 10 minutes, then reconnect the power and pair the remote with the fan again within 5 seconds. Also try to pair the app again to reconnect. 4.The WIFI must be 2.4Ghz, incompatible with 5Ghz WIFI.
Try these troubleshooting steps before contacting Customer Service. For additional operation, maintenance, and troubleshooting information, please contact our service center directly.	

cs@carrohome.com
1431 S. Baker Ave. Ontario, CA 91761 USA
Tel: 888-253-2374

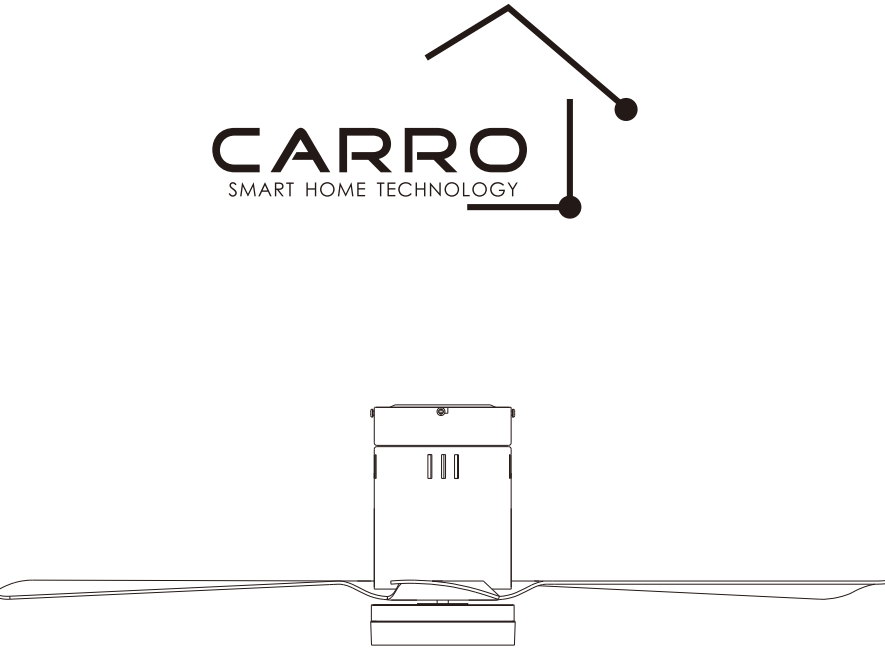

ITEM: CES523PL

Technical Parameter: AC 100-240V 50/60HZ
DC 24V 49W

SMART CEILING FAN INSTALLATION GUIDE
Please read and follow the instructions carefully before using this product