

Magdeco

# Outdoor Privacy Screen



Email: [Haiyun20220510@outlook.com](mailto:Haiyun20220510@outlook.com)





If the privacy screen will be used in a strong wind area, we highly recommend you using four Hex-Head Sleeve Anchors to fix the privacy screen on solid ground.

Before assembling, we recommend:

1. Wear Gloves.

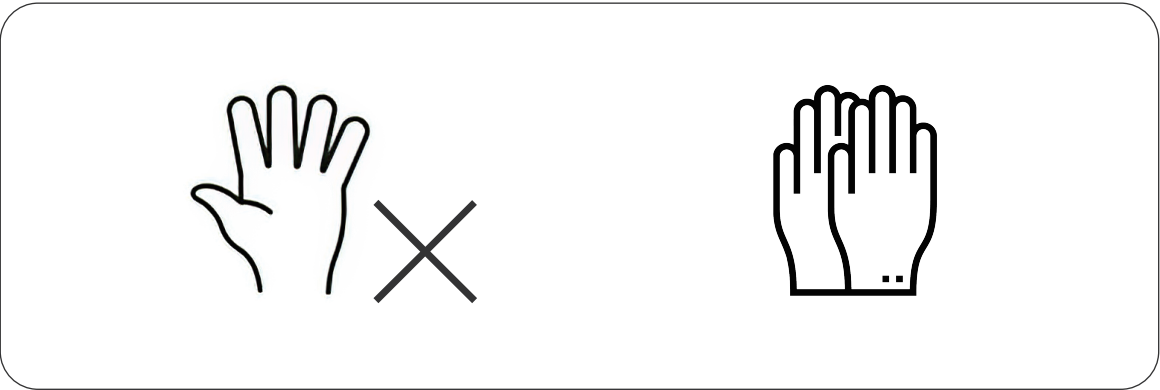

2. Don't assemble the privacy screen on a Hard Surface.

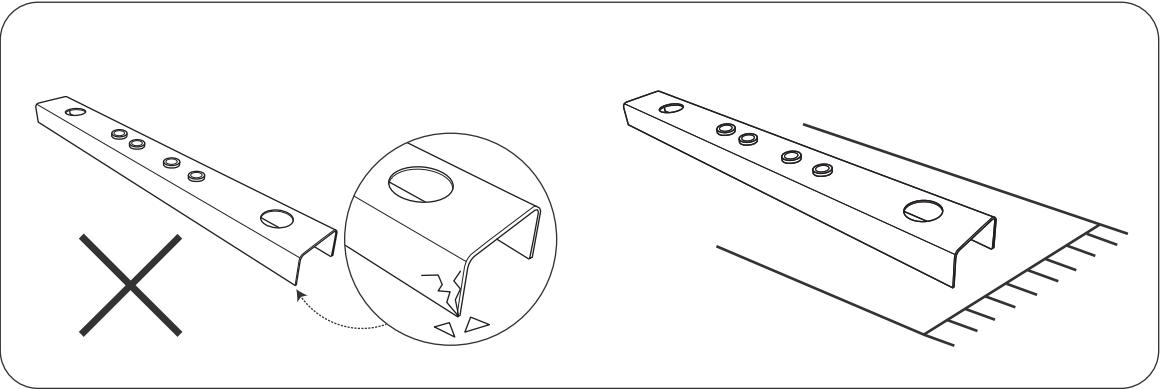

3. Ask for a Helping Hand.

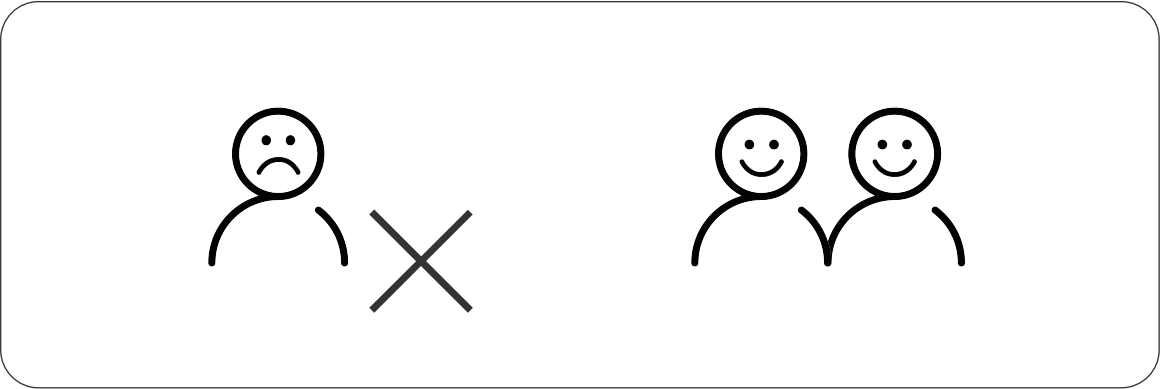

4. Use Hex-Head Sleeve Anchors to fix the privacy screen on solid ground if necessary.

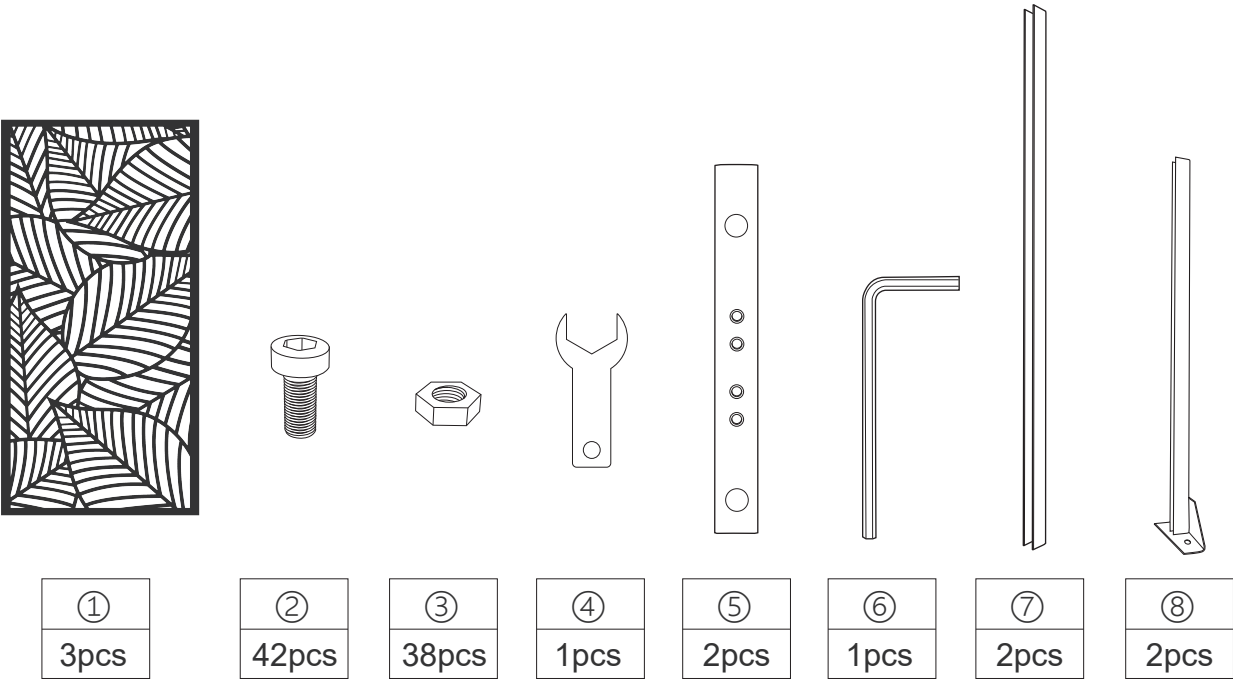
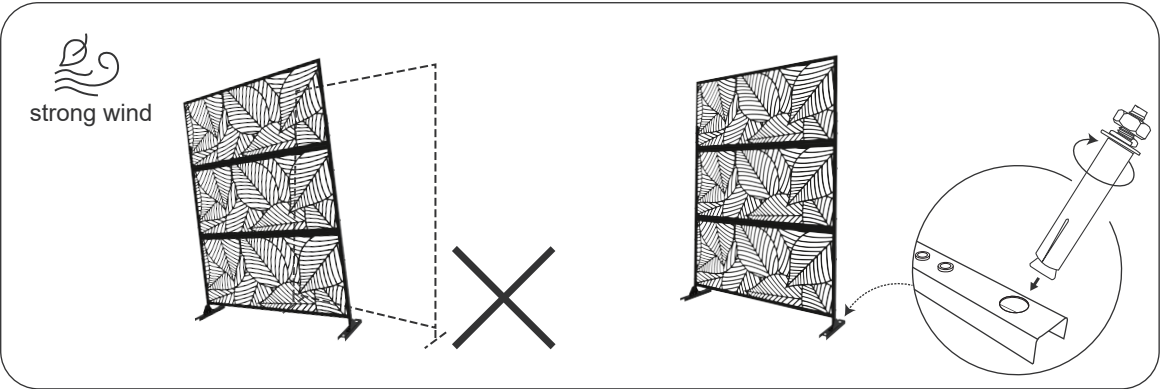



# Vertically Install

1.

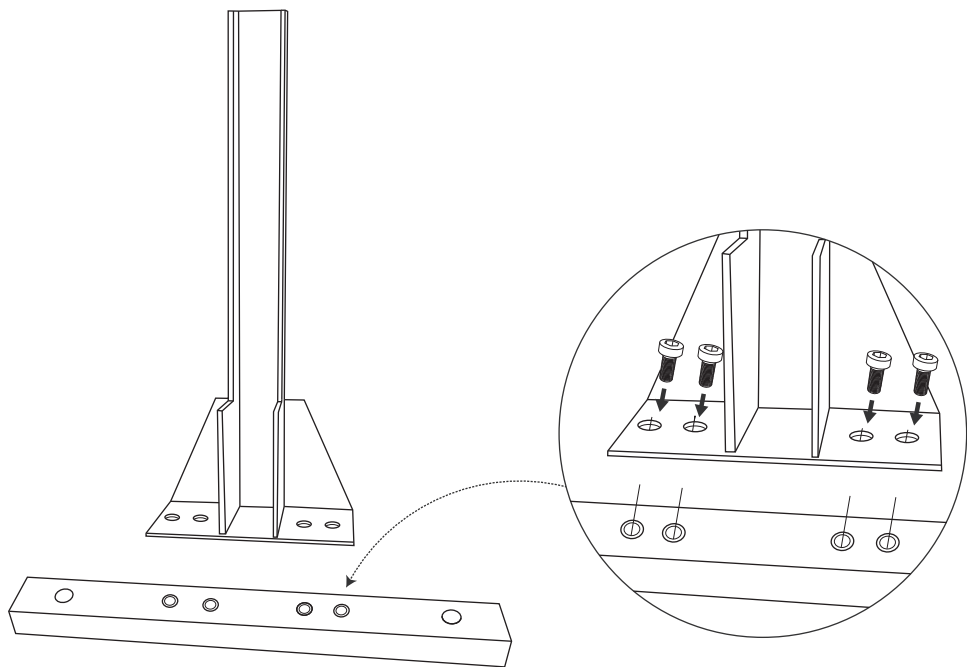

2.

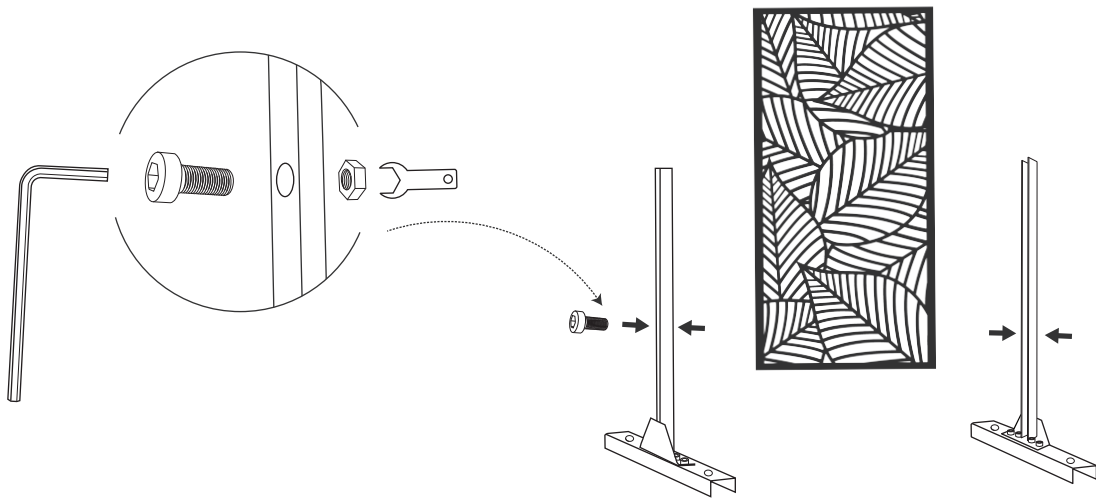

3.

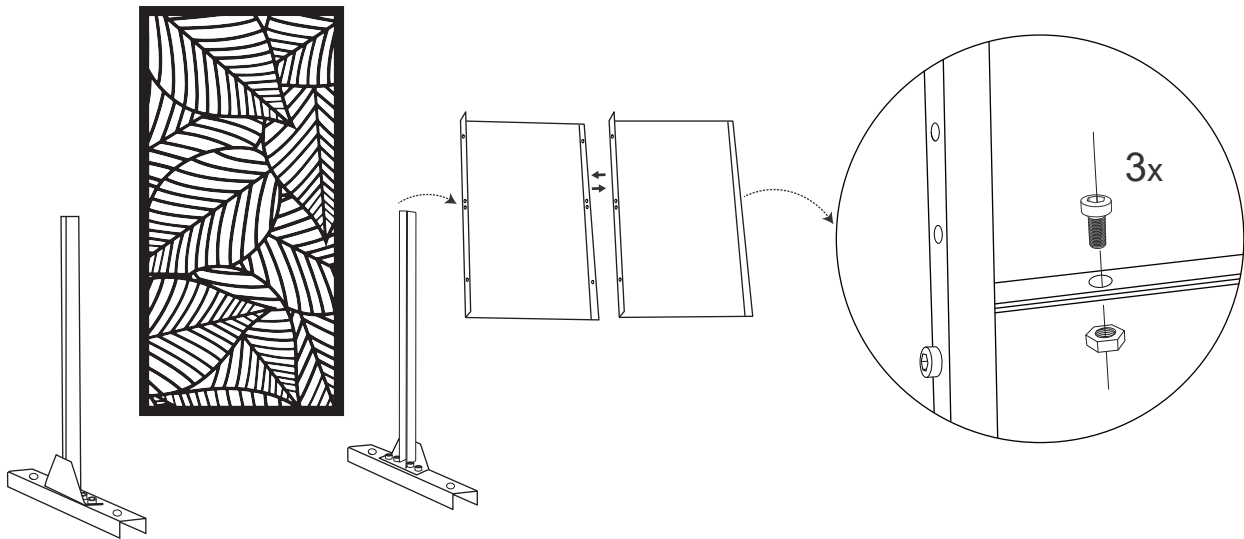

4.

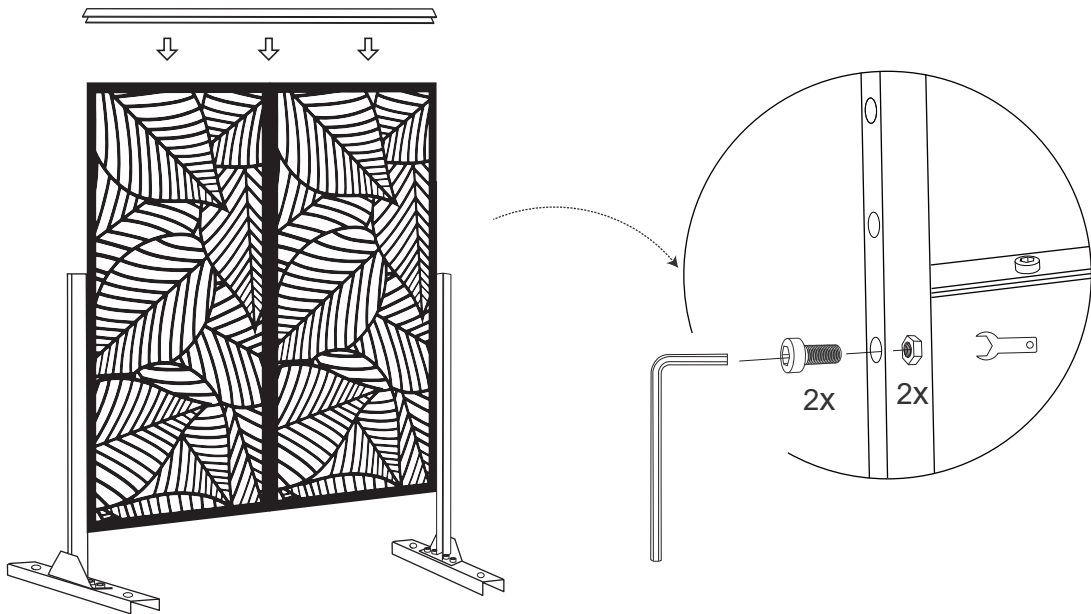

# Single Panel Installation

5.

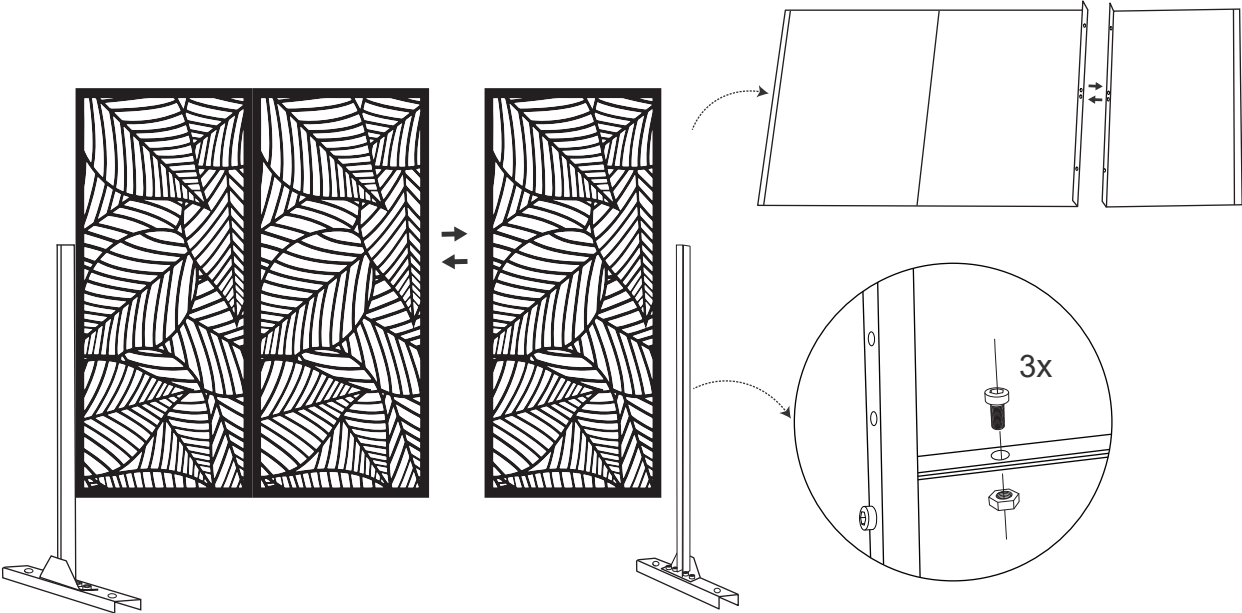

1.

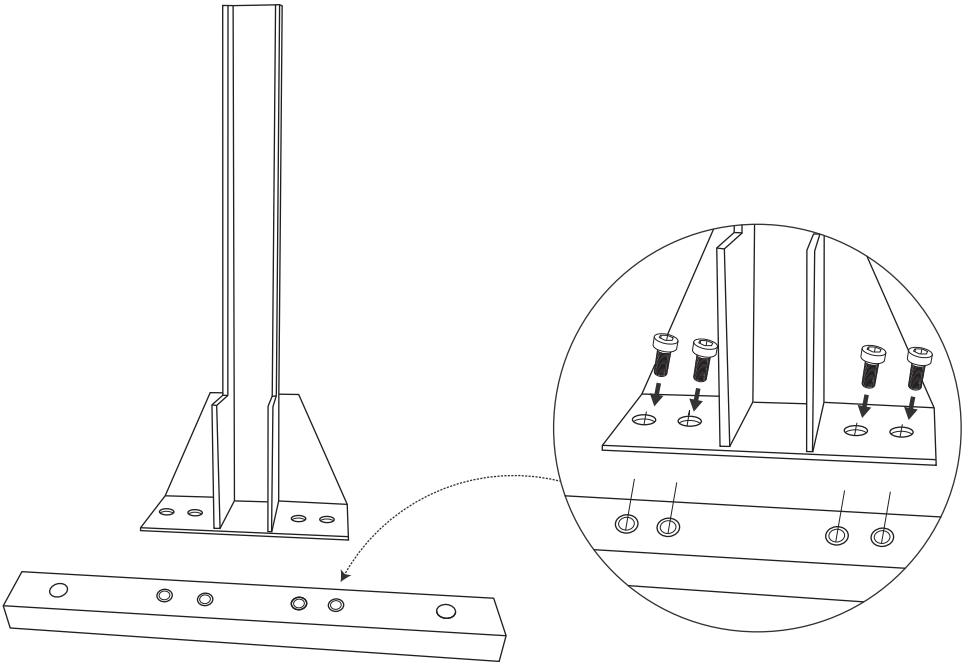

6.

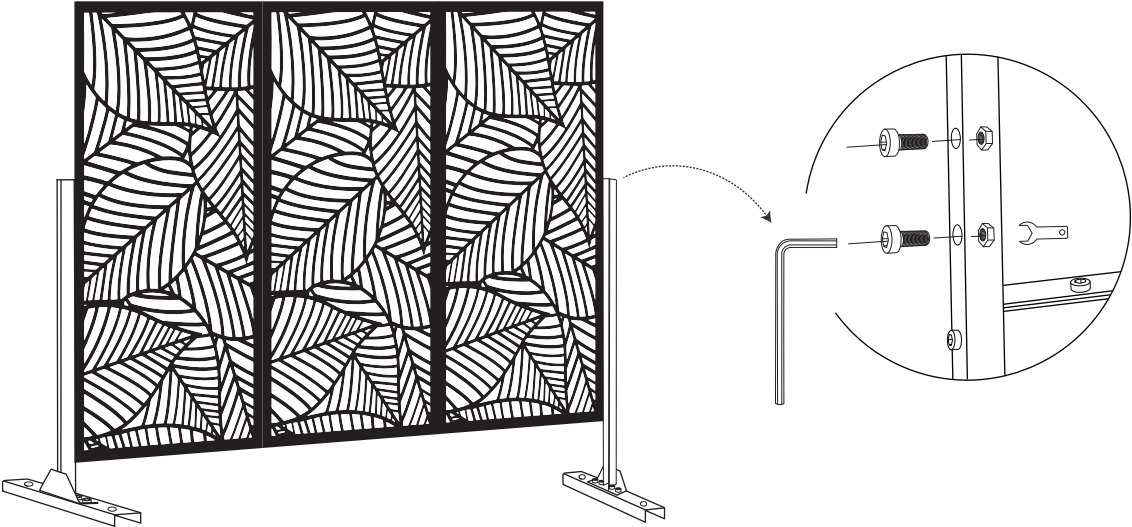

2.

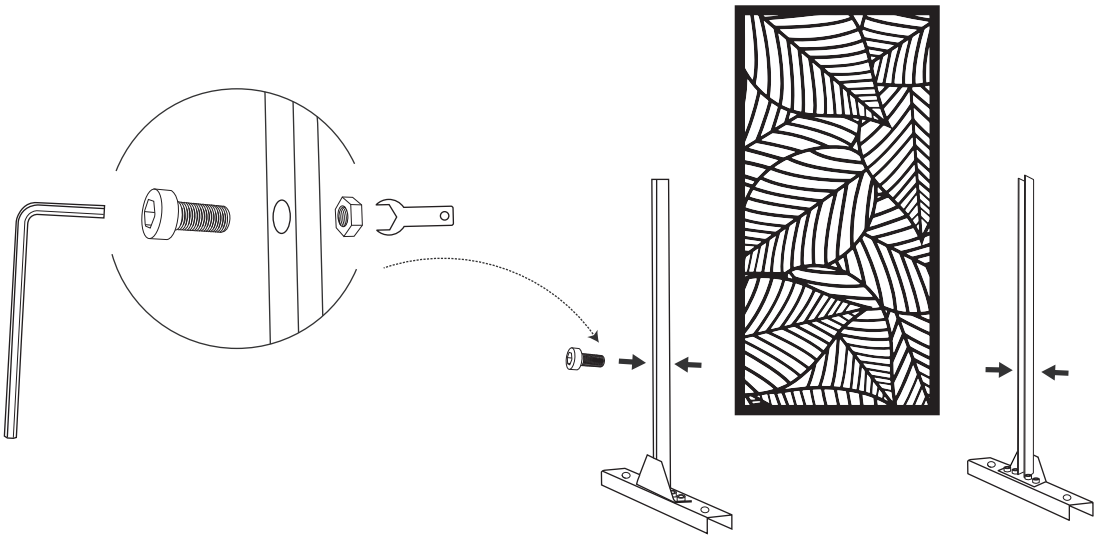

3.

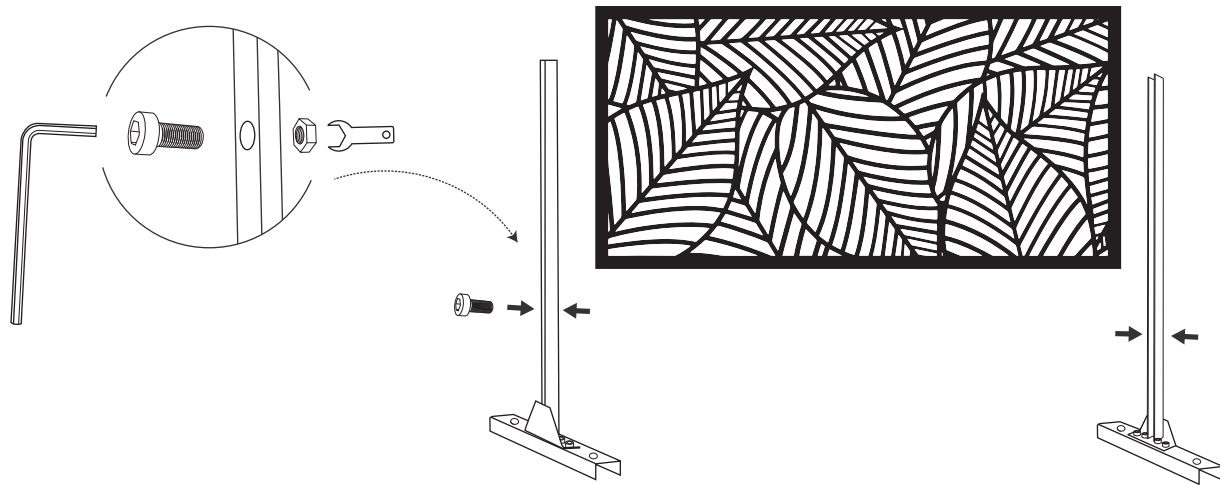

4.

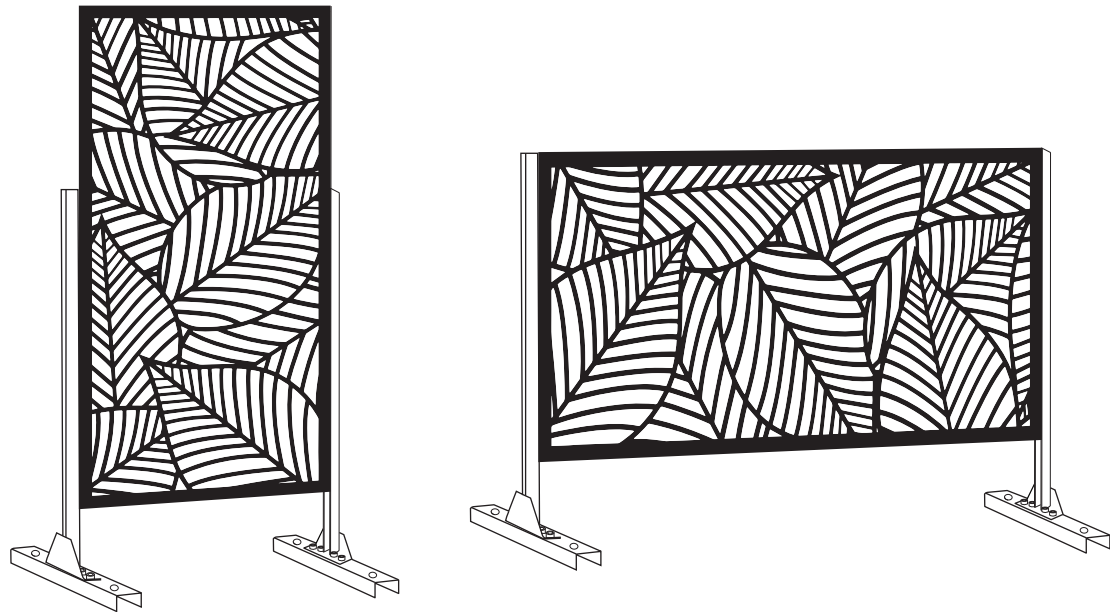

5.

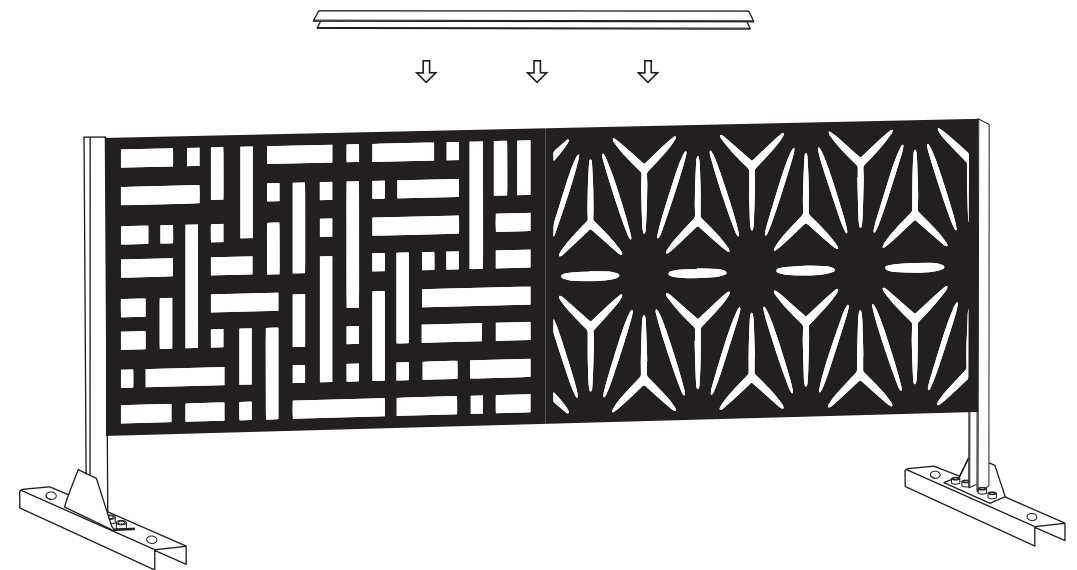
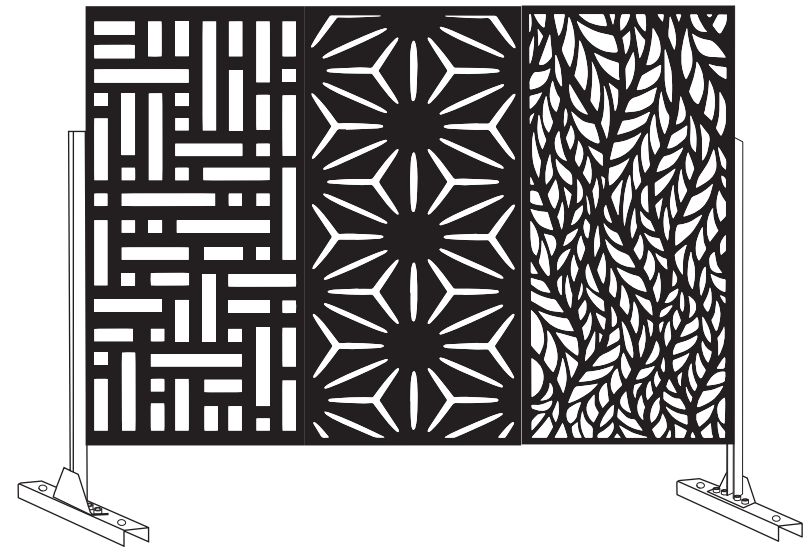

# Horizontally Install

1.

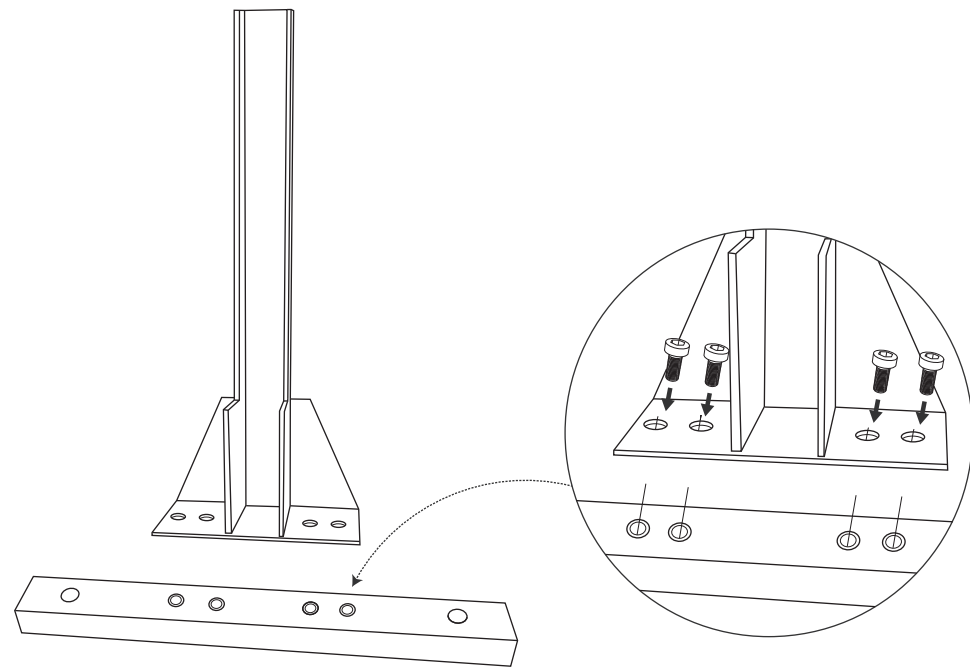

2.

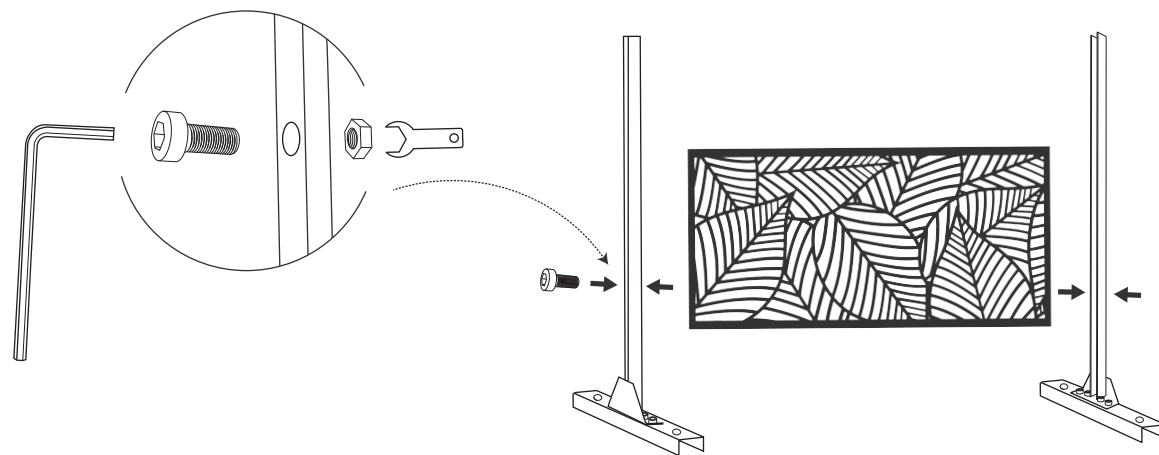

3.

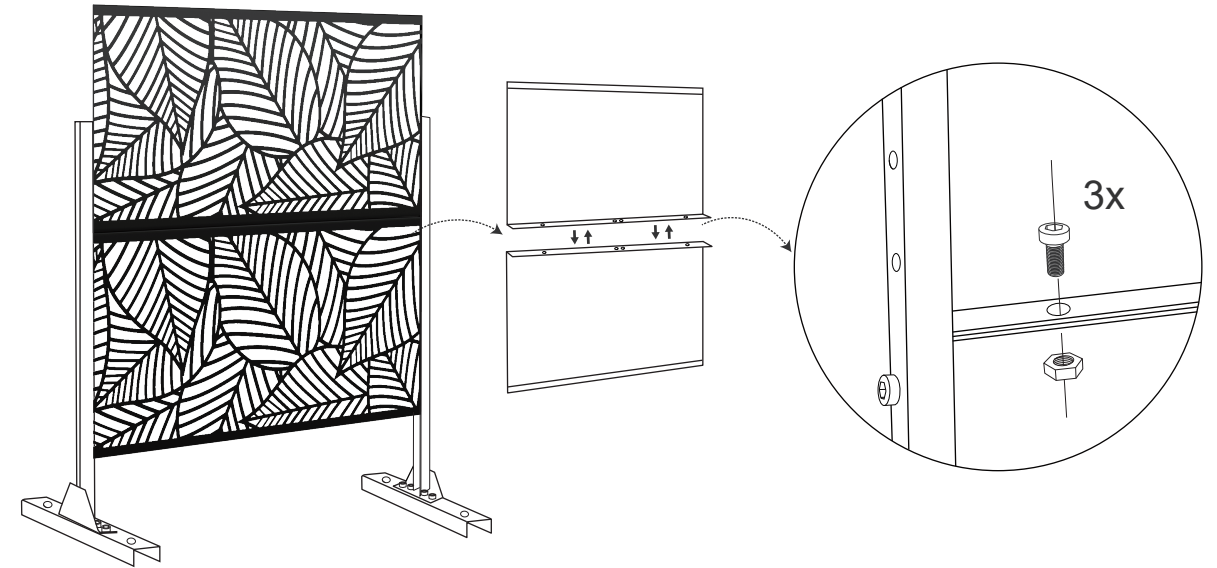

4.

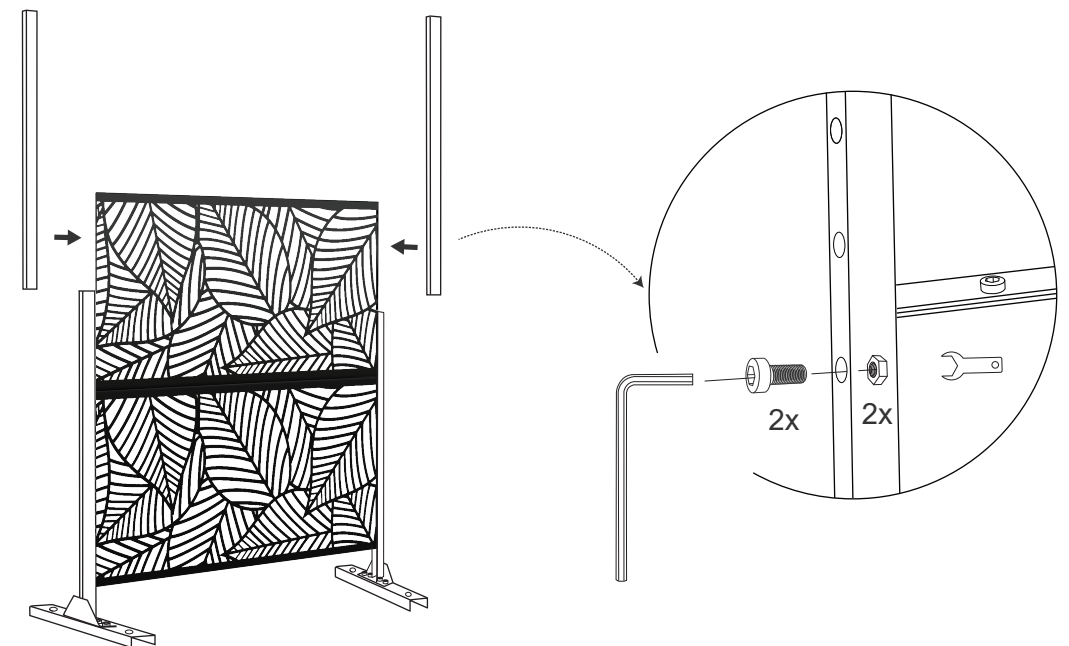



5.

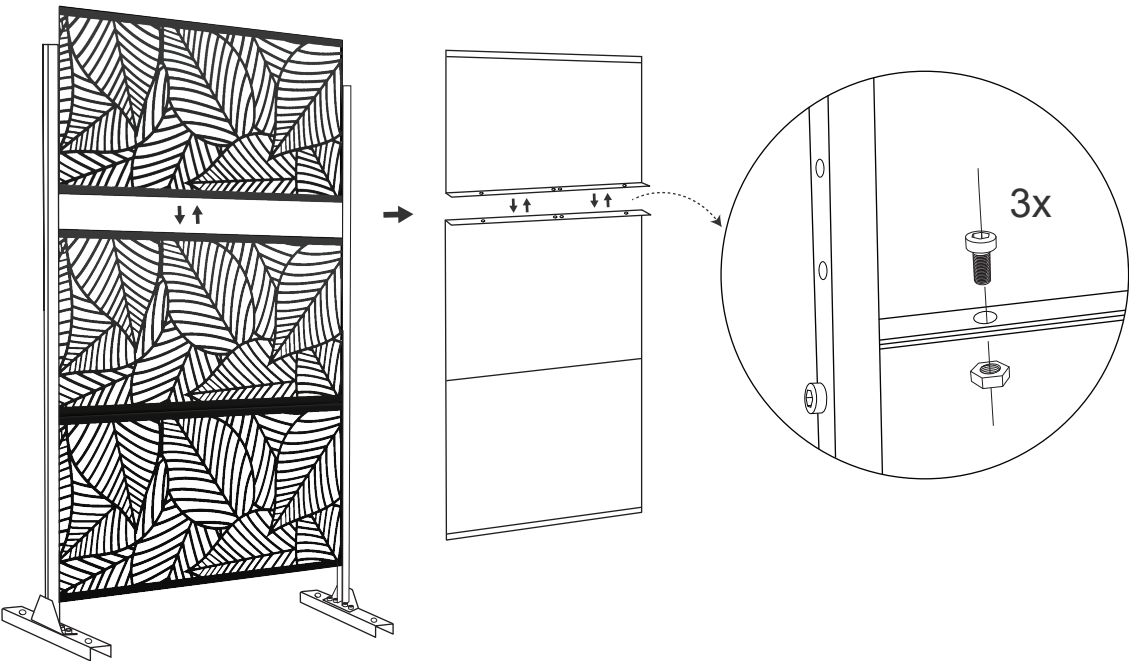

6.

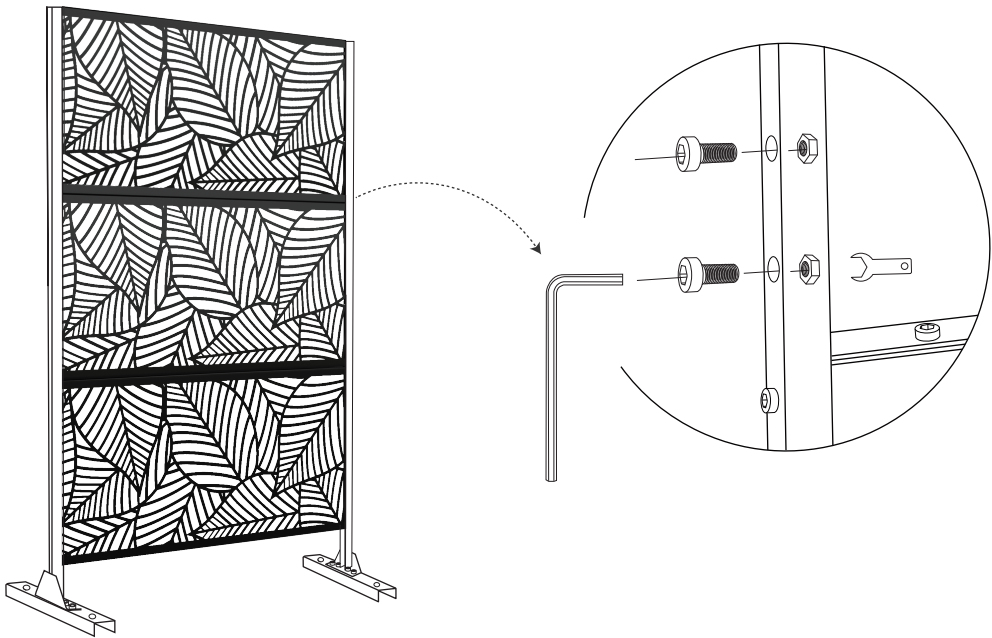

We have various choices of pattern for you:

