



# LED light wand

## User Manual

### I. LOADING BATTERY:

1. Unscrew the button by twisting the end cap counter-clockwise. A coin or flat screwdriver (not included) may be used if needed.
2. Push out the inner casing from the tube and insert 3 "AAA" batteries (not included), noting the correct polarity. Insert the casing back into the tube and screw the end cap back on. (see Fig. 1)

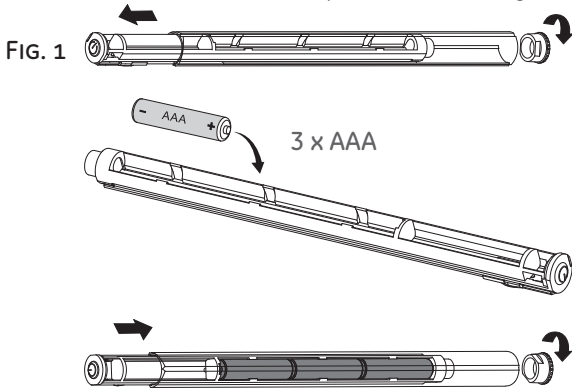

**Note:** Remove batteries when not in use.

### II. LIGHT MODE SELECTION:

Press the on/off button to cycle through to the preferred light mode. (see Fig. 2) This light offers 3 modes for use: ON (full brightness), ON (dim), and OFF.

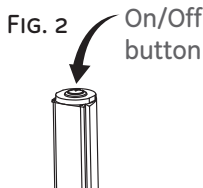

### III. INSTALLATION:

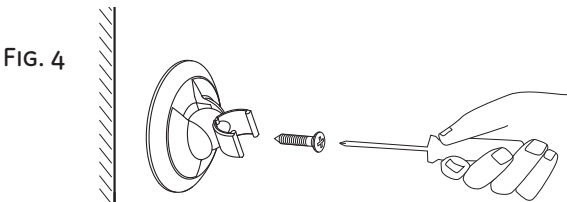
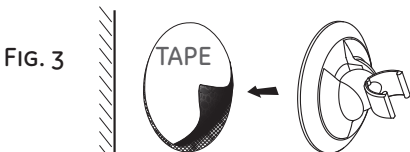

1. Mount the light in the desired position using the hook-and-loop tape (included) (see Fig. 3) or by using a screw (included). Note the diagram in Fig. 4 for proper installation using a screw.
2. Turn the power on and set the mode you need.
3. Snap the light tube into the stand clip.

### IV. FEATURES:

This device can be mounted nearly anywhere, and can be positioned vertically or horizontally. Additionally, the light can be detached from the base to be used as a hand-held utility light

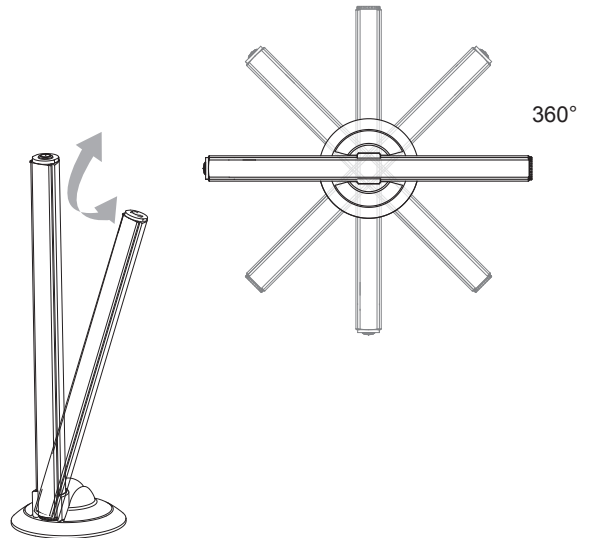

**⚠ WARNING**

- BATTERIES MAY LEAK HARMFUL LIQUIDS OR IGNITABLE MATERIALS OR EXPLODE CAUSING INJURY AND PRODUCT DAMAGE
- DO NOT MIX OLD AND NEW OR OTHER BATTERY TYPES
- REPLACE ALL BATTERIES AT THE SAME TIME
- REMOVE BATTERIES IF PRODUCT IS TO BE UNUSED FOR EXTENDED PERIODS OF TIME

12747 Manual v01  
05/05/15 RT

MADE IN CHINA

GE is a trademark of General Electric Company and is under license by Jasco Products Company LLC, 10 E. Memorial Rd., Oklahoma City, OK 73114.

This Jasco product comes with a limited-lifetime warranty.

Visit [www.jascoproducts.com](http://www.jascoproducts.com) for warranty details and product registration.

Questions? Contact us at 1-800-654-8483 between 7:30AM–5:00PM CST.



# Varilla de iluminación LED

## Manual de usuario

### I. LOADING BATTERY:

1. Unscrew the button by twisting the end cap counter-clockwise. A coin or flat screwdriver (not included) may be used if needed.
2. Push out the inner casing from the tube and insert 3 "AAA" batteries (not included), noting the correct polarity. Insert the casing back into the tube and screw the end cap back on. (see Fig. 1)

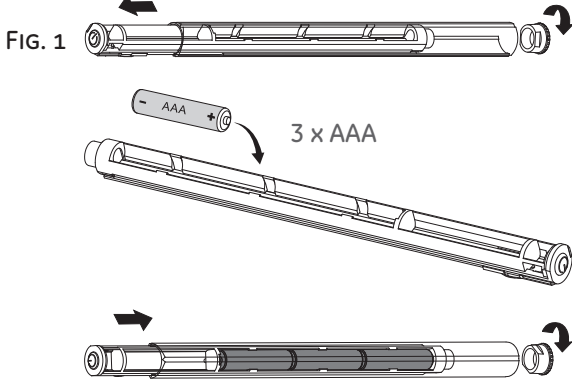

**Note:** Remove batteries when not in use.

### II. LIGHT MODE SELECTION:

Press the on/off button to cycle through to the preferred light mode. (see Fig. 2) This light offers 3 modes for use: ON (full brightness), ON (dim), and OFF.

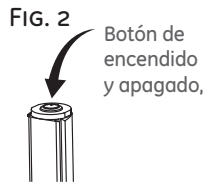

### III. INSTALLATION:

1. Mount the light in the desired position using the hook-and-loop tape (included) (see Fig. 3) or by using a screw (included). Note the diagram in Fig. 4 for proper installation using a screw.
2. Turn the power on and set the mode you need.
3. Snap the light tube into the stand clip.

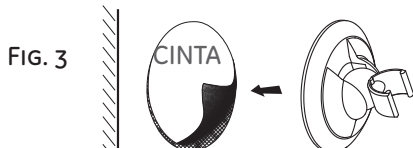
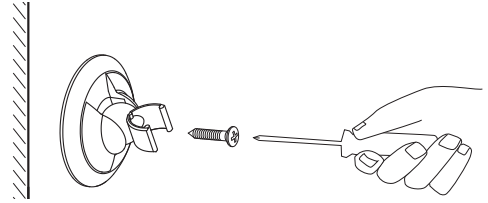
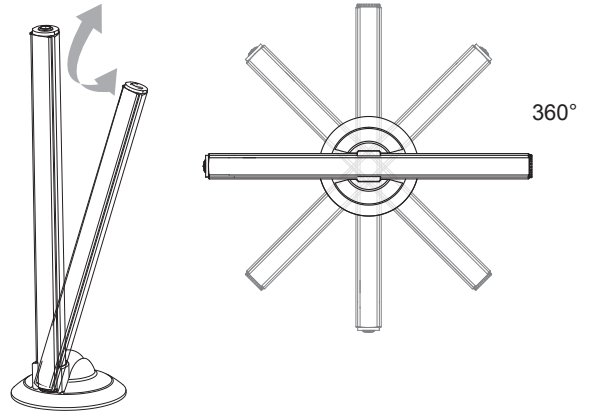

FIG. 4



### IV. FEATURES:

This device can be mounted nearly anywhere, and can be positioned vertically or horizontally. Additionally, the light can be detached from the base to be used as a hand-held utility light



### ⚠ ADVERTENCIA

- LAS PILAS PUEDEN PERDER LÍQUIDOS PERJUDICIALES O MATERIALES INFLAMABLES, O EXPLOTAR Y CAUSAR LESIONES Y DAÑOS EN LOS PRODUCTOS.
- NO COMBINE PILAS VIEJAS Y NUEVAS, NI TIPOS DE PILAS DISTINTAS.
- REEMPLACE TODAS LAS PILAS AL MISMO TIEMPO.
- quite las pilas si no usará el producto durante periodos prolongados.

HECHO EN CHINA

GE es una marca registrada de la compañía General Electric Company y es utilizada bajo licencia a la compañía Jasco Products Company LLC, 10 E. Memorial Rd., Oklahoma City, OK 73114.

Este producto de Jasco Products tiene una garantía limitada de por vida. Visite [www.jascopeproducts.com](http://www.jascopeproducts.com) para detalles.

¿Tiene preguntas? Comuníquese al 1-800-654-8483 entre las 7:30 a.m. y las 5:00 p.m. CST (hora central estándar).