

# *Marine Washer*

**Model: 828**

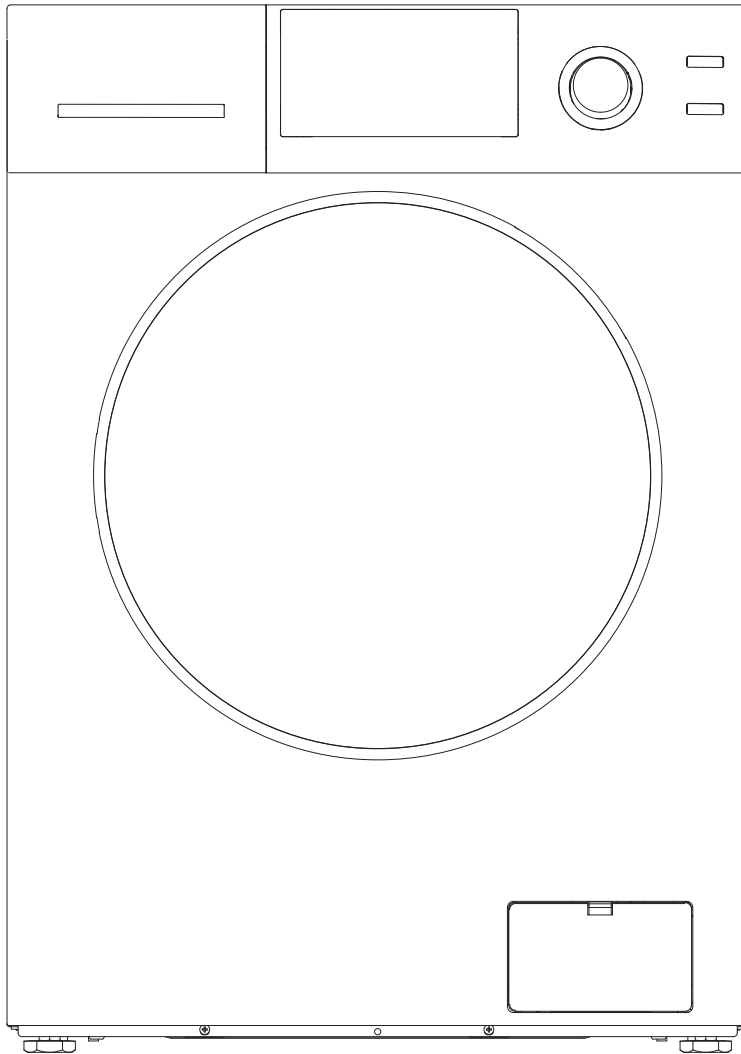

## **OWNER'S MANUAL**

Read the instructions carefully and keep for future reference. Information may be updated from time to time so please refer to the website for the latest version of the manual.



**DO NOT RETURN TO STORE!**

**HAVE QUESTIONS OR NEED SERVICE?**



**1-800-776-3538**



**Service@ApplianceDesk.com**

## ***Congratulations on your new Marine Washer!***

In addition to its contemporary design, this is a highly sophisticated engineered product that will give you many years of satisfaction.

### **Here are some of the best reasons for buying your Marine Combo**

1. Cabinet - Galvanized steel with phosphate treatment and painted, to prevent rust
2. Nuts, Bolts, Screws, Clamps - Stainless steel grade 316
3. Terminals and Connecters - Conformal coating to prevent moisture build-up
4. Spider wheel (Containing Bearings): Conformal coating to prevent rust
5. Tub Enamel: 2 coats of enamel on tub to prevent rust

### **Upgraded Accessories Included:**

1. Stainless Steel Inlet hoses (2)
2. Floor Bracket (2)

## **TABLE OF CONTENTS**

### **Please read the Owner's Manual carefully before using your Fully Automatic Washer**

Introduction.....	1
Warranty.....	2
Technical Data.....	4
Important Safety Instructions .....	5
Diagram of the Washer .....	7
Handling and Placement .....	8
Installation Instructions .....	9
Electrical.....	10
Plumbing.....	11
Special Installations Requirements .....	12
Program Selection Chart .....	13
Control Panel.....	15
Maintenance.....	17
Troubleshooting.....	20
Error Codes.....	21

# INTRODUCTION

## 1. Easy Operation

This appliance is simple to use as a washer.

## 2. Efficient Operation

With a high spin speed of 1400 rpm, more water is extracted, allowing shorter dry times.

## 3. Convenience

This appliance can be permanently installed and be made portable with the installation of the portability kit (sold separately) where needed.

## 4. Placement Options

The Washer's sleek design makes it a perfect appliance for any kitchen or laundry room. Its compact size makes the Washer perfect for placement on each floor of your home.

## 5. Better Clothing Appearance

This Washer has no agitator to damage your clothes so they look better and last longer.

## 6. Water Savings

This appliance uses very little water for washing and far less than a standard full size top-loading washer. A new feature introduced is automatic water level which helps in saving water as it automatically decides the water intake depending on the quantity of your clothes.

## 7. Energy Savings

This appliance is engineered to provide valuable energy savings when compared to other washers

## 8. Maintenance

Since the machine has a self-cleaning pump, this appliance needs no cleaning of lint after every washing. Instead, there is a convenient coin trap which only needs to be cleaned every few months.

## 9. Space Savings

The washer is of optimum size thus saving previous space around your home.

## 10. Add a sock

In this feature, the program can be stopped at any time to add forgotten items to the wash. Press PAUSE for 5 seconds. Door will open after draining water so that it does not overflow. Load clothes. Close door. Press the START button. Washer will continue from the point it stopped.

## WARRANTY INFORMATION

**Your appliance is protected by this warranty under normal, personal, family or household use for 1 Year Parts & Labor and limited commercial use (90 days) in USA and Canada.**

### WARRANTY

Consolidated Brands undertakes to the consumer/owner to repair or, at our option, to replace any part of this product which proves to be defective in workmanship or material under normal personal, family or household use in USA and Canada, for a period of one years parts & labor from the date of original purchase. For commercial use, the product is warranted for a period of 90 days.

During this period, we will provide all labor and parts necessary to correct such defect, free of charge, if the appliance has been installed and operated in accordance with the written instructions provided with the appliance. Ready access to the appliance, for service, is the responsibility of the consumer/owner. If unit installed in closet or cabinet, it should be removed for access by service technician. If this cannot be done, then there will be extra charge.

We may require return of products or parts to our warranty department for which the shipping charges are to be incurred by the consumer. If a return or replacement is required, allow 3-4 weeks to process. If unit is located more than 25 miles there will be a trip charge. If unit is in remote area more than 75 miles, customer will need to take the product to the technician's workshop.

Replacement unit will be delivered with curbside delivery only. If Unit is installed in a 5th wheel RV, in a location behind the axle it won't be covered under warranty.

All repairs or replacements are warranted only for the remainder of the original warranty period. Charges may incur if warranty coverage is not applicable. Service would be provided from Monday to Friday between normal business hours.

### GENERAL

Since it is the responsibility of the consumer/owner to establish the warranty period by verifying the original purchase date, Consolidated Brands recommends that a receipt, delivery slip or some other appropriate payment record be kept for that purpose. This warranty gives you specific legal rights, and you may also have other rights which vary from State to State.

You can register your Warranty by either of the following methods:

1. Scan QR Code
  - Open Smart Phone
  - Open Camera
  - Click the Link
2. Register online at [ApplianceDesk.com/Warranty](https://ApplianceDesk.com/Warranty)
3. QR Code is also used to obtain Product Information, Manuals and Updates



### WARRANTY SERVICE

This warranty is given by:

**Consolidated Brands**  
**10222 Georgibelle Drive, Suite 200,**  
**Houston, TX 77043-5249**

#### QUESTIONS / SERVICE

Phone/Text: 1-800-776-3538  
Email: [Service@ApplianceDesk.com](mailto:Service@ApplianceDesk.com)  
Web: [www.ApplianceDesk.com](http://www.ApplianceDesk.com)

## EXCLUSIONS

---

In no event shall Consolidated Brands be liable for incidental or consequential damages or for damages resulting from external causes such as abuse, operation misuse, neglect, alterations, normal wear and tear, incorrect voltage or acts of God. This warranty does not cover service calls which involve defective workmanship, damage due to other products while combined use with this product or materials covered by this warranty. Accordingly, diagnosis and repair costs for a service call which involves defective workmanship or materials will be the responsibility of the consumer-owner.

Most work is covered. The defining factor is has the machine malfunctioned (Consolidated Brands is responsible) or has the customer omitted or done something to cause malfunction (customer is responsible).

### THE FOLLOWING WORK ARE NOT COVERED UNDER WARRANTY:

#### Installation

1. Non-removal of shipping bolts, causing vibration / internal damage.
2. Non-adjustment of feet to level machine, causing vibration / internal damage.
3. Not conforming to minimum space requirements for built-in installation, causing excess heat and resulting in damage to internal components.
4. Installation in a corrosive environment.
5. Incorrect water pressure i.e below 7.25 psi or above 145 psi
6. Incorrect water inlet hose installation (use only factory supplied hoses with metric threads on the L shaped side to fit water valve)

#### Maintenance

1. Non-cleaning of coin trap for debris, causing the unit to not drain out water and resulting in drain pump malfunction.
2. Improper maintenance (such as, but not limited to, scale build-up, freeze damage, or vent blockage).

#### Damage

1. Breakage of cosmetic parts e.g., door handle, knob.

#### Other

1. Accident, abuse or misuse.
2. Using solvents to clean the machine or wash clothes, causing damage.
3. Misapplication of this product e.g., use in a non household/commercial environment.
4. Any other cause not due to defects in materials or workmanship.
5. Problems or damage due to fires, flooding, electrical surges, freezing or any acts of God.
6. Any damage caused by poor water quality.
7. Operating the appliance with anything other than potable water at all times.
8. Force majeure.

### Warranty Limitations

1. If a unit is located more than 25 miles away, there will be a trip charge.
2. If a unit is in a remote area more than 75 miles away, the machine should be taken to the technician's workshop.
3. If the unit is installed in a 5th wheel RV, in a location behind the axle, it will not be covered under warranty.
4. All repairs or replacements are warranted only for the remainder of the original warranty period.
5. If a return or replacement is required, allow 3-4 weeks to process.
6. Replacement units will be delivered with curbside delivery only.
7. We may require the return of products or parts to our warranty department for which the shipping charges are to be pre-paid by the consumer / owner.
8. Charges may be incurred if warranty coverage is not applicable.
9. Service would be provided from Monday to Friday between normal business hours.

## TECHNICAL DATA

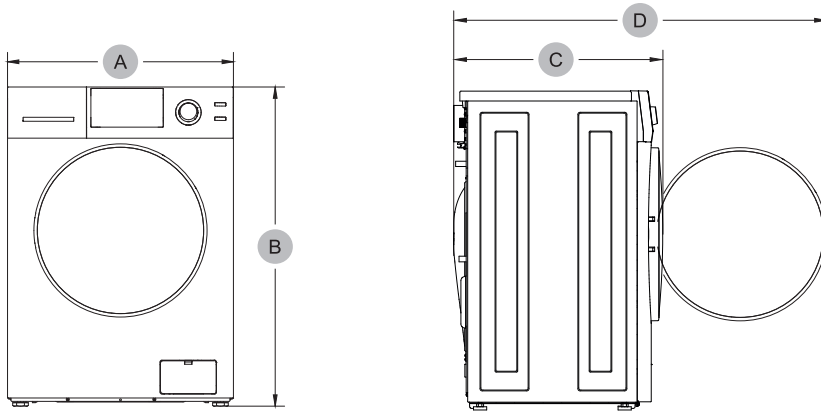

Type		Front loading washing machine
Model		<b>828</b>
Dimensions (inches/mm)	A. Width	23.6 / 600
	B. Height-overall	33.5 / 850
	C. Depth	21.85 / 555
	D. Depth with door open	38.54 / 979
Rated voltage		110-120V / 60Hz 10A
Water pressure (psi/Mpa)		7.25 - 145 / 0.05- 1.00
Wash capacity (lb/kg)		15.0 / 7.0
Net weight (lb/kg)		152 / 69
Spin revolution (rpm)		Max. 1,400
Power consumption (W)	Washing	120
	Spin	500
	Wash heater	1,000



**Intertek**  
4007606

**Electrical Testing Laboratories**

**US    N° 4007606    CANADA**

*The ETL Listed Mark is the legal equivalent to the UL and CSA Listed Marks*

**Note:** All rights reserved.  
Designs, Specifications and Manual subject to change without notice

## IMPORTANT SAFETY INSTRUCTIONS

**Your washing machine has been built in compliance with safety regulations, to protect you and all your family.**

**WARNING** – To reduce the risk of fire, electric shock, or injury to persons when using your appliance, follow basic precautions, including the following:



1. Read all instructions before using the appliance.
2. Do not wash articles that have been previously cleaned in, washed in, or spotted with gasoline, other flammable or explosive substances, as they emit vapors that could ignite or explode.
3. Do not allow children to play on or in the appliance. Close supervision of children is necessary when the appliance is used near children.
4. Before the appliance is removed from service or discarded, remove the door.
5. Do not reach into the appliance if the tub or drum is moving.
6. Do not install or store this appliance where it will be exposed to the weather.
7. Do not tamper with controls.
8. Do not repair or replace any part of the appliance or attempt any servicing unless specifically recommended in the user-maintenance instructions or in published user-repair instructions that you understand and have skills to carry out.
9. Do not add gasoline, dry-cleaning solvents, or other flammable or explosive substances to the wash water. These substances give off vapors that could ignite or explode.
10. Under certain conditions, hydrogen gas may be produced in a hot water system that has not been used for 2 weeks or more. **HYDROGEN GAS IS EXPLOSIVE.** If the hot water system has not been used for such a period, before using the washer, turn on all hot water faucets and let the water flow from each for several minutes. This will release any accumulated Hydrogen.
11. Do not use fabric softeners or products to reduce static unless recommended by the manufacturers of the fabric softener product
12. Check the Coin Trap every few months to remove any coins, buttons or similar size objects.

---

**SAVE THESE INSTRUCTIONS**

---

## SAFETY

 <b>CAUTION</b> 	The model number and the serial number are on the label affixed to the back of the unit. These numbers are also available on the front of the cabinet behind the door.
<b>RISK OF ELECTRIC SHOCK DO NOT OPEN</b>	You should note the model and serial numbers of this unit in the space provided. Retain this booklet as a permanent record of your purchase to aid in identification in the event of theft.
<b>CAUTION: TO REDUCE THE RISK OF ELECTRIC SHOCK, DO NOT REMOVE COVER (OR BACK). NO USER SERVICEABLE PARTS INSIDE. REFER SERVICING TO QUALIFIED SERVICE PROFESSIONALS.</b>	MODEL# _____ SERIAL# _____

### Safe Disposal

Before discarding the appliance, please remove the door to prevent risk of child entrapment.

Keep children away from the shipping carton and packing components.

Please dispose off this appliance and all packaging material in accordance with local regulations.

#### California Proposition 65

WARNING: This product contains chemical known to the State of California to cause cancer and birth defects or other reproductive harm.

## HELPFUL HINTS

1. Your Washer spins at a high 1200 rpm spin speed, which will extract more water especially from absorbent fabrics and reduce the degree of dampness. This will cut down on your drying time.
2. **FABRIC SOFTENER:** After the wash cycle, the clothes can get stuck to the sides of the drum. USING LIQUID FABRIC SOFTENER WILL CAUSE THE CLOTHES TO UNSTICK IMMEDIATELY AND REDUCE WRINKLES.

## USEFUL TIPS

#### Denim Alert:

Some overalls have straps with hooks that can damage the drum of your washing machine or other garments during the wash. To minimize the risk, place hooks in the pocket and fasten with safety pins.

#### Vacation:

It is recommended that you should unplug the machine from the socket and turn off the water supply. Leave the door ajar to allow air circulation to the drum and the door gasket area. This will prevent unpleasant odors.



# DIAGRAM OF WASHER

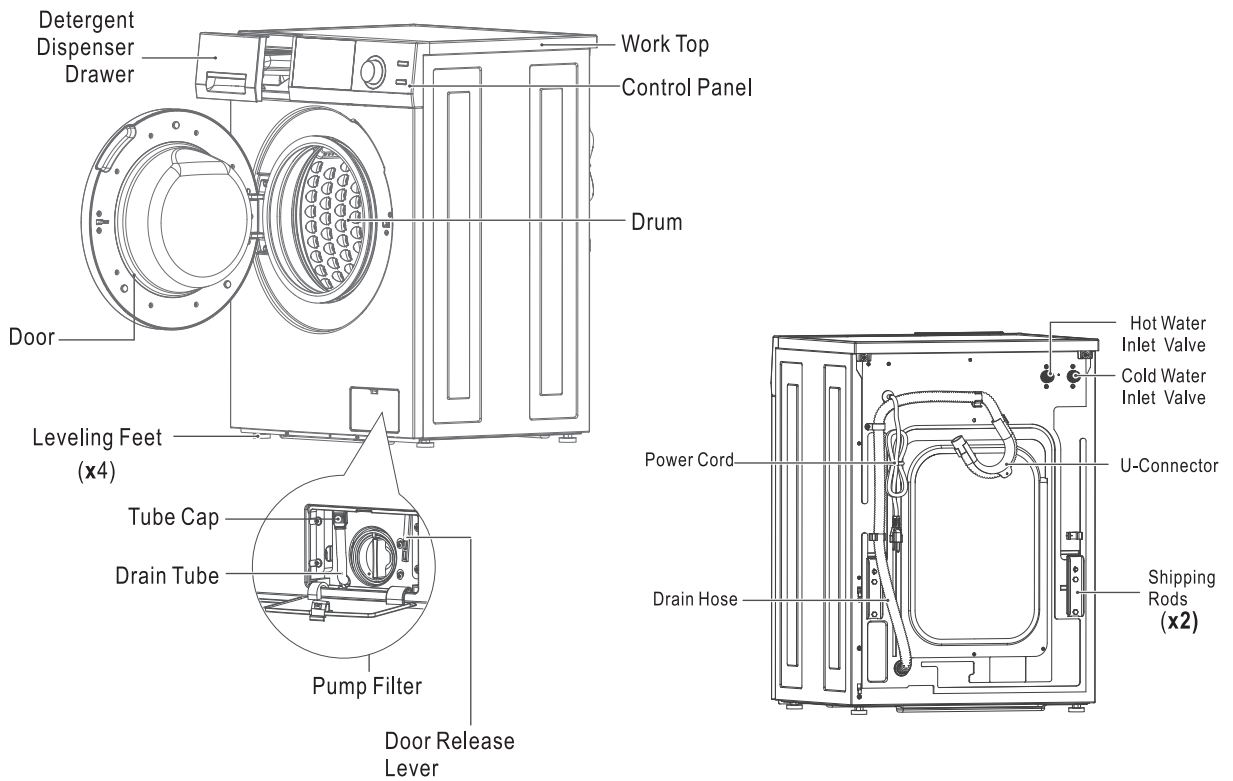

## Factory supplied accessories

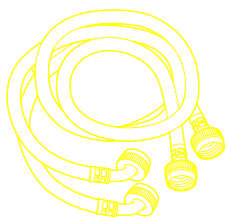

Cold/Hot water hoses



Caps for covering shipping rod holes

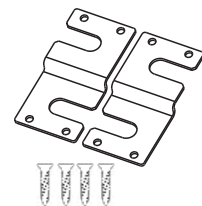

Floor Brackets with screws (x4)

### NOTE

- Contact Customer Service if any accessories are missing.
- For your safety and for extended product life, use only authorized components. The manufacturer is not responsible for product malfunction or accidents caused by the use of separately purchased unauthorized components or parts.
- The images in this guide may be different from the actual components and accessories, and are subject to change by the manufacturer without prior notice for product improvement purposes.

## HANDLING AND PLACEMENT

Remove the packing and check that the Super Combo is undamaged. If you have any doubt, do not use the Super Combo and call Customer Service. Keep all packing parts (plastic bag, foam rubber, screws, etc.) out of the reach of children since they could be dangerous.

**Important:** The inside of the Super Combo consists of a free floating drum that is affixed with shipping bolts at the back of the cabinet during transport (Fig.1). The power cord can be accessed by removing the shipping bolts (Fig. 2 & 3). Close the holes left open by the bolts with the caps provided (Fig. 4).

It is important for the machine to be perfectly level. For this reason, the machine is fitted with adjustable feet used for leveling the machine before use (Fig. 5).

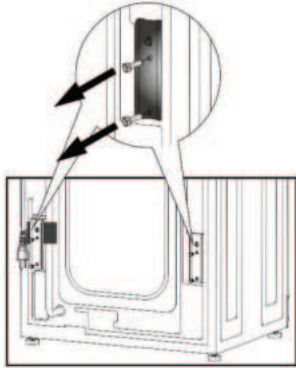

Fig.1

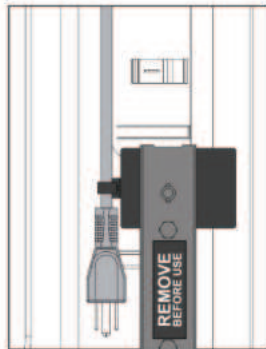

Fig.2

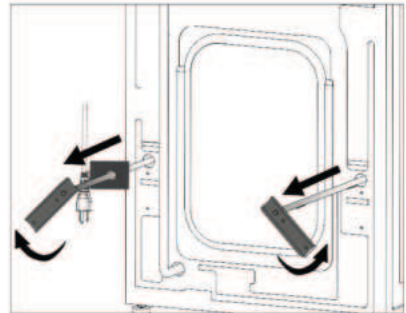

Fig.3

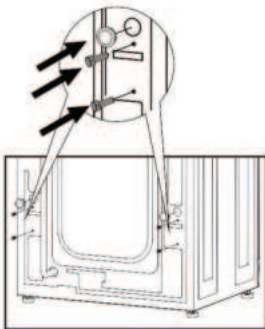

Fig.4

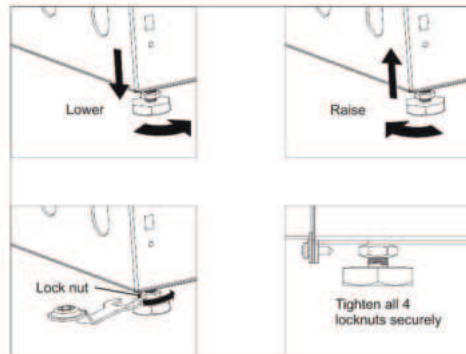

Fig. 5

### NOTE

- Save the bolt assemblies for future use. To prevent damage to internal components, DO NOT transport the washer-dryer combo without reinstalling the shipping bolts.
- Failure to remove shipping bolts and retainers may cause severe vibration and noise, which can lead to permanent damage to the combo.
- The cord is secured to the back of the combo by a clamp with a shipping bolt to help prevent operation with shipping bolts in place.
- An adjustable wrench or 17mm open end wrench is required when loosen or tighten the leveling feet.

# INSTALLATION INSTRUCTIONS

Do not drag the appliance

Do not hold protruding parts when lifting.

Install the appliance on a firm level surface.

Ensure the appliance is placed in a dry, well ventilated area.

Do not install the appliance outdoors where it can be exposed to freezing conditions.

## Secure the appliance to the floor using the floor brackets provided.

### 1. Level the appliance

- Tighten the two back feet so they are all the way in.
- Tilt the appliance back. Then adjust the two front feet up or down so the appliance does not rock side to side, or front to back when upright.

### 2. Place the brackets around the front feet (Fig.6).

### 3. Secure both brackets to the floor using a drill and 2 screws each (Fig.7).

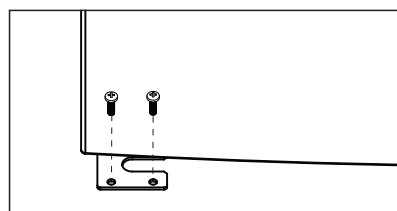
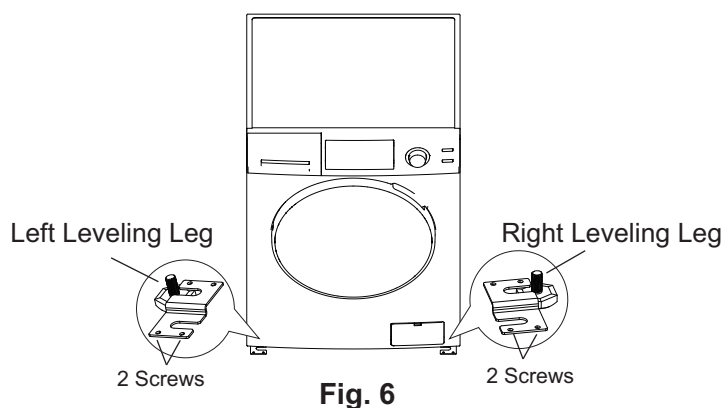

**Note: Any residual moisture inside the drum is due to the final testing which every appliance undergoes before leaving the factory.**

# ELECTRICAL

## CONNECTION

Connect the plug to a power outlet - 110V / 60Hz with minimum 15 Amps. Make sure that the voltage and frequency available correspond with those stated on the serial number plate located on the machine. Do not use adaptors or extension cords since they could result in overheating and burn out.

## POWER SUPPLY

This Super Washer must be connected to an individual circuit identical to the one specified on the rating plate of the loading port protected by fuses or circuit breaker conforming to local codes.

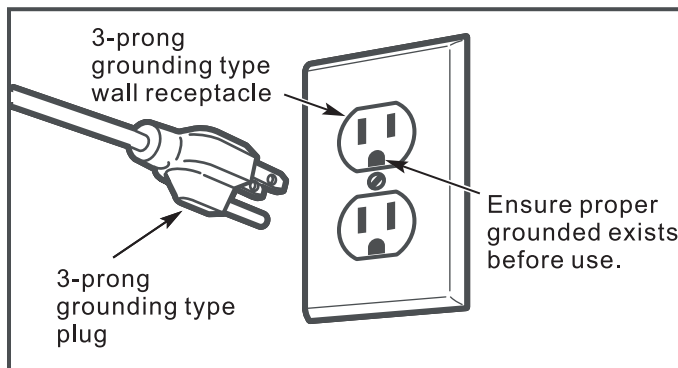

## GROUNDING

This appliance must be grounded. In the event of malfunction or breakdown, grounding will reduce the risk of electric shock by providing a path of least resistance for electric current. This appliance is equipped with a power cord having an equipment-grounding conductor and a grounding plug. The plug must be plugged into an appropriate outlet that is properly installed and grounded in accordance with all local codes and ordinances.

## WARNINGS

- Improper connection of the equipment-grounding conductor can result in a risk of electric shock. Check with a qualified or service representative or personnel if you are in doubt as to whether the appliance is properly grounded.
- Do not modify the plug provided with the appliance: if it will not fit the outlet, have a proper outlet installed by a qualified electrician.

**Note: If the electrical power supply does not meet the specifications listed above, please call a licensed electrician.**

## CONNECTING TO THE WATER FAUCET

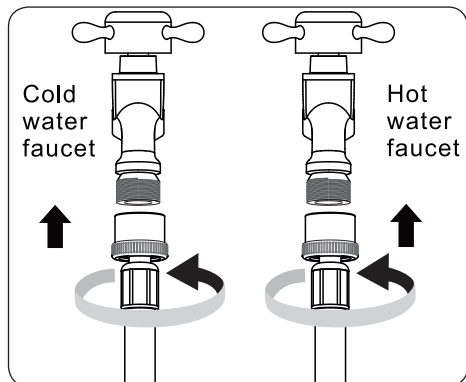

Fig.6

- To connect the hoses to the water faucets:
- Connect the straight end of each hose to the cold or hot faucet.
  - Turn the fittings by hand until they are tight, and then tighten them by just an additional two-thirds of a turn with a plier. Do not overtighten the fittings. They can be damaged.
  - When done, pull the water hoses up and down to check if they are properly connected.

## CONNECTING TO THE MACHINE

- To connect the hoses to the machine:
- Connect the L-shaped end of each hose to the cold or hot water valve on the rear of machine.
  - Open both the faucets, and check if there is a leak.

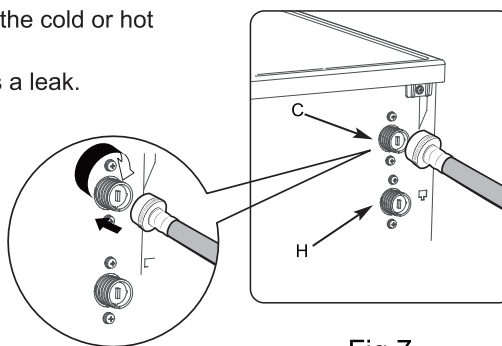

Fig.7

## CONNECTING THE DRAIN HOSE

Connect the drain hose to a drain duct (with internal diameter of at least 1.6 inches) or place it for drainage in to a sink or a tub, ensuring that there are no kinks or bends. The free end must be at a height of 24"- 40" from the floor. The hose can be held in place using the white plastic clamp on the upper part of the back panel.

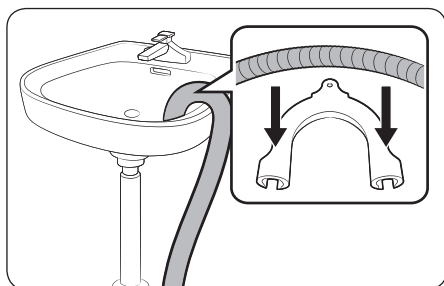

Fig.8

Height difference between the installation location of the washing machine and the drainage point:  
Minimum 24", and Maximum 40".

- Attach water drain hose to hose guide.
- Hook the hose guide over the side or standpipe (Fig.8).
- When the water is being drained, check that the water flow out of the hose is adequate.

## SPECIAL INSTALLATION REQUIREMENTS

### MINIMUM CLEARANCE OTHER THAN ALCOVE OR CLOSET INSTALLATION

Minimum clearances to combustible surfaces: 2" (5 cm) clearance both sides and 3" (7.5 cm) rear.

### BUILT-IN, RECESSED, CLOSET AND ALCOVE INSTALLATION

The Super Washer may be installed in a built-in, recessed area, closet or alcove.

The installation spacing is in inches and is the minimum acceptable.

Other installations must use the minimum dimensions indicated.

Minimum clearance between dryer cabinet and adjacent walls are: 2" either side and 3" front and rear.

Minimum vertical space from floor to overhead cabinets, etc. is 52" (132 cm).

Closet door must be louvered or otherwise ventilated and must contain a minimum of 60 sq. in. of open area equally distributed. If this closet contains both washer and a dryer, doors must contain a minimum 120 sq. in. of open area equally distributed.

No other fuel-burning appliance shall be installed in the same closet with dryer.

★ Additional clearances for wall, door and floor molding may be required.

**NOTE:** If a door is installed that potentially encloses the unit while running, the door must allow for a minimum of 20 sq. in. of air free movement. There must also be a 1" additional space in front of the unit to the closed door and 1" from the back of the unit to the wall. Additional spacing should be considered for easy installation, servicing and compliance with all applicable local, state and federal codes.

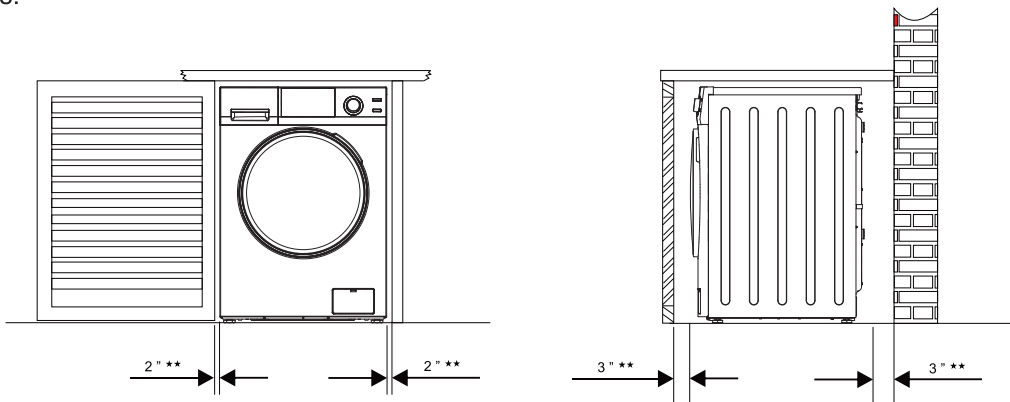

Fig.10

### ADA COMPLIANCE

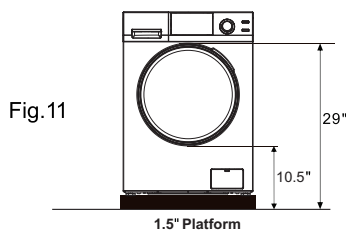

Fig.11

Use 1.5" height platform to make the machine ADA compliant.

## PROGRAM SELECTION CHART

### WASH CYCLES

Wash Programs	Description of Load	Wash Features Water Temp/Spin rpm	Approx Time
<b>1. NORMAL</b>	Mixed clothes (shirts, pants, etc.)	Warm / 1200	51 mins
<b>2. Prewash+Heavy</b>	Thick cottons (towels, jeans)	Cold +Hot / 1400	75 mins
<b>3. Heavy</b>	Mixed cottons (t-shirts, jeans)	Hot / 1400	51 mins
<b>4. ECO</b>	Cotton blends, light fabrics	Cold / 800	31 mins
<b>5. Quick 20</b>	Cotton blends, light fabrics	Cold / 1200	20 mins
<b>6. Baby</b>	Light fabrics	Warm / 800	41 mins
<b>7. Delicate</b>	Silk, Polyester, etc.	Cold / 800	36 mins
<b>8. Salt wash</b>	Mixed cottons	Cold / 800	36 mins
<b>9. Quiet 60</b>	Mixed cottons	Cold / 800	31 mins
<b>10. Sanitize 165</b>	Bedsheets, etc.	Hot / 1200	69 mins
<b>11. Allergen 131</b>	Mixed Cottons	Hot / 1200	59 mins
<b>12. PET Cycle</b>	Mixed Cottons	Cold / 1200	46 mins

### OTHER CYCLES:

**Spin only** - 12 minutes Spin cycle at Max. 1,000 RPM.

**Self clean** - 40 minutes cycle at 90° to clean the inner drum and tub of the machine.

**Winterize** - 2 minutes cycle to winterize your appliance.

**PET Cycle** - For cleaning pet hair - Please see important instructions on page 17.

**Salt Wash** - 5 minute initial rinse before wash cycle begins to remove salt from clothing.

**!** The total working time will vary with the laundry size, water pressure, water temperature and ambient temperature etc.

## PET Cycle

Before loading clothes and sheets into the appliance, remove as much pet hair as possible in order to prevent buildup and clogging of the drain pump. Wipe the surface of clothes and sheets with a lint roller or a damp rubber glove to easily remove pet hair.

After the end of the wash cycle, run a quick wash cycle without clothes. After the cycle ends, wipe down the drum with a damp cloth to collect any pet hair on the drum surface.

## OPERATING INSTRUCTIONS

1. Ensure the Washer is turned off. (Power Indicator light should be off).
2. Separate clothes by type, color and degree of soiling.
3. For small items use a mesh bag.
4. Load clothes of the selected type loosely into the drum.
5. Close the Washer ⊕ Dryer door. You will hear a click when it is correctly closed.  
Use Front Load detergent, as per direction.  
Add detergent to Dispenser A.  
You can add fabric softener in Dispenser B & pre-wash detergent and bleach in Dispenser C (Fig. 12).

### Detergent Dispenser

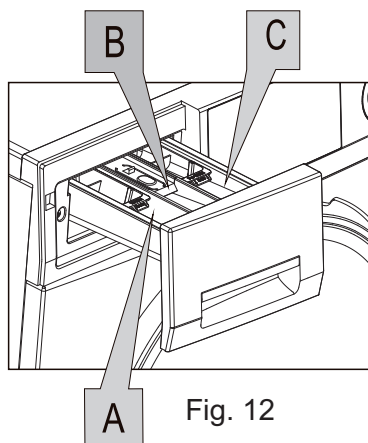

Dispenser A:  
**Detergent for main wash**

Dispenser B:  
**Fabric softener**

Dispenser C:  
**Detergent for pre-wash and bleach**

**The blue cups are only for liquid detergent.  
Please do not add powder in these cups.**

Note: concentrated fabric softener must be diluted with a little water before being poured into the dispenser  
(This prevents the overflow siphon from getting blocked)

Your washer is designed to use a high efficiency (HE) detergent, which reduces or eliminates suds and results in more efficient washing.



## WINTERIZING

### How to winterize for cold weather

1. Pour 2 cups of RV type Antifreeze in soap dispenser.
2. Select WINTERIZE cycle on knob and press START. Machine will Rinse & Spin.
3. Open Coin trap once cycle is finished and drain out reaming water.
4. Shut off water at both faucets and disconnect water inlet hoses from faucets and drain.



## Control Panel

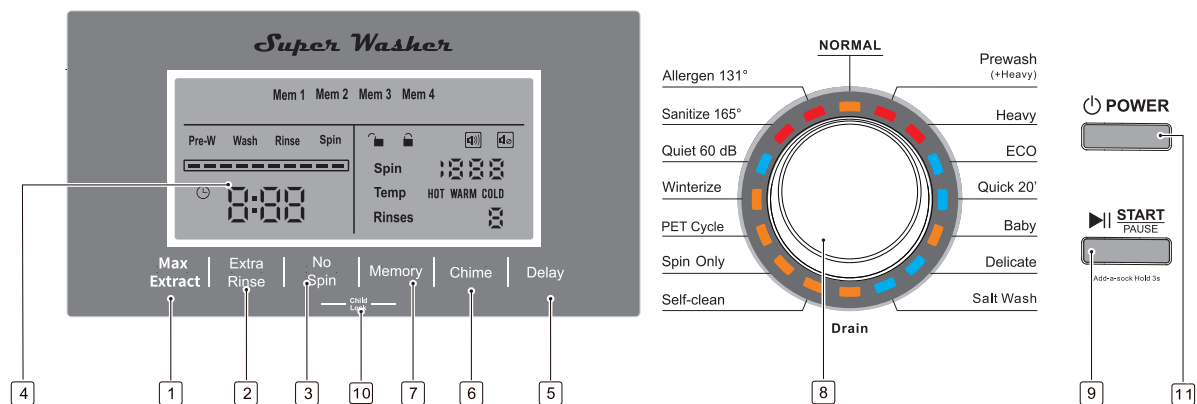

## Buttons Introduction

- 1** Max Extract      To extend the duration of final spin cycle by 30%.
- 2** Extra Rinse      Press this selection button to add once more rinse cycle to the selected wash program.
- 3** No Spin          If you want to soak your clothes before the spin cycle, press this button to eliminate the spin function. This will keep the clothes in the rinse water after the last rinse cycle is finished. After the desired soak time, press this button again and the water will drain out and proceed to the last spin cycle.
- 4** Color LED Display      Displays the selected program, such as the water temperature, spin speed, remaining time, rinse times, water level and error messages.
- 5** Delay Start button      Press this button to select the delay time from 1 to 24 hours, in one hour increments, for the wash cycle to start.  
If a change is to be made after the delay start time is set, turn the dial to another point, then select your desired program again.
- 6** Chime button      Press this button to turn on, or turn off the chime before you start the washing cycle.
- 7** Memory button      Press this button to select one of the four memory settings. Then select the your favorite wash cycles. Then press START/PAUSE button to run this program, and this program will be memorized. If you want to run the memorized program later, press this button to select desired program and then press START/PAUSE button.
- 8** Program Dial      Turn dial to point to one of the 16 programs depending on the load to select wash program.
- 9** Start/Pause button      Press this button to start or interrupt the selected wash program, or to view the program during a cycle.
- 10** Child Lock      In order to deactivate function to the controls, to prevent altering the wash cycle, press and hold No spin and Memory buttons for 5 seconds.
- 11** Power          Press this button to turn the machine on. Or hold down this button to turn it off.

## Display Panel Symbols

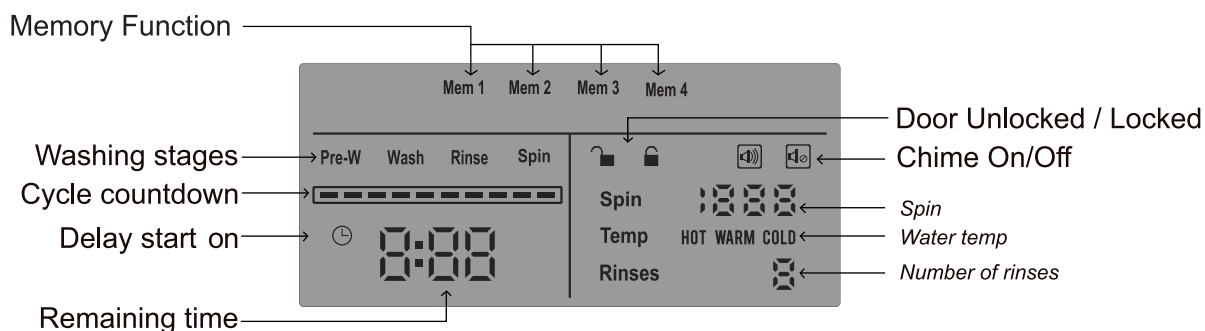

## How to Run Wash cycle

1. Press POWER button
2. Press START

Default cycle is NORMAL - If required, you can change to desired washing cycle based on type of clothes by rotating the Program Dial knob.

## How to stop the wash cycle

- The wash program can be stopped at any time.
- PRESS START/PAUSE, rotate the knob to another program to cancel the current selected program.
- PRESS POWER button for 3 seconds to turn off the machine

## How to turn on the display in energy saving mode



- Machine display gets turned off automatically during operations to save energy.
- Press any button to turn on display during this energy saving mode

## Add-a-sock Feature

The wash program can be stopped at any time to add forgotten items to the laundry.

- PRESS START/PAUSE for 5 seconds.
- Door will open after draining water so that it does not overflow.
- Load clothes. Close door.
- Press START. The cycle will continue from the point it stopped

## Door lock function

Pressing the START button  will lock the door  → . The wash cycle will start and will continue until the whole program is completed. The door will be locked and cannot be opened until the wash cycle ends. In a few minutes after the cycle ends, the door lock icon will change from locked to unlocked and then you can open the door easily.

Please do not try to force the door open. **Breakage of the door handle is not covered by warranty.**

## MAINTENANCE

Your Washer has been designed to operate with easy maintenance.

Follow these simple maintenance procedures to obtain optimum performance:

1. Ensure that your machine was installed according to the correct installation procedures detailed in this Manual.
2. Do not use solvents either to clean the machine or to wash clothes.
3. Keep the inside of the detergent dispenser clean.

### Cleaning the coin trap

- Switch off the Washer, allow the water to cool down.
- Open the service flap by using a finger. (bottom right corner) (Fig.13)
- Turn the pump filter open to the left. (Fig.14)
- Remove foreign objects/fluff from inside and clean the interior. (Fig.15)
- The pump impeller wheel located behind the water filter, must be able to rotate. Remove detergent residue and fluff from the pump cover thread and pump housing.
- Insert the coin-trap cover and screw tight, close the service flap. (Fig.16)

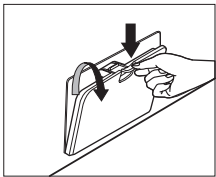

Fig.13

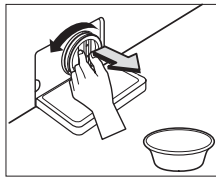

Fig.14

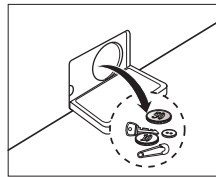

Fig.15

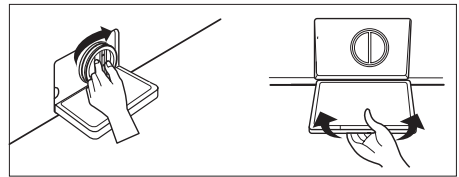

Fig.16

### Cleaning the Detergent drawers and Recess

- Press release lever on the inside of the drawer and pull it out. (Fig.16)
- Remove the cap from the Fabric Softener compartment.
- Clean the drawer recess with a bristle brush. (Fig.17, Fig.18)
- Reinsert the cap (Pushing it firmly into place).
- Push the drawer back into place.
- Run a rinse program without any laundry in the drum.

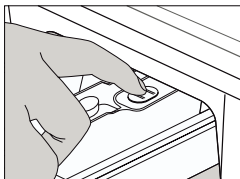

Fig.16

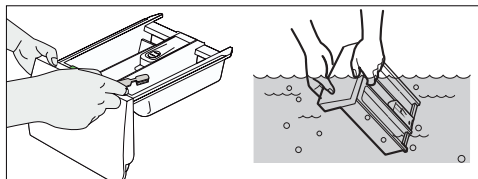

Fig.17

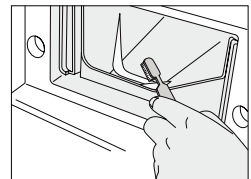

Fig.18

# Cleaning the water inlet filter

- If water is very hard or contains traces of lime deposit, the water inlet filter may become clogged. It is therefore a good idea to clean it from time to time.

- Turn off the water tap. ( Fig.19)
- Unscrew the water inlet hose. ( Fig. 20)
- Clean the filter using a hard bristle brush under the running water. ( Fig. 21)
- **Insert the filter into the valve** and tighten up the inlet hose. ( Fig. 22)

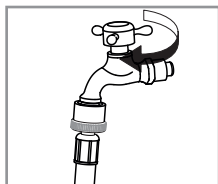

Fig.19

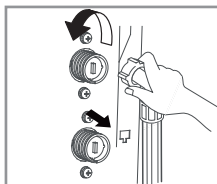

Fig. 20

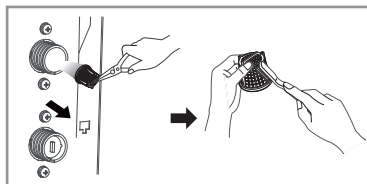

Fig. 21

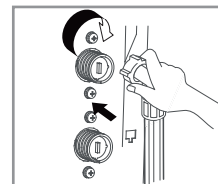

Fig. 22

# Cleaning the drum

If you live in a hard water area, limescale may build up continuously in places where it cannot be seen and thus not easily. Over time the build up of scale clogs appliances, and if it is not kept in check these may have to be replaced. Although the washing drum is made of stainless steel, specks of rust can be caused by small metal articles (paper clips, safety pins) which have been left in the drum.

- The washing drum should be cleaned from time to time.
- If you use descaling agents, dyes or bleaches, make sure they are suitable for washing machine use.
- Descaler may contain chemicals that may damage part of your washing machine.
- Remove any spots with a stainless steel cleaning agent.
- Never use steel wool.

# Cleaning the machine

## 1.Exterior

Proper care of your washer can extend its life.

- The outside of the machine can be cleaned with warm water and a neutral non abrasive household detergent.
- Immediately wipe off any spills. Wipe with damp cloth.
- Try not to hit surface with sharp objects.
- Do not use methylated spirits, diluents or similar products.

## 2.Interior

- Dry around the washer door opening, flexible gasket and door glass.
- Run washer through a complete cycle using hot water.
- Repeat process if necessary.



To remove hard water deposits, use only cleaners labelled washer safe.

# Clean Door gasket

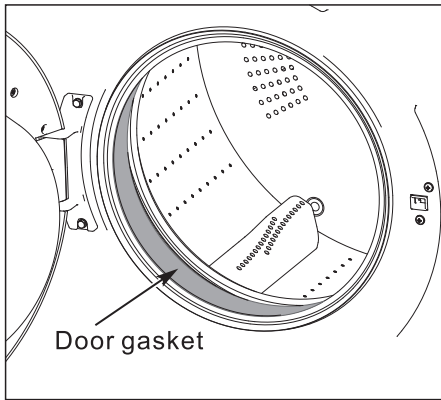

Clean the door gasket once a month to prevent buildup of dirt in the door gasket.

- Open the door, and then empty the drum.
- Combine 3/4 cups of liquid chlorine bleach and approx 6 pints of warm tap water.
- Turn over the rubber door gasket.
- Wearing rubber gloves, use a soft, clean cloth dipped in the water and bleach solution to clean the gasket.
- Let stand 5 minutes, and then wipe up and dry well.
- Put the rubber gasket back into position.

## ⚠ CAUTION

1. Clean the door gasket with undiluted liquid chlorine bleach may cause the door gasket and machine to malfunction. Dilute the bleach by adding it to water before using it.
2. Use bleach carefully and be sure to follow the bleach manufacturer's use and care instructions.

# PET Cycle - Maintenance

If the PET Cycle is used, it is important to run a quick wash cycle without clothes following every load. After the cycle ends, wipe down the drum with a damp cloth to collect any pet hair on the drum surface. The lint filter should also be cleaned more frequently.

# Emergency Release, e.g. the power failure occurs

The program continues running if the power is restored. If the laundry is still to be unload, the door can be opened as described below:

- Open the service flap.
- Drain the remaining water.
- Pull down the emergency release lever with a tool and release.
- Door can then be opened.
- Close the service flap.

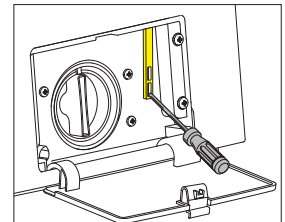

# The dangers of freezing

If the machine is exposed to temperatures below 0°C, certain precautions should be taken.

- Turn off the water tap.
- Unscrew the inlet hose.
- Unhook the drain hose from the sink.
- Pull forward the drain hose and the inlet hose in a bowl placed on the floor, and let the water drain out.
- Screw the water inlet hose back on and reposition the drain hose.

When you intend to start the machine up again, make sure that the room temperature is above 0°C.

## TROUBLESHOOTING

In most cases, when your Super Washer fails to work, the problems arising can be easily solved without having to call for a technician. Before calling for assistance, always check these points.

Problem	Solution
Will not start	<ul style="list-style-type: none"> <li>• Make sure the door is firmly closed. <a href="#">E -1</a></li> <li>• Make sure your Washer is plugged in.</li> <li>• Make sure the water source faucets are open.</li> <li>• Make sure to press the Start/Pause Button to start your Washer.</li> <li>• Make sure the Child Lock is not activated.</li> <li>• Before your machine starts to fill, it will make a series of clicking noises to check the door lock and do a quick drain.</li> <li>• Check the fuse or reset the circuit breaker</li> </ul>
Has no water or not enough water	<ul style="list-style-type: none"> <li>• Turn both faucets on fully. <a href="#">E -3</a></li> <li>• Make sure the door is tightly closed.</li> <li>• Straighten the water inlet hoses.</li> <li>• Disconnect hoses and clean filters. Hose filter screens may be clogged.</li> <li>• Open and close the door, then press the Start/Pause Button.</li> </ul>
Vibrates or is too noisy	<ul style="list-style-type: none"> <li>• Make sure your machine is set on a level surface. If the surface is not level, adjust your machine feet to level the appliance.</li> <li>• Make sure that the shipping bolts are removed.</li> <li>• Make sure your machine is not touching any other object.</li> <li>• Make sure the laundry load is balanced.</li> </ul>
Load is too wet at the end of the wash cycle	<ul style="list-style-type: none"> <li>• Use the High or Extra High spin speed.</li> <li>• Use high efficiency detergent to reduce over-sudsing. <a href="#">E -4</a></li> <li>• Load is too small. Very small loads (one or two items) may become unbalanced and not spin out completely.</li> </ul>
Leaks water	<ul style="list-style-type: none"> <li>• Make sure the door is firmly closed.</li> <li>• Make sure all hose connections are tight.</li> <li>• Make sure the end of the drain hose is correctly inserted and secured to the drainage system.</li> <li>• Avoid overloading.</li> <li>• Use Front loading detergent to prevent over - sudsing. <a href="#">E -4</a></li> </ul>
Door locked or will not open	<ul style="list-style-type: none"> <li>• Press the Start/Pause Button to stop your machine.</li> <li>• Your machine door will remain locked during the heating portion of the Sanitize Cycle</li> <li>• It may take a few moments for the door lock mechanism to disengage.</li> </ul>
Does not drain and/or spin	<ul style="list-style-type: none"> <li>• Check the fuse or reset the circuit breaker.</li> <li>• Straighten the drain hoses. Eliminate kinked hoses. If there is a drain restriction, call for service. <a href="#">E -2</a></li> <li>• Close the door and press the Start/Pause Button. For your safety, your Washer will not tumble or spin unless the door is closed.</li> </ul>
Has excessive suds	<ul style="list-style-type: none"> <li>• Use Front loading detergent to prevent over-sudsing. <a href="#">E -4</a></li> <li>• Reduce the detergent amount for soft water, small or lightly soiled loads.</li> <li>• Non Front loading detergent is NOT recommended.</li> </ul>
Continuously fills and drains water	<ul style="list-style-type: none"> <li>• Check if the drain hose is positioned too low.</li> <li>• Check that the inlet hose is not connected at a height more than 3 feet (100 cm) above the floor.</li> </ul>

## ERROR CODES

Code	Description	Component
E1	Door close	Door Switch
E2	Drain	Drain Pump
E3	Water inlet	Inlet Valves
E4	Water overflow	Pressure Switch
E5	Motor	Motor +Electronic Module
E7	Washing heater failure	Washing heater
E10	Water level failure	Water level sensor
E16	Communication between display & electronic module	Communication Cable

**To Order parts : [www.ApplianceDesk.com/Parts](http://www.ApplianceDesk.com/Parts)**





# *Marine Dryer*

**Model: 868**

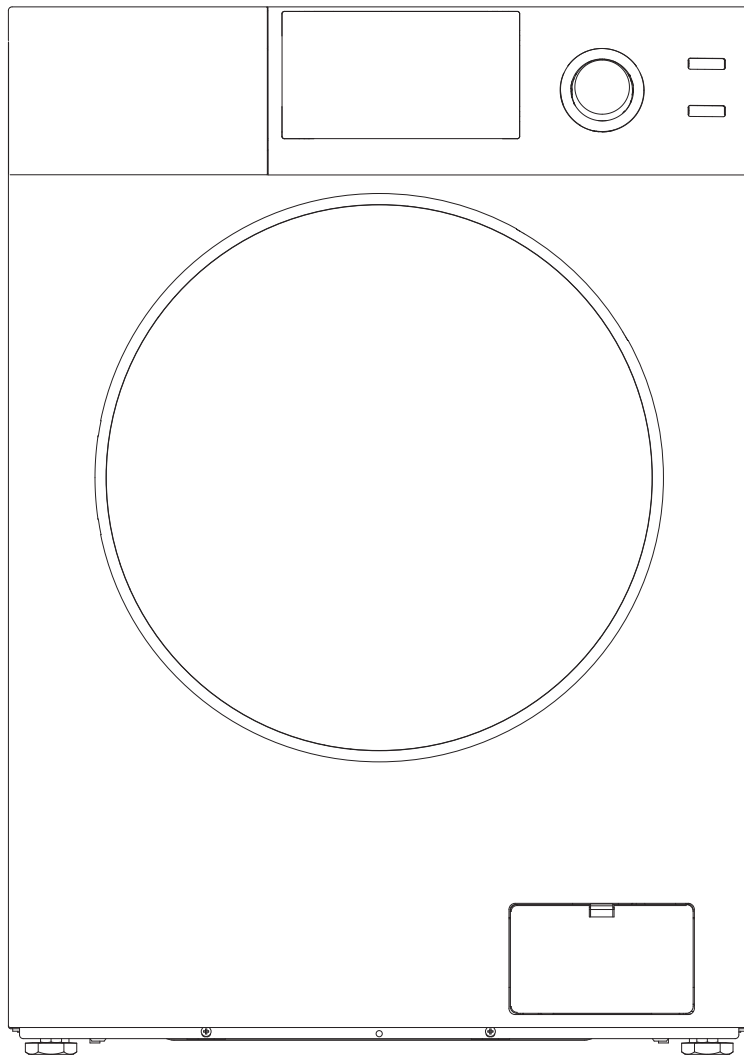

## **OWNER'S MANUAL**

Read the instructions carefully and keep for future reference. Information may be updated from time to time so please refer to the website for the latest version of the manual.



**DO NOT RETURN TO STORE!**

**HAVE QUESTIONS OR NEED SERVICE?**



1-800-776-3538



Service@ApplianceDesk.com

## WARRANTY INFORMATION

**Your appliance is protected by this warranty under normal, personal, family or household use for 1 Year (Parts and Labor), 2 Years (Motor) and 5 Years (Rust Only) and limited commercial use (90 days) in USA and Canada.**

### WARRANTY

---

Consolidated Brands undertakes to the consumer / owner to repair or, at our option, to replace any part of this product which proves to be defective in workmanship or material under normal personal, family or household use, in USA and Canada, for a period of one year parts and labor, two years motor and five years rust only from the date of original purchase. For commercial use, the product is warranted for a period of 90 days.

During this period, we will provide all labor and parts necessary to correct such defect, free of charge, if the appliance has been installed and operated in accordance with the written instructions provided with the appliance. Ready access to the appliance, for service, is the responsibility of the consumer / owner. If a unit is installed in a closet or cabinet, it should be removed by the consumer / owner, for access by service technicians. If this is not done, there will be an extra charge.

### EXCLUSIONS

---

In no event shall Consolidated Brands be liable for incidental or consequential damages or for damages resulting from external causes such as abuse, operation misuse, neglect, alterations, normal wear and tear, incorrect voltage or acts of God. This warranty does not cover service calls which do not involve defective workmanship, damage due to other products while combined use with this product or materials covered by this warranty. Accordingly, diagnosis and repair costs for a service call which does not involve defective workmanship or materials will be the responsibility of the consumer / owner.

Most work is covered. The defining factor is, has the machine malfunctioned (Consolidated Brands is responsible) or has the customer omitted or done something to cause malfunction (customer is responsible). Some states do not allow the exclusion or limitation of incidental or consequential damages, so the above limitation or exclusion may not apply to you.

You can register your Warranty by either of the following methods:

1. Scan QR Code

- Open Smart Phone
- Open Camera
- Click the Link



2. Register online at [ApplianceDesk.com/Warranty](https://ApplianceDesk.com/Warranty)

3. QR Code is also used to obtain Product Information, Manuals and Updates

### WARRANTY SERVICE

---

This warranty is given by:

**Consolidated Brands**

**10222 Georgibelle Drive, Suite 200,  
Houston, TX 77043-5249**

Customer Service: **Appliance Desk**

Phone / Text: 1-800-776-3538

Email: [Service@ApplianceDesk.com](mailto:Service@ApplianceDesk.com)

Web: [www.ApplianceDesk.com](http://www.ApplianceDesk.com)

Business hours: 9:00 am to 5:00 pm weekdays

## **THE FOLLOWING WORK ARE NOT COVERED UNDER WARRANTY:**

---

### **Installation**

1. Non-removal of shipping bolts, causing vibration / internal damage.
2. Non-adjustment of feet to level machine, causing vibration / internal damage.
3. Using incorrect length of venting i.e. more than 10 feet unless used with a booster fan.
4. Not conforming to minimum space requirements for built-in installation, causing excess heat and resulting in damage to internal components.
5. Installation in a corrosive environment.

### **Maintenance**

1. Non-cleaning of vent fan & exhaust hose for lint, causing the unit to not dry properly.
2. Improper maintenance (such as, but not limited to, scale build-up, freeze damage, or vent blockage).

### **Damage**

1. Breakage of cosmetic parts e.g., door handle, knob.

### **Other**

1. Accident, abuse or misuse.
2. Using solvents to clean the machine, causing damage.
3. Misapplication of this product e.g., use in a non household/commercial environment.
4. Any other cause not due to defects in materials or workmanship.
5. Problems or damage due to fires, flooding, electrical surges, freezing or any acts of God.
6. Force majeure.

## **Warranty Limitations**

1. If a unit is located more than 25 miles away, there will be a trip charge.
2. If a unit is in a remote area more than 75 miles away, the machine should be taken to the technician's workshop.
3. If the unit is installed in a 5th wheel RV, in a location behind the axle, it will not be covered under warranty.
4. All repairs or replacements are warranted only for the remainder of the original warranty period.
5. If a return or replacement is required, allow 3-4 weeks to process.
6. Replacement units will be delivered with curbside delivery only.
7. We may require the return of products or parts to our warranty department for which the shipping charges are to be pre-paid by the consumer / owner.
8. Charges may be incurred if warranty coverage is not applicable.
9. Service would be provided from Monday to Friday between normal business hours.

## **GENERAL**

---

Since it is the responsibility of the consumer / owner to establish the warranty period by verifying the original purchase date, Consolidated Brands recommends that a receipt, delivery slip or some other appropriate payment record be kept for that purpose. This warranty gives you specific legal rights, and you may also have other rights which vary from state to state.

All rights reserved. Manual subject to change without notice.

## ***Congratulations on your new Marine Dryer!***

In addition to its contemporary design, this is a highly sophisticated engineered product that will give you many years of satisfaction.

### **Here are some of the best reasons for buying your Marine Dryer**

1. Cabinet - Galvanized steel with phosphate treatment and painted, to prevent rust
2. Nuts, Bolts, Screws, Clamps - Stainless steel grade 316
3. Terminals and Connecters - Conformal coating to prevent moisture build-up
4. Spider wheel (Containing Bearings): Conformal coating to prevent rust
5. Tub Enamel: 2 coats of enamel on tub to prevent rust

### **Upgraded Accessories Included:**

1. Stacking Kit (1)
2. Floor Bracket (2)
3. Aluminum Flexible Duct (5 Feet Length + 2 Clamps)

## **FEATURES**

### **1. Reversible Door**

Achieve the optimum fit in any space configuration.

### **2. Lint Reminder**

Benefit from a Lint Reminder feature which reminds you to remove lint buildup and prevent maintenance issues with your machine.

### **3. Diagnostic Menu**

Take advantage of a diagnostic menu to help you troubleshoot any issues.

### **4. Multiple Dry Cycles**

Use normal, heavy, eco, delicate, shoes, allergen 131, sanitize 165, or refresh 12 dry cycles for your clothes.

### **5. Child Lock**

Protect young children with the Child Lock feature.

### **6. Powerful Machine**

This dryer is powered by 1200 Watts and 110V to make it a dynamic, energy-efficient machine.

### **7. Efficiently Built**

This machine has dimensions of 33.5 x 23.6 x 22.2 inches and a net weight of 79 lbs.

## Safety

In order to reduce the risk of fire, electric shock, and/or injury, please follow safety precautions. Read all instructions carefully and save for future reference.

- Use the appliance indoors. It is not intended to be used outdoors.
- Ensure that open flame sources, such as candles are not placed on top of the dryer.
- Do not place items in the dryer that are soiled with flammable liquids, oils and other chemicals. These items should be washed thoroughly before placing them in the dryer.
- Ensure fabric softeners or products to eliminate static are not used inside the dryer, unless recommended by manufacturers of these products.
- Do not dry items containing rubber, plastic or similar materials.
- Ensure the dryer and electrical cord are not placed near heat sources, such as radiators, heaters, air ducts or in direct sunlight.
- Ensure vents and ventilation openings are not blocked.
- Ensure the power cord is not bent or twisted, and not exposed in an area where it could be a tripping hazard.
- Do not use the dryer if the cord is damaged.
- To disconnect the dryer, press the power button to turn it off, then grasp the plug of the power cord firmly and pull straight out of the outlet.
- Do not open the dryer and reach into the drum while it is rotating.
- Ensure the dryer is not overloaded.
- Do not tamper with controls.
- Perform regular maintenance and cleaning of lint filter after each use. Ensure periodic cleaning of exhaust duct is done by a qualified technician.
- Check that foreign objects are not in the drum.
- This appliance is not intended for use by persons, including children, with reduced physical, sensory or mental capabilities, or lack of experience and knowledge, unless they have been given supervision or instruction concerning use of the appliance by a person responsible for their safety.
- Do not allow children to play on or in the appliance. Close supervision of children is necessary when the appliance is used near children.

## Safe Disposal

Before discarding the appliance, please remove the door to prevent risk of child entrapment.

Keep children away from the shipping carton and packing components.

Please dispose of this appliance and all packaging material in accordance with local regulations.

### California Proposition 65

WARNING: This product contains chemical known to the State of California to cause cancer and birth defects or other reproductive harm.

# Technical Data

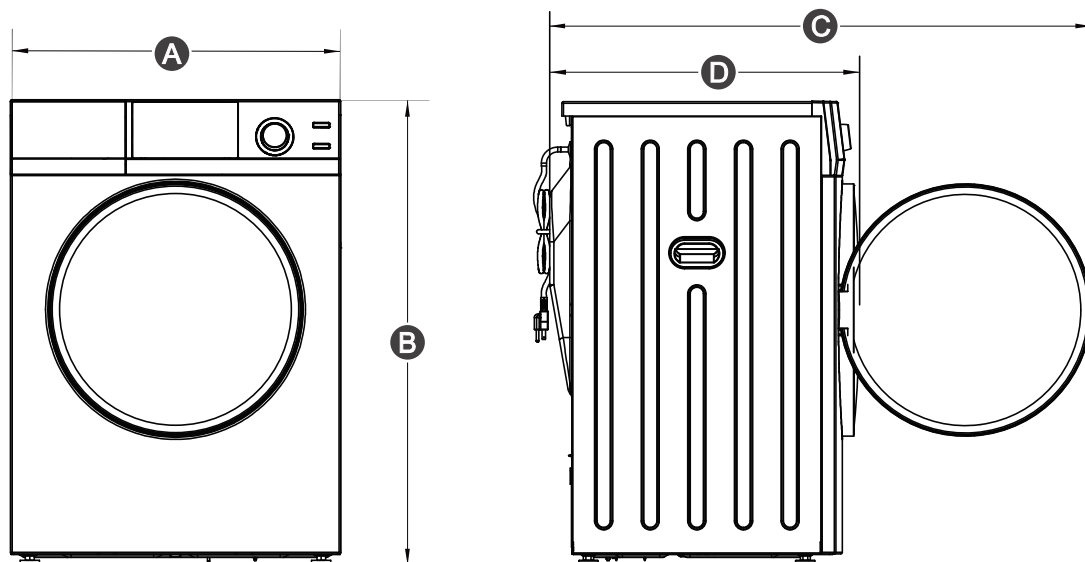

Type		Vented Electric Dryer
Model		<b>868</b>
Dimensions (inches / mm)	A. Width	23.6 / 600
	B. Height-overall	33.5 / 850
	C. Depth	22.2 / 565
	D. Depth with door open	38.9 / 988
Rated voltage		110-120V / 60Hz 12A
Dry capacity (cu. ft.)		3.1
Net weight (lb / kg)		79 / 36
Heater rating (Watts)		1,200
Power consumption	No heat (Watts)	240
	Heating (Watts)	1,440



Intertek

4007606

**US N° 4007606 CANADA**

*The ETL Listed Mark is the legal equivalent to the UL and CSA Listed Marks*

# Dryer - External Components

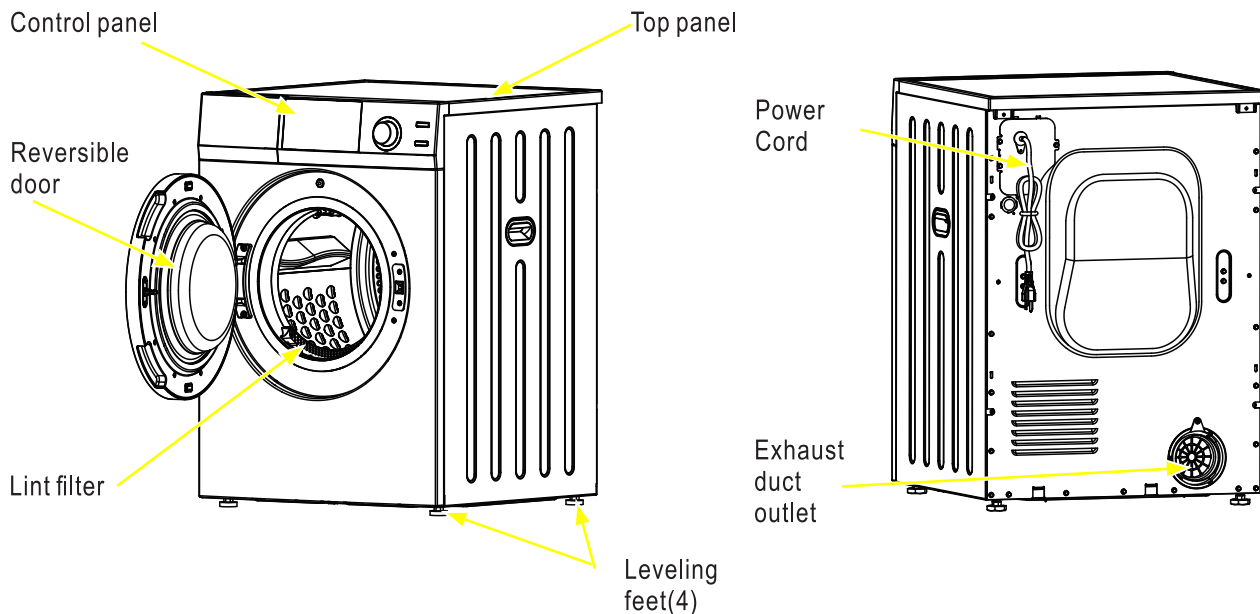

## Accessories

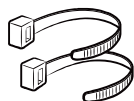

Hose ties (x2)

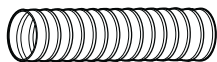

Exhaust hose



Exhaust elbow

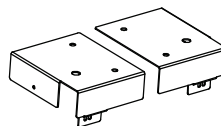

Stacking kit  
(2 brackets)

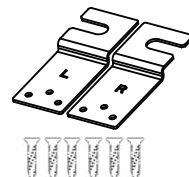

Floor Brackets  
with screws (6)

### NOTE:

1. For your safety and for extended product life, use only authorized components. The manufacture is not responsible for product malfunction or accidents caused by the use of separately purchased unauthorized components or parts.
2. The images in this manual may be different from the actual components and accessories, and are subject to change by the manufacture without prior notice for product improvement purpose.

## Handling and Placement

Remove the packing and check that the appliance is undamaged. If you have any doubt, do not use the appliance and call Customer Service. Keep all packing parts (plastic bag, foam rubber, screws, etc.) out of the reach of children since they could be dangerous.

**Important:** The inside of the appliance consists of a free floating drum that is affixed with shipping rods at the back of the cabinet during transport (Fig.1). The power cord can be accessed by removing the shipping rods (Fig. 2 & 3). Close the holes left open by the rods with the caps provided (Fig. 4). The screws also need to be reinstalled (Fig. 4).

It is important for the machine to be perfectly level. For this reason, the machine is fitted with adjustable feet used for leveling the machine before use (Fig. 5).

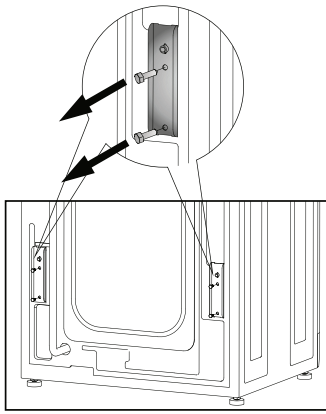

Fig.1

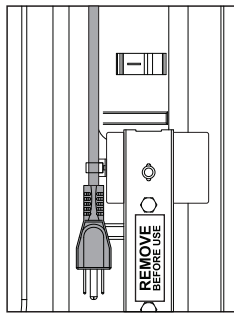

Fig.2

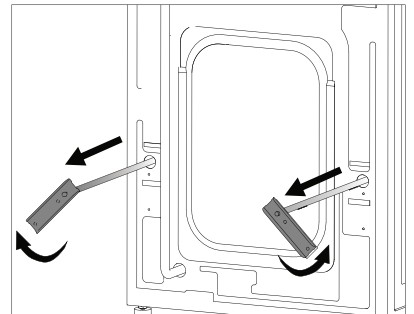

Fig.3

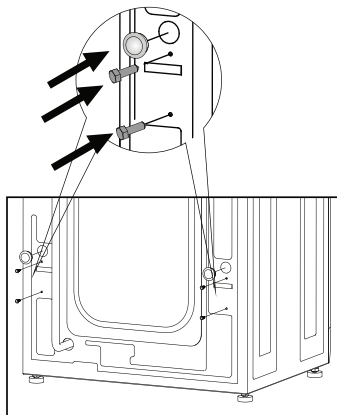

Fig.4

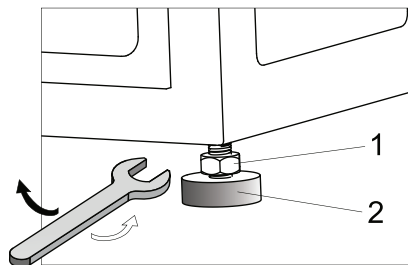

Fig.5

### NOTE

- Save the bolt assemblies for future use. To prevent damage to internal components, DO NOT transport the washer-dryer combo without reinstalling the shipping bolts.
- Failure to remove shipping bolts and retainers may cause severe vibration and noise, which can lead to permanent damage to the combo.
- The cord is secured to the back of the combo by a clamp with a shipping bolt to help prevent operation with shipping bolts in place.



## Installation

**The dryer must be installed and serviced by a qualified technician.**

Install the dryer according to manufacturer's instructions and local codes.

- The dryer must be properly grounded. Do not modify the plug.
- Do not install the dryer in a tight-fitting cabinet. Ensure there is adequate ventilation space all around the dryer (please see detailed installation instructions).
- Do not use flexible plastic venting materials which may collapse. Use only vent hoses that are approved by the manufacturer.
- In Canada and the United States, only those foil-type flexible ducts, if any, specifically identified for use with the appliance by the manufacturer shall be used and that comply with the outline for the Clothes Dryer Transition Duct, subject to 2158A, shall be used.
- In Canada, the exhaust duct shall be 4" (10.2 cm) in diameter.  
In the United States, the exhaust duct shall be 4" (10 cm) in diameter.
- The total length of flexible metal duct shall not exceed 8 feet (2.4 m).
- The duct shall not be assembled with screws or other fastening means that extend into the duct and catch lint.
- The appliance shall not be exhausted into a chimney, wall, ceiling, attic, crawl space, or a concealed space of a building.

### MOBILE HOME INSTALLATION

- The dryer must be exhausted to the outdoors with the termination securely fastened to the mobile home structure.
- The exhaust **must not** be terminated beneath the mobile home.
- Provisions must be made for the introduction of outside air into the dryer. The free air opening shall not be less than 12 sq. inches.
- The exhaust duct material **must be metal**.
- The dryer must be attached to the floor following instructions available from the dealer.
- Installation must comply with the current CAN / CSA Z240MH series Mobile Home Installation Codes.

## Installation Instructions

Do not drag the appliance

Do not hold protruding parts when lifting.

Install the appliance on a firm level surface.

Ensure the appliance is placed in a dry, well ventilated area.

Do not install the appliance outdoors where it can be exposed to freezing conditions.

### Secure the appliance to the floor using the floor brackets provided.

1. Level the appliance
  - Tighten the two back feet so they are all the way in.
  - Tilt the appliance back. Then adjust the two front feet up or down so the appliance does not rock side to side, or front to back when upright.
2. Place the brackets around the front feet (Fig.6).
3. Secure both brackets to the floor using a drill and 3 screws each (Fig.7).

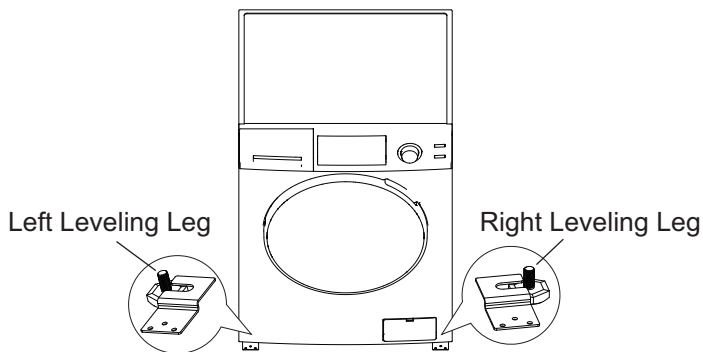

Fig. 6

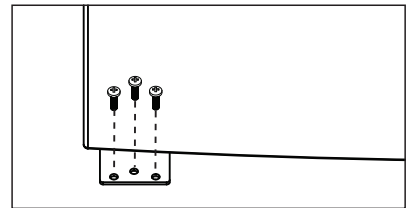

Fig. 7

**Note: Any residual moisture inside the drum is due to the final testing which every appliance undergoes before leaving the factory.**

## Built-In, Recessed, Closet and Alcove Installation

- The dryer MUST be vented to the outdoors.
- The dryer may be installed in a built-in, recessed area, closet or alcove.
- The installation spacing is in inches and is the minimum acceptable.
- Other installations must use the minimum dimensions indicated.
  - a) Minimum clearances between the dryer cabinet and adjacent wall are: 2" either side and 3" front and rear.
  - b) Minimum vertical space from floor to overhead cabinets, etc. is 52" (132cm).
- The rear of the dryer should face a wall.
- Consideration must be given to provide adequate clearance for installation and service.
- Closet doors must be louvered or otherwise ventilated and have at least 60 square inches of open area. If the closet contains both a washer and a dryer, door must contain a minimum of 120 square inches of open area.
- No other fuel-burning appliance shall be installed in the same closet with the dryer.

**NOTE:** If a door is installed that potentially encloses the unit while running, the door must allow for a minimum of 20 square inches of free air movement. There must also be a 1" additional spacing should be considered for easy installation, servicing and compliance with space in front of the unit to the closed door and 1" from the back of the unit to the wall.

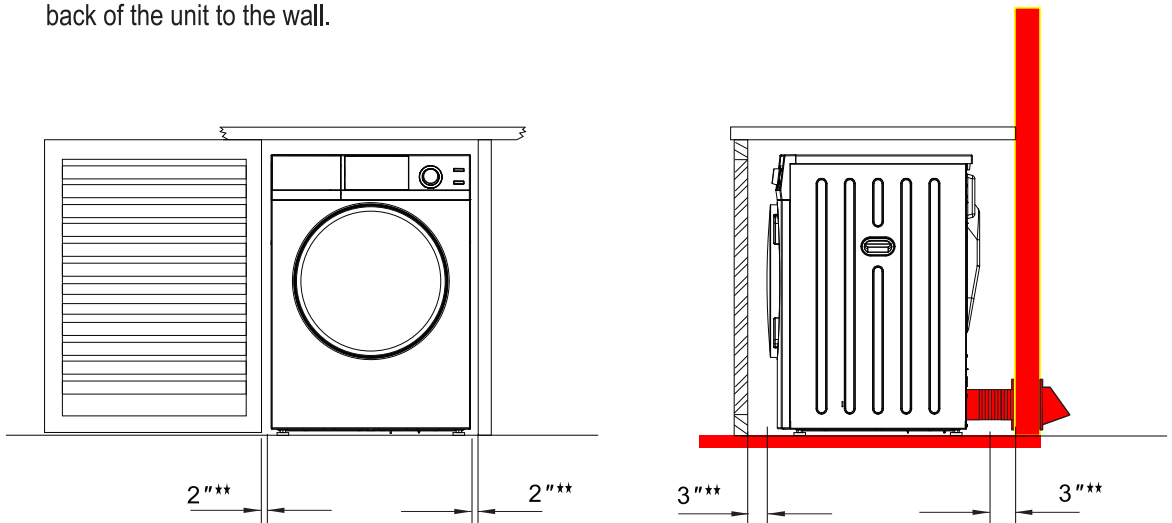

### Minimum clearance other than alcove or closet installation

- Minimum clearance between the dryer cabinet and adjacent walls or other surfaces is: 2" clearance both sides and 3" rear.
- The rear of the dryer should face a wall.
- Consideration must be given to provide adequate clearance for installation and service.

### ADA Compliance

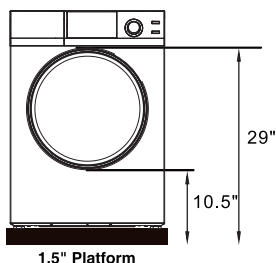

Use 1.5" height platform to make the machine ADA compliant.

## Venting Connections

- This dryer **MUST** be vented to the outdoors.
- Use only 4" (10.2 cm) rigid metal duct for the home exhaust duct.
- Use only 4" (10.2 cm) rigid metal, UL-listed flexible metal, or UL-listed metal foil dryer transition duct to connect the dryer to the home exhaust.
- **Do not** use flexible duct inside the dryer.
- **Do not** exhaust into a chimney, kitchen exhaust, gas vent, wall, ceiling, attic, crawl space, or concealed space of a building. The combination of lint and grease could create a fire hazard or damages.
- **Do not** install a screen in or over the exhaust duct.
- **Do not** install a booster fan in the exhaust duct.
- **Do not** use duct longer than specified in the exhaust length table.
- Provide an access for inspection and cleaning the exhaust system at least once year.
- Failure to follow these instructions can result in death or fire.

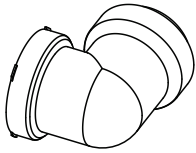

**This Dryer Vent Elbow attachment is included with your Dryer.  
Attach it to the Exhaust Duct outlet at the back of your Dryer.**

## Exhaust system check list hood or wall cap

- Terminate in a manner to prevent back drain or entry of birds or other wildlife.
- Termination should present minimum resistance to the exhaust air flow and should require little or not maintenance to prevent clogging.
- Wall caps must be installed at least 12" (30 cm) above ground level or any other obstruction with the opening pointed down.
- If roof vents or louvered plenums are used, they must be equivalent to a 4" (10.2 cm) dampened wall cap in regard to resistance to air flow. Prevention of back drafts and regular maintenance are required to prevent clogging.

## Separation of turns

Separate all turns by at least 3 ft. (1 m) of straight duct, including distance between last turn and dampened wall cap. If two turns must be closer than 3 ft. (1 m) deduct 10 ft. (3 m) from the maximum length.

## Turn other than 90°

- One turn of 45° or less is acceptable.
- Two 45° turns should be treated as one 90°.
- Each turn over 45° should be treated as one 90°.
- Deduct 10 ft. (3 m) for each additional elbow. It is not recommended to use more than three 90° elbows.

## Sealing of joints

- All joints should be tight to avoid leaks. The male end of each section of duct must point away from the dryer.
- Do not assemble the duct work with fasteners that extend into the duct, as they may collect lint.
- Duct joints can be made air and moisture-tight by wrapping the overlapped joints with duct tape.

**Routing and connecting ductwork.**

- Ductwork and fittings are NOT included and must be purchased separately.
- The exhaust duct run should be as short as possible.
- Use as few elbow joints as possible.
- The male end of each section of exhaust duct must point away from the dryer.
- Insulate ductwork that runs through unheated areas to reduce condensation and lint buildup on duct surfaces.
- Incorrect or inadequate exhaust systems are not covered by the dryer warranty.

**Insulation**

Ductwork which runs through an unheated area or is near an air conditioning duct, should be insulated to reduce condensation and lint build up and be sloped down toward outdoors.

**Note:** Never install screen inside exhaust duct.

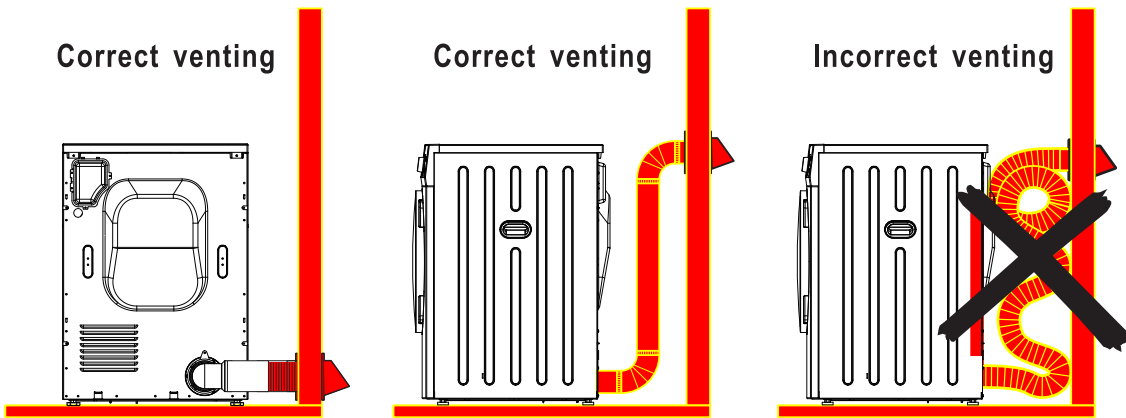

EXHAUST LENGTH	Wall Cap Type			
	Recommended		Use only for short-run installation	
	<p>4" (10.2cm)</p>		<p>2.5" (6.4cm)</p>	
No. of 90° elbows	Rigid	Metallic Flexible	Rigid	Metallic Flexible
0	24.4 m (80 ft.)	12.5 m (41 ft.)	22.6m (74 ft.)	10.1 m (33 ft.)
1	20.7 m (68 ft.)	11.3 m (37 ft.)	18.9 m (62 ft.)	8.8 m (29 ft.)
2	17.4 m (57 ft.)	10.1 m (33 ft.)	15.5 m (51 ft.)	7.6 m (25 ft.)
3	14.3 m (47 ft.)	8.8 m (29 ft.)	12.5 m (41 ft.)	6.4 m (21 ft.)

**Do not use non-metallic flexible duct.**

## Electrical

### CONNECTION

Connect the plug to a power outlet - 110V / 60Hz with minimum 15 Amps. Make sure that the voltage and frequency available correspond with those stated on the serial number plate located on the machine. Do not use adaptors or extension cords since they could result in overheating and burn out.

### POWER SUPPLY

This Marine Dryer must be connected to an individual circuit identical to the one specified on the rating plate of the loading port protected by fuses or circuit breaker conforming to local codes.

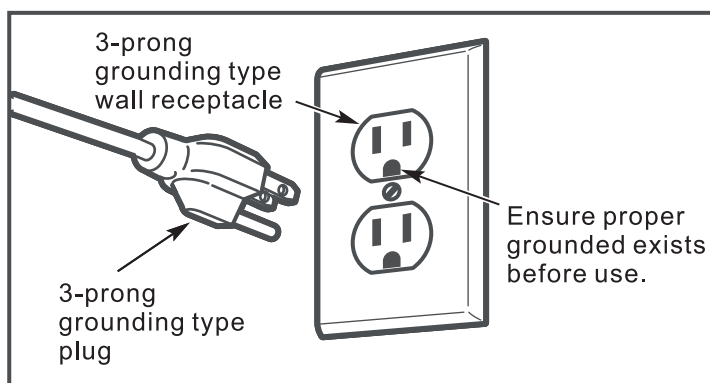

### GROUNDING

This appliance must be grounded. In the event of malfunction or breakdown, grounding will reduce the risk of electric shock by providing a path of least resistance for electric current. This appliance is equipped with a power cord having an equipment-grounding conductor and a grounding plug. The plug must be plugged into an appropriate outlet that is properly installed and grounded in accordance with all local codes and ordinances.

### WARNINGS

- Improper connection of the equipment-grounding conductor can result in a risk of electric shock. Check with a qualified or service representative or personnel if you are in doubt as to whether the appliance is properly grounded.
- Do not modify the plug provided with the appliance: if it will not fit the outlet, have a proper outlet installed by a qualified electrician.

**Note: If the electrical power supply does not meet the specifications listed above, please call a licensed electrician.**

## Program Selection Chart

Cycle	Fabric type	Dry level (Default)	Temperature (Default Heat)	Sensor Dry Pre-set Time
NORMAL	Mixed cottons	More	Medium	2 hrs
Heavy	Towels, jeans	Extra	High	2 hrs 30 mins
ECO	Mixed cottons	More	Medium	1 hr 40 mins
Delicate	Silk, Wool	Damp	Air	2 hrs
Shoes	Shoes	More	Medium	2 hrs
Allergen 131°	Sheets	Extra	High	2 hrs 15 mins
Sanitize 165°	Mixed Cottons	Extra	High	2 hrs 30 mins
Refresh 12'	Mixed and Heavy	—	Medium	12 mins

**NOTE:** For **Allergen 131°**, **Sanitize 165°** and **Delicate** cycles, the **Dry Level** and **Temperature** cannot be changed from the default settings.

### Allergen Function

The Allergen 131° cycle heats the air to 131°F to remove allergens from clothes. This Sensor Dry cycle is pre-set to High heat temperature and Extra Dry Level and runs for 2 hours and 15 minutes. Turn the Dry Cycle Dial to Allergen 131° and press the Start/Pause button.

Clothes that have already been dried in another dry cycle, can be additionally run in the Allergen 131° cycle. Turn the Dry Cycle Dial to Allergen 131°, and press Time Dry and select the minutes to dry, then press the Start/Pause button.

### Sanitize Function

The Sanitize 165° cycle heats the air to 165°F to remove germs from clothes. This Sensor Dry cycle is pre-set High heat temperature and Extra Dry Level and runs for 2 hours and 30 minutes. Turn the Dry Cycle Dial to Sanitize 165°, and press the Start/Pause button.

Clothes that have already been dried in another dry cycle, can be additionally run in the Sanitize 165° cycle. Turn the Dry Cycle dial to Sanitize 165°, and press Time Dry and select the minutes to dry, then press the Start/Pause button.

### Drying Rack (Optional)

The drying rack can be used to dry items such as delicates and shoes.

- Install the drying rack by placing the front lip on top of the lint filter.
- Place items to be dried flat on the rack, leaving enough space for air circulation.
- Lower the top bar onto the rack to hold the items in place.

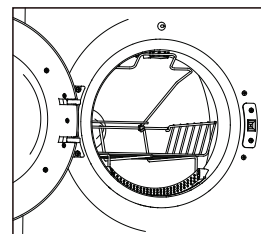

# Control Panel

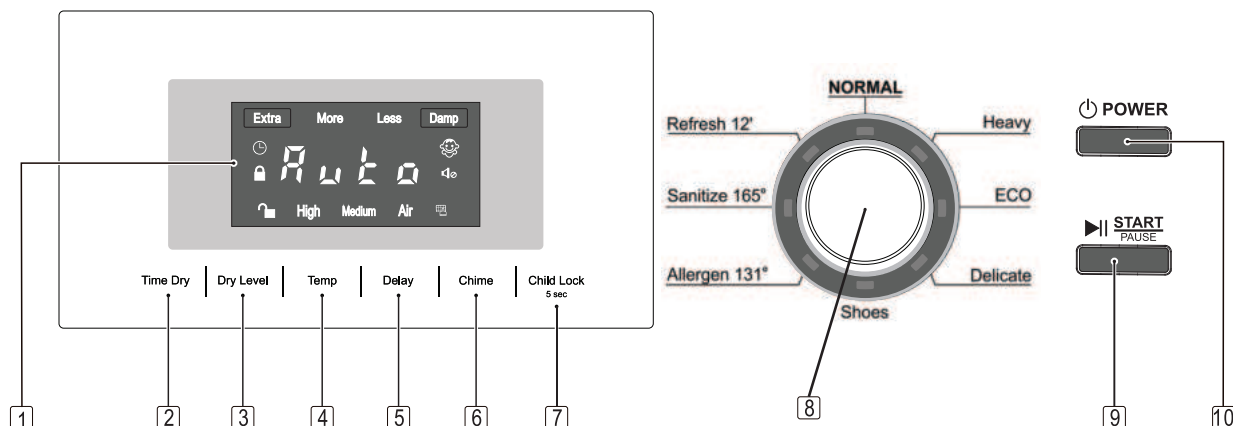

1 Display Screen	The <b>Display screen</b> shows the estimated time remaining in the dry cycle. It also illuminates options that are selected for Dry Level, Temperature (heat level), Delay start, Chime, Child lock, and Clean Filter Reminder.
2 Time Dry	Press <b>Time Dry</b> to select the minutes to run the dry cycle.
3 Dry Level	Press <b>Dry Level</b> to select how much you want the clothes to dry. Press repeatedly to select from Extra, More, Less or Damp.
4 Temp.	Press <b>Temp.</b> to select the heat level for drying clothes. Press repeatedly to select from: High, Medium or Air.
5 Delay	Press <b>Delay</b> to start the dry cycle at a later time. Select from 1 to 24 hours.
6 Chime	Press <b>Chime</b> to turn the end of cycle chime sound, or button chime sound on or off.
7 Child Lock	The Child Lock function prevents children from playing with the buttons on the control panel. Press and hold <b>Child Lock</b> for 5 seconds to set or release the Child Lock.
8 Dry Cycle Dial	To select a dry cycle, rotate the <b>Dry Cycle Dial</b> to the desired cycle: Normal, Heavy, ECO, Delicate, Shoes, Allergen 131°, Sanitize 165°, and Refresh 12'.
9 Start / Pause button	Press the <b>Start/ Pause</b> button to start, pause, or restart the dry cycle.
10 Power button	Press the <b>Power</b> button once to turn the dryer on. Press and hold it for 3 seconds to turn the dryer off.



## Display Panel

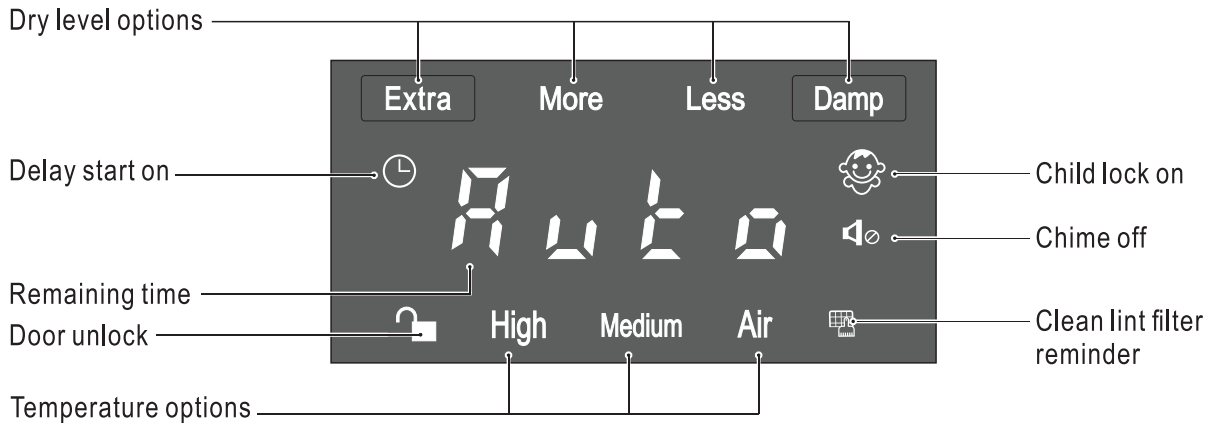

## Operating Instructions

Before using the Dryer, please check the inside of the drum to ensure that children or pets have not climbed into the appliance.

### Operating the Dryer

#### Before Starting the Dry Cycle

- Empty pockets of items
- Do not dry clothes with residues of oil or flammable substances
- Follow clothing manufacturer's care labels.

Load clothes loosely into the dryer, ensuring that the clothes have enough room to tumble and to let the air circulate through the clothes. Filling the dryer with too many clothes will require more time to dry and may cause wrinkle in the clothing.

**Ensure that lint has been removed from the filter for efficient drying.**

The Clean Lint Filter Reminder icon will flash on the display screen.

### Power On

Close the door firmly and press the **Power** button to turn on the dryer. If the door is not closed properly, the **door unlock** icon will appear on the **Display Screen**.

The LED will illuminate on the **Display Screen** and on the **Dry Cycle Dial**.

The default setting is for **NORMAL** dry cycle, "**More**" Dry Level, "**Medium**" Temp and **2** hours dry time.

### Select a Dry Cycle

If the default **NORMAL** dry cycle is desired, the cycle can be started. If an alternate cycle is desired, rotate the **Dry Cycle Dial** in either direction to any of the other cycles: **Heavy**, **ECO**, **Delicate**, **Shoes**, **Allergen131°**, **Sanitize165°**.

The indicator light by the cycle name will illuminate. Each of the cycles has pre-set dry times, dry levels and temperatures, based on sensor drying. Sensor dry cycles monitor the moisture in the clothes and shut the dryer off automatically when the selected dry level is reached.

Note: The time shown remaining on the display screen may increase or decrease during the dry cycle as the sensor dry function monitors for moisture in the clothes and adjusts the time.

## Refresh

Refresh 12' is a time dry cycle which tumbles the clothes for a short time while blowing hot air into the drum. This reduces wrinkles and refreshes the clothes. Use this cycle after the drying is completed and before taking clothes out of the dryer. This is optional.

## Select Dry Level and Temperature

After the dry cycle is selected, you have the option to change the Dry Level and the Temperature.

- Press Dry Level to select how much you want the clothes to dry. Press repeatedly to select from: Extra, More, Less or Damp. The selection will illuminate on the display screen.
- Press Temp to select the heat level for drying clothes. Press repeatedly to select from: High, Medium or Air. The selection will illuminate on the display screen.

Note: Some dry cycles do not allow these settings to be changed. For example, Allergen and Sanitize only use High heat.

## Options

In addition to selecting the dry level and temperature, you can also select options on the Control Panel for **Delay**, **Chime** and **Child Lock**.

- Press **Delay** to start the dry cycle at a later time. Select from 1 to 24 hours. Each time you press increases the time in one-hour increments.
- Press **Chime** to turn the end of cycle chime sound on or off. An indicator light will illuminate on the **Display Screen** to show if the Chime is on or off.
- The Child Lock function prevents children from playing with the buttons on the control panel. Press and hold **Child Lock** for 5 seconds to set or release the Child Lock. An indicator light will illuminate on the display screen to show that the Child Lock is set. Once Child Lock is set, no button except for the **Power** button will function until the Child Lock has been released.

## Time Dry

If you want to set a specific time for drying (not using sensor dry cycles) press **Time Dry** to select the minutes to run the dry cycle. Repeated pressing of **Time Dry** increases the time in 10-minute increments up to one hour.

## Start the cycle

After dry cycle and options have been selected, Press the **START/PAUSE** button to start the cycle. The cycle can be paused at any time either by opening the door, or by pressing the **START/PAUSE** button.

## End of the cycle

When the cycle is completed, "**End**" will be displayed on the screen and the chime will sound if it has been set. Open the dryer door and remove the clothes from the dryer. It is recommended that clothes be removed from the dryer when the cycle ends and the clothes are still warm. Folding them right away will reduce wrinkles.

If clothes have been sitting in the dryer for a while after the cycle has ended, the **Refresh 12'** cycle can be run for a quick refresh of the clothes.

## Maintenance

To reduce the risk of electric shock, disconnect this dryer from the power supply before attempting any user maintenance other than cleaning the lint trap at the door. Pressing the POWER button does not disconnect this appliance from the power supply.

### Cleaning

Clean with a soft, damp cloth. Do not use abrasive substances.

Do not spray cleaners directly on the panel.

The control panel finish may be damaged by some laundry pre-treatment soil and stain remover products.

Apply such products away from your dryer and wipe up any spills or over spray immediately.

Protect the surface from sharp objects as they may scratch or damage the finish.

Do not place any heavy or sharp objects or a detergent box on the dryer. Keep them on the purchased pedestal or in a separated storage box.

### Lint Filter

Clean the lint filter before each dry cycle.

Pull the lint filter straight up. Moisten your fingers and remove the captured lint. Once clean, slide the filter back into its position.

Have a qualified technician vacuum the lint from the dryer once a year.

**NEVER operate the dryer without its lint filter in place.**

**NEVER operate the dryer with a wet lint filter.**

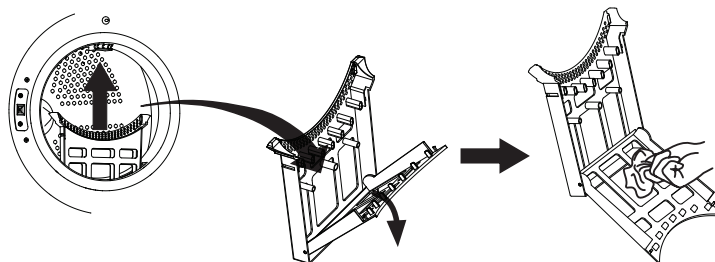

### Clean the lint filter at exhaust outlet regularly.

1. Release the tie to remove the exhaust hose from the exhaust elbow.

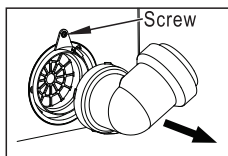
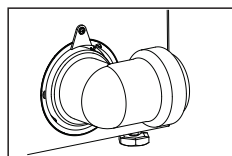

2. Turn the exhaust elbow counter clockwise about 30°, and pull it out.

3. Unscrew the screw that hold the lint filter in its place. Turn the filter about 30°, then pull it out. Clean all the lint on the filter and in the exhaust duct.

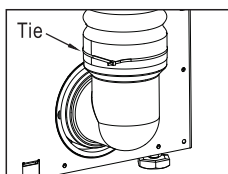
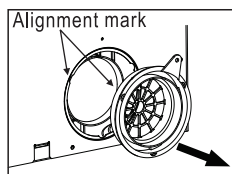

4. Re-install all the parts by following the reverse steps.

# Door Reversal

## Reversing the Door Swing (Optional)

- Before you start, unplug your dryer from its electrical outlet.
- Handle any parts carefully to avoid scratching the surface.
- This dryer must be exhausted to the outdoors.
- Do not move the dryer when service until door swing reversal completed.
- These steps are for changing the hinge and door assembly from left side to the right side. If you ever want to switch them back to the left side, follow these instructions and reverse all references to the left and right.

**Step 1.** Open the door. Remove the two screws holding the hinge/door assembly to the cabinet. Carefully set them aside.

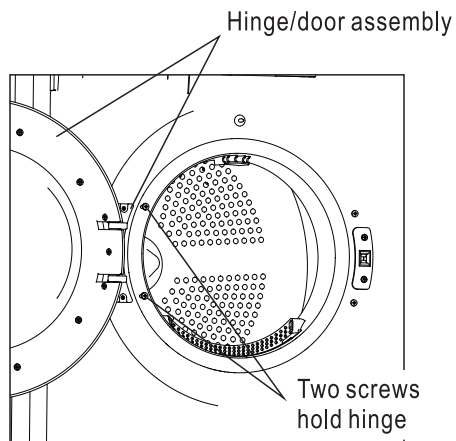

**Step 2.** Remove the two screws holding the strike plate, and the other two screws above and under the strike plate.

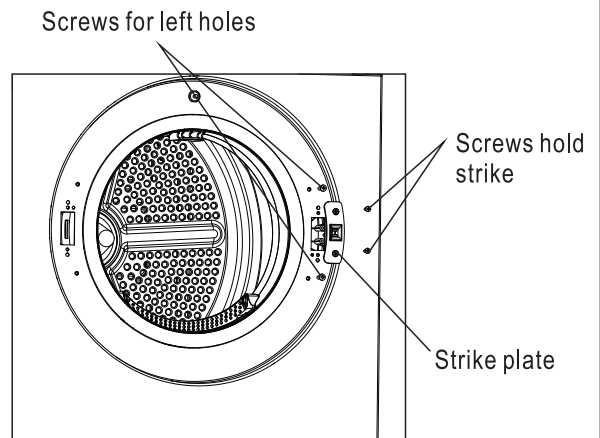

**Step 3.** Rotate the strike plate, then re-install it on the opposite side. And screw the other two screws into the holes left after remove the hinge/door assembly.

Secure with two same screws

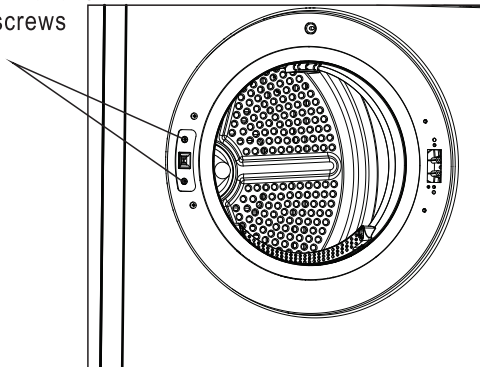

**Step 4.** Rotate and replace the hinge/door assembly on the opposite side, secure them using the same screws.

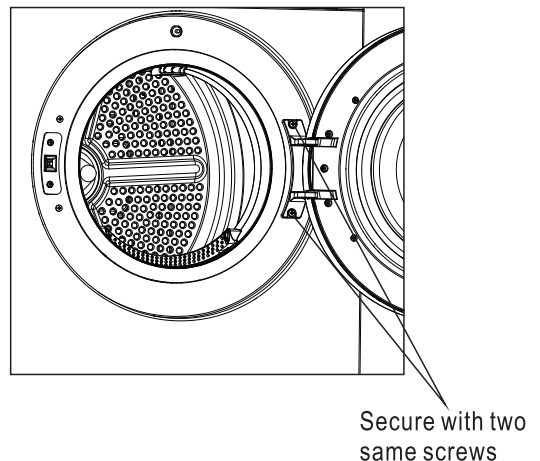

## Troubleshooting

In most cases, when your Dryer fails to work, the problems arising can be easily solved without having to call for a technician. Before calling for assistance, always check these points.

Problem	Possible Causes	Solutions
Dryer will not turn on	Power cord is not properly plugged in. House fuse is blown, circuit breaker has tripped, or power outage has occurred.	Make sure that the plug is plugged securely into a grounded outlet matching the dryer's rating card. Reset circuit breaker or replace fuse. Do not increase fuse capacity. If the problem is circuit overload, have it corrected by a qualified electrician.
Dryer shakes or make noise	Some shaking/noise is normal. Dryer may be sitting unevenly.	Move the dryer to an even floor space, or adjust the leveling legs as necessary until it is even.
Clothes take too long to dry	Improper or obstructed duct	Check the Installation Instructions to make sure the dryer venting is correct. Make sure duct is clean, free of kinks and unobstructed. Check to see if outside wall cap operates easily.
	Improper sorting	Separate heavy items from lightweight items (generally, a well-sorted washer load is a well-sorted dryer load).
	Large loads of heavy fabrics (like beach towels)	Large, heavy fabrics contain more moisture and take longer to dry. Separate large, heavy fabrics into smaller loads to speed drying time.
	Controls improperly set	Match the settings to the clothes to dry.
	Lint filter is full	Clean the filter before every load.
	Blown fuses or tripped circuit breaker	Replace fuses or reset circuit breakers. Since most dryers use 2 fuses/breakers, ensure both are operating.
	Overloading/combining loads	Do not put more than one wash load in the dryer at a time.
The dry level was chosen, but load is still damp	Load consists of a mixture of heavy and light fabrics	When combining heavy and light fabrics in a load, select Extra dry level.
	Lint filter is blocked	Check and clean the lint filter.
	Dry sensor is dirty	Clean the sensor with a moist cloth.
Control button(s) not responding	Child lock activated	This is normal, press the button for 5 seconds to release.
	The option is incompatible with the desired dry cycle.	This is normal, select the right options for your dry cycle.
Remaining time changed to a lower or a greater number	The estimated time may change when dry a smaller, or bigger load than normal load.	This is normal.
Dryer doesn't heat	Fuse is blown/circuit breaker is tripped	Check the fuse/circuit breaker, and replace fuse or reset breaker.

<b>Problem</b>	<b>Possible Causes</b>	<b>Solutions</b>
Clothes are still wet and dryer shut off after a short time	The door was opened before the end of dry cycle, then the load was removed, and a new wet clothes were loaded without selecting a new cycle	A new dry cycle must be selected for each new load.
	Load was already dry except for collars and waistbands	Choose Quick Dry or Time Dry to dry damp collars and waistbands. In the future, when drying a load with collars and waistbands, choose Extra.
Clothes are wrinkled	Over drying	Select a shorter drying time. Remove items while they still hold a slight amount of moisture. Select a Damp setting.
	Items sit in dryer after cycle ends	Remove items when cycle ends and fold or hang immediately.
	Overloading	Separate large loads into smaller ones.
Clothes shrink	Some fabrics will naturally shrink when washed. Others can be safely washed, but will shrink in the dryer.	To avoid shrinkage, follow garment care labels exactly. Some items may be pressed back into shape after drying. If you are concerned about shrinkage in a particular item, do not machine wash or tumble dry it.
Greasy spots on clothes	Drying dirty items with clean ones	Use your dryer to dry only clean items. Dirty items can stain clean items and the dryer.
	Clothes were not completely clean	Sometimes stains which cannot be seen when the clothes are wet appear after drying. Use proper washing programs before drying.
Lint on clothes	Lint filter is full	Clean lint screen before each load.
Static occurs	Synthetics, permanent press and blends can cause static	Try a fabric softener.
	Over drying	Try a fabric softener. Select Damp dry level.

## Error Codes

Information codes may be displayed to help you understand better what is wrong with your dryer.

Error Codes	Problem	Solutions
E -1	Door is open	Close the door well.
	Door switch failure	Check the wiring connections between door switch and the Electronic Module. Replace a new door switch.
E -2	Dry sensor failure	Check the wiring connections between dry sensor and the Electronic Module. Replace a new dry sensor.
E -5	Dry heating failure	Clean the lint filter at exhaust outlet. Push down the button of thermostat.
E -7	Drum does not rotate	Belt has fallen off or broken. Replace belt.

If Error Codes display that are other than the ones listed in the table, please contact Customer Service.

