

INSTALLATION INSTRUCTIONS

PLEASE READ CAREFULLY AND SAVE THESE INSTRUCTIONS, AS YOU MAY NEED THEM AT A LATER DATE.

Remove the fixture and the mounting package from the box and make sure that no parts are missing by referencing the illustrations on the installation instructions.

GENERAL: All electrical connections must be in accordance with local and National Electrical Code (N.E.C.) standards. Installation must be performed by a qualified installer.

WARNING

TURN OFF THE MAIN POWER AT THE CIRCUIT BREAKER BEFORE INSTALLING THE FIXTURE, IN ORDER TO PREVENT POSSIBLE SHOCK.

THIS FIXTURE IS RATED FOR INSTALLATION ONTO A 100 -130 V CIRCUIT. USING APPROPRIATE METER EQUIPMENT, IT IS THE RESPONSIBILITY OF THE INSTALLER TO IDENTIFY THE HOT AND NEUTRAL WIRES OF THE POWER CIRCUIT BEFORE INSTALLATION.

* 15WATT LED = 90 WATT EQUIVALENT;
20WATT LED = 100 WATT EQUIVALENT.

* 25WATT LED=(2) 60 WATT EQUIVALENT;
INCANDESCENT BULBS.

ASSEMBLY AND INSTALLATION

1. To avoid risk of electric shock, make sure to turn off main power switch prior to installation or maintenance.
2. Drive the screws into the Junction Box, with 2/3 inside and 1/3 outside. (FIG. 1)
3. Connect the black and white wires of the luminaire with two wires of the same color from the junction box with wire caps. Connect the grounding wire of the luminaire with the one from the junction box with wire cap (FIG. 2)
4. Tuck all the wires and connections into the Junction Box. Align the Mounting Hole on the fixture to the driven screws and put in, then twist the fixture clockwise. Use the screw driver to adjust the screws outside length and fix the fixture on the wall. (FIG. 3)
5. Put the Light Shade back to the light and use the Top Ring to cover it, fix the Light Shade and the Top Ring with 3pcs hold-down nuts. (FIG. 4)
6. Turn on power and light switch to activate the luminaire. (FIG. 5)

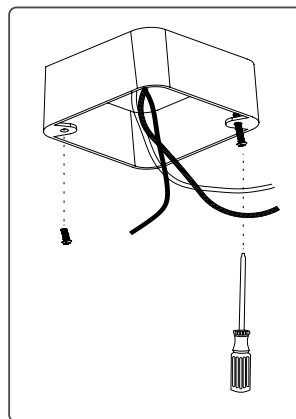

FIG. 1

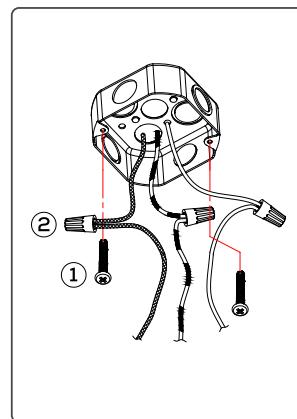

FIG. 2

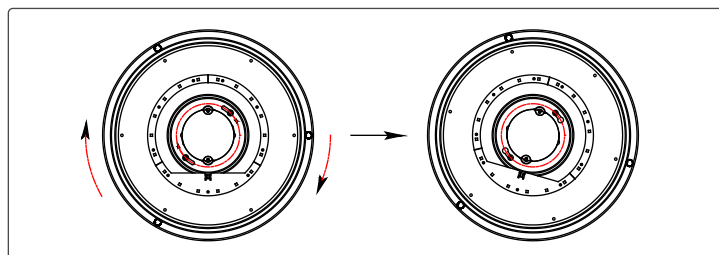

FIG. 3

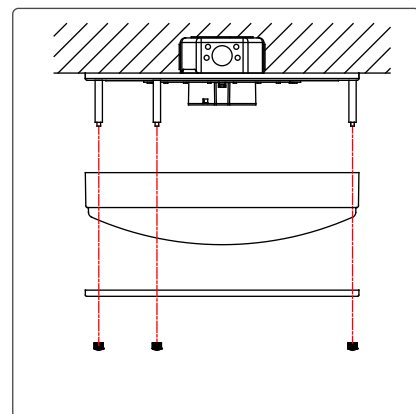

FIG. 4

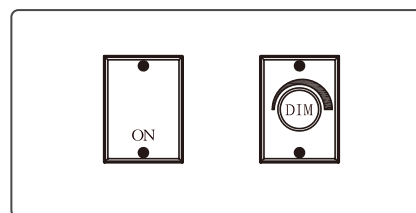

FIG. 5