

# Natural Roller Shade Installation Instructions

## Persiana Enrollable Instrucciones de instalación

TOOLS  
HERRAMIENTAS

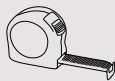

Brackets included  
Los soportes incluidos

### INSTALLATION INSTRUCTIONS · INSTRUCCIONES DE INSTALACION

#### 1 BRACKET PLACEMENT COLOCAR EL SOPORTE

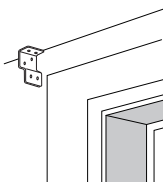

Universal mount  
Montaje universal

#### 2 INSTALL SHADE ON BRACKETS INSTALE LA PERSIANA EN LOS SOPORTES

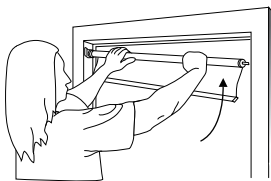

### SPECIAL CASES · CASOS ESPECIALES

**IF SHADE DOES NOT RAISE:  
SI LA PERSIANA NO SE ELEVA:**

\*Over winding may cause permanent damage  
\*Enrollar la persiana excesivamente puede ocasionarle daños permanentes al producto

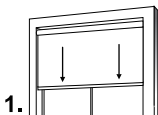

1. Pull down one Foot  
Baje hasta 30cm



2. Remove from brackets  
Retire de los soportes



3. Roll shade up  
Enrolle la persiana



4. Re-install on brackets  
Vuelva a instalar sobre los soportes

5. Repeat if necessary  
Repita la operación  
si fuera necesario

**IF SHADE DOES NOT LOWER WITH EASE:  
SI LA PERSIANA NO SE BAJA CON FACILIDAD:**



1. Remove from brackets  
Retire de los soportes



2. Roll shade down one foot  
Desenrolle la persiana 30cm



3. Re-install on brackets  
Vuelva a instalar sobre los soportes

4. Repeat if necessary  
Repita la operación  
si fuera necesario

Instrucciones de cuidado:  
Use un detergente ligero para limpiar la persiana. Verifique resultados en una área pequeña.

Care Instructions:  
Use mild detergent to wipe shades clean. Test on small area to verify results.

We hope you enjoy your new purchase!  
If you have any questions regarding this product or the instructions  
Please call Achim's Family of Home Furnishings  
Customer Service at 1-800-54-ACHIM  
Visit our website at [www.achimonline.com](http://www.achimonline.com)  
Made in Taiwan, Finished in China

