

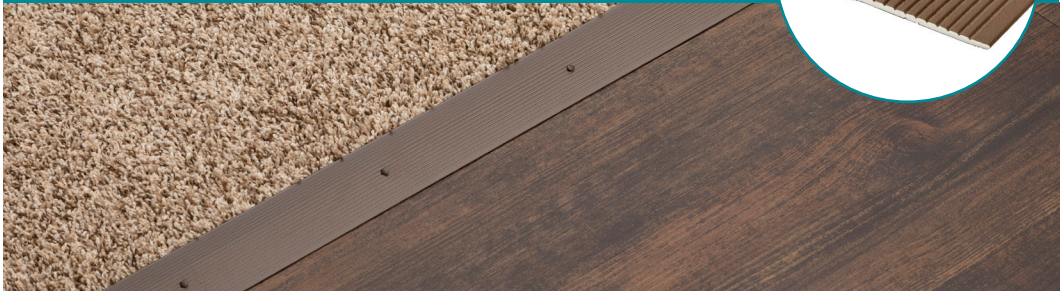

FLOOR TRANSITIONS

CARPET TRIMS - Aluminum



- Transitions carpet to lower floor
- Covers gap between floors of unequal height
- Protects carpet edge

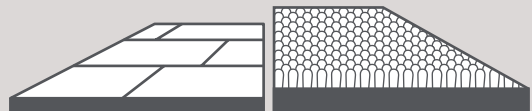

Transitions floors of unequal height

How-To Install

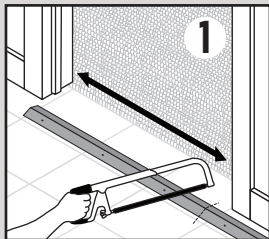

Cut trim to desired length.

Corte la moldura al largo deseado.

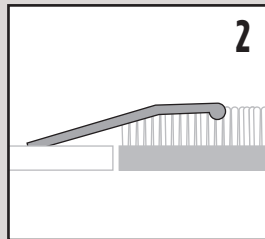

Position shorter leg on carpet.

Coloque le sección más cora sobre la alfombra.

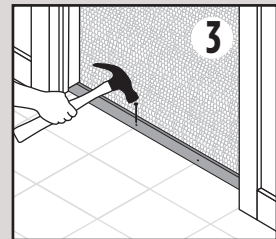

Wood Floors: Use provided fasteners. **Concrete Floors:** Install with provided fasteners & wood pegs (sold separately).

Piso de madera: Use los sujetadores provistos. **Pisos de concreto:** Use los sujetadores provistos con tarugos de madera (se venden por separado).

NOTE: When hammering down fasteners, protect nail heads from chipping by placing clear tape over the heads. Replace tape for each screw nail installed.
NOTA: Al martillar los sujetadores, proteja las cabezas de los clavos para que no se astillen colocando cinta transparente sobre las cabezas. Reemplace la cinta para cada clavo de tornillo instalado.