

# Assembly Instructions

PWS-EC4091-TO

70.87 IN. TENDER OAK WOOD TV STAND

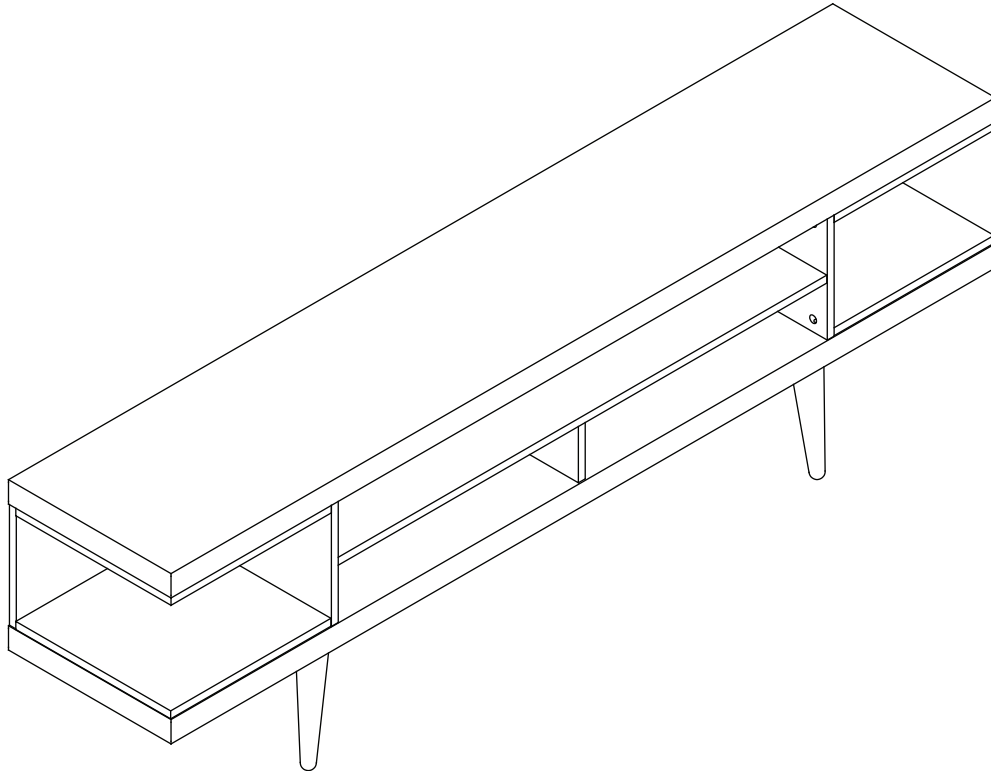

THIS INSTRUCTION BOOKLET CONTAINS **IMPORTANT** SAFETY INFORMATION. PLEASE READ AND KEEP FOR FUTURE REFERENCE.

## Do Not Return This Product!

Contact our customer service team for help first.

Monday-Friday 9am - 5pm CST

Visit: [support@cenports.com](mailto:support@cenports.com)



## **WARNING**

- Unit can tip over causing severe injury or death.
- Anchor unit to stud in wall (if instructed to).
- Do Not allow children to climb on unit.
- Put heavy items on lower shelves or drawers.

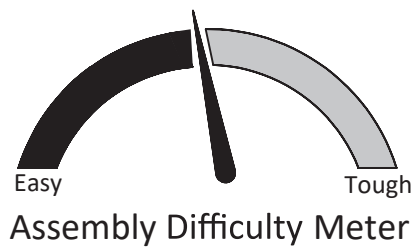

# Contact Us!

## Do NOT return this product!

Contact our friendly customer service team first for help



Visit [support@cenports.com](mailto:support@cenports.com)

# Helpful Hints

PEOPLE NEEDED FOR ASSEMBLY: **1-2**

ESTIMATED ASSEMBLY TIME: **30 MINUTE**

- Open your item in the area you plan to keep it to avoid excessive heavy lifting.
- Identify, sort and count the parts before attempting assembly.
- Compression dowels are lightly tapped in with a hammer.
- Slides are labeled with a **R** (right) and **L** (left) for proper placement.
- Make sure to always face the point on the top of the Cam Lock towards the outer edge.
- Use all the nails provided for the back panel and spread them out equally.
- Back panel must be used to make sure your unit is sturdy.
- Do NOT use harsh chemicals or abrasive cleaners on this item.
- Never push, pull, or drag your furniture.



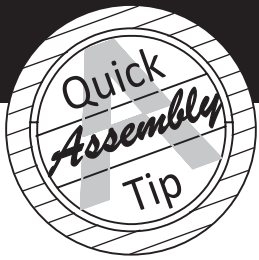

# Before You Start

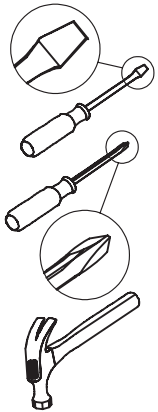

- ✓ Read through each step carefully and follow the proper order
- ✓ Separate and count all your parts and hardware
- ✓ Give yourself enough room for the assembly process
- ✓ Have the following tools: Flat Head Screwdriver, #2 Phillips Head Screwdriver and Hammer
- ✓ Caution: If using a power drill or power screwdriver for screwing, please be aware to slow down and stop when screw is tight. Failure to do so may result in stripping the screw.

## Cam Lock Fastening System

This Cam Lock Fastening System will be used throughout the assembly process.

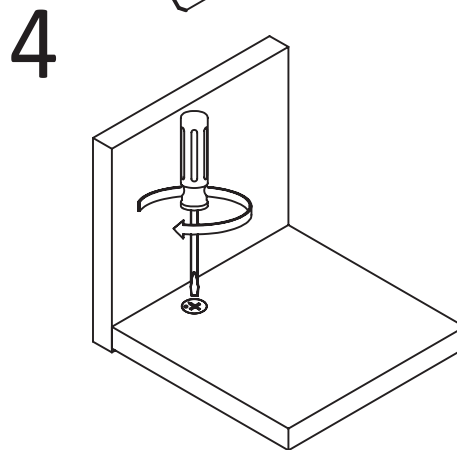
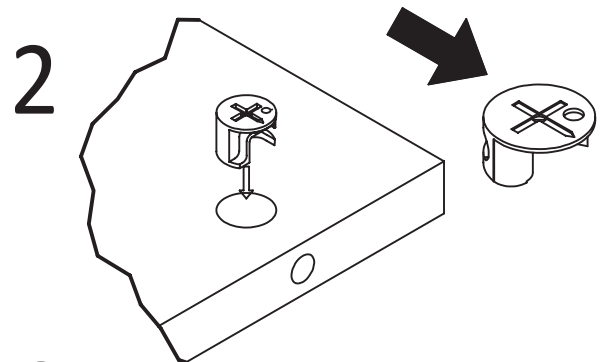
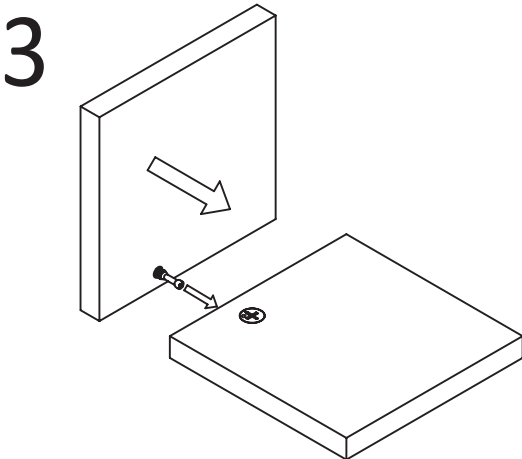
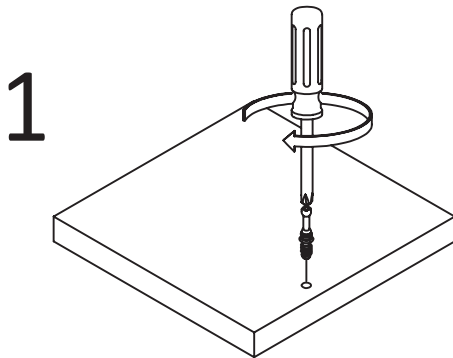

# Board Identification

Not actual size

A

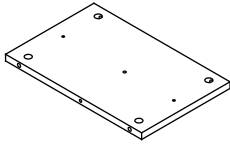

x1  
SIDE PANEL LEFT

B

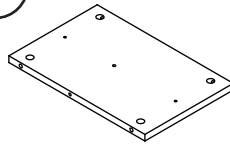

x1  
SIDE PANEL RIGHT

C

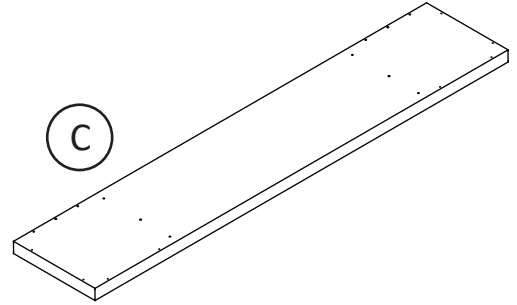

x1  
TOP PANEL

D

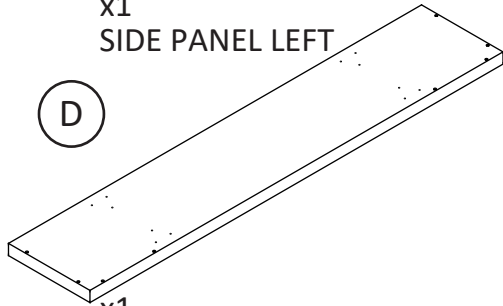

x1  
BOTTOM PANEL

E

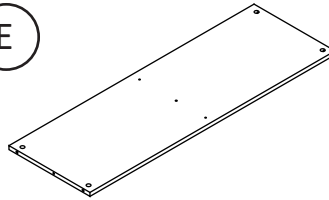

x1  
CENTER PANEL

F

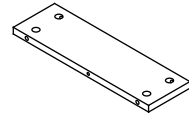

x1  
CENTER SUPPORT PANEL

G

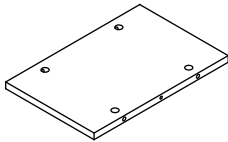

x1  
BACK LEFT PANEL

H

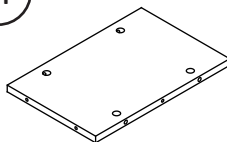

x1  
BACK RIGHT PANEL

I

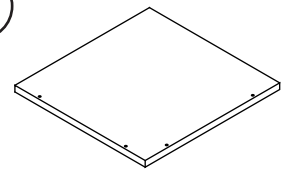

x1  
TOP LEFT PANEL

J

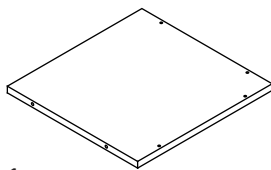

x1  
TOP RIGHT PANEL

K

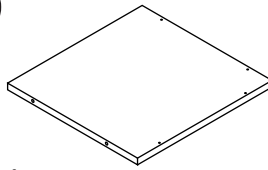

x1  
BOTTOM LEFT PANEL

L

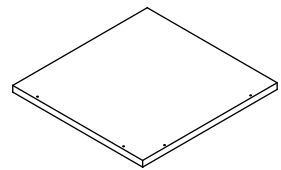

x1  
BOTTOM RIGHT PANEL

Y

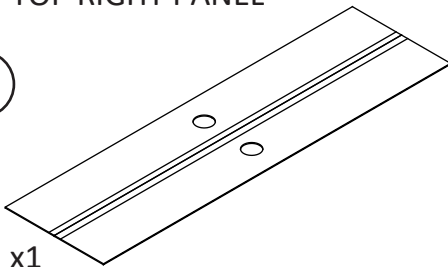

x1  
BACKPLY PANEL

# Part List

Not Actual Size



x24  
Minifix Bolt

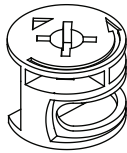

x24  
Cam Lock  
12-15



x28  
Wood Dowel  
6 X 30

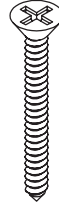

x16  
Csk Screw  
4.7 X 38



x12  
Csk Screw  
3.5 X 15

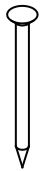

x18  
NAIL PIN

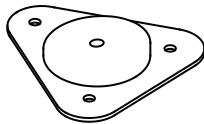

x4  
METAL BRACKET



x4  
SOLIDWOOD LEG

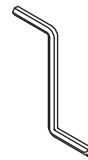

x1  
Allen Key M4

# Step 1

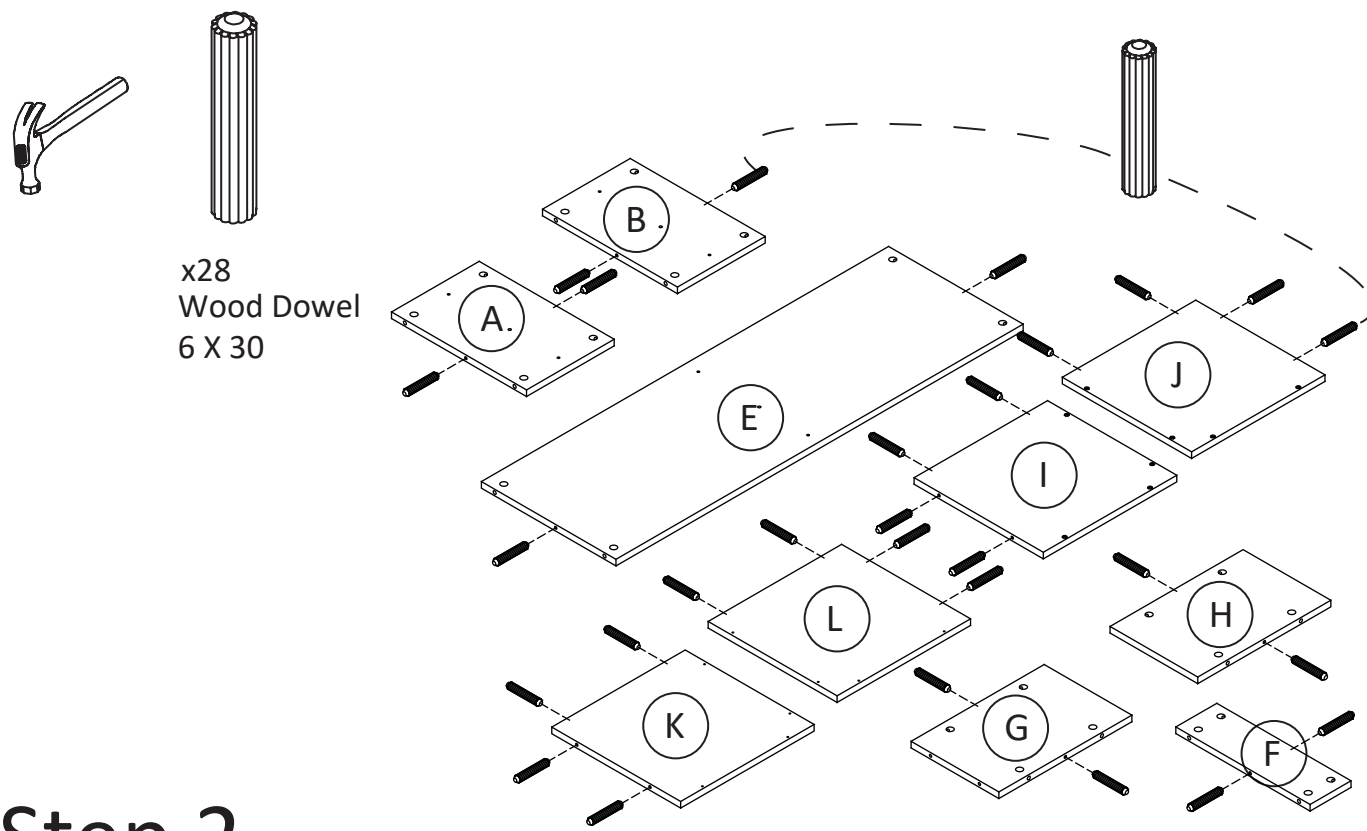

# Step 2

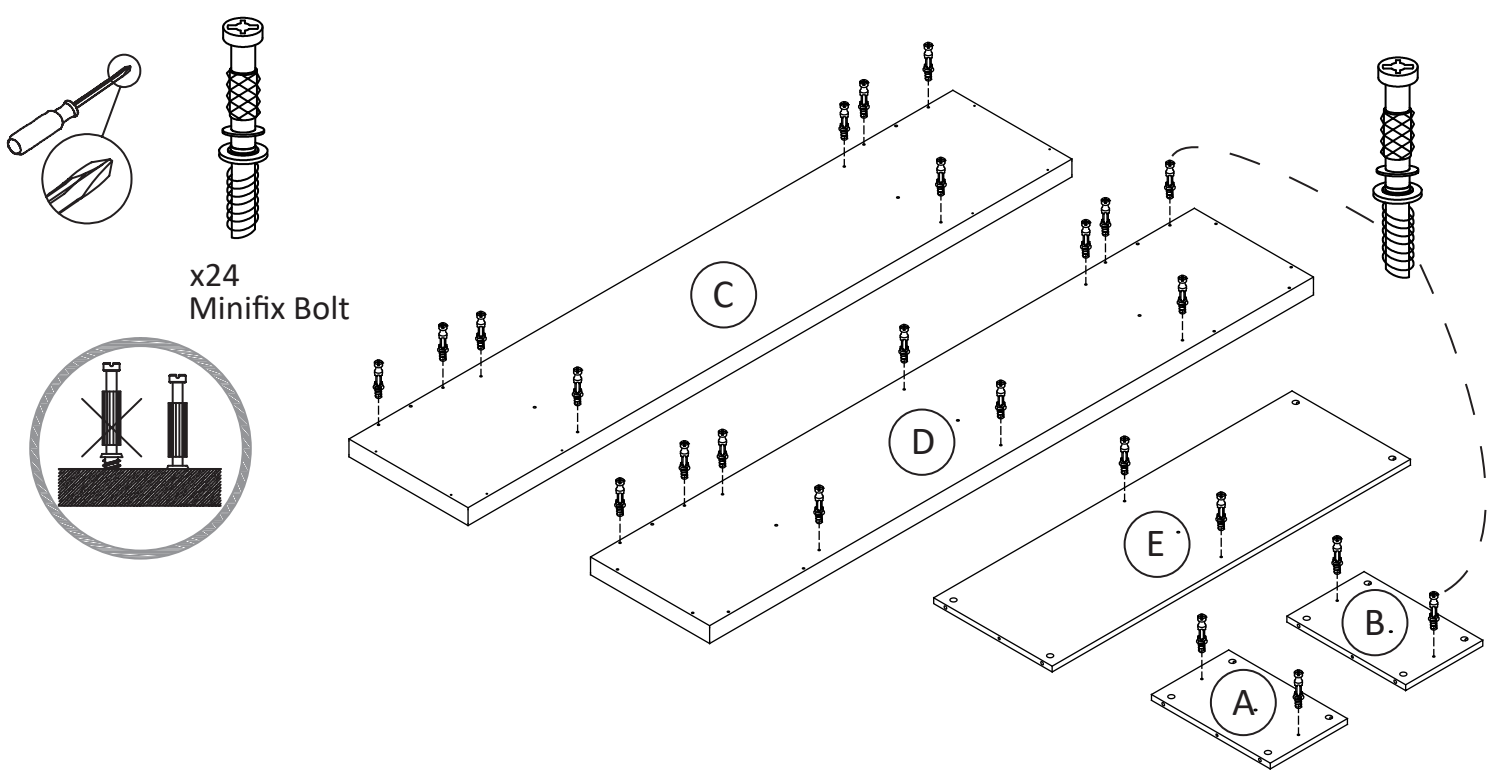

# Step 3

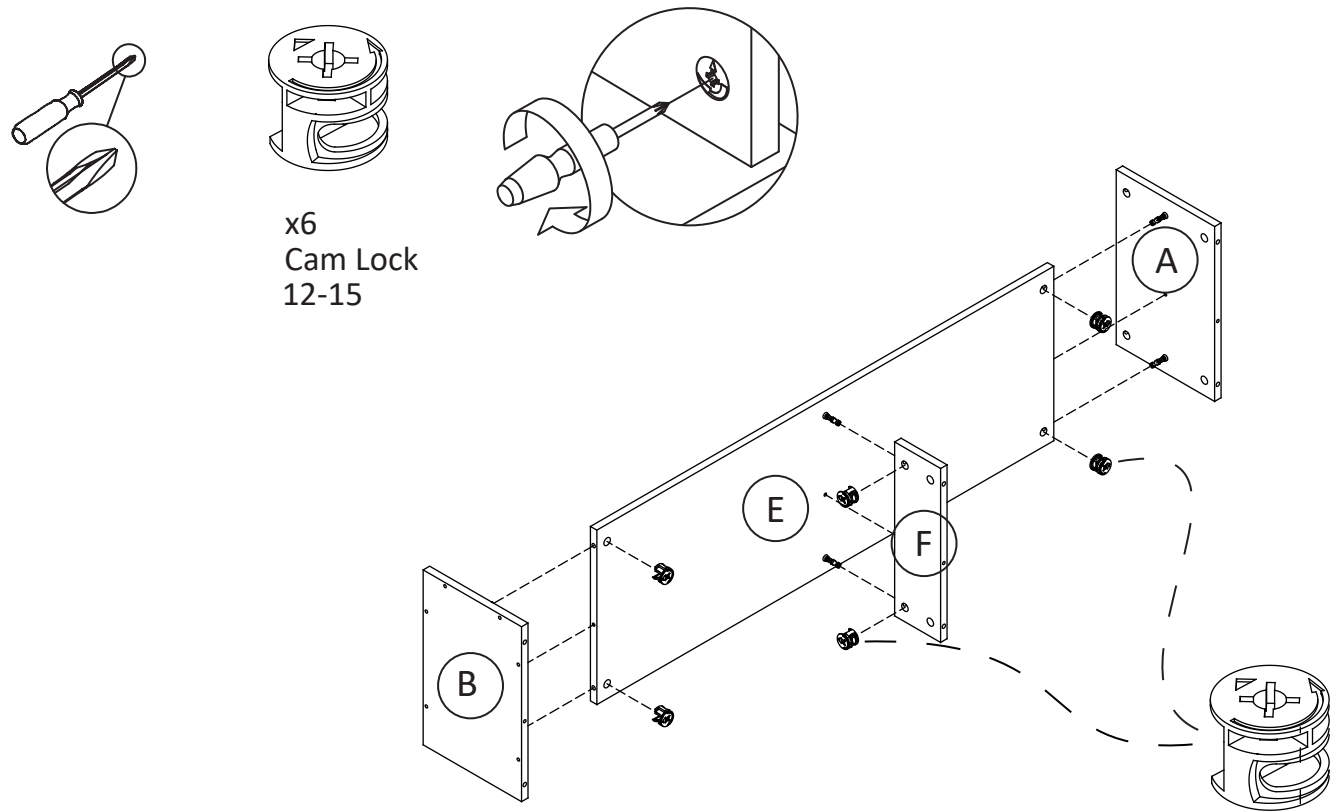

# Step 4

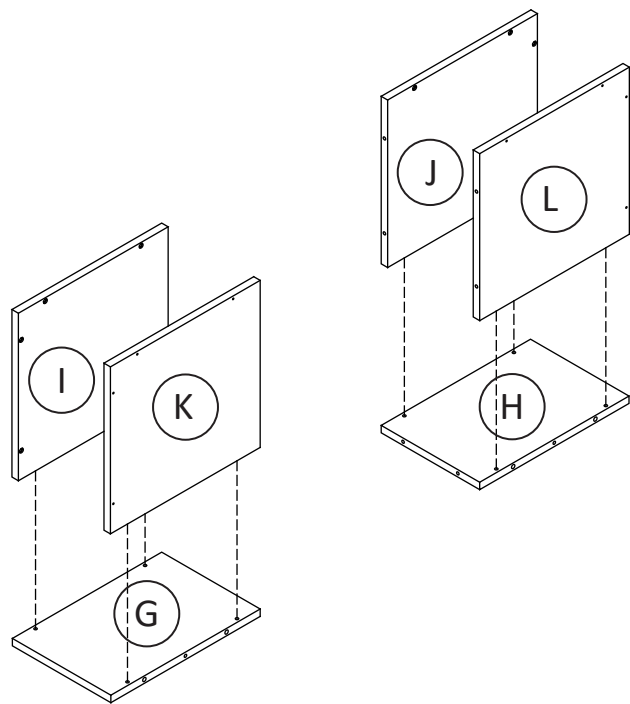

# Step 5

---

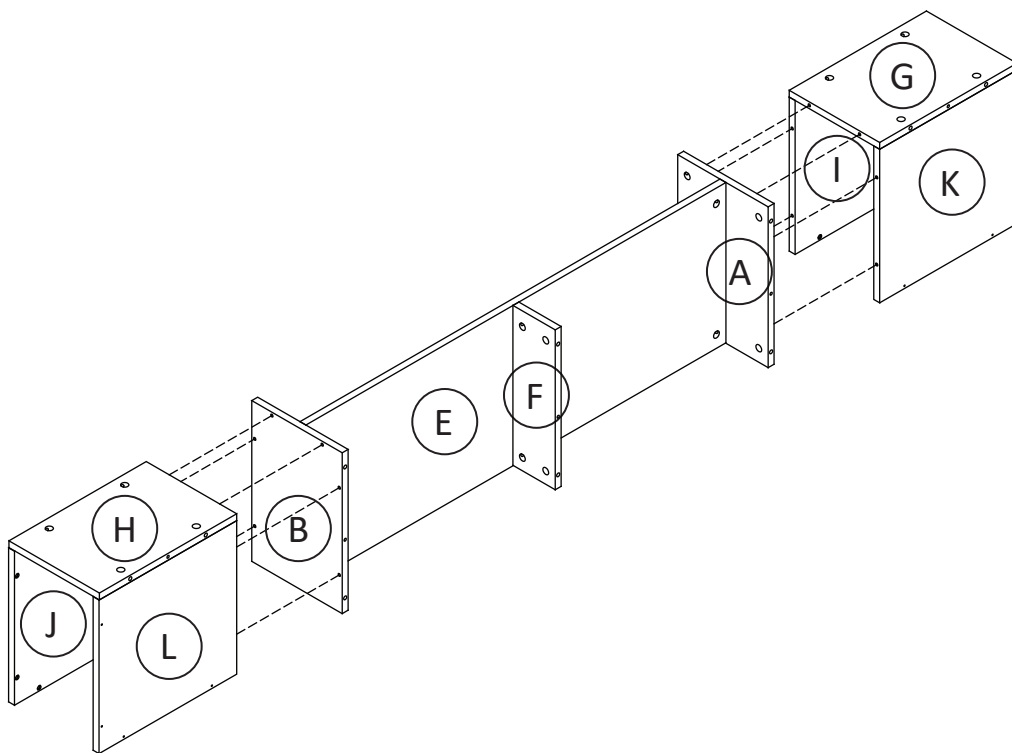

# Step 6

---

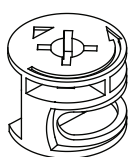
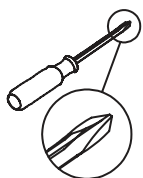

x8  
Cam Lock  
12-15

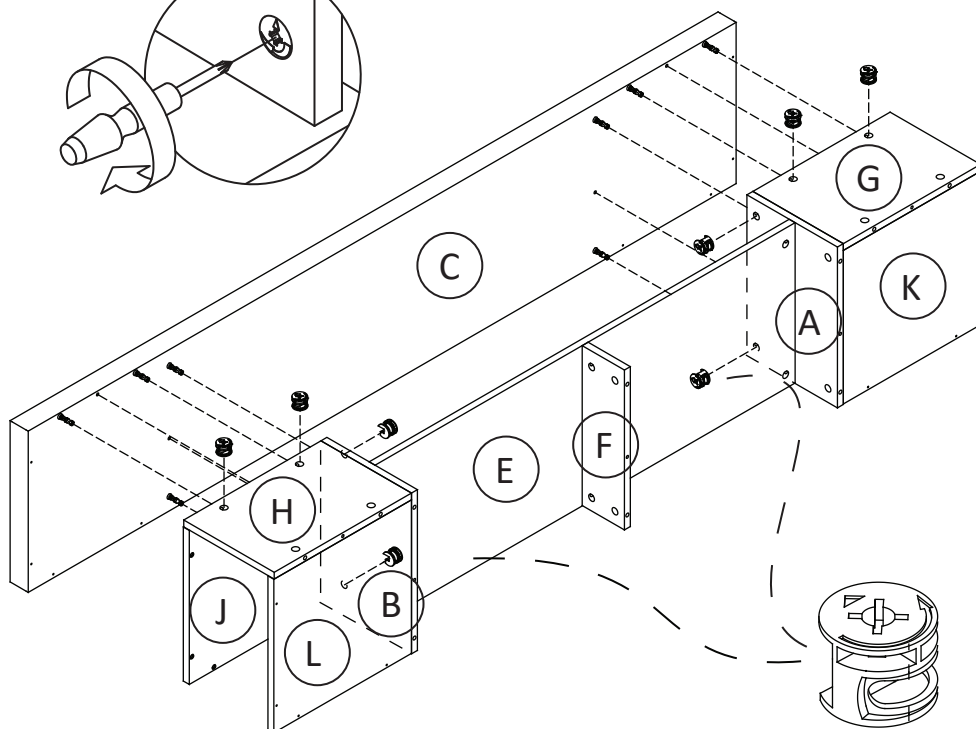
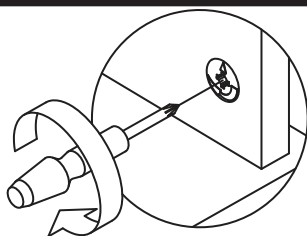

## Step 8

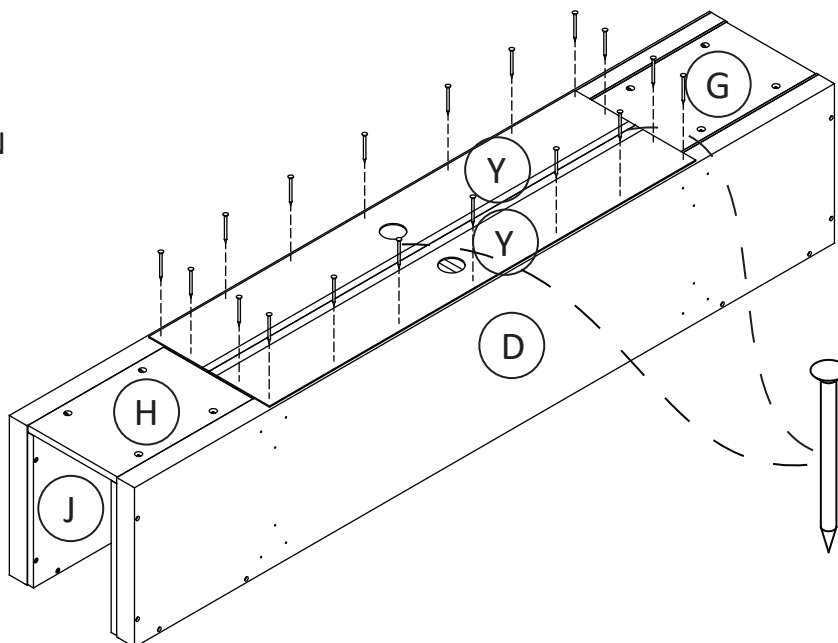

# Step 9

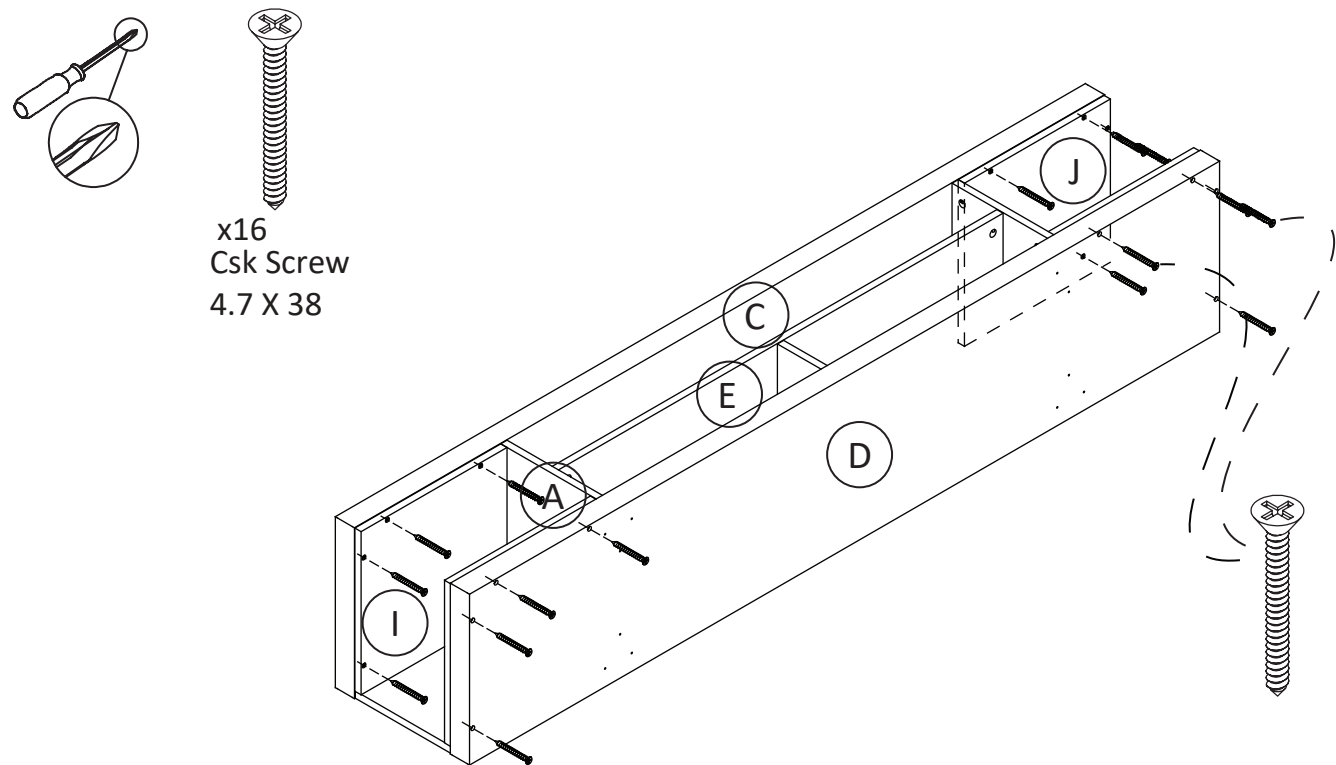

# Step 10

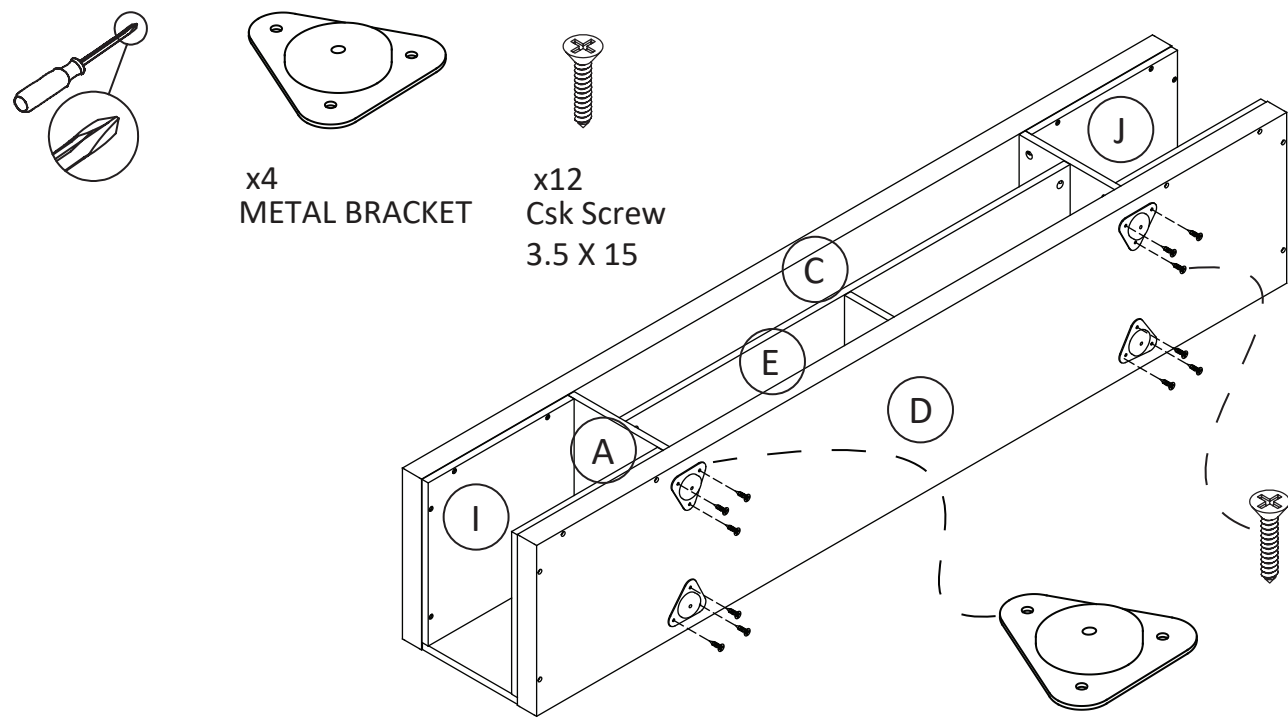

# Step 11

---

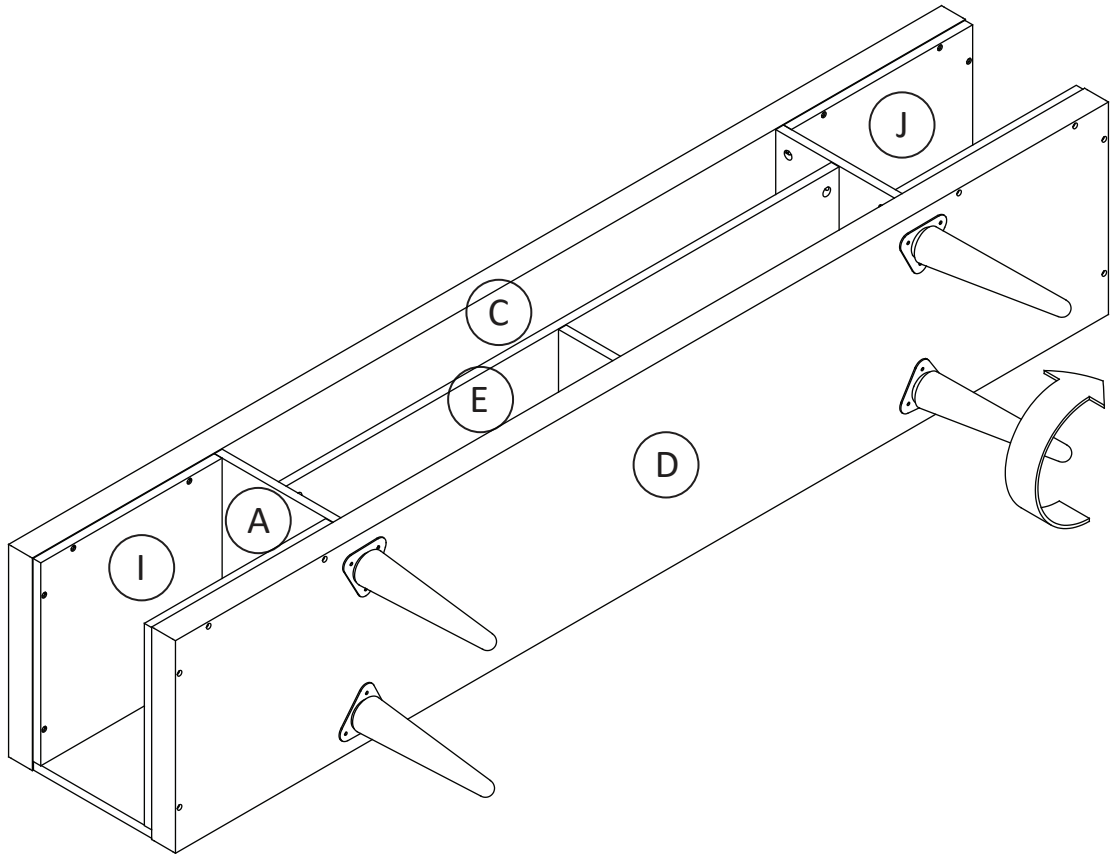
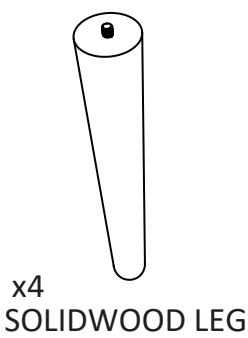

---

MAX WEIGHT LOAD: 99 LBS

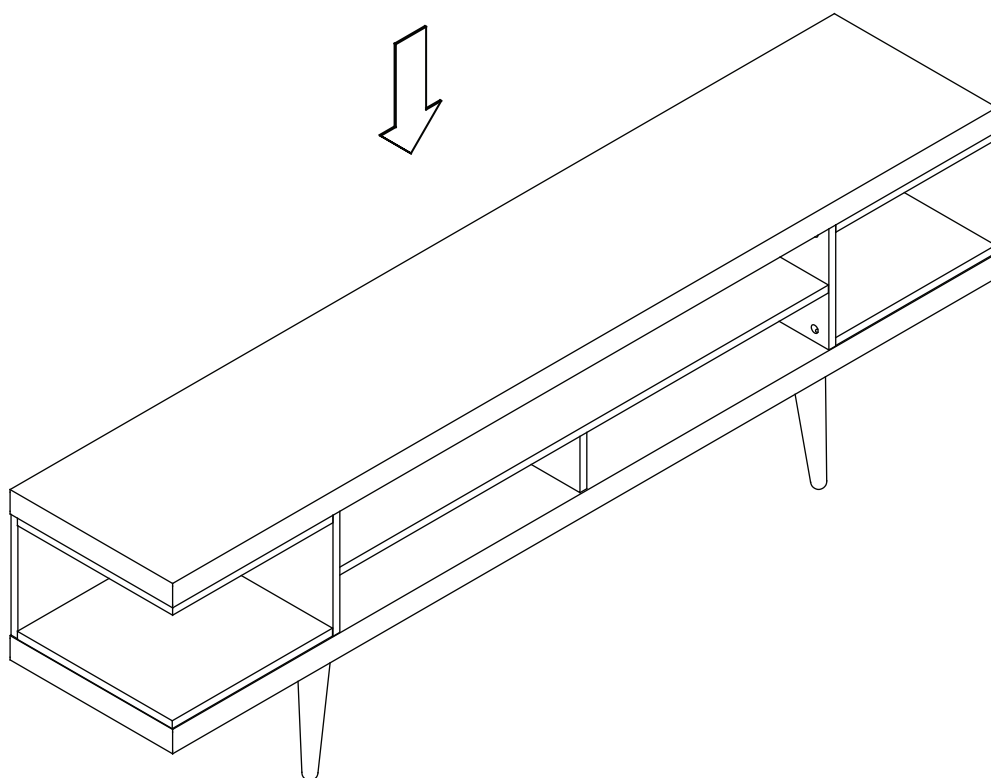

## **Tips for Proper Care and Maintenance of Particle Board Furniture**

### **Understanding Particle Board**

#### **Particle Board Composition:**

Particle board is composed of wood particles, such as sawdust and wood chips, bonded together with adhesive under high pressure. The surface of particle board is typically covered with a laminate or veneer to enhance its appearance.

#### **Sensitivity to Moisture:**

One of the primary vulnerabilities of particle board is its sensitivity to moisture. Excessive exposure to water or high humidity can cause swelling, warping, or delamination.

### **Cleaning and Maintenance Guidelines**

#### **1. Dust Regularly:**

Regular dusting is crucial to prevent the accumulation of dirt and grime on particle board surfaces. Use a soft, dry cloth or a duster to gently remove dust.

#### **2. Avoid Excess Water:**

Particle board should not be cleaned with excessive water or harsh cleaning agents. Use a slightly damp (not wet) cloth with a mild cleaner specifically designed for wood surfaces.

#### **3. Protect from Direct Sunlight:**

Prolonged exposure to direct sunlight can cause discoloration or fading of the particle board surface. Position furniture away from direct sunlight or use window coverings to reduce exposure.

#### **4. Use Coasters and Mats:**

Protect particle board surfaces from hot items, spills, and scratches by using coasters, placemats, or felt pads under objects. This precaution prevents damage and preserves the furniture's appearance.

#### **5. Repair Minor Damage Promptly:**

Address minor damage such as scratches or small chips promptly. You can use touch-up markers or putty to fill in and conceal minor imperfections. Ensure that the repair materials match the furniture's colour and finish.