

**Air  
INNOVATIONS<sup>®</sup>**



**12" SWIRL COOL™ 2-IN-1 FAN  
WITH CORD WRAP**

# Contents

|  |   |
|--|---|
| Safety Instructions.....   | 1 |
| How It Works / Specifications .....  | 2 |
| Parts / Fan Assembly .....   | 3 |
| Operating Instructions / Using The SwirlCool™ Function / Setting The Timer ..... | 4 |
| How To Convert To Tabletop .....   | 5 |
| Cleaning .....   | 6 |
| Servicing Instructions / How To Replace the Fuse.....                            | 7 |
| Other Great Products .....   | 8 |
| Warranty .....   | 9 |

## FCC STATEMENT

Potential for Radio/Television interference.

This device complies with Part 18 of the FCC Rules. Operation is subject to the following two conditions:

(1) This device may not cause harmful interference, and (2) this device must accept any interference received, including interference that may cause undesired operation. This product has been tested and found to comply with the limits for a Class B digital device, pursuant to Part 18 of the FCC rules.

These limits are designed to provide reasonable protection against harmful interference in a residential installation. The product generates, uses, and can radiate radio frequency energy and, if not installed and used in accordance with the instructions, may cause harmful interference to radio communications. However, there is no guarantee that the interference will not occur in a particular installation. If the product does cause harmful interference to radio or television reception, which can be determined by turning the product on or off, the user is encouraged to try to correct the interference by one or more of the following measures:

- Reorient or relocate the receiving antenna.
- Increase the separation between the product and the receiver.
- Connect the product into an outlet on a circuit different from that to which the receiver is connected.
- Consult the dealer or an experienced radio/TV technician for help.
- Changes or modifications not expressly approved by the party responsible for compliance could void the user's authority to operate the equipment.

# SAFETY INSTRUCTIONS

READ AND SAVE THESE INSTRUCTIONS

**When using electrical appliances, basic safety precautions should always be taken including the following:**

- This product is for household use only; do not use outdoors.
- Always use on a dry, level surface.
- ⚠ **WARNING: DO NOT** operate in the presence of explosive and/or flammable fumes.
- Avoid contact with moving parts.
- Operate fan only when fully assembled with all parts properly in place.
- Only use attachments provided by the manufacturer for this product.
- Close supervision is necessary when any fan is used by or near children.
- Unplug from outlet when not in use, when moving fan from one location to another, before servicing and before cleaning.
- To disconnect, grip plug and pull from wall outlet; never pull on cord.
- ⚠ **WARNING: DO NOT** operate the fan with a damaged cord or plug, or after the fan malfunctions, has been dropped or damaged in any manner.
- To protect against electrical shock, **DO NOT** immerse unit, plug or cord in water or spray with liquids and plug the appliance directly into a 120V AC electrical outlet.
- ⚠ **WARNING:** To avoid fire hazard, **NEVER** place the cord under rugs or any parts near open flame, cooking or other heating appliance. **DO NOT:** run cord under carpeting or cover cord with throw rugs, runner, or similar covering. Arrange cord away from traffic areas and where it will not be tripped over.
- ⚠ **WARNING:** To reduce the risk of fire or shock, **DO NOT** use this fan with any solid-state speed control device.
- This product employs overload protection (fuse). A blown fuse indicates an overload or short-circuit situation. If the fuse blows, unplug the fan from the outlet. Replace the fuse as per the user Servicing Instructions (following product marking for proper fuse rating) and check the fan. If the replacement fuse blows, a short-circuit may be present and the product should be discarded or returned to an authorized service facility for examination and/or repair.

**THIS APPLIANCE HAS A POLARIZED PLUG** (one blade is wider than the other). To reduce the risk of electric shock, this plug is intended to fit in a polarized outlet only one way. If the plug does not fit fully in the outlet, reverse the plug. If it still does not fit, contact a qualified electrician to install the proper outlet.

**DO NOT ATTEMPT TO MODIFY THIS PLUG OR DEFEAT THIS SAFETY FEATURE IN ANY WAY.**



## How it Works

Thank you for purchasing the Air Innovations® 12" SwirlCool™ 2-in-1 Fan with Cord Wrap. This product comes with a 1-YEAR WARRANTY from the date of purchase as your satisfaction is our primary concern.

Air Innovations® 12" SwirlCool™ 2-in-1 Fan with Cord Wrap helps to cool and circulate the air around you. Perfect for any room in your home or office, this stand fan is adjustable in height and can also be converted to a tabletop fan by simply removing the fan from the base and placing it on the included Tabletop Bracket. This 6 blade fan also includes Swirl-Cool™ Technology, a unique rotating Front Grill, to increase air circulation throughout the room. With speeds from Low, Medium to High you can change the desired fan speed at any time. The convenient timer feature allows you to set the fan to turn off in 1 hour increments, up to 7 hours.

## Specifications

| Product Model | Power Consumption | Rated Voltage | Dimensions              | Weight  |
|---------------|-------------------|---------------|-------------------------|---------|
| AI-4400       | 55W               | AC 120V-60Hz  | L20" x W 15"<br>x H 42" | 7.5 lbs |

# Parts

1. (1) Fan with 2 Short Chrome Rods & End Caps
2. 2a Front Grill / 2b Front Grill Cover
3. (2) Long Chrome Rods
4. (1) Support Bar
5. (1) Base
6. (1) Tabletop Bracket
7. (2) Additional Replacement Caps
8. (2) Adjustment Levers
9. Cord Wrap

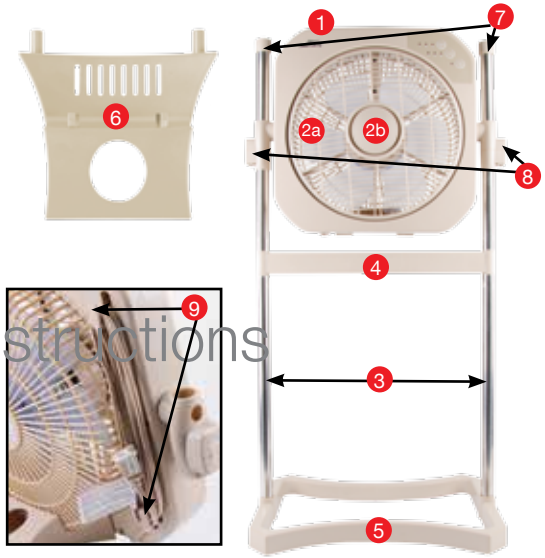

To ensure proper assembly be sure that all openings on the Chrome Rods line up to the snaps properly.

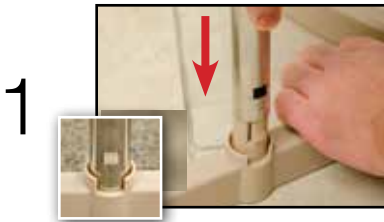

Place the base on the floor. Insert the Long Chrome Rods into the base until they snap into place.



Place the Support Bar on the top ends of Long Chrome Rods. Push down and snap into place.

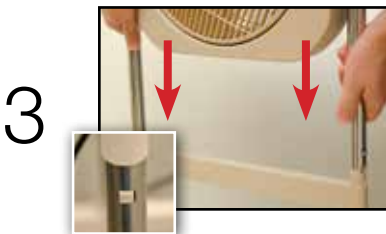

Insert the Fan with the Short Chrome Rods onto the Support Bar. Push down and snap into place.



Lift Adjustment Levers up and slide fan up or down to desired level.

# Operating Instructions

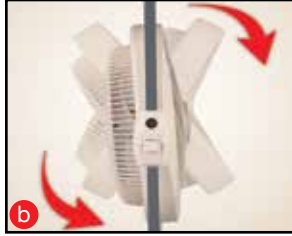
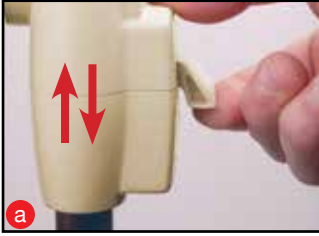

Set fan on a level, dry surface and plug the cord into wall outlet. Adjust the fan to desired height by lifting the Adjustment Levers and slide the fan up or down (a). Aim the fan up or down (up to 45°) by rotating the fan housing to desired position (b). Select your desired fan speed: Low, Medium or High by pressing the ON (SPEED) button repeatedly (c).



LOW



MEDIUM



HIGH



OFF

## Using The SwirlCool™ Feature

The Front Grill of this fan will rotate, if desired, to increase circulation of air throughout the room. Press the SwirlCool™ button once to turn ON this feature. When ON the SwirlCool™ LED will glow, and the Grill will rotate. Press the button again to stop rotation.

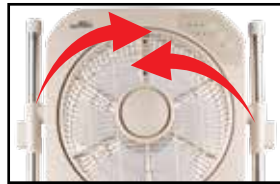

### NOTE:

The Grill may rotate in either direction. This is normal and does not affect performance.

|                       |       |                |
|-----------------------|-------|----------------|
| <b>TIMER SETTINGS</b> | ● ● ● | OFF            |
|                       | ● ● ● | 1 hour setting |
|                       | ● ● ● | 2 hour setting |
|                       | ● ● ● | 3 hour setting |
|                       | ● ● ● | 4 hour setting |
|                       | ● ● ● | 5 hour setting |
|                       | ● ● ● | 6 hour setting |
|                       | ● ● ● | 7 hour setting |

## Setting The Timer

If desired, you can set the fan to turn OFF in 1 to 7 hours, in one hour increments. Press the TIMER button repeatedly to achieve your desired time setting. The LED lights will glow according to the setting, see chart.

# How To Convert To Tabletop



1



Remove the Plastic Caps from the top of the Chrome Rods.

2



Pull up the Adjustment Levers on both sides of the Fan, then slide the Fan up and off of the Chrome Rods to remove from the Stand.

3

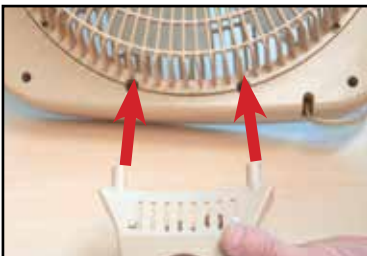

Insert the Tabletop Bracket into lower back of the fan and push up to attach. Push down and pull out to detach and remove.

# Cleaning

Before cleaning, make sure the fan is **UNPLUGGED**. ⚠ **WARNING: DO NOT immerse fan in water and never allow water to drip into the motor housing.**

Step 1:

Clean exterior with a soft damp cloth and mild detergent.

Step 2:

To clean interior: remove the Front Grill (see below), then wipe the blades and Grill with a soft damp cloth and mild detergent. **NOTE:** For cleaning only remove the Front Grill; **DO NOT** remove screws from the back of the fan.

## REMOVING FRONT GRILL

Unscrew Front Grill cover counterclockwise (a). Using a Phillips head screwdriver, **remove only the center screw** (b). Lift the Front Grill off the center post (c). Gently wipe blades (d). **DO NOT** bend blades.

Front Grill **MUST** be re-installed before operating fan.

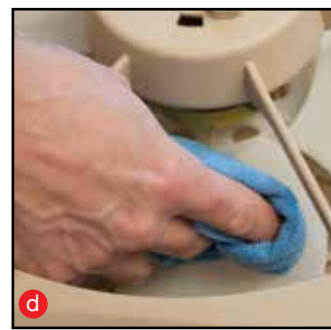
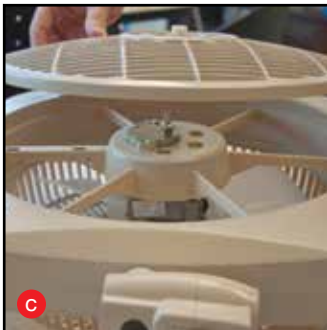
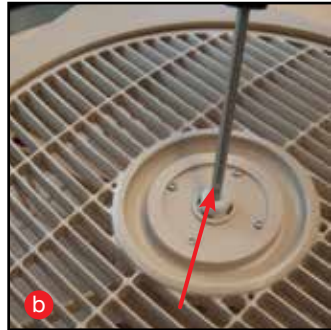
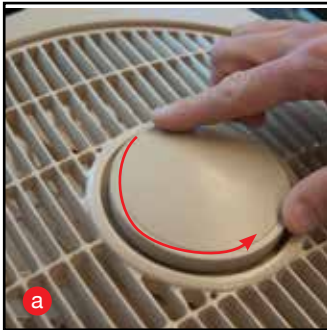

# SERVICING INSTRUCTIONS

READ AND SAVE THESE INSTRUCTIONS

## How To Replace The Fuse

**RISK OF FIRE: DO NOT** replace attachment plug. Contains a safety device (fuse) that should not be removed. Discard product if the attachment plug is damaged.

**Note:** Unplug fan before replacing the fuse. Grasp plug and remove from the receptacle or other outlet device. **DO NOT** unplug by pulling on cord.

1. Open fuse cover. Slide open the fuse access cover on top of plug toward blades.
2. Remove fuse carefully. Replace fuse only with 5 Amp max, 125 Volt fuse, not included.
3. Close fuse cover by sliding the fuse access cover closed.

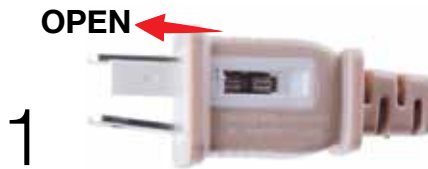

Open fuse cover.

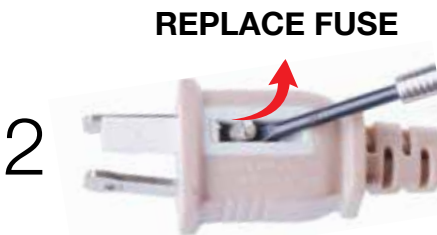

Remove fuse carefully.  
Replace fuse only with 5 Amp  
max fuse.

**(REPLACEMENT NOT INCLUDED)**

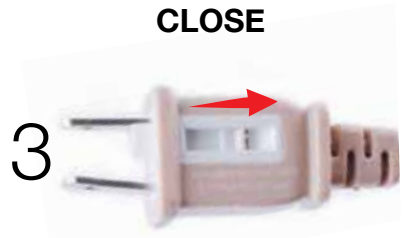

Close fuse cover by sliding the  
fuse access cover closed.



Try These Other Great  
Products For Your **Life!**

GREAT  
INNOVATIONS

Available at: [www.ForLifeProducts.com](http://www.ForLifeProducts.com), [www.Air-Innovations.com](http://www.Air-Innovations.com), [www.Pursfection.com](http://www.Pursfection.com)



*Pursfection*<sup>®</sup>



**Rejuvenate**<sup>®</sup>   
Make it **NEW** Again!



# 1-YEAR WARRANTY

AI-4400



Air Innovations® 12" SwirlCool™ 2-in-1 Fan with Cord Wrap comes with a 1-year manufacturer's warranty. If this unit should become defective within 1-year from the date of purchase, or if you have any questions or comments or regarding replacements for any of our products, please contact us directly at:

Call us toll free at: 844-600-1370  
Monday thru Friday 8:30 AM to 5:00 PM EST.  
Visit us on the web at: [www.Air-Innovations.com](http://www.Air-Innovations.com)  
e-mail us: [sales@air-innovations.com](mailto:sales@air-innovations.com)

Or write us:

Air Innovations  
Att: Quality Assurance Dept.  
2301 SW 145<sup>th</sup> Ave.  
Miramar, FL. 33027 USA

Please fill out the warranty card and  
mail back to the above address.  
Or, register your warranty online today.  
Simply go to:  
<http://www.Air-Innovations.com>

NAME \_\_\_\_\_

ADDRESS \_\_\_\_\_

CITY \_\_\_\_\_

STATE \_\_\_\_\_ ZIP \_\_\_\_\_

TELEPHONE \_\_\_\_\_

E-MAIL \_\_\_\_\_

DATE OF PURCHASE \_\_\_\_\_

PLACE OF PURCHASE \_\_\_\_\_

AI-4400 2016

Please check here if you would not like to receive any solicitations from our company

**THIS UNIT COMES WITH A 1-YEAR WARRANTY SUBJECT TO THE FOLLOWING CONDITIONS:**

In the first year, all repairs will be performed free of charge or the unit will be replaced. This warranty is not transferable, it is valid only for the original purchaser. This warranty will be voided if the unit is subjected to unauthorized repair or impact damage. If you have any questions please call toll free: 844-600-1370. This warranty gives you specific legal rights, and you may also have other rights which vary from state to state.

# Air INNOVATIONS<sup>®</sup>

Air Innovations<sup>®</sup> ©2016 Great Innovations, L.L.C. All Rights Reserved. US & International Patents Pending.

Available in a variety of colors

