

HOME
DECORATORS
COLLECTION®

Item # 1005559842
Model # JS-3429-C

Item # 1005535061
Model # JS-3429-A
Item # 1005559800
Model # JS-3429-B

USE AND CARE GUIDE

BRADSTONE WRITING DESK

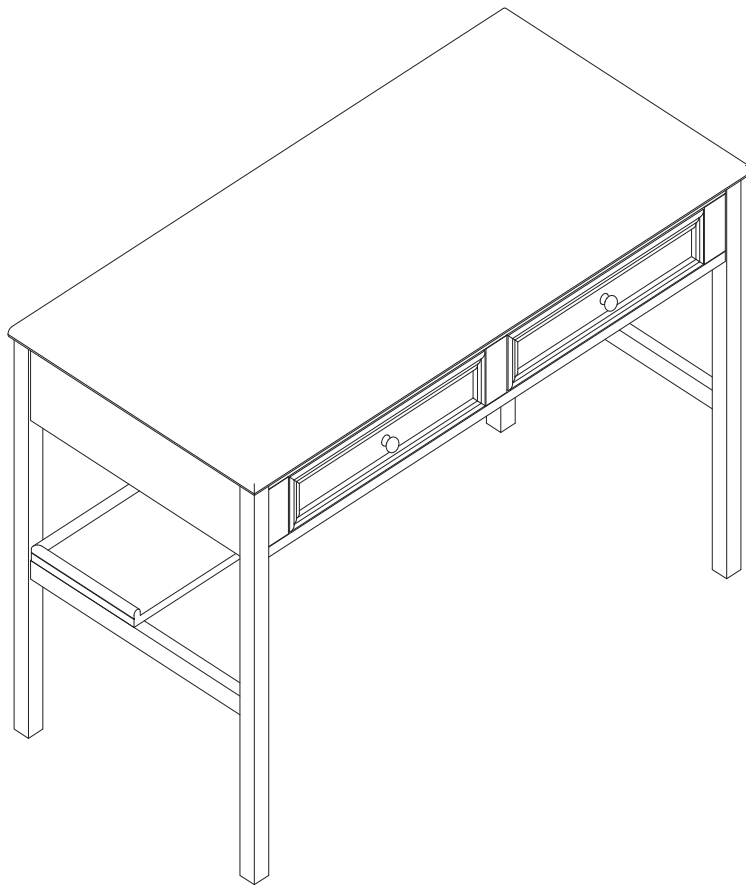

Questions, problems, missing parts? Before returning to the store,
call Home Decorators Collection Customer Service.
8 a.m.-7 p.m., EST, Monday-Friday, 9 a.m.-6 p.m., EST, Saturday

1-800-986-3460

HOMEDEPOT.COM/HOMEDECORATORS

THANK YOU

We appreciate the trust and confidence you have placed in Home Decorators Collection through the purchase of this Bradstone Writing Desk. We strive to continually create quality products designed to enhance your home. visit us online to see our full line of products available for your home improvement needs. Thank you for choosing Home Decorators Collection!

Table of Contents

Table of Contents	2	Pre-assembly (continued)	4
Safety Information	2	Package Contents.....	4
Pre-assembly	3	Assembly	5-8
Planning Assembly.....	3	Maintenance	9
Tools Required.....	3	Care and Cleaning	9
Hardware Included.....	3	Troubleshooting	9

Safety Information



DANGER

- Keep small parts away from children during assembly.
- Read and follow instructions carefully.



WARNING

- Read these instructions carefully and keep in a safe place.
- TO GUARANTEE THE SAFE USE OF THIS PRODUCT, FOLLOW THE WARNINGS, GUIDELINES AND RECOMMENDATIONS IN THIS MANUAL.
- Adult assembly required.
- Small parts may present choking hazard prior to assembly.
- Do not stand, step or climb on unit.



CAUTION

- Do not use power tools to assemble your item.
- Power tools may strip or damage parts/product.
- Do not over tighten connectors (screws,bolts,etc.) Overtightening can lead to product damage.
- Be sure to check all packing materials carefully for small parts that may have come loose inside the carton during shipment. If parts are missing, contact THE HOME DEPOT to obtain any missing parts.
- DO NOT USE SUBSTITUTE PARTS.
- This product should only be used on a flat, level surface.
- Assembly requires 2 people; assembly alone may cause injury.

Warranty

3 YEARS WARRANTY

WHAT IS COVERED

We guarantee this product to be free of manufacturing defects to the original purchaser for three years.

WHAT IS NOT COVERED

This warranty does not cover commercial use, acts of nature, and abusive use.

Pre-assembly

PLANNING ASSEMBLY

Keep children and pets away from build area. Make sure your area is large enough to unpack, sort and assemble the unit.

TOOLS REQUIRED

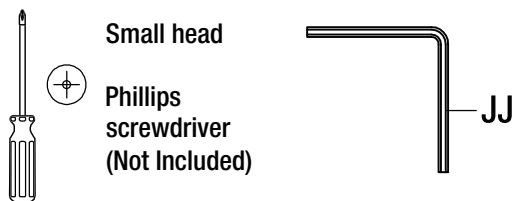

HARDWARE INCLUDED



NOTE: Hardware not shown to actual size.

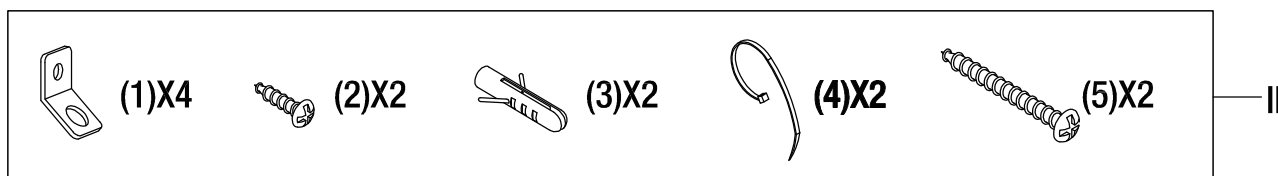
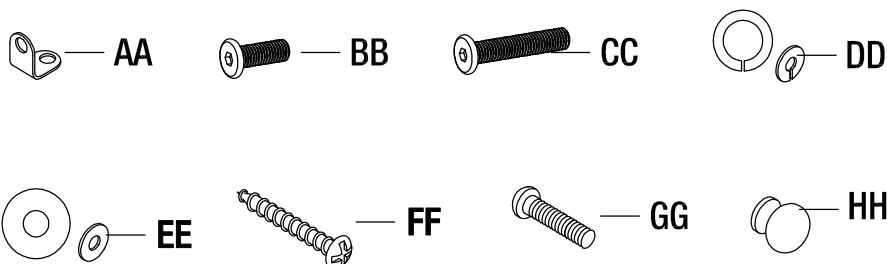

Part	Description	Quantity
AA	L shaped bracket	4
BB	Short hexagon socket screw	8
CC	Long hexagon socket screw	8
DD	Spring washer	16+2
EE	Flat gasket	16+2

Part	Description	Quantity
FF	Cross round head screw	4
GG	Cross round head bolt	2
HH	Handle	2
II	Anti-tipping hardware package	1
JJ	Spanner	1

Pre-assembly(continued)

PACKAGE CONTENTS

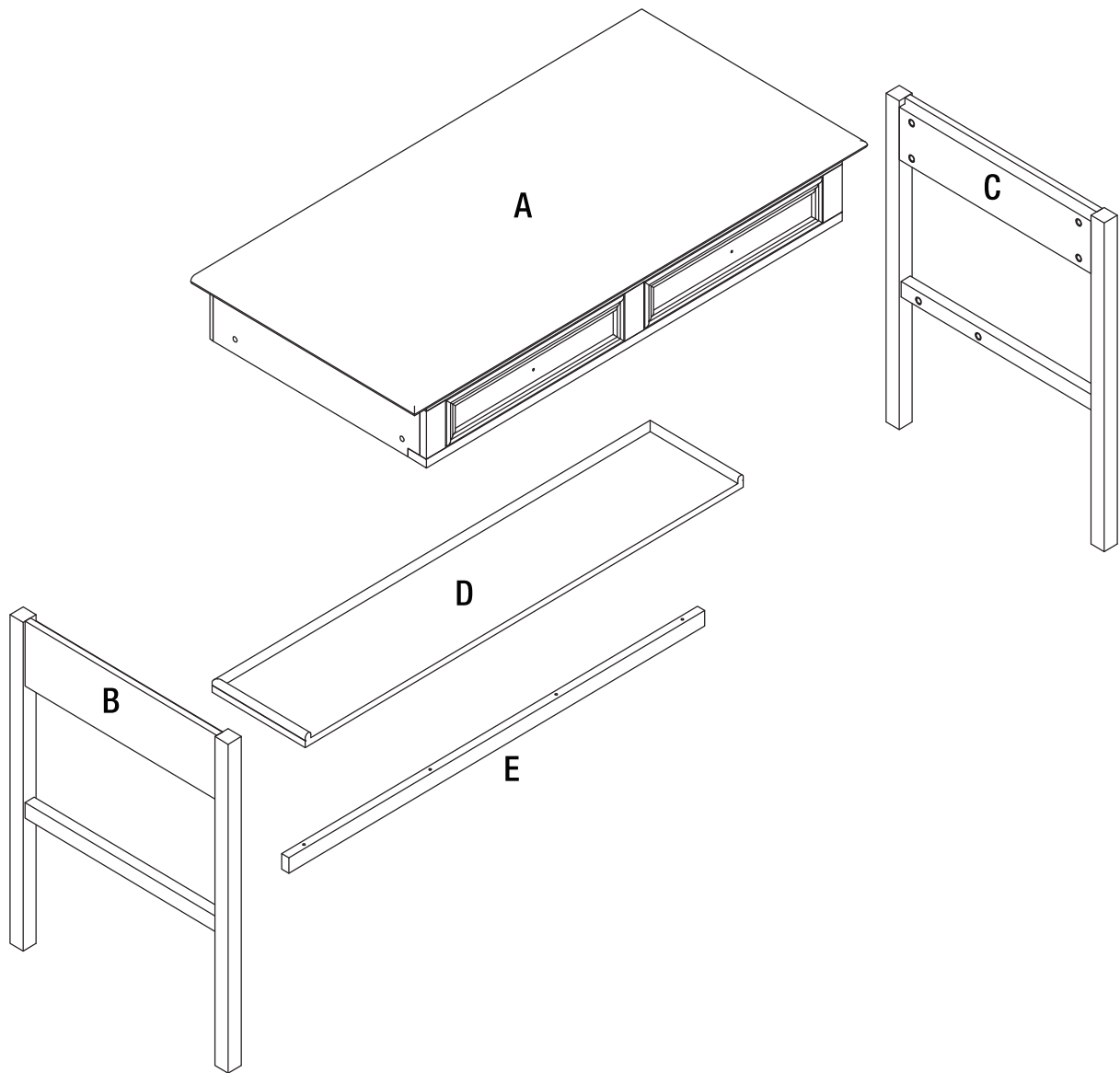

Part	Description	Quantity
A	Top panel	1
B	Left side panel	1
C	Right side panel	1
D	Fixed shelf	1
E	Shelf support	1

Assembly

1 Assemble L shaped bracket and shelf support

- a) Align L shaped bracket(AA) to holes on fixed shelf(D)

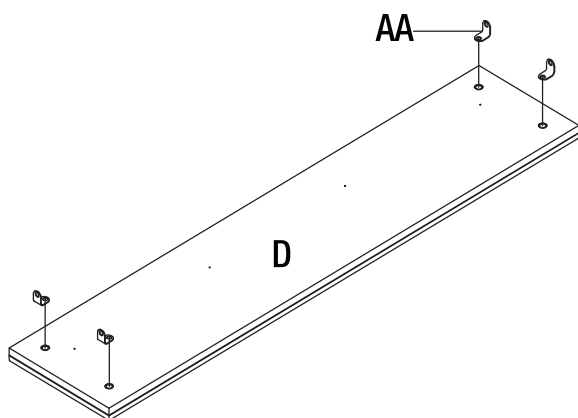

- b) Semi-fix L shaped bracket(AA) with short hexagon socket screw(BB)

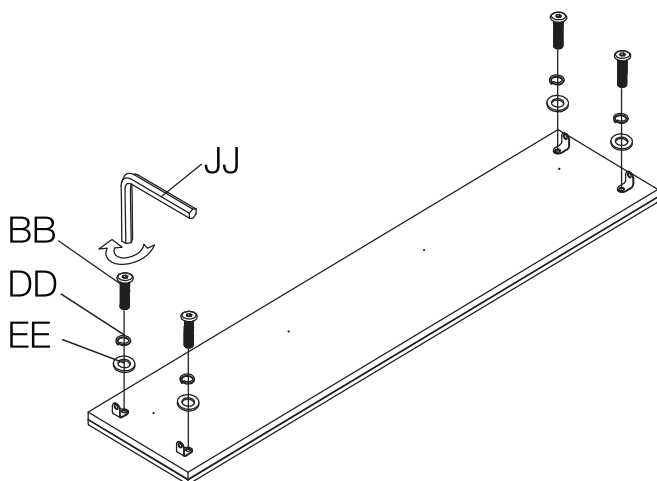

- c) Align shelf support(E) to holes on fixed shelf(D)

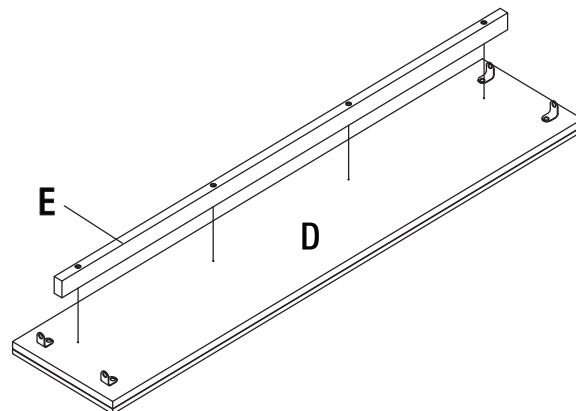

- d) Tightening shelf support(E) with cross round head screw(FF)

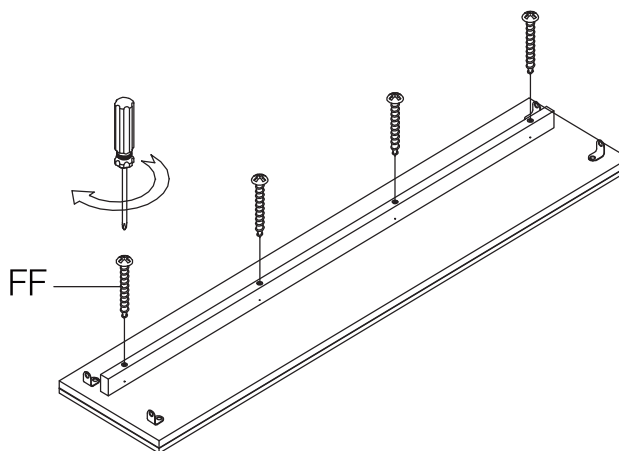

L shaped bracket

(AA)X4



Short hexagon socket screw

(BB)X4



Spring washer

(DD)X4



Flat gasket

(EE)X4



Cross round head screw

(FF)X4

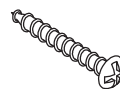

Small head

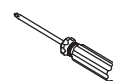

Spanner

(JJ)X1



Assembly

2 Assemble side panel & handle

□ a) Release drawers

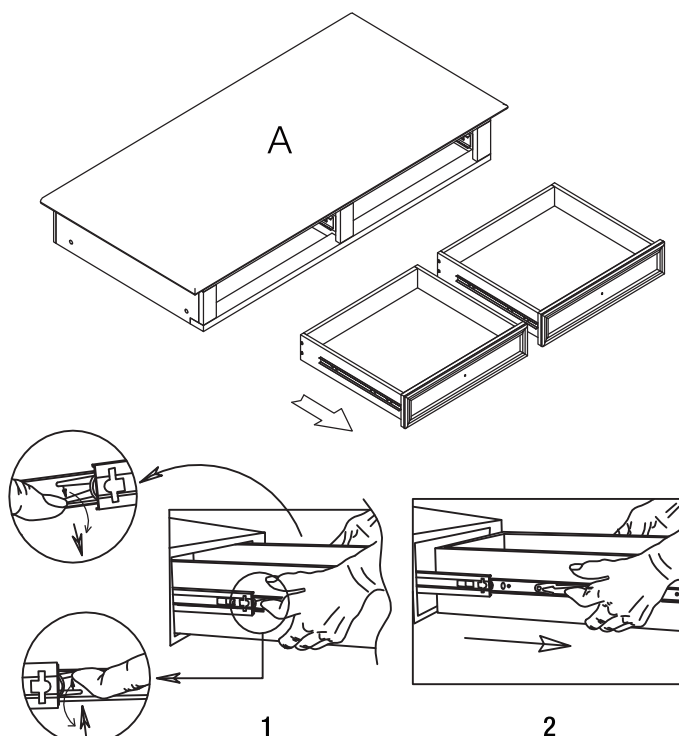

□ b) Assemble handle(HH) with cross round head bolt(GG)

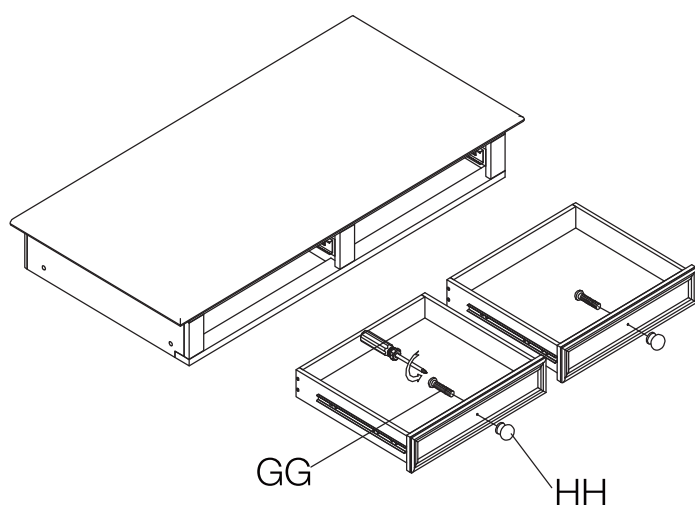

□ c) Align side panel(B/C) to holes

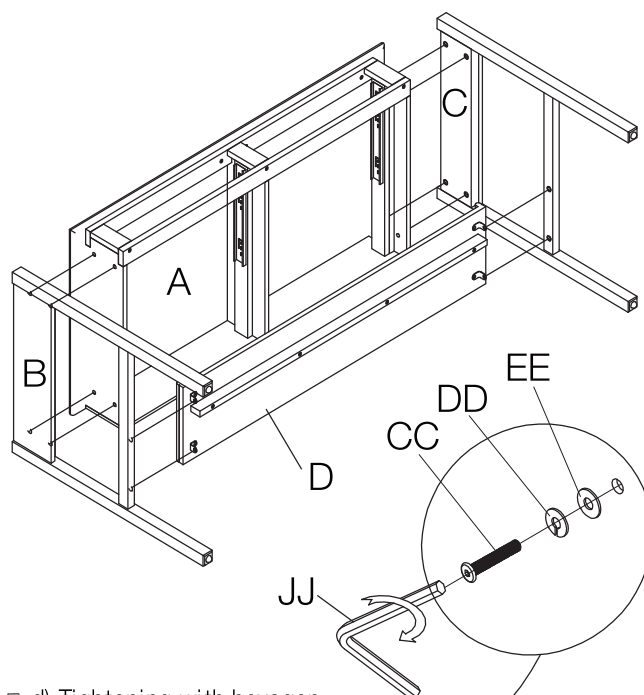

□ d) Tightening with hexagon socket screw

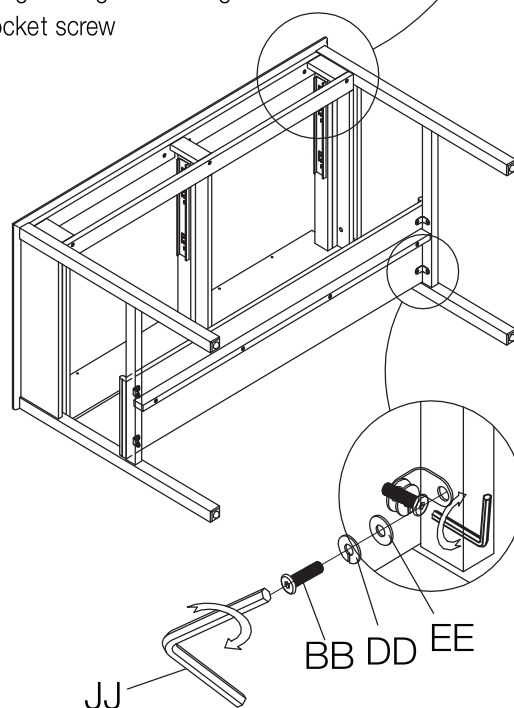

Cross round
head bolt

(GG)X2



Handle

(HH)X2



Short hexagon
socket screw

(BB)X4



Long hexagon
socket screw

(CC)X8



Spring washer

(DD)X12



Flat gasket

(EE)X12



Small head

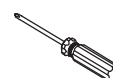

Spanner

(JJ)X1

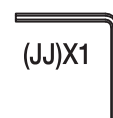

Assembly

3 Inserting the drawer

- Insert the drawer into the assembled body as shown.

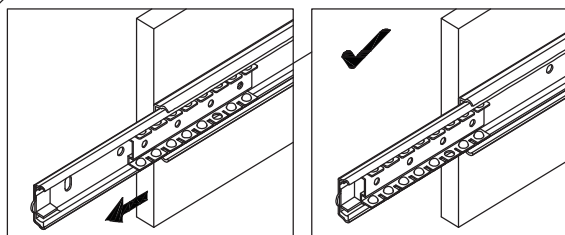

1. Pull out slide. Slide bearings forward

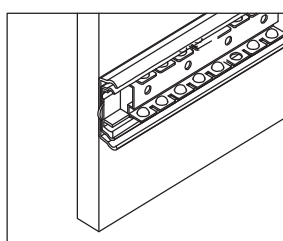

2. Push slide back inside.
Repeat for every slide!

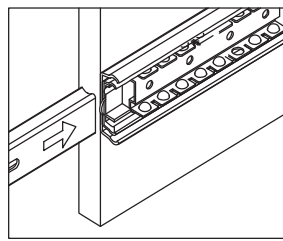

3. Insert into slide slot correctly,
push the drawer into the cabinet
body with even force

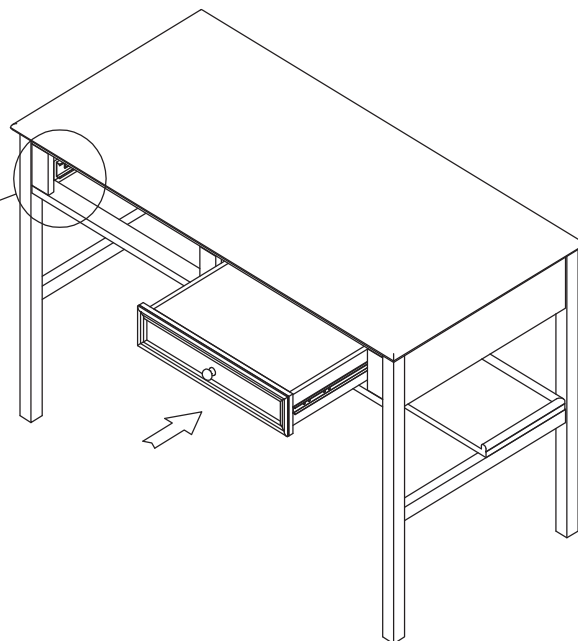

NOTE: Make sure the slide piece is at the front end of the glide when installing the drawer into the body.

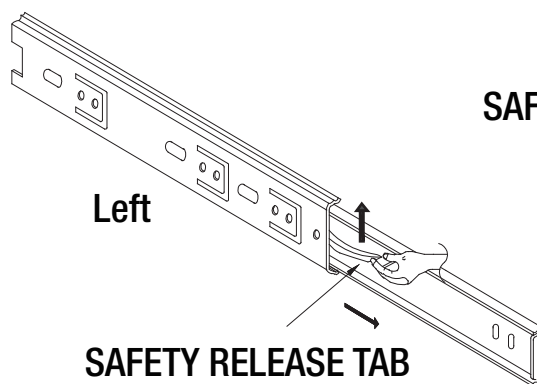

Left

SAFETY RELEASE TAB

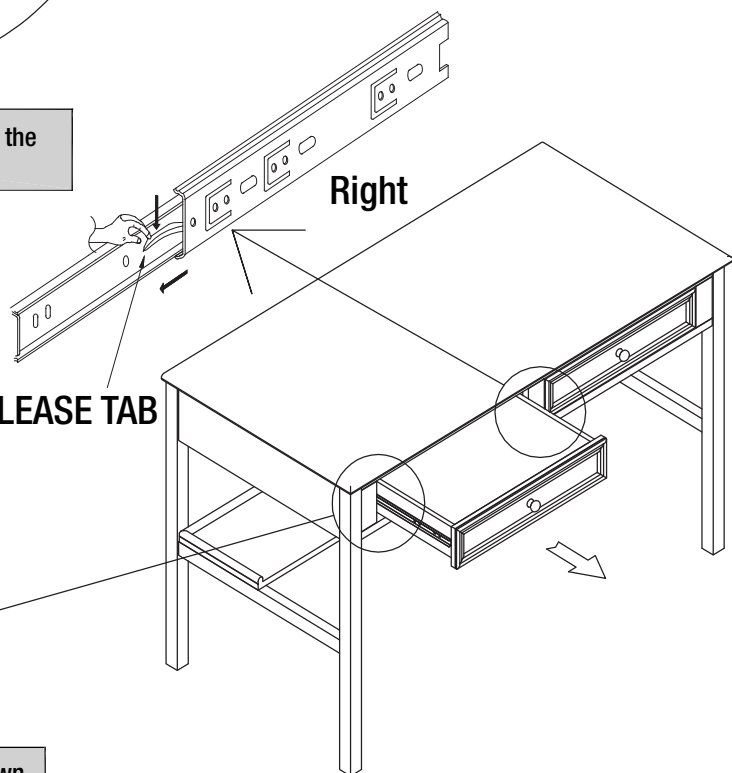

Right

SAFETY RELEASE TAB



NOTE: When removing the drawer, tip up and press down the safety release tab to remove the drawer from the body

Assembly

4 Adjust the foot leveler and assemble anti-tipping hardware package(II)

□ a) Adjust the foot leveler

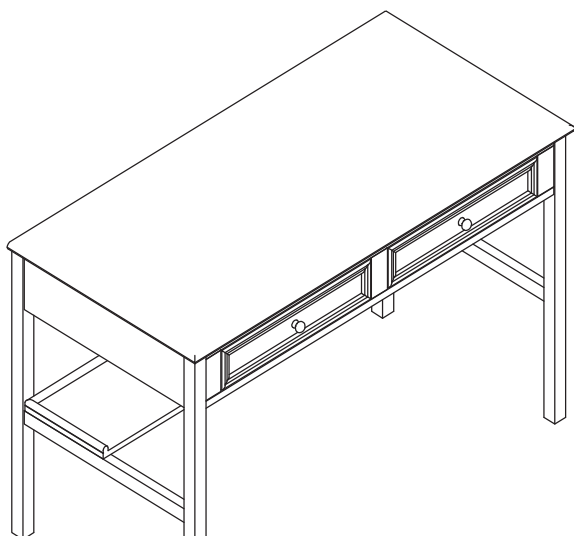

IF THE GROUND IS NOT EVEN THE SIDE BOARD WILL BE UNSTABLE OR THE DOORS UNSYMMETRICAL, YOU CAN ADJUST THE FOOT LEVELER UNDER THE LEG. TURN LEFT TO TIGHTEN, TURN RIGHT TO LOOSEN.

□ b) Lock the two hardware on the product and the other two hardware lock on the wall, then lock the product with a plastic band.

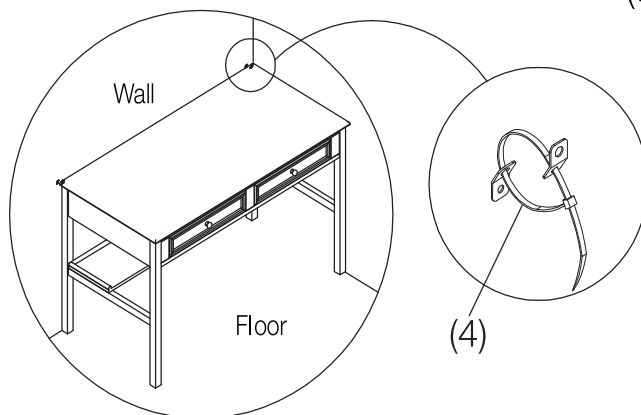
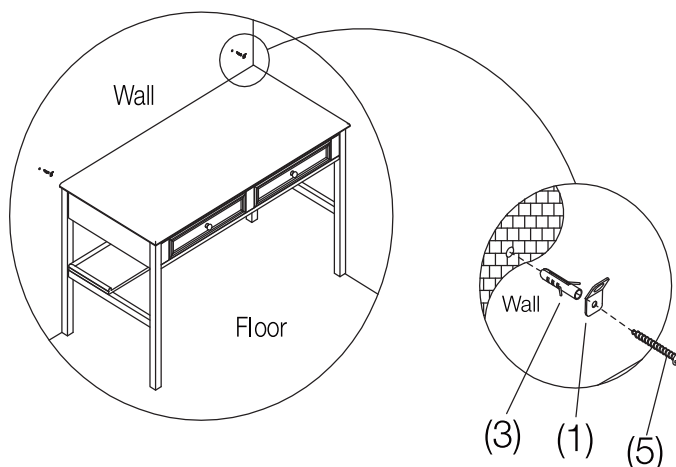
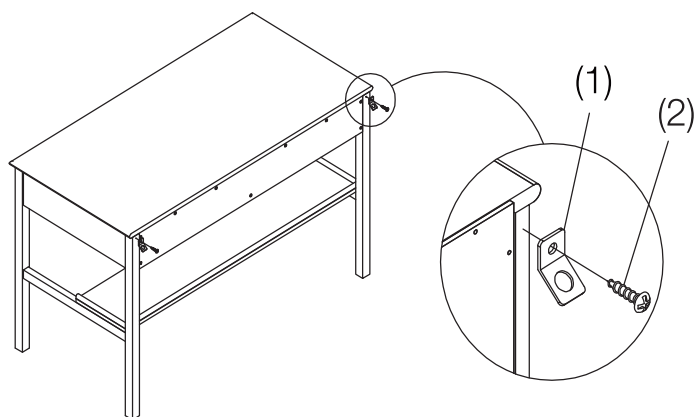

Rectangle
metal plate

(1)X4



0.63 in.Round
head screw

(2)X2



Plastic
anchor

(3)X2



Plastic
band

(4)X2



1.97 in.Round
head screw

(5)X2



Small head

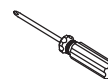

Maintenance

- If your furniture is stained or otherwise damaged during use, contact a professional for repairs.

Care and Cleaning

- Use a soft, clean cloth that will not scratch the surface when dusting.
- Use of furniture polishes is not necessary. Should you choose to use polishes, test the polish in an inconspicuous area before using over the entire surface of the product.
- Using solvents of any kind on your furniture may damage the finish.
- Never use water to clean your furniture as it may cause damage to the finish.
- Always use coasters under beverage glasses and flowerpots.
- Liquid spills should be remove immediately. Using a soft, clean cloth, blot the spill gently avoid rubbing.
- Always use protective pads under hot dishes and plates. Heat can cause chemical changes that may create spotting within the furniture finish.
- Use care as stains or marks from crayons or ink markers will be difficult to remove.
- Be sure to immediately clean red wine or soda stains within 30 minutes or the surface will stain.

Troubleshooting

PROBLEMS	SOLUTIONS
Not all of the product's legs touch the floor	Make sure adjustable center feet levelers are adjusted properly. The levelers are pre-assembled on the bottom of the legs
Glide can not be assembled	Make sure the slide piece is at the front end of the glide when installing the drawer into the body
Drawer can not be removed	When removing the drawer, tip up and press down the safety release tab to remove the drawer from the body.

The logo for Home Decorators Collection is centered within a dark gray rectangular box. The word "HOME" is in a large, white, serif font. Below it, "DECORATORS" is in a smaller, white, serif font. At the bottom, "COLLECTION®" is in an even smaller, white, sans-serif font.

HOME DECORATORS COLLECTION®

Questions, problems, missing parts?
Before returning to the store, call Home Decorators Collection Customer Service.
8 a.m. – 7 p.m., EST, Monday – Friday, 9 a.m. – 6 p.m., EST, Saturday

1-800-986-3460

HOMEDEPOT.COM/HOMEDECORATORS

Retain this manual for future use.