

# Installation Instructions

## UltraBright Path Light

### MB590

**Thank you** for purchasing the Mr Beams® UltraBright Path Light. We are committed to eliminating darkness using the latest in Light-Emitting Diodes (LEDs). LEDs are the most efficient and durable light sources available. We are certain that your light will contribute to a safer environment and provide light where you need it at a very reasonable cost.

#### What is included:

- 2 Motion Sensor Path Lights
- 2 Stakes

#### What you need to install:

- 4 C-Cell Alkaline Batteries (per light)

#### Path Light Features:

**Motion/Light Sensor:** The Path Light instantly turns on when it detects motion from up to 10 feet away. The light sensor conserves battery life by preventing the light from activating in daylight.

**Auto Shut-off:** Path Light shuts off automatically after 30 seconds if no motion is detected.

**Bright LED:** 80 Lumens covers up to 180 sq ft.

**Durable, Weather Resistant:** Tight seals and UV resistant material allow the light to work in all weather conditions.

#### Tips:

- Use only new alkaline C-Cell batteries with 1.5V rating.
- Do not mix old and new batteries. If batteries are not new, it may cause the light to malfunction.
- Install batteries with polarity in correct position.
- Light may activate when batteries are inserted. Simply take light into a dark room, allow batteries to settle, then test activation.
- **If your light will not turn off, it means that it is time to replace the batteries.**

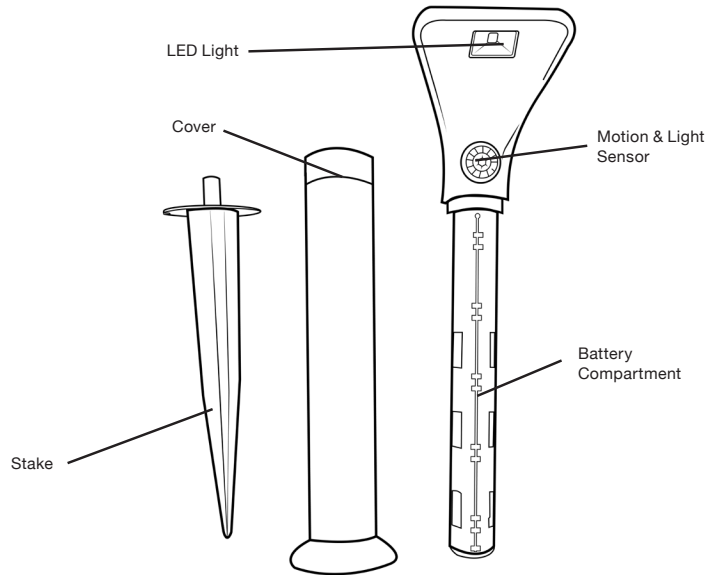

**NOTE: Light sensor only allows light to activate in darkness. We recommend you test in a dark room or closet.**

#### Battery Installation

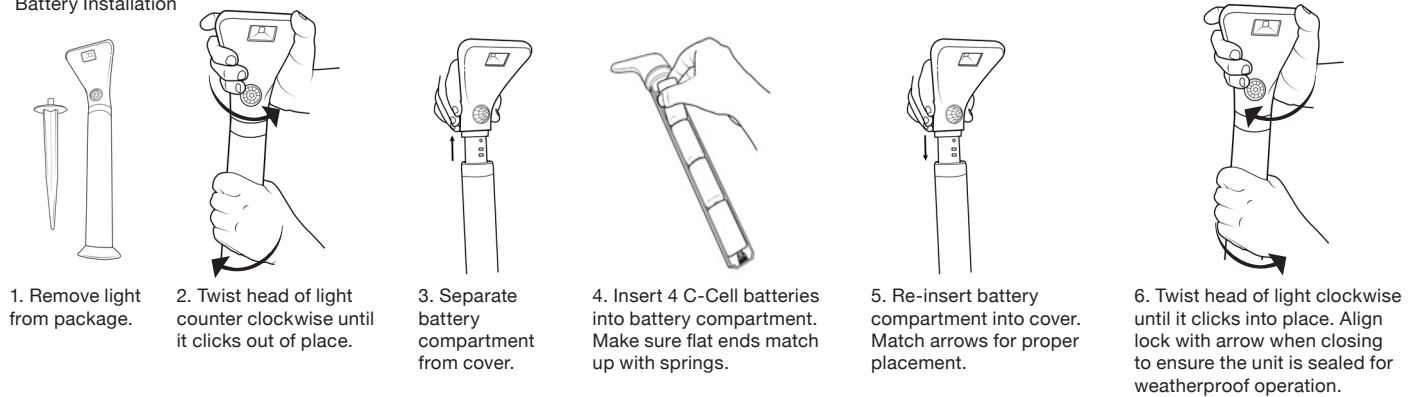

#### Mounting with Stake

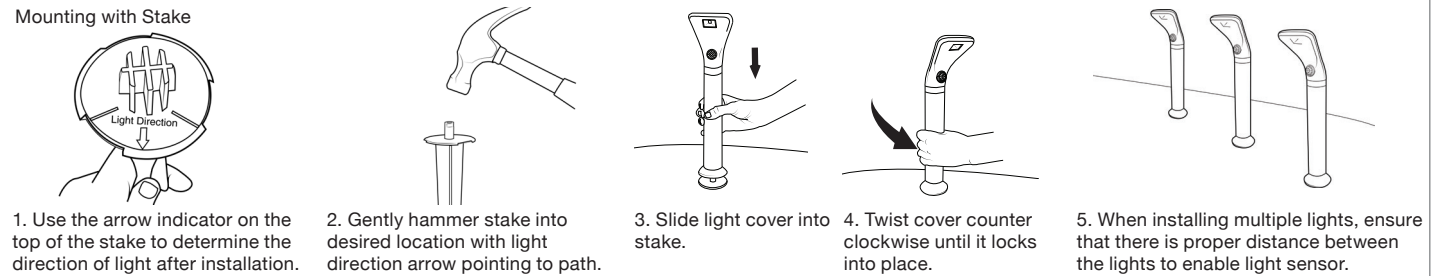

#### Battery Caution:

- 1) Do not mix old and new batteries
- 2) Do not mix Alkaline, Standard (Carbon-Zinc) or Rechargeable (Nickel Cadmium) or (Nickel Metal Hydride) batteries
- 3) Do not dispose of batteries in fire
- 4) Batteries should be recycled or disposed of as per state and local guidelines

**MR BEAMS®**  
Surprisingly Bright Light Anywhere  
www.mrbeams.com

\* Visit our website to view installation video.  
\* 1 year limited warranty. Visit site for details.  
600 Beta Drive, Unit 100, Mayfield Village, OH 44143  
877.298.9082

