

Attention please:

**Improper use of screws may cause the product surface damage!
Please be careful when installing.**

To prevent you from confusing the accessories and boards, Please do not mix the parts of different units when you buy two or more products at the same time.

READ AND SAVE THIS INSTRUCTIONS FOR FUTURE USE

ASSEMBLY & INSTRUCTION MANUAL



WARNING:

Please read this manual carefully before using the product. Failure to do so may result in serious injury.

ASSEMBLY PRECAUTIONS

1. Assemble only according to these instructions. Improper assembly can create hazards.
2. Wear ANSI-approved safety goggles and heavy-duty work gloves during assembly.
3. Keep the assembly area clean and well-lit.
4. Keep bystanders out of the area during assembly.
5. Do not assemble when tired or when under the influence of alcohol, drugs or medication.
6. The product capabilities apply to properly and completely assembled products only.
7. Assemble on a flat, level, hard and smooth surface capable of safely supporting the Rattan Console Table.
8. For additional information regarding the parts listed in the following pages, please refer to the Assembly Diagram of this manual. Unwrap and separate all parts in a clean work area.

SAVE THESE INSTRUCTIONS

USE PRECAUTIONS

TO PREVENT SERIOUS INJURY AND DEATH FROM TIPPING:

1. This product is not a toy Do not allow children to play with or near this item.
2. Do not exceed weight capacities, before moving.
3. Use only on a flat, level, hard and smooth surface capable of safely supporting a fully loaded Rattan Console Table.
4. Use as intended only.
Inspect before every use; do not use if parts are loose or damaged.

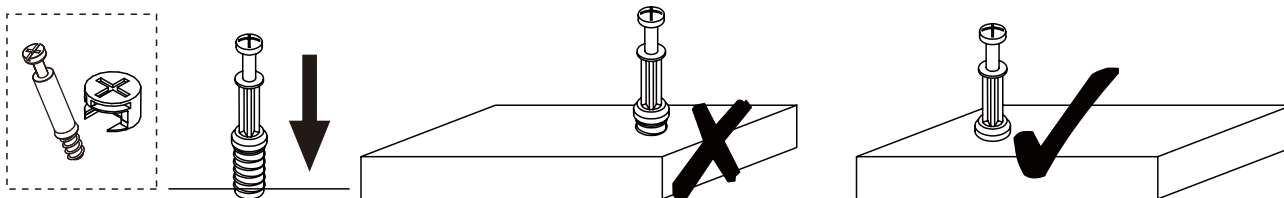

QUICKFIT: Tighten quickfit until shoulder is flush with panel. Do not overtighten or undertighten.

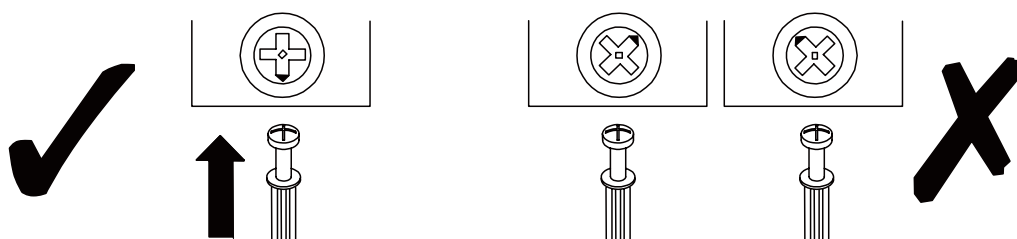

CAMLOCK: When fitting cam lock, ensure starting position is correct before you insert connecting quickfit.

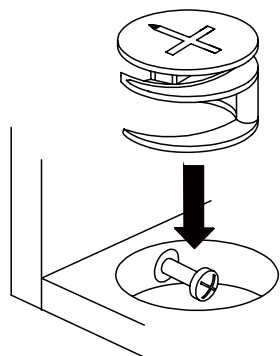

Quickfit head should be in the centre of the cam lock when the two panels are joined. Cam lock should be inserted before quickfit.

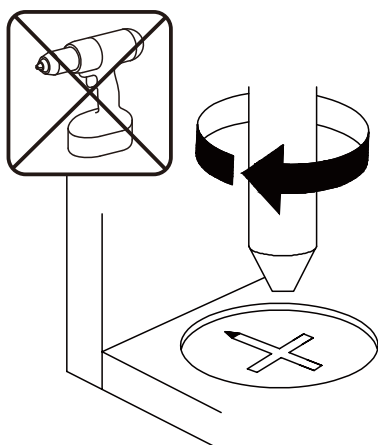

Turn cam lock clockwise to tighten.

NOTE DIFFERENT MODELS

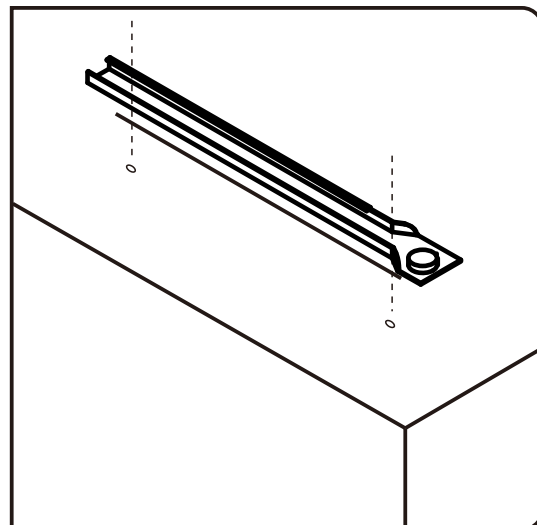
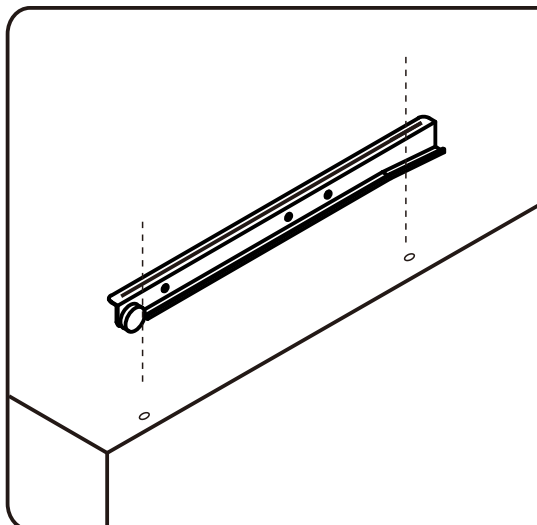
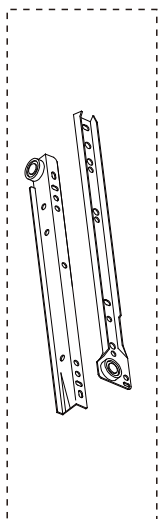

Please find the exact hole for installation, otherwise it will be misaligned. The screws on the drawer slide must be leveled, otherwise it will affect the smoothness of the drawer.

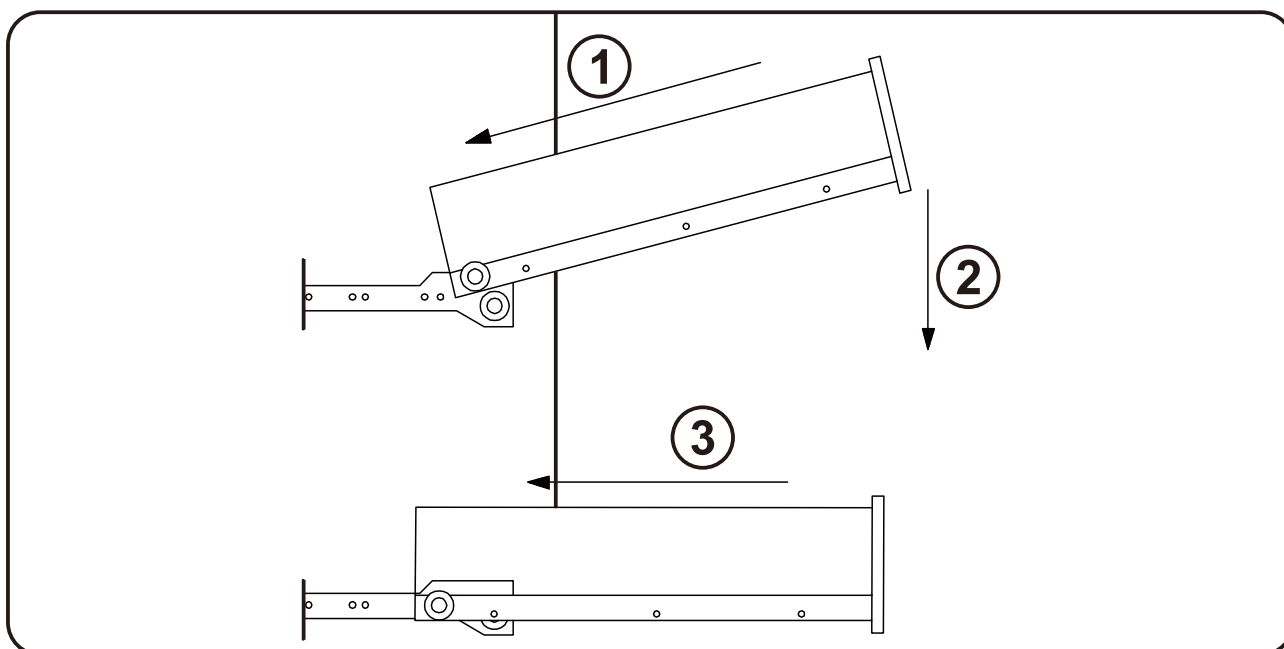

Be careful to push in the board when the both sides slide way been aligned.

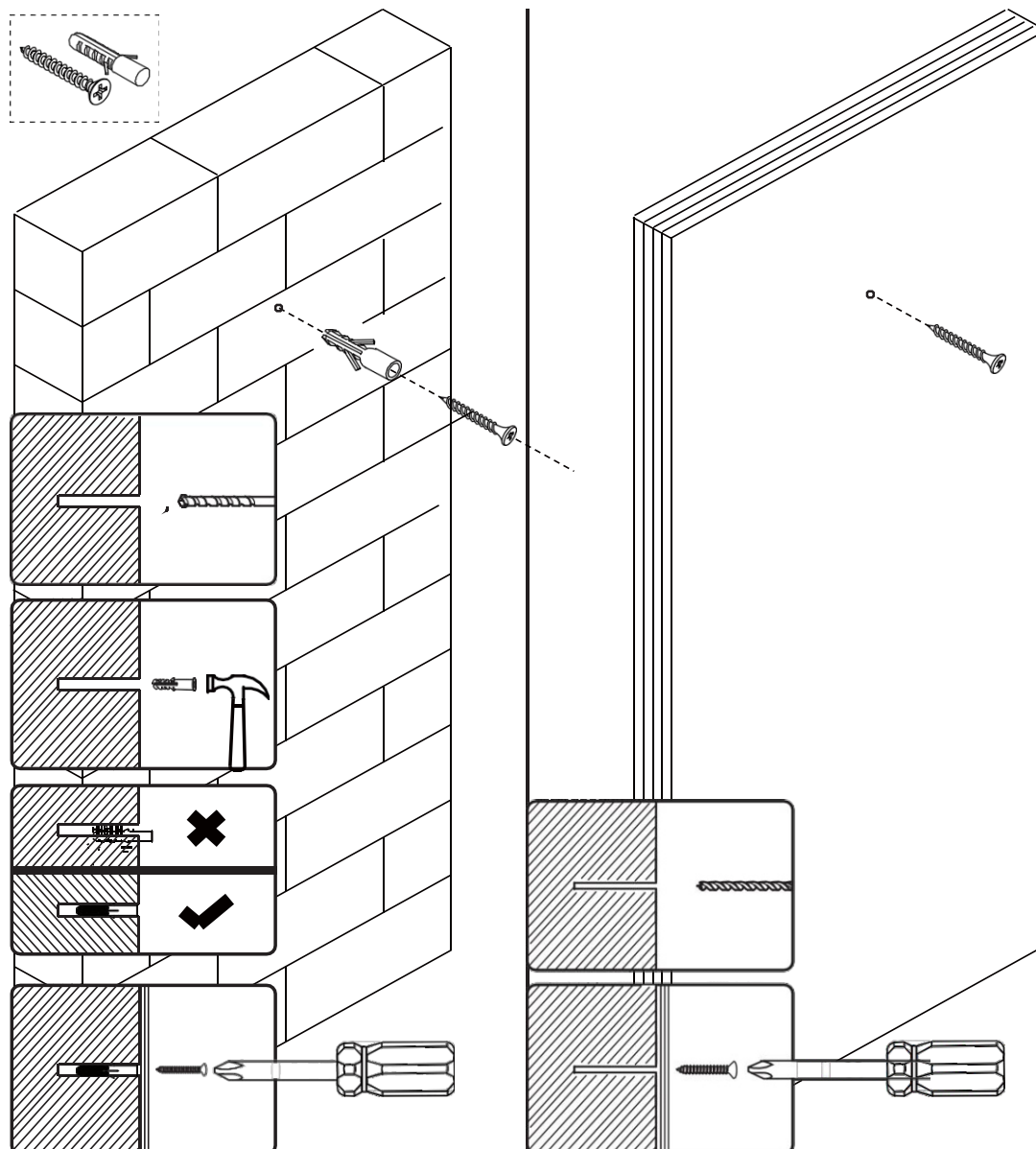

If it is a solid wall, please use expansion and self-tapping screws, if it is a wooden wall, only use self-tapping screws, please do not overtighten the screws.

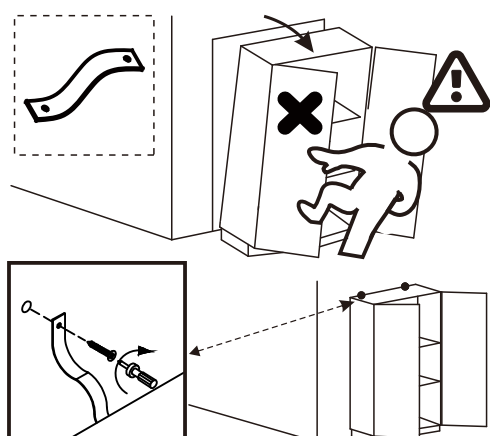

This is anti-dumping belt that fix the product to the wall and it can be used or not follow your needs.

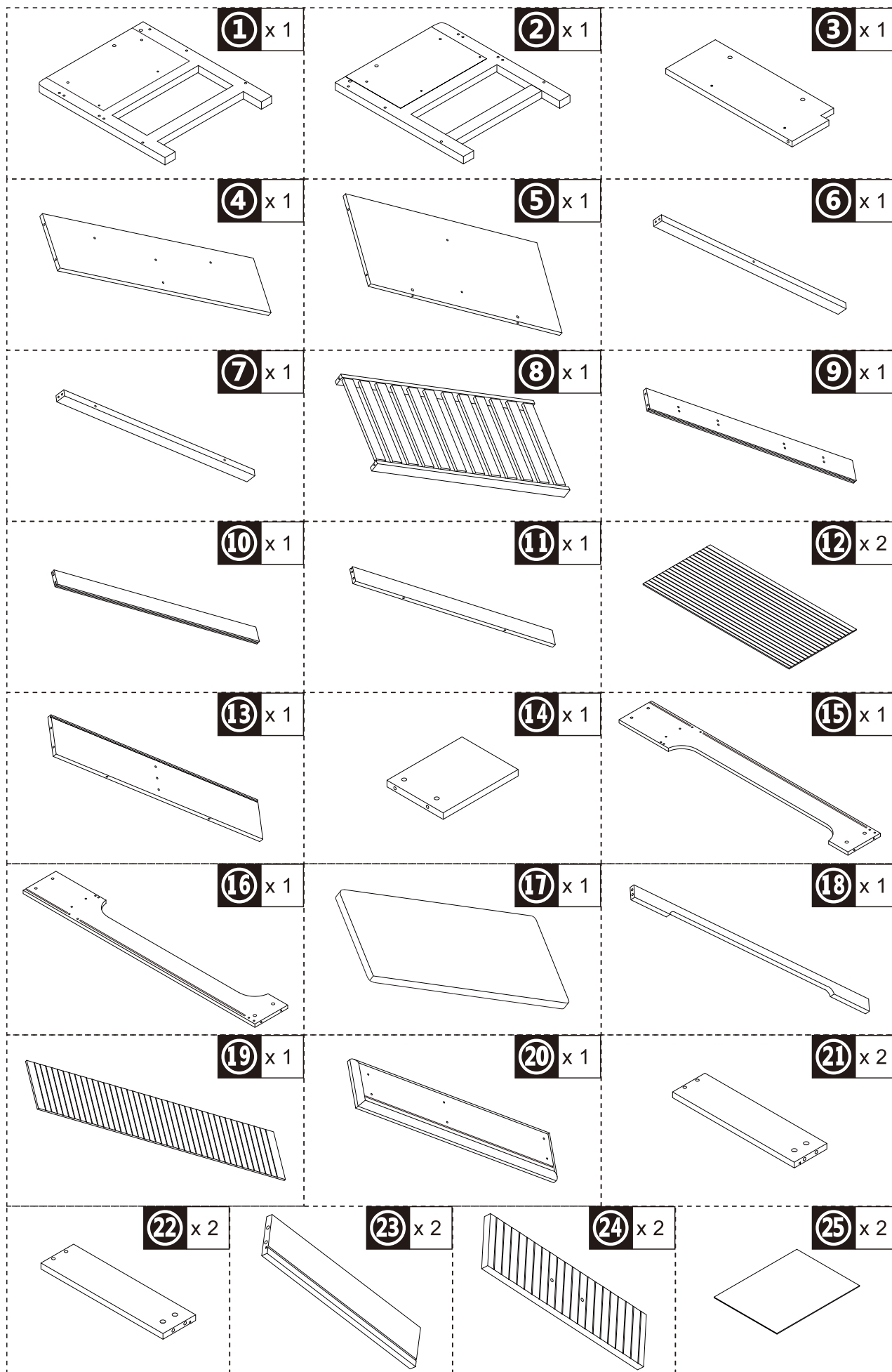

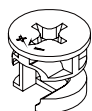
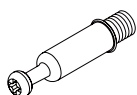
A x42**B** x34**C** x21**D** x12

M6*55

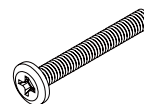
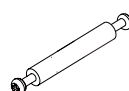
**E** x12**F** x16M3.5*12
+1(spare)**K** x 4**L** x13

M4*35

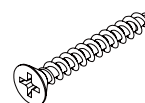
**M** x 2**N** x 4

M3*14

**O** x 1

M4*12

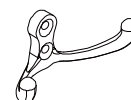
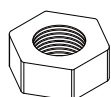
**P** x 4**Q** x 8**R** x 8

M4*30

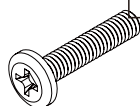
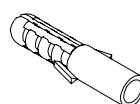
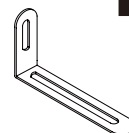
**S** x 1**T** x 1**U** x 1

M4*40

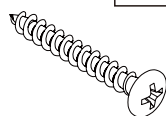
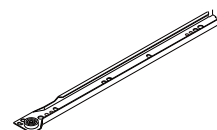
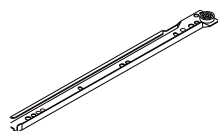
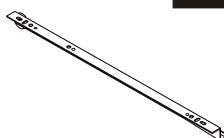
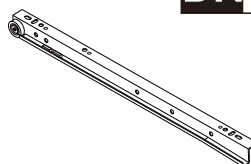
**V** x10**W** x32**CL** x 2**CR** x 2**DL** x 2**DR** x 2

F	x 8
CL	x 2
CR	x 2

01

This hole

This hole

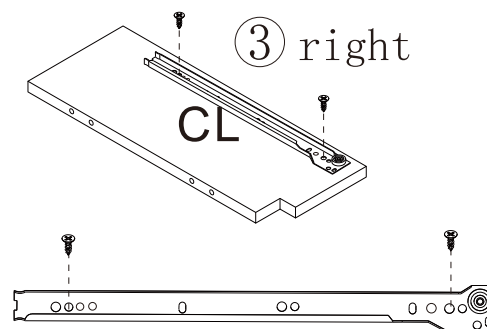
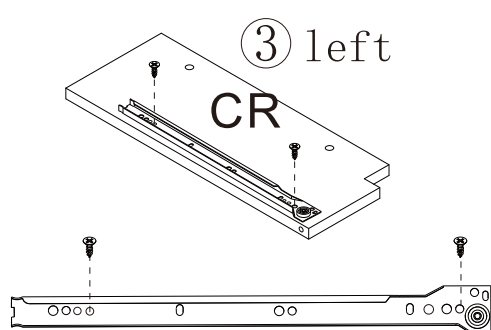
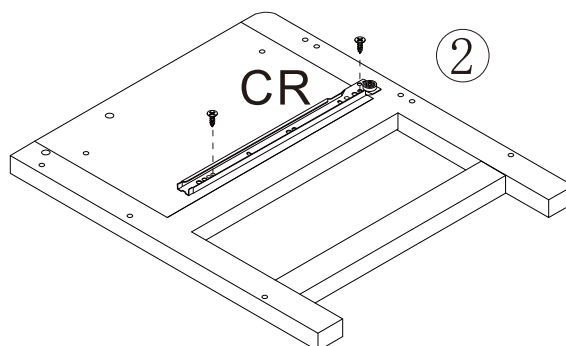
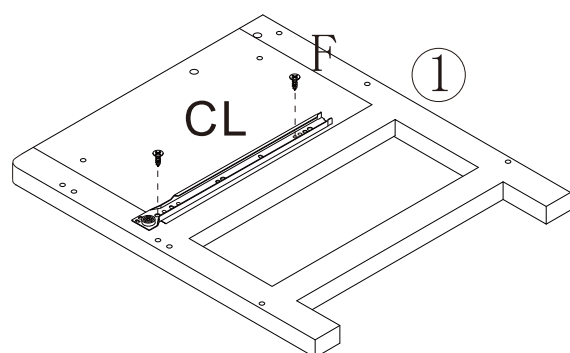

L x 2

02

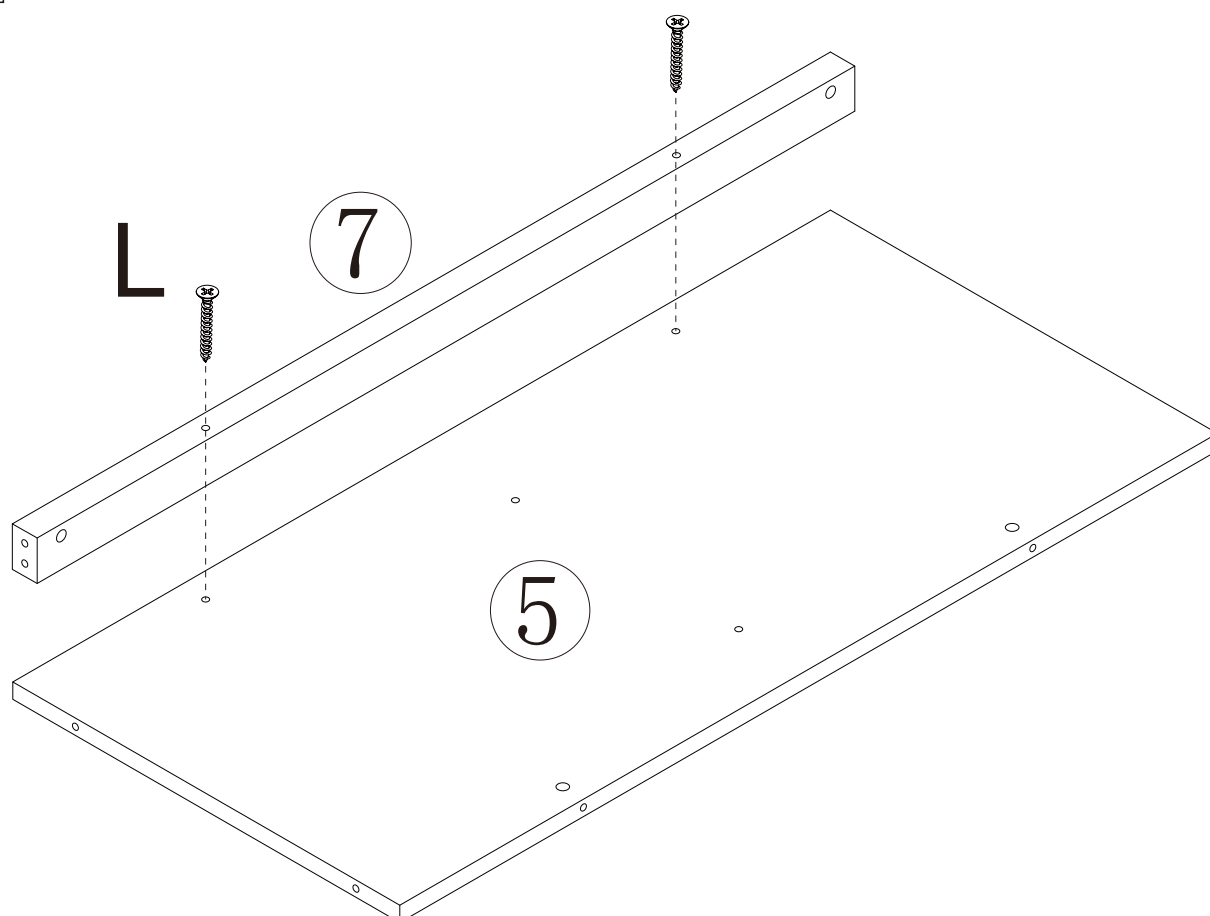

A	x 2
B	x 2

03

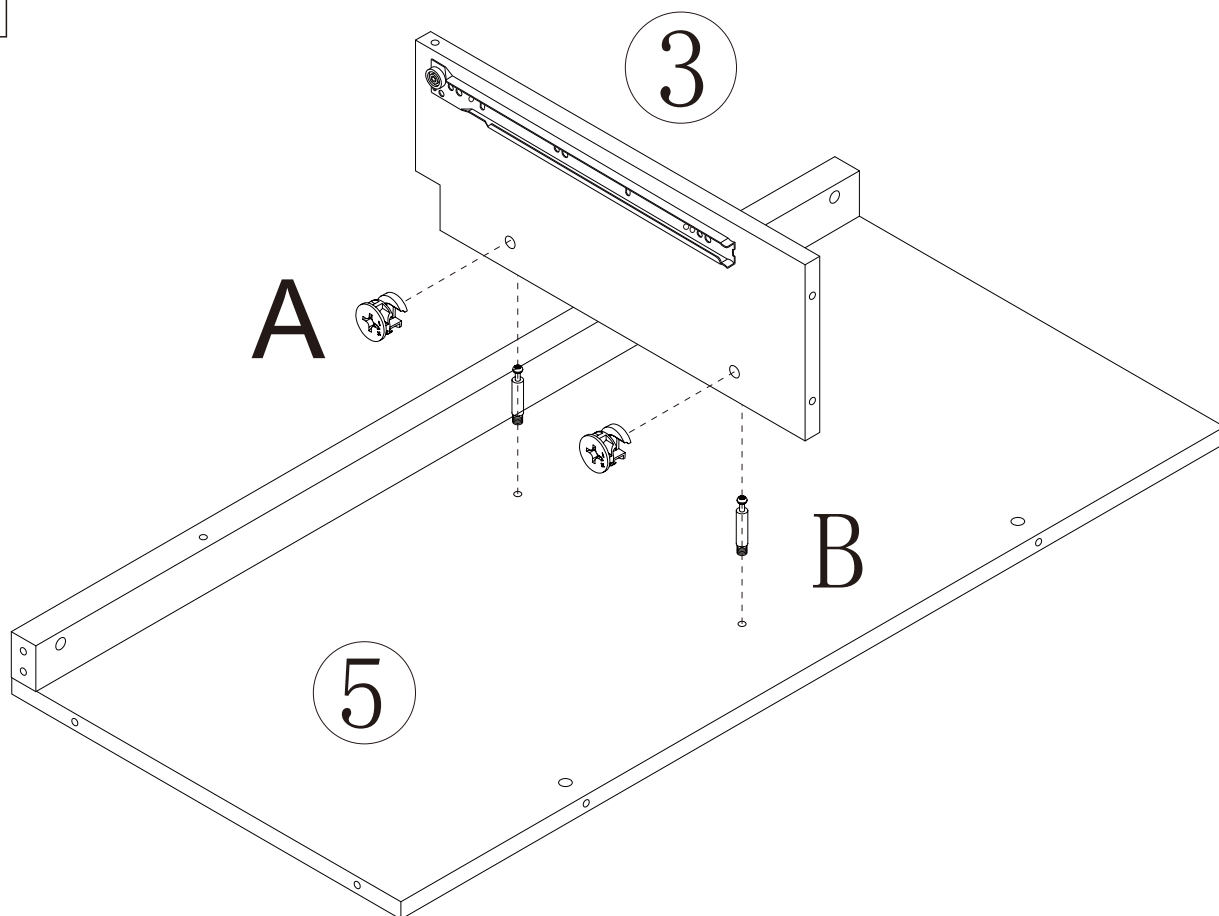

A	x 2
B	x 2
L	x 2

04

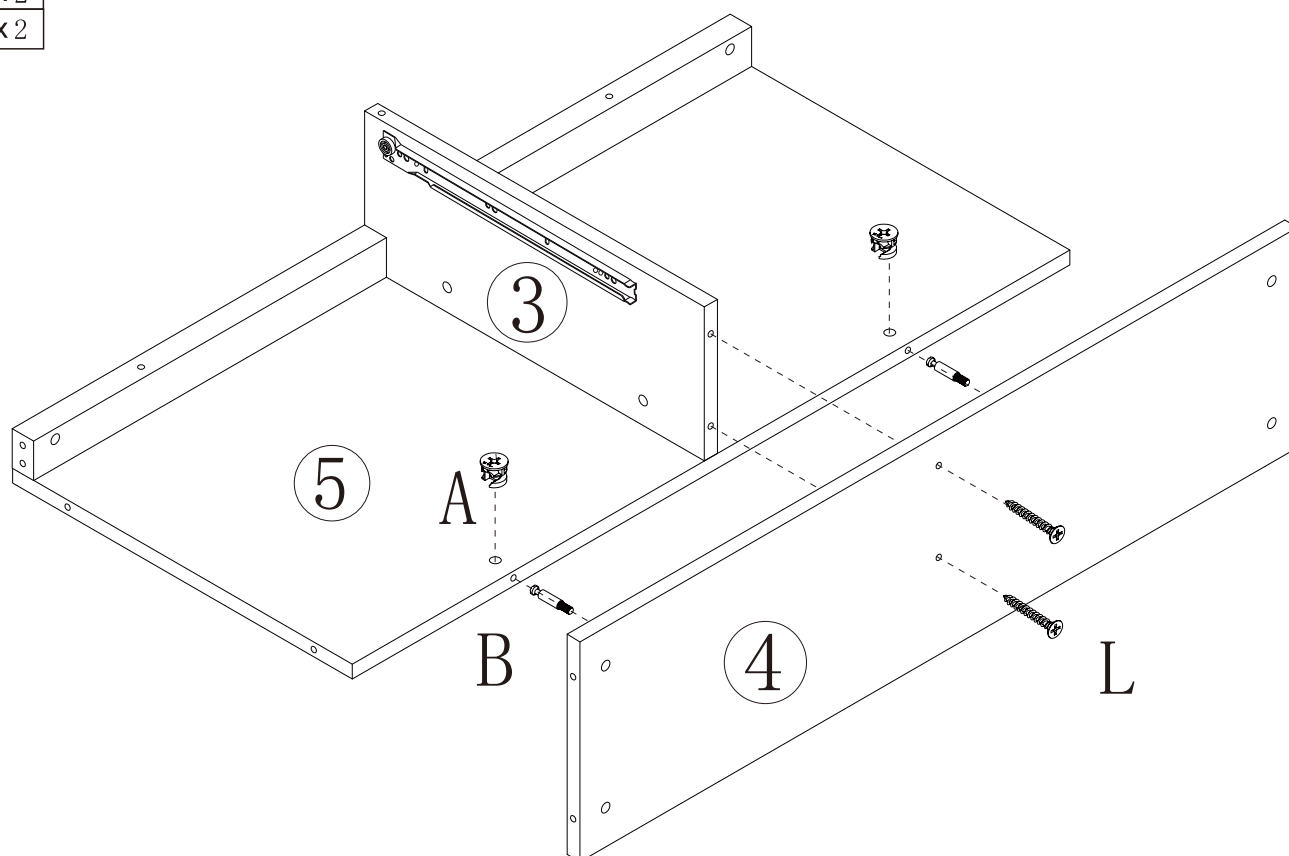

C x 1

05

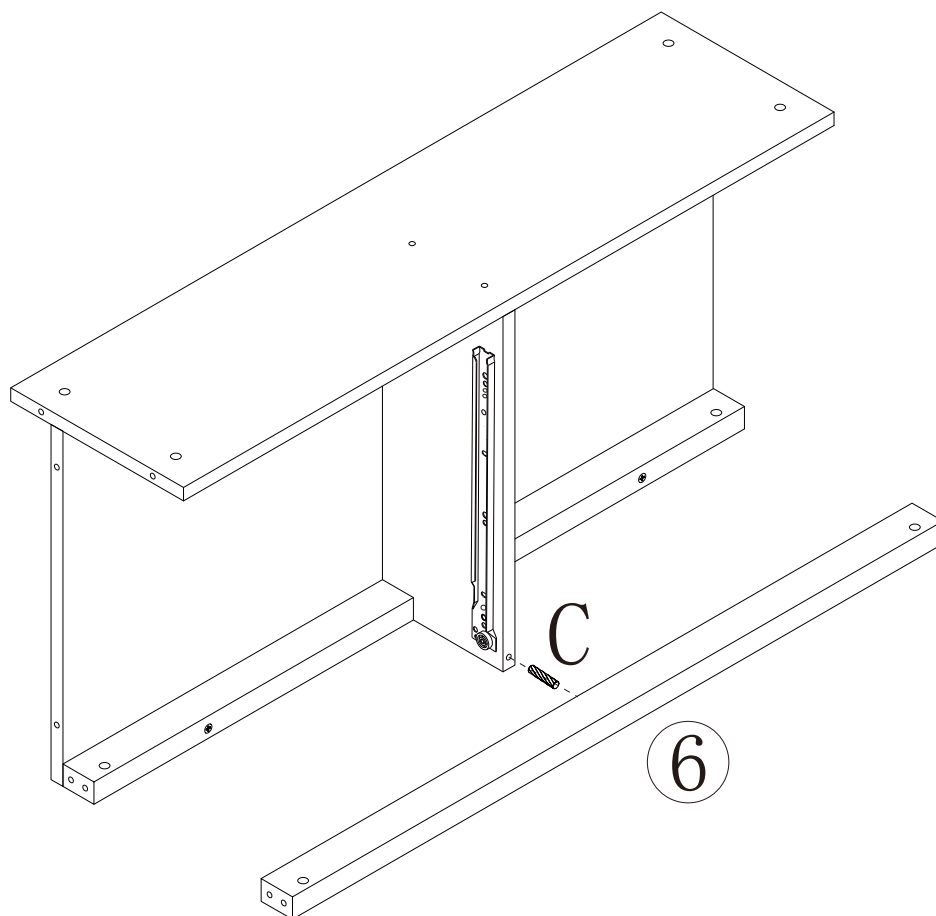

C x 4
D x 4
E x 4
W x 4

06

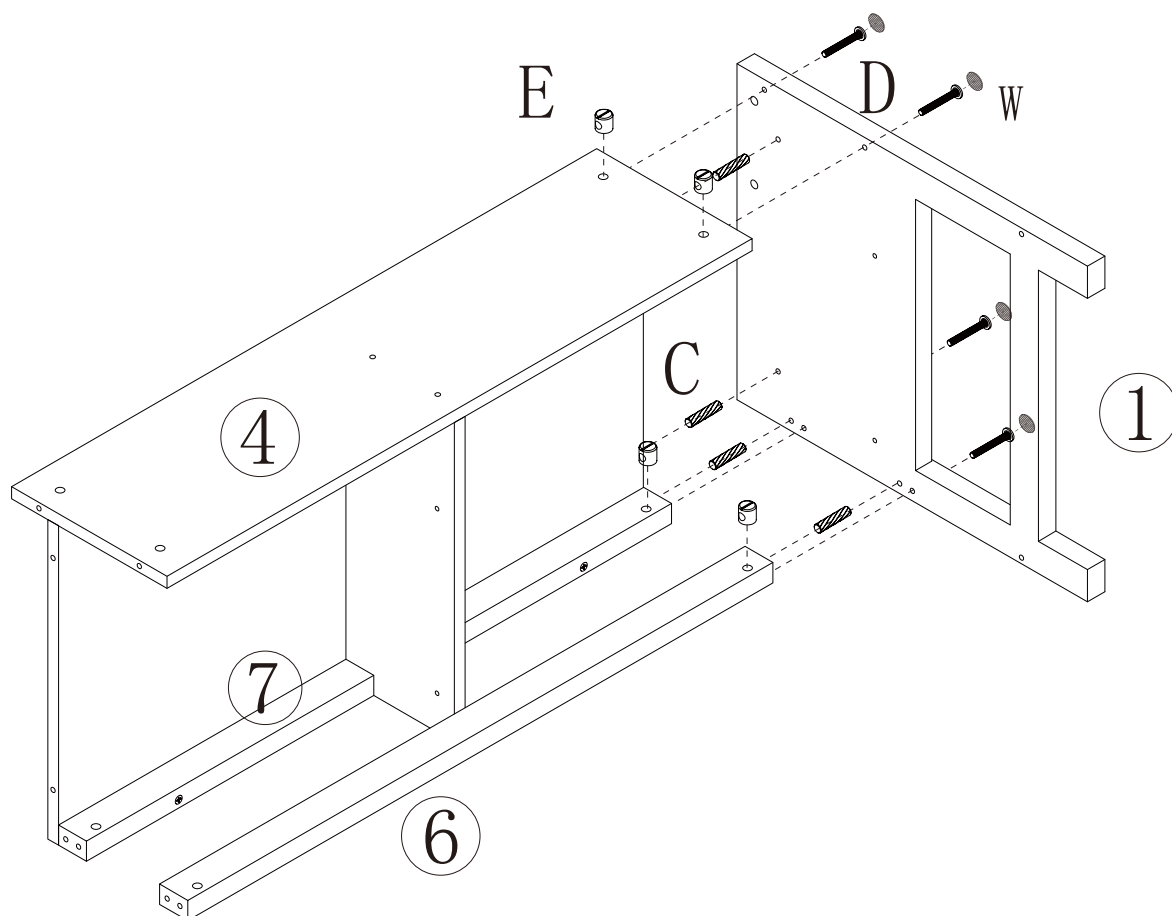

D	x 2
E	x 2
W	x 2

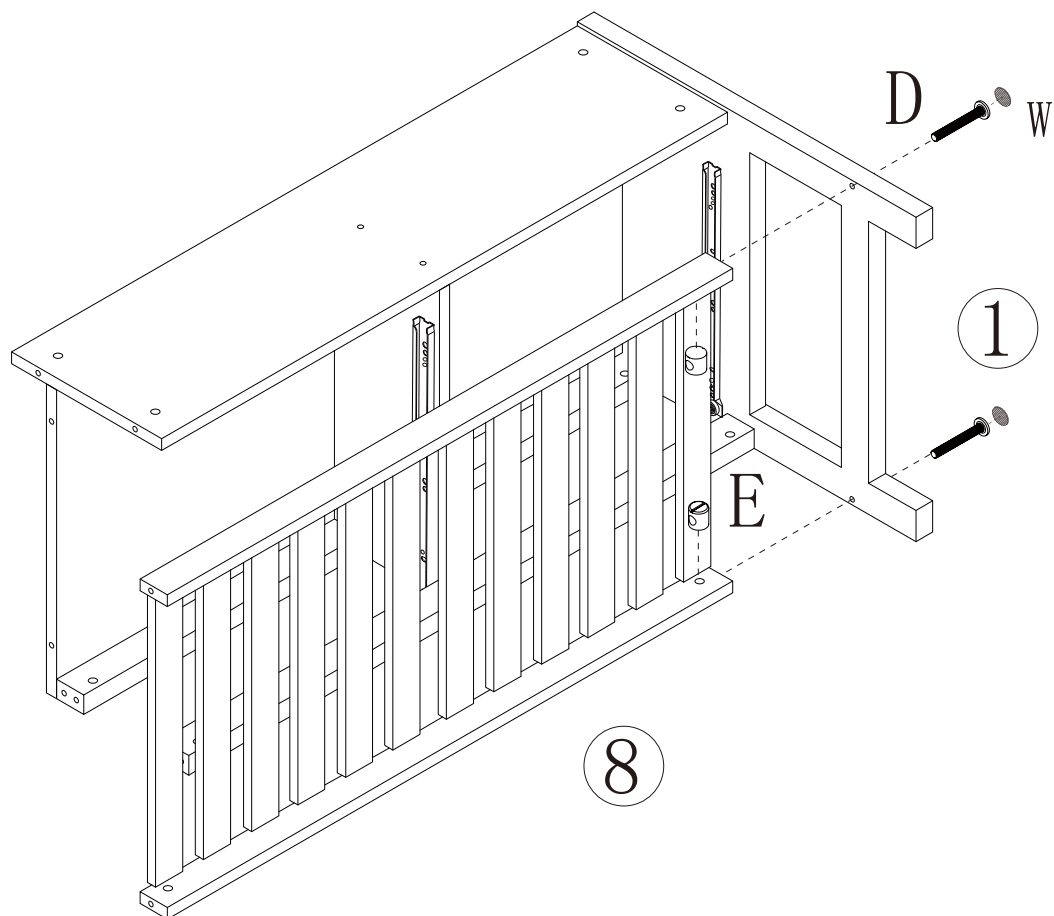

C	x 4
D	x 6
E	x 6
W	x 6

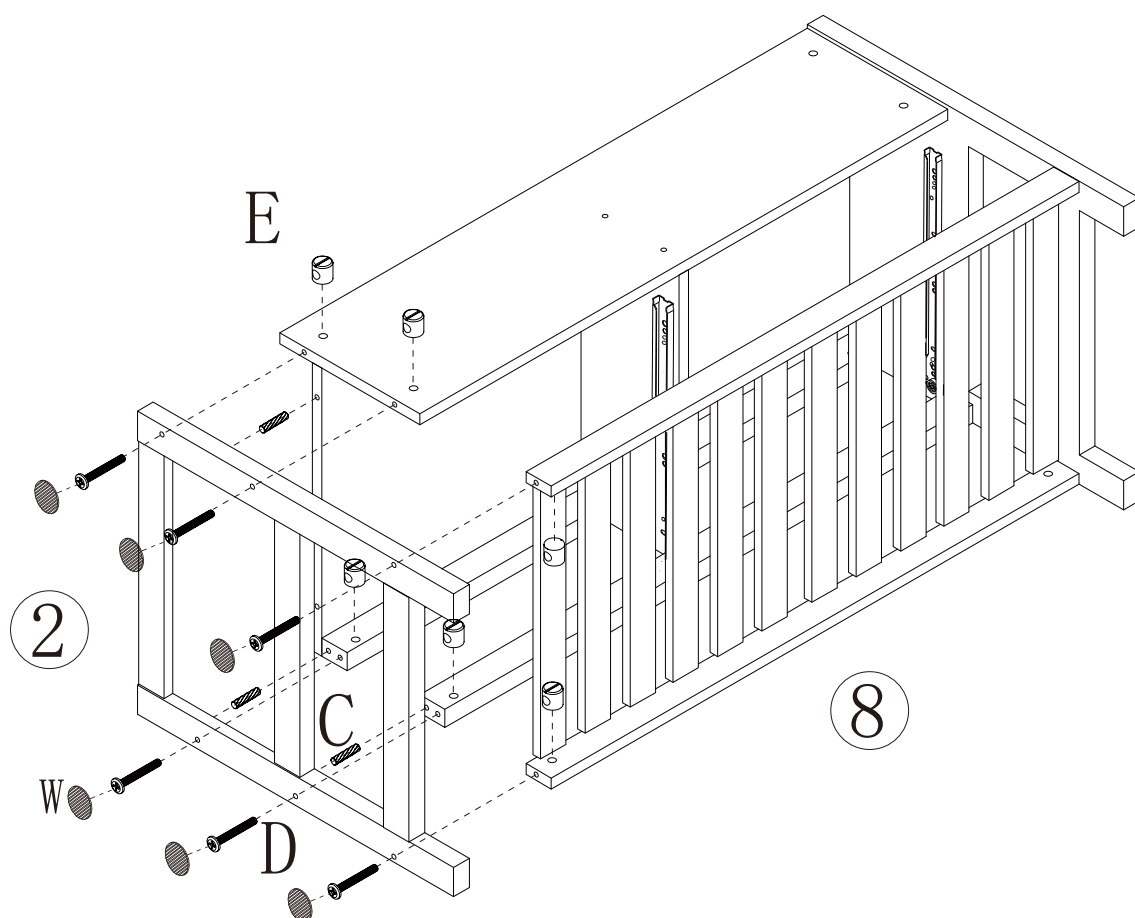

A	x 2
B	x 2
W	x 2

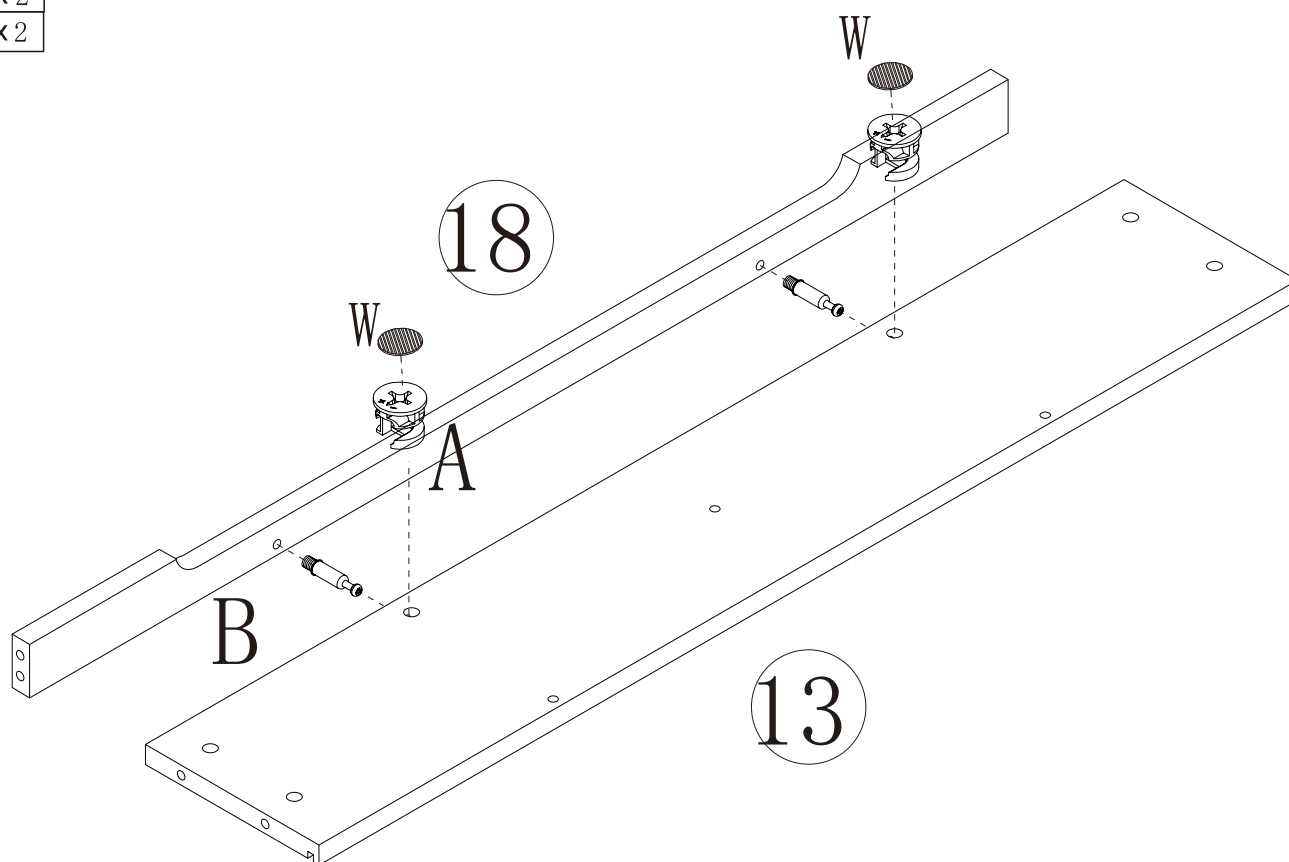

A	x 2
B	x 2
P	x 4
Q	x 8
R	x 8
V	x 8

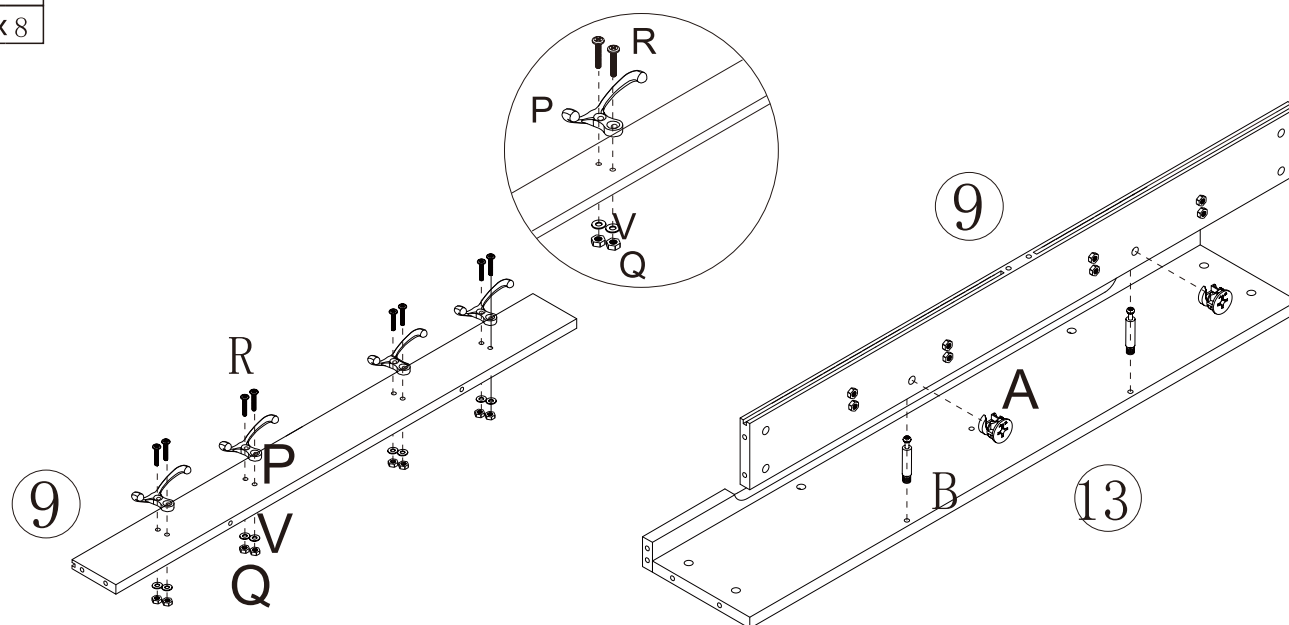

C	x 2
L	x 1

11

14

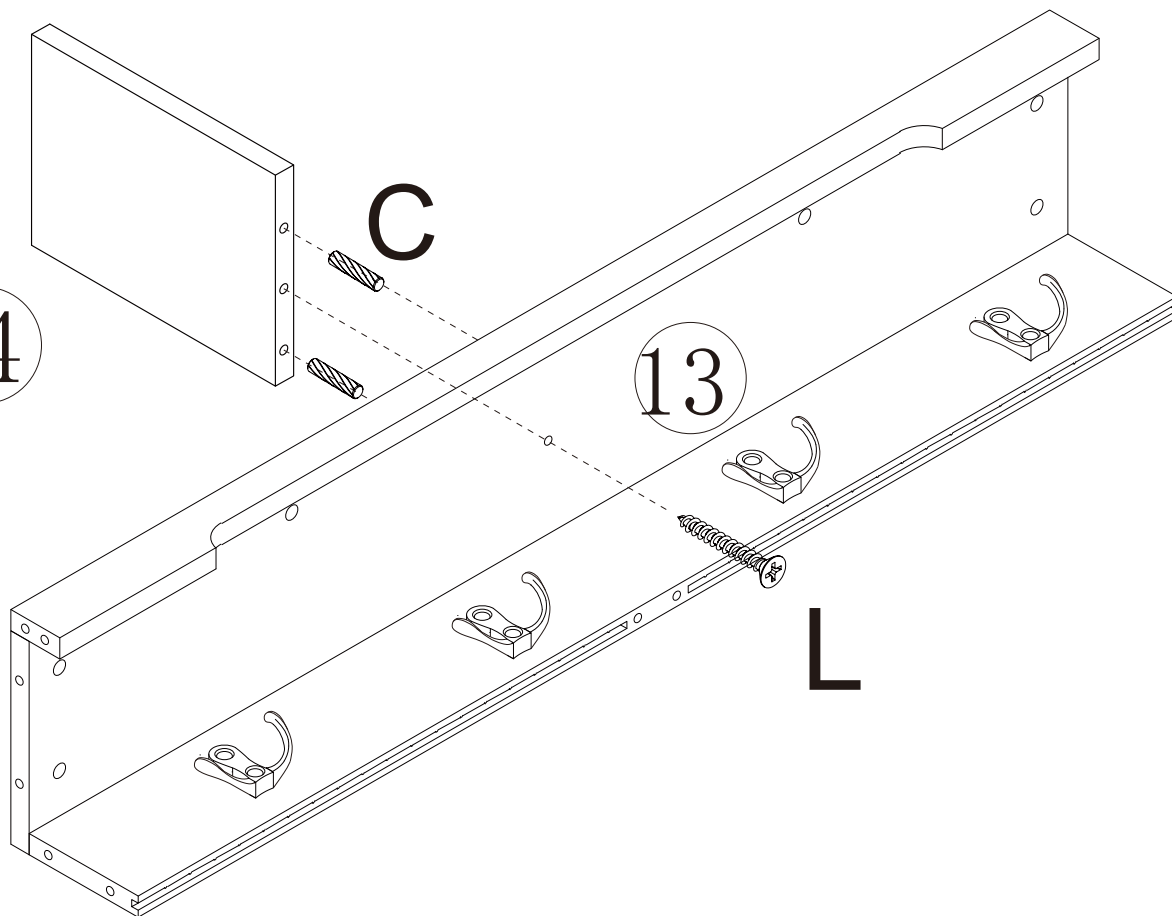

13

L

C

A	x 4
B	x 6
C	x 2
W	x 2

12

15

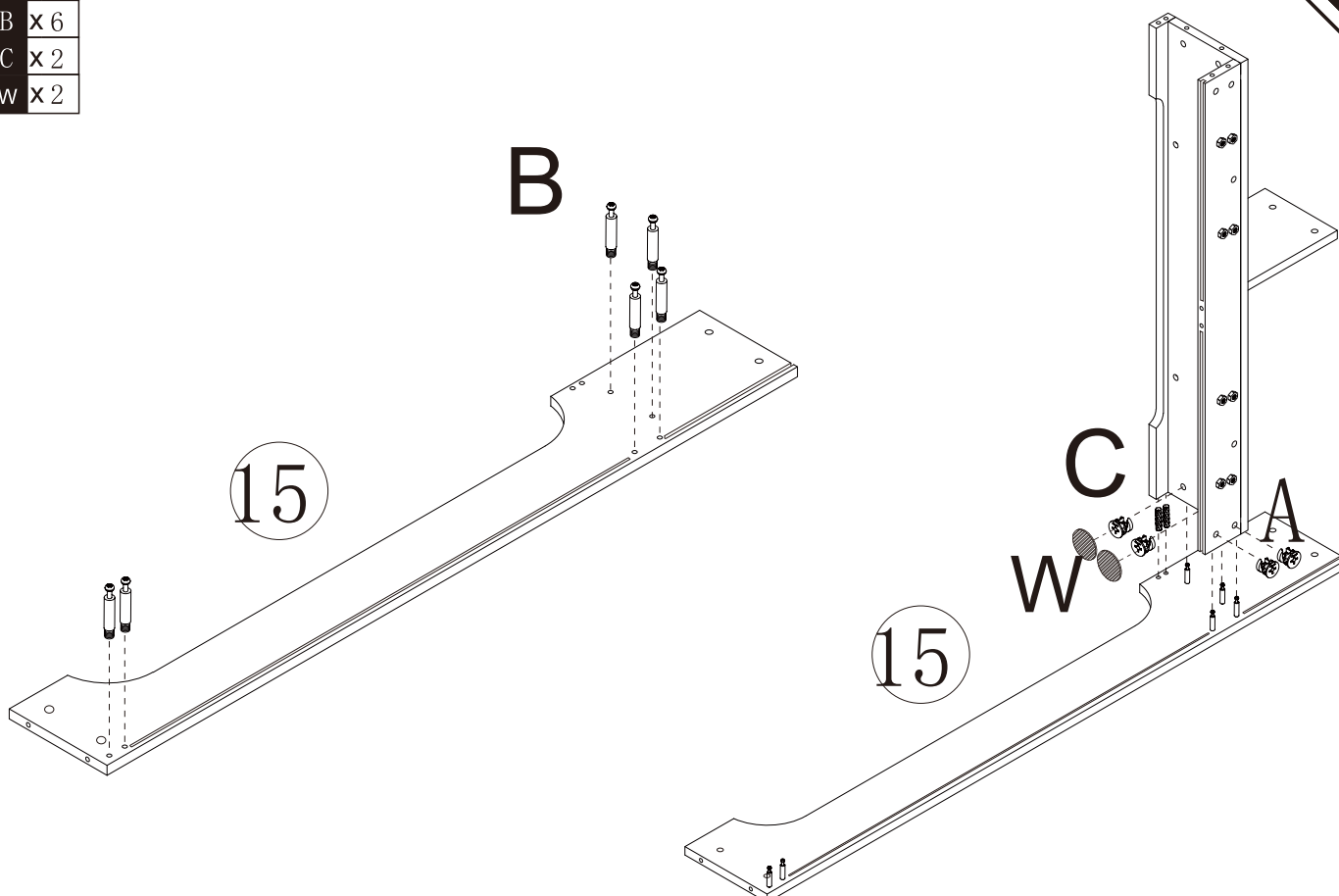

15

C

W

A

B

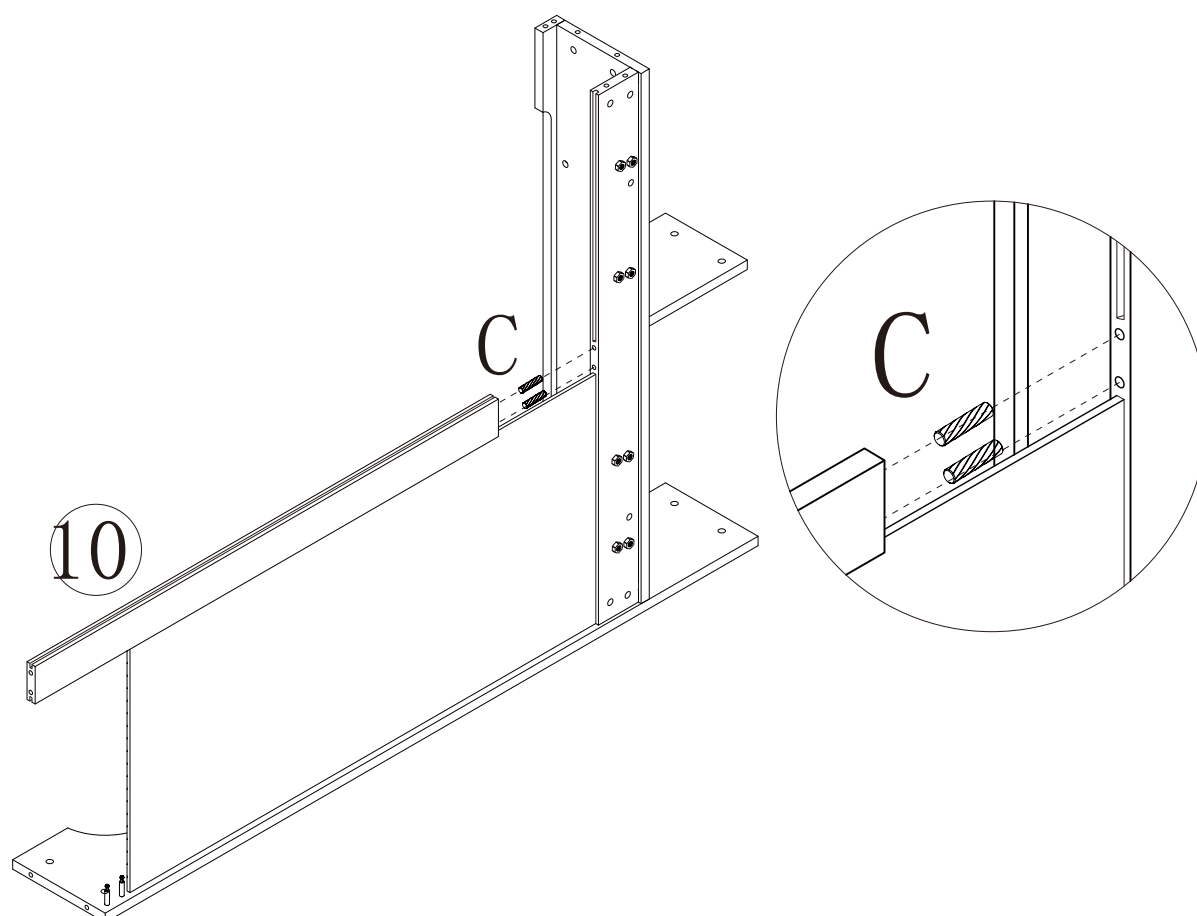
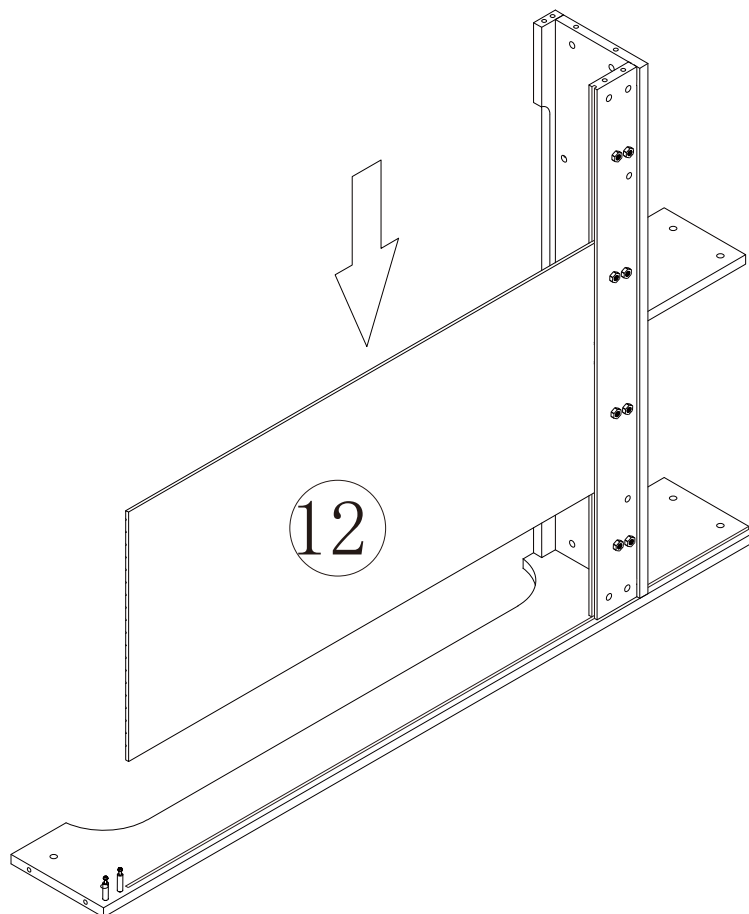

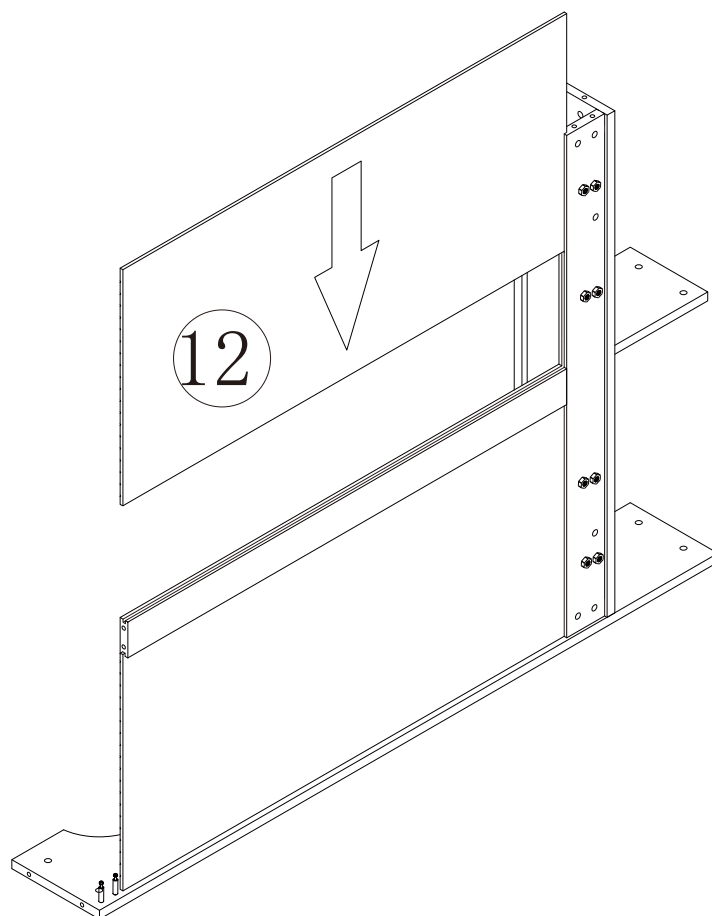

A x 2
C x 2

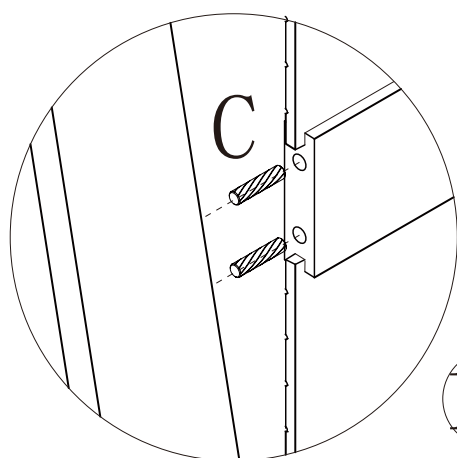

11

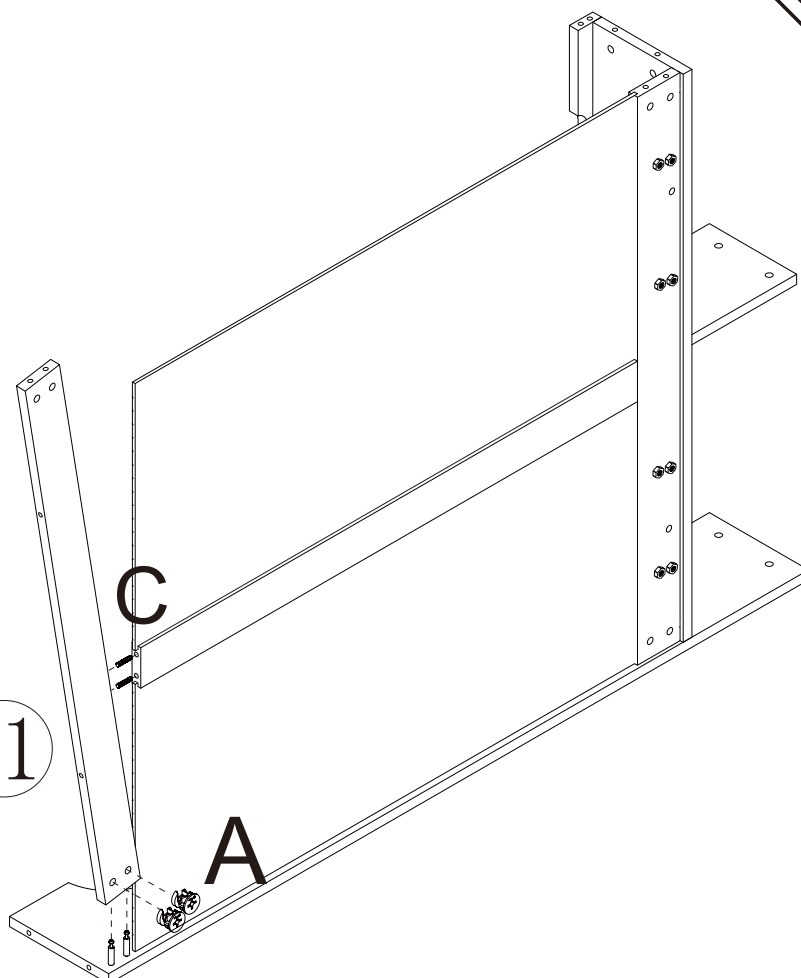

A	x6
B	x6
C	x2
W	x2

17

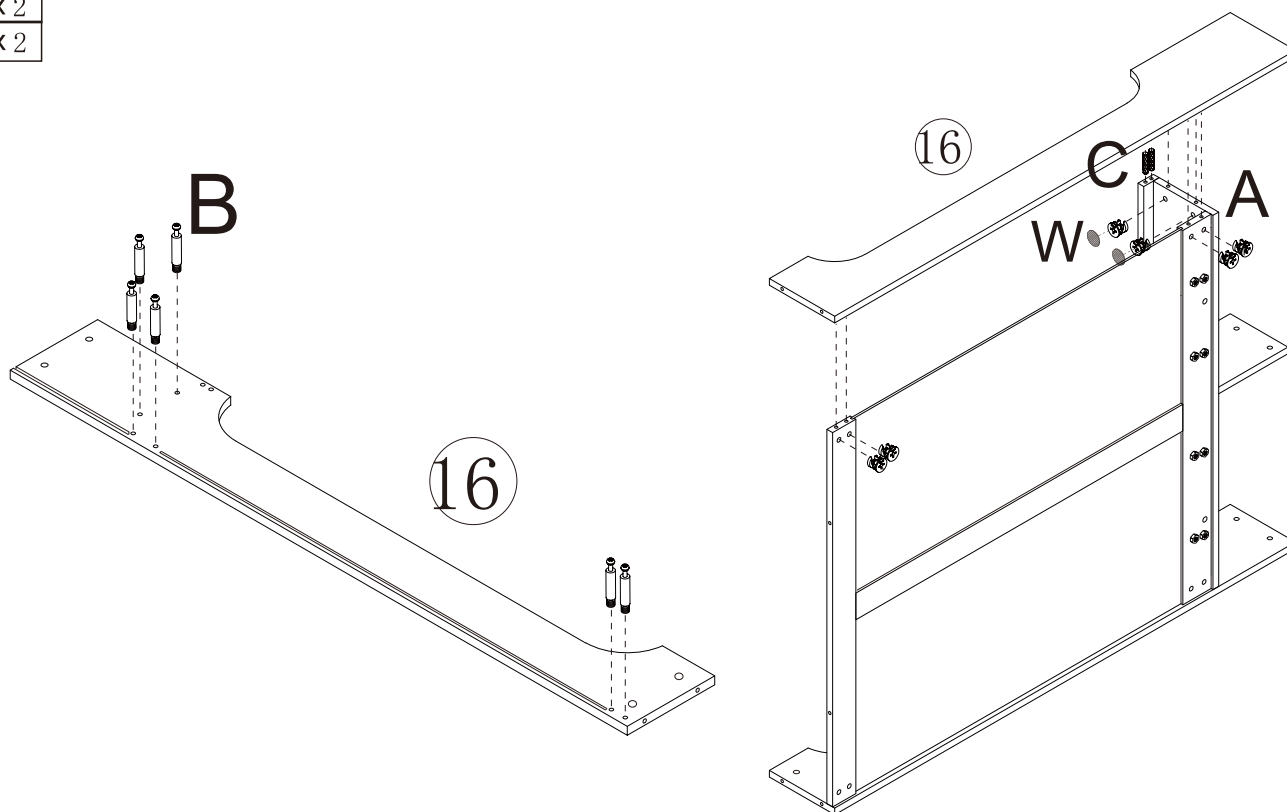

18

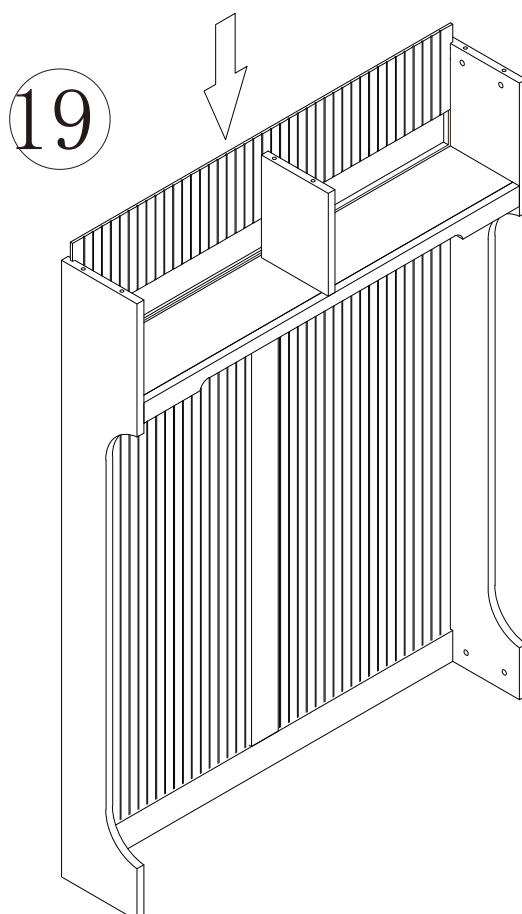

A	x6
B	x6
W	x6

19

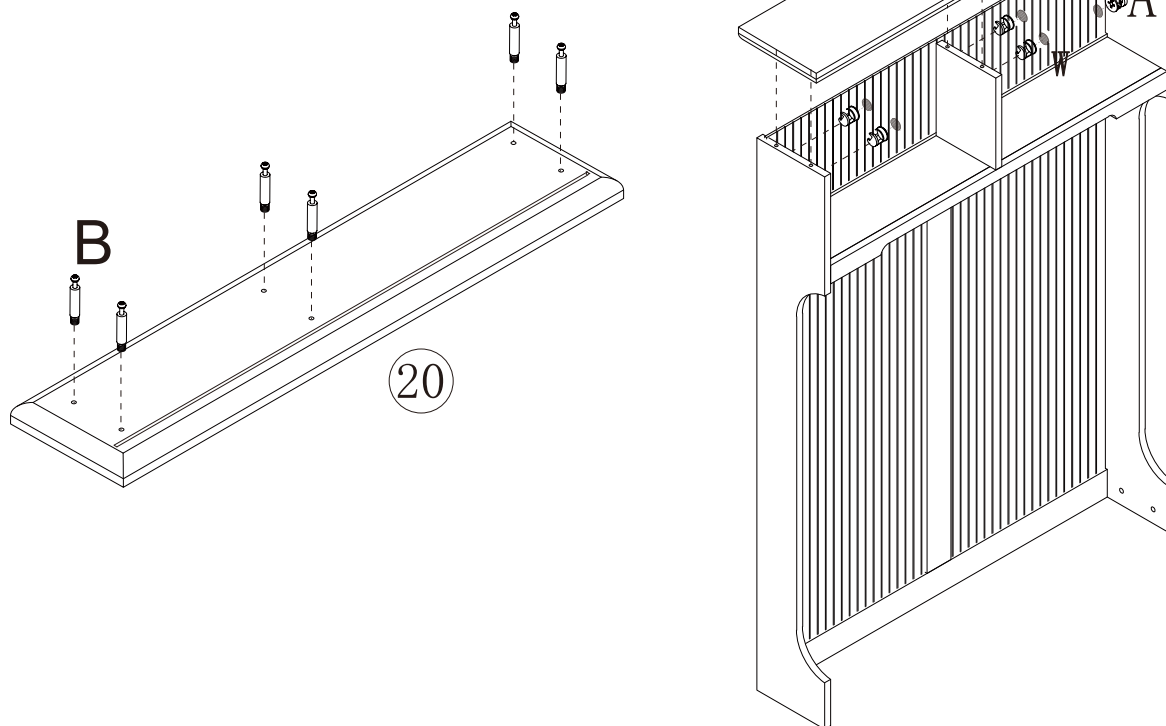

A	x8
K	x4
C	x2
W	x8

20

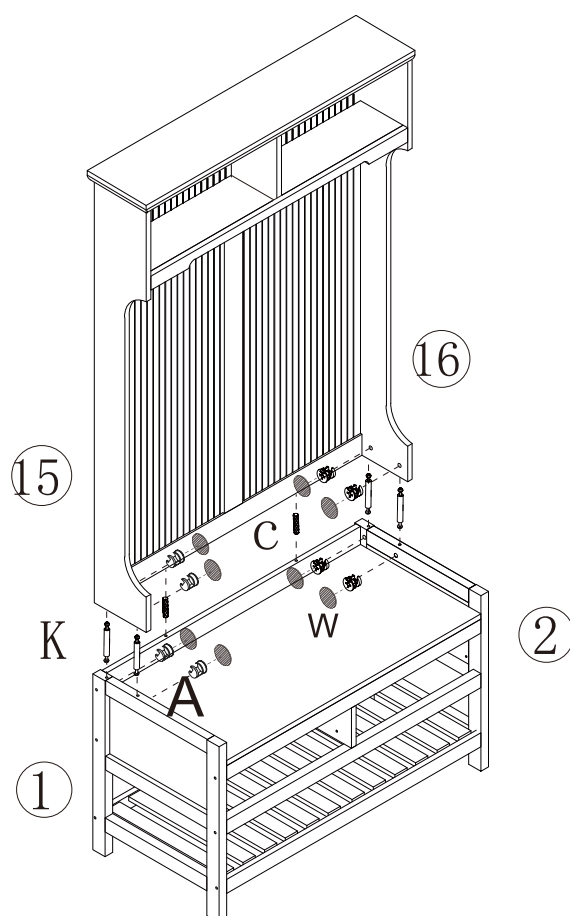

A	x8
B	x8
L	x8
M	x2
N	x4

21

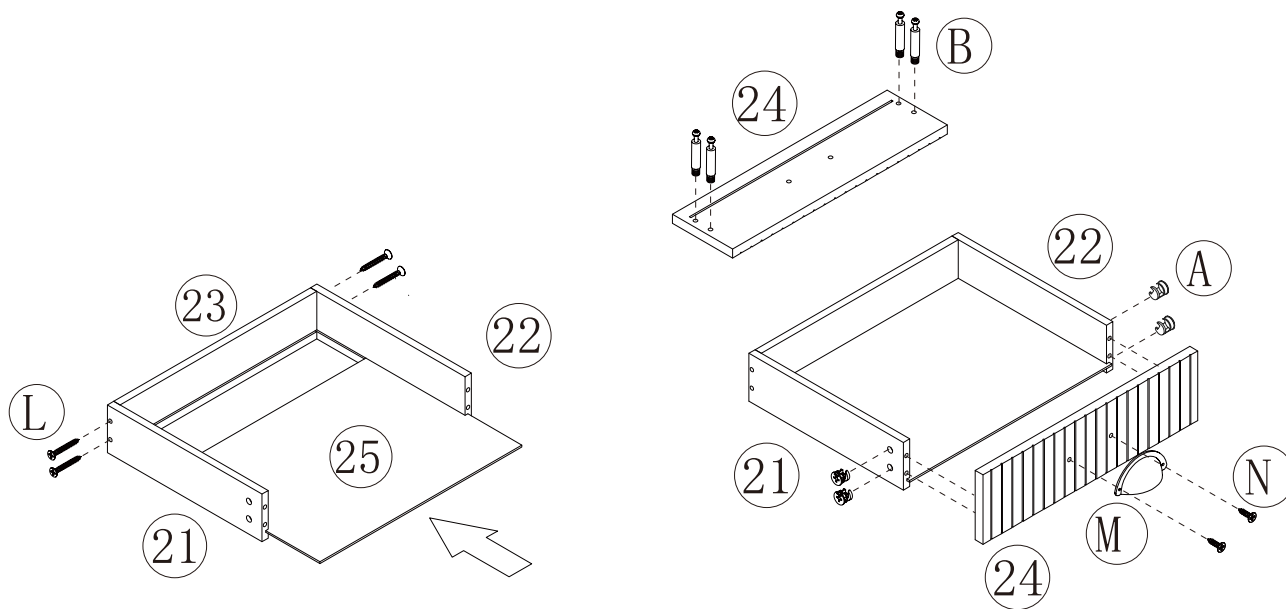

x2

F	x8
DL	x2
DR	x2

22

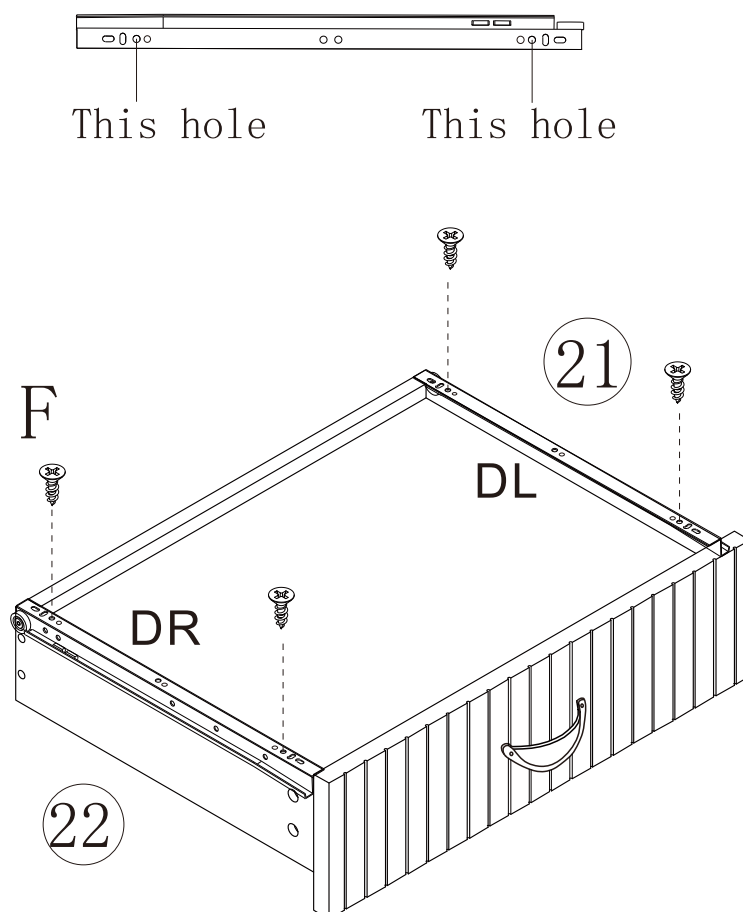

x2

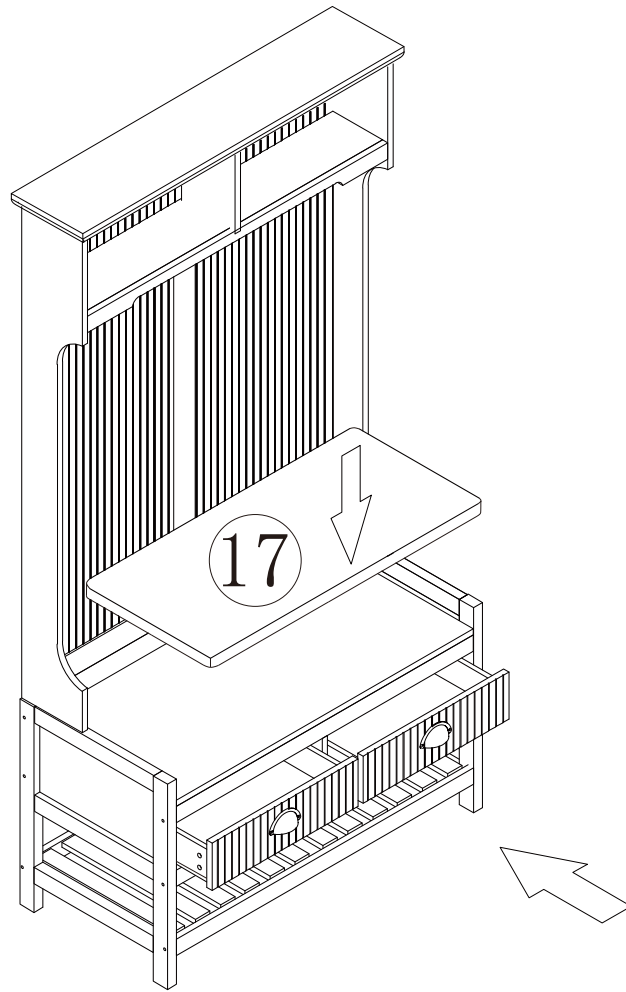

O	x1
T	x1
V	x1

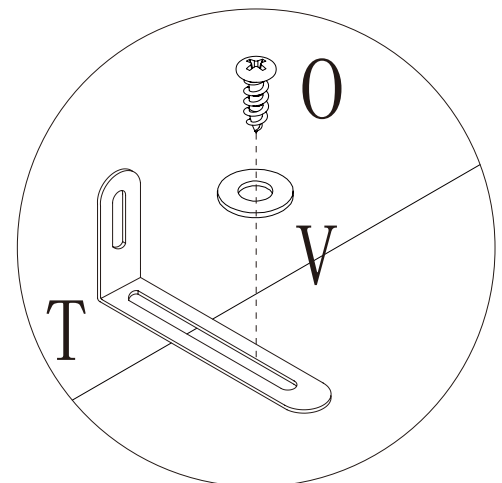
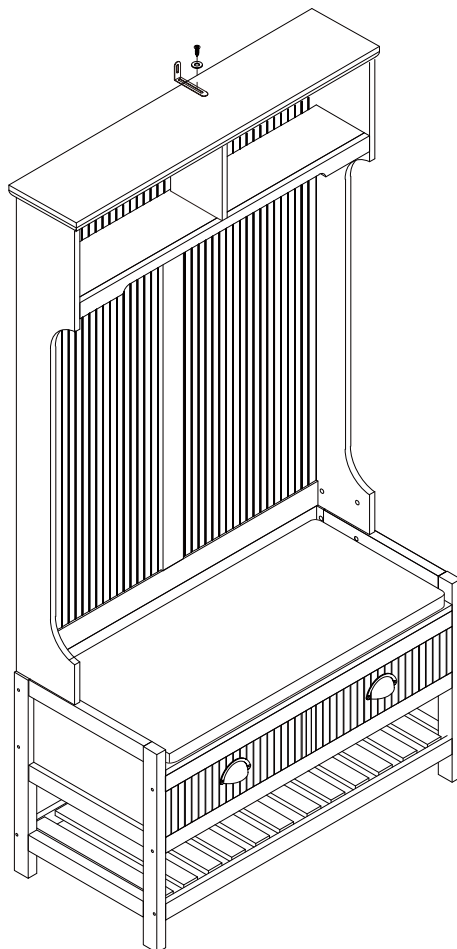

S	x 1
U	x 1
V	x 1

25

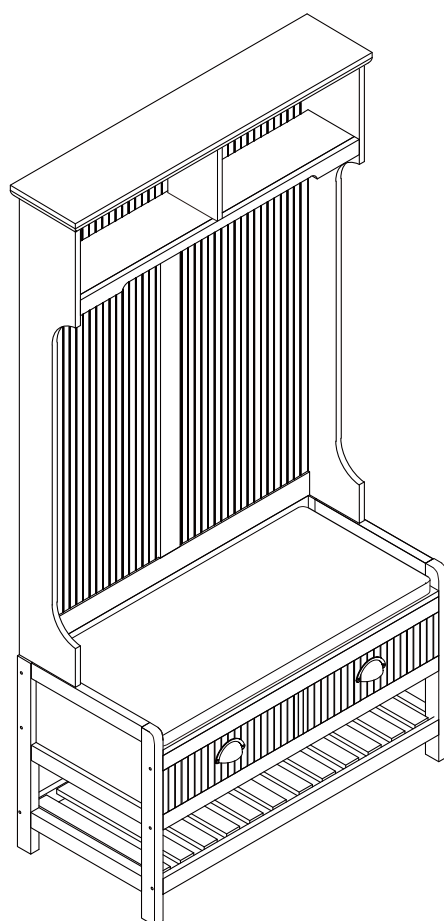
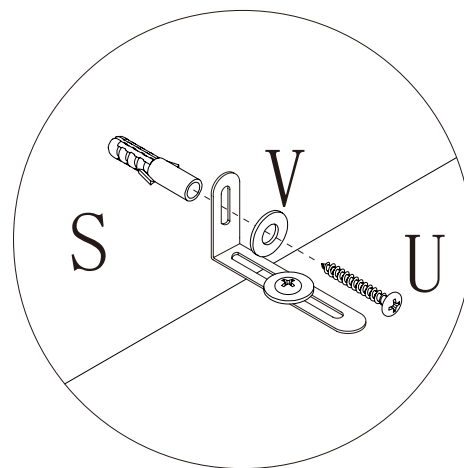
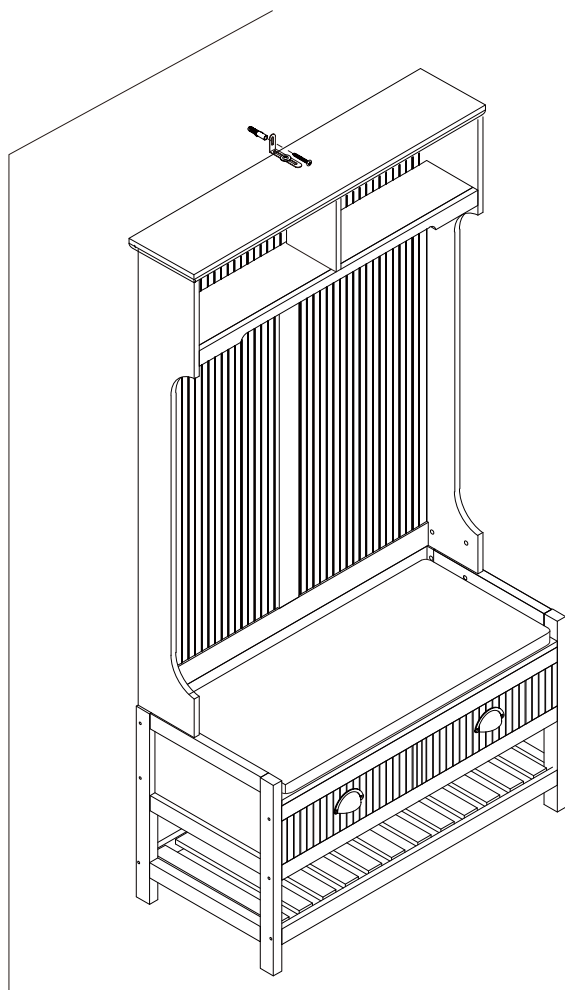

Done