

OSLB

Portable Air Conditioner

OSP1-10

Use and Care Manual

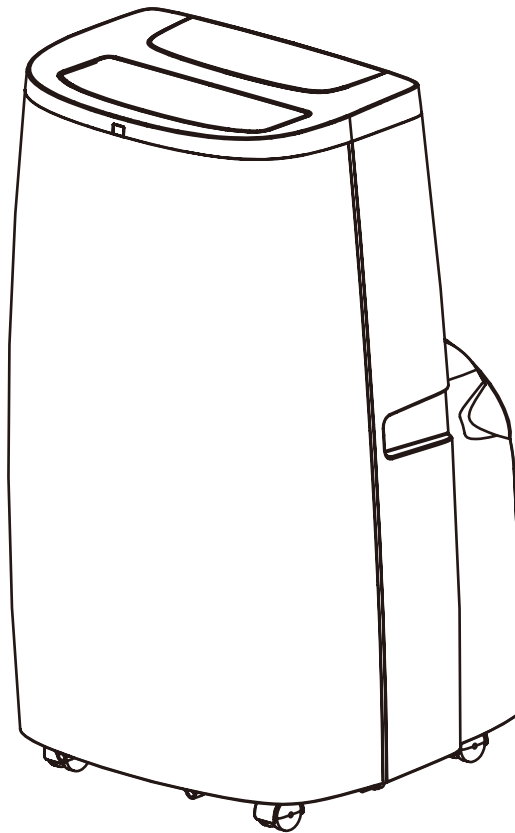

Thank you very much for selecting this new model of Portable Air Conditioner, please read this Use and Care Manual carefully before installing and using this appliance. Please keep this Use and Care Manual properly for future reference.

210204

Contents

Safety Instructions.....	1
Features & Identification of Parts.....	3
Operations and Settings.....	4
Installation and Adjustment.....	7
Drainage Instructions.....	10
Multiple Protection Functions	11
Maintenance and Service.....	11
Troubleshooting.....	13
Warranty.....	14

Safety Instructions

1. All wiring must comply with local and national electrical codes and be installed by a qualified electrician. If you have any questions regarding the following instructions, please contact a qualified electrician.
2. The unit must be installed in accordance with national wiring regulations. Check available power supply and resolve any wiring problems before installation and operation of this unit.
3. For your safety and protection, this unit will be grounded through the power cord plug when plugging into a matching wall outlet. If you are not sure whether the wall outlet at your home are properly grounded, please consult an electrician. If supply cord is damaged, it must be replaced by the manufacturer, its service agent or similarly qualified person in order to avoid any hazards.
4. This appliance is not intended for people (including children) with reduced physical, sensory or mental capabilities, or lack of experience and knowledge, unless they have been given supervision or instruction concerning use of the appliance by a person responsible for their safety. Young children should be supervised to ensure that they do not play with the appliance.



To reduce the risk of fire, electrical shock or injury when using your air conditioner, follow up these basic precautions:

- ※ Indoor use only, it is prohibited to use this unit outdoors or in humid environment such as bathroom etc.
- ※ Do not remove ground prong.
- ※ Do not use an adapter.
- ※ Do not use an extension code.
- ※ Never share the power outlet with other appliances.
- ※ Never connect or disconnect the power plug with wet hands to avoid electric shocks.
- ※ Never turn off the unit by unplugging.
- ※ Unplug air conditioner before servicing.
- ※ Never dismantle, repair or modify the unit without authorization to avoid body injury or

property damage, be sure it repaired by manufacturer or professionals.

- ※ After the air conditioning installation, please ensure that the wires plug in good condition and securely inserted into the power socket, and always maintain the power cord placement rules orderly, avoid someone stumbled or pull the plug out.
- ※ Never put any objects into the unit.
- ※ Never cover or obstruct air inlet or outlet to prevent overheating.
- ※ Never hit or shake the unit to prevent damage.
- ※ Never spray water or place the unit near water to prevent electric shocks.
- ※ Never place the unit near gas appliances, fire or flammable liquids.
- ※ Move and install the unit by two or more people.
- ※ The unit should be far away from the gas, flammable gas, stoves, or other heat source
- ※ This appliance can be used by children aged from 8 years and above and persons with reduced physical, sensory or mental capabilities or lack of experience and knowledge if they have been given supervision or instruction concerning use of the appliance in a safe way and understand the hazards involved. Children shall not play with the appliance. Cleaning and user maintenance shall not be made by children without supervision.

Cautions

- ※ Please make sure that the unit is placed on a flat, dry place. Keep the unit between the wall around has more than 0.5meters.
- ※ Keep the unit at least 1 meter away from TV or radios to avoid electromagnetic interference.
- ※ Do not expose the unit under direct sun light to avoid surface color fading.
- ※ Do not tilt the unit for more than 35 degrees or upside-down while transporting.
- ※ Keep the drain hose in good condition without flexure then connect with unit.
- ※ Empty the condensed drainage pan before putting the unit in storage to prolong the unit lifetime end of the season.
- ※ Do not use insecticide spraying or other combustible material near the air conditioning .
- ※ Do not use chemical solvents (e.g. Benzene, alcohol-glazer) to clean the unit surface, do not scratch or damage the unit.

※ Make sure to cut off the power before disassembling or installing the filter.

※

Remark: Do not use this unit in cooling mode if the ambient temperature is higher than 35°C.

Features and Identification of Parts

1. Features

- New appearance with compact design, more luxury and upscale.
- Outlet louver swing automatically and wind direction up to consumer needs.
- Beautiful and simple appearance, humanized design for remote control storage, which can be placed in storage bracket at the back of the unit body.
- Simple operation, LED digital display control panel and high-end LCD remote control.
- Winding pillar and universal socket can protect power cord better.
- 24-hour Timer function, unique on/off reminding music.
- 3-minute re-start delay protection to compressor and other multiple protection functions.
- Unique exhaust hose and fasteners, convenient installation.

2. Identification of Parts

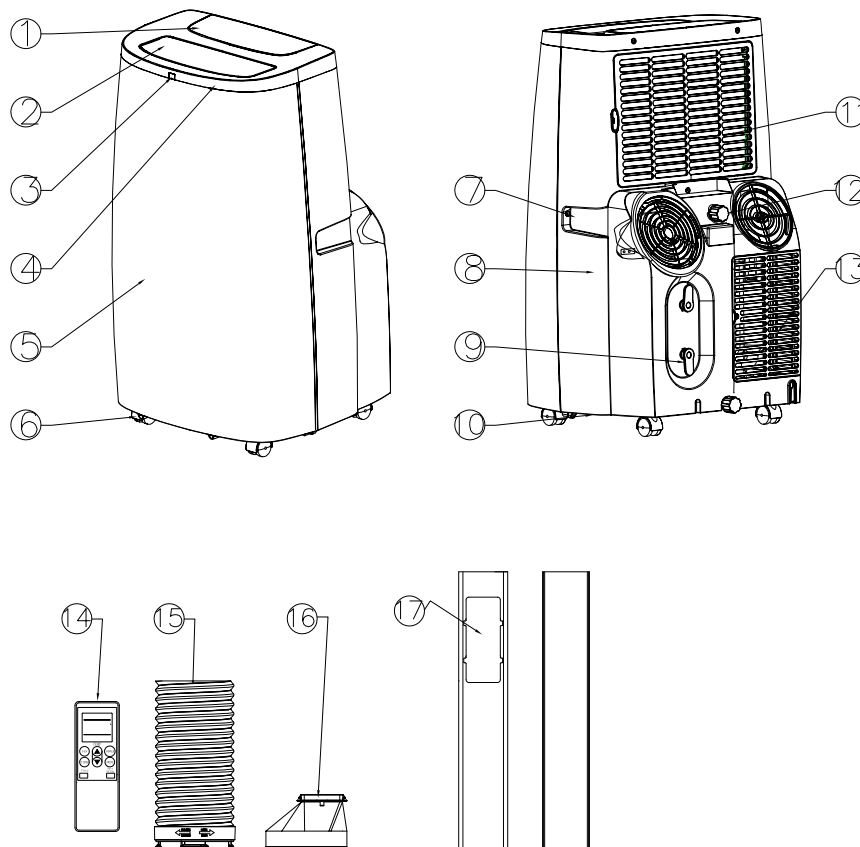

-
- | | |
|------------------------------------|--------------------------------------|
| 1. Control panel | 10. Chassis |
| 2. Horizontal louver | 11. Upper filter assembly |
| 3. Remote control receiving window | 12. Drain cover and stopper |
| 4. Top panel | 13. Lower filter assembly |
| 5. Front shell | 14. Remote control |
| 6. Universal wheels | 15. Round connector and exhaust hose |
| 7. Handle | 16. Adapter of exhaust hose |
| 8. Back shell | 17. Window kits |
| 9. Winding pillar | |

Operations and Settings

1. Control Panel

This section explains proper mobile air conditioner operation.

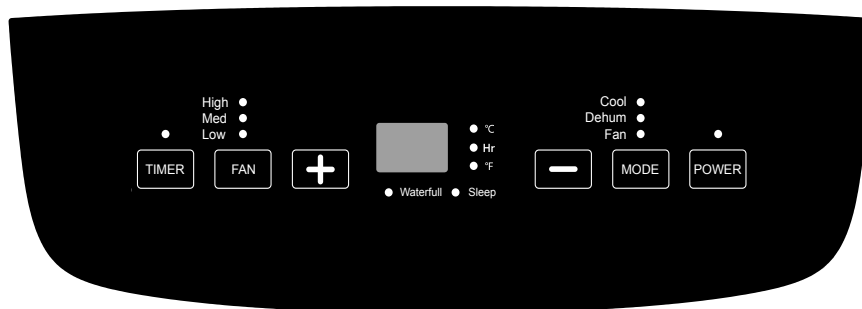

2. Control Panel Operation

- A. Power button: Press the power button, the power indicator lights up in green; when the power is on, press the power button, the power indicator light is off (or red).
- B. Mode button: Touch this key to switch and select unit working mode you want, all modes turn as COOL – DEHUM – FAN, the indicator will light up accordingly.
- C. Fan button: Press this button to change fan speed to High, Medium or Low.
- D. Up button: Press the up key to adjust the set temperature or timing up.
- E. Down button: Press the down key to adjust the set temperature or timing up.
- F. Timer button: Press the timer button to set the timing, query timing, and cancel the timing.
- G. "Up" + "Down" button: Press this group of composite keys at the same time to switch the display temperature (Fahrenheit / Celsius).
- H. "Timer" + "Up" button: Press this group of composite keys at the same time to select sleep mode.
- I. "Timer" + "Fan" button: Press this group of composite buttons at the same time to turn the swing function on or off.

3. Remote Control Operation

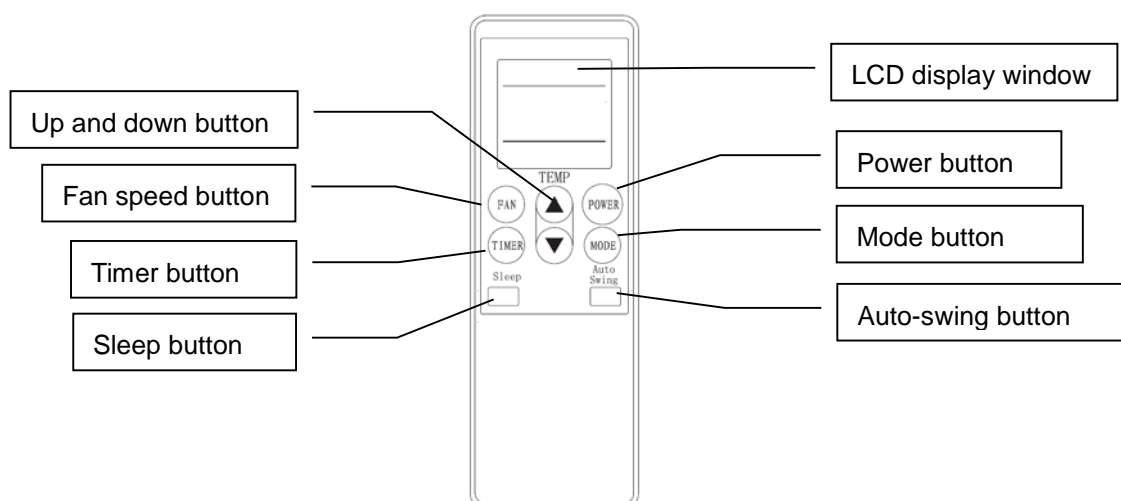

- 1) Power: Press this button to start the unit when it is energized or stop the unit when it is in operation.
- 2) Mode: Press this button to select operation mode.
- 3) : Press this button to increase room temperature and timer setting.
- 4) : Press this button to decrease room temperature and timer setting.
- 5) Fan: Press this button to select fan speed in sequence: Low → Medium → High.
- 6) Auto-Swing: Press this button to turn on or turn off auto-swing function.
- 7) Sleep: Press this button to select or cancel sleep mode (only effective under cooling operation or energy conversation modes).
- 8) Timer: press this button to set AUTO-ON and AUTO-OFF time. Time can be adjusted between 0.5-24 hours. It jumps by 0.5 hour interval within 5 hours, and 1 hour interval over 5 hours, set time will flash 5 times on screen then confirm the setting.

Before using your remote, install the AAA batteries into remote control.

- 1) Press and glide the battery cover on the back of the remote control, then you can remove the cover.
- 2) Insert two new alkaline AAA batteries into the battery compartment, being sure to note the proper polarity.

Reattach the battery cover, making sure the locking tab clicks into place.

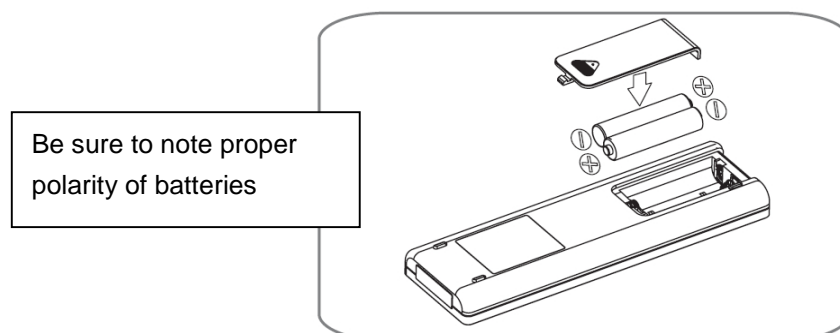

Notes:

-
- Use alkaline batteries only. Do not use rechargeable batteries.
 - When replace batteries, always replace both batteries with new batteries, do not mix old and new batteries.
 - If the air conditioner will not be used for an extended period of time, remove the batteries from the remote control.

4. Remote Control Storage

In order to avoid losing the remote control, please put the remote control inside of the storage place when you not use it.

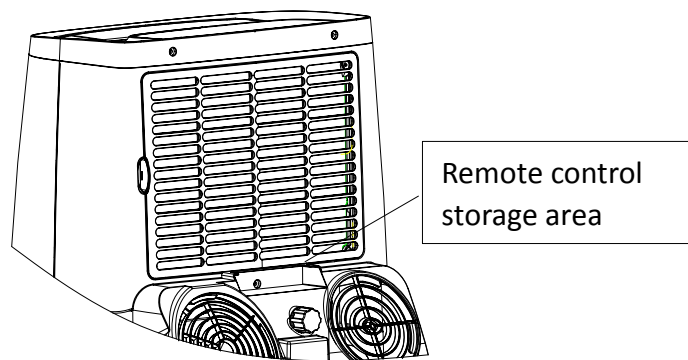

WARNING

If the liquid from the batteries gets onto your skin or clothes, wash it well with clean water, do not use the remote control if the batteries have any leakage.

If you eat the liquid from the batteries, brush your teeth and see doctor. The chemicals in batteries could cause burns or other health hazards.

Handling and Transportation

1. Handle and move the unit

1) Hold handles on side panels to move the unit in upright position.

Note:

- Make the unit in the upright position whatever handling or moving it.
- Drain the water in the unit completely to prevent water leakage and wet the floor or carpet before handling or moving the unit.
- Take out the remote control from the storage area and keep it.

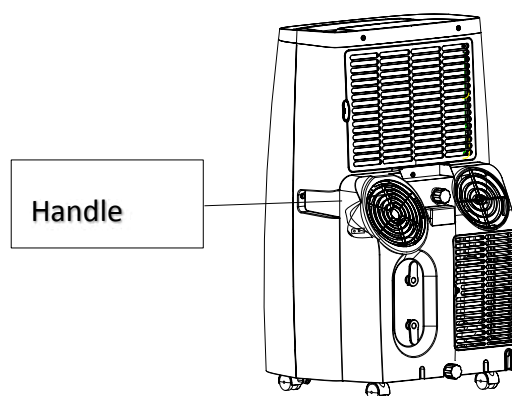

Installation & Adjustment

1. Installation

Notes:

- Keep this mobile air-conditioner in upright position at least 2 hours before first installation.
- This air-conditioner may be moved indoor conveniently; keep the unit in upright position while moving it. The air-conditioner shall be placed at flat surface.
- Do not install or operate this air-conditioner in bathroom or other wet environments.

1) Installation of exhaust hose assembly and its adapter.

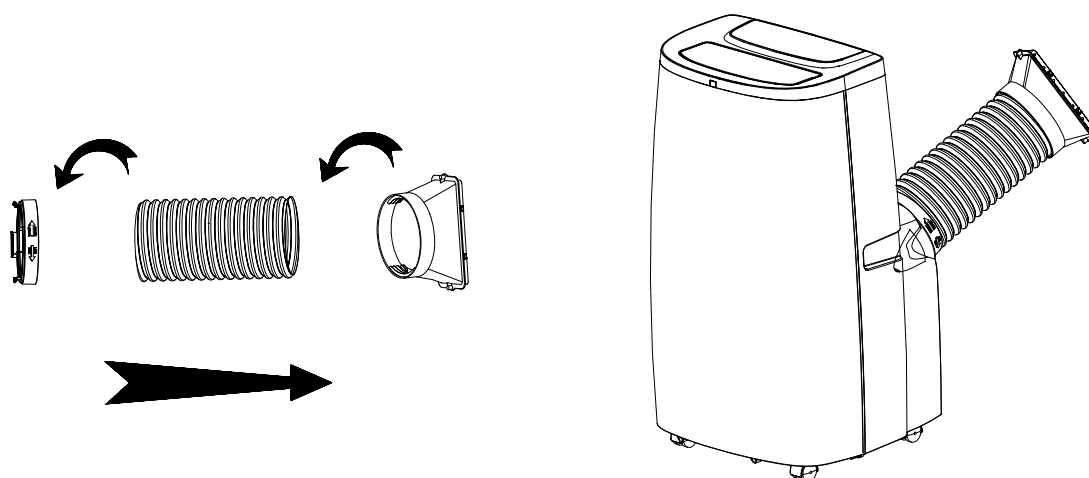

- A. Take out the exhaust hose and its connector and adapter, to remove the plastic bag.
- B. Extend one end of exhaust hose, screw the end without slot of round connector onto it with anticlockwise direction at least 3 laps.
- C. Extend another end of exhaust hose, screw the adapter onto it with anticlockwise direction at least 3 laps.

Note: Screw round connector and adapter into right position, at least 3 laps, to keep good connection of exhaust hose assembly.

2) Installation of window seal-plate

- A. Make the window half open, put the seal-plate into window, either in vertical or horizontal position.

- B. Extend seal plate parts and adjust it to the length of window, keep both ends to meet window edge, fix it with screws then.

Note:

- Keep two ends of window seal-plate to meet the window edges well, to assure seal effect.
- Turn the screw in good position.

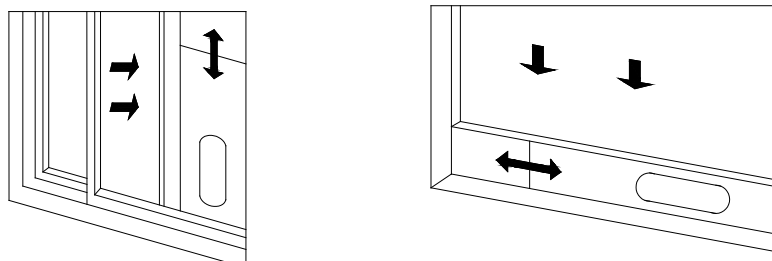

3) Installation of the unit

- A. Move the unit with the exhaust hose assembly installed in front of window and keep the unit at least 50cm away from the walls or other objects.

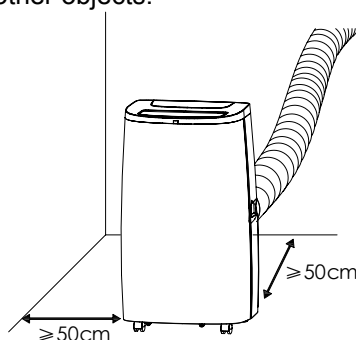

- B. Install the rectangle end of exhaust hose assembly into the corresponding rectangle hole in window seal-plate assembly, fix it with screw and close the window.

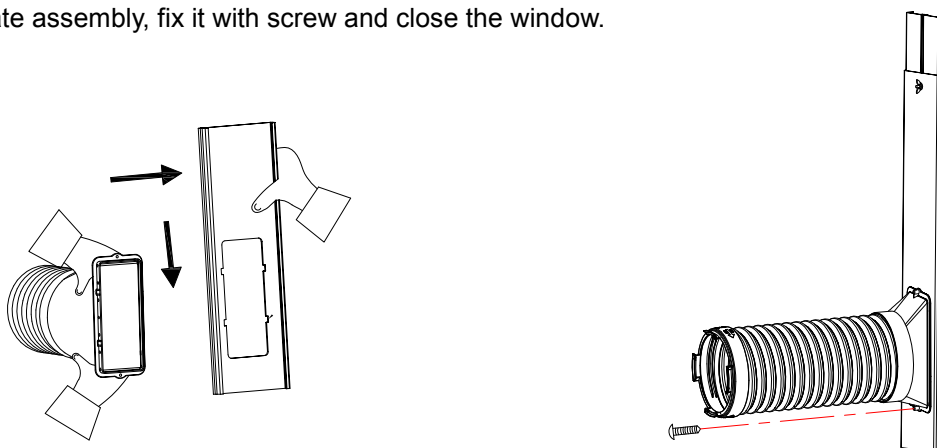

Note:

- Slide the adapter downwards and assure adapter installed in good position.
- Assure the slant panel direction to match seal-plate direction.
- Exhaust hose cannot be bent or with flexure higher than 45°, in order to keep good ventilation of exhaust hose.

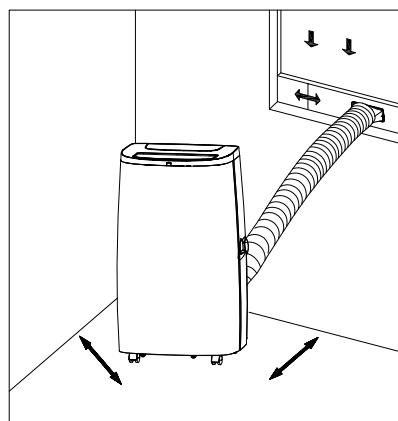
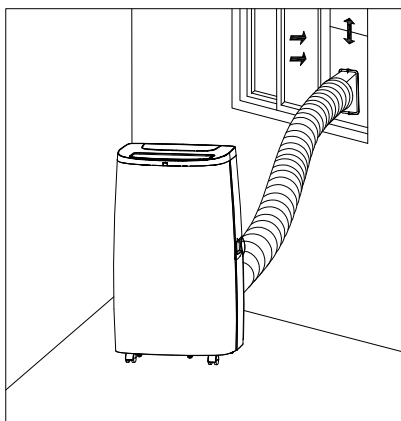

Important notes:

The exhaust hose is 280mm-1500mm long and this length is determined based on the specification of the air-conditioner (s). Do not use prolonged the hose or replace it with other different hoses as this may affect the functions of the air-conditioner. The exhaust hose must be smooth or it may lead air-conditioner overheat and damage.

Drainage Instruction

1. Manual drainage:

- 1) Once the unit shuts down upon water-full, turn off the unit and then unplug.
- 2) Put the tray below the water outlet at the back of the unit.
- 3) Screw off the drain cover, unplug the water stopper for water flow into the tray.
- 4) Plug in stopper and screw the drain cover tightly onto water outlet after drainage.

Notes:

- Protect the drain cover and water stopper properly.
- Move the unit carefully to avoid the leakage it is necessary.
- Tilt the unit slightly backwards when draining.
- Block the drain hole as soon as possible before the tray is full if it cannot hold all water in the unit to prevent the water leakage and wet the floor or carpet.
- Water stopper and drain cover must be tightly installed, to avoid new condensate to wet the floor or carpet when the unit re-starts working.

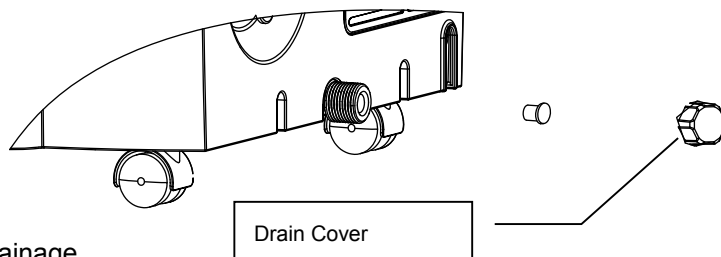

2. Continuous drainage

- 1) Screw off the drain-cover & unplug the water stopper.
- 2) Connect drain-hole with $\phi 13\text{mm}$ drain hose, as deep as possible to avoid leakage.
- 3) Pull the drain hose to bathroom or outdoor.

Notes:

- Drain hose must be installed when there's no water in the tray.
- It is suggested that not to use continuous drainage when unit is in COOL mode, to ensure enough water recycle in the unit to enhance the system cooling effects.
- Put the drain hose in an inaccessible place, not higher than drainage hole and keep drain hose straight without any flexure.
- Keep the drain cover and its stopper properly when continuous drainage is adopted.
- **Drain pipe needs to be purchased separately**

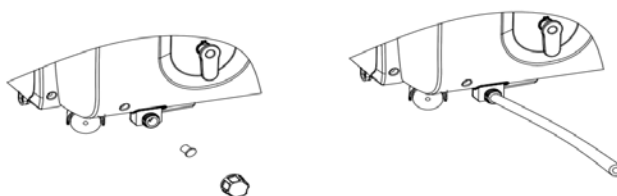

Multiple protection functions

1. Anti-frozen protection function

Under COOL mode, when the compressor continuously runs over 10 minutes, if tube temperature is $\leq 2^{\circ}\text{C}/36^{\circ}\text{F}$ for 20 seconds, the anti-frozen protection function will be on, E4 will be shown on LCD display, compressor and water wheel motor will stop working, but upper fan remains running; If tube temperature $\geq 8^{\circ}\text{C}/46^{\circ}\text{F}$, the unit will stop anti-frozen protection and recover to the original working condition. Compressor will re-start working with 3 minutes delay for protection.

2. Water-full safety alarm and shut –off protection function

When the water volume exceeds its alarm level in chassis, warning sounds automatically and water-full icon is lighting in LCD display, you need to drain the condensate and re-start the unit.(For more information about how to drain, refer to the “Drainage Instruction” please). If the unit is not shut down manually, the unit will recover to the original operating status automatically once the water is fully drained. Or connect the power to re-start the unit again.

3. Delay protection function of compressor

This unit offers restart protection to compressor. Except that the compressor may start immediately when the unit is energized first time, there is 3-minute delay re-start protection after compressor is shut down.

Maintenance and Service

Note: Be sure to turn off the unit and pull out the plug before maintain or send to service center.

1. Surface cleaning

- 1) Clean the unit surface with wet soft cloth and do not use chemical solvents such as alcohol and gasoline to avoid any damage to unit.

-
- 2) Clean the dirty air outlet or louvers with wet soft cloth and detergent.
 - 3) Any chemical solvent is prohibited to use for unit cleaning or put such things near the unit for a long time.
 - 4) Any thinner, alcohol-glazer or other similar solvents is prohibited for unit cleaning.

2. Filter cleaning

Clean the filter once every two weeks, or it would influence the unit function if filter clogged with dust.

1) How to clean filter

- A. Grip the filter handle and pull it out gently in correct direction.
- B. Clean the dirty particles in filter by cleaner if it is necessary.
- C. Immerse and wash the filter gently into warm water (about 40°C) mixed with neutral cleaner, and then rinse and dry them thoroughly in the shade.

Notes:

- Pull out the filter gently.
- Removal of filter at back panel is at priority then for the filter at side panel, to avoid any twist or damage to filter.
- Do not squash the mesh.
- Do not hit the mesh with sharp objects or brush.

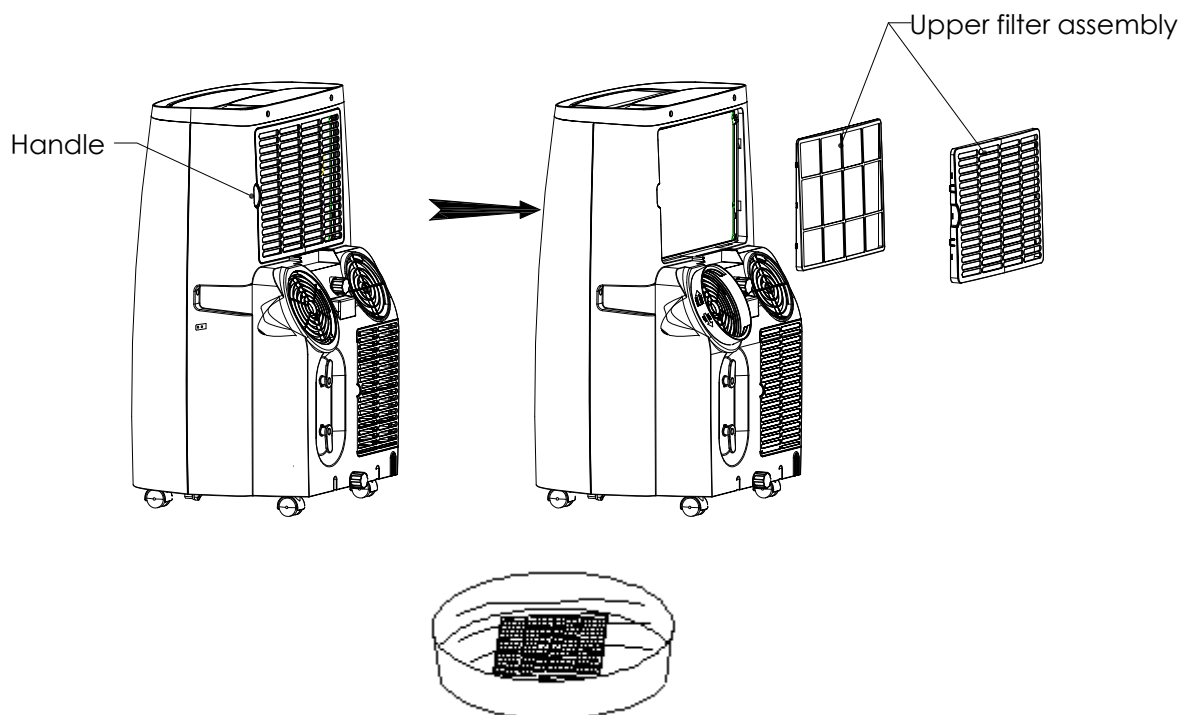

3. Installation of the filter

Aim the end of the filter toward slot then push filter gently into slot.

Notes:

- Be sure to install the filter to side panel then for the filter to back panel.
- Install the filter with opposite direction of removal.

- Install the filter into place gently to avoid any damage to filter.

4. End of Season Storage

- 1) Screw off the drain cover and pull out the stopper to drain condensate water completely. (Note: the tilt angle of the unit must be $\leq 30^\circ$).
- 2) Keep unit running in fan mode for half day to dry inside of unit completely to prevent from going moldy.
- 3) Turn off the unit, pull out plug then wrap the power cord around the wire-winding pillar, insert the plug into the universal fixing hole at the back panel of the unit, install the water stopper and drain cover.
- 4) Remove the heat exhaust hose assembly, clean and keep it properly.

Notes:

- Hold the exhaust hose assembly with both hands when removal.
 - Push the fasteners aside on exhaust air outlet using your thumbs, then pull out exhaust hose assembly.
- 5) Pack the air-conditioner properly with soft plastic bag and put it in dry place with appropriate dust-proof measures, and keep the unit away from children.
 - 6) Take out the batteries from the remote control and keep it properly.

Note:

Assure the unit is stored in a dry place. All accessories of the unit shall be protected together properly.

Troubleshooting

Please check the unit and suggestions below before asking for professional service, but never dismantle or repair the unit by yourself, it may cause harm to you and your property.

If problems not listed in the table occur or recommended solutions do not work, please contact the professional service organization.

Trouble	Cause	Remedy
The unit fails to start up	Power supply failure	Connect the unit to a live socket and turn it on.
	Water-full and its icon lighting	Drain the water stored in the unit.
	Ambient temperature too low or low high	It is recommended to use this unit between 8-35°C
	The room temperature is lower than the set temperature in cooling mode or higher temperature in heating mode	Change the set temperature
Bad cooling	There is direct sunlight	Close the window curtain

effects	The doors and windows are open, the room is crowded or there are other heat sources	Close the door and window, remove other heat sources, and add new air-conditioners
	Dirty filter	Clean or replace the filter mesh
	Air inlet or air outlet clogged	Remove the obstruction
High noise level	The unit is being placed at uneven surface.	Put the unit at a flat and firm place (may reduce noise)
The compressor does not work	Initiation of overheat protection.	Wait until the temperature decrease, the unit will re-start automatically
The remote control does not work	Too long distance	Bring the remote control close to the air-conditioner and ensure aims at signal receptor on unit.
	The remote control didn't aim at signal receptor on unit.	
	The batteries have no electricity	Replace the batteries
"E1" code displays	Tube temperature sensor failure	Check the tube temperature sensor and related circuits
"E2" code displays	Room temperature sensor failure	Check the room temperature sensor and related circuits
"E4" code displays	Anti-freeze protection	Restore the functions automatically once anti-freeze protection is over.
FL Displays	Water tank in chassis is full	Drain the condensate and re-start the unit

Appendix

Schematic diagram of the air-conditioner

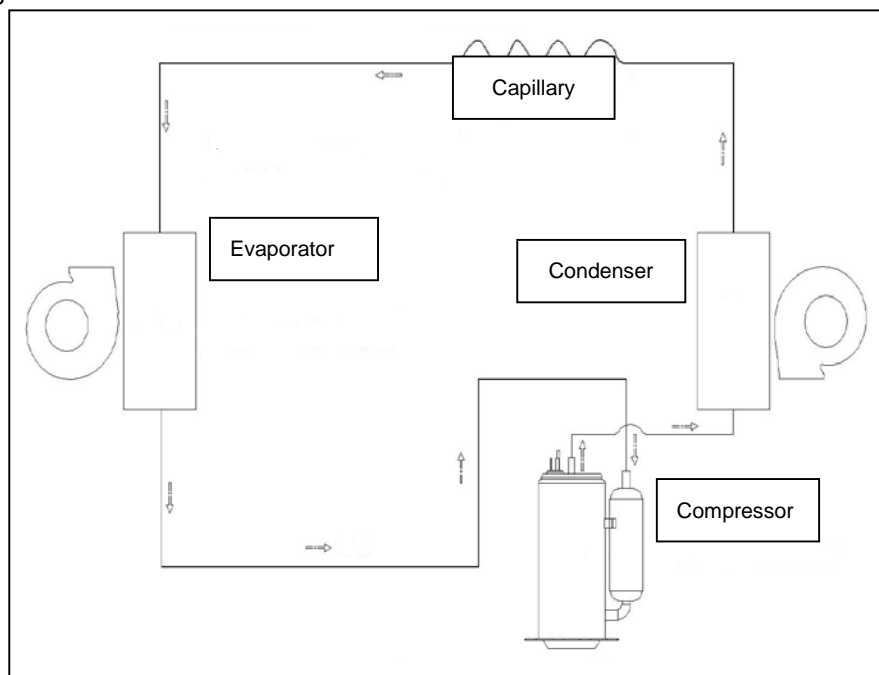

For specific technical parameters of the model, refer to rating label on the product.

One Year Limited Warranty

NEPO USA warrants the accompanying Air Conditioner to be free of defects in material and workmanship for the applications specified in its operation instruction for a period of One (1) year from the date of original retail purchase in the United States.

If the unit exhibits a defect in normal use, NEPO USA will, at its option, either repair or replace it, free of charge within a reasonable time after the unit is returned during the warranty period.

As a condition to any warranty service obligation, the consumer must present this Warranty Certificate along with a copy of the original purchase invoice.

THIS WARRANTY DOES NOT COVER:

- Damage, accidental or otherwise, to the unit while in the possession of a consumer not caused by a defect in material or workmanship.
- Damage caused by consumer misuse, tampering, or failure to follow the care and special handling provisions in the instructions.
- Damage to the finish of the case, or other appearance parts caused by wear.
- Damage caused by repairs or alterations of the unit by anyone other than those authorized by NEPO USA.
- Freight and Insurance cost for the warranty service.
- Filter and Accessories

ALL WARRANTIES, INCLUDING ANY IMPLIED WARRANTY OF MERCHANTABILITY ARE LIMITED TO THE DURATION OF THIS EXPRESS LIMITED WARRANTY. **NEPO USA** DISCLAIMS ANY LIABILITY FOR CONSEQUENTIAL OR INCIDENTAL DAMAGES AND IN NO EVENT SHALL NEPO USA'S LIABILITY EXCEED THE RETAIL VALUE OF THE UNIT FOR BREACH OF ANY WRITTEN OR IMPLIED WARRANTY WITH RESPECT TO THIS UNIT.

This warranty covers only new products purchased from our authorized dealers or retailers. It does not cover used, salvaged, or refurbished products.

As some states do not allow the limitation or exclusion of incidental or consequential damages, or do not allow limitation on implied warranties, the above limitations and exclusions may not apply to you. This warranty gives you specific legal rights, and you may also have other rights that vary from state to state.

For Technical Support and Warranty Service

Please Call (866) 669-9998

www.oslousa.com



Correct Disposal of this product

This marking indicates that the product should not be disposed with other household wastes. To prevent possible harm to the environment or human health from uncontrolled waste disposal, recycle it responsibly to promote the sustainable reuse of material resources. To return your used device, please use the return and collection systems or contact the retailer where the product was purchased. They can take this product for environmentally safe recycling.