

Instruction Manual

Basin faucet&Bathtub faucet System



1370



5437



1371



5441

CONTENT

1. Installation Condition	1
2. Basin Faucet Standard Part List (Model: 1370 & 1371)	2
3. Bathtub Faucet Standard Part List (Model: 5437 & 5441)	5
4. Clean And Maintenance	9

Installation Condition

1. Check the Accessories List to verify that all parts are complete in this package.
2. Do not disassemble the main body by yourself.
3. Connect inlet pipes to supply valves.
4. Make sure inlet pipes and supply valves have been installed and cleaned, with no impurities in the pipeline.
5. After installation, check all joints for leakages.
6. Do not leave the rain shower system exposed to a severely corrosive environment.

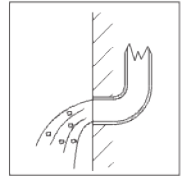

YOU MAY NEED:

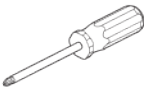

Model:1370 Basin Faucet Standard Part List

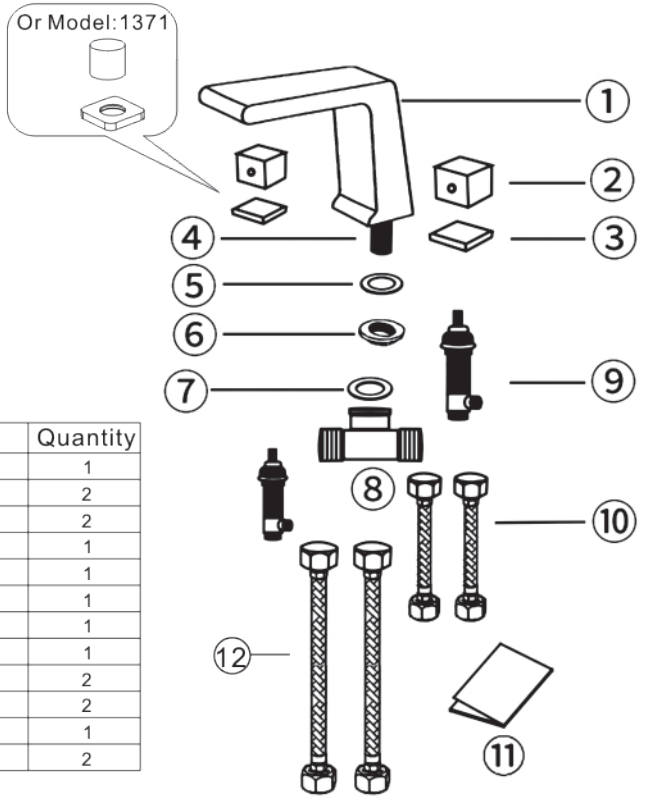

NO	Part Name	Quantity
1	Faucte Body	1
2	Handlet	2
3	Decorate Seat	2
4	Brass Part	1
5	Faucet Body Gasket	1
6	Mounting Nut	1
7	Tee Gasket	1
8	Tee	1
9	Control Water Body	2
10	Inlet Hose	2
11	Instruction Manual	1
12	Hot And Cold Hose	2

Hose Connection Travel

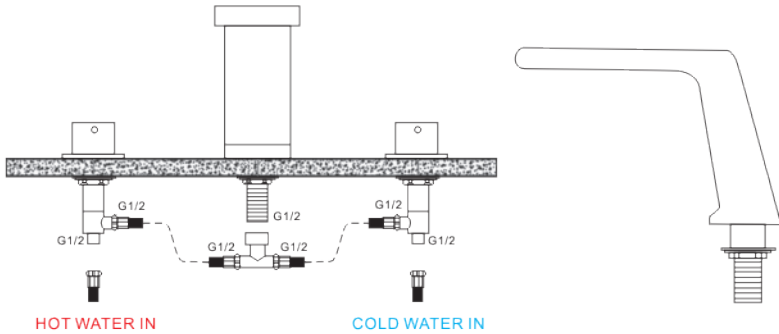

Basin Faucet Installation Step 1

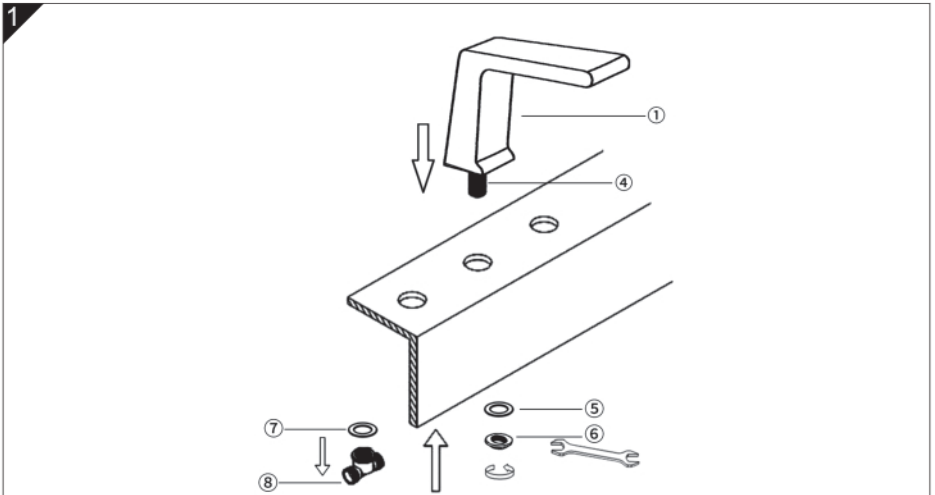

Connect Brass Part ④ with Faucet Body ① and put the Brass Part ④ through the basin hole. Install Faucet Body Gasket ⑤ and Mounting Nut ⑥ in sequence and tighten the nut with a wrench. Then put Tee Gasket ⑦ into Tee ⑧ and connect Tee ⑧ to Brass Part ④.

2 Model:1370

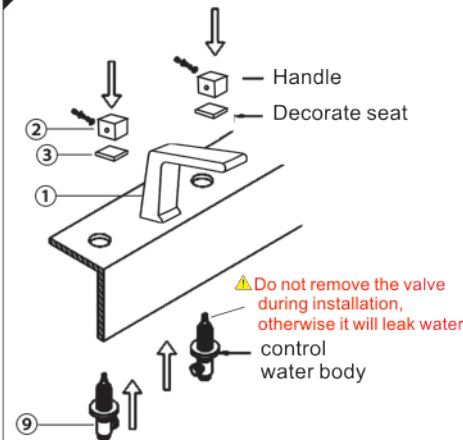

Model:1371

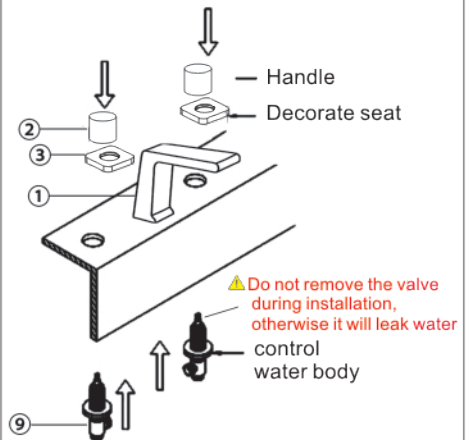

Remove the Decorate Seats ③ and put them on the basin holes. Connect the Control Water Bodies ⑨ with Decorate Seats ③ from the underside of the basin holes, and tighten them. Finally install the Handles ② and tighten them. (Not to disassemble the valve by yourself, otherwise leakage will occur.)

Basin Faucet Installation Step 2

3

Model:1370

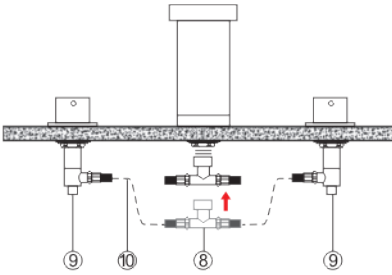

Model:1371

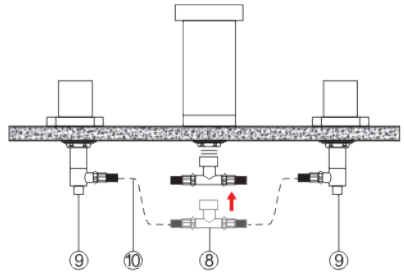

Connect one side of the Inlet Hoses ⑩ to the Control Water Bodies ⑨, the other side to Tee ⑧, and tighten them. The red hose is for hot water and the blue hose is for cold water.

4

Model:1370

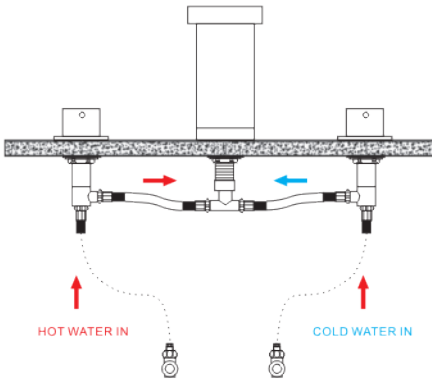

Model:1371

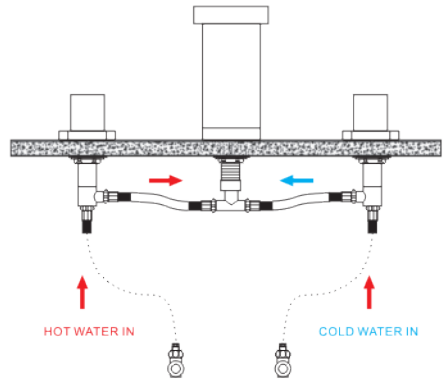

Separately connect another two inlet hoses (please buy them by yourself) to angle valves and control water bodies, left connect to the hot water, right connect to cold water.

Model:5437 Bathtub Faucet Standard Part List

NO	Part Name	Quantity
1	Faucet Body	1
2	Brass Part	1
3	Faucet Body Gasket	1
4	Mounting Nut	1
5	Hand Shower	1
6	Hand Pedestal	1
7	Pedestal Gasket	2
8	Mounting Nut	1
9	Handle	3
10	Decorate Seat	3
11	Transforms Control Valve	1
12	Control Water Body	2
13	Hand Connect Hose	2
14	Shower Connect Hose	1
15	Shower Hose	1
16	Instruction Manual	1
17	Hot And Cold Hose	2
18	Shower Connect	1

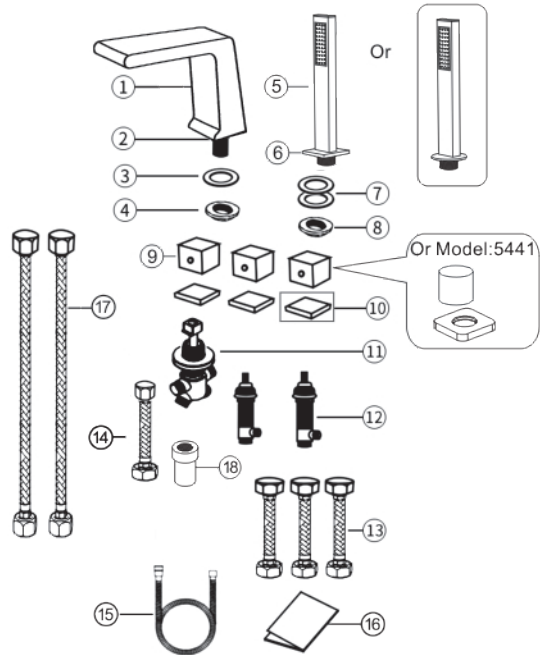

Hose Connection Travel

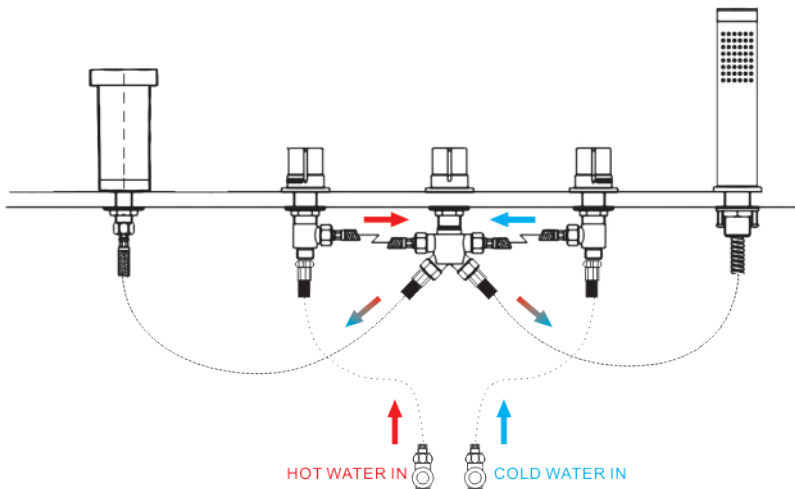

Bathtub Faucet Installation Step 1

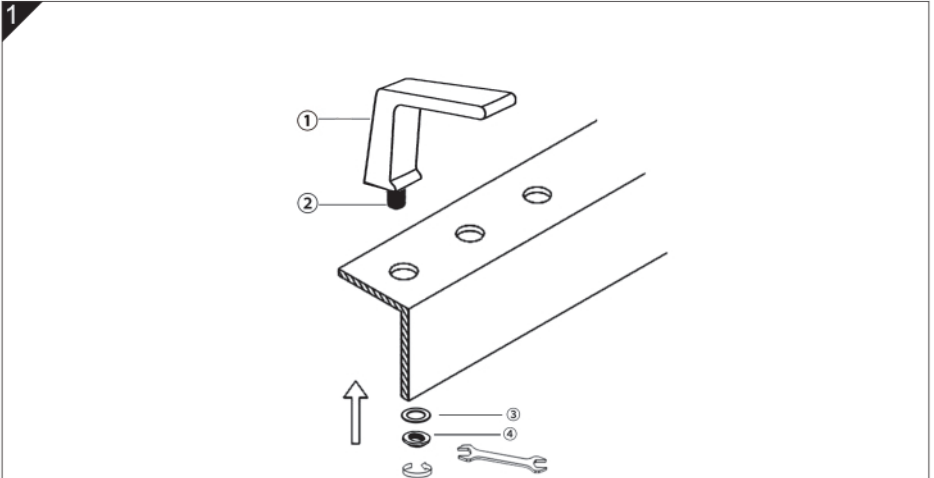

Connect Brass Part ② with Faucet Body ① and put the Brass Part ② through the basin hole. Install Faucet Body Gasket ③ and Mounting Nut ④ in sequence and tighten the nut with a wrench.

2 Model:5347

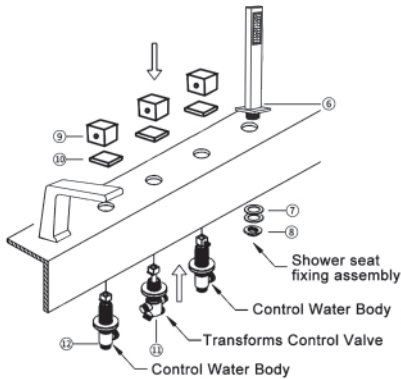

Model:5441

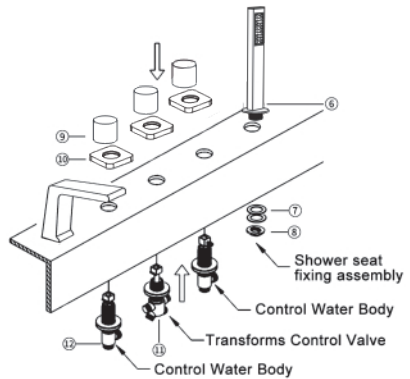

Remove the Decorate Seats ⑩ and put them on the bathtub holes. Connect Transforms Control Valve ⑪ and Control Water Bodies ⑫ with Decorate Seats ⑩ from the underside of the bathtub holes, and tighten them. Then install the Handles ⑨ and tighten them. Hand Pedestal ⑥ installation: Remove Pedestal Gaskets ⑦ and Mounting Nute ⑧. Connect them with Hand Pedestal ⑥ from the underside of the bathtub holes, and tighten Mounting Nut ⑧ with a wrench. (Not to disassemble the valve by yourself, otherwise leakage will occur. Left Control Water Body ⑫ connects to the hot water, right connects to cold water.)

Bathtub Faucet Installation Step 2

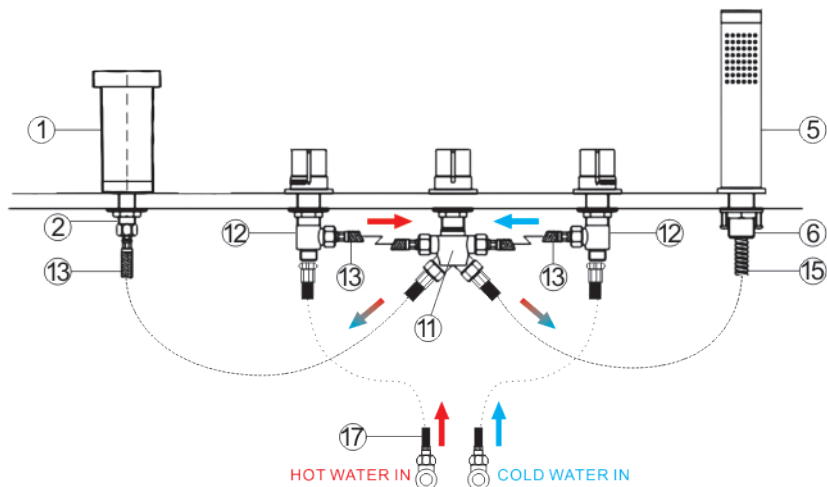

Install Hot and Cold Hoses ⑬ as the above drawings. Connect one side of Hot and Cold Hoses ⑬ with Transforms Control Valve ⑪, the other side to Control Water Bodies ⑫. Left is to hot water, right is to cold water. One side of Shower Hose ⑮ is connected to Hand Shower ⑤, the other side is connected to the Shower Connect Hose ⑭ through Hand Pedestal ⑥. Then the other side of Shower Connect Hose ⑭ is connected to Transforms Control Valve ⑪. Finally one side of Body Connect Hose ⑬ is connected with Brass Part ②, the other side is connected to Transforms Control Valve ⑪, and tighten them. Separately connect another two inlet hoses (please buy them by yourself) to angle valves and Control Water Bodies ⑫.

Model:5437



Model:5441



Adjust the handwheel installation position according to your own preference

Basin Faucet Application Instruction

1: Operating handle gradually is better for valve protection.

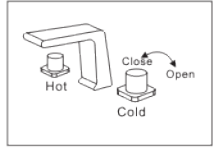
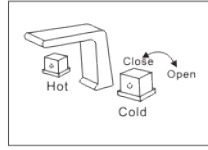

2: The handles turn right or left is to open or close. The larger the rotation angle, the larger the flow rate. Conversely, the smaller the rotation angle, the smaller the flow rate. Mixed warm water when the cold water handle and the hot water handle are opened at the same time.

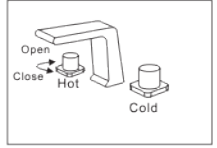
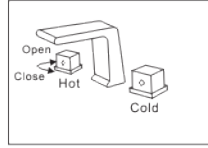

Bathtub Faucet Application Instruction

1: The middle one of the Handles 9 is control water diversion of the Faucet Body 1 and Hand Shower 5. Turn left, water comes out from the Hand Shower 5; turn right, water comes out from the Faucet Body 1.

2: Operating handle gradually is better for valve protection.

3: The handles 9 turn right or left is to open or close. The larger the rotation angle, the larger the flow rate. Conversely, the smaller the rotation angle, the smaller the flow rate. Mixed warm water when the cold water handle and the hot water handle are opened at the same time.

4: Turn on the water supply, check all connect points if leaking. If leaking, tighten it. Now the faucet is ready for using.

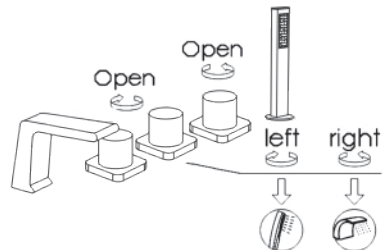
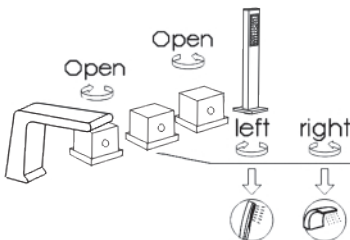

Care and Maintenance

Do's

1. In order to keep the mixer surface bright, please clean the mixer regularly.
2. Rinse faucet with clean water and wipe it with soft cotton cloth.
3. Use one of the following cleaners to remove dirt on the surface:
 - a. Mild liquid cleaner.
 - b. Colorless glass cleaner and powder cleaner which does not cause abrasion and can be dissolved completely.
 - c. Polish liquid which does not cause abrasion.



Don'ts

- a. Avoid using cleaning powder, harsh cleaning chemicals, brushes and coarse cloth to prevent scratching and friction.
- b. Do not use acid cleaner to clean the faucet as it may cause surface corrosion of the faucet. If the faucet should be exposed to harmful acid substances, please rinse it with water immediately.

