

Out-of-Plumb: ▶▶

Your walls are Out-of-Plumb if the side walls of the shower enclosure are not vertically level and lean or bow in any direction.

Plumb vs Out-of-Plumb: ▶▶

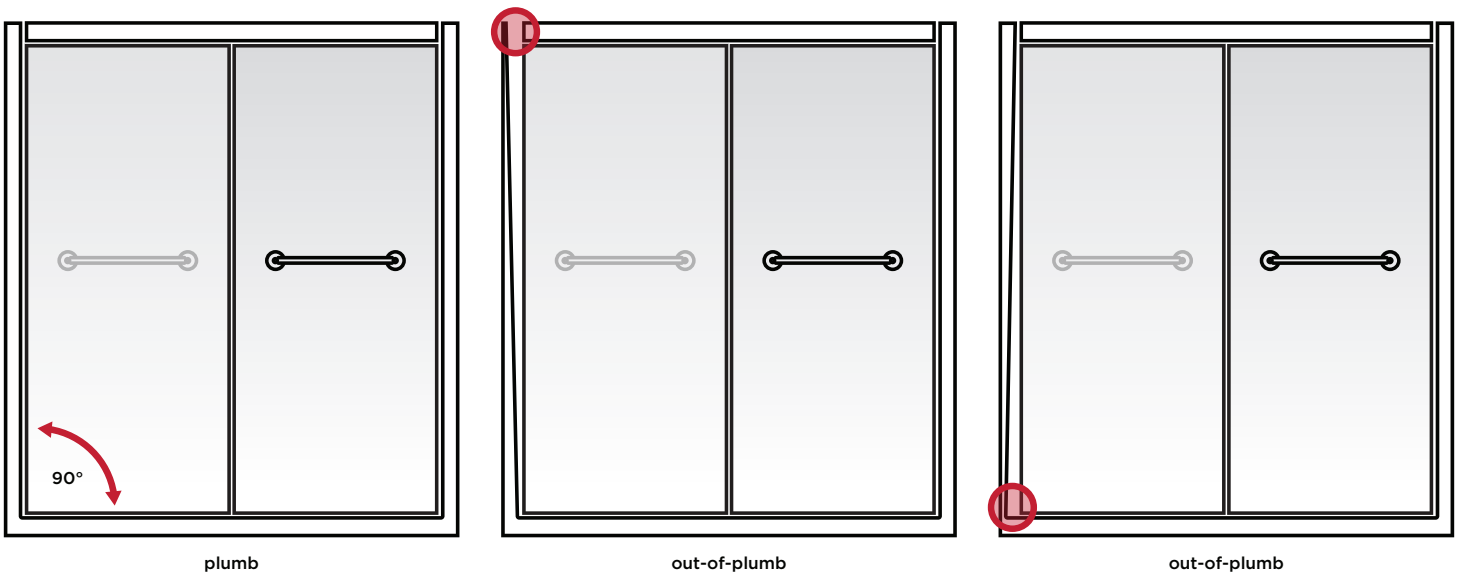

Most **Delta Shower Doors** are designed to accommodate out-of-plumb conditions up to 3/8". If your shower environment is out-of-plumb, simply adjust the placement of the roller to lower or raise the glass.

to lower the glass

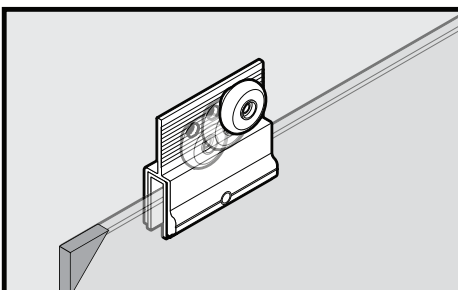

to raise the glass

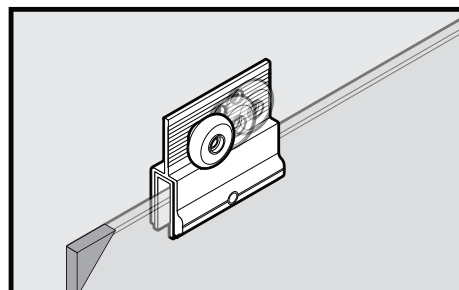

● common out-of-plumb locations

