

## ASSEMBLAGE

Assemblez complètement le produit avant de l'utiliser.

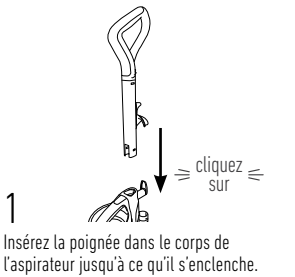

1 Insérez la poignée dans le corps de l'aspirateur jusqu'à ce qu'il s'enclenche.

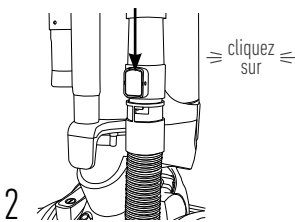

2 Insérez le tuyau dans l'orifice à cet effet. Vous entendrez un « clic » une fois qu'il sera fixé.

## FONCTIONNEMENT

### MISE EN GARDE:

N'utilisez pas l'aspirateur pour toiletter un animal.

### MISE EN GARDE:

Redoublez de prudence lorsque vous utilisez l'appareil dans un escalier. Pour éviter tout dommage ou blessure et empêcher l'appareil de tomber, placez toujours ce dernier au bas des escaliers ou sur le plancher. Ne placez pas l'appareil sur les marches d'un escalier ou sur un meuble, car cela peut entraîner des dommages ou des blessures. Lorsque vous utilisez des accessoires, assurez-vous que la poignée est toujours en position verticale.

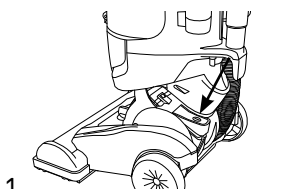

1 Appuyez sur la pédale d'alimentation avec un pied pour mettre l'appareil en marche ou hors tension.

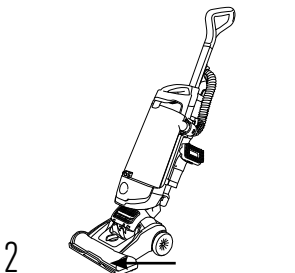

2 Appuyez sur la buse avec le pied et inclinez la poignée vers l'arrière.

## UTILISATION DU TUYAU ET DES ACCESSOIRES

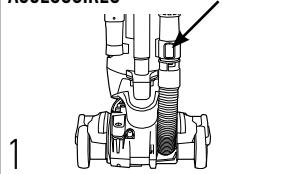

1 Assurez-vous que l'aspirateur est en position verticale et appuyez sur le bouton de dégagement du tuyau.

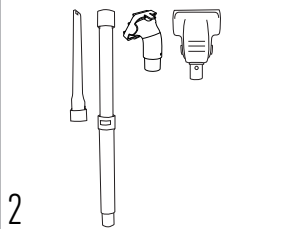

2 Retirez le tuyau et fixez l'accessoire souhaité. Le tube-rallonge télescopique peut être ajouté pour une portée supplémentaire.

## ENTRETIEN

### AVERTISSEMENT:

Débranchez l'appareil avant de le nettoyer ou d'en effectuer l'entretien afin de réduire le risque de blessures.

Ce produit ne contient pas de pièces réparables. Si l'appareil ne fonctionne pas comme il le devrait, est tombé, est endommagé, a été laissé à l'extérieur ou a pris l'eau, apportez-le à un centre de réparation ou communiquez avec le service à la clientèle au 1-800-944-9200 avant de continuer à l'utiliser.

### VIDAGE DU VIDE-POUSSIÈRE

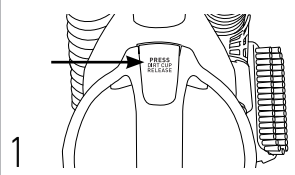

1 Appuyez sur le bouton de dégagement du vide-poussière.

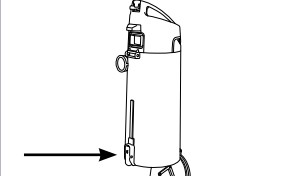

2 Videz-le au-dessus d'une poubelle en appuyant sur le bouton de dégagement de la trappe.

### NETTOYAGE DU FILTRE D'ÉCHAPPEMENT

N° DE PIÈCE 440014853

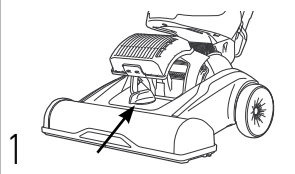

1 Inclinez l'aspirateur vers l'arrière, puis relâchez le loquet pour retirer le filtre d'échappement.

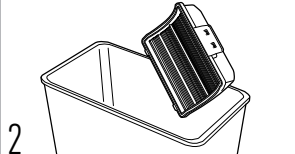

2 Tapotez le filtre sur la poubelle et essuyez la poussière restante à l'aide d'un chiffon sec. Remettez le filtre d'évacuation sur l'aspirateur.

## NETTOYAGE DU FILTRE LAVABLE

N° DE PIÈCE AH44200

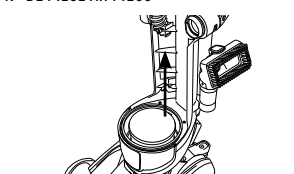

1 Retirez le vide-poussière, puis le filtre en le tirant vers le haut et l'extérieur.

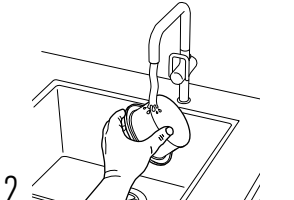

2 Rincez le filtre avec de l'eau uniquement jusqu'à ce que le filtre soit propre et que l'eau soit claire. Pressez doucement le filtre pour enlever l'excès d'eau.



3 Laissez l'ensemble du filtre sécher à l'air pendant au moins 24 heures.

**IMPORTANT :** Avant de le remettre en place, le filtre doit être complètement sec. Cela peut prendre entre 24 et 48 heures.

Vérifiez l'humidité à l'intérieur du filtre avant de le remplacer.

**LUBRIFICATION :** Le moteur et le rouleau-brosse sont dotés de roulements contenant une quantité suffisante de lubrifiant pour leur durée de vie. L'ajout de lubrifiant pourrait causer des dommages. C'est pourquoi vous ne devez pas ajouter de lubrifiant dans les roulements du moteur.

**RANGEMENT DU CORDON :** Enroulez le cordon autour des crochets destinés à cet effet avant de ranger l'appareil. Fixez la fiche au cordon.

## MISE EN GARDE:

Débranchez l'appareil avant d'en effectuer l'entretien afin de réduire le risque de blessures présenté par les pièces en mouvement.

### COMMENT REMPLACER LA COURROIE ET NETTOYER LE ROULEAU-BROSSÉ

ROULEAU-BROSSE N° DE PIÈCE 440014833

COURROIE N° DE PIÈCE AH20080

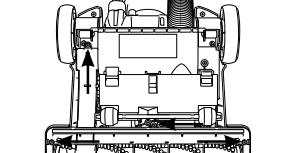

1 Retirez les sept vis pour enlever le protège-buse.

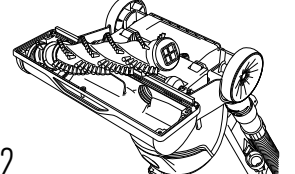

2 Tirez le rouleau-brosse vers le haut et hors de la courroie de l'aspirateur.

3 Coupez les cheveux emmêlés et ôtez tous les débris.

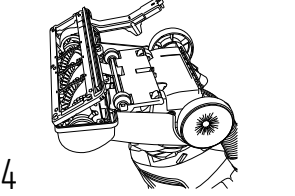

4 Pour remplacer le rouleau-brosse, enroulez la courroie autour du rouleau-brosse et poussez-le en place. Remplacez le protège-buse et les sept vis.

**ASTUCE :** Faites tourner le rouleau-brosse manuellement afin de vous assurer que la courroie est bien installée. L'aspirateur est doté d'un système d'arrêt automatisé du rouleau-brosse en cas de surcharge ou de blocage. Vérifiez s'il y a des obstructions dans la zone du rouleau-brosse et retirez-les le cas échéant. Lorsque les obstructions sont dégagées, reprenez le travail normalement.

## AVERTISSEMENT:

Débranchez l'appareil avant de le nettoyer ou d'en effectuer l'entretien afin de réduire le risque de blessures.

### RETRAIT DES OBSTRUCTIONS DANS LE SYSTÈME

Si vous rencontrez une perte d'aspiration ou que vous remarquez des débris jaillir de la buse, nous vous recommandons de vérifier la buse, le tube, le tuyau et les filtres pour déceler tout signe visible d'obstruction ou d'accumulation de débris. Il est également recommandé de rincer le filtre s'il y a une accumulation de saleté et de poussière sur le filtre. Cela devrait aider à améliorer le rendement de votre aspirateur.

### PROTECTION THERMIQUE

Votre appareil est équipé d'un rupteur thermique interne afin de le protéger contre la surchauffe. L'appareil cessera de fonctionner si ce rupteur thermique s'active. Voici ce qu'il faut faire lorsque ceci survient :

1. Mettez l'appareil hors tension et débranchez-le.
2. Videz le vide-poussière.
3. Inspectez l'orifice de la buse, le connecteur, le tuyau, le manchon du vide-poussière, le filtre cyclonique, le filtre lavable et le filtre d'échappement pour déceler toute obstruction. Dégagez toutes les obstructions visibles.
4. Lorsque l'appareil est hors tension et que le moteur a refroidi pendant 30 minutes, le rupteur thermique se désactivera et vous pourrez poursuivre le nettoyage.

Votre appareil devra être réparé si le rupteur thermique se réinitialise constamment après avoir respecté les étapes ci-dessus.



## HIGH PERFORMANCE SWIVEL PET VACUUM

### USER MANUAL

MODEL: UH75120

Please visit [Hoover.com](http://Hoover.com) for video instructions and FAQ's for this Vacuum Cleaner.

IMPORTANT: READ ALL INSTRUCTIONS CAREFULLY BEFORE ASSEMBLY AND USE.

This product is intended for Household use only. If used Commercially warranty is VOID.

Questions or concerns?

For assistance, please call Customer Service at 1-800-944-9200 Mon-Fri 9am-6pm EST before returning this product to the store.

## IMPORTANT SAFETY INSTRUCTIONS SAVE THESE INSTRUCTIONS

READ ALL SAFETY WARNINGS AND INSTRUCTIONS BEFORE USING THIS PRODUCT.

**WARNING:** When using an electrical product, basic precautions should always be followed to avoid electric shock, fire, and/or serious injury, including the following:

- Fully assemble before operating.
- Operate cleaner only at voltage specified on data plate on back of cleaner.
- Do not leave product when plugged in. Unplug from outlet when not in use and before servicing.
- Do not use outdoors or on wet surfaces.
- Do not allow to be used as a toy. Not intended for use by children age 12 and under. Close supervision is necessary when used by or near children. To avoid injury or damage, keep children away from product, and do not allow children to place fingers or other objects into any openings.
- Use only as described in this user's manual. Use only HOOVER® recommended attachments.
- Do not use product with damaged cord or plug. If product is not working as it should, has been dropped, damaged, left outdoors, or dropped into water, call customer service at 1-800-944-9200 prior to continuing use.
- Do not pull or carry by cord, use cord as a handle, close a door on cord, or pull cord around sharp edges or corners. Do not run appliance over cord. Keep cord away from heated surfaces.
- Do not unplug by pulling on cord. To unplug, grasp the plug, not the cord.
- Do not handle plug or appliance with wet hands.
- Do not put any object into openings. Do not use with any opening blocked; keep free of dust, lint, hair, and anything that may reduce air flow.
- Keep hair, loose clothing, fingers, and all parts of body away from openings and moving parts.
- Turn off all controls before unplugging.
- Use extra care when cleaning on stairs. To avoid personal injury or damage, and to prevent the cleaner from falling, always place cleaner at bottom of stairs or on floor. Do not place cleaner on stairs or furniture, as it may result in injury or damage.
- Do not use to pick up flammable or combustible liquids, such as gasoline, or fine wood sandings, or use in areas where they may be present.
- Unplug before connecting Turbo Tool.
- Do not pick up anything that is burning or smoking, such as cigarettes, matches, or hot ashes.
- Do not use without separator, filters, or dirt cup in place.

**CAUTION: TO REDUCE THE RISK OF DAMAGE:**

- Avoid picking up hard, sharp objects with this product, as they may cause damage
- Store appropriately indoors in a dry place. Do not expose machine to freezing temperatures.
- Brush roll continues to turn while product is turned on and handle is in upright position. To avoid damage to carpet, rugs, and flooring, avoid tipping cleaner or setting it on furniture, fringed area rugs, or carpeted stairs during tool use.

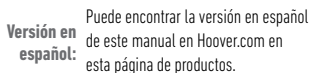
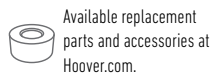
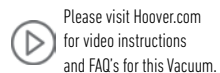
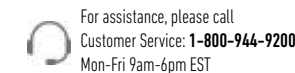

- Do not use sharp objects to clean out hose as they can cause damage.
- With brush roll on, do not allow cleaner to sit in one location for an extended period of time, as damage to floor can result.

**WARNING:** TO REDUCE THE RISK OF ELECTRIC SHOCK, THIS APPLIANCE HAS A POLARIZED PLUG (ONE BLADE IS WIDER THAN THE OTHER). THIS PLUG WILL FIT IN A POLARIZED OUTLET ONLY ONE WAY. IF THE PLUG DOES NOT FIT FULLY IN THE OUTLET, REVERSE THE PLUG. IF IT STILL DOES NOT FIT, CONTACT A QUALIFIED ELECTRICIAN TO INSTALL THE PROPER OUTLET. DO NOT CHANGE THE PLUG IN ANY WAY.

## WARRANTY

LIMITED WARRANTY FOR HOOVER® PRODUCT / FIVE YEAR LIMITED WARRANTY (DOMESTIC USE)

If this product is not as warranted, contact TTI Floor Care North America Customer Service at 1-800-944-9200. Please have available the proof of purchase and model number for the warranted product.

**WHAT THIS WARRANTY COVERS:** This limited warranty provided by Royal Appliance Mfg. Co., doing business as TTI Floor Care North America (referred to hereafter as "Warrantor") applies only to products purchased in the U.S. (including its territories and possessions), a U.S. Military Exchange, or Canada. When used and maintained in normal household use and in accordance with the Owner's Guide, this product is warranted against original defects in material and workmanship for FIVE years from the date of original purchase (the "Warranty Period"). If Warrantor determines that the issue you are experiencing is covered under the terms of this warranty (a "covered warranty claim"), we will, at our sole discretion and free of charge (subject to the cost of shipping), either (i) repair your product; (ii) ship you a replacement product, subject to availability; or (iii) in the event that the applicable parts or replacement are not reasonably available, ship you a similar product of equal or greater value. In the unlikely event that we are unable to repair your product or ship a replacement or similar product, we reserve the right, at our sole discretion, to issue you a refund or store credit (if applicable) of the actual purchase price at the time of the original purchase as reflected on the original sales receipt. Parts and replacements may be new, refurbished, lightly used, or remanufactured, in Warrantor's sole discretion.

**WHO THIS LIMITED WARRANTY COVERS:** This limited warranty extends only to the original retail purchaser, with original proof of purchase from Warrantor or an authorized dealer of Warrantor products, in the U.S., U.S. Military Exchanges, and Canada.

**WHAT THIS WARRANTY DOES NOT COVER:** This warranty does not cover use of the product in a commercial operation (such as maid, janitorial, and equipment rental services, or any other income-generating activity); improper maintenance of the product; the product if it has been subject to misuse, negligence, neglect, vandalism, or the use of voltages other than that on the data plate of this product. This warranty does not cover damage resulting from an act of God, accident, owner's acts or omissions, service of this product by other than Warrantor or a Warrantor authorized service provider (if applicable), or other acts beyond the control of Warrantor. This warranty also does not cover use outside the country in which the product was initially purchased, or resale of the product by the original owner. Pick-up, delivery, transportation, and house calls are not covered by this warranty. In addition, this warranty does not cover any product that has been altered or modified, or repairs made necessary by normal wear or the use of other products, parts, or accessories which are either incompatible with this product or adversely affect this product's operation, performance, or durability. Normal wear items are not covered under this warranty. Depending on the product, normal wear items may include, but are not limited to, belts, filters, brush rolls, blower fans, blower and vacuum tubes, and vacuum bags and straps.

**OTHER IMPORTANT TERMS:** This warranty is not transferable and may not be assigned; any assignment made in contravention of this prohibition is void. This warranty shall be governed and construed under the laws of the state of North Carolina. The Warranty Period will not be extended by any replacement of batteries, parts, or products or by virtue of any repair performed under this warranty.

THIS LIMITED WARRANTY IS THE EXCLUSIVE WARRANTY AND REMEDY, AND ALL EXPRESS AND IMPLIED WARRANTIES OTHER THAN THE LIMITED WARRANTY SET FORTH ABOVE, INCLUDING IMPLIED WARRANTIES OF MERCHANTABILITY AND FITNESS FOR A PARTICULAR PURPOSE, ARE EXPRESSLY DISCLAIMED. IN NO EVENT WILL WARRANTOR BE LIABLE FOR ANY SPECIAL, INDIRECT, INCIDENTAL OR CONSEQUENTIAL DAMAGES OF ANY KIND OR NATURE TO OWNER OR ANY PARTY CLAIMING THROUGH OWNER, WHETHER BASED IN CONTRACT, NEGLIGENCE, TORT, OR STRICT PRODUCTS LIABILITY OR ARISING FROM ANY CAUSE WHATSOEVER, EVEN IF THIS WARRANTY FAILS OF ITS ESSENTIAL PURPOSE. TO THE EXTENT PERMITTED BY APPLICABLE LAW, NO WARRANTIES THAT ARISE BY OPERATION OF LAW, IF APPLICABLE, SHALL EXCEED THE DURATION OF THE LIMITED WARRANTY PROVIDED HEREIN. Warrantor's liability for damages to you for any costs whatsoever arising out of this statement of limited warranty shall be limited to the amount paid for this product at the time of original purchase.

Some states do not allow the exclusion or limitation of incidental or consequential damages, disclaimers of implied warranties, or limitations on the duration of implied warranties, so the above exclusions, disclaimers, and/or limitations may not apply to you. This warranty gives you specific legal rights, and you may also have other rights, which vary from state to state.

**GENUINE PARTS AND ACCESSORIES:** We recommend using only with genuine HOOVER® parts, and accessories. Damage caused by use with other than genuine HOOVER® parts, and accessories is not covered by and may void your warranty.



