



Item #658493

Model #ADH04302K01

USE AND CARE GUIDE

NILES PARK ADJUSTABLE CHAISE LOUNGE

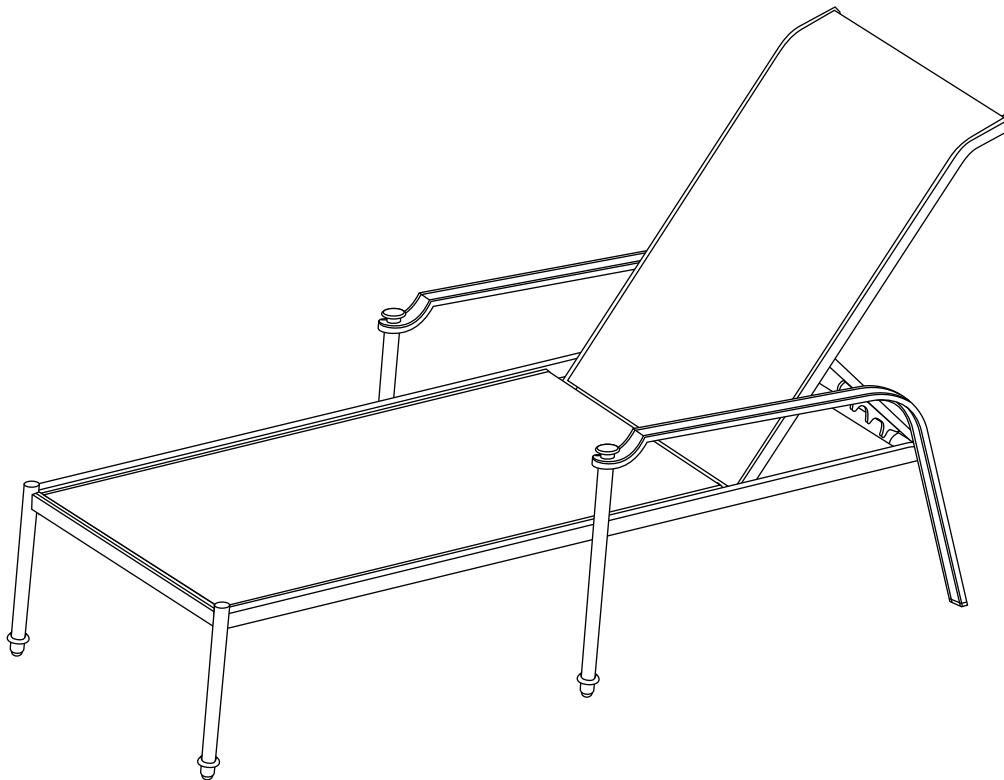

Questions, problems, missing parts? Before returning to the store,
call Hampton Bay Customer Service
8 a.m. - 6 p.m., EST, Monday - Friday

1-855-HD-HAMPTON

HAMPTONBAY.COM

THANK YOU

We appreciate the trust and confidence you have placed in Hampton Bay through the purchase of this chaise.

We strive to continually create quality products designed to enhance your home.

Visit us online to see our full line of products available for your home improvement needs.

Thank you for choosing Hampton Bay!

Table of Contents

Table of Contents.....	2	Assembly.....	5
Warranty	2	Maintenance	6
What is Covered	2	Care and Cleaning	6
What is Not Covered	2		
Pre-Assembly	3		
Planning Assembly.....	3		
Hardware Included.....	3		
Package Contents.....	4		

Warranty

3 Year Frame / 2 Year Fabric Limited Warranty

What is Covered

We warrant the frame to be free of manufacturing defects to the original purchaser for three years and the fabric for two years.

What is Not Covered

It remains the customer's responsibility for freight and packaging charges to and from our service center. This warranty does not cover commercial use, hardware, acts of nature, fire, freezing and abusive use. In addition, purchased parts are not covered under this warranty. We reserve the right to make substitutions with similar merchandise, if the model in question is no longer in production.

Contact Customer Care at 1-855-HD-HAMPTON or visit www.HamptonBay.com.

Pre-Assembly

PLANNING ASSEMBLY

Identify all parts packed in the carton against the parts list. Remove all protective materials. Place parts on a non-abrasive surface to avoid scratching. If you are missing any parts or are unsure how to proceed with the assembly, call our Customer Service Team at 1-855-HD-HAMPTON. Do not attempt assembly if any parts are missing or damaged.

Two people may be required to assemble the chaise.

Damage to welds or frames resulting from over tightened bolts or improper assembly is not covered under our warranty. Please read all instructions carefully before assembly. If you have any questions regarding your assembly, call our Customer Service Team at 1-855-HD-HAMPTON.

HARDWARE INCLUDED



NOTE: Hardware not shown to actual size.

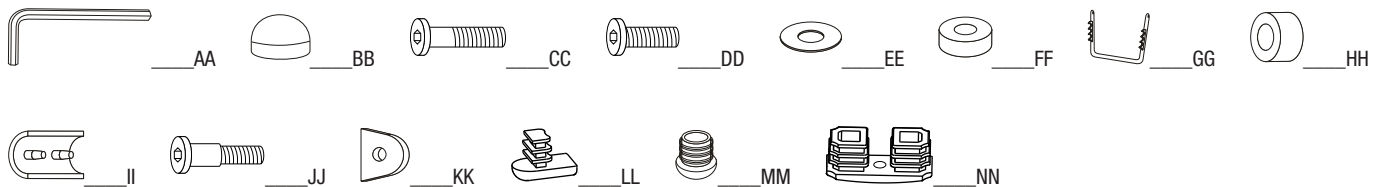

Part	Description	Order Part #	Quantity
AA	Hex Bolt Driver	HW0006	1
BB	Bolt Cover	HW0105	8
CC	1/4 in. x 45 mm Bolt	HW0793	2
DD	1/4 in. x 20 mm Bolt	HW0036	8
EE	Ø6.5 x 1.0 mm Washer	HW0004	10
FF	Ø20 x 9 mm Plastic Washer	HW0482	2
GG	Adjustment Bar (Preassembled)	AL1501	1
HH	Adjustment Bar Washer (Preassembled)	HW0129	2
II	Bumper (Preassembled)	HW0078	2
JJ	Adjustment Bar Bolt (Preassembled)	HW0710	2
KK	Adjustment Bar Cover (Preassembled)	HW0509	2
LL	Sling Tube Cap (Preassembled)	FC0005	8
MM	Front Foot Cap (Preassembled)	FC0033	4
NN	Back Foot Cap (Preassembled)	FC0621	2

Pre-Assembly (continued)

PACKAGE CONTENTS

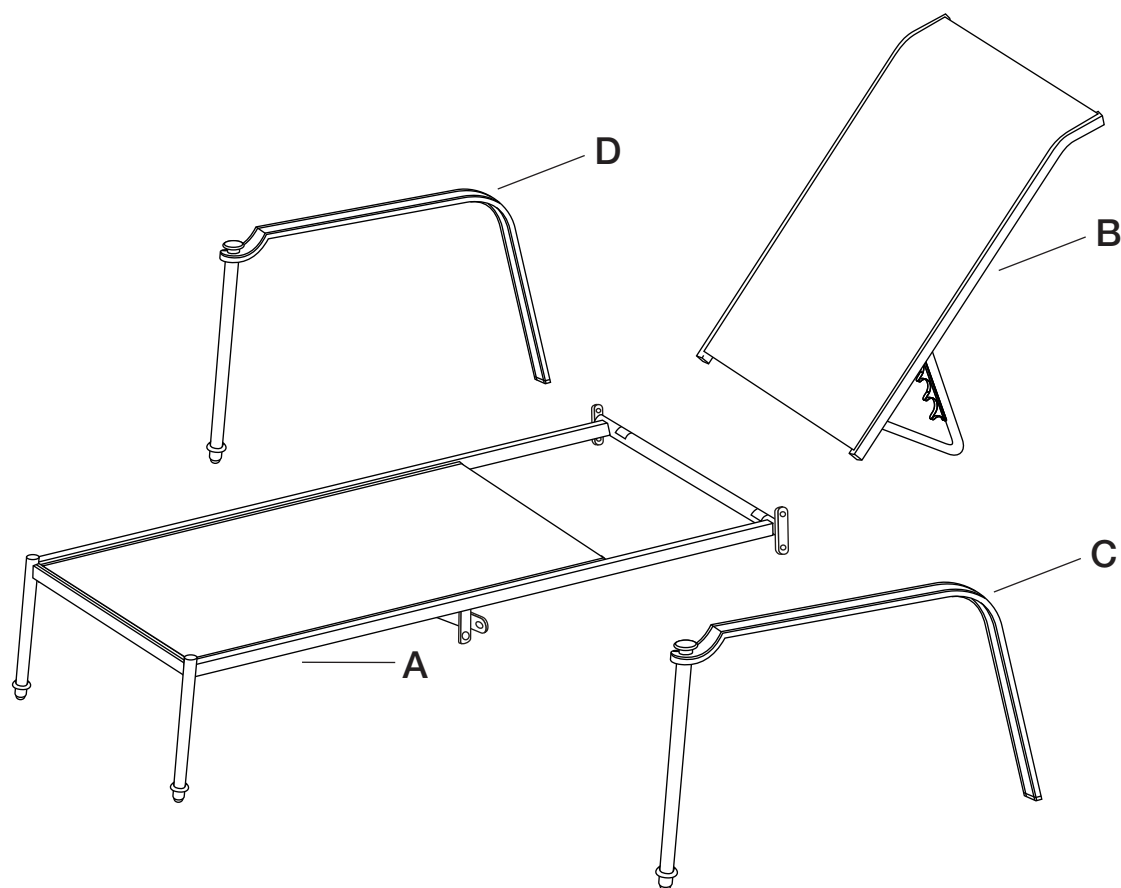

Part	Description	Order Part #	Quantity
A	Sling Seat Frame	AL1497	1
B	Sling Back Frame	AL1498	1
C	Left Leg	AL1499	1
D	Right Leg	AL1500	1

Assembly



Important note: The basic assembly of the chaise lounge is to attach the back frame to the lounge frame. We recommend two people work together to line up the holes on the back frame with the fixed nut holes on the lounge frame to ensure the bolts are on a straight, direct path. Starting the bolts at an angle could cause cross threading which will ruin the entire lounge frame.

1 Assembling the sling seat frame

- Attach the left arm (C) to the sling seat frame (A) by using the four bolts (DD) and washers (EE).
- Guide the bolt (DD) through the hole in the sling seat frame (A) and into the pre-drilled hole in the left arm (C).
- Hand tighten three to four turns only. (Do not tighten completely.)
- Repeat for the right arm (D).

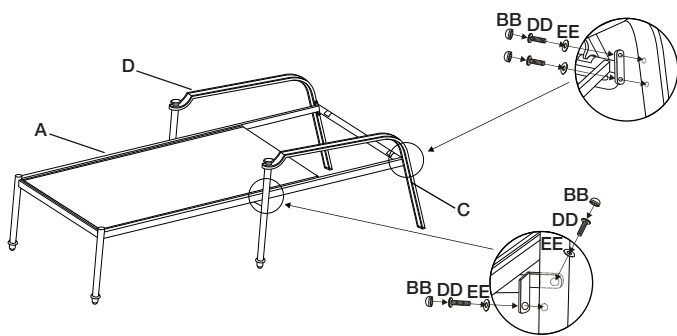

2 Assembling the chaise back

- From behind the chaise lounge back frame (B), add a washer (EE) to the bolt (CC) and insert the bolt (CC) through the hole in the lower sling back frame (B).
- Add a plastic washer (FF) before inserting it into the fixed nut inside the sling seat frame (A).
- Hand tighten 2-3 turns only. (Do not tighten completely.)
- Repeat on the opposite side.

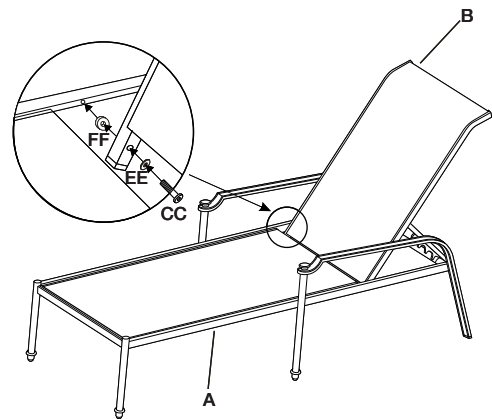

Important note: Each bolt must be tightened a few turns at a time. Start with a bolt on one side and then move to the bolt on the opposite side. Continue this method of turning each bolt a few times until lounge frame and sling evenly. Do not over tighten. Over tightening may damage the threads on the bolts and the entire chaise lounge.

3 Tightening the bolts

- Using the hex bolt driver (AA) provided, tighten all bolts and add bolt covers (BB).

Maintenance

FRAME:

Periodically clean and dry thoroughly. Be sure to drain any water accumulated inside the frames. To thoroughly drain the frames, remove the foot caps and tilt the frames, if necessary, to remove all water. This is critical. Water allowed to accumulate inside the frames and then exposed to sub-freezing temperatures can cause damage to the frame tubing. Such damage is not covered under the warranty. Always clean, drain, and dry thoroughly before storing for the winter. For best results, always store or cover your furniture when not in use. We recommend commercially available outdoor furniture covers. Any small nicks or scratches can be covered with a light application of touchup paint.

FABRIC (CUSHIONS/SLINGS):

The best way to maintain the beauty of cushions and slings is to store them in a dry area and out of the elements when not in use or cover with commercially available outdoor furniture covers.

Care and Cleaning

FRAME:

Use mild soap and warm water. Do not use abrasive materials, cleansers, or bleach products. Rinse with clean water and dry thoroughly.

FABRIC (CUSHIONS/SLINGS):

Wipe minor spills immediately. Clean with mild soap, warm clean water, and a soft cloth. Do not use abrasive materials, cleansers, or bleach products. Although fabric has been treated to resist stains, occasional use of commercially available fabric cleaners may be necessary. Follow the manufacturer's instructions.



Questions, problems, missing parts? Before returning to the store,
call Hampton Bay Customer Service
8 a.m. - 6 p.m., EST, Monday - Friday

1-855-HD-HAMPTON

HAMPTONBAY.COM

Retain this manual for future use.