



Over the door ironing board



PLEASE READ INSTRUCTIONS CAREFULLY BEFORE ASSEMBLY
SIGA LAS INSTRUCCIONES CON ATENCIÓN ANTES DE ARMAR

PARTS INCLUDED:

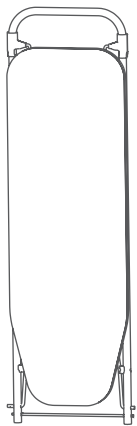
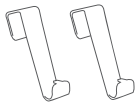

**NO ADDITIONAL
TOOLS REQUIRED**

**HERRAMIENTAS
ADICIONALES
NECESARIAS**

1.

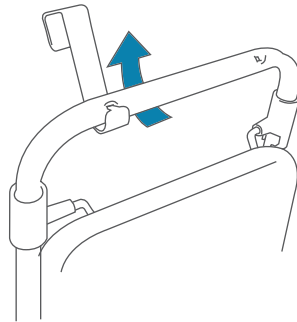

Insert the tab on the hanger brackets into the slots at the top of the frame. Then, pull on the hanger brackets to lock in place

2.

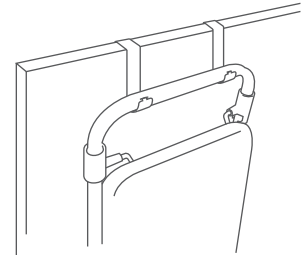

To prevent the hanger brackets from marring the door, a piece of heavy paper or fabric should be placed over the top edge of the door before hanging the board in place. Hang the board over the top of the door. Pull down firmly to be sure the hanger brackets are fully seated on the top of the door.

3.

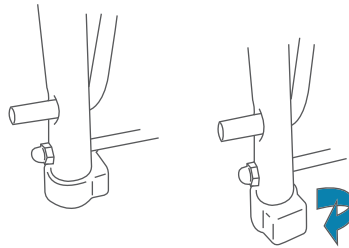

Locate the 2 plastic bumpers at bottom of plastic poles. Rotate each bumper 90 degrees so flat side rests against door.

4.

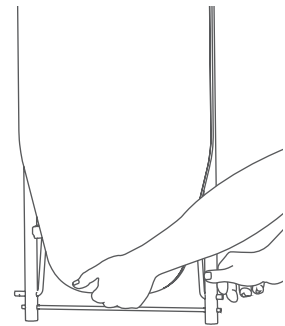

Place hand on frame and push securely towards door while pulling nose of board away from door with other hand.

OPENING BOARD

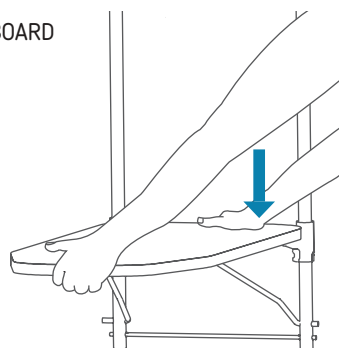

Once board is fully extended, push firmly down on rear until board fully engages. Board is ready for ironing.

CLOSING BOARD

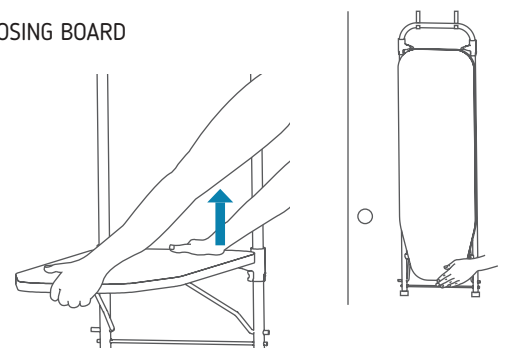

Place one hand on the nose of the board while pulling up on rear of board to disengage. Slide board upward until it locks into place.

For help assembling this product, or if you find that parts are missing, please contact our customer service department at 1-800-457-9881 Monday through Friday 8am-5pm CST or e-mail us at homzinfo@homzproducts.com

Para obtener ayuda para ensamblar este producto, o si le faltan piezas, llame a nuestra línea de atención al cliente 1-800-457-9881 de lunes a viernes de 8am-5pm CST o escribanos por correo electrónico en homzinfo@homzproducts.com

WWW.HOMZPRODUCTS.COM