

Let's build the

Daisy Desk

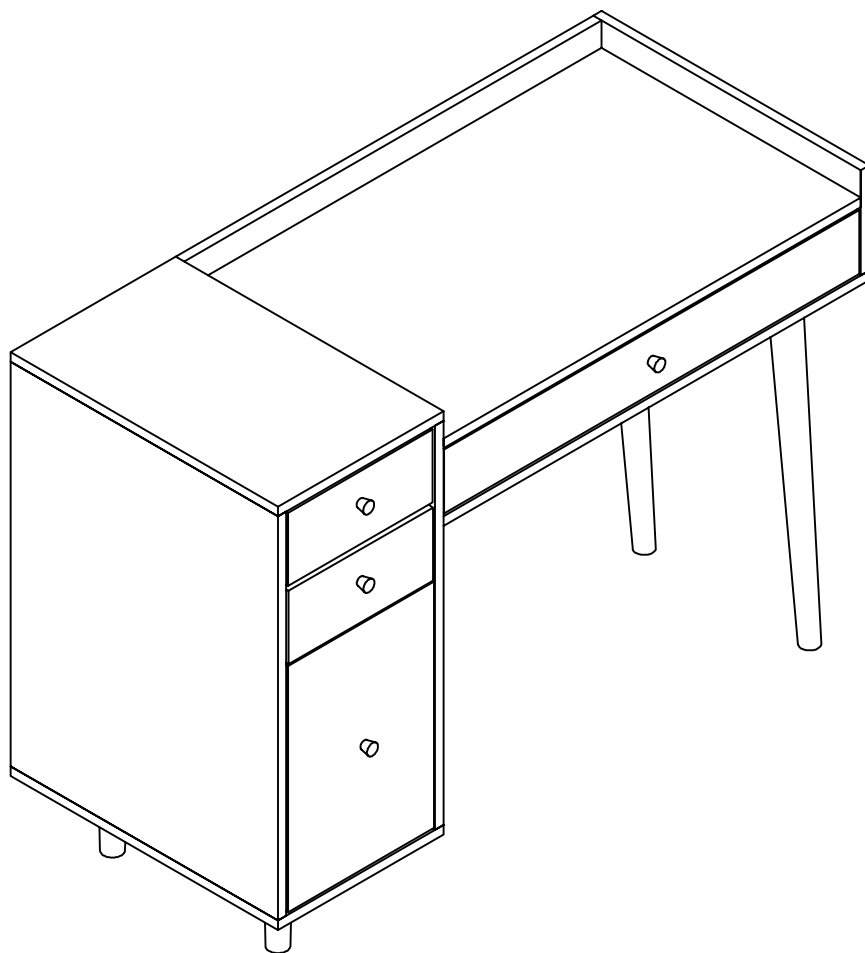

Scan me!

Inspiration
Digital Instructions
Free Lifetime Warranty

nathan james

21-0903

Ok, let's get rolling

This should be easy, just follow our instructions and you will be back to Netflix in no time.

Estimated time for assembly



60:00

What you need

- Some of your favourite bubbly or your preferred relaxant
- Use the packaging carton as a working surface to prevent product damage during assembly
- Phillips head screwdriver

Do not use a drill



Weight Limitation



66
lbs

Toll-free at 1-866-619-1004
Help@nathanjames.com
Nathanjames.com/help

What's included

Description	Qty
A Table Top	1
B Middle Support Panel	1
C Right Side Panel	1
D Back Panel	1
E Bottom Deck Panel	1
F Top Panel	1
G Left Side Panel	1
H Particle Panel	1
I Cross Bar	1
J Bottom Panel	1
K Door Panel	1
L Left Back Panel	1

Scan me!

Inspiration
Digital Instructions
Free Lifetime Warranty



What's included (continued)

Description		Qty
M	Left Leg	2
N	Right Leg	2
O	Support Crossbar	1
P	Big Drawer Back	1
Q	Big Drawer Ride Side Panel	1
R	Big Drawer Left Side Panel	1
S	Drawer Support Panel	1
T	Big Drawer Bottom	1
U	Big Drawer Front	1
V	Small Drawer Back	2
W	Small Drawer Right Side Panel	2
X	Small Drawer Left Side Panel	2
Y	Small Drawer Bottom	2
Z	Small Drawer Front	2



The goods

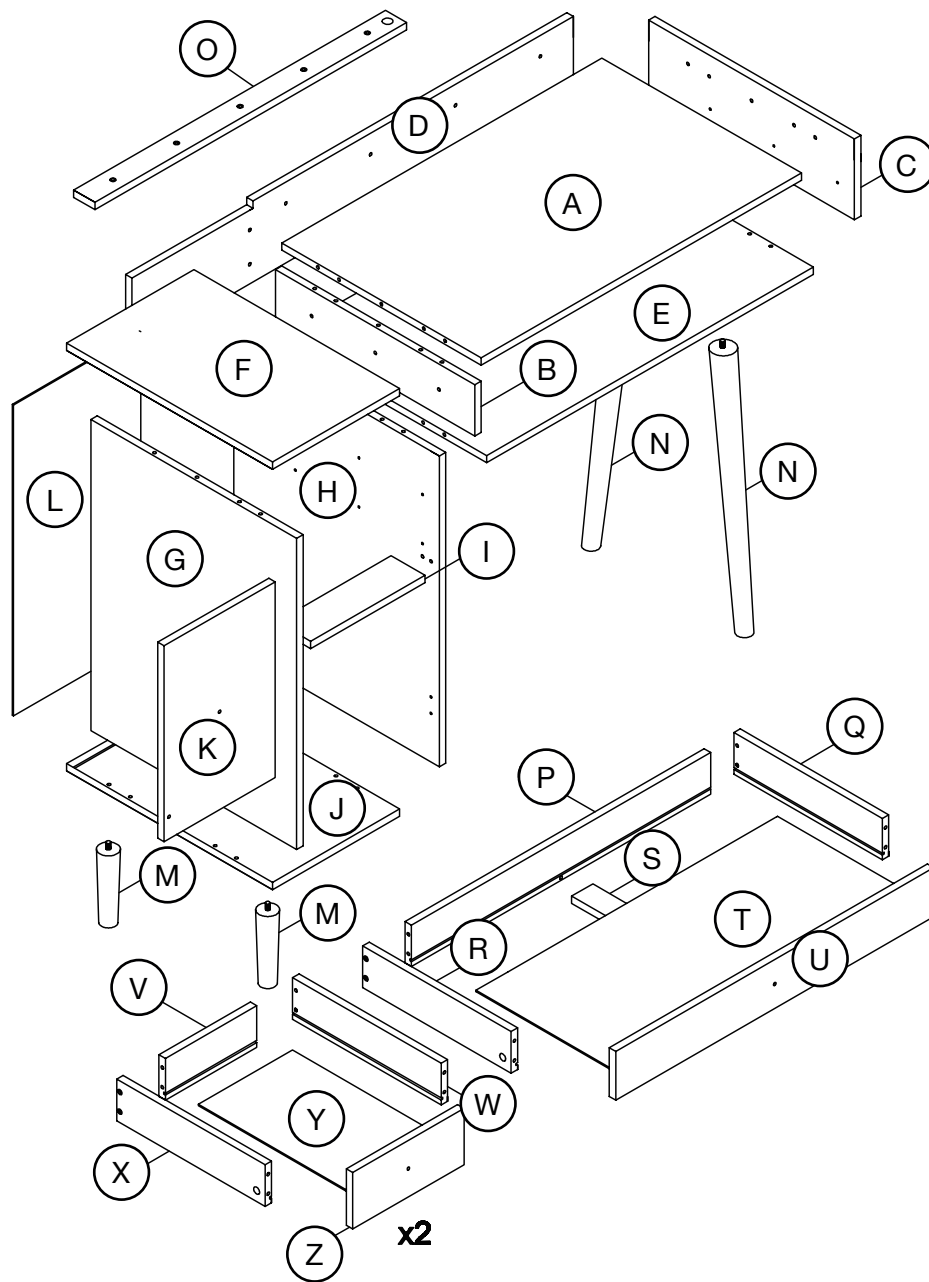

IMPORTANT

1. Do not tighten bolts / screws completely until all bolts / screws are lined up and inserted into holes.
2. Do not over tighten screws and bolts to avoid stripping.
3. Please use hand tools to assemble this product. Do not use power tools.



What's included

Description		Qty	Description		Qty
1	M5X35 MM cam bolt	23	15	Right side drawer slide	23
2	Cam Lock	23	16	Metal hinge	2
3	M6*30 MM wooden dowel	28	17	M4*12 MM screw	2
4	M4*35 MM screw	43	18	Wall anchor	4
5	M4*20 MM screw	8	19	Magnetic piece	1
6	3.5*12 MM screw	36	20	Iron	1
7	M4*16 MM bolt	4	21	M3*14 MM screw	3
8	Handle	4			
9	Eva pad	4			
10	Hinger	2			
11	M4*14 MM screw	8			
12	Left side panel slide	3			
13	Left side drawer slide	3			
14	Right side panel slide	3			



The goods

1



2



3

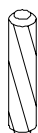

4



5



6



7



8

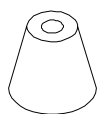

9



10

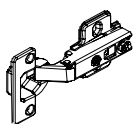

11



12

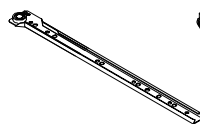

13

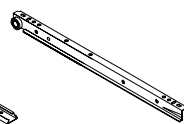

14

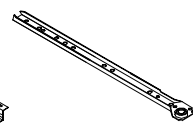

15

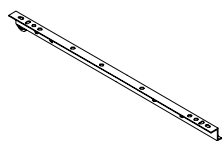

16

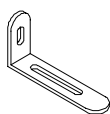

17

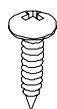

18

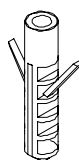

19

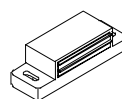

20



21



Step 1

Lay down packaging or carpet as a working surface and let's fire this thing up!

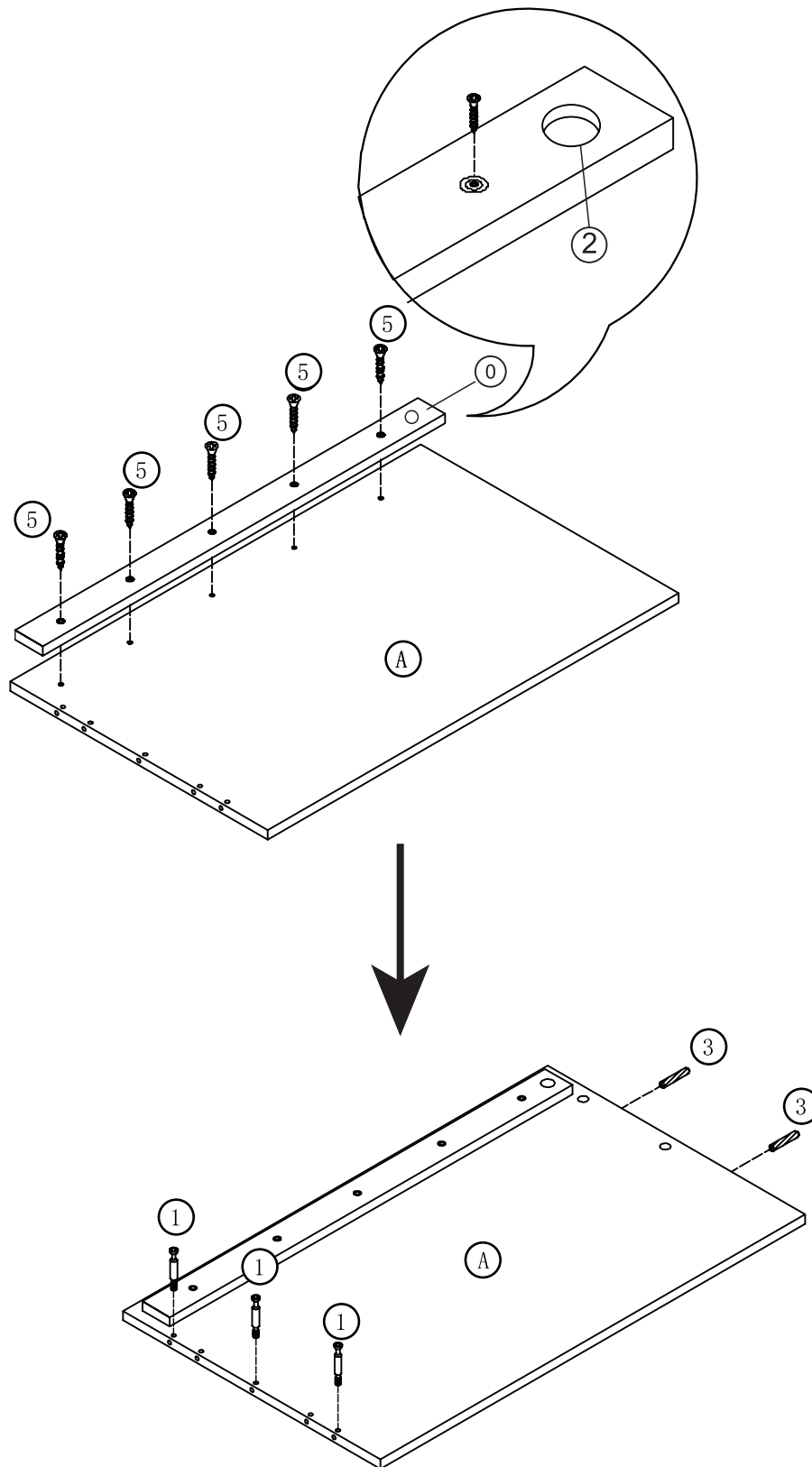

Step 2

Secure the left side panel slide (12) to the middle support panel (B) and the right side panel slide (14) to the right side panel (C).

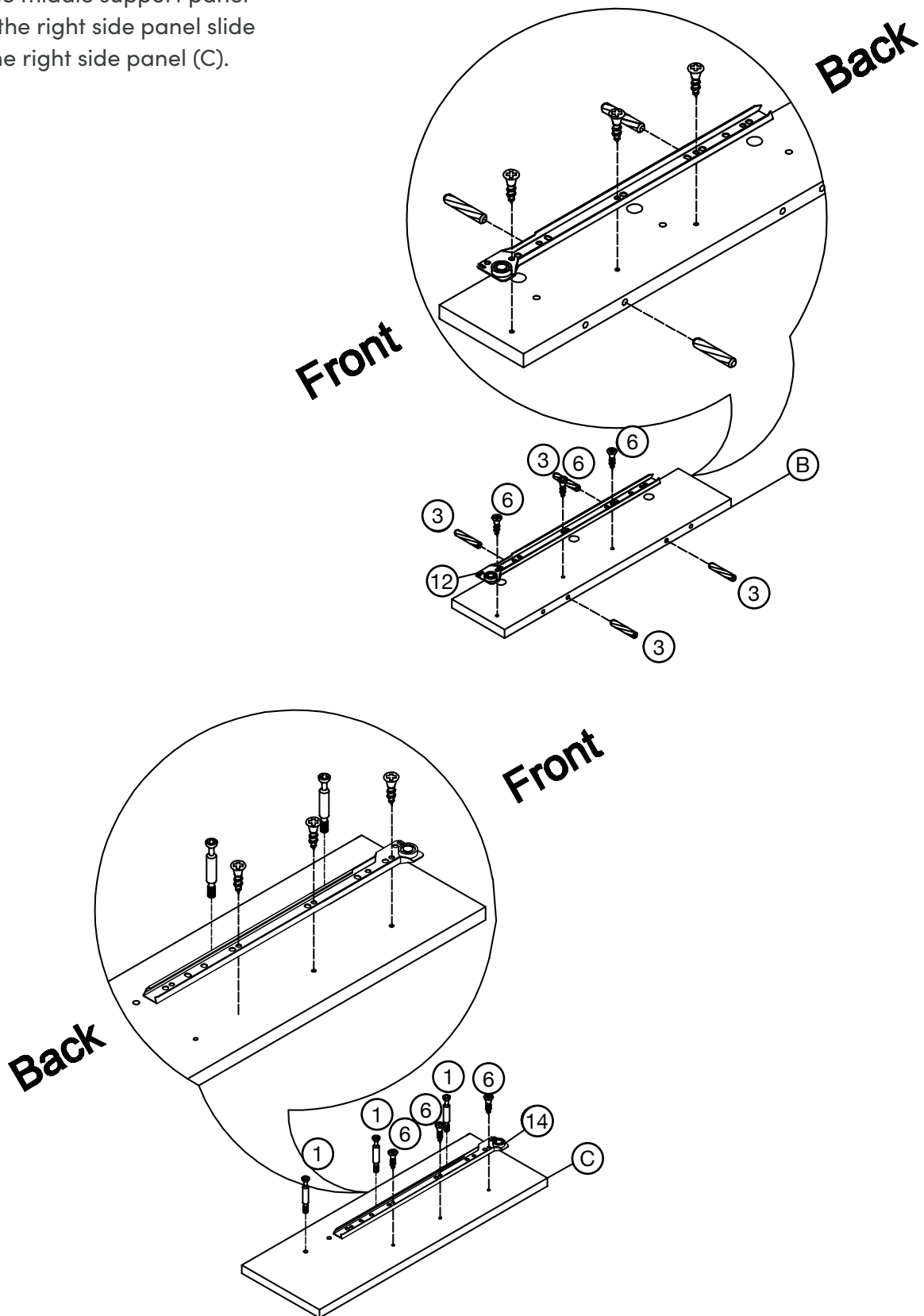

Step 3

Secure the right side panel to the table top.

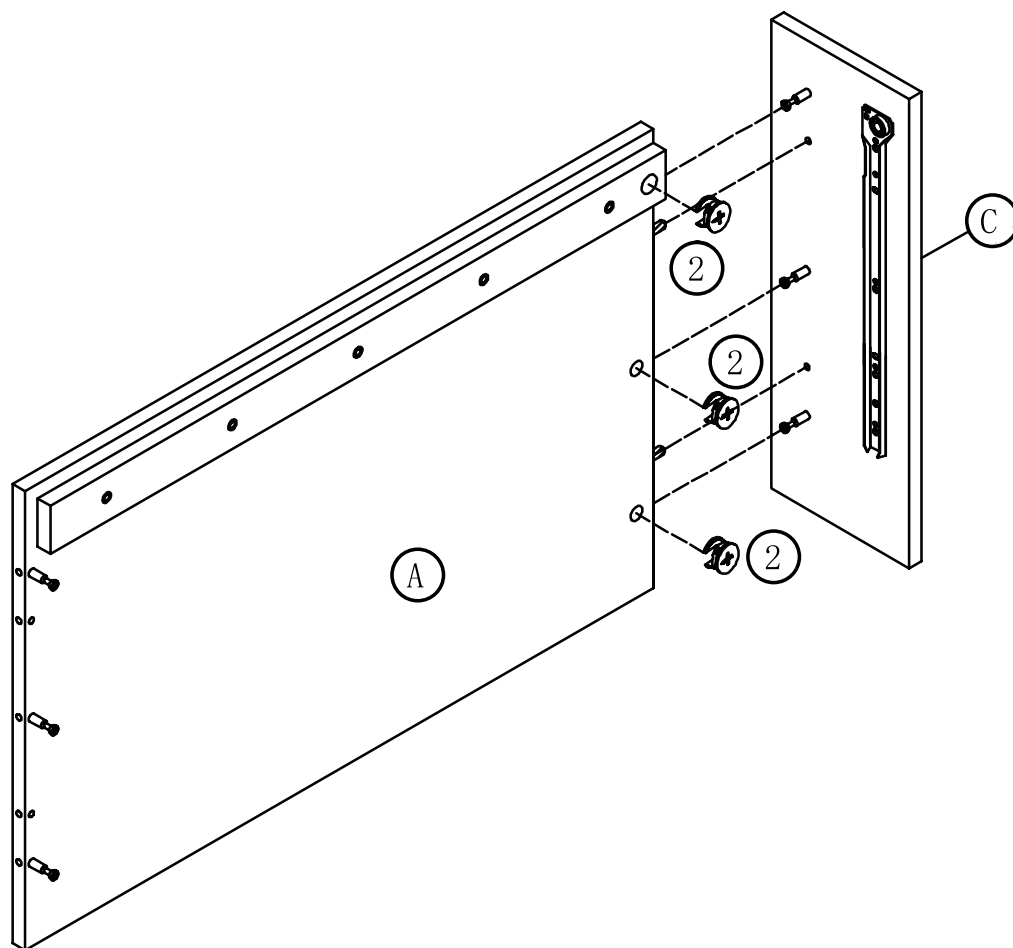

Step 4

Attach the middle support panel to the table top.

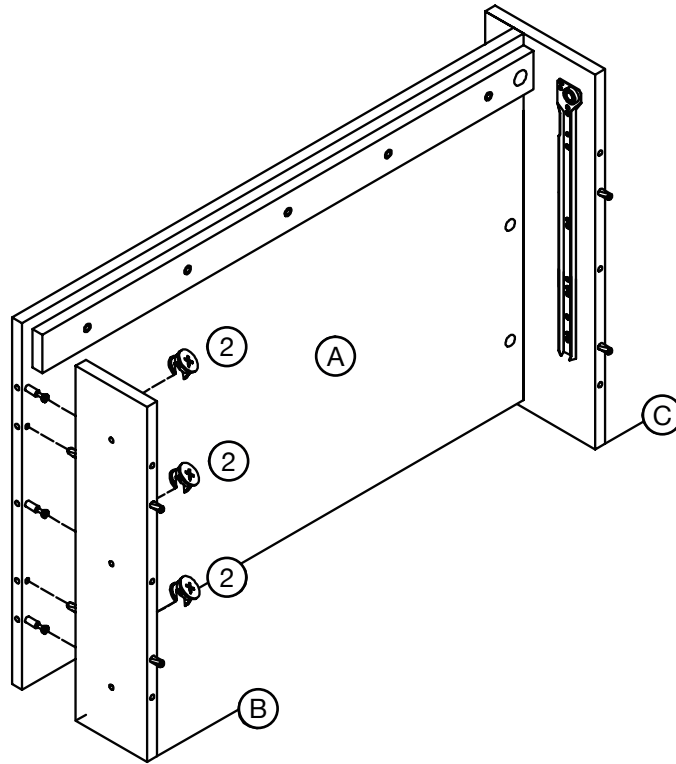

Secure the bottom deck panel.

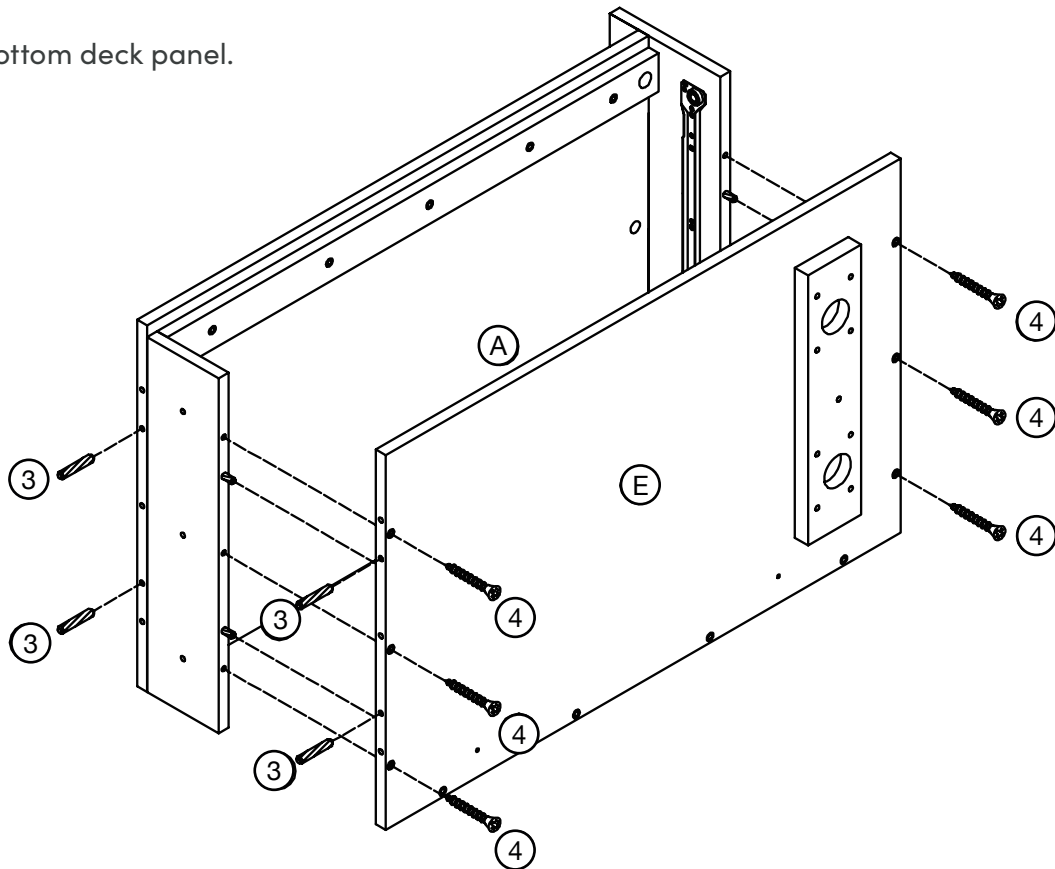

Step 5

Screw in the back panel on the top and the sides.

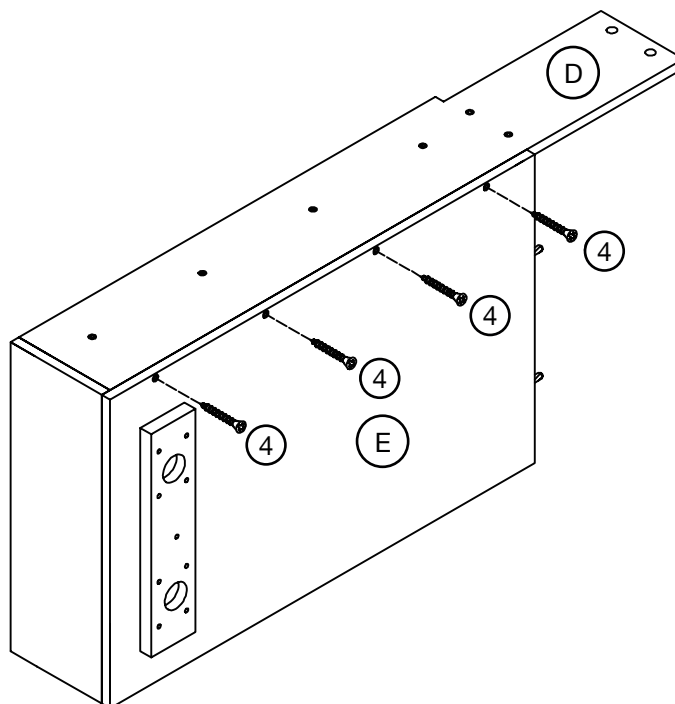
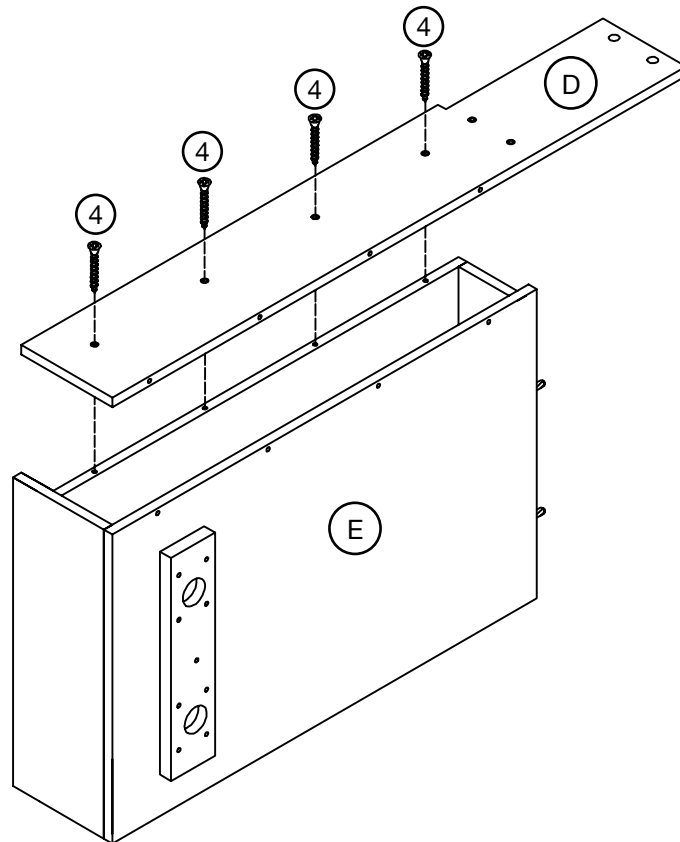

Step 6

Tip from a friend to a friend: be extra aware of screwing in the side panels correctly. Make note of which way the front and the back goes.

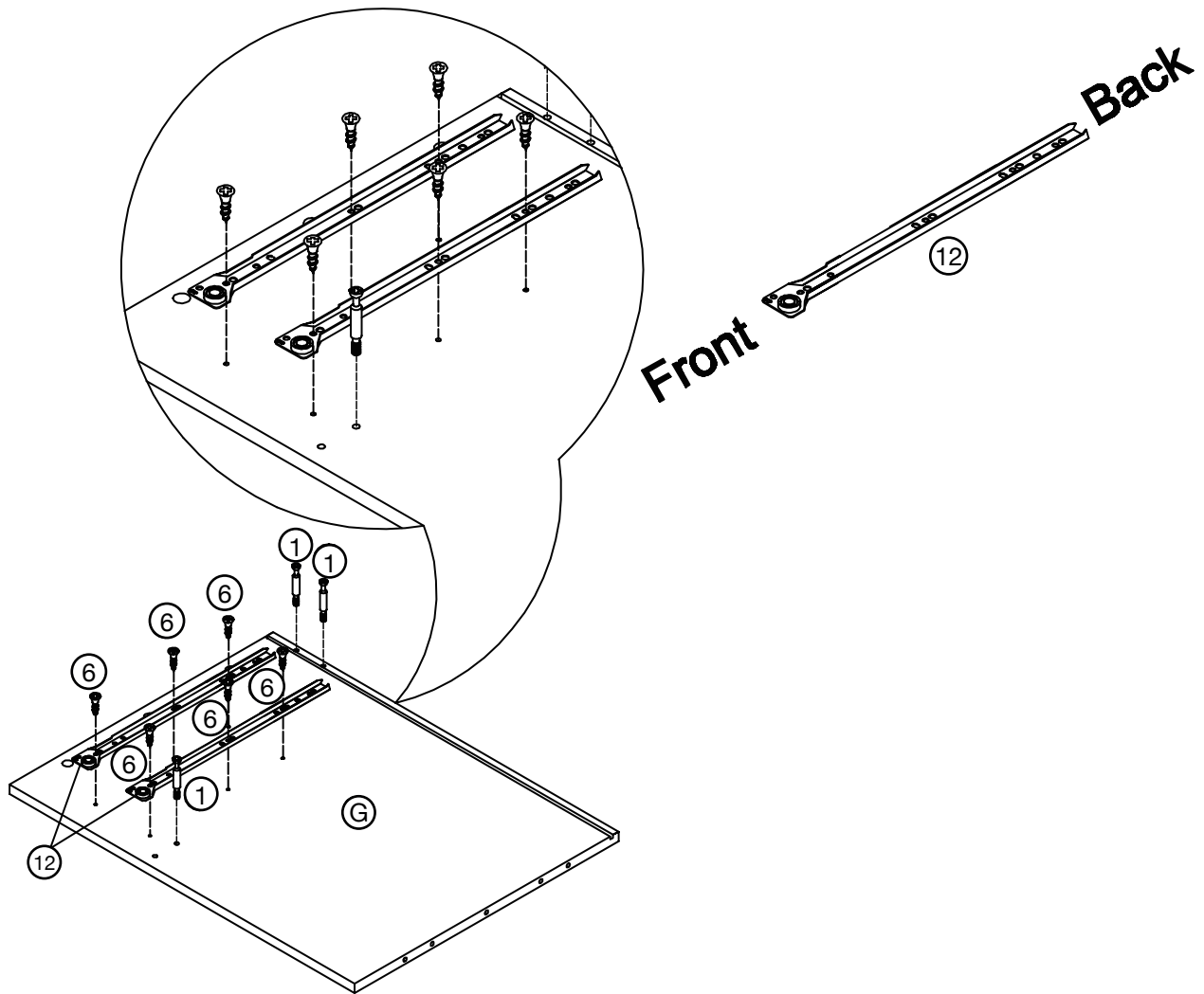

Step 6 cont.

Repeat on the particle panel
and don't forget to screw on the
magnetic piece!

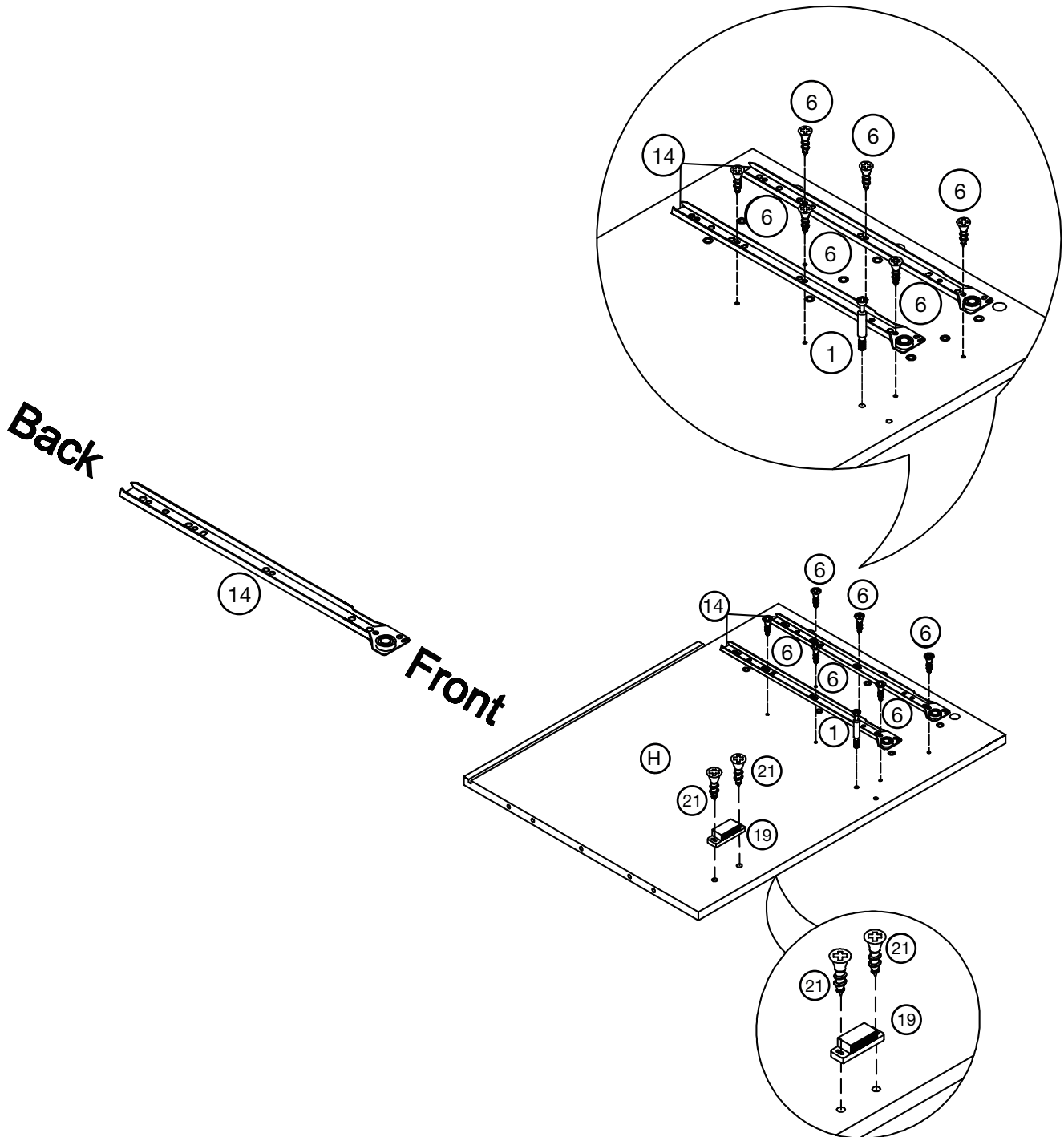

Step 7

We know, there are a lot of pieces with this product, but take it slow, you're doing great!

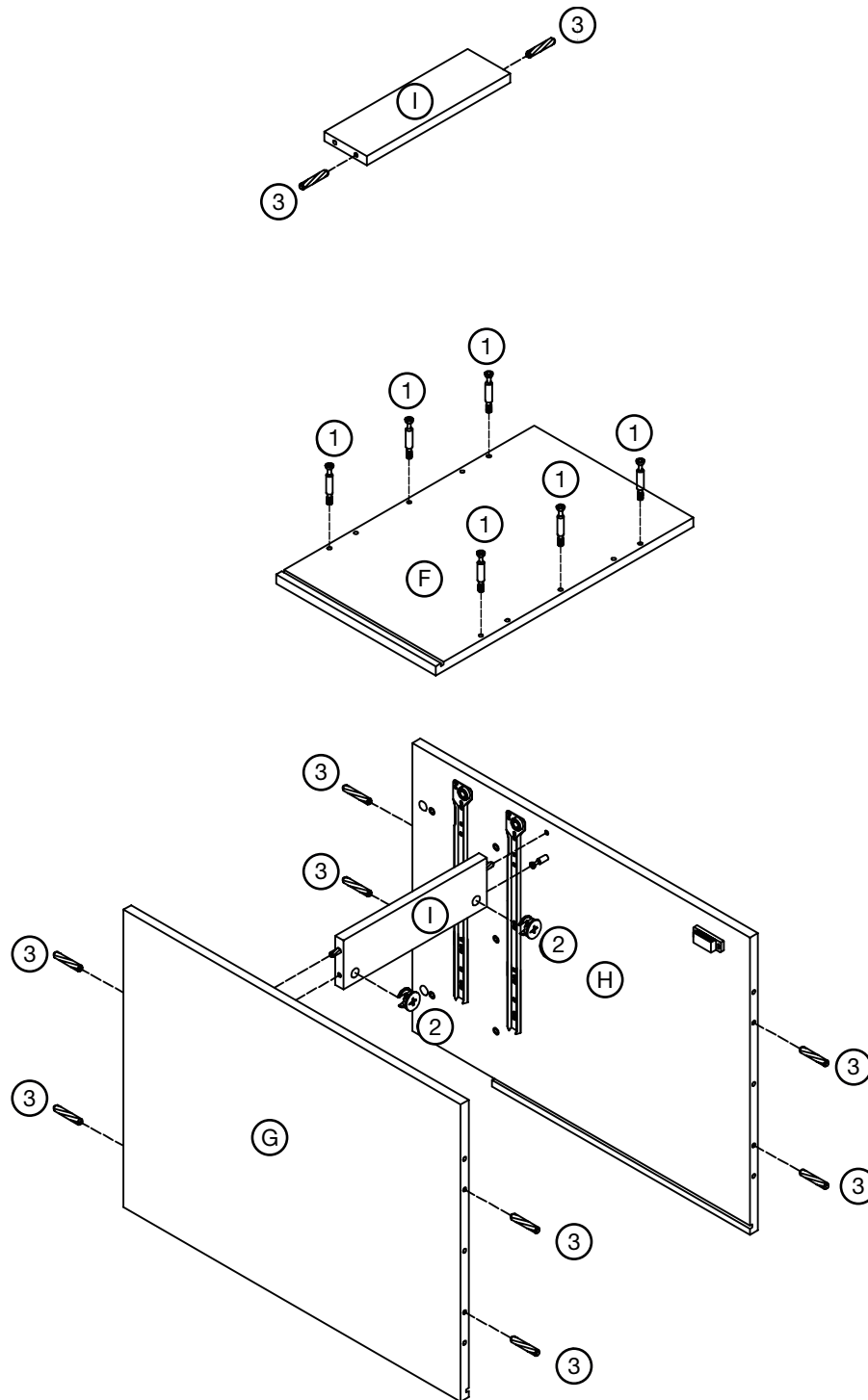

Step 8

Attach the top panel.

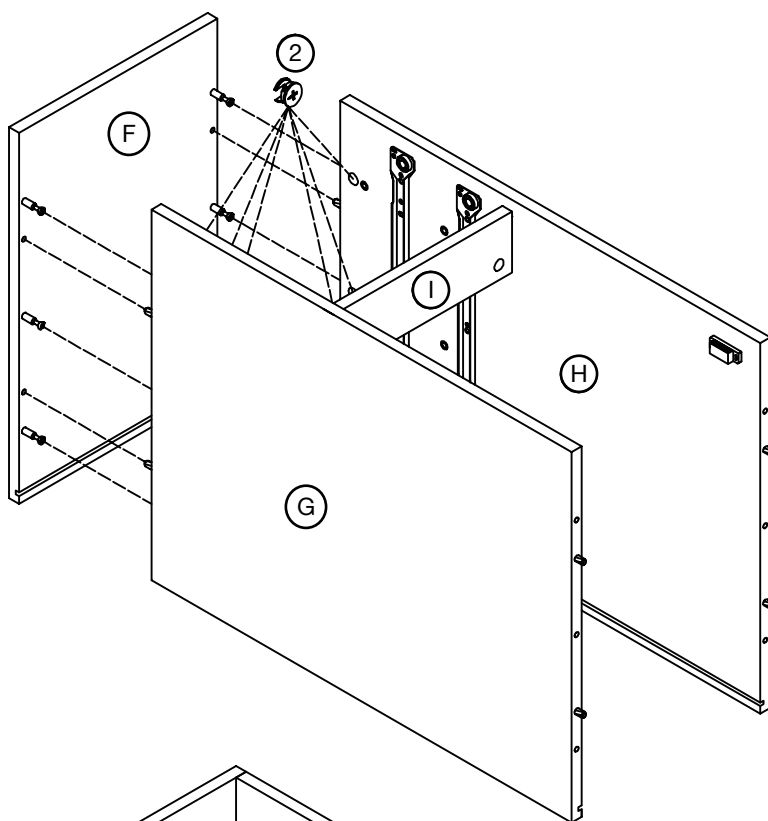

Slide in the left back panel.

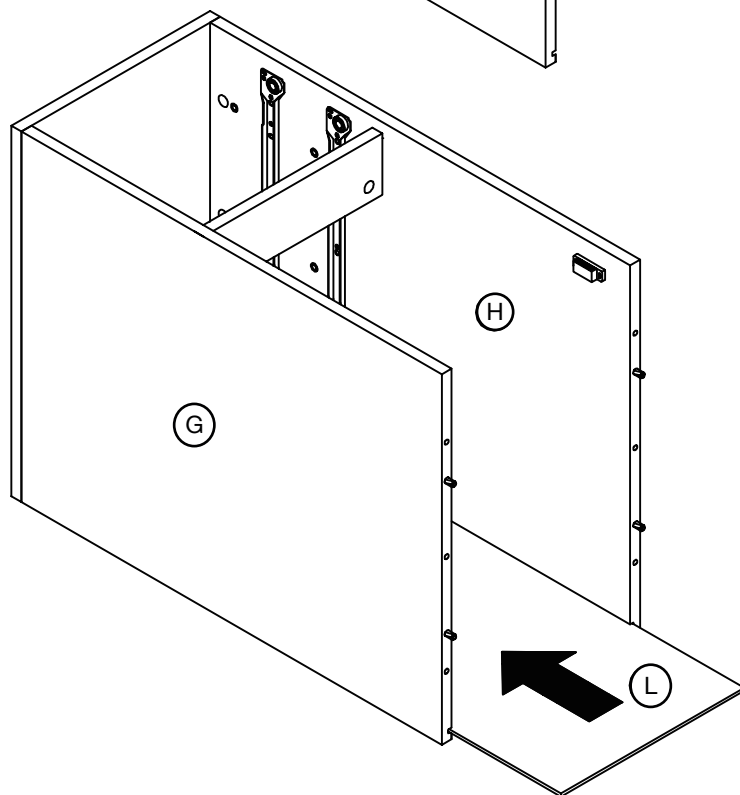

Step 9

Screw in the back panel. You're halfway there!

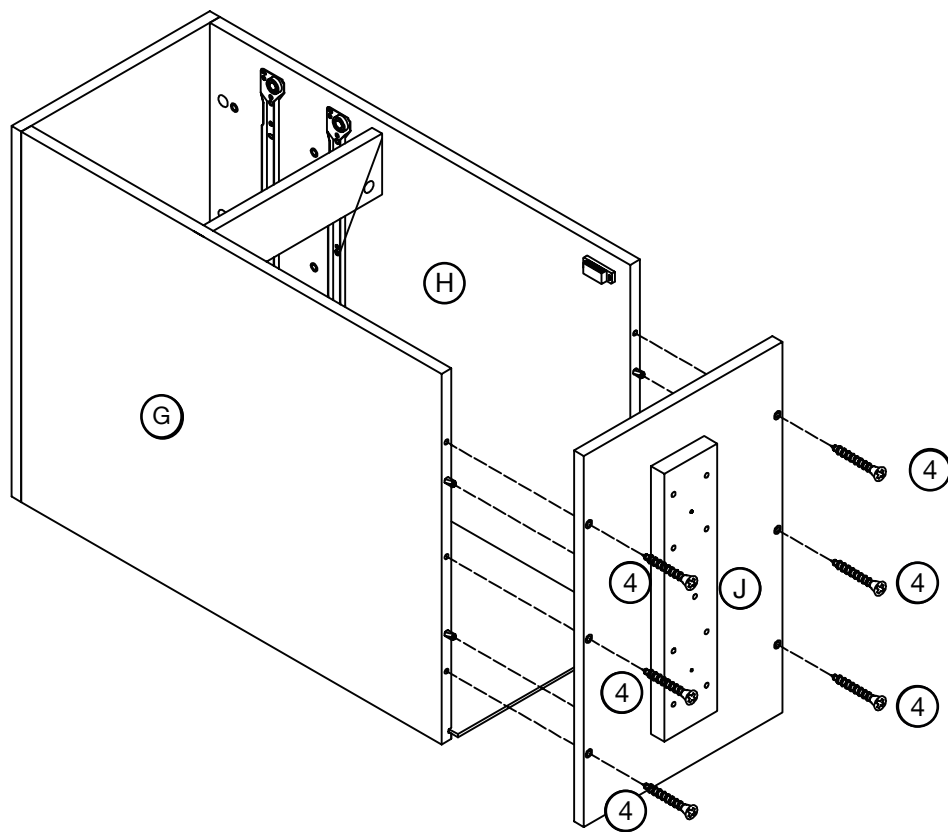

Step 10

Time to secure the back panel and bottom deck panel.

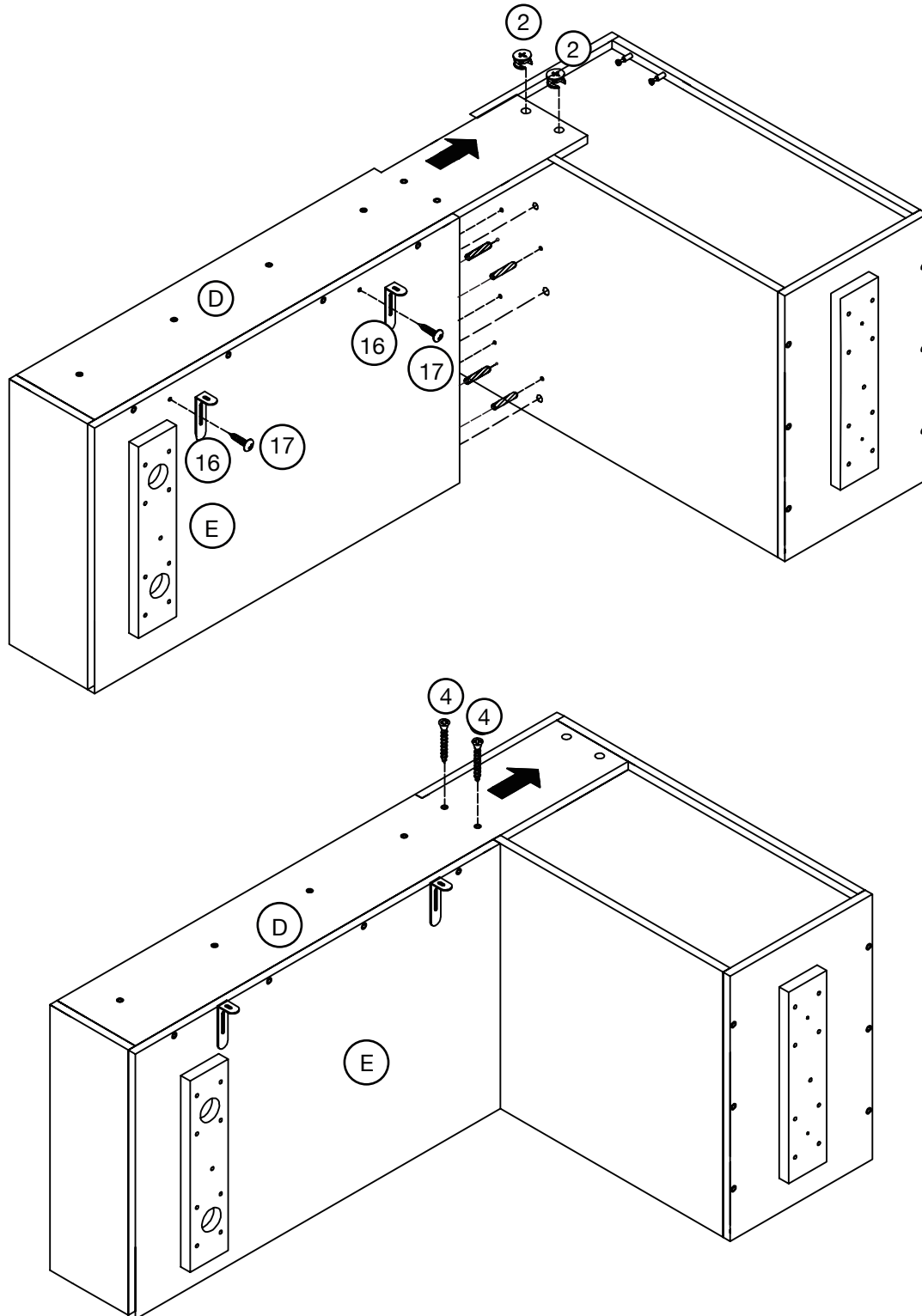

Step 11

Time to work on securing the drawer slides. You're going to want these for easy access to the snacks you'll be hiding in here.

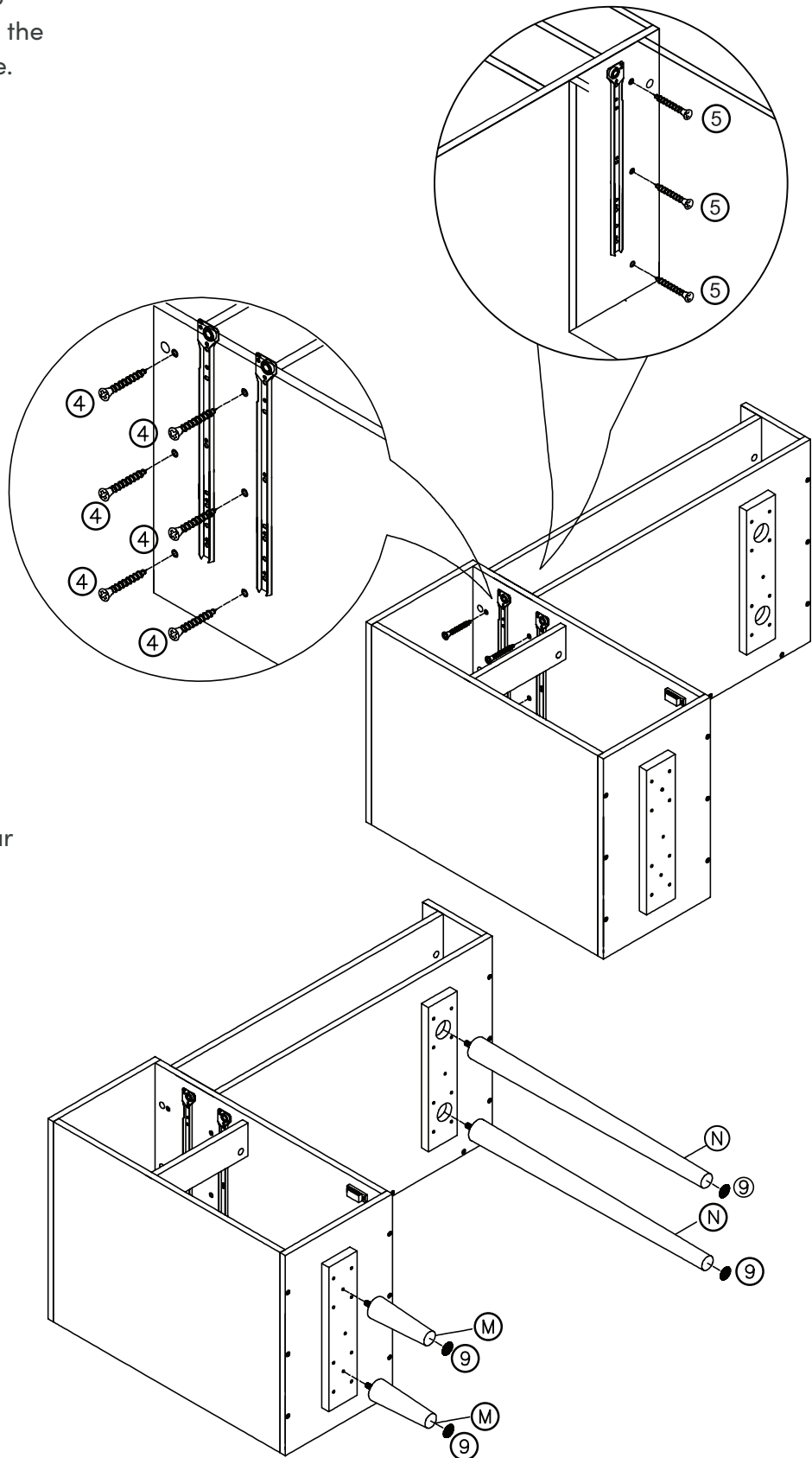

Twist on the legs and attach the footpads. Got to keep your beautiful floors safe!



Step 12

Screw on the hinges to the door panel and twist on the handle.

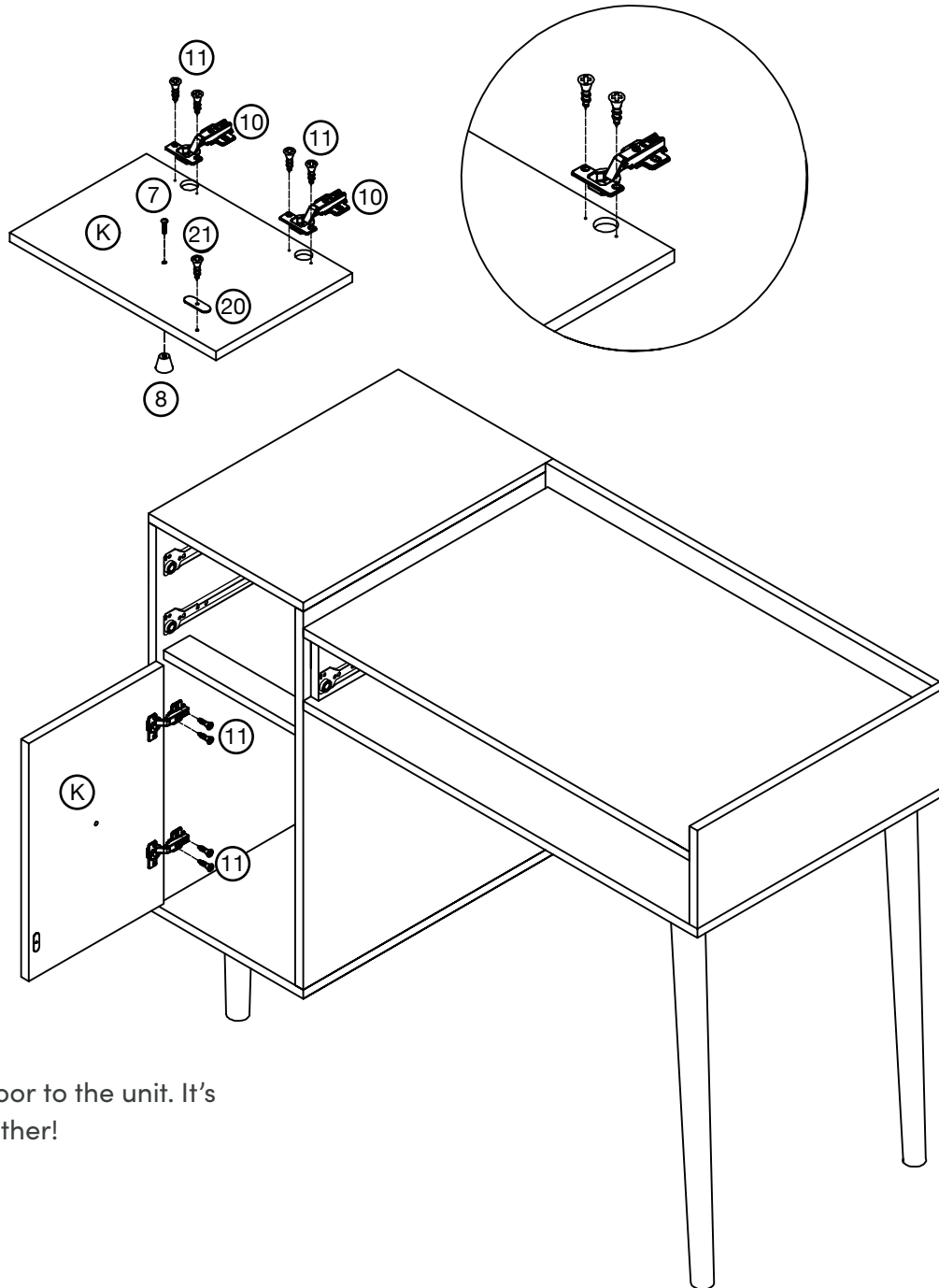

Screw on the door to the unit. It's all coming together!



Is your cabinet door looking crooked or unevenly spaced?

Then you've come to the right place.
Follow the illustrations below to get
your cabinet door aligned and ready
for action.

If your door is too low or too high...

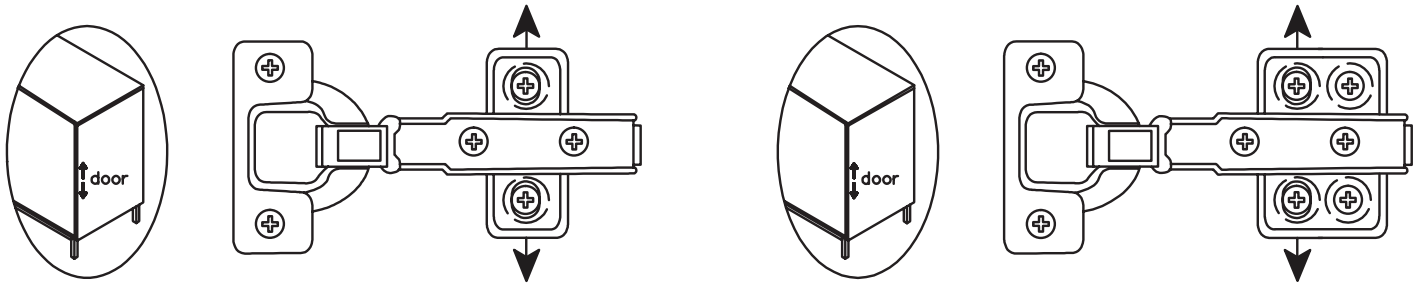

Loosen the height screws, then move the door up or down to
make it level.

If the space between your doors is off...

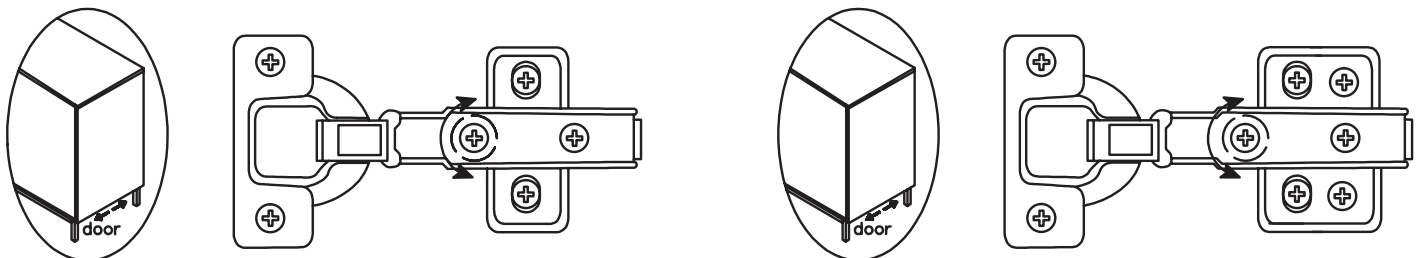

Loosen the side-to-side screws, then screw counter-clockwise
to make the gap wider or clockwise to close any gaps.

If you need to adjust the depth of the doors...

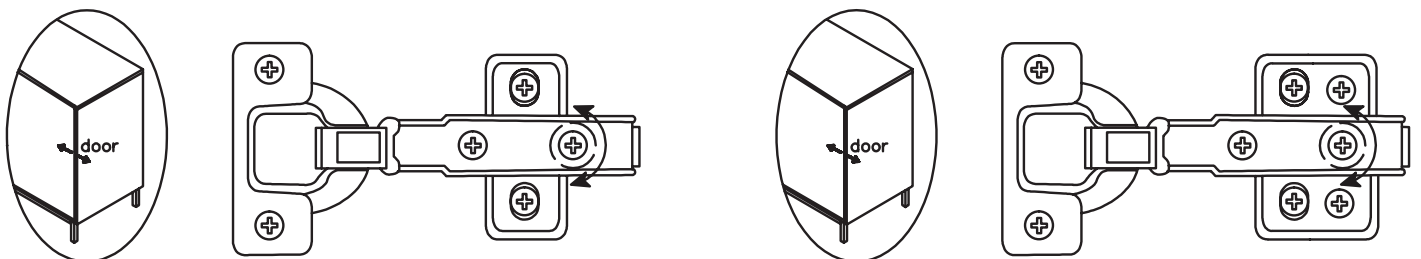

Adjust the in-and-out screws until the door is aligned with the
side of the cabinet.



Step 13

Time for the drawers. Repeat this step twice to finish both sets of drawers.

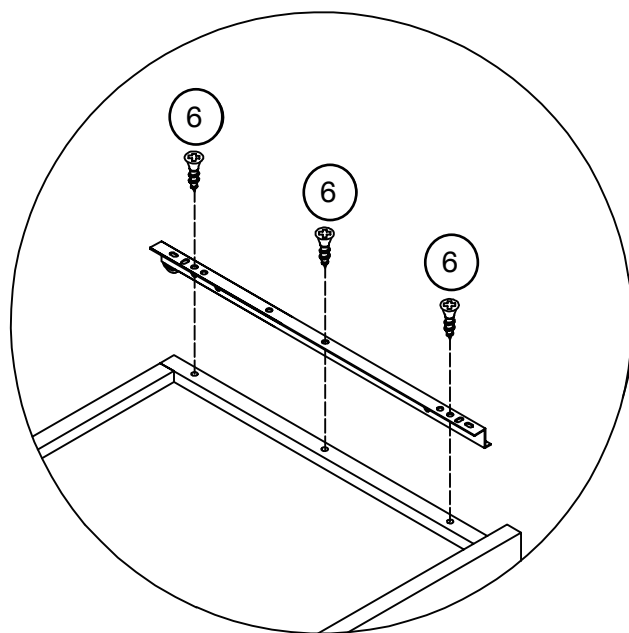
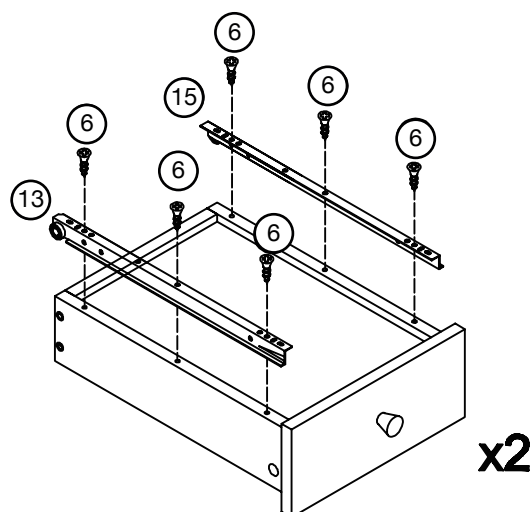
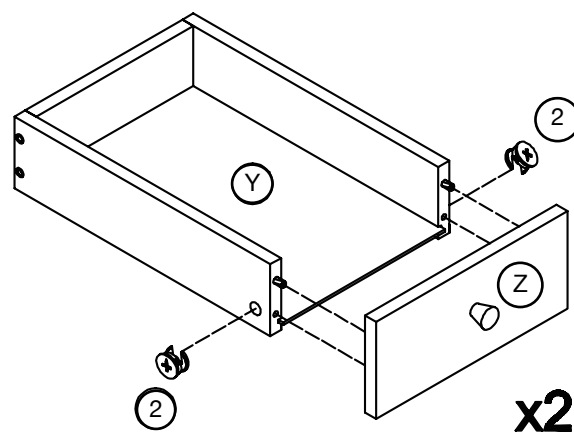
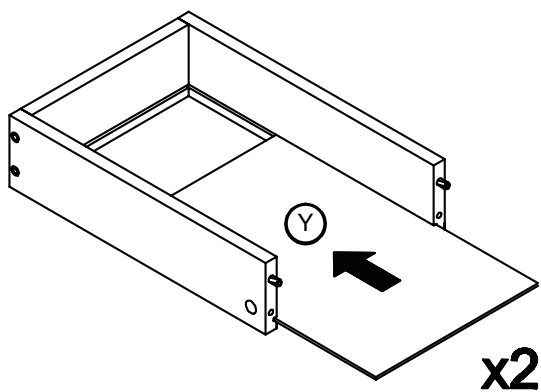
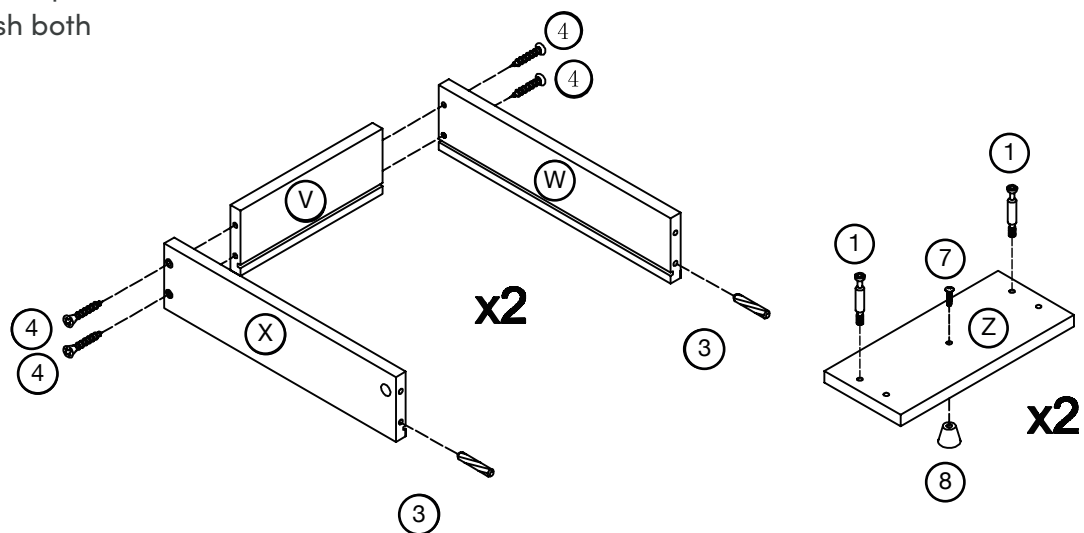

Step 14

Let's consider this your workout for the day. Take a five minute break and order yourself some pizza before coming back to finish up the last drawer.

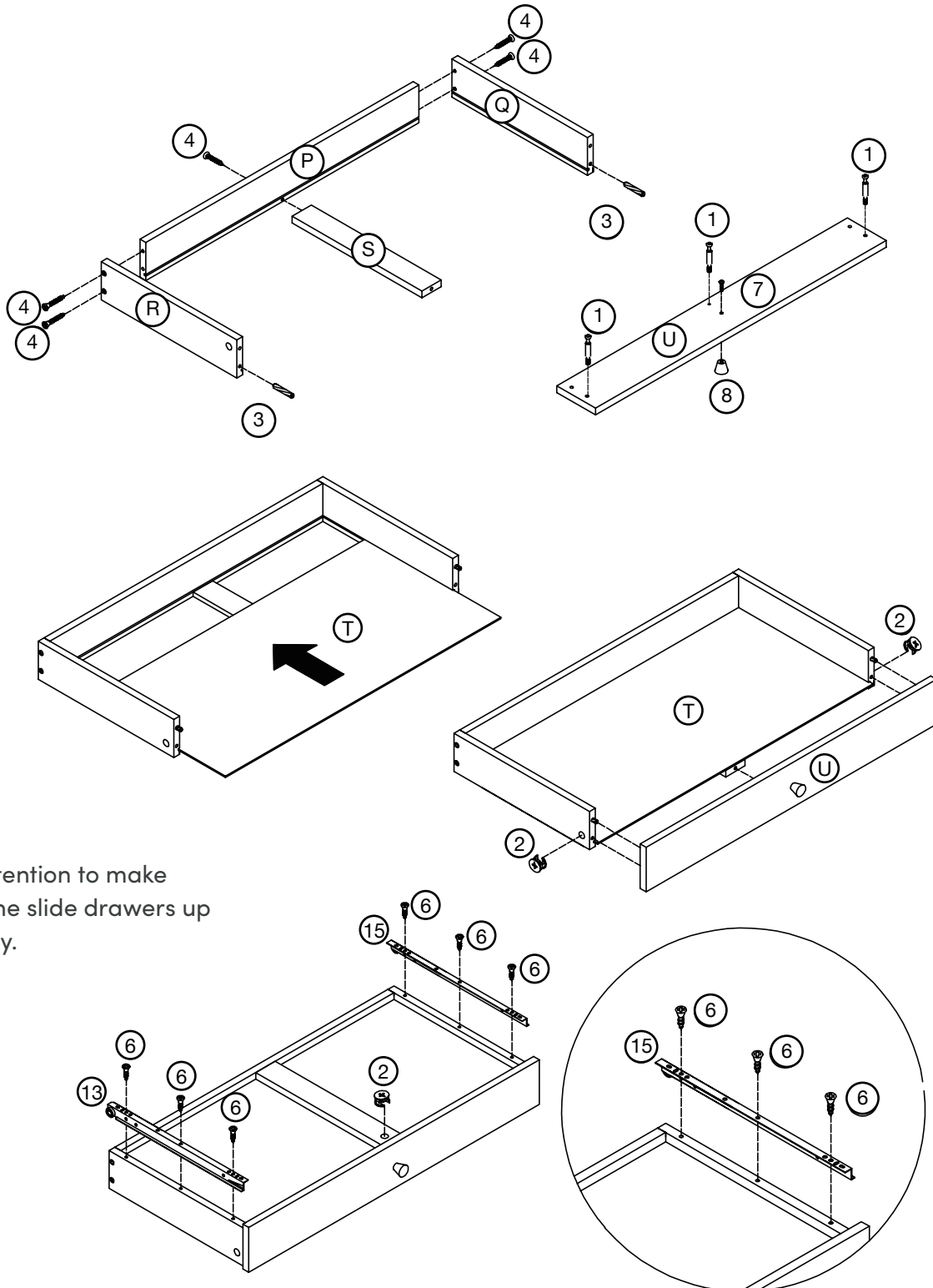

Pay careful attention to make sure you line the slide drawers up the correct way.



Step 15

Slide in your drawers and ta-da!
You did it! *Cue party music*

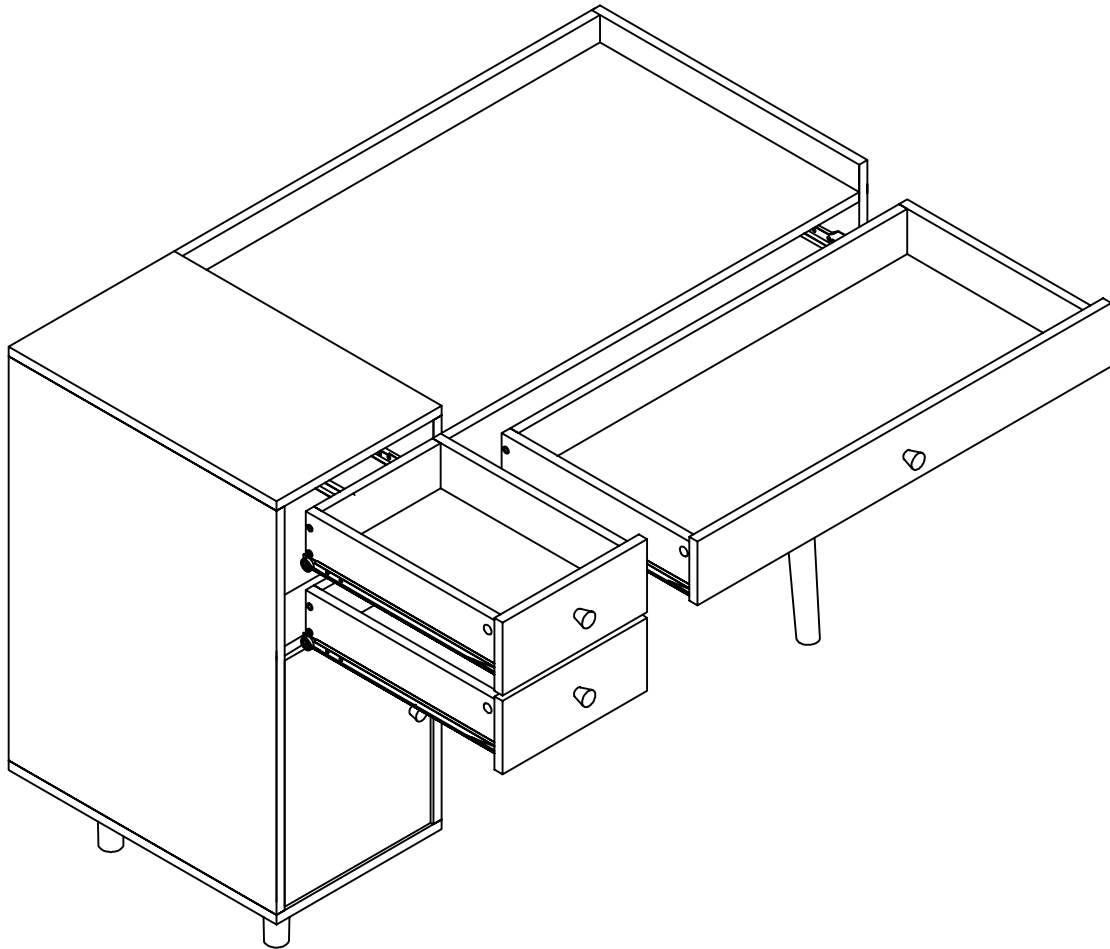

Step 16

For safety, we recommend
securing your vanity to a wall.

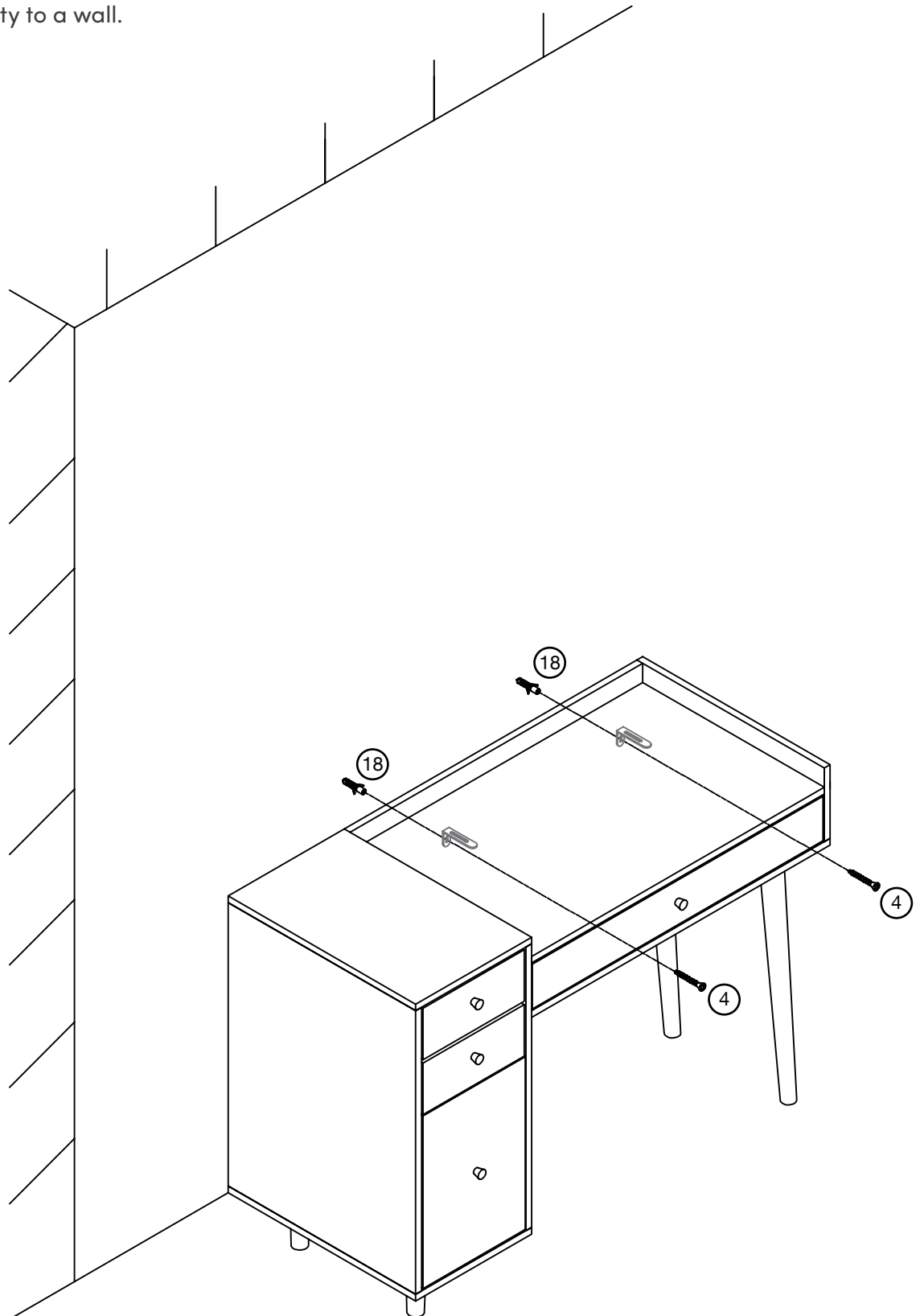

No heartburn, when we handle the return

Give us a call **1-866-619-1004** or shoot us a message
at **help@nathanjames.com** we will issue you a free
replacement with **zero hassle**.

Our way



Give us a call



Replacement



You

Their way



Re-package item



Schedule pick up



Track package



Replacement



You

We really don't want you to go through the hassle of re-packaging your item
and sending it back, because let's be honest...nobody has time for that.



Safety first, fun later

We want your Daisy Desk to last as long as possible, so we recommend that you tighten the screws 2 weeks after assembly and for added safety check the tightness of all screws every 2 months.

For proper care and treatment of wood please check our website at NathanJames.com/products

Safe use of this product starts with you.

Use this Nelson Bar Stool responsibly with the primary concern for your safety. Follow assembly instructions carefully and inspect product upon receipt and each use.

Nathan James and its parent companies cannot be held legally responsible for any injuries or death resulted from failure to follow instructions or improper use of this product.

Do not modify the structure of this product in any way.

Our products have been tested to meet specific safety measures as they were originally intended to be sold. Any modifications will present the risk of creating significant safety issues which NJ will not be responsible for.

Proper use

DO NOT	use for commercial purposes
DO NOT	place on uneven floor or surface
DO NOT	stand on table top
DO NOT	leave spilled liquid on table top
DO NOT	use table if damaged
DO NOT	make temporary repairs
DO NOT	use outdoor



We are only in business if you're happy

For starters, thanks for being you.

☎ Toll-free at 1-866-619-1004

✉ Help@nathanjames.com

🌐 NathanJames.com/help

We do our best to ensure your furniture arrives without any problems, but occasionally mistakes happen—as humans we are imperfect beings. In the event that a part is damaged or missing, we will be more than happy to provide you with replacement part(s) for free.

Warranty

This product comes with a lifetime warranty from the date of purchase. Please use your phone to scan the QR code to register your product or visit <https://goo.gl/i9dk3q>



Did we do alright? Please spread the love!

If you are happy with your product, tell your friends and family about us or even better leave us a review online. Spreading the word gives us the opportunity to make more people happy and keep our prices low for your next purchase.

Brooklyn Burdon

Founder, Nathan James

