



How to change Carbon Brush and Add Grease



How to assemble chisel bit and how to use the function knob



How to contact us for after-sales support

Berserker®

Hangzhou Berserker Trading Company Ltd.

Room 3509, Building 2, Left Right World Business Center, Ningwei Street, Xiaoshan District, Hangzhou, Zhejiang, China



Berserker

BSK-42MB ROTARY HAMMER

Original Instructions

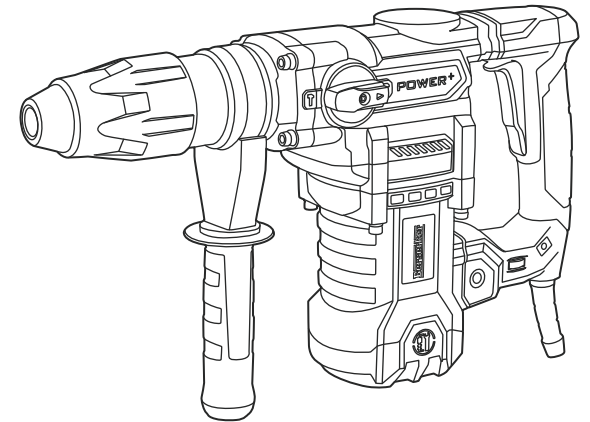

Please read the carefully before use

Attention: If you have any question during use, please contact us at Amazon after-sale service

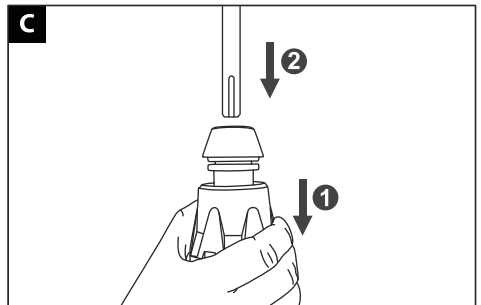
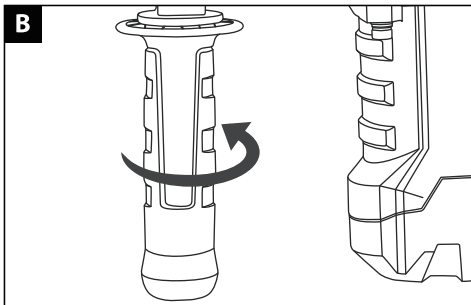
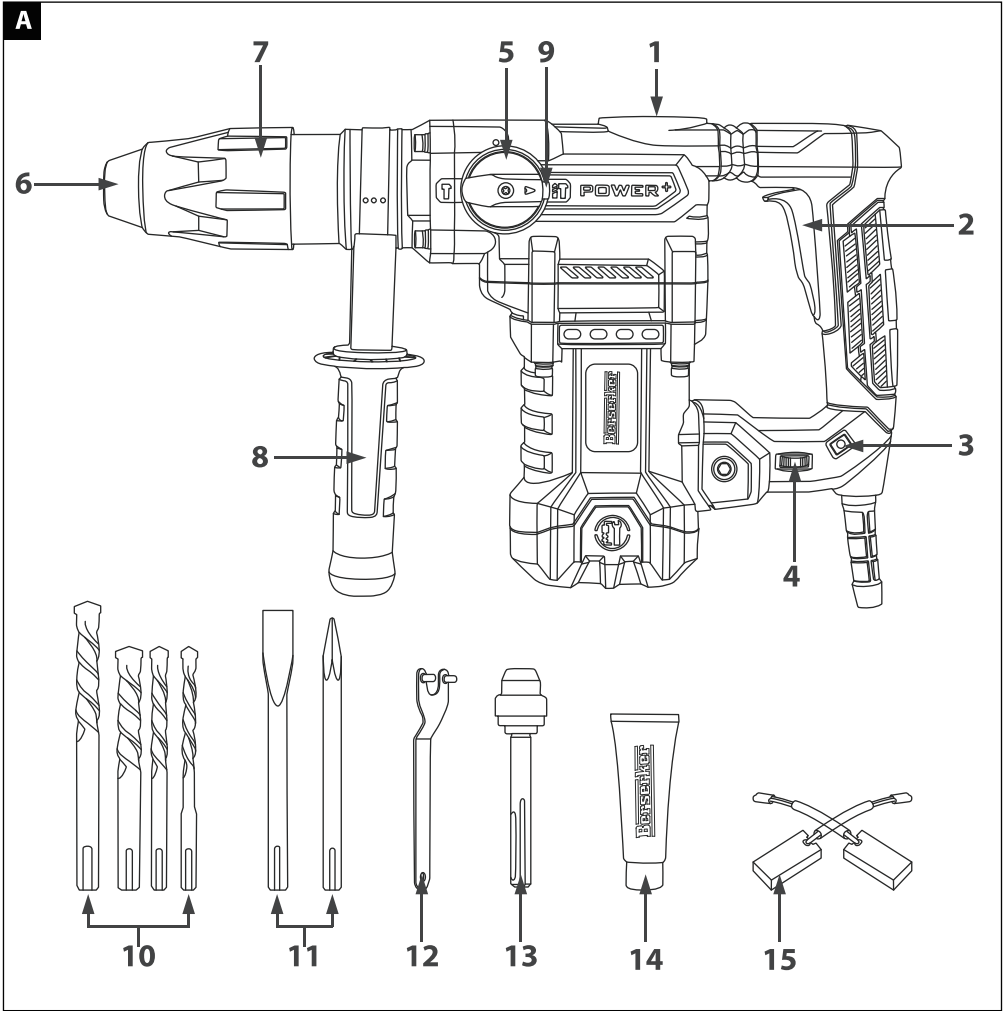

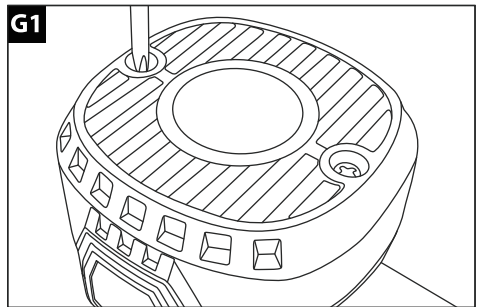
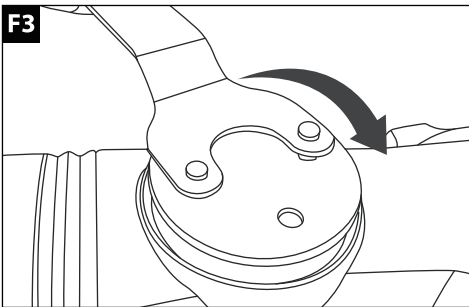
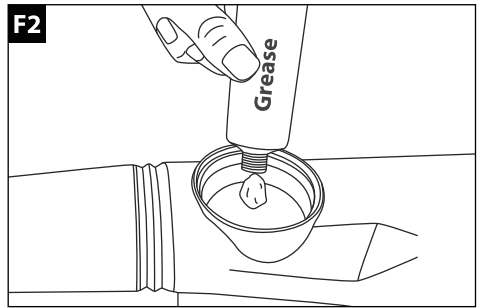
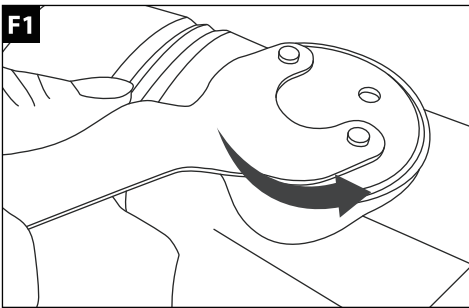
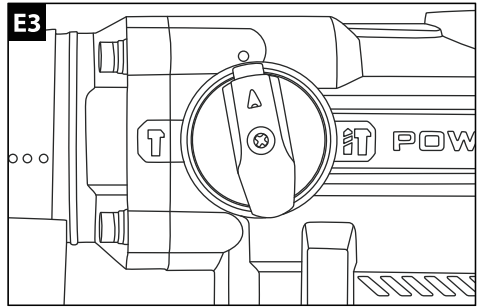
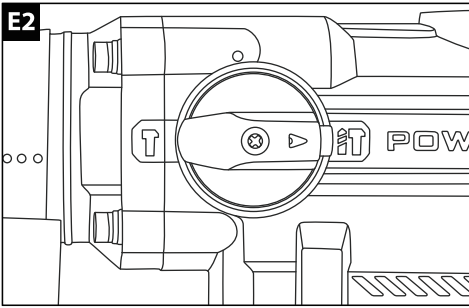
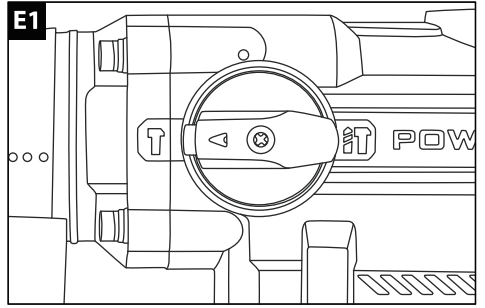
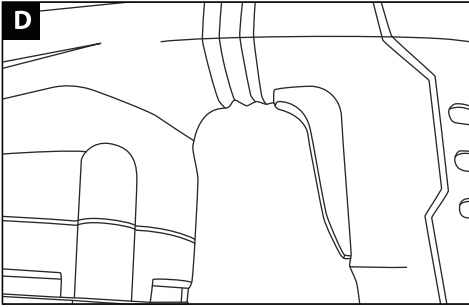

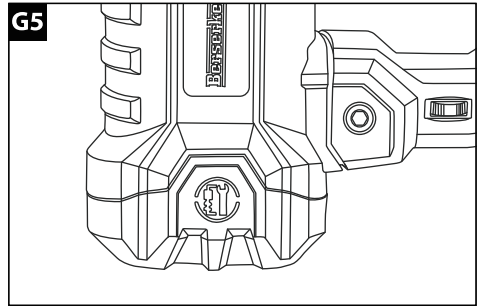
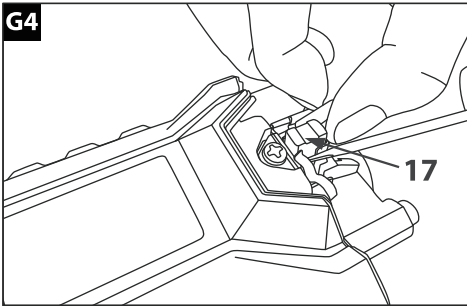
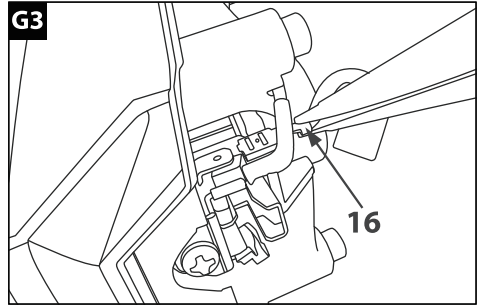
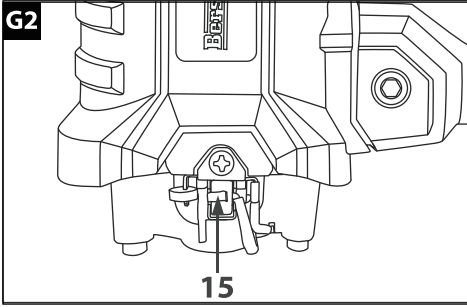

How to change Carbon Brush and Add Grease



How to assemble chisel bit and how to use the function knob



How to contact us for after-sales support

SAFETY INSTRUCTIONS

WARNING!

Read all safety warnings and all instructions. Failure to follow the warnings and instructions may result in electric shock, fire and/ or serious injury. Save all warnings and instructions for future reference. The term “power tool” in the warnings refers to your mains-operated (corded) power tool or battery-operated (cordless) power tool.

1. Safety in the Work Area

- Keep the work area clean and well lit. Dark and cluttered work areas increase the risk of accidents and injuries.
- Do not use power tools in explosive environments, such as in the vicinity of flammable liquids, gases or dust. Power tools produce sparks that can ignite dust and fumes.
- Keep children and onlookers at a safe distance when working with a power tool. You can lose control of the tool if you are distracted.

2. Electrical Safety

- The plug on the power tool must match the power point. Never modify the plug in any way. Never use adapter with earthed power tools. Intact plugs and matching outlets reduce the risk of electric shock.
- Avoid body contact with earthed surfaces such as pipes, radiators, cookers and refrigerators. There is an increased risk of electric shock if your body is earthed.
- Do not expose power tools to rain or moisture. There is a greater risk of electric shock if water gets into a power tool.
- Be careful with the power cord. Never use the power cord to carry or pull the power tool, or to pull out the plug from the mains. Keep the power cord away from heat, grease, sharp edges and moving parts. Damaged or tangled power cords increase the risk of electric shock.
- When you use a power tool outdoors, use an extension cord intended for outdoor use. Using cords intended for outdoor use reduces the risk of electric shock.
- If you have to use a power tool in damp conditions, use a mains connection protected by a residual current device RCD. Using an RCD reduces the risk of electric shock.

3. Personal Safety

- Stay alert, pay attention to what you are doing, and use your common sense when working with power tools. Never use power tools if you are tired or under the influence of drugs, alcohol or medication. A moment of inattention when using a power tool can result in serious personal injury.
- Use safety equipment. Always wear safety glasses. The correct use of safety equipment such as a dust filter mask, non-slip safety shoes, helmets and ear protection, reduces the risk of personal injury.
- Avoid accidental starting. Check that the power switch is in the OFF position before connecting to the mains and/ or the battery, or lifting/ carrying the tool. Carrying a power tool with your finger on the switch, or connecting a tool to the mains when the switch is pressed, increases the risk of accidents.
- Remove all allen keys/ spanners etc. before switching the power tool. A spanner left in a rotating part of the power tool can result in personal injury.
- Do not overreach. Always maintain a firm footing and good balance. This will ensure you have better

control over the tool in unexpected situations.

- Wear suitable clothing. Do not wear loose-fitting clothing or jewellery. Keep your hair, clothing and gloves away from moving parts. Loose-fitting clothing, jewellery and long hair can get caught in moving parts.
- If dust extraction and dust collection equipment is available, this should be connected and used correctly. The use of such devices can reduce the risk of dust-related problems.
- Hold the power tool by the insulated grips when working in areas where the drill can come into contact with concealed electrical cables or its own power cord. If the drill comes into contact with a live wire, unprotected metal parts on the tool can give the user an electric shock.

4. Using and Looking After Power Tools

- Do not force the power tool. Use the correct power tool for the planned work. The correct power tool will work better and more safely when used with the load for which it was designed.
- Do not use the tool if it cannot be switched on and off with the power switch. Power tools that cannot be controlled with the power switch are dangerous and must be repaired.
- Unplug the plug from the mains and/ or remove the battery from the power tool before making any adjustments, replacing accessories or putting the tool away. These safety precautions reduce the risk of accidentally starting the power tool.
- Store power tools out of the reach of children when not in use. Never allow anyone who is unfamiliar with the power tool and these instructions to use the tool. Power tools are dangerous in the hands of inexperienced users.
- Keep the power tool properly maintained. Check that moving parts are not misaligned, jammed or loose, and that there are no other factors that could affect the safe use of the tool. If the power tool is damaged, it must be repaired before being used again. Many accidents are caused by poorly maintained power tools.
- Make sure that cutting tools are sharp and clean. Properly maintained cutting tools with sharp cutting edges are less likely to jam and are easier to control.

5. Service

- Make sure that the power tool is serviced by qualified technicians that only use identical spare parts. This will ensure that the power tool remains safe to use.





6. Safety Instructions for Hammer Drill

- Wear ear protection. Exposure to noise can cause hearing loss.
- Use auxiliary handle(s), if supplied with the tool. Loss of control can cause personal injury.
- Hold the power tool by the insulated gripping surfaces, when performing an operation where the cutting accessory may contact hidden wiring or its own cord. Cutting accessory contacting a "live" wire may make exposed metal parts of the power tool "live" and could give the operator an electric shock.

7. Reduction of Noise and Vibrations

- Plan the work so that exposure to heavy vibrations is spread over a longer period.
- To reduce noise and vibrations when in use, limit the time the tool is in use, and use low-power/ vibration mode and suitable safety equipment.
- Take the following precautions to minimise the risks of exposure to vibrations and/ or noise:
 - Only use the tool in accordance with these instructions.
 - Check that the tool is in good condition.
 - Use accessories in good condition, and which are suitable for the purpose.
 - Keep a firm grip on the handles/ grips.
 - Maintain and lubricate the tool in accordance with these instructions.

8. Symbols

	Read the instructions.
	Safety class II.
	Approved in accordance with the relevant directives.
	Recycle discarded product in accordance with local regulations.

TECHNICAL DATA

Rated voltage	120 V ~60Hz
Drill capacity	42mm
Rated input power	1600W
No-load speed	0-630r/min
Max impact rates	3800 Bpm
Impact joules	10 J
Net weight	7.3kg

Always Wear Ear Protection.

The declared values for vibration and noise, which have been measured according to a standardised test method, can be used to compare different tools with each other and for a preliminary assessment of exposure. The measurement values have been determined in accordance with EN 60745-2-6:2010.



WARNING!

The actual vibration and noise level when using tools may differ from the specified maximum value, depending on how the tool is used and the material. It is therefore necessary to determine which safety precautions are required to protect the user, based on an estimate of exposure in actual operating conditions (taking into account all stages of the work cycle, e.g. the time when the tool is switched off and when it is idling, in addition to the start-up time).

DESCRIPTION

Powerful machine with three function modes for stripping concrete, metal and wood. Hammer drill mode, chisel with free rotation and chisel with rotation stop. SDS-Max holder for quick and tool-free changing of drills or chisels. The handle is vibration damping and has soft grips for optimum control. A safety switch is activated if the tool fastens. Supplied with the following accessories: Pointed chisel (18x320mm)

Flat chisel (18x320mm)

Four drills (22x320mm) (8/10/12x150mm)

- | | |
|---|---------------------|
| 1. Grease port | 8. Auxiliary handle |
| 2. On/off switch | 9. Lock button |
| 3. Power indicator | 10. SDS Max drill |
| 4. Speed regulator | 11. SDS Max chisel |
| 5. Function selector hammer/hammer drilling | 12. Grease wrench |
| 6. SDS Max chuck | 13. Converter |
| 7. Chuck sleeve | 14. Grease |
| | 15. Carbon brush |

USE



IMPORTANT:

At low temperatures the viscosity of the grease can prevent the activation of the percussion function even though the motor is running. In which case, run the product for 5 minutes with no load to warm up the grease.

MODE SELECTION

1. Hammer (See Fig. E1)

Press down the lock button (9) and turn the function selector hammer/ hammer drilling (8) to position  so that it engages.

2. Hammer Drilling (See Fig. E2)

Press down the lock button (9) and turn the function selector hammer/ hammer drilling (8) to position  so that it engages.

3. Chisel Steering Control (See Fig. E3)

The vario-lock positioning allows rotates and locks chisel into 12 different positions to optimize the working angle, maximum comfort when chiseling in tight spaces or in a wide variety of positions.

Press in the lock button and turn the function selector and turn the chisel to the required position.

MAINTENANCE



WARNING!

Switch off the product and pull out the plug before refilling with grease. The grease reservoir holds enough grease for about 60–80 hours of work.

1. Filling Up With Grease (See Fig. F1-F3)

Check the grease level before use and refill if necessary.

1. Run the product warm, if necessary, open the oil cap with wrench and check the grease level in sight. (See Fig. F1)
Fill 30g (1oz) with grease tube if there is no grease in sight. (See Fig. F2)
After adding grease, use the wrench to close the oil cap. (See Fig. F3)

2. Always check the grease level before use.

Attention: If need more grease, please choose the Shell Gadus S5 series and Mobil grease SHC100 series.

1. Before Use

- Check that the mains voltage corresponds to the rated voltage on the type plate.
- The plug must be plugged into a correctly installed and earthed power point.
- Check that the power switch is switched off. If the plug is plugged in when the power switch is in the ON position the product will start to move, which can cause serious personal injury.
- An extension cord must have a cross-sectional wire area to match the power supply to the product. Do not use longer than necessary extension cords.

2. Auxiliary Handle (See Fig. B)

The auxiliary handle can be placed on either side, which makes it easy to handle the product in different positions. Screw on the auxiliary handle clockwise and firmly tighten. Remove the auxiliary handle by turning it anticlockwise.

NOTE: Always use the auxiliary handle and hold the hammer drill firmly with both hands.

3. Assembly And Dismantling (See Fig. C)

Clean and lightly lubricate the shank of the drill (1). Put the drill in the chuck (2) by twisting it (3) until it locks in place. The drill shank locks automatically.

Pull on the drill to check that it is properly in place.

Pull back the chuck sleeve and take out the drill.

4. How to Use (See Fig. D)

NOTE: When starting the product there may be a temporary voltage drop in the mains supply, which could affect other equipment. Such interference does not normally occur if the impedance in the mains supply Z_{max} is less than 0.195 ohm. Contact your electricity supplier for more information.

1. Place the tip of the drill against the surface and start the hammer drill. In some situations the tip of the drill must be pressed hard against the surface to activate the percussion action. This is not a malfunction, it is caused by the safety mechanism to prevent impact when there is no load.

2. Hold the hammer drill firmly in both hands and use the weight of the tool to counteract the recoil. Do not press too hard, this will reduce its performance.

2. Regular Checks

- Always replace, or resharpen blunt bits. Blunt bits overload the motor and are less effective.
- Check at regular intervals that all the screw unions on the product are properly tightened. Retighten if necessary, otherwise there is a risk of serious personal injury.
- Protect the motor windings from damage, oil and water.

3. Carbon Brush (See Fig. G1-G5)

The motor's carbon brush are replacement parts. Check the carbon brush at regular intervals and

replace them when they are worn. Always keep the carbon brush clean and check that they move freely in the brush holders.

1. Remove the carbon brush cover (See Fig. G1).
2. Remove the clasp (15) (See Fig. G2).
3. Pull out fixed parts (16) (See Fig. G3).
4. Pull out the carbon brush (17) (See Fig. G4).

Install carbon brush

1. Refit in the reverse order.
After installation, it can be energized to test whether it is fixed.

TROUBLE SHOOTING

Symptom	Possible Cause	Remedy
Drill or chisel can not be installed or pulled out.	Users have not yet mastered the correct installation method.	Press down the SDS-MAX chuck (6) and rotate the chisel slowly to click into the right position. To see more details please check the previous contents.
Rotary hammer stops working or not working properly.	The carbon brush may be worn out.	Change the carbon brush. To know how to change carbon brush please refer to the previous contents.
The rotary hammer won't hammer or the hammering force becomes weaker.	Lack of grease.	Add some grease into it. To see how to add grease please refer to the previous contents.
	The lubricant grease inside has solidified due to a long period of non-use.	Allow the rotary hammer to start for a while then press rotary hammer and drill /chisel slightly harder on the ground.
If you encounter any problem that you can't solve, you can email us at once, we will reply to you within 8 hours and solve your problems until you are satisfied. Your satisfaction is our greatest pursuit!		