

Waterlogic® Countertop Installation & User Guide



**Waterlogic® Countertop
F-FWCU1-M-HCA-TT-XX-YY2**

**Waterlogic® Countertop Pure Kit
K-FU-00S20-00C1L-13-0-XXX
(includes sediment filters FT-0003-L00-XXX,
carbon filter FT-0006-L00-XXX, UV lamp CT-2090-C)**

Your Guide

Welcome to your new Waterlogic® Countertop machine.
Please read this manual before installing or operating the machine.

Index

Declarations	3
Quick Reference	5
Machine Overview	6
Operating Instructions	7
Installation Guide	8
12 Month Servicing Guide	18
Product Disposal	29
Performance Data Sheet	30

Declaration and Safety Precautions

Waterlogic International Ltd

1. Do not remove any panels or covers from the appliance unless acceptable in this instruction.
2. When any abnormal case happens, firstly unplug the appliance.
3. The appliance is not intended for use by persons (including children) with reduced physical, sensory or mental capabilities, or lack of experience and knowledge, unless they have been given supervision or instruction concerning the use of the appliance by a person responsible for their safety.
4. The appliance can be used by children aged from 12 years and above if they have been given supervision or instruction concerning use of the appliance in a safe way and if they understand the hazards involved. Cleaning and user maintenance shall not be made by children unless they are older than 12 and supervised. Keep the appliance and its power cord out of reach of children aged less than 12 years of the appliance.
5. If the supply cord or the detachable cord sets are damaged, it must be replaced by the manufacturer, its service agent or a similarly qualified person in order to avoid a hazard.
6. The appliance is to be supplied through a residual current device (RCD) having a rated residual operating current not exceeding 30mA.
7. The appliance is intended to be used in household and similar applications such as
 - staff kitchen areas in shops, offices and other working environments;
 - farm houses and by clients in hotels, motels and other residential type environments;
 - bed and breakfast type environments;
 - catering and similar non-retail applications.
8. The appliance contains a UV-C emitter (UV lamp)
9. Unintended use of the appliance or damage to the housing may result in the escape of dangerous UV-C radiation. UV-C radiation may, even in little doses, cause harm to the eyes and skin.
10. Appliances that are obviously damaged must not be used.
11. Read the maintenance instructions before opening the appliance.
12. The appliance must be disconnected from the power supply before replacing the UV lamp.
13. The UV lamp must be replaced at 12 month intervals or when necessary. If the unit is placed in a high use area, the UV lamp will need to be replaced more frequently.
14. **WARNING:** Do not operate the UV lamp when it is removed from the appliance enclosure.
15. In accordance with these instructions, the appliance must be properly located and installed before use.
16. Appliance must be unplugged before maintenance, cleaning, sanitizing or repairing.
17. The appliance heats water to a temperature above 203°F (95°C). Water temperatures above 125°F (52°C) can cause severe burns or death from scalding. Most at risk of being scalded are children, the disabled and the elderly.
18. Follow proper grounding safety precautions and instructions prior to plugging in appliance.
19. **WARNING:** Boil the water should the purification unit fail.
20. **Note:** Flush 2 liters of water from the system after a system failure.

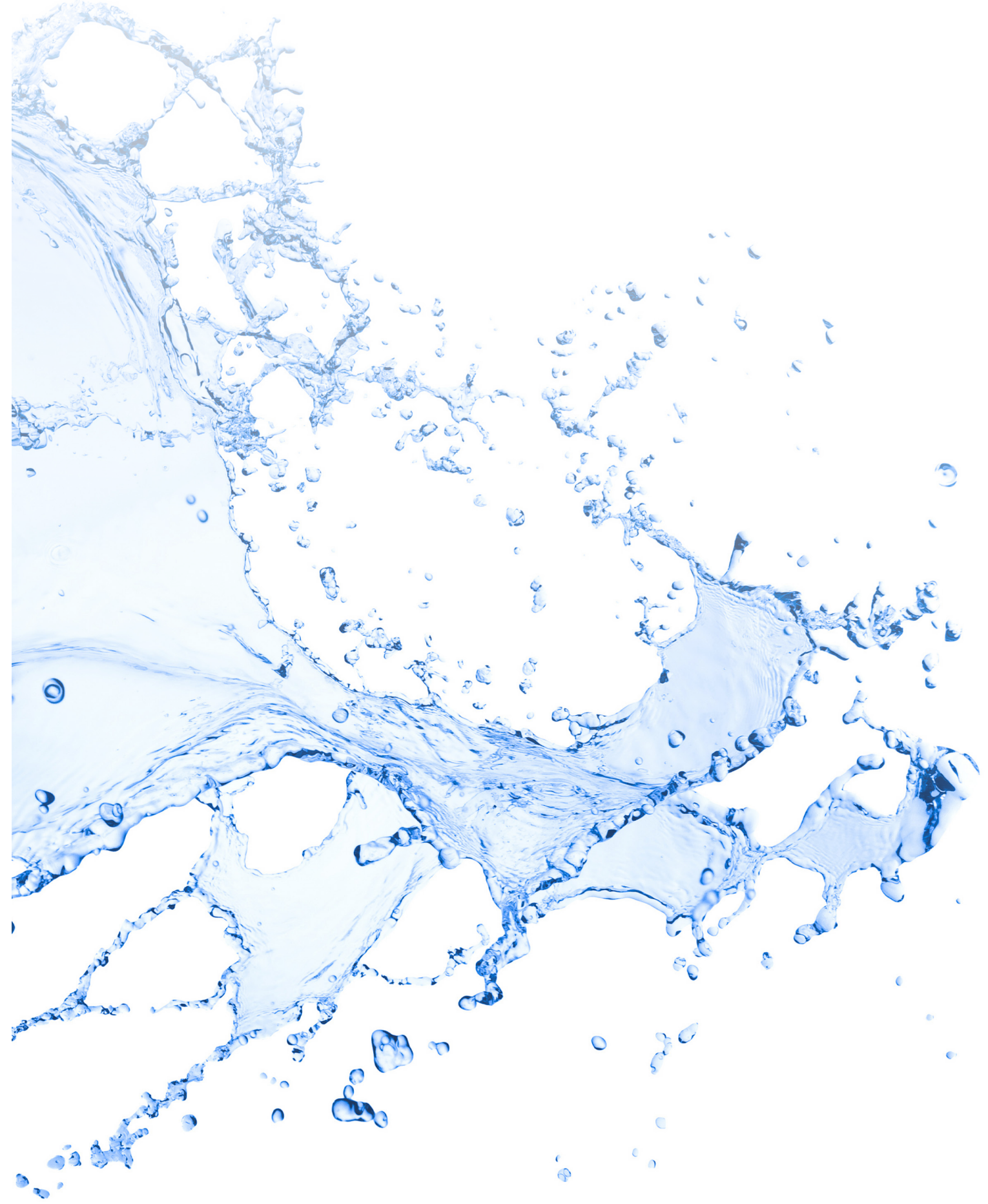

Quick Reference

HOT WATER

Press and hold the hot water icon for 3 seconds until the icon has illuminated orange, select the dispense button and hot water will be dispensed (this safety feature helps prevent hot water from being dispensed accidentally, especially by children).

DISPENSING BUTTON

For cold, ambient or hot water, first select the relevant icon, then press this dispensing button and keep held until you have the desired fill.

COLD WATER

Select cold water icon, then press and hold the dispensing button until you have the desired fill.

AMBIENT WATER

Select ambient water icon, then press and hold the dispensing button until you have the desired fill.

EXTRA HOT WATER

Press and hold the extra hot water icon on the display panel, the icon will flash red to indicate that the water is heating. Once the icon turns off, the water is at the correct temperature and extra hot water can be dispensed following the same method as Hot Water.

UV LAMP HAS FAILED
Replace UV lamp.

FILTER SERVICE DEMAND
Replace filter cartridge.

A LEAK HAS BEEN DETECTED
Turn off the water supply and call your authorized service agent.

POWER /UV OK

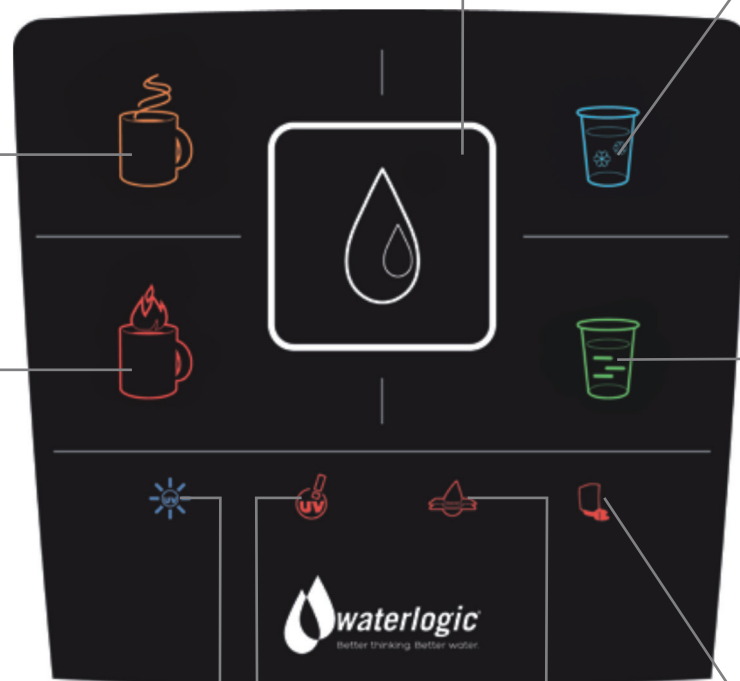

Machine Overview

THE COUNTERTOP

The Countertop enables you to enjoy filtered and perfectly purified Cold, Hot, Extra Hot and Ambient water.

COLD TANK

The cold tank is manufactured from 304 Stainless Steel, which is food-grade and non-corrosive. The temperature of the cold tank is controlled by a micro-processor and is set to 5°C as the factory default setting.

HOT TANK

The hot water temperature is controlled by a microprocessor which is set to 87°C for standard hot water and 95°C for extra hot water.

FILTERS

The filtration systems in the Countertop are designed to reduce dirt and sediment particles from the water. Furthermore, the carbon block filter will remove a wide variety of contaminants e.g. chlorine and pesticides.

FIREWALL SYSTEM

The Firewall system incorporates the in-faucet UV system and is made from highly reflective aluminum.

UV LAMP

The UV lamp is a 13 Watt germicidal lamp that works at a wavelength of 253.7 NM, which is very efficient at destroying bacteria in water. The UV lamp must be replaced every 12 months or when indicated by the warning lights.

WATER PIPES AND FITTINGS

The inlet tube needs to be 1/4" and must be food-grade NSF approved.



Operating Instructions

Please do not attempt to operate the machine before completing the installation in accordance with the installation instructions. Attempting to operate the machine before full installation could result in damage.

See the QUICK REFERENCE on page 5 on how to dispense your choice of water.

ENERGY SAVING FEATURE

The Countertop has a programmable energy saving feature that minimizes power consumption when the machine has not been operated for 3 / 72 hours. Please refer to section 6 of the installation guide for instructions on how to program the energy saving feature. The Countertop can be taken out of sleep mode by selecting any of the buttons. Please note the hot tank will take 10-12 minutes to reach optimum hot temperature after the machine has been taken out of sleep mode.

DISPENSING YOUR CHOICE OF WATER IS VERY SIMPLE:

- 1.** Place your cup centrally in the dispensing area. The drip tray can be removed for filling bottles or other containers.
- 2.** Select the type of water you wish to be dispensed and press/touch the corresponding icon. See the Quick Reference on page 5.
- 3.** Once the icon you have selected is illuminated, select the dispense button in the middle of the button panel.
- 4.** Press and hold the dispensing button until your cup has reached the desired level, and then release the button.



HOT WATER CAUTION

- Always place cup / mug in the centre of the dispensing area.
- Always use a ceramic cup or a cup suitable for use with hot water.
- Do not hold cup or place hands in dispensing area whilst dispensing hot water.
- Dispense water continuously until you've reached the desired fill.
- Never try to fill more than one vessel at a time.

Installation Guide

PLEASE FOLLOW THIS INSTALLATION PROCESS CAREFULLY.

You must have a permanent potable water supply and power supply. We recommend that this appliance be installed by a licensed plumber. The laws of your state, including the local plumbing codes in your area, may require installation of this appliance to be conducted by a licensed plumber. If you intend to install this appliance by yourself, please consult your applicable state and local laws, rules, regulations and codes to ensure that your plan for installation satisfies your any state or local code requirements. Installation should only be completed by an adult. If you choose to do it yourself, please read and follow the instructions carefully.

GROUNDING INSTRUCTIONS

WARNING: The appliance must be grounded - if the appliance is improperly grounded, the result could be electric shock. In the event of a malfunction or breakdown, grounding will reduce the risk of electric shock by providing a path of least resistance for electric current. This appliance is equipped with a cord having an appliance-grounding conductor and a grounding plug. The plug must be plugged into an appropriate outlet that is installed and grounded in accordance with all local codes and ordinances.

WARNING

Improper connection of the appliance-grounding conductor can result in a risk of electric shock. Check with a qualified electrician or service representative if you are in doubt whether the appliance is properly grounded. Do not modify the plug provided with the appliance; if it will not fit the outlet, have a proper outlet installed by a qualified technician. Boil the water should the purification unit fail.

Our dispensers of UV lamp type conform to the applicable provisions of the Code of Federal Regulations (CFR) requirements including, Title 21, Chapter 1, Subchapter J, Radiological Health.

Note: Images shown may vary from your particular model.

Note: Flush 2 liters of water from the system after a system failure.

WHAT YOU ARE GOING TO NEED WHEN INSTALLING THE WATERLOGIC COUNTERTOP



A)
Electrical power lead
(supplied in the box)

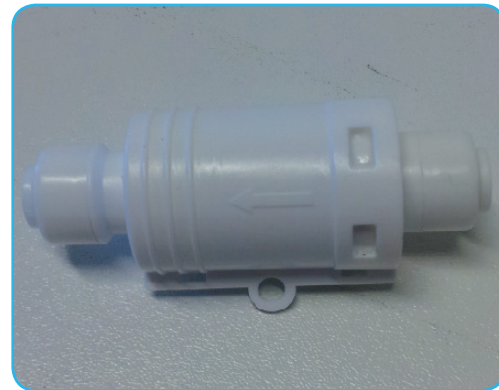

B)
1/4" push-fitting pressure reducing valve (supplied in the box, located inside the drip tray)

This pressure regulator must be used to limit the incoming water pressure to a maximum of 3 Bar. If it is not used the incoming water pressure must be regulated and must not exceed 3 Bar



1/4" push-fitting outlet

C)
1. A potable water source
2. A 1/4" push-fitting on the outlet

Not supplied in the box but can be purchased from a local plumbing or DIY store

The Countertop can be connected to the water source supplying the fridge or dishwasher and other appliances such as this, as long as the water source is deemed potable



D)
2 to 3 metres of 1/4" flexible tubing

Not supplied in the box but can be purchased from a local plumbing or DIY store

NOTE: Please ensure the installation is conducted in compliance with local plumbing codes. Depending on your location, you may be required to install a back-flow preventer or other parts.

1. HOW TO INSTALL THE WATER CONNECTION FOR YOUR WATERLOGIC COUNTERTOP

1.1 Cut a 20cm length of your ¼" flexible tubing (see picture E)

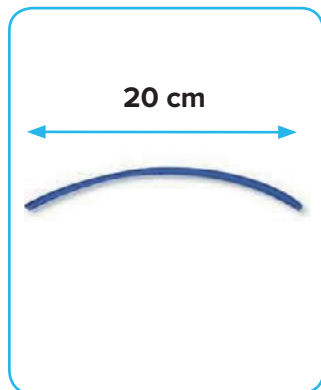

E)

1.2 Insert one end of the tube into the water inlet at the back of the Countertop (see pictures F & G)



F)



G)

1.3 Fit the pressure reducing valve onto the other end of the tube, making sure the direction of flow arrow is pointing the right way (see picture H for the correct installation)

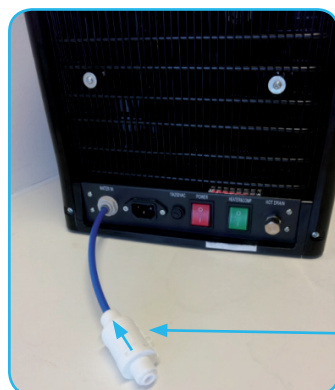

H)

1.4 Connect your 1/4" push-fitting to the water outlet



Water outlet with isolator valve 1/4" push fitting outlet - cold water only

1.5 Connect the water outlet to the open end of the pressure reducing valve via a length of 1/4" flexible tubing (see picture I)



Water outlet

1/4" pressure reducing valve

I)

1.6 Turn on the water supply and check all the connections for leaks

Key Point

When inserting tubing into the push-fittings, make sure the tube is pushed firmly into the fitting and check that it is secure.

When installing the machine, ensure you leave enough length on the 1/4" flexible tubing to make moving the machine for maintenance easier, 25-40cm (10" to 15") should be enough for most situations.

2. HOW TO INSTALL THE POWER CONNECTION FOR YOUR WATERLOGIC COUNTERTOP

We strongly recommend connecting the appliance to a circuit that is protected by a ground-fault circuit-interrupter (GFCI).

2.1 Plug your electrical power lead into the power inlet at the back of the Countertop (see pictures J & K)

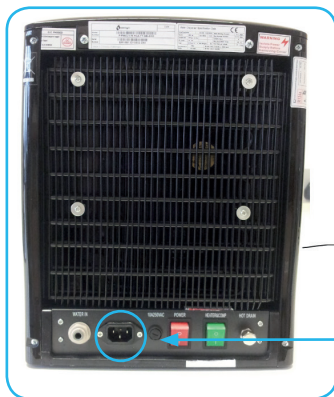

Connect
your
electrical
power
lead into
here



J)

K)

2.2 Plug the electrical power lead into the wall socket (see picture L)



L)

2.3 Turn on the red power switch at the back of the Countertop and it will illuminate ('1' is for on) (see picture M). Do not turn on the green heater / compressor switch at this stage

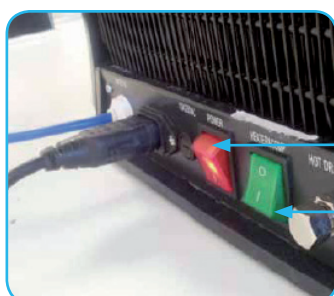

Turn this
switch on

Do not turn on the green
heater / compressor
switch at this stage

M)

2.4 The Countertop will now go through a self test cycle to check all the functions on the machine are working correctly. The highlighted icon below will flash repeatedly until this process has finished (see picture N)

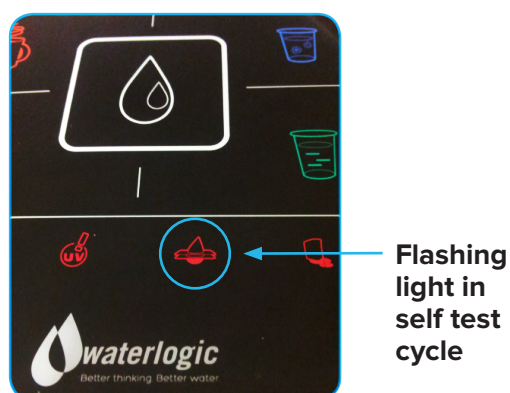

N)

2.5 After the Countertop has finished going through the self test cycle and the icon shown in picture N is no longer flashing, place a container in the dispense area for the flushing process (see picture O)



O)

3. HOW TO FILL THE HOT WATER TANK AND FLUSH THE FILTER

Do not turn on the green heater / compressor switch before filling and flushing the hot tank, cold tank and ambient water pipes.

3.1 Select and hold the hot water icon until it lights up. Whilst the hot water icon is lit, select and hold the central dispense button

3.2 Keep the central dispense button held down until the hot tank has filled and water is coming out of the dispensing area (this could take 2-4 minutes)*

3.3 Once the tank is full with water, continue to dispense a further 4 litres (1 gallon) of water through the hot option by following the procedure above**

Key Points

* You may need to repeat the process of selecting the water icon and holding the central dispense button as the machine has an automatic button unselect safety feature.

**The initial water dispensed from the machine may be discoloured. This is just the carbon fines from the filter and is a natural, organic material that is harmless to health if digested.



Refer to the operational instructions (page 5) for full instructions on using the machine's dispense features

4. HOW TO FILL THE COLD WATER TANK

4.1 Select and hold the cold water icon until it lights up. Whilst the cold water icon is lit, select the central dispense button to start filling the cold tank with water

4.2 After one minute the machine will automatically un-select the central dispense button. Repeat step 4.1 until the cold tank has filled and water is coming out of the faucet (this could take 2-4 minutes)*

4.3 Once the tank is full with water continue to dispense a further 4 litres (1 gallon) of water through the cold option by following the procedure above.

Key Point

* You may need to repeat the process of selecting the water icon and the central dispense button as the machine has an automatic button unselect safety feature.



5. HOW TO FLUSH THE AMBIENT WATER PIPES

5.1 Select and hold the ambient water icon until it lights up. Whilst the ambient water icon is lit, select the central dispense button to start filling the ambient pipes with water.

5.2 Keep the button selected until water is coming out of the faucet (this could take 10-20 seconds).

5.3 Continue to dispense a further 500ml (15-20 fluid ounces) of water through the ambient option by following the procedure above.

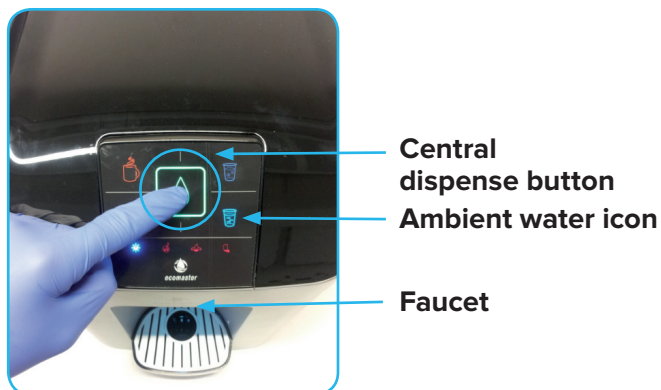

5.4 Once you have completed steps 3.1-5.3, you can turn on the green heater / compressor switch at the back of the Countertop. Press down to switch on ('1') and it will illuminate.

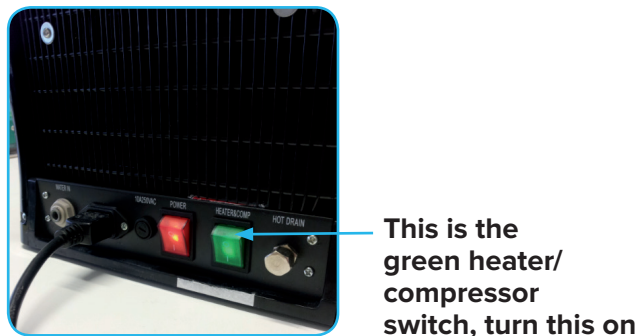

5.5 The machine will now begin to heat / chill the water. The hot water should be up to operating temperature after 8-10 minutes and the cold water will take between 60-90 minutes to cool.

5.6 The water should now be taste tested, if there is any hint of taste in the water then flush an additional 5 liters (1.3 gallons) of hot and then 5 liters (1.3 gallons) of cold. Do another taste test and if necessary repeat the flush again.

6. SETTING THE ENERGY SAVING FEATURE

6.1 If you want the energy saving feature to be set to 3 hours, press and hold the hot water icon for 10 seconds until you hear the machine beep. The energy saving feature will now activate if the machine is not used for 3 hours.

6.2 If you want the energy saving feature to be set to 72 hours, press and hold the extra hot water icon for 10 seconds until you hear the machine beep. The energy saving feature will now activate if the machine is not used for 72 hours.

CONGRATULATIONS, YOUR WATERLOGIC COUNTERTOP IS NOW READY TO USE.



12 Month Servicing Guide

- Servicing of the Countertop needs to take place every 12 months. Operational, maintenance, and replacement requirements are essential for the water-treatment device to perform as represented
- During the 12 month service it is recommended you de-scale the hot tank in order to remove any calcium build up inside the tank, just like you would a kettle. Please use the Waterlogic Countertop De-scaling Kit. If you do de-scale the machine, please do so prior this service procedure
- The filter and UV lamp must be replaced at this service
- Some units may have screws holding the lid on that will need to be unscrewed before the lid can be removed. This will be model dependant. Screws will need to be put back when the lid is replaced
- Servicing must be performed by an adult

WHAT YOU ARE GOING TO NEED WHEN SERVICING THE WATERLOGIC COUNTERTOP



Latex rubber gloves

Recommended



Phillips / cross head screwdriver

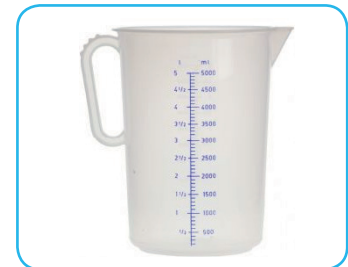

A container that can hold 5 litres



Countertop Pure Kit, which includes a sediment filter, a carbon filter and a UV lamp

Please make sure you use only original Waterlogic replacement parts. If you are not sure which replacement parts to use, please consult with your local Waterlogic retailer or distributor.

Important Note About Servicing

MODEL NUMBER: F-FWCU1-M-HCA-TT-XX-YY2

This system, when used with FT-0006-L00-XXX 1 micron CBC cyst and lead reduction filter, has been tested and certified by WQA according to NSF/ANSI 42, NSF/ANSI 53, NSF/ANSI 55 Class A and NSF/ANSI P231 as verified and substantiated by test data.

To ensure the highest quality of water and compliance with NSF Protocol P231, the Countertop model that is on sale in the US includes a 1 micron carbon block filter with cyst & lead reduction capabilities, and a 13 Watt UV-C lamp, that requires periodic replacement (annually, in most cases).

Please ensure you purchase only original Waterlogic replacement parts sold in the US.

Part numbers:

- The Countertop Pure Kit which is sold in the US: K-FU-00S20-00C1L-13-0-XXX
- Sediment filter assembly included in the Countertop Pure Kit: FT-0003-L00-XXX
- Carbon block filter assembly included in the Countertop Pure Kit: FT-0006-L00-XXX
- UV lamp included in the Countertop Pure Kit: CT-2090-C

** Please note the letters “XXX” can be any 3 letters.

Where to buy

the Hybrid Pure Kit is available from the retailer where you purchased your machine, call us if you want more details

 1-800-574-0435

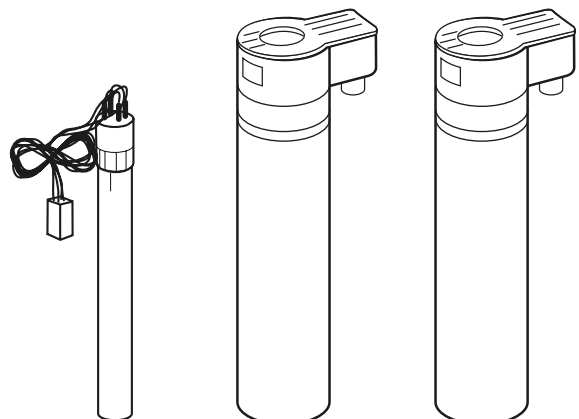

CT-2090-C
UV lamp

FT-0003-L00-XXX
Sediment Filter

FT-0006-L00-XXX
Carbon Block Filter

Do not use with water that is microbiologically unsafe or of unknown quality without adequate disinfection before or after the system.

Systems certified for cyst reduction may be used on disinfected waters that may contain filterable cysts.

7. PREPARING FOR SERVICE

7.1 Put on the rubber gloves to minimise the chance of any contamination to the machine.

7.2 Turn off the incoming water supply at the isolation point

7.3 Select the cold water icon until it lights up. Whilst the cold water icon is lit select and hold the central dispense button, when the water stops flowing release the button and continue to step 1.3. (see picture A)



A)

7.4 Turn off the red and green power switches at the back of the Countertop to the '0' position and remove the power lead from the wall socket and machine (see picture B)



B)

7.5 Remove the top cover from the machine by placing your hands on the top of it, pushing it backwards (step 1) and lifting it upwards (step 2) (see picture C). You may be required to remove two screws at the back of the machine to enable you to remove the top cover (this is dependant on the machine model)

Note: you may need to move the machine from under wall units to allow access. This is why it is important you fit an extra 15-30cm of the flexible tubing from the water supply when installing the unit.

Please take care not to dislodge the flexible tubing connection.

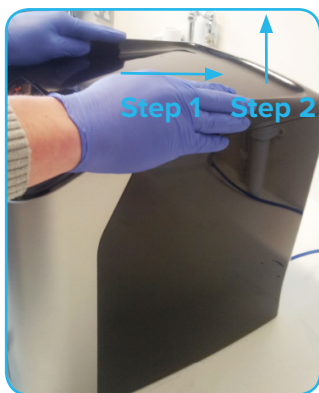

C)

8. REPLACING THE CARBON BLOCK FILTER

8.1 Insert your finger into the loop at the top of the carbon block filter (the filter that is closer to the front of the machine) and pull it up until it is in the vertical position (see picture D)



The carbon block filter is closer to the front of the machine

D)

8.2 Remove the filter by pulling straight upwards on the filter loop (see picture E)



E)

8.3 Insert the new carbon block filter assembly into its cradle, with the filter loop on the left (see picture F) , which enables the filter shape to perfectly fit the cradle profile



F)

8.4 Push the filter firmly into place until the filter sits snugly and is flush with the cradle top surface then lock the filter into place by closing the locking lever until it 'clicks' into place (see picture G)



G)

9. REPLACING THE SEDIMENT FILTER

9.1 Insert your finger into the loop at the top of the sediment filter (the one which is closer to the back of the machine) and pull it up until it is in the vertical position (see picture H)

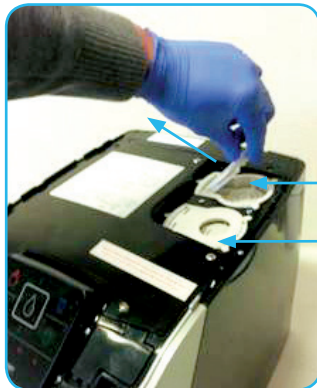

Sediment filter (some machines may not have this option, due to better water conditions in some regions)
Carbon block filter

H)

9.2 Remove the filter by pulling straight upwards on the filter loop (see picture I)



I)

9.3 Insert the new sediment filter assembly into its cradle, with the filter loop on the left (see picture J), which enables the filter shape to perfectly fit the cradle profile



J)

9.4 Push the filter firmly into place until the filter sits snugly and is flush with the cradle top surface then lock the filter into place by closing the locking lever until it 'clicks' into place (see picture K)



K)

10. REPLACING THE UV LAMP

10.1 Remove the UV lamp protective cover from the front right hand side of the machine by undoing the fixing screw and lifting the cover up (see pictures L & M)



L)

**UV
protective
cover**

**UV
protective
cover fixing
screw**

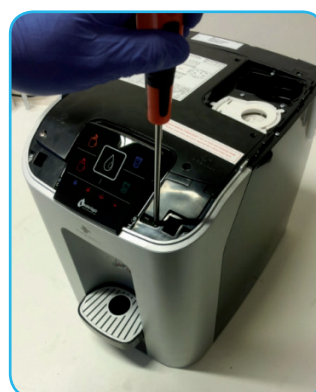

M)

10.2 Disconnect the UV lamp connector by pressing in the clip on the side of the connector (step 1) and pulling the connector towards the front of the machine (step 2) (see picture N)

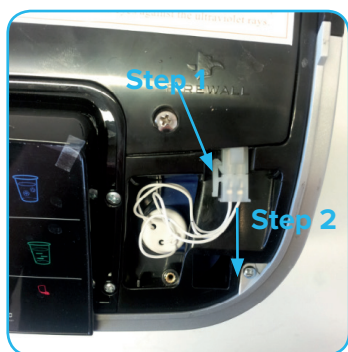

N)

10.3 Holding onto the white end cap of the UV lamp, pull firmly upwards to remove the lamp. Make sure you do not pull the lamp out at an angle, as you may risk breaking or damaging the machine's internal components (see picture O)

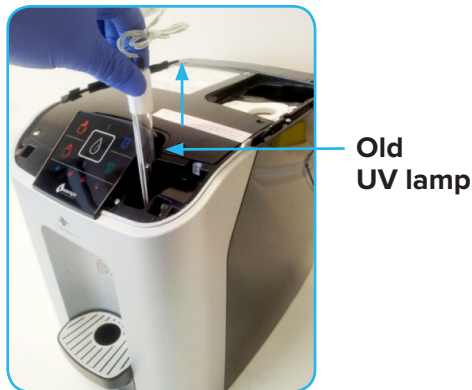

O)

10.4 Take the new UV lamp and insert it into the same position at the front of the machine where the old lamp was positioned, making sure you hold the lamp only by the white end cap (see picture P). Please take care when inserting the lamp to avoid breaking it - ensure that it is fully vertical when you insert it, and do not use excessive force

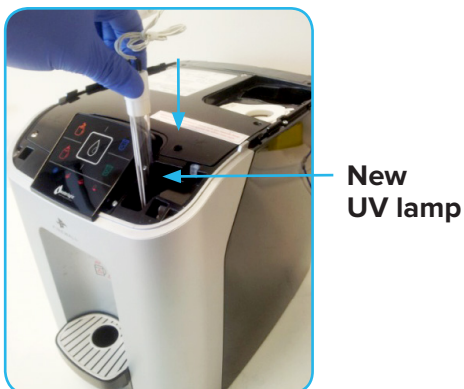

P)

10.5 Insert the connector on the new UV lamp into the UV connector in the machine (see picture Q)

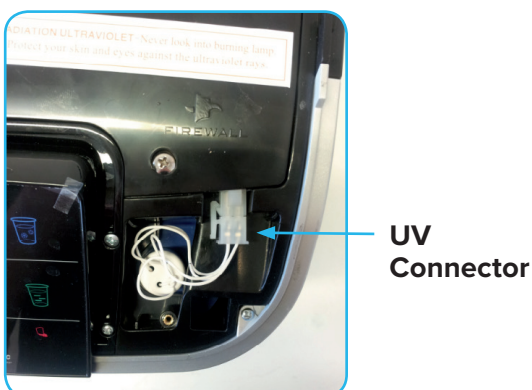

Q)

10.6 Refit the UV lamp protective cover and secure it in place with the fixing screw (see picture R)

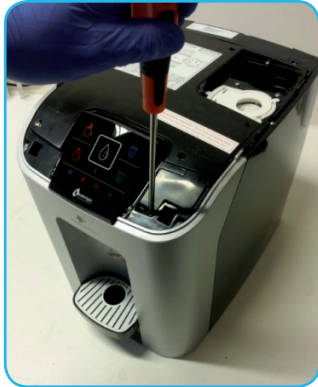

R)

10.7 Refit the top cover onto the machine by placing into position, making sure the two fixing lugs at the front are lined up with the grooves (step 1) and then pulling the cover firmly towards yourself until it clicks into place (step 2) (see picture S).
If your machine has screws holding down the top cover, screw them back in at this stage. Hand tighten only.

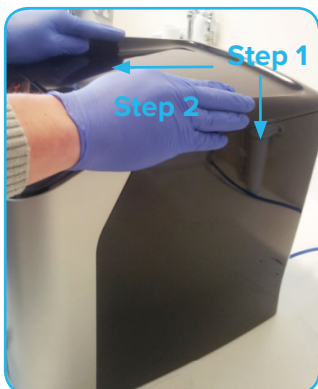

S)

10.8 Reconnect the power lead into the back of the machine and then insert the plug into the wall socket (see picture T)



T)

10.9 Turn on the red power switch on the back of the machine to the “I” position.



Turn on the red switch

U)

11. FLUSHING THE NEW FILTERS

11.1 Turn on the incoming water supply at the isolation point.

11.2 Place your container in the machine’s dispense area for the flushing process (see picture V).



V)

11.3 Select and hold the ambient water icon until it lights up. Whilst the ambient water icon is lit, select and hold the central dispense button to start dispensing water. Continue to hold the dispense button until 8 litres of ambient water has passed through the machine. Once 8 litres has passed through release the dispense button and the water flow will stop. This will sufficiently generate the filter and flush it of any excess carbon fines.



Central dispense
button
Ambient water
icon

W)

11.4 Turn on the green heater / compressor switch at the back of the Countertop to the '1' position (see pictureX).



Turn
on

X)

12. CHECKING THE MACHINE FUNCTIONS AND WATER QUALITY

12.1 The machine will now begin to heat / chill the water. The hot water should be up to operating temperature after 8-10 minutes and the cold water will take between 60-90 minutes to cool.

12.2 The water should now be taste tested, if there is any hint of taste in the water then flush an additional 5 liters of hot and then 5 liters of cold. Do another taste test and if necessary repeat.

13. RESETTING THE FILTER TIME

13.1 To reset the filter timer, hold down the hot and cold icons simultaneously for 10 seconds, until the appliance “beeps”. If the filter warning indicator was lit, it should disappear at this stage.

Product Disposal

At the end of this products life, please ensure that it is disposed of in an environmentally friendly manner which is in line with your Country requirements/guidelines.

WEEE (EU ONLY)

Please be aware that our products are covered by the Waste Electrical and Electronic (WEEE) directive (2002/96/EC). The symbol shown above denotes that the product should not be disposed of with general/household waste. Hand it in at an official collection point for recycling.

ROHS

All Waterlogic machines comply with EC Directive (2002/95/EC) on the Restriction of the Use of Certain Hazardous Substances in Electrical and Electrical Equipment (RoHS).

Performance Data Sheet

MODEL NAME: F-FWCU1-M-HCA-TT-XX-YY2 WATERLOGIC COUNTERTOP WATER PURIFIER WITH CYST/LEAD REMOVAL FILTER FT-0006-L00-YYY AND SEDIMENT REMOVAL FILTER FT-0003-L00-YYY

XX: COLOR CODE, -YY2: CUSTOMER CODE

IMPORTANT NOTICE



This system, when used with FT-0006-L00-WLT 1 micron CBC cyst and reduction filter, has been tested according to NSF/ANSI 42, NSF/ANSI 53, NSF/ANSI 55 Class A and NSF/ANSI P231 for the reduction of the substances listed below.

The concentration of the indicated substances in water entering the system was reduced to a concentration less than or equal to the permissible limit for water leaving the system, as specified in NSF/ANSI 42, NSF/ANSI 53, NSF/ANSI 55 Class A and NSFANSI P231. While testing was conducted under standard laboratory conditions, actual performance may vary.

Filter Performance Data Table						
Parameter	Minimum % reduction requirement / Max effluent concentration	Average Influent Challenge	Effluent Average	Effluent Maximum	Percent Reduction Average	Percent Reduction Minimum
Chlorine	>=50% reduction	1.90 ppm	0.02 mg/L	0.02 mg/L	98.9%	98.9%
Cyst	>=99.95% reduction	120,000 oocyst/L	38 oocyst/L	< 50 oocyst/L	99.99%	99.97%
Lead (Low pH = 6.5)	< 10 ug/L	144 ug/L	0.49 ug/L	1.60 ug/L	99.7%	98.9%
Lead (High pH = 8.5)	< 10 ug/L	140 ug/L	1.47 ug/L	7.50 ug/L	98.9%	94.6%
Particulate Class I (>=0.5 um to <1 um)	>=85% reduction	>=10,000 particles/ml	288 particles/ml	704 particles/ml	97.9%	94.9%

Tested using flow rate=0.5 GPM; pressure=60 psi; pH=7.5 ± 0.5; temp.=20 ± 1.0 °C.

UV Performance Data Table

Parameter	Log Reduction Average
Bacteria (R.terrogema)	7.4 Log
Virus (MS2)*	3.16 Log

Note: 2 Log reduction of MS2 is equivalent to 4 Log reduction of Poliovirus or Rotavirus

Tested using flow rate=0.5 GPM; pressure=60 psi; pH=7.5 ± 0.5; temp.=20 ± 1.0 °C.

Operating Specifications

Filter Capacity	2,500 Gallons / 9,464 Liters
Lead Capacity	1,250 Gallons / 4,732 Liters
Maximum Flow Rate	0.34 GPM / 1.3 LPM
Feed Water Temperature	2 °C / 35 °F - 32 °C / 90 °F
Operating Temperature	5 °C / 41 °F - 30 °C / 86 °F
Working Pressure	0.26Mpa / 37.7Psi - 0.414Mpa / 60 Psi
Electrical Requirements	EU: 220-240V 50Hz / maximum 3.0 amps; USA: 120V 60Hz / maximum 6.2 amps

GENERAL INSTALLATION/OPERATION/MAINTENANCE REQUIREMENTS

- This appliance is for use with potable drinking water only. Never use this appliance with unknown or unsafe sources.
- Flush the hot tank, cold tank and filters as instructed.
- Replace filter cartridge when rated capacity is reached, or every 12 months, or when flow becomes to slow.
- Replace UV lamps every 12 months, or when the UV intensity is lower than required.
- Install in compliance with state and local laws and regulations.

Manufactured by Qingdao Waterlogic Manufacturing Co., Ltd
No 10 Jinling Road, Jinling Industrial Zone, Chengyang District, Qingdao, 266111, Shandong, P.R. CHINA TEL: +86-532-87909132

SPECIAL NOTICES

- The contaminants or other substances removed or reduced by this water treatment system are not necessarily in your water.
- Do not use with water that is microbiologically unsafe or of unknown quality without adequate disinfection before or after the system.
- System certified for cyst reduction may be used on disinfected waters that may contain filterable cysts.
- This Class A system conforms to NSF/ANSI 55 for the disinfection of microbiologically contaminated water that meets all other public health standards. The system is not intended to convert wastewater or raw sewage to drinking water. This system is intended to be installed on visually clear water. NSF/ANSI 55 defines wastewater to include human and/or animal body waste, toilet paper, and any other material Intended to be deposited in a receptacle designed to receive urine and/or feces (blackwaste); and other waste materials deposited in plumbing fixtures (greywaste).
- Performance may vary based on local water conditions seconds.

WARRANTY

Waterlogic International (Waterlogic) warrants that the products delivered will be free from any defects in workmanship or materials. Further, the warranty provided here in applies, only when used within the products specifications and service life, from the date of installation, beyond which time or use Waterlogic is absolved of any and all liability for any use of the product. In the event of defect or non-conformity, buyer shall promptly notify Waterlogic in writing, supplying proof of purchase dates, installation dates, and will protect and retain the products for investigation, or Waterlogic is absolved of any and all liability for any use of the product. There are no other warranties, either merchantability or fitness, either expressed or implied.

FOR IOWA ONLY

The Manufacturer's PDS shall be given to the buyer by the seller and shall be signed and dated by the buyer and the seller prior to the consummation of the sales of the water treatment system and retained on file by the seller for a minimum of two years.

Seller _____ Date _____

Buyer _____ Date _____



We hope you love drinking good water as much as we do.
Please let us know your thoughts by email to
goodwater@waterlogic.com

To speak to a Water Expert,
please refer to your Guarantee
and After-sales service card
for contact details.