

Spring Roller Shade

Installation Guide

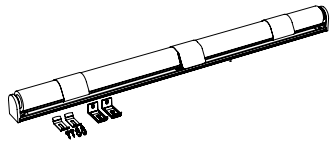

Components & fittings



Standard click-on brackets, L-brackets, screws and wall plugs

Tools Required

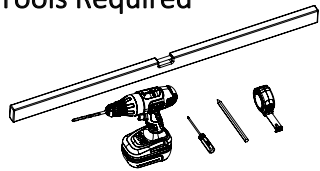

Power drill and 3/32" drill bit, screwdriver or bits with phillips heads, level, metal tape measure, a pencil and note pad

Installation Positions

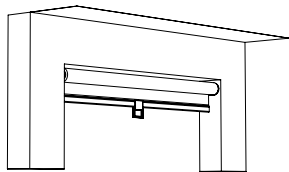

Inside mount (Use L-brackets)

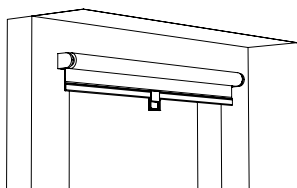

Outside mount (Use standard click-on brackets)

Measurement instructions

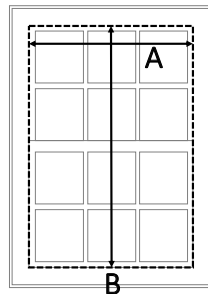

Inside mount

Measure the window opening width at the top (A) rounded down to the closest 0.5". The depth of the window frame must be at least 1.5" for inside mount.

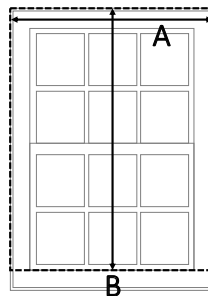

Outside mount

Measure the width from edge to edge of window molding (A) to the closest 0.5". If preferred the shade can also be installed on the wall above the molding.

The maximum height (B) of the IFit shade is 73".

Inside mount

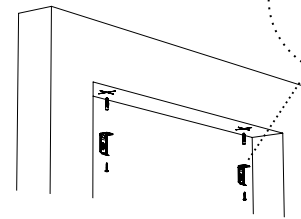

With a pencil, mark the position of the brackets approx. 4" from the inside edges. Use the level to assure that brackets are level across. For shades 47" and shorter 2 mounting brackets are supplied.

(For 47,5" and wider shades an extra third middle bracket is supplied)

Drill mounting holes using a 3/32" drill bit. Attach brackets with the provided screws using a screw driver or power drill. (If installed in drywall use the supplied plugs) .

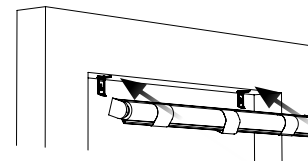

Install the shade by simply clicking it on the bracket with an up and in motion. Now the shade can be adjusted sideways by hand to be centered.

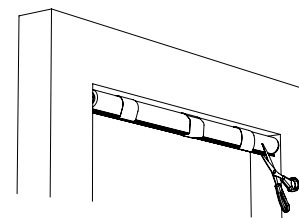

Carefully remove the protective tape

Outside mount

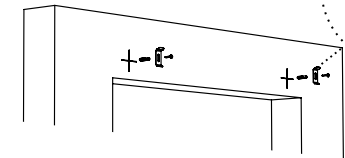

With a pencil, mark the position of the brackets approx. 4" from the edges of the roller shade. Use the level to assure that brackets are level across. For shades 47" and shorter 2 mounting brackets are supplied.

(For 47,5" and wider shades an extra third middle bracket is supplied)

Drill mounting holes using a 3/32" drill bit. Attach brackets with the provided screws using a screw driver or power drill. (If installed in drywall use the supplied plugs).

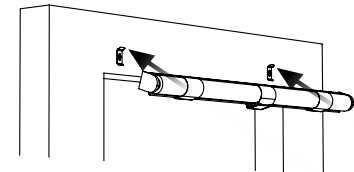

Install the shade by simply clicking it on the bracket with an up and in motion . Now the shade can be adjusted sideways by hand to be centered .

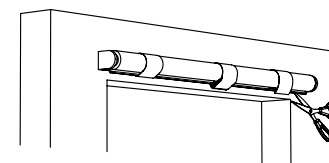

Carefully remove the protective tape

Spring Roller Shade

Installation Guide - Adjusting the Shade (optional)

Spring Roller Shade Installation Guide

Option 1: The roller shade is stopping too low

Hold the left part of the shade with one hand and lift the adjustable ring in the bracket. Turn the ring together with the shade in the clockwise direction and insert it back in the bracket slot. Half turns (180°) and full turns (360°) are possible. The bigger adjustment in the clockwise direction, the higher the shade will stop. More than 1 adjustment might be needed before reaching desired position.

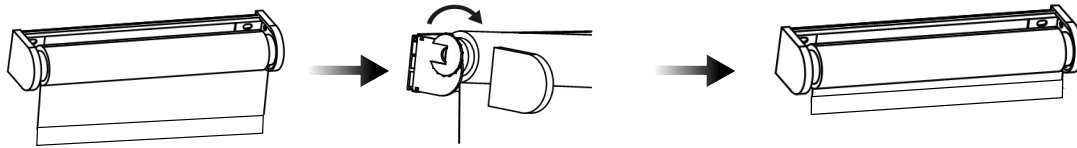

Option 2: The roller shade is stopping too high

Hold the left part of the shade with one hand and lift the adjustable ring in the bracket. Turn the ring together with the shade in the counterclockwise direction and insert it back in the bracket slot. Half turns (180°) and full turns (360°) are possible. The bigger adjustment in the counterclockwise direction, the lower the shade will stop. More than 1 adjustment might be needed before reaching desired position.



For more information contact
support@markisolUSA.com