

# HUD-1 EZ BUILDINGS

**731-574-8702**

## Cabins & Homes



Larger cabins and homes for year round dwellings can be virtually any design. We manufacture to order, and to meet local building code requirements for wind and snow loads. For increasing wall heights, adding roof purlins or changing roof slopes the simplicity and versatility is unmatched.

This all natural construction is efficient, and has virtually no waste. Home packages are delivered to site with components pre-cut. Assembly is simpler than conventional construction, reducing labor costs. With the combined thermal mass of a solid wood wall and the insulation, the energy efficiency has unmatched value.

The use of a local engineer is required to adapt our construction methods prior to production to ensure the package meets local requirements.

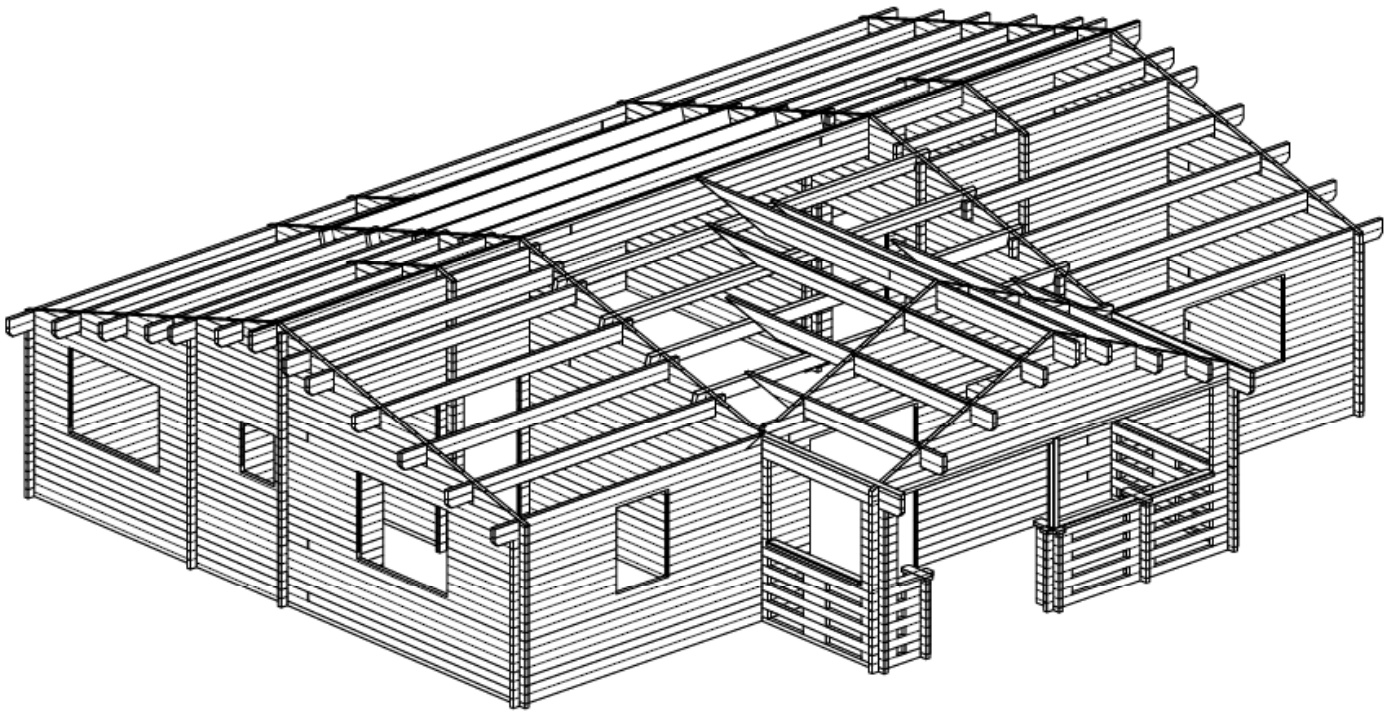

### Wall log sizes

Thickness 58mm/2 1.4"

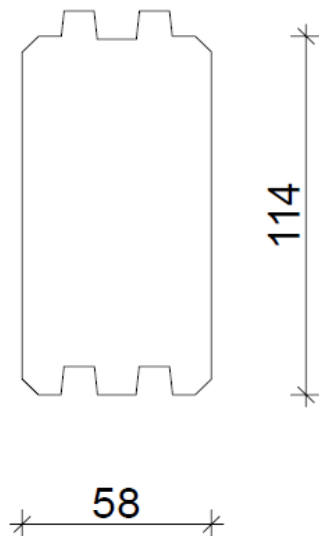

114

58

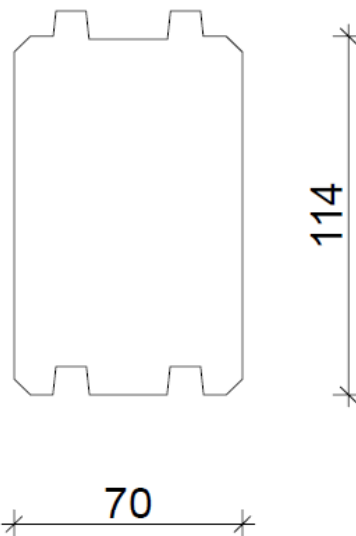

114

70

Thickness 70mm/2 ¾"

Height 114mm/4 ½"

## Mounting first two rows of wall logs to foundation

Concrete

The first TWO rows of wall logs must be secured to the foundation using long screws or lag bolts

A moisture barrier can be applied between the first wall log and the surface it's being mounted to

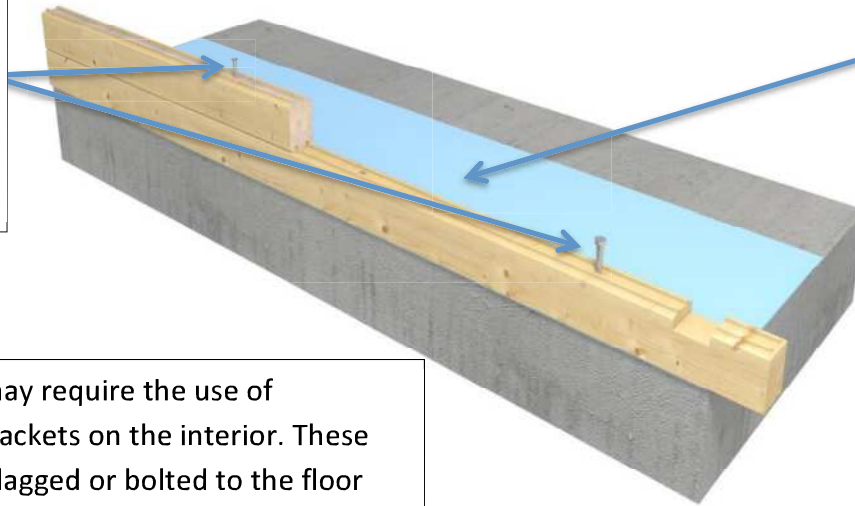

Local wind codes may require the use of additional metal brackets on the interior. These brackets would be lagged or bolted to the floor and fastened to the wall log. When insulating the wall these brackets are not seen.

Wood sub floor

Wood sub floors are built prior to arrival of the package using local materials. Floor plans are provided in advance to determine the location of blocking required under interior walls.

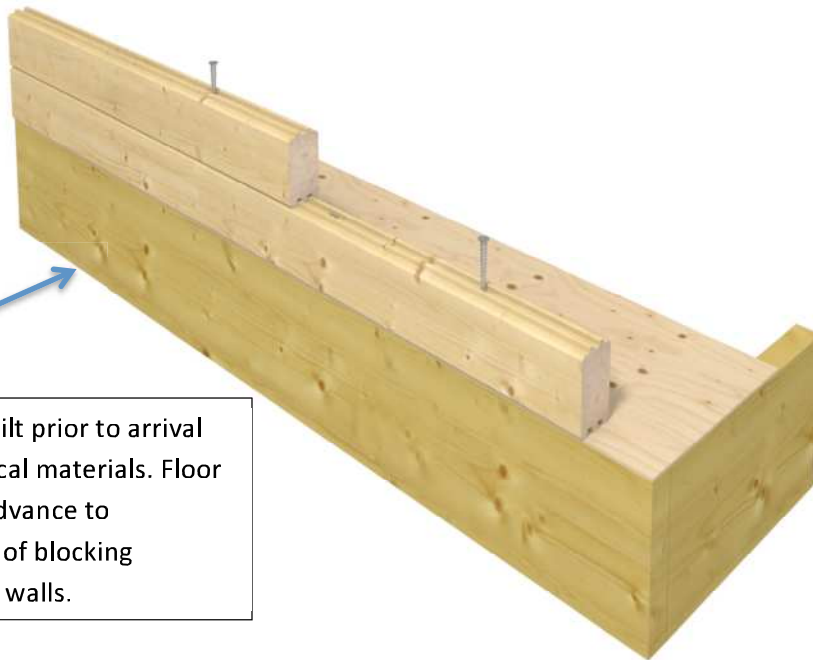

## Windows and doors

Windows and doors are **NOT** fastened to the wall logs with fasteners. This allows free movement for the logs to settle as they climatise. The wall logs have a dado (groove) cut into the edge at the rough opening and the window jamb has a protruding strip of wood built into the jamb that fits into the dado. This joint prevents with window from coming out of the wall, creates an air barrier and allows the wall logs to settle.



2" of space must be allowed on rough opening at the top of all windows and doors. This cavity is reduced over time as the wall logs settle. Larger trim boards are used on the outside and inside.

## Using Local Windows

When local building codes require specific windows & doors, local windows are used. Rough openings are cut during production to fit the local windows & door sizes. A spacer block must be fastened to the outside of the window frames at time of installation.

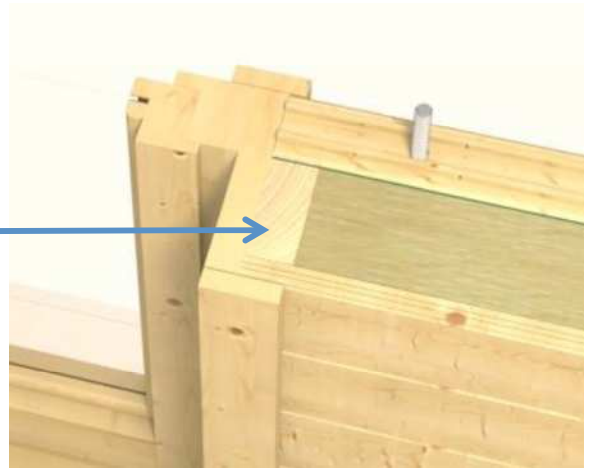

This spacer block is equal to the depth of the studs being used and is sealed and fastened to the bottom and sides of window jambs and sides only of door jambs. (DO NOT apply to the top of jambs)

When the exterior trims (brick mold) is applied on the outside and it creates a cavity for the wall logs to move freely between the spacer block and the exterior trim boards. The exterior trims are not fastened to the wall logs.

Wall logs floats freely between outside trims and the spacer block fastened to window or door jamb

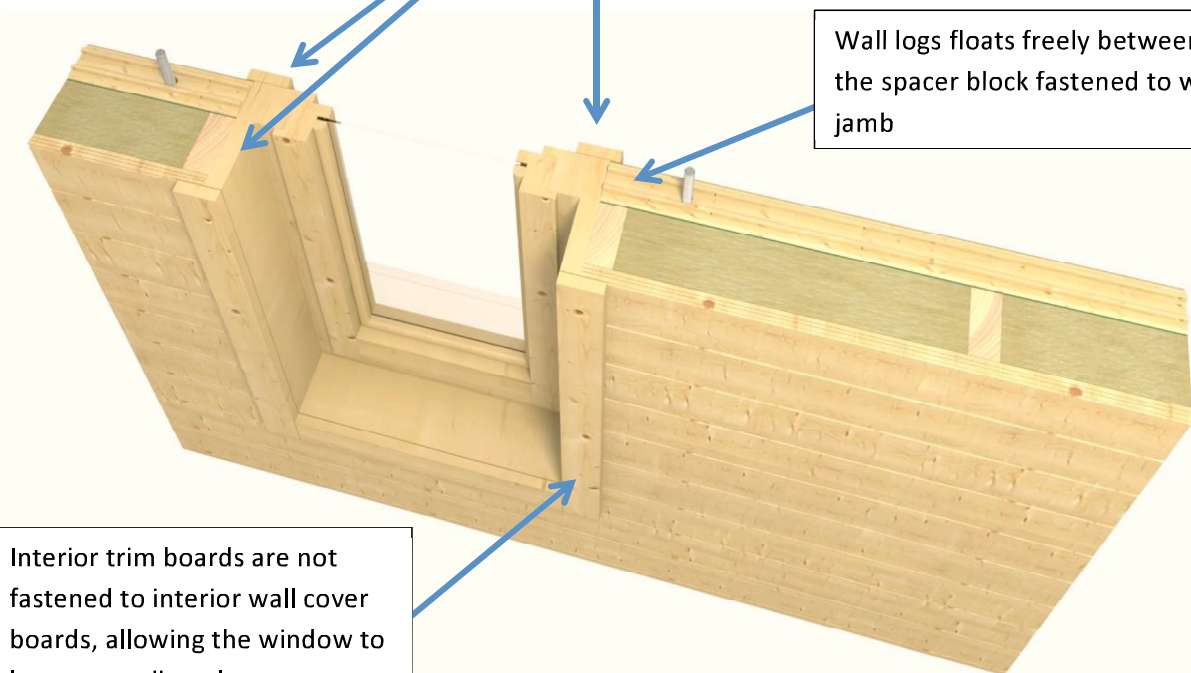

Interior trim boards are not fastened to interior wall cover boards, allowing the window to lower as wall settles.

## Flashing

Where flashing is required above windows and doors a saw kerf is cut in the wall log 2" above the exterior top trim board. Flashing is inserted to the saw kerf and sealed. (do not fasten to wall) As the wall logs settle the flashing will move down freely over the top exterior trim boards.

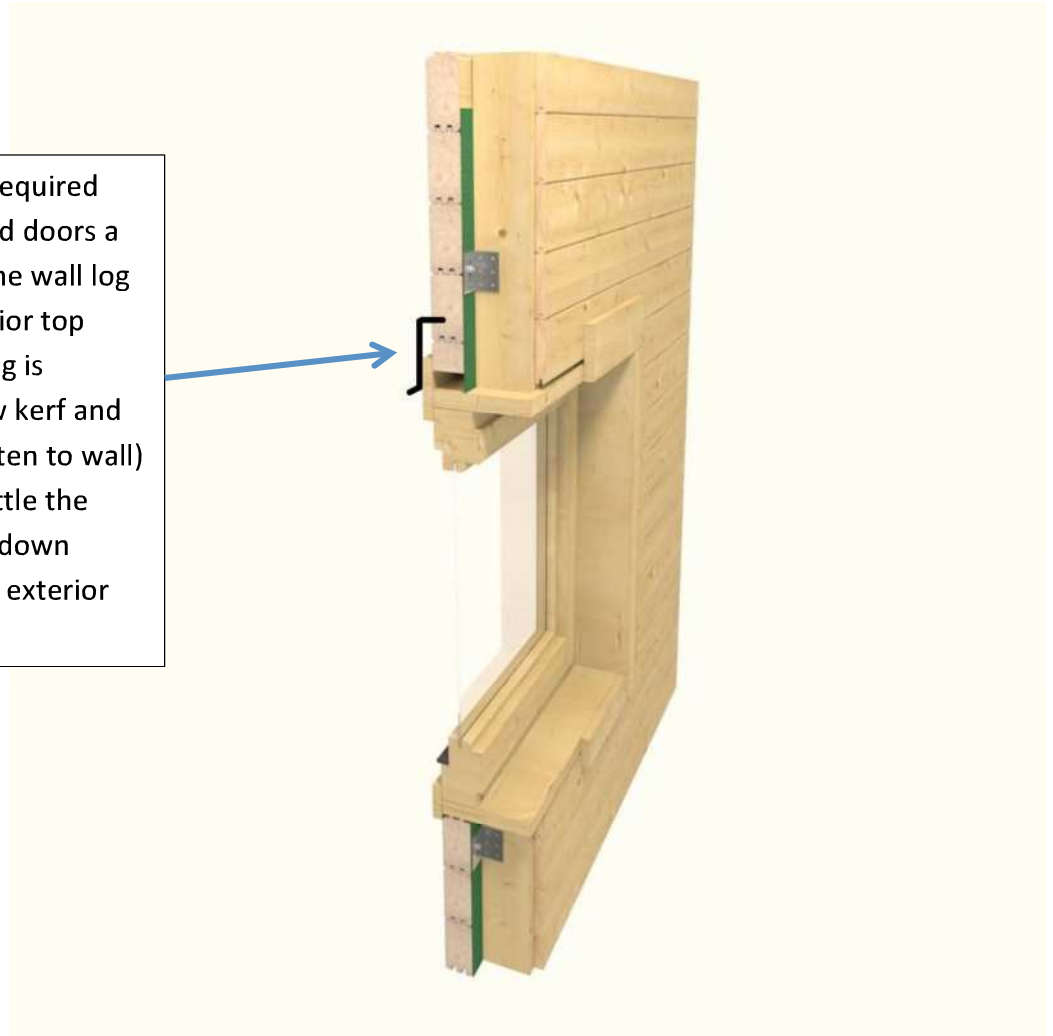

## Insulating Walls



Studs with a depth required for the insulation being used, are installed 16" or 24" on center. Metal brackets are provided to attach the studs to the wall logs. No top plate or bottom plate is required. The metal brackets are designed to allow the exterior wall logs to settle while the studs remain stationary



Studs are cut 2" short of ceiling height to accommodate shrinkage.

A crown molding attached to the ceiling lowers as the wall logs settle

### Insulating ceilings - Option 1



Insulating the ceiling can be done from the interior by placing insulation between the purlins and then applying a cover board to the underside of the purlins. Insulating from the underside reduces ceiling heights. Walls can be increased in height if requested.

### Insulating ceilings - Option 2

Insulating from the outside requires a buildup using local materials. Insulation is installed and then a layer of plywood before installing the finished roofing materials. Larger fascia trims are required for this method.

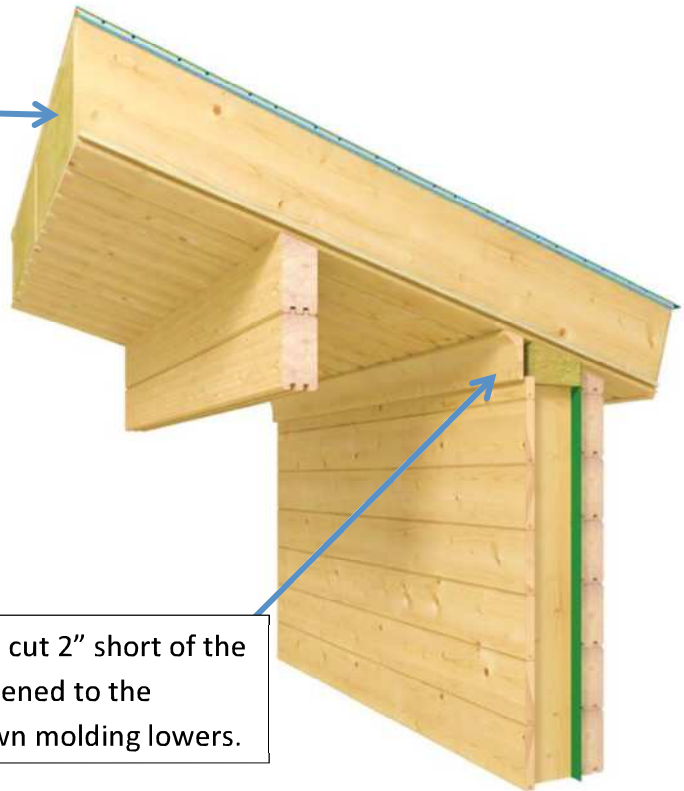

Interior wall cover boards must be cut 2" short of the ceiling and a crown molding is fastened to the ceiling. As the wall settles the crown molding lowers.

## Electrical Wiring

Wiring installed in studs using the same method as regular construction



Interior divisional walls are pre-drilled with electrical chases during production. Wiring is installed during assembly and surface mounted or countersunk electrical outlets are used.

## Vapor Barrier & House Wraps

Must be determined by local engineers based on regions climate

## Wood Treatments

The wood must be sealed on the interior and exterior wall surfaces immediately following assembly. High quality treatments are available locally; similar to what is used on wood decks or fences. Research the wood treatments used in your region from approved manufacturers

## Maintenance

During the first year, storm rods need to be tightened as the moisture content reduces and the building settles. At the end of the first year tightening will not be required. Exterior and interior staining or painting will be required as recommended by the stain or paint manufacturers

---